

1st O.REV.

GENERAL INDEX

INCLUDED THIS PROJECT	BEGIN WITH SHEET
<input checked="" type="checkbox"/> ROADWAY	1
<input type="checkbox"/> PERMANENT SIGNS	1001
<input type="checkbox"/> TRAFFIC SIGNALS	2001
<input type="checkbox"/> ITS COMPONENTS	3001
<input type="checkbox"/> LIGHTING	4001
<input type="checkbox"/> (RESERVED)	5001
<input checked="" type="checkbox"/> ROADWAY STANDARD DWGS	6001
<input type="checkbox"/> BOX CULVERT STD. DRAWINGS (LRFD)	7001
<input type="checkbox"/> BOX CULVERT STD. DRAWINGS (STD. SPEC.)	7501
<input type="checkbox"/> BRIDGE	8001
<input checked="" type="checkbox"/> CROSS SECTIONS	9001

STATE OF MISSISSIPPI

MISSISSIPPI DEPARTMENT OF TRANSPORTATION

PLAN AND PROFILE OF PROPOSED STATE HIGHWAY

FEDERAL AID PROJECT NO. ER-0008-03(060)

US 49 AND SR 27 SLIDE REPAIRS
HINDS COUNTY, MS.

FMS CON. NO. 108474 /301000-US 49
108476 /301000-SR 27

SCALES

PLAN	1 IN. = 20 FT.
PROFILE {	HOR. 1 IN. = 20 FT.
	VERT. 1 IN. = 5 FT.
LAYOUT	1 IN. = 1,000 FT.

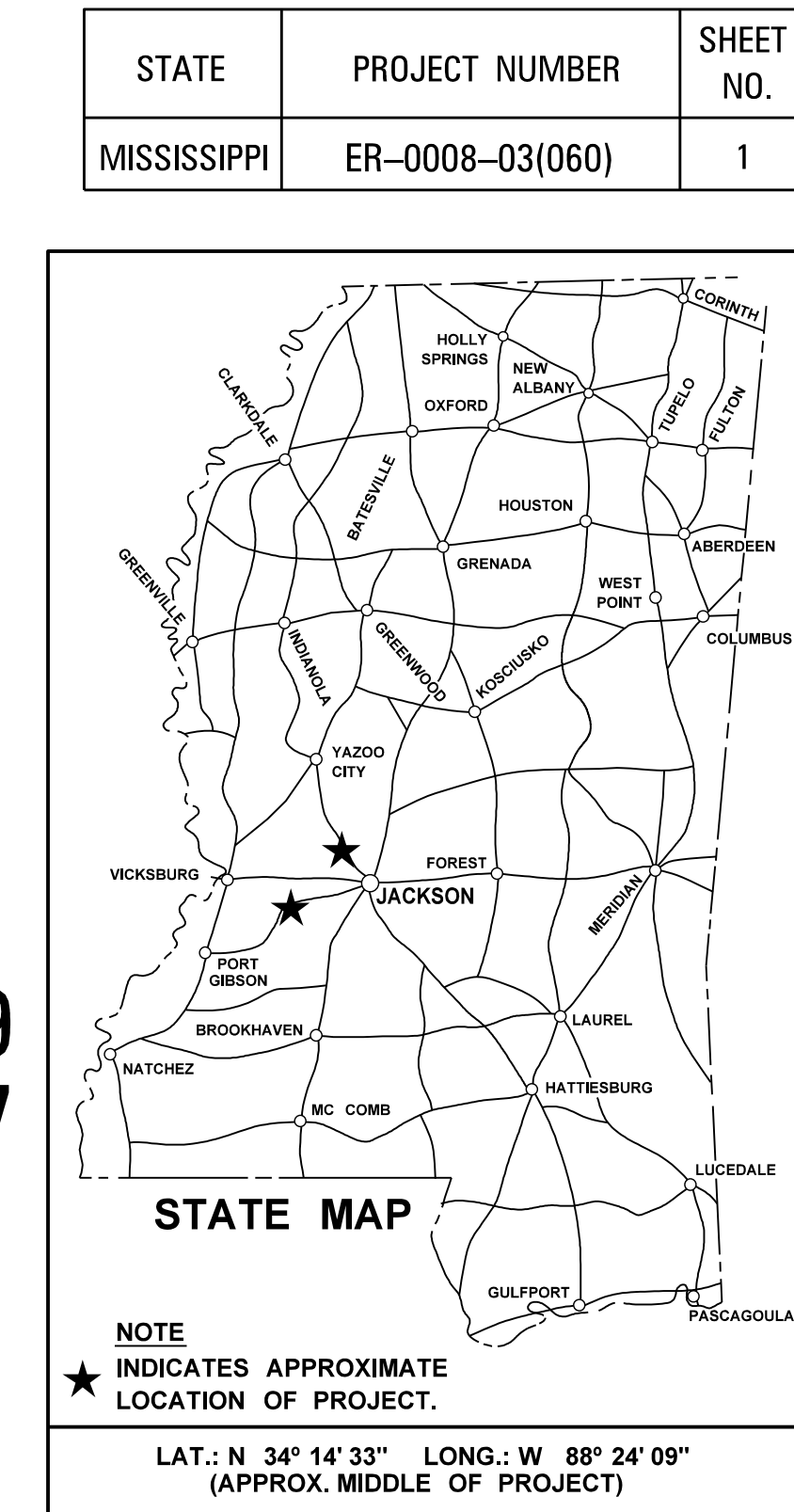

BRIDGE STRUCTURES REQ'D.
NONE

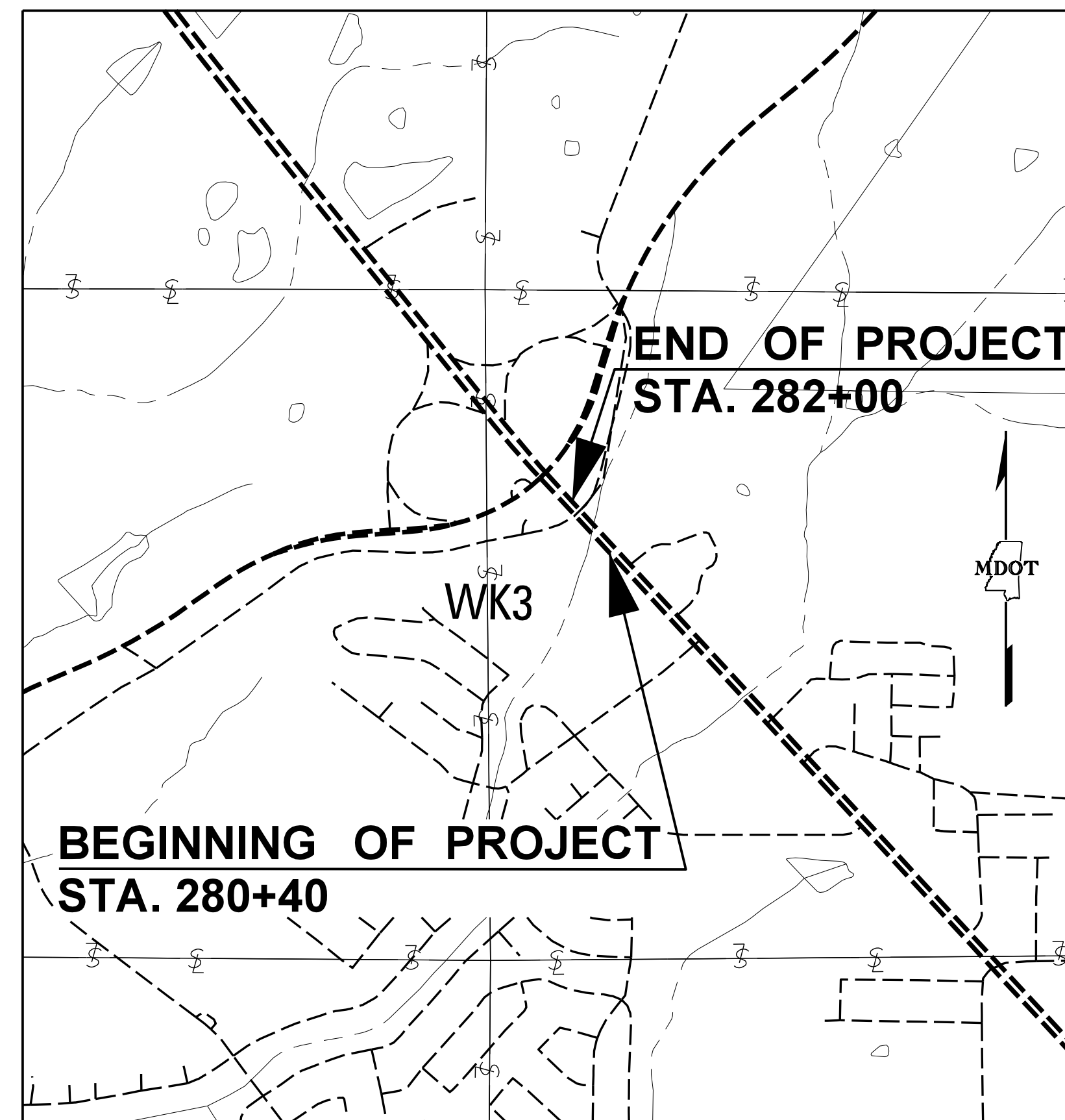

EQUATIONS US 49 NONE
EXCEPTIONS US 49 NONE

LENGTH DATA

LENGTH OF ROADWAY	160.00 FT.	0.030 MI.
LENGTH OF BRIDGES	0.00 FT.	0.00 MI.
LENGTH OF PROJECT (NET)		0.030 MI.
LENGTH OF EXCEPTIONS	0.00 FT.	0.000 MI.
LENGTH OF PROJECT (GROSS)	160.00 FT.	0.030 MI.

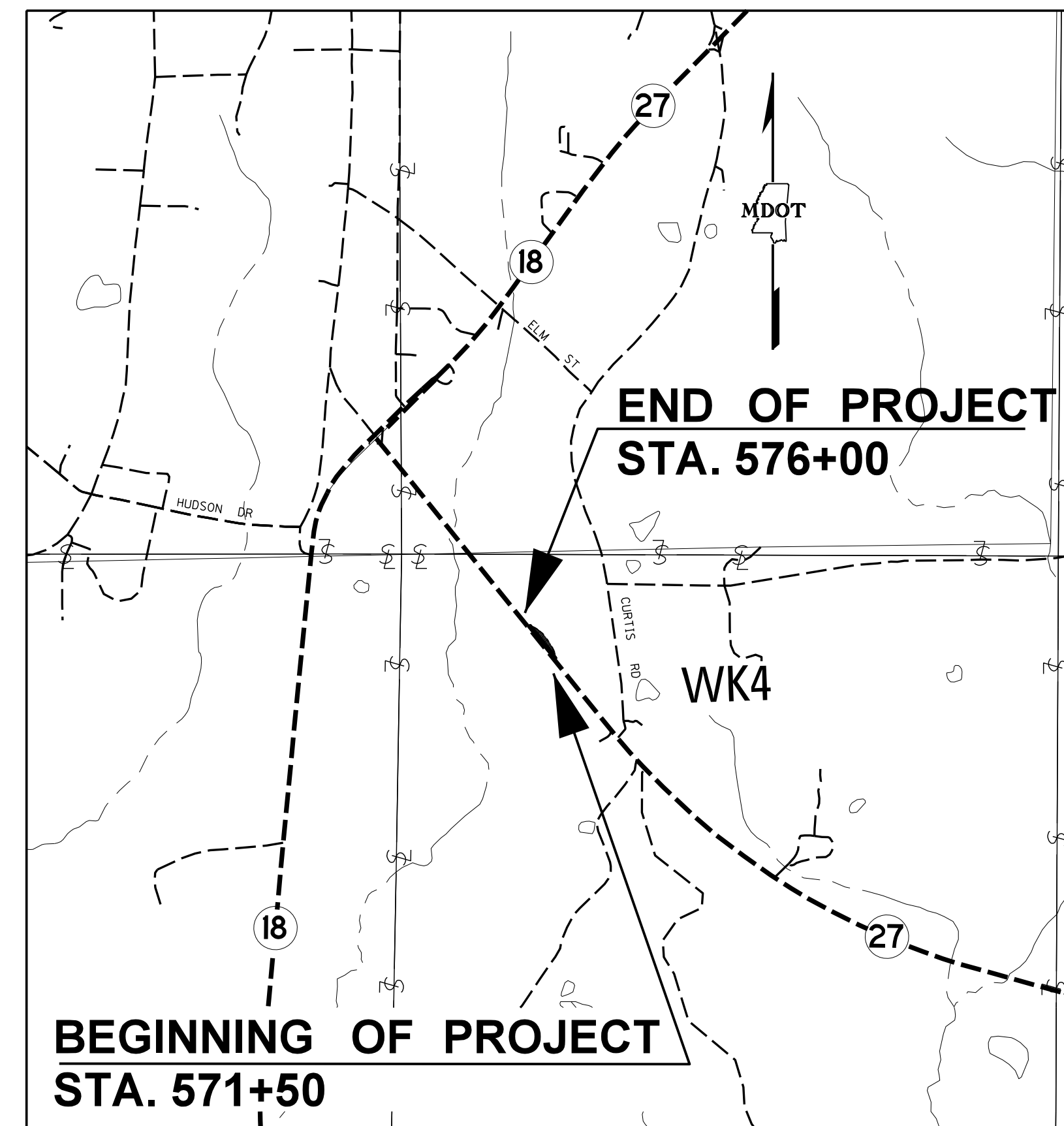

EQUATIONS SR 27 NONE
EXCEPTIONS SR 27 NONE

LENGTH DATA

LENGTH OF ROADWAY	450.00 FT.	0.085 MI.
LENGTH OF BRIDGES	0.00 FT.	0.00 MI.
LENGTH OF PROJECT (NET)		0.085 MI.
LENGTH OF EXCEPTIONS	0.00 FT.	0.000 MI.
LENGTH OF PROJECT (GROSS)	450.00 FT.	0.085 MI.

DESIGN CONTROL US 49
45 MPH = V (SPEED DESIGN)

ADT (2020) = X,XXX : ADT (2040) = XX,XXX
DHV = X,XXX : D = XX % T = XX %

DESIGN CONTROL SR 27
55 MPH = V (SPEED DESIGN)

ADT (2020) = X,XXX : ADT (2040) = XX,XXX
DHV = X,XXX : D = XX % T = XX %

PERMITS ACQUIRED BY MDT

WETLANDS AND WATERS PERMITS		
	WATERS	WETLANDS
NATIONWIDE #14	<input type="checkbox"/> N	<input type="checkbox"/> N
NATIONWIDE (OTHER)*	<input type="checkbox"/> Y	<input type="checkbox"/> N
GENERAL*	<input type="checkbox"/> N	<input type="checkbox"/> N
INDIVIDUAL (404)*	<input type="checkbox"/> N	<input type="checkbox"/> N
STORMWATER PERMIT <input checked="" type="checkbox"/> S		
Y	REQUIRED, CNOI SUBMITTED BY MDT (DISTURBED AREA = 5 ACRES)	
S	REQUIRED, SCNOI TO BE SUBMITTED BY CONTRACTOR (1 TO 4.99 ACRES)	
N	NO STORMWATER PERMIT REQUIRED (<1 ACRE)	
APPROVED BY: _____		

PERMITS ACQUIRED BY MDT

WETLANDS AND WATERS PERMITS		
	WATERS	WETLANDS
NATIONWIDE #14	<input type="checkbox"/> N	<input type="checkbox"/> N
NATIONWIDE (OTHER)*	<input type="checkbox"/> Y	<input type="checkbox"/> N
GENERAL*	<input type="checkbox"/> N	<input type="checkbox"/> N
INDIVIDUAL (404)*	<input type="checkbox"/> N	<input type="checkbox"/> N
STORMWATER PERMIT <input checked="" type="checkbox"/> S		
Y	REQUIRED, CNOI SUBMITTED BY MDT (DISTURBED AREA = 5 ACRES)	
S	REQUIRED, SCNOI TO BE SUBMITTED BY CONTRACTOR (1 TO 4.99 ACRES)	
N	NO STORMWATER PERMIT REQUIRED (<1 ACRE)	
APPROVED BY: _____		

BOX BRIDGES REQ'D.
NONE

CONVENTIONAL SYMBOLS

COUNTY LINE	-----
TOWN CORPORATION LINE	-----
SECTION LINE	-----
EXISTING ROAD OR TRAVELED WAY	-----
PROPOSED ROAD OR TRAVELED WAY	-----
RAILROAD	-----
SURVEY LINE	-----
BRIDGES	-----

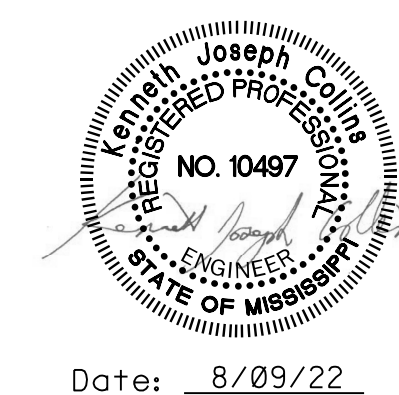

P S & E DATE: 7/19/22

APPROVED: _____

DEPUTY EXECUTIVE DIRECTOR / CHIEF ENGINEER

EXECUTIVE DIRECTOR

8/15/2022 1:21:31 PM TITLE SHEET SR27-US49 SLIDE REPAIR, DGN

STATE	PROJECT NO.
MISS.	ER-0008-03(060)

B:\31\2022\11:51 AM - DI-1.dgn

DESCRIPTION OF SHEET	WK. SH.	SH. NO.
TITLE SHEET (1)		1
DETAILED INDEX - ROADWAY	DI-1	2
GENERAL NOTES	GN-1	3
GENERAL NOTES	GN-2	4
TYPICAL SECTION SHEETS (1)		
US 49 & SR 27 SLOPE REPAIR	TS-1	5
SUMMARY OF QUANTITY SHEETS (2)		
SUMMARY OF QUANTITIES - US 49	SQ-1	6
SUMMARY OF QUANTITIES - SR 27	SQ-2	7
ESTIMATED QUANTITY SHEETS (5)		
ESTIMATED QUANTITY - SUMMARY OF DRAINAGE & JUNCTION BOX	EQ-1	8
ESTIMATED QUANTITY - ESTIMATED EARTHWORK	EQ-2	9
ESTIMATED QUANTITY - CONSTRUCTION SIGNING - US 49	EQ-3	10
ESTIMATED QUANTITY - CONSTRUCTION SIGNING - SR 27	EQ-4	11
ESTIMATED QUANTITY - TRAFFIC CONTROL	EQ-5	12
PLAN & PROFILE SHEETS (2)		
US 49 SLIDE REPAIR - B.O.P. STA. 280+40 TO E.O.P. STA. 282+00	3	13
SR 27 SLIDE REPAIR - B.O.P. STA. 571+50 TO E.O.P. STA. 576+00	4	14
SPECIAL DESIGN SHEETS (10)		
CONSTRUCTION SIGNING SHEETS (2)		
CONSTRUCTION SIGNING - US 49 SB	CS-1	15
CONSTRUCTION SIGNING - SR 27 NB	CS-2	16
TRAFFIC CONTROL SHEETS (2)		
TRAFFIC CONTROL - US 49 SLOPE REPAIR	TC1-1	17
TRAFFIC CONTROL - US 49 SLOPE REPAIR	TC1-2	18
PRELIMINARY EROSION CONTROL PLANS (2)		
US 49 SLIDE REPAIR - B.O.P. STA. 280+40 TO E.O.P. STA. 282+00	ECP3	19
SR 27 SLIDE REPAIR - B.O.P. STA. 571+50 TO E.O.P. STA. 576+00	ECP4	20
MISCELLANEOUS - SPECIAL DESIGN SHEETS (4)		
RIGHT-OF-WAY COORDINATE SHEET	RW-1	21
SITE MAP - US 49	SM-49	22
SITE MAP - SR 27	SM-27	23
VEGETATION SCHEDULE	VS-1	24

DESCRIPTION OF SHEET	WK. SH.	SH. NO.
STANDARD DRAWINGS (30)		
TYPICAL TEMPORARY EROSION / SEDIMENT CONTROL APPLICATIONS	ECD-1	6101
DETAILS OF SEDIMENT BARRIER APPLICATIONS	ECD-2	6102
DETAILS OF SILT FENCE INSTALLATION	ECD-3	6103
DITCH CHECK STRUCTURES, TYPICAL APPLICATIONS AND DETAILS	ECD-4	6104
TEMPORARY EROSION, SEDIMENT AND WATER POLLUTION CONTROL MEASURES (SILT FENCE AND HAY BALE DITCH CHECKS)	ECD-5	6105
DETAILS OF EROSION CONTROL WATTLE DITCH CHECK	ECD-6	6106
DETAILS OF EROSION CONTROL SILT DIKE DITCH CHECK	ECD-7	6107
ROCK DITCH CHECK	ECD-8	6108
ROCK FILTER DAM	ECD-9	6109
ROCK DITCH CHECK WITH SUMP EXCAVATION AND ROCK FILTER DAM	ECD-10	6110
STABILIZED CONSTRUCTION ENTRANCE	ECD-16	6116
DETAILS OF EROSION CONTROL SANDBAG DITCH CHECK	ECD-21	6121
SEDIMENT RETENTION BARRIER	ECD-22	6122
DETAILS OF TYPICAL DITCH TREATMENTS	DT-1	6123
DITCH TREATMENT INSTALLATION DETAILS FOR SOIL REINFORCING MAT	DT-1A	6124
TYPICAL TEMPORARY EROSION CONTROL MEASURES (SLOPE DRAIN AND TYPE A SILT BASIN)	BAS-A	6125
SUPER SILT FENCE	SSF-1	6130
EROSION CONTROL BLANKET	ECB-1	6131
TRAFFIC CONTROL PLAN WITH FLAGGER (ONE-LANE CLOSURE OF TWO-WAY TRAFFIC)	TCP-1	6351
SHORT DURATION CLOSURE OF TWO LANE TWO WAY HIGHWAYS	TCP-6	6356
HIGHWAY SIGN AND BARRICADE DETAILS FOR CONSTRUCTION PROJECTS	TCP-8	6358
TRAFFIC CONTROL DETAILS DRUM PLACEMENT AND SHOULDER CLOSURE	TCP-16	6366
RIGHT-OF-WAY MARKERS	RW-1	6401
RURAL DRIVEWAYS	RD-1	6403
TYPICAL GRADING TRANSITION BETWEEN CUTS AND FILLS	GT-1	6404
MISCELLANEOUS DETAIL SHEET 1. STACKED PIPE JOINTS, 2. EXCAVATION AT GRADE POINTS	MDS-1	6425
PIPE CULVERT INSTALLATION	PI-1	6501
CONCRETE PIPE COLLAR	PC-1	6503
JUNCTION BOX FOR PIPE CULVERTS	JB-1	6504
FLARED END SECTION FOR CONCRETE PIPE	FE-1	6530
JUNCTION BOX FOR PIPE CULVERTS		
CROSS SECTION SHEETS (8)		
US 49 MAINLINE		9001-9005
SR 27 MAINLINE		9006-9008

TOTAL SHEETS = 62

PS & E PLANS-DATE: 7/19/22		
FMS CON.: 108474 / 301000		
FMS CON.: 108476 / 301000		
REVISIONS		
DATE	SHEET NO.	BY
8/9/22	1	KJC

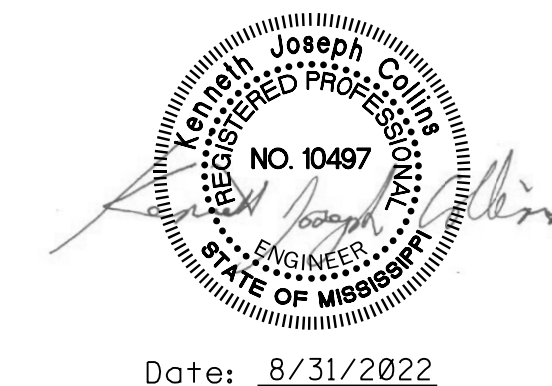

MISSISSIPPI DEPARTMENT OF TRANSPORTATION	
DETAILED INDEX	
US 49 AND SR 27	
SLOPE REPAIR	
PROJ. NO.: ER-0054-02(031) & ER-0008-03(060)	
COUNTY: HINDS	
WORKING NUMBER	DI-1
SHEET NUMBER	2
DATE	FILENAME: DI-1.dgn
DESIGN TEAM	Michael Baker Intl. CHECKED: KJC DATE: 2022

STATE	PROJECT NO.
MISS.	ER-0008-03(060)

GENERAL NOTES

- | | |
|--|--|
| <p>(1) THE LOCATION AND SPACING OF SIGNS, SHOWN ON THE TRAFFIC CONTROL PLANS, ARE APPROXIMATE AND MAY BE ADJUSTED AS NECESSARY TO FIT FIELD CONDITIONS.</p> <p>(2) ALL TRAFFIC CONTROL DEVICES ON THIS PROJECT SHALL COMPLY WITH PART VI OF THE MUTCD (LATEST EDITION).</p> <p>(3) ALL PLASTIC DRUMS SHALL HAVE A BALLASTING COLLAR MADE FROM RECYCLED TRUCK TIRES OR OTHER SUITABLE MATERIAL.</p> <p>(4) 25% SHRINKAGE FACTOR USED IN THE EARTHWORK CALCULATIONS IS FOR DESIGN ESTIMATING PURPOSES ONLY.</p> <p>(5) THE CONTRACTOR SHALL BE RESPONSIBLE FOR PROTECTING EXISTING STRUCTURES SUCH AS, BUT NOT LIMITED TO, PIPES, INLETS, APRONS, AND BRIDGES FROM DAMAGE WHICH MIGHT OCCUR DURING CONSTRUCTION. THE CONTRACTOR SHALL REPLACE OR REPAIR, AS DIRECTED BY THE ENGINEER, ANY STRUCTURES DAMAGED DURING THE LIFE OF THE CONTRACT. NO PAYMENT WILL BE MADE FOR REPLACEMENT OR REPAIR OF DAMAGED ITEMS.</p> <p>(6) ALL PIPE JOINTS ARE TO BE WRAPPED IN 24-INCH WIDE TYPE V GEOTEXTILE FABRIC. ALL PICKUP HOLES SHALL BE PLUGGED WITH PLASTIC INSERTS AND BITUMINOUS SEALER, TO THE SATISFACTION OF THE ENGINEER, THE COST OF WHICH SHALL BE ABSORBED IN OTHER BID ITEMS.</p> <p>(7) VOIDS CREATED BY THE REMOVAL OF, BUT NOT LIMITED TO, POSTS, CONCRETE ANCHORS, AND FOOTINGS SHALL BE BACKFILLED AND TAMPED IN ACCORDANCE WITH SECTION 203 OF THE MISSISSIPPI STANDARD SPECIFICATIONS FOR ROAD AND BRIDGE CONSTRUCTION, THE COST OF WHICH SHALL BE ABSORBED IN OTHER BID ITEMS.</p> <p>(8) UTILITIES ON THE DRAWINGS ARE SHOWN IN THEIR ORIGINAL LOCATION BASED UPON THE BEST INFORMATION AVAILABLE TO THE ENGINEER. UTILITIES THAT WERE FOUND TO BE IN CONFLICT WITH CONSTRUCTION HAVE BEEN RELOCATED. PERMITS ARE ON FILE WITH THE DEPARTMENT SHOWING THE APPROXIMATE LOCATION OF UTILITIES RELOCATED WITHIN THE RIGHT-OF-WAY. THE ENGINEER CAN NOT AND DOES NOT WARRANT THAT THIS INFORMATION IS COMPLETE OR ACCURATE. THE CONTRACTOR MUST COORDINATE DIRECTLY WITH THE INVOLVED UTILITY OWNERS TO HAVE UNDERGROUND UTILITY LINES FIELD LOCATED IN ADVANCE OF CONSTRUCTION.</p> <p>(9) WORK ON STRUCTURES FOR THIS PROJECT REQUIRES EXCAVATION IN THE IMMEDIATE VICINITY OF TRAFFIC AND ADJACENT PROPERTIES. THEREFORE, THE RISK OF A FAILURE OCCURRING DURING EXCAVATION REQUIRES THAT EXTREME CAUTION BE EXERCISED. THE CONTRACTOR SHALL BE RESPONSIBLE FOR PLACING WHAT BRACING, SHORING, OR GROUND SUPPORT SYSTEM THAT IS DEEMED NECESSARY TO PREVENT A FAILURE AND PROTECT THE PERSONS WORKING NEAR THE EXCAVATION, THE PUBLIC THAT MAY BE ABOVE THE EXCAVATION OR ANY STRUCTURES ADJACENT TO THE EXCAVATION. ALL COSTS FOR DESIGNING, DRAWING, AND CONSTRUCTING THE FACILITY SHALL BE INCLUDED IN THE PRICE BID FOR CONTRACT ITEMS.</p> | <p>(11) WIRE FENCE BACKING WILL BE REQUIRED FOR ALL SILT FENCE. (SEE WK. NO. ECD-3)</p> <p>(12) SOME WORK IS REQUIRED OUTSIDE THE PROJECT LIMITS. NO ADDITIONAL COMPENSATION WILL BE MADE FOR SUCH WORK EXCEPT AS PROVIDED BY SPECIFIC PAY ITEMS INCLUDED IN THE PLANS.</p> <p>(13) FOR LIST OF PUBLIC UTILITIES, SEE WORKING SHEET NO. 3.</p> <p>(14) FLUORESCENT ORANGE SHEETING SHALL BE USED ON ALL CONSTRUCTION AND TRAFFIC CONTROL SIGNS EXCEPT FOR THOSE DESIGNATED ON THE PLANS TO BE BLACK LEGEND AND BORDER ON WHITE BACKGROUND.</p> <p>(15) VEGETATIVE MATERIAL WILL BE REMOVED PRIOR TO PLACEMENT OF GRANULAR MATERIAL. THE COST OF WHICH SHALL BE ABSORBED IN OTHER ITEMS BID.</p> <p>(16) THE CONTRACTOR SHALL COVER OR REMOVE ANY TEMPORARY TRAFFIC CONTROL SIGNS SHOWN IN THE TRAFFIC CONTROL PLAN THAT DO NOT APPLY TO THE CURRENT PHASE.</p> <p>(17) ALL EXISTING SIGNS WHICH ARE TO BE REMOVED AS A PART OF THIS PROJECT THAT ARE NOT IN CONFLICT WITH CONSTRUCTION SHALL REMAIN IN PLACE UNTIL NEW SIGNS ARE INSTALLED UNLESS NOTED OR DIRECTED OTHERWISE BY THE PROJECT ENGINEER. ROADWAY SIGNS THAT ARE IN CONFLICT WITH CONSTRUCTION SHALL BE REMOVED AND RELOCATED BY THE CONTRACTOR AS DIRECTED BY THE ENGINEER, THE COST OF WHICH SHALL BE ABSORBED IN OTHER ITEMS BID.</p> <p>(18) THE CONTRACTOR SHALL REPAIR ANY DAMAGE TO THE SURFACE TREATED SHOULDER THAT MIGHT OCCUR DURING CONSTRUCTION. ANY REPAIR TO SHOULDER WILL BE IN ACCORDANCE WITH SECTION 410 OF THE MISSISSIPPI STANDARD SPECIFICATIONS FOR ROAD AND BRIDGE CONSTRUCTION. NO PAYMENT WILL BE MADE FOR REPAIR OF DAMAGED SHOULDER.</p> <p>(19) THE EROSION CONTROL DEVICES REFERENCED IN THESE PLANS ARE A MINIMUM REQUIREMENT. IT IS THE RESPONSIBILITY OF THE CONTRACTOR TO ENSURE THAT SILT DOES NOT LEAVE THE RIGHT OF WAY OR CONTAMINATE WATERS OF THE U. S. DURING CONSTRUCTION. THE CONTRACTOR SHALL SUBMIT AN EROSION CONTROL PLAN PRIOR TO COMMENCEMENT OF WORK AND MAINTAIN THE PLAN DURING CONSTRUCTION. ANY ADDITIONAL SILT BASINS NOT SHOWN IN THE PLANS SHALL BE INCLUDED IN THE CONTRACTOR'S EROSION CONTROL PLAN PRIOR TO SUBMITTING FOR APPROVAL.</p> |
|--|--|

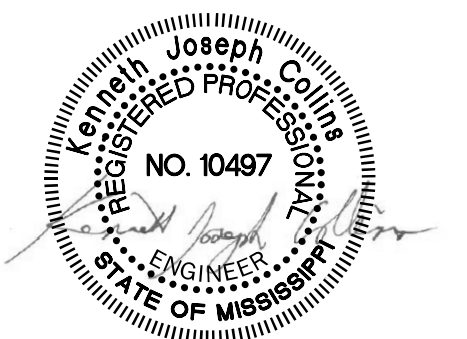

Date: 7/19/2022

MISSISSIPPI DEPARTMENT OF TRANSPORTATION	
GENERAL NOTES	
SR 27 AND US 49	
SLOPE REPAIR	
PROJ. NO.: ER-0054-02(031) & ER-0008-03(060)	
COUNTY: HINDS	
WORKING NUMBER	GN-1
FILENAME: GN-1.dgn	SHEET NUMBER
DESIGN TEAM: Michael Baker Intl. CHECKED: KJC DATE: 2022	3



7/19/2022 7:51 AM GN-1.dgn

STATE	PROJECT NO.
MISS.	ER-0008-03(060)

GENERAL NOTES (CONT'D)

- (20) PRIOR TO EARTHWORK OPERATIONS, THE EXISTING 4" OF TOPSOIL IS TO BE STRIPPED AND STOCK-PILED. AFTER THE GRADING OPERATIONS ARE COMPLETED, SAID TOPSOIL SHALL BE PLACED ON ALL AREAS THAT ARE NOT TO BE PAVED OR OTHERWISE PROTECTED, IN ACCORDANCE WITH SECTION 211 OF THE SPECIFICATIONS, OR THE VEGETATION SCHEDULE (SEE WK. SH. VS-1). EXISTING TOPSOIL AND ALL COSTS ASSOCIATED WITH STRIPPING, HAULING, STOCKPILING, AND PLACEMENT OF THE EXISTING TOPSOIL IS TO BE ABSORBED IN OTHER EARTHWORK ITEMS.
- (21) THE CONTRACTOR IS RESPONSIBLE FOR FIELD-VERIFICATION OF EXISTING GRADES AND MAKING ADJUSTMENTS AS NECESSARY WITH THE APPROVAL OF THE PROJECT ENGINEER.
- (22) ALL ITEMS OF WORK ASSOCIATED WITH THE INSTALLATION OF A CONSTRUCTION ENTRANCE SHALL BE ABSORBED IN OTHER ITEMS OF WORK.
- (23) IF COLORS ARE USED ON PLAN/PROFILE SHEETS, THEY ARE INTENDED TO VISUALLY EASE THE LOCATION OF ELEMENTS FOR USERS OF THESE DRAWINGS. ALTHOUGH THE INTENT IS TO CATEGORIZE EVERYTHING AS EITHER EXISTING OR PROPOSED, IT IS THE END USER'S RESPONSIBILITY TO ENSURE ALL ELEMENTS ARE INTERPRETED CORRECTLY REGARDLESS OF COLOR.
- (24) IF POLYACRYLAMIDE (PAM) POLYMER IS USED FOR EROSION CONTROL OF SOIL ON CONSTRUCTION SITES, WRITTEN NOTIFICATION OF THE USED PAM SHALL BE INCLUDED IN THE STORM WATER POLLUTION PREVENTION PLAN/EROSION CONTROL PLAN SUBMITTED TO MISSISSIPPI DEPARTMENT OF ENVIRONMENTAL QUALITY. THIS NOTIFICATION SHALL INCLUDE A WRITTEN PLAN FOR THE SPECIFIC APPLICATION AREA(S) WHICH WILL DESCRIBE: HOW UNIFORM COVERAGE WILL BE ENSURED AND HOW APPLICATION ONTO NON-TARGET AREAS INCLUDING WATERS OF THE STATES WILL BE PREVENTED. PAM SHALL MEET THE REQUIREMENTS OF SPECIAL PROVISIONS NO. 907-250-A001. THERE SHALL BE NO DISCHARGE OF PAM INTO STATE WATERS.
- (25) ALL ADDENDA TO THESE PLANS WILL BE POSTED TO WWW.MDOT.MS.GOV UNDER THE PROPOSAL ADDENDA COLUMN. BIDDERS ARE ADVISED THAT HARD COPIES OF ANY ADDENDA FOR THIS PROJECT WILL NOT BE MAILED. IT IS THE BIDDER'S RESPONSIBILITY TO CHECK AND SEE IF ANY ADDENDA HAVE BEEN POSTED FOR THIS PROJECT.
- (26) THE COST FOR REMOVAL OF ALL HEADWALLS AND WINGWALLS (PIPES, BOX CULVERTS, BOX BRIDGES) SHALL BE ABSORBED IN OTHER ITEMS BID.
- (27) THE CONTRACTOR SHALL COORDINATE AND CONDUCT WORK AT LOCAL ROADS AND DRIVEWAYS IN A MANNER SUCH THAT ACCESS IS NOT INTERRUPTED UNNECESSARILY. ACCESS SHALL BE PRESERVED IN THE BEST MANNER POSSIBLE. COORDINATION AND COMMUNICATION WITH LANDOWNERS MAY BE NECESSARY TO PREVENT INTERRUPTION OF DRIVEWAY ACCESS.
- (28) THE CONTRACTOR SHALL BE RESPONSIBLE FOR MAINTAINING AND RELOCATING MAIL BOXES AS NECESSARY TO MAINTAIN CONTINUOUS MAIL SERVICE THROUGHOUT THE LIFE OF THE PROJECT, THE COST OF WHICH SHALL BE ABSORBED IN OTHER ITEMS BID.

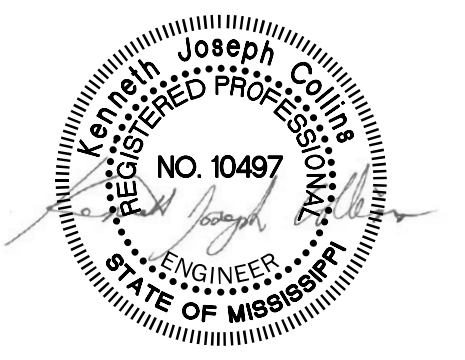

Date: 7/19/2022

7/19/2022 7:51 AM GN-2.DGN

MISSISSIPPI DEPARTMENT OF TRANSPORTATION	
GENERAL NOTES	
US 49 AND SR 27	
SLOPE REPAIR	
PROJ. NO.: ER-0054-02(031) & ER-0008-03(060)	
COUNTY: HINDS	WORKING NUMBER
	GN-2
FILENAME: GN-2.dgn	SHEET NUMBER
DESIGN TEAM Michael Baker Intl. CHECKED KJC DATE 2022	4

