

STATE	PROJECT NUMBER	SHEET NO.
MISSISSIPPI	BR-0044-01(030)	1

GENERAL INDEX

INCLUDED THIS PROJECT	BEGIN WITH SHEET
<input checked="" type="checkbox"/> ROADWAY	1
<input type="checkbox"/> PERMANENT SIGNS	1001
<input type="checkbox"/> TRAFFIC SIGNALS	2001
<input type="checkbox"/> ITS COMPONENTS	3001
<input type="checkbox"/> LIGHTING	4001
<input type="checkbox"/> (RESERVED)	5001
<input checked="" type="checkbox"/> ROADWAY STANDARD DWGS	6001
<input type="checkbox"/> BOX CULVERT STD. DRAWINGS (LRFD)	7001
<input type="checkbox"/> BOX CULVERT STD. DRAWINGS (STD. SPEC.)	7501
<input type="checkbox"/> BRIDGE	8001
<input checked="" type="checkbox"/> CROSS SECTIONS	9001

BRIDGE STRUCTURES REQ'D.
NONE

BOX BRIDGES REQ'D.
NONE

CONVENTIONAL SYMBOLS

COUNTY LINE	-----
TOWN CORPORATION LINE	-----
SECTION LINE	--- § --- § --- § ---
EXISTING ROAD OR TRAVELED WAY	-----
PROPOSED ROAD OR TRAVELED WAY	-----
RAILROAD	====+====
SURVEY LINE	-----
BRIDGES	-----

STATE OF MISSISSIPPI
MISSISSIPPI DEPARTMENT OF TRANSPORTATION
PLAN AND PROFILE OF PROPOSED STATE HIGHWAY
FEDERAL AID PROJECT NO. BR-0044-01(030)

SR 30 to Intersect with
CR 29 (BR# 17.7)
UNION COUNTY

FMS ROW NO. 107742 / 201000
FMS CON. NO 107742 / 301000

SCALES

PLAN	1 IN. = 100 FT.
PROFILE {	HOR. 1 IN. = 100 FT.
	VERT. 1 IN. = 10 FT.
LAYOUT	1 IN. = 2800 FT.

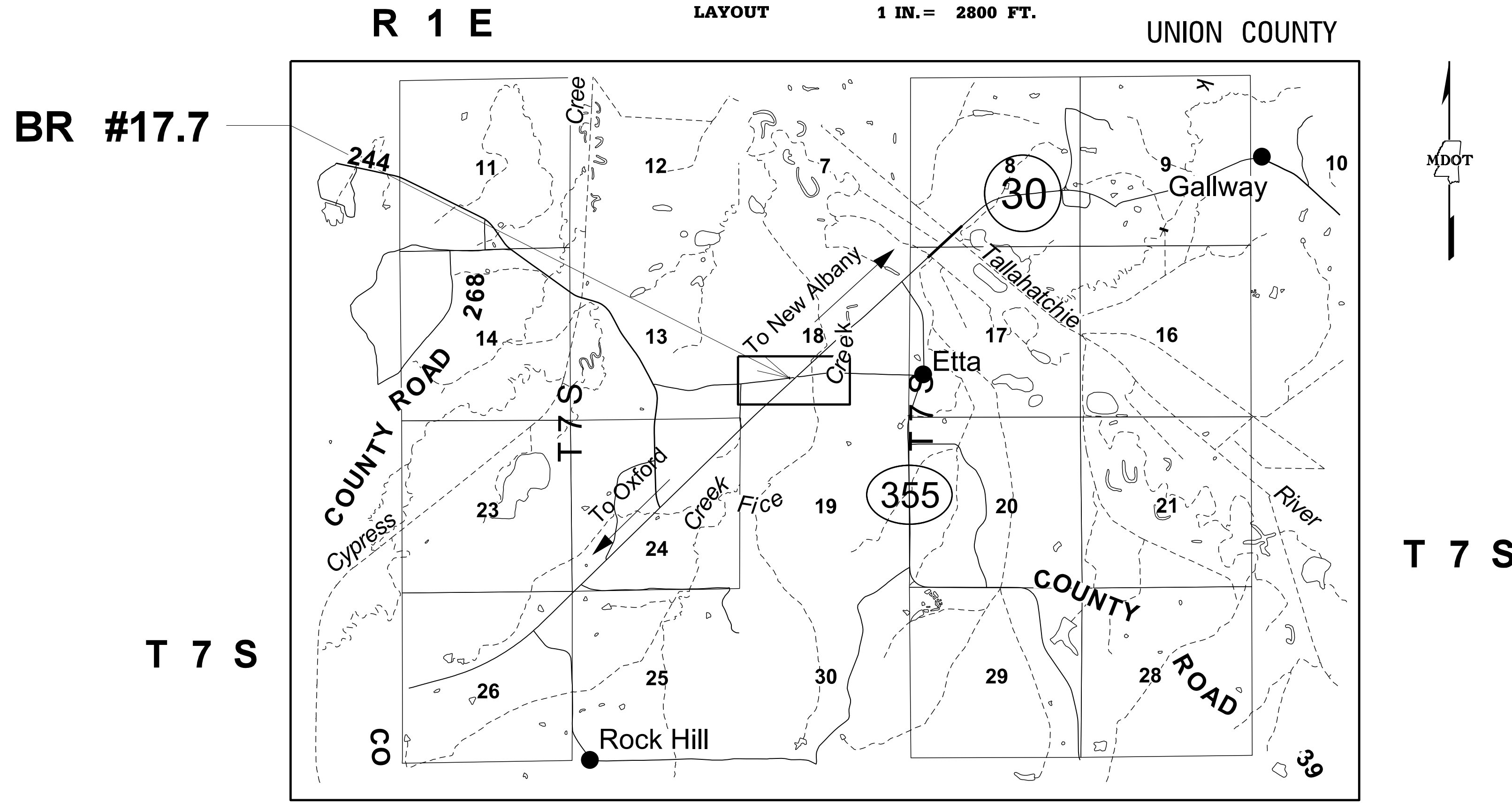

EQUATIONS
NONE

EXCEPTIONS
NONE

LENGTH DATA

LENGTH OF ROADWAY	950.02	FT.	0.18	MI.
LENGTH OF BRIDGES		FT.		MI.
LENGTH OF PROJECT (NET)		FT.		MI.
LENGTH OF EXCEPTIONS		FT.		MI.
LENGTH OF PROJECT (GROSS)		FT.	0.18	MI.

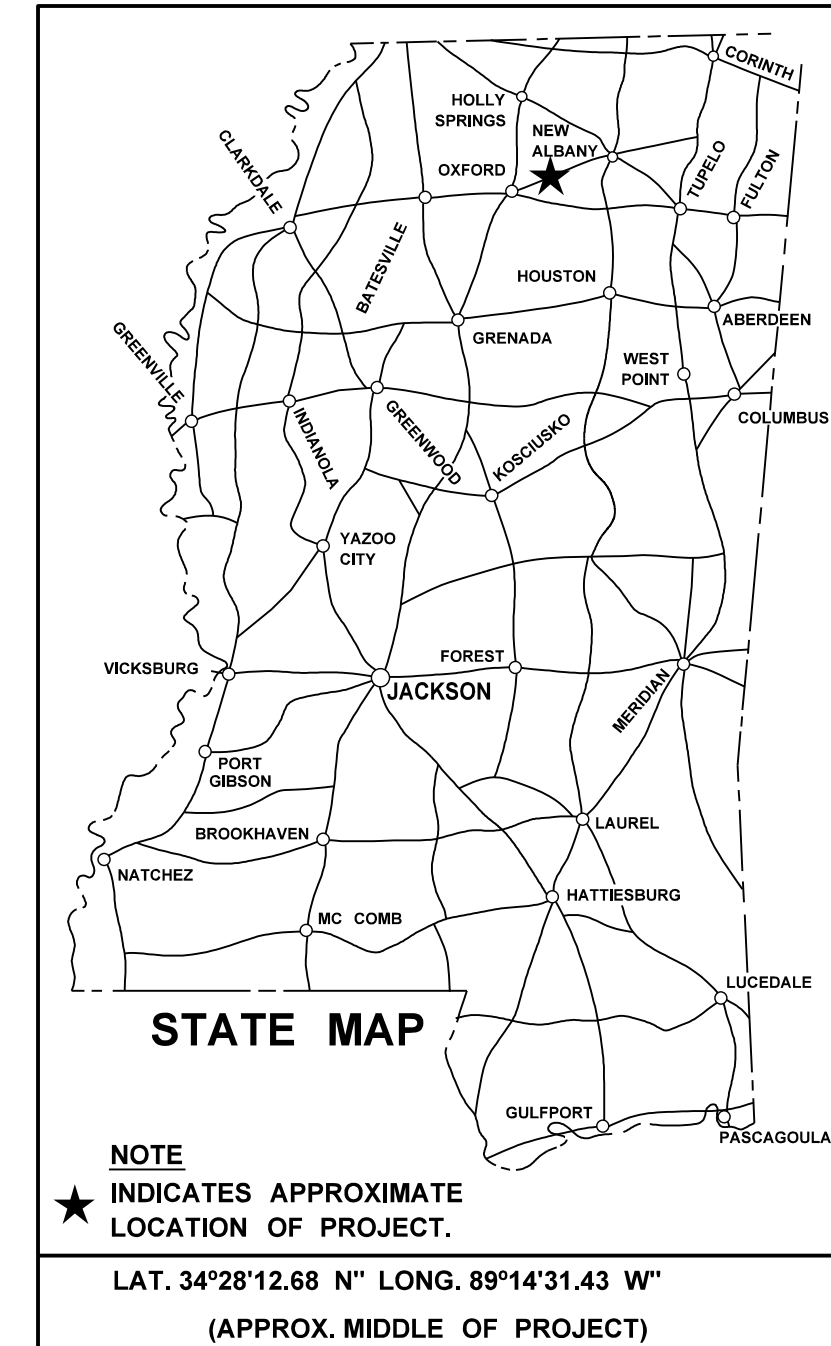

DESIGN CONTROL

55 MPH = V (SPEED DESIGN)

ADT (2025) = 3000 ; ADT (2049) = 3700

DHV = 340 ; D = 50 % T = 0 %

PERMITS ACQUIRED BY MDOT

WETLANDS AND WATERS PERMITS		
	WATERS	WETLANDS
NATIONWIDE #14	<input type="checkbox"/> N	<input type="checkbox"/> N
NATIONWIDE (OTHER)*	<input type="checkbox"/> Y	<input type="checkbox"/> N
GENERAL*	<input type="checkbox"/> N	<input type="checkbox"/> N
INDIVIDUAL (404)*	<input type="checkbox"/> N	<input type="checkbox"/> N

STORMWATER PERMIT S

Y REQUIRED, CNDI SUBMITTED BY MDOT (DISTURBED AREA = 5 ACRES)

S REQUIRED, SCNDI TO BE SUBMITTED BY CONTRACTOR (1 TO 4.99 ACRES)

N NO STORMWATER PERMIT REQUIRED (<1 ACRE)

APPROVED BY: _____

P S & E DATE: 11-17-2022

APPROVED: _____

DEPUTY EXECUTIVE DIRECTOR / CHIEF ENGINEER

EXECUTIVE DIRECTOR

DATE _____

REVISIONS _____



11/17/2022 10:18 AM RMD-TITLE.DGN TITLE DIVISION MISSISSIPPI DEPARTMENT OF TRANSPORTATION

STATE	PROJECT NO.
MISS.	BR-0044-01(030)

DESCRIPTION OF SHEET	WKG. NO.	SH. NO.	DESCRIPTION OF SHEET	WKG. NO.	SH. NO.
TITLE SHEET (1)					
DETAILED INDEX & GENERAL NOTES (2)			LOCATION OF R16-3 SIGNS (SPEEDING SIGNS DOUBLED)	TCP-15	6365
DETAILED INDEX	DI-1	2	TRAFFIC CONTROL DETAILS DRUM PLACEMENT AND SHOULDER CLOSURE	TCP-16	6366
GENERAL NOTES	GN-1	3	RIGHT-OF-WAY MARKER	RW-1	6401
			SUPERELEVATION - CASE 1 (ROTATION ABOUT CENTERLINE)	SE-2A	6408
			DRIVEWAYS, CURB & GUTTER, & SIDEWALK	SD-1	6419
			MISCELLANEOUS DETAIL SHEET 1. STACKED PIPE JOINTS		
			2. EXCAVATION AT GRADE POINTS	MDS-1	6425
TYPICAL SECTION SHEETS (1)					
TYPICAL SHEET - WIDENING & OVERLAY, NEW CONSTRUCTION & CURB & GUTTER	TS-1	4	PIPE CULVERT INSTALLATION	PI-1	6501
			CONCRETE PIPE COLLAR	PC-1	6503
			FLARED END SECTION FOR CONCRETE PIPE	FE-1	6530
			FLARED END SECTION FOR CONCRETE ARCH PIPE	FE-1A	6531
QUANTITY SHEETS (5)					
SUMMARY OF QUANTITY	SQ-1	5			
SUMMARY OF QUANTITY	SQ-2	6			
ESTIMATED QUANTITIES - DRAINAGE STRUCTURES	EQ-1	7	CROSS-SECTION (5)		
ESTIMATED QUANTITIES - EARTHWORK, CURB AND GUTTER	EQ-2	8			
ESTIMATED QUANTITIES - TRAFFIC ESTIMATED QUANTITIES	EQ-3	9	STA. 10 + 25.00 - STA. 19 + 75.02	9001-9005	
PLAN-PROFILE SHEET (1)					
WK3	WK-3	10			
SPECIAL DESIGN SHEETS (4)			TOTAL SHEETS (41)		
DETAIL OF CONSTRUCTION SIGNING	DCS-1	11			
DETAIL OF INTERSECTION	ID-1	12			
VEGETATION SCHEDULE	VS-1	13			
RIGHT-OF-WAY COORDINATES	RCS-1	14			
STANDARD DESIGN SHEETS (22)					
PAVEMENT MARKING DETAILS FOR 2-LANE & 4-LANE DIVIDED ROADWAYS	PM-1	6051			
RUMBLE STRIPES 2-LANE HIGHWAYS (ASPHALT LANES, 2-FT. SHOULDERS)	RS-1	6064			
TYPICAL TEMPORARY EROSION CONTROL /SEDIMENT CONTROL APPLICATIONS	ECD-1	6101			
DETAILS OF SEDIMENT BARRIER APPLICATIONS	ECD-2	6102			
DETAILS OF SILT FENCE INSTALLATION	ECD-3	6103			
TEMPORARY EROSION SEDIMENT, AND WATER POLLUTION CONTROL MEASURES (SILT FENCE, AND HAY BALES DITCH CHECKS)	ECD-5	6105			
DETAILS OF EROSION CONTROL WATTLE DITCH CHECK	ECD-6	6106			
STABILIZED CONSTRUCTION ENTRANCE	ECD-16	6116			
TRAFFIC CONTROL PLAN WITH FLAGGER (ONE-LANE CLOSURE OF TWO-WAY TRAFFIC)	TCP-1	6351			
HIGHWAY SIGN AND BARRICADE DETAILS FOR CONSTRUCTION PROJECTS	TCP-8	6358			
TRAFFIC CONTROL PLAN: UNEVEN PAVEMENT DETAILS	TCP-12	6362			
TEMPORARY STRIPING FOR TRAFFIC CONTROL 2-LANE AND 4-LANE DIVIDED HIGHWAYS	TCP-13	6363			

PS & E PLANS-DATE 11/17/2022		
FMS CON. # 107742/301000		
REVISIONS		
DATE	SHEET NO.	BY

REVISION	MISSISSIPPI DEPARTMENT OF TRANSPORTATION	
	DETAILED INDEX	
DATE	PROJECT NO.: BR-0044-01(030)	
	COUNTY : UNION	
DESIGN TEAM	FILE NAME: DI.DGN	WORKING NUMBER
	DESIGN TEAM BROWN CHECKED _____ DATE _____	DI-1
		SHEET NUMBER
		2



11/17/2022 10:18 AM DI

STATE	PROJECT NO.
MISS.	BR-0044-01(030)

GENERAL NOTES

- (1) THE LOCATION AND SPACING OF SIGNS, SHOWN ON THE TRAFFIC CONTROL PLANS, ARE APPROXIMATE AND MAY BE ADJUSTED AS NECESSARY TO FIT FIELD CONDITIONS.
- (2) ALL TRAFFIC CONTROL DEVICES ON THIS PROJECT SHALL COMPLY WITH PART VI OF THE **MUTCD** (LATEST EDITION).
- (3) ALL PLASTIC DRUMS SHALL HAVE A BALLASTING COLLAR MADE FROM RECYCLED TRUCK TIRES OR OTHER SUITABLE MATERIAL.
- (4) UTILITIES ON THE DRAWINGS ARE SHOWN IN THEIR ORIGINAL LOCATION BASED UPON THE BEST INFORMATION AVAILABLE TO THE ENGINEER. UTILITIES THAT WERE FOUND TO BE IN CONFLICT WITH CONSTRUCTION HAVE BEEN RELOCATED. PERMITS ARE ON FILE WITH THE DEPARTMENT SHOWING THE APPROXIMATE LOCATION OF UTILITIES RELOCATED WITHIN THE RIGHT-OF-WAY. THE ENGINEER CAN NOT AND DOES NOT WARRANT THAT THIS INFORMATION IS COMPLETE OR ACCURATE. THE CONTRACTOR MUST COORDINATE DIRECTLY WITH THE INVOLVED UTILITY OWNERS TO HAVE UNDERGROUND UTILITY LINES FIELD LOCATED IN ADVANCE OF CONSTRUCTION.
- (5) FLUORESCENT ORANGE SHEETING SHALL BE USED ON ALL CONSTRUCTION AND TRAFFIC CONTROL SIGNS EXCEPT FOR THOSE DESIGNATED ON THE PLANS TO BE BLACK LEGEND AND BORDER ON WHITE BACKGROUND.
- (6) SOME CUTS WILL BE NECESSARY ON THE PROJECT. THIS MATERIAL WILL BE USED AS E.S.F.E. MATERIAL AND WILL BE PAID FOR AS BORROW. NO E.S.F.E. MATERIAL BE REMOVED FROM THE PROJECT WITHOUT THE APPROVAL OF THE ENGINEER.
- (7) VEGETATIVE MATERIAL WILL BE REMOVED PRIOR TO PLACEMENT OF GRANULAR MATERIAL. THE COST OF WHICH SHALL BE ABSORBED IN OTHER ITEMS BID.
- (8) THE CONTRACTOR SHALL REPAIR ANY DAMAGE TO THE SHOULDER THAT MIGHT OCCUR DURING CONSTRUCTION. ANY REPAIR TO SHOULDER WILL BE IN ACCORDANCE WITH **THE MISSISSIPPI STANDARD SPECIFICATIONS FOR ROAD AND BRIDGE CONSTRUCTION**. NO PAYMENT WILL BE MADE FOR REPAIR OF DAMAGED SHOULDER.
- (9) THE CONTRACTOR SHALL COORDINATE WITH THE CONTRACTOR FROM ADJACENT PROJECT(S) IN IMPLEMENTING THE TRAFFIC CONTROL PLAN AS DIRECTED BY THE ENGINEER. ALL CONFLICTING SIGNS SHALL BE COVERED OR REMOVED AS DIRECTED BY THE ENGINEER.
- (10) THE CONTRACTOR SHALL COVER ANY TEMPORARY TRAFFIC CONTROL SIGNS SHOWN IN THE TRAFFIC CONTROL PLAN THAT DO NOT APPLY TO THE CURRENT PHASE.
- (11) REMOVAL OF RAISED PAVEMENT MARKERS THAT ARE IN CONFLICT WITH REQUIRED CONSTRUCTION IS NOT CONSIDERED A SEPARATE PAY ITEM. COST TO BE ABSORBED IN OTHER ITEMS BID.
- (12) REMOVAL OF OBJECT MARKERS IS NOT CONSIDERED A SEPARATE PAY ITEM, AND SHALL BE ABSORBED IN OTHER ITEMS BID.
- (13) THE EROSION CONTROL DEVICES REFERENCED IN THESE PLANS ARE A MINIMUM REQUIREMENT. IT IS THE RESPONSIBILITY OF THE CONTRACTOR TO ENSURE THAT SILT DOES NOT LEAVE THE RIGHT OF WAY OR CONTAMINATE WATERS OF THE U. S. DURING CONSTRUCTION. THE CONTRACTOR SHALL SUBMIT AN EROSION CONTROL PLAN PRIOR TO COMMENCEMENT OF WORK AND MAINTAIN THE PLAN DURING CONSTRUCTION. ANY ADDITIONAL SILT BASINS NOT SHOWN IN THE PLANS SHALL BE INCLUDED IN THE CONTRACTOR'S EROSION CONTROL PLAN PRIOR TO SUBMITTING FOR APPROVAL.

GENERAL NOTES (CONT.)

- (14) THE CONTRACTOR IS RESPONSIBLE FOR FIELD-VERIFICATION OF EXISTING GRADES AND MAKING ADJUSTMENTS AS NECESSARY WITH THE APPROVAL OF THE PROJECT ENGINEER.
- (15) TEMPORARY STRIPING SHALL CONFORM TO FINISHED STRIPE SPECIFICATIONS FOR ALIGNMENT, NEATNESS, AND STRAIGHTNESS.
- (16) ALL ITEMS OF WORK ASSOCIATED WITH THE INSTALLATION OF A CONSTRUCTION ENTRANCE SHALL BE ABSORBED IN OTHER ITEMS OF WORK.
- (17) IF COLORS ARE USED ON PLAN/PROFILE SHEETS, THEY ARE INTENDED TO VISUALLY EASE THE LOCATION OF ELEMENTS FOR USERS OF THESE DRAWINGS. ALTHOUGH THE INTENT IS TO CATEGORIZE EVERYTHING AS EITHER EXISTING OR PROPOSED, IT IS THE END USER'S RESPONSIBILITY TO ENSURE ALL ELEMENTS ARE INTERPRETED CORRECTLY, REGARDLESS OF COLOR.
- (18) ALL ADDENDA TO THESE PLANS WILL BE POSTED TO WWW.MDOT.MS.GOV UNDER THE PROPOSAL ADDENDA COLUMN. BIDDERS ARE ADVISED THAT HARD COPIES OF ANY ADDENDA FOR THIS PROJECT WILL NOT BE MAILED. IT IS THE BIDDER'S RESPONSIBILITY TO CHECK AND SEE IF ANY ADDENDA HAVE BEEN POSTED FOR THIS PROJECT.
- (19) CURB AND GUTTER VERTICAL DIMENSIONS SHOWN IN THE DETAIL DRAWINGS ARE FOR A CURB IN THE "CATCH" CONFIGURATION AND SHALL BE CONSIDERED TO BE MINIMUM DIMENSIONS. THE DIMENSIONS MAY BE MODIFIED AS NECESSARY FOR "SPILL" CURB AND GUTTER, BUT SHALL NOT BE LESS THAN THE MINIMUM SHOWN.
- (20) THE COST FOR REMOVAL OF ALL HEADWALLS AND WINGWALLS (PIPES, BOX CULVERTS, BOX BRIDGES) SHALL BE ABSORBED IN OTHER ITEMS BID.
- (21) STORAGE OF FLAMMABLE MATERIALS WILL NOT BE ALLOWED UNDER ANY BRIDGE STRUCTURES WITHOUT WRITTEN APPROVAL FROM THE PROJECT ENGINEER. SEE NOTICE TO BIDDERS ENTITLED "MATERIAL STORAGE UNDER BRIDGES" FOR MORE INFORMATION.
- (22) INSTALLATION DATES SHALL BE CLEARLY WRITTEN IN BOLD BLACK MARKINGS ON THE BACK BOTTOM HALF OF ALL SIGNS WITH A PERMANENT MARKING STICK THAT IS WATERPROOF, FADE RESISTANT AND MARKS ON WET OR DRY SURFACES.
- (23) ALL POST, PIPE, AND I-BEAM LENGTHS IN THESE PLANS ARE ESTIMATES. POST LENGTHS FOR ALL SIGNS SHALL BE VERIFIED IN THE FIELD BY THE CONTRACTOR PRIOR TO FABRICATION.
- (24) ALL EXISTING SIGNS WHICH ARE TO BE REMOVED AS A PART OF THIS PROJECT THAT ARE NOT IN CONFLICT WITH CONSTRUCTION SHALL REMAIN IN PLACE UNTIL NEW SIGNS ARE INSTALLED UNLESS NOTED OR DIRECTED OTHERWISE BY THE PROJECT ENGINEER. ROADWAY SIGNS THAT ARE IN CONFLICT WITH CONSTRUCTION SHALL BE REMOVED AND RELOCATED BY THE CONTRACTOR AS DIRECTED BY THE ENGINEER, THE COST OF WHICH SHALL BE ABSORBED IN OTHER ITEMS BID.
- (25) DIRECT-APPLIED LEGEND, BORDER, AND/OR SHIELDS ARE TO BE USED ON ALL SIGNS. DIGITALLY PRODUCED SIGN COPY, SHIELDS, LEGEND, SYMBOLS, OR IMAGES WILL NOT BE ALLOWED WITHOUT WRITTEN APPROVAL FROM MDOT'S PROJECT ENGINEER.
- (26) ALL SIGN LOCATIONS SHALL BE APPROVED BY THE PROJECT ENGINEER PRIOR TO INSTALLATION.
- (26) THE RETROREFLECTIVE SIGN SHEETING ON RIGID, TEMPORARY TRAFFIC CONTROL (ORANGE) SIGNS SHALL BE MINIMUM TYPE IX.
- (27) ALL EXISTING SIGNS AND SUPPORTS REMOVED UNDER THIS PROJECT SHALL BECOME THE PROPERTY OF THE CONTRACTOR AND ARE NOT A SEPARATE PAY ITEM.
- (28) THE CONTRACTOR SHALL COORDINATE AND CONDUCT WORK AT LOCAL ROADS AND DRIVEWAYS IN A MANNER SUCH THAT ACCESS IS NOT INTERRUPTED UNNECESSARILY. ACCESS SHALL BE PRESERVED IN THE BEST MANNER POSSIBLE. COORDINATION AND COMMUNICATION WITH LANDOWNERS MAY BE NECESSARY TO PREVENT INTERRUPTION OF DRIVEWAY ACCESS.

ROADWAY PLAN DIVISION MISSISSIPPI DEPARTMENT OF TRANSPORTATION

11/17/2022 10:18 AM DI

		MISSISSIPPI DEPARTMENT OF TRANSPORTATION	
		GENERAL NOTES	
		PROJ. NO.: BR-0044-01(030)	
		COUNTY: UNION	
		WORKING NUMBER GN-1	
		SHEET NUMBER 3	
REVISION	BY	FILE NAME: DI.dgn	
DATE	DESIGN TEAM	CHECKED _____ DATE _____	
		DESIGN TEAM BROWN	

