

GENERAL INDEX

INCLUDED THIS PROJECT	BEGIN WITH SHEET
<input checked="" type="checkbox"/> ROADWAY.....	1
<input type="checkbox"/> PERMANENT SIGNS.....	1001
<input type="checkbox"/> TRAFFIC SIGNALS.....	2001
<input type="checkbox"/> ITS COMPONENTS.....	3001
<input type="checkbox"/> LIGHTING.....	4001
<input type="checkbox"/> (RESERVED).....	5001
<input checked="" type="checkbox"/> ROADWAY STD. DWGS.....	6001
<input type="checkbox"/> BOX CULVERT STD. DWGS (LRFD).....	7001
<input type="checkbox"/> BOX CULVERT STD. DWGS (STD. SPEC.)....	7501
<input type="checkbox"/> BRIDGE.....	8001
<input type="checkbox"/> CROSS SECTIONS.....	9001

**STATE OF MISSISSIPPI
MISSISSIPPI DEPARTMENT OF TRANSPORTATION**

**PLAN AND PROFILE OF
PROPOSED STATE HIGHWAY
FEDERAL AID PROJECT NO. IM-0059-01(127)**

**I-59 From 0.5 Mi N of LA SL to McNeill
PEARL_RIVER COUNTY**

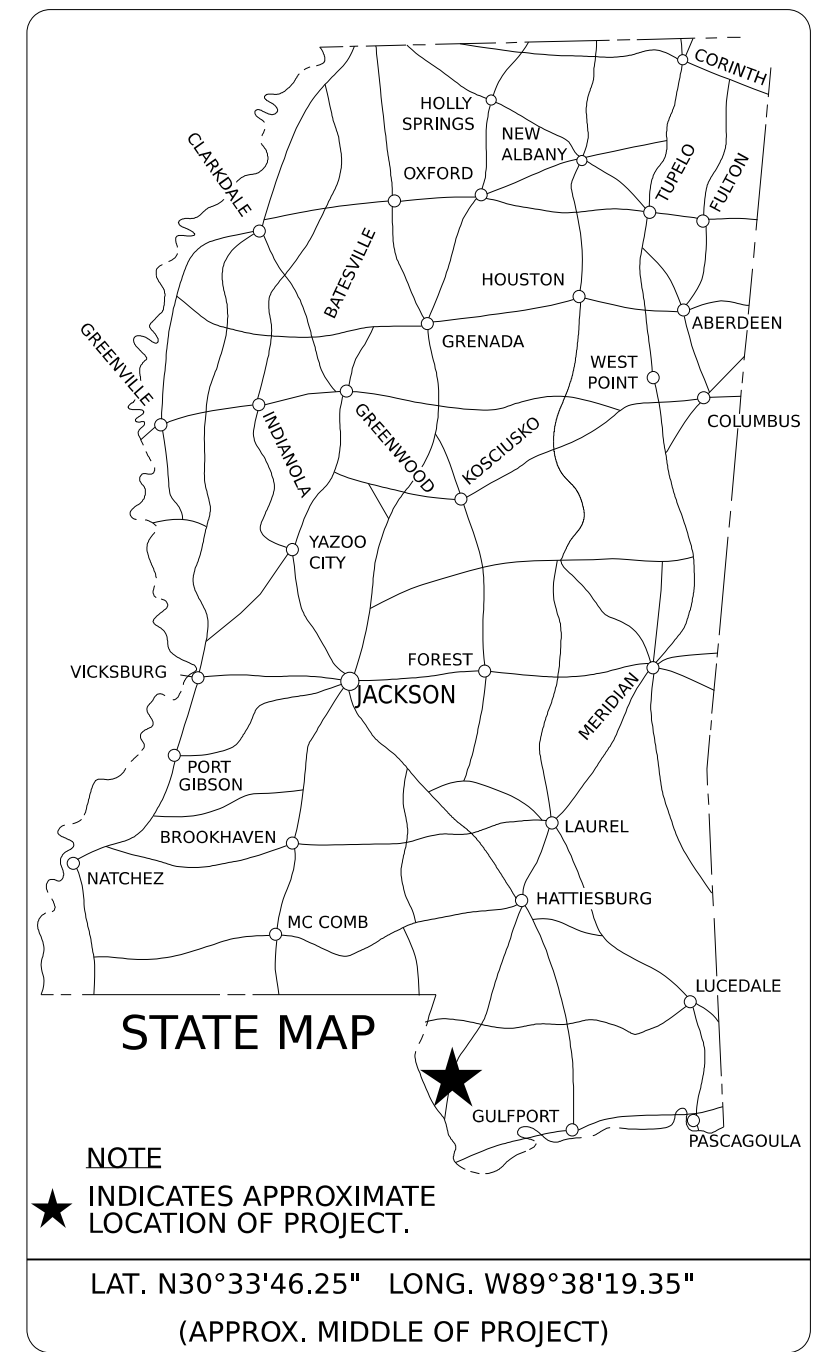

DESIGN CONTROL
70 MPH = V (SPEED DESIGN)

ADT (2021) = 22,000 : ADT (2047) = 32,400
DHV = 2,720 : D = 60 % T = 25 %

PERMITS ACQUIRED BY MDOT

WETLANDS AND WATERS PERMITS

	WATERS	WETLANDS
NATIONWIDE #14	<input checked="" type="checkbox"/> N	<input checked="" type="checkbox"/> N
NATIONWIDE (OTHER)*	<input checked="" type="checkbox"/> N	<input checked="" type="checkbox"/> N
GENERAL*	<input checked="" type="checkbox"/> N	<input checked="" type="checkbox"/> N
INDIVIDUAL (404)*	<input checked="" type="checkbox"/> N	<input checked="" type="checkbox"/> N

STORMWATER PERMIT N

Y REQUIRED, CNOI SUBMITTED BY MDOT (DISTURBED AREA=5 ACRES)

S REQUIRED, SCNOI TO BE SUBMITTED BY CONTRACTOR (1 TO 4.99 ACRES)

N NO STORMWATER PERMIT REQUIRED (<1 ACRE)

APPROVED BY: _____

PLAN SHEET

BRIDGE STRUCTURES REQ'D.
NONE

BOX BRIDGES REQ'D.
NONE

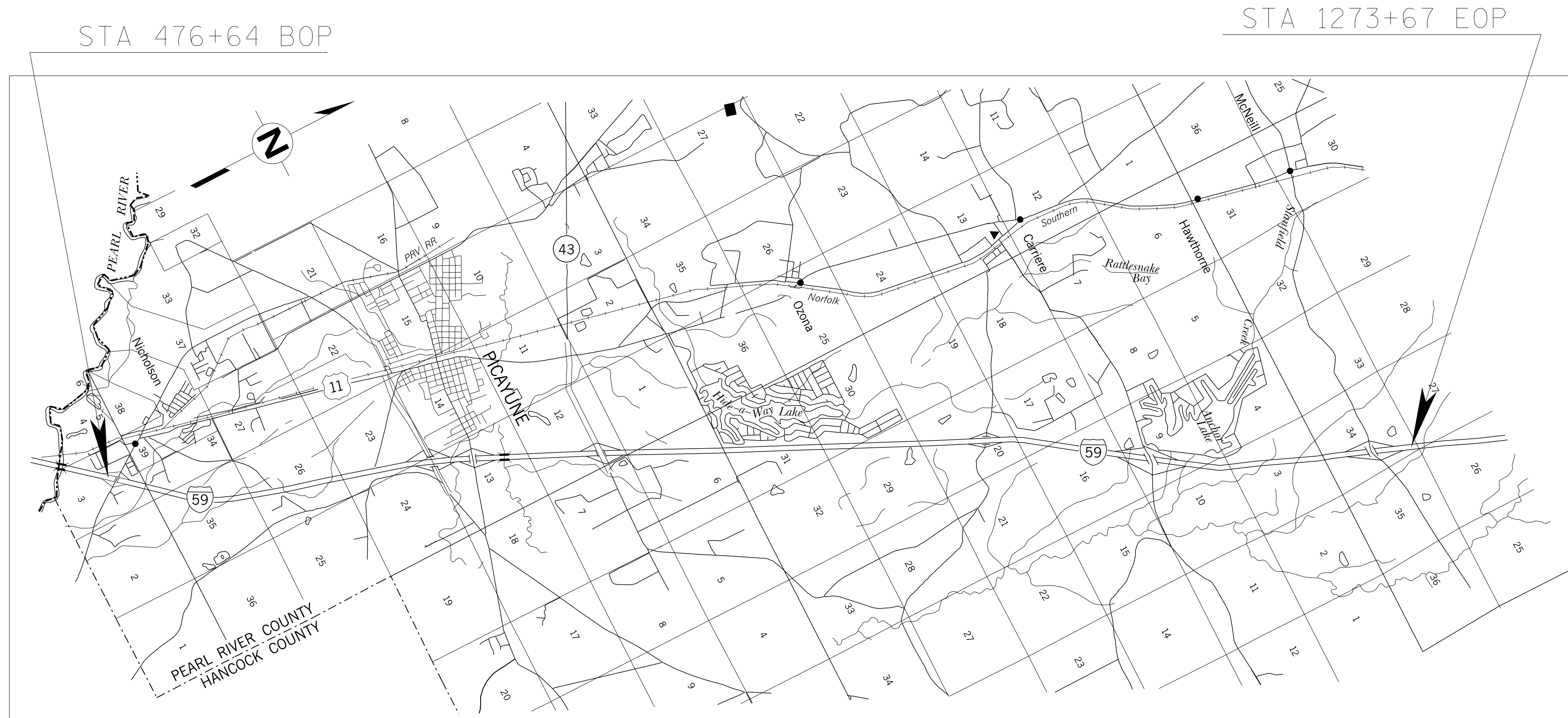

CONVENTIONAL SYMBOLS

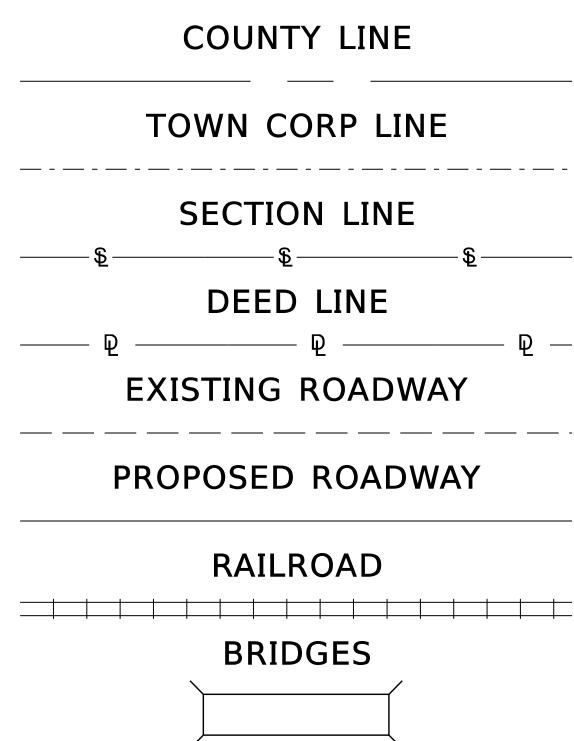

EQUATIONS

RURAL	URBAN
STA. 560+06.50 BK. = STA. 559+97.80 AH. = + 18.70 FT	STA. 691+14.79 BK. = STA. 691+17.35 AH. = - 2.56 FT
STA. 881+76.33 BK. = STA. 811+75.49 AH. = + 0.84 FT	= - 2.56 FT
STA. 1033+33.04 BK. = STA. 1033+46.75 AH. = - 10.71 FT	
STA. 1162+78.39 BK. = STA. 1162+63.61 AH. = + 14.78 FT	
	+ 23.61 FT

EXCEPTIONS

NONE

LENGTH DATA

LENGTH OF ROADWAY	78247.763 FT.	14.820 MI.
LENGTH OF BRIDGES	1096 FT.	0.207 MI.
LENGTH OF PROJECT (NET)	79,343.763 FT.	15.027 MI.
LENGTH OF EXCEPTIONS	FT.	MI.
LENGTH OF PROJECT (GROSS)	79,343.763 FT.	15.027 MI.

SCALES

PLAN	1 IN. = 100 FT.
PROFILE	{ HOR. 1 IN. = 100 FT.
LAYOUT	{ VERT. 1 IN. = 10 FT.
	1 IN. = 10 FT.

TITLE.dgn

TIME

DATE

DESIGNED BY: DISTRICT 6

CONSTRUCTION PROJECT DATA

EXTERNAL PROJECT NUMBER	IM-0059-01(127)
FMS & DETAIL	108138/301000

P S & E DATE: 11/16/2022

APPROVED:

DEPUTY EXECUTIVE DIRECTOR / CHIEF ENGINEER

EXECUTIVE DIRECTOR



DESCRIPTION OF SHEET

WKG. NO. SH. NO.

TITLE SHEET (1)		1
DETAIL INDEX AND GENERAL NOTES (2)		
DETAIL INDEX	DI-1	2
GENERAL NOTES	GN-1	3
TYPICAL SECTIONS (7)		
TYPICAL SECTION - MAIN FACILITY	TS-1	4
TYPICAL SECTION - MAIN FACILITY W.I.M.	TS-2	5
TYPICAL SECTION - INTERCHANGE RAMPS	TS-3	6
TYPICAL SECTION - MISCELLANEOUS TYPICAL DETAILS	TS-4	7
TYPICAL SECTION - PAVING DETAILS AT RAMPS	TS-5	8
TYPICAL SECTION - MCNEILL INTERCHANGE RAMPS	TS-6	9
TYPICAL SECTION - ROADSIDE CLEAR ZONES REQUIRED	TS-7	10
QUANTITY SHEETS (5)		
SUMMARY OF QUANTITIES	SO-1	11
SUMMARY OF QUANTITIES	SO-2	12
ESTIMATED QUANTITIES - GUARDRAIL REMOVAL ITEMS	EO-1	13
ESTIMATED QUANTITIES - GUARDRAIL REQUIRED	EO-2	14
ESTIMATED QUANTITIES - TRAFFIC CONTROL SIGNS	EO-3	15
PLAN SHEETS (29)		
STATION 476+64 (BOP) - STATION 501+50	WK3	16
STATION 501+20 - STATION 530+00	WK4	17
STATION 529+75 - STATION 558+25	WK5	18
STATION 558+00 - STATION 586+75	WK6	19
STATION 586+50 - STATION 615+00	WK7	20
STATION 614+80 - STATION 643+50	WK8	21
STATION 643+00 - STATION 672+00	WK9	22
STATION 671+75 - STATION 700+25	WK10	23
STATION 700+00 - STATION 728+75	WK11	24
STATION 728+50 - STATION 757+20	WK12	25
STATION 756+80 - STATION 785+50	WK13	26
STATION 785+00 - STATION 814+00	WK14	27
STATION 813+50 - STATION 842+50	WK15	28
STATION 842+00 - STATION 871+00	WK16	29
STATION 870+50 - STATION 899+10	WK17	30
STATION 898+75 - STATION 927+75	WK18	31
STATION 927+25 - STATION 956+00	WK19	32
STATION 955+50 - STATION 984+50	WK20	33
STATION 984+00 - STATION 1013+00	WK21	34
STATION 1012+50 - STATION 1041+10	WK22	35
STATION 1040+80 - STATION 1069+50	WK23	36
STATION 1069+00 - STATION 1098+00	WK24	37
STATION 1097+50 - STATION 1125+25	WK25	38
STATION 1126+00 - STATION 1155+00	WK26	39
STATION 1154+50 - STATION 1183+10	WK27	40
STATION 1182+75 - STATION 1211+75	WK28	41
STATION 1211+50 - STATION 1240+00	WK29	42
STATION 1239+50 - STATION 1268+50	WK30	43
STATION 1268+00 - STATION 1273+67 (EOP)	WK31	44
SPECIAL DESIGN SHEETS (14)		
MILLING TRANSITION US 11 / SR 607 UNDERPASS - NORFOLK S RAILROAD UNDERPASS	RD-1	45
MILLING TRANSITION SR 43 UNDERPASS - ANCHOR LAKE RD UNDERPASS	RD-2	46
MILLING TRANSITION MCNEILL STEEPHOLLOW RD	RD-3	47
BRIDGE PIER PROTECTION US 11 / SR 607 STA. 483+15	BPP-1	48
BRIDGE PIER PROTECTION NORFOLK S RAILROAD STA. 501+00	BPP-2	49
BRIDGE PIER PROTECTION SR 43 STA. 778+55.5	BPP-3	50
BRIDGE PIER PROTECTION ANCHOR LAKE RD STA. 1106+73	BPP-4	51
BRIDGE PIER PROTECTION MCNEILL STEEPHOLLOW RD STA. 1245+50	BPP-5	52
DETAILS OF CONSTRUCTION SIGNING	DCS-1	53
DETAILS OF CONSTRUCTION SIGNING	DCS-2	54
DETAILS OF CONSTRUCTION SIGNING	DCS-3	55
PAVEMENT MARKING DETAIL NORTHBOUND REST AREA	SDPM-1	56
PAVEMENT MARKING DETAIL MCNEILL INTERCHANGE RAMPS	SDPM-2	57
TRAFFIC RECORDER WIM KISTLER SYSTEM 4 LN STANDARD WITH BREAK AWAY POLE	TRS-1	58

DESCRIPTION OF SHEET

WKG. NO. SH. NO.

STANDARD DRAWINGS (33)		
PAVEMENT MARKING DETAILS FOR 2-LANE AND 4-LANE DIVIDED HIGHWAYS	PM-1	6051
PAVEMENT MARKING DETAILS FOR INTERCHANGE ENTRANCE RAMPS (PARALLEL AND TAPER)	PM-3	6053
PAVEMENT MARKING DETAILS FOR INTERCHANGE EXIT RAMPS (PARALLEL AND TAPERS)	PM-4	6054
RUMBLE STRIP DETAIL FOR OFGC OR CONCRETE ROADWAY WITH ASPHALT SHOULDERS	RS-3	6066
GUARDRAIL: "W" BEAM (STEEL POSTS)	GR-1B	6203
GUARDRAIL BRIDGE END SECTIONS TYPE "A" & "C"	GR-2	6204
GUARDRAIL BRIDGE END SECTION TYPE "H" (STEEL POSTS)	GR-2D	6208
GUARDRAIL: BRIDGE END SECTION-TYPE I (STEEL POSTS) (NEW CONSTRUCTION)	GR-2G	6211
GUARDRAIL: TYPICAL INSTALLATION AT BRIDGE APPROACHES FOR DIVIDED HIGHWAYS	GR-4	6214
GUARDRAIL: MISCELLANEOUS HARDWARE	GR-HW	6221
CONCRETE MEDIAN BARRIER (PRECAST)(32")	CMB-3	6226
3'-6" PIER PROTECTION DETAILS (1 OF 3)	PPD-A1	6228
3'-6" PIER PROTECTION DETAILS (2 OF 3)	PPD-A2	6229
3'-6" PIER PROTECTION DETAILS (3 OF 3)	PPD-A3	6230
4'-6" PIER PROTECTION DETAILS (1 OF 3)	PPD-B1	6231
4'-6" PIER PROTECTION DETAILS (2 OF 3)	PPD-B2	6232
4'-6" PIER PROTECTION DETAILS (3 OF 3)	PPD-B3	6233
TYPICAL INSTALLATION AND DETAILS OF DELINEATORS AND DISTANCE REFERENCE SIGNS	SN-8	6314
TYPICAL GUARDRAIL DELINEATION	SN-8C	6317
SIGNING DETAILS FOR BRIDGE APPROACHES	SN-9	6318
TRAFFIC CONTROL PLAN WITH FLAGGER (ONE-LANE CLOSURE OF TWO WAY TRAFFIC)	TCP-1	6351
TRAFFIC CONTROL PLAN FOR POSTED SPEED LIMIT OF 65 OR 70 MPH (INTERSTATES AND OTHER 4-LANE DIVIDED HIGHWAYS)XMEDIAN LANE OR OUTSIDE LANE CLOSUREXWORK DAY ONLY)	TCP-4	6354
TRAFFIC CONTROL PLAN FOR POSTED SPEED LIMIT OF 65 OR 70 MPH (INTERSTATES AND OTHER 4-LANE DIVIDED HIGHWAYS)XMEDIAN LANE OR OUTSIDE LANE CLOSUREXWORK DAY ONLY)	TCP-5	6355
HIGHWAY SIGN AND BARRICADE DETAILS FOR CONSTRUCTION PROJECTS	TCP-8	6358
TRAFFIC CONTROL PLAN MOBILE OPERATIONS MULTILANE ROADS AND TWO-LANE ROADS	TCP-9	6359
DETAILS OF OUTSIDE LANE CLOSURE AT EXIT AND ENTRANCE RAMPS	TCP-10	6360
TRAFFIC CONTROL PLANS FOR UNEVEN PAVEMENT DETAILS	TCP-12	6362
TEMPORARY STRIPING FOR TRAFFIC CONTROL 2-LANE AND 4-LANE DIVIDED HIGHWAYS	TCP-13	6363
TRAFFIC CONTROL DETAILS DRUM PLACEMENT AND SHOULDER CLOSURE	TCP-16	6366
SUPERELEVATION CASE I ROTATION ABOUT CENTERLINE	SE-2A	6408
SUPERELEVATION CASE II ROTATION ABOUT EDGE OF TRAVELED WAY	SE-2B	6409
SUPERELEVATION RUNOFF CASE I ROTATION ABOUT CENTERLINE	SE-3A	6413
SUPERELEVATION RUNOFF CASE II ROTATION ABOUT EDGE OF TRAVELED WAY	SE-3B	6414
TOTAL NUMBER OF SHEETS (91)		

DISTRICT 6

PS & E PLANS-DATE 11/16/2022

FMS CON. # 108138 / 301000

REVISIONS		
DATE	SHEET NO.	BY



DESIGNED BY: DISTRICT 6
 DETAILED BY:
 CHECKED BY: MB
 DATE: 11/02/2022

FMS CON: 108138/301000
 PROJECT NO.: IM-0059-01(127)
 COUNTY: PEARL_RIVER

DETAIL INDEX

WKG. NO. DI-1
 SHEET NO. 2

PLAN SHEET

TS, GN, D,ldgn

TIME

DATE

GENERAL NOTES

1. THE LOCATION AND SPACING OF SIGNS SHOWN ON THE TRAFFIC CONTROL PLAN ARE APPROXIMATE AND MAY BE ADJUSTED TO SUIT FIELD CONDITIONS.
2. THE CONTRACTOR IS TO REMOVE AND RESET ANY SIGNS WHICH CONFLICT WITH CONSTRUCTION. (NOT A SEPARATE PAY ITEM)
3. TEMPORARY STRIPING SHALL CONFORM TO FINISHED STRIPE SPECIFICATIONS FOR ALIGNMENT, NEATNESS AND STRAIGHTNESS.
4. PRIOR TO PLACEMENT OF THE ASPHALT, ALL RAISED PAVEMENT MARKERS THROUGHOUT THE PROJECT SHALL BE REMOVED, PATCH SPALLING AT TRANSVERSE AND LONGITUDINAL PAVEMENT JOINTS, AND CLIP BULGING ASPHALT AT PAVEMENT JOINTS (COST ABSORBED).
5. THE CONTRACTOR SHALL PROVIDE 2 PORTABLE R16-3 SIGNS REQUIRED BY THE STANDARD DRAWINGS FOR LANE CLOSURES (THE COST IS TO BE INCLUDED IN THE PRICE BID FOR PAY ITEM NO. 618-A, MAINTENANCE OF TRAFFIC).
6. CONES SHALL BE NARROW PROFILE WITH A MINIMUM HEIGHT OF 28 INCHES AND A MINIMUM WEIGHT OF TEN (10) POUNDS. CONES USED IN SPEED ZONES EQUAL TO OR GREATER THAN 45 MPH SHALL BE NARROW PROFILE WITH A MINIMUM HEIGHT OF 28 INCHES AND A MINIMUM WEIGHT OF FIFTEEN (15) POUNDS. ALL CONES SHALL BE APPROVED BY THE ENGINEER PRIOR TO USE.
7. WHERE MILLING OF THE ROADWAY LANES IS REQUIRED, THE CONTRACTOR SHALL PROVIDE OUTLETS IN THE EXISTING SHOULDERS AT SUFFICIENT INTERVALS TO PREVENT POOLING OR STANDING WATER ON THE MILLED SURFACE (NOT A SEPARATE PAY ITEM).
8. IT SHALL BE THE RESPONSIBILITY OF THE CONTRACTOR TO PROTECT EXISTING STRUCTURES SUCH AS PIPES, INLETS, APRONS, BRIDGES, ETC. FROM DAMAGE WHICH MIGHT OCCUR DURING CONSTRUCTION. EXTREME CARE SHALL BE EXERCISED IN UNDERCUT AREAS AND THE UNDERCUT DEPTH MAY BE ADJUSTED AT CROSS DRAINS, AS DIRECTED BY THE PROJECT ENGINEER. THE CONTRACTOR SHALL REPLACE OR REPAIR, AS DIRECTED BY THE ENGINEER, ANY STRUCTURES DAMAGED DURING THE LIFE OF THE CONTRACT. NO PAYMENT WILL BE MADE FOR REPLACEMENT OR REPAIR OF DAMAGED STRUCTURES.
9. VOIDS CREATED BY THE REMOVAL OF POSTS, CONCRETE ANCHORS, FOOTINGS, ETC., SHALL BE BACKFILLED AND TAMPED IN ACCORDANCE WITH SECTION 203 OF THE MISSISSIPPI STANDARD SPECIFICATIONS FOR ROAD AND BRIDGE CONSTRUCTION.
10. ALL TRAFFIC CONTROL DEVICES ON THIS PROJECT SHOULD COMPLY WITH PART VI OF THE MUTCD (LATEST EDITION).
11. ALL PLASTIC DRUMS SHALL HAVE A BALLASTING COLLAR MADE FROM RECYCLED TRUCK TIRES OR OTHER SUITABLE MATERIAL.
12. FLUORESCENT ORANGE SHEETING SHALL BE USED ON ALL CONSTRUCTION AND TRAFFIC CONTROL SIGNS EXCEPT FOR THOSE DESIGNATED IN THE PLANS TO BE BLACK LEGEND AND BORDER ON WHITE BACKGROUND.
13. THE CONTRACTOR IS RESPONSIBLE FOR PROVIDING BRACING, SHORING, OR ANY GROUND SUPPORT SYSTEM REQUIRED TO PREVENT A FAILURE FROM OCCURRING DURING EXCAVATION. PROTECTIVE MEASURES INCLUDING THE MATERIALS AND LABOR FOR DESIGNING AND CONSTRUCTING THE FACILITY ARE NOT CONSIDERED A SEPARATE PAY ITEM.
14. CENTERLINE RED/CLEAR PAVEMENT MARKERS SHALL BE PLACED AT A 40' INTERVAL FROM BOP TO EOP.
15. REMOVAL OF OBJECT MARKERS IS NOT CONSIDERED A SEPARATE PAY ITEM.
16. THE RECLAIMED ASPHALT PAVEMENT (RAP) MATERIAL REMOVED BY THE MILLING OPERATION SHALL BECOME THE PROPERTY OF THE CONTRACTOR WITH THE EXCEPTION OF 1000 TONS AND SHALL BE DELIVERED TO THE CLOSED REST AREAS ON THE PROJECT. SUFFICIENT ADVANCE NOTICE SHALL BE GIVEN TO ENSURE THAT MDOT MAINTENANCE PERSONNEL WILL BE ON HAND TO DIRECT THE DELIVERY. THE CONTRACTOR SHALL ALSO PROVIDE MDOT WITH AN OPERATOR AND THE NECESSARY EQUIPMENT TO STOCKPILE THE DELIVERY. THE COST OF WHICH SHALL BE ABSORBED.
17. IF COLORS ARE USED ON PLAN/PROFILE SHEETS, THEY ARE INTENDED TO VISUALLY EASE THE LOCATION OF ELEMENTS FOR USERS OF THESE DRAWINGS. ALTHOUGH THE INTENT IS TO CATEGORIZE EVERYTHING AS EITHER EXISTING OR PROPOSED, IT IS THE END USER'S RESPONSIBILITY TO ENSURE ALL ELEMENTS ARE INTERPRETED CORRECTLY REGARDLESS OF COLOR.
18. BIDDERS ARE ADVISED THAT HARD COPIES OF ANY ADDENDA FOR THIS PROJECT WILL NO LONGER BE MAILED. ALL ADDENDA FOR THIS PROJECT WILL BE POSTED TO WWW.MDOT.MS.GOV UNDER THE PROPOSAL ADDENDA COLUMN. IT IS THE BIDDER'S RESPONSIBILITY TO CHECK AND SEE IF ANY ADDENDA HAVE BEEN POSTED FOR THIS PROJECT. PLEASE CONTACT CONTRACT ADMINISTRATION DIVISION AT 601-359-7700 FOR ANY QUESTIONS REGARDING ELECTRONIC ADDENDA.
19. STORAGE OF FLAMMABLE MATERIALS WILL NOT BE ALLOWED UNDER ANY BRIDGE STRUCTURE.
20. MILLED SURFACES IN THE ROADWAY LANES MUST BE OVERLAYED AND TEMPORARILY STRIPED THE SAME DAY/NIGHT THEY ARE MILLED. TRAFFIC SHALL NOT BE ALLOWED TO TRAVEL ON A MILLED SURFACE, UNLESS DIRECTED OTHERWISE BY THE PROJECT ENGINEER.
21. THE CONTRACTOR SHALL PROVIDE A VARIABLE MESSAGE BOARD (THE COST IS TO BE INCLUDED IN THE PRICE BID FOR PAY ITEM NO. 907-618-A001, MAINTENANCE OF TRAFFIC). A VARIABLE MESSAGE BOARD SHALL BE PLACED 2 MILES IN ADVANCE OF EACH LANE CLOSURE.
22. ON CONCRETE RAMPS, STRIPE IS TO BE REMOVED AND REPLACED WITH COLD PLASTIC STRIPE OR AN APPROVED EQUAL. ALL JOINTS ARE TO BE CLEANED AND FILLED. (PAYMENT BY PAY ITEMS)
23. THE MAXIMUM LENGTH OF ANY LANE CLOSURE IS THREE (3) MILES, INCLUDING TAPERS. THE MINIMUM DISTANCE BETWEEN LANE CLOSURES SHALL BE TWO (2) MILES IN THE SAME LANE AND THREE (3) MILES IN OPPOSITE LANES.
24. ANY SITE GRADING AND ALL FILL MATERIAL NECESSARY AT THE BRIDGE PROTECTION LOCATIONS WILL NOT BE MEASURED FOR SEPARATE PAYMENT BUT WILL BE ABSORBED IN OTHER PAY ITEMS. SEEDING, FERTILIZER, AND VEGETATIVE MULCH ARE REQUIRED ON ALL DISTURBED AREAS AT THE BRIDGE PROTECTION SITE AND WILL BE CONSIDERED AN ABSORBED ITEM. APPLICATION RATES FOR BERMUDA AND BAHIA GRASS WILL BE 20 AND 25 POUNDS PER ACRE. APPLICATION RATE FOR COMBINATION FERTILIZER (13-13-13) WILL BE 1,000 POUNDS PER ACRE. APPLICATION RATE FOR MULCH SHALL BE TWO (2) TONS PER ACRE.
25. ONCE PRECAST CONCRETE MEDIAN BARRIERS ARE PLACED FOR LANE CLOSURES, WORK SHALL BEGIN WITHIN 48 HOURS AND SHALL BE CONTINUOUS UNTIL THOSE CONSTRUCTION ACTIVITIES ARE COMPLETED.
26. REST AREA IMPROVEMENTS ARE LIMITED TO ASPHALT AREAS AS MARKED ON THE PLANS.
27. THE GRASS ISLAND THAT IS TO BE REMOVED AT STA. 46+25 RT. ON THE EXIT RAMP OF THE MCNEILL INTERCHANGE, HAS TWO SIGN POST FOOTINGS FROM A SIGN THAT HAS BEEN RELOCATED. THE COST OF REMOVING THESE TWO FOOTINGS DURING THE WORK OF THE CONTRACT SHALL BE ABSORBED AND REMOVED FROM ROW.

PLAN SHEET

TS: GN, D1.dgn

TIME

DATE

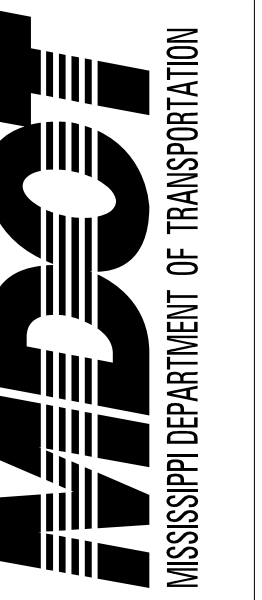

DESIGNED BY: DISTRICT 6

DETAILED BY:

CHECKED BY: MB

DATE: 11/02/2022

FMS CON: 108138/301000

PROJECT NO.: IM-0059-01(127)

COUNTY: PEARL_RIVER

GENERAL NOTES

WK. NO.
GN-1

SHEET NO.
3