

SECTION 905 -- PROPOSAL (CONTINUED)

I (We) hereby certify by digital signature and electronic submission via Bid Express of the Section 905 proposal below, that all certifications, disclosures and affidavits incorporated herein are deemed to be duly executed in the aggregate, fully enforceable and binding upon delivery of the bid proposal. I (We) further acknowledge that this certification shall not extend to the bid bond or alternate security which must be separately executed for the benefit of the Commission. This signature does not cure deficiencies in any required certifications, disclosures and/or affidavits. I (We) also acknowledge the right of the Commission to require full and final execution on any certification, disclosure or affidavit contained in the proposal at the Commission's election upon award. Failure to so execute at the Commission's request within the time allowed in the Standard Specifications for execution of all contract documents will result in forfeiture of the bid bond or alternate security.

Bidder acknowledges receipt of and has added to and made a part of the proposal and contract documents the following addendum (addenda):

ADDENDUM NO. <u> 1 </u>	DATED <u> 2/21/2024 </u>	ADDENDUM NO. <u> </u>	DATED <u> </u>
ADDENDUM NO. <u> </u>	DATED <u> </u>	ADDENDUM NO. <u> </u>	DATED <u> </u>
ADDENDUM NO. <u> </u>	DATED <u> </u>	ADDENDUM NO. <u> </u>	DATED <u> </u>

Number	Description
--------	-------------

- | | |
|---|---|
| 1 | Revised Table of Contents; Revised Notice To Bidders No. 5589; Added Notice To Bidders No. 5590; Added Notice To Bidders No. 5591; Added Special Provision No. 907-619-5 Revised Bid Items; Added and/or Revised Plan Sheet Nos. 4, 11, 12, and 17; Amendment EBSx Download Required. |
|---|---|

TOTAL ADDENDA: 1
(Must agree with total addenda issued prior to opening of bids)

Respectfully Submitted,

DATE _____

Contractor

BY _____
Signature

TITLE _____

ADDRESS _____

CITY, STATE, ZIP _____

PHONE _____

FAX _____

E-MAIL _____

(To be filled in if a corporation)

Our corporation is chartered under the Laws of the State of _____ and the names, titles and business addresses of the executives are as follows:

_____ President	_____ Address
--------------------	------------------

_____ Secretary	_____ Address
--------------------	------------------

_____ Treasurer	_____ Address
--------------------	------------------

The following is my (our) itemized proposal.

STBG-0054-01(061)/ 109246301000 & CRP-0054-01(063)/ 109274301000

Lawrence County(ies)

Revised 01/26/2016

**MISSISSIPPI DEPARTMENT OF TRANSPORTATION
TABLE OF CONTENTS**

**PROJECT: STBG-0054-01(061)/109246301 - Lawrence
CRP-0054-01(063)/109274301 - Lawrence**

Section 901 - Advertisement

Section 904 - Notice to Bidders

#1	Governing Specification, w/ Supplement
#2	Status of ROW, w/ Attachments
#3	Final Cleanup
#113	Tack Coat
#296	Reduced Speed Limit Signs
#445	Mississippi Agent or Qualified Nonresident Agent
#516	Errata and Modifications to the 2017 Standard Specifications
#757	Additional Erosion Control Requirements
#1225	Early Notice to Proceed
#1226	Material Storage Under Bridges
#1241	Fuel and Material Adjustments
#1434	Erosion Control Plan
#1878	Storm Water Discharge Associated with Construction Activities (≥ 1 and < 5 Acres)
#1963	Guardrail Pads
#2172	App for Storm Water Reports
#2206	MASH Compliant Devices
#2273	Mississippi Special Fuel Tax Law
#2782	DBE Pre-Bid Meeting
#2954	Reflective Sheeting for Signs
#3676	Asphalt Gyratory Compactor Internal Angle Calibration
#4113	Unique Entity ID Requirement For Federal Funded Projects
#4702	App for Traffic Control Report
#5086	Detail of Square Tube Sign Posts
#5551	Federal Bridge Formula
#5587	Contract Time
#5588	Specialty Items
#5589	Scope of Work
#5590	Project Number Change
#5591	Pay Item Correction
#5605	Disadvantaged Business Enterprise In Federal-Aid Highway Construction, w/ Supplement
906	Required Federal Contract Provisions -- FHWA 1273, w/Supplements

Section 907 - Special Provisions

907-101-1	Definitions and Terms
907-102-2	Bidding Requirements and Conditions
907-105-2	Control of Work
907-106-1	Control of Materials
907-107-2	Contractor's Erosion Control Plan
907-108-4	Subletting of Contract

**PROJECT: STBG-0054-01(061)/109246301 - Lawrence
CRP-0054-01(063)/109274301 - Lawrence**

907-109-4	Measurement and Payment
907-234-1	Silt Fence
907-619-5	Traffic Control for Construction Zones
907-619-6	Temporary Portable Rumble Strips
907-700-1	Materials and Tests
907-701-3	Hydraulic Cement
907-702-4	Bituminous Materials
907-703-2	Gradation
907-705-1	Stone Riprap
907-707-3	Joint Materials
907-711-2	Plain Steel Wire
907-712-1	Fence and Guardrail
907-714-3	Miscellaneous Materials
907-718-1	Timber and Dimension Lumber
907-720-2	Acceptance Procedure for Glass Beads
907-721-4	Materials for Signing

Section 905 - Proposal, Proposal Bid Items, Combination Bid Proposal
Certification of Performance - Prior Federal-Aid Contracts
Certification Regarding Non-Collusion, Debarment and Suspension
SAM.GOV Registration and Unique Entity ID
Section 902 - Contract Form
Section 903 - Contract Bond Forms
Form -- OCR-485

(REVISIONS TO THE ABOVE WILL BE INDICATED ON THE SECOND SHEET
OF SECTION 905 AS ADDENDA)

02/21/2024 01:38 PM

MISSISSIPPI DEPARTMENT OF TRANSPORTATION

SECTION 904 – NOTICE TO BIDDERS NO. 5589

CODE: (SP)

DATE: 02/20/2024

SUBJECT: Scope of Work

**PROJECT: STBG-0054-01(061) / 109246301 & CRP-0054-01(063) / 109274301 --
Lawrence County**

The contents of this Notice to Bidders is for the construction of Project No. STBG-0054-01(061) / 109246301. The Plans portion of this contract is for the construction of Project No. CRP-0054-01(063) / 109274301.

Reference in this Notice to Bidders may be made to Standard Drawings which shall be in accordance with the Notice to Bidders entitled, “Standard Drawings.”

The work described below is to overlay the following section of SR 27 from Dewey Ballard Road to just North of US 84.

<u>Route</u>	<u>Length (Mile)</u>	<u>Width (Feet)</u>	<u>Surface Lift</u>	<u>Thickness (Inches)</u>
SR 27	8.0	28' & Var.	9.5-mm, ST	1½”

See Typical Sections TS-1 for more details.

Work on the Project shall consist of the following:

1. The Contractor shall erect and maintain construction signing, provide all signs, set up nighttime lane closures (if needed), and traffic handling devices in accordance with the Traffic Control Plan. The cost for this work is to be included in the price bid for pay item 618-A: Maintenance of Traffic. All traffic control devices on this project should comply with the latest version of the MUTCD. Fluorescent orange sheeting shall be used on all construction and traffic control signs except for those designated in the standards to be black legend and border on white background.
2. Prior to the overlay, the existing shoulders shall be clipped to provide proper drainage and surplus material shall be spread along the edge of the shoulders, fore slopes, or other adjacent areas as directed by the Project Engineer, and will be an absorbed item.
3. The Contractor shall fine mill at the following locations: (See TS-1)

LOCATION	MILLING (SY)	REMARKS
BOP 1427+70 to 1428+20	467	BOP Tie-In
EOP 1846+70 to 1848+20	483	EOP Tie in
1716+60 to 1719+18	483	Bridge End
1722+98 to 1725+57	483	Bridge End
1733+08 to 1735+88	483	Bridge End
1738+33 to 1741+15	558	Bridge End, 33.5 width average of 29/38'
1836+15 to 1840+99	2366	Under Hwy 84 Overpass
1745+00, W. McPherson Dr, Int.	1580	Curbed road Milling
1683+53, Light plant Road LL	733	Curbed road Milling
1683+53, Light plant Road RL	1106	Curbed road Milling
1642+10, Bethel Road LL	1145	Curbed road Milling
1642+10, Bethel Road RL	1338	Curbed road Milling
1622+99, F E Sellers Hwy	2106	Curbed road Milling
1825+57, Henry Bass Road	603	Curbed road Milling
Hwy 27 / Hwy 84 Intersection	10,547	
Hwy 27 / Hwy 184 Intersection	8486	
W. McPherson Dr, Road	7031	As directed

4. The Contractor shall perform mill and inlay at the following locations: (See TS-1)

LOCATION	MILLING (SY)	REMARKS
Hwy 84 SW Ramp, 1835+69	134	Damaged Area
Hwy 84 SE Ramp, 1835+69	59	Damaged Area
Hwy 84 SE Ramp, 1835+69	73	Damaged Area
W McPherson Dr, 1738+33	109	Damaged Area
W McPherson Dr, 1738+33	109	Damaged Area

5. The existing guardrail pads from the face of the rail extending outward shall be removed. The Contractor shall then place crushed stone at these locations (6" depth). Excess excavation may be required. Existing guardrail items shall then be removed, and the following shall be installed, as per the standard drawings.

Station	Station	Terminal End	Bridge End	Delineators	W Beam	Removal of Rail
291+48	295+28	4	4	18	225	667
308+18	310+63	4	4	18	225	667
400+92	403+11	2	0	8	169	219

A saw cutting pay item has been included in the quantities to be utilized in the removal of the asphalt pavement. If the item is not utilized, no payment will be made under this item.

- 6. The Contractor shall place ¾” and variable of 9.5-mm, ST, Leveling asphalt at locations directed by the Engineer.
- 7. The Contractor shall place the top lift of asphalt on the roadway left and right of the centerline from BOP to EOP as shown on sheet TS-1. The finished cross-slope is to be 2% in tangent sections and match the existing super elevation rate in horizontal curves.

The Contractor shall remove existing pavement markers prior to placing asphalt. The cost of removing these pavement markers is to be included in other items bid.

Asphalt surface shall be placed on all local roads, driveway aprons and guardrail pads (1½” Thickness). This includes McPherson Drive from the intersection SR 27 to the overpass on SR 27.

Driveway aprons shall be paved 10’ wide or as directed by the Engineer. All local roads shall be paved to the normal right of way line or as directed by the Engineer.

Asphalt quantities were estimated as follows:

Mainline	12,833 Tons
Local Roads	943 Tons
Driveway Pads	416 Tons
Guardrail Pads	221 Tons
Mill & Inlay	40 Tons

Note: The Contractor shall be responsible for traffic control while MDOT personnel conduct density testing on the asphalt. The cost shall be included in the price in the bid price for pay item 618-A: Maintenance of Traffic.

- 8. The Contractor shall place granular material on the shoulders to raise the existing shoulders to the new grade. The shoulder shall be bladed, shaped, and compacted to a minimum slope of 4%. Granular material will not be allowed to be placed directly on the top lift of asphalt, but must be placed directly on the gravel shoulder by means of a road widener machine approved by the Project Engineer. Light blading or mowing of the shoulders will be required prior to placement of the granular material. Please refer to Subsection 618.03.3 of the Specification Book as well as sheet SDTCP-16 for requirements related to pavement edge drop-offs.
- 9. The Contractor shall place rumble strips in the locations indicated in the typical sections on sheet TS-1.
- 10. The Contractor shall place all permanent pavement markings, including stripe and raised pavement markers, throughout the project as required by the Standard Drawings or as directed by the Engineer. Existing pavement markings located on bridges shall be removed as required prior to placing new markings.

The Contractor shall be responsible for replacing guardrail delineators throughout the project as required by the Standard Drawings or as directed by the Engineer.

An asphalt taper shall be placed at the temporary joints caused by the milling or overlay in order to provide for the safe movement of traffic. The taper shall be three feet (3') in length per one inch of depth and will be an absorbed item.

Temporary striping shall be required after milling and overlaying operations: Temporary striping shall be placed in the same locations and layout as permanent stripe. All centerline, lane lines, edge lines, and no passing stripes that have been removed during the day's operations shall be replaced with temporary stripe before work is discontinued for the day or as soon thereafter as weather conditions will permit, except that:

- Replacement of no-passing stripes may be delayed for a period not to exceed three (3) days for a two or three lane road.
- Temporary edge lines on projects requiring shoulders constructed of granular material may be delayed for a period not to exceed three (3) days.

All asphalt and concrete curbs along local roads from BOP to EOP shall be painted (two applications) with white traffic paint and traffic beads as shown on sheet DCIS-1; such costs shall be included in other items bid.

It shall be the responsibility of the Contractor to protect the roadway and all existing structures, such as bridges, culverts, signs, and curbs, from damage occurring as a result of the Contractor's operations. Damages to existing structures caused by the Contractor's operations shall be repaired or replaced at no cost to the Department.

Incidental work such as removing vegetation, shaping and compaction of shoulders, removing excess asphalt material, project clean-up, and other incidental work necessary to complete the project will not be measured for separate payment. Such costs shall be included in the price of other items bid.

It is the Contractor's responsibility to insure the drainage of surface water from milled areas. Where applicable, existing shoulder material is to remain in place to be incorporated into final sloping of the shoulders. Temporary wedges (paper joints) of full lane width asphalt shall be placed by the Contractor immediately after the fine milling process to allow the safe transition of traffic. These wedges shall be maintained in a satisfactory condition by the Contractor until the permanent asphalt is placed, cost to be absorbed.



DESIGNED BY:
 DETAILED BY:
 CHECKED BY:
 DATE:

FMS CON: 109246/301000
 PROJECT NO.: STBG-0054-2(061)
 COUNTY: LAWRENCE

Notice To Bidder No. 5589 - Cont'd

WY. NO. 1
 SHEET NO. 1

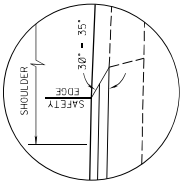

SAFETY EDGE REQ'D
 TOP 2 LIFTS ONLY
 (NOT A PAY ITEM)
 OVERLAY

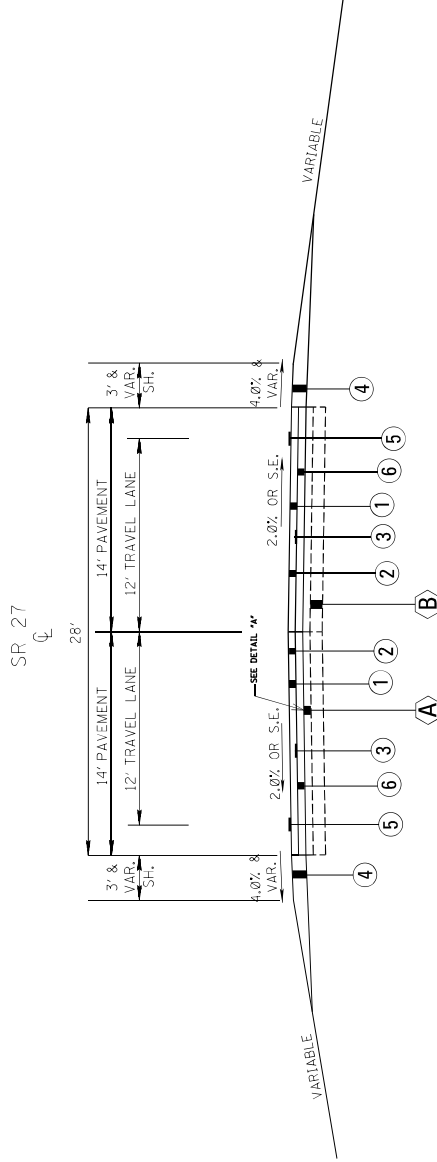

TYPICAL SECTION

B.O.P. STA. 1427+70 - E.O.P. STA. 1848+20

NOT TO SCALE

PROPOSED

- ① 1.5" OF 9.5MM ST ASPHALT REQ'D
- ② 1.5" & VAR. FINE MILLING WHERE REQ'D
- ③ TACK COAT REQ'D
- ④ 1.5" & VAR. OF CL. 6, GR. D GRANULAR MATERIAL REQ'D
- ⑤ RUMBLE STRIPS REQ'D (SEE SHEET RS-1, DETAIL "B")
- ⑥ 0.75" & VAR. OF 9.5MM ST ASPHALT LEVELING WHERE REQ'D

EXISTING

- Ⓐ BITUMINOUS PAVEMENT IN PLACE (SEE DETAIL "C")
- Ⓑ GRANULAR SUBGRADE IN PLACE

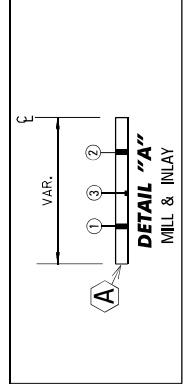
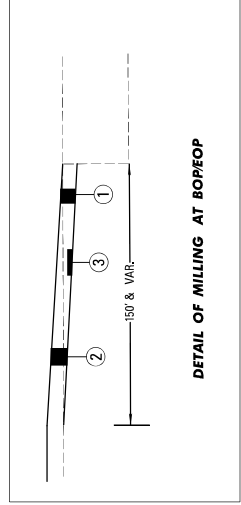
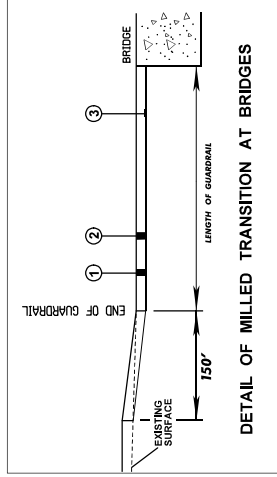

STATE	MISS
PROJECT NO.	STBG-0054-01(061)

SUMMARY OF QUANTITIES (SHEET 1)

PAY ITEM NO.	PAY ITEM	UNIT	LAWRENCE : 109246-301000	
			Prelim	Final
202-B006	Removal of Asphalt Paved Shoulders, All Depths	SY	830	
202-B150	Removal of Guard Rail Including Post, Blockouts & Hardware	LF	1,553	
202-B240	Removal of Traffic Stripe	LF	2,500	
203-G002	Excess Excavation, LVM, AH	CY	58	
304-A008	Granular Material, LVM, Class 6, Group D	CY	1,816	
304-F001	3/4" and Down Crushed Stone Base	TON	233	
304-F002	OR	TON	233	
304-F002	Size 610 Crushed Stone Base	TON	233	
304-F003	OR	TON	233	
304-F003	Size 825B Crushed Stone Base	TON	233	
403-A015	9.5-mm, ST, Asphalt Pavement	TON	14,453	
403-B012	9.5-mm, ST, Asphalt Pavement, Leveling	TON	811	
406-D001	Fine Milling of Bituminous Pavement, All Depths	SY	45,570	
407-A001	Asphalt for Tack Coat	GAL	18,031	
412-A001	Pre-Grinding	SF	1,584	
423-A001	Rumble Strips, Ground In	MI	15	
503-C010	Saw Cut, Full Depth	LF	1,355	
606-D019	Guard Rail, Bridge End Section, Type H	EA	8	
606-E005	Guard Rail, Terminal End Section, Flared	EA	10	
618-A001	Maintenance of Traffic	LS	1	
618-B001	Additional Construction Signs	SF	1	
619-A1001	Temporary Traffic Stripes, Continuous White	MI	15	
619-A2001	Temporary Traffic Stripes, Continuous Yellow	MI	10	
619-A4002	Temporary Traffic Stripes, Skip Yellow	MI	6	
619-A5001	Temporary Traffic Stripes, Detail	LF	33,970	
619-A6001	Temporary Traffic Stripes, Legend	SF	529	
619-A6002	Temporary Traffic Stripes, Legend	LF	5,384	
907-619-B001	Temporary Portable Rumble Strips	LF	132	
620-A001	Mobilization	LS	1	
626-C002	6" Thermoplastic Double Drop Edge Stripe, Continuous White	MI	15	
626-D001	6" Thermoplastic Double Drop Traffic Stripe, Skip Yellow	MI	6	
626-E001	6" Thermoplastic Double Drop Traffic Stripe, Continuous Yellow	MI	9	
626-G002	Thermoplastic Detail Stripe, White	LF	21,695	
626-G003	Thermoplastic Detail Stripes, Yellow	LF	12,275	
626-H004	Thermoplastic Legend, White	SF	502	
626-H005	Thermoplastic Legend, White	LF	4,752	
627-J001	Two-Way Clear Reflective High Performance Raised Markers	EA	993	
627-K001	Red-Clear Reflective High Performance Raised Markers	EA	24	
627-L001	Two-Way Yellow Reflective High Performance Raised Markers	EA	1,423	
630-F006	Delineators, Guard Rail, White	EA	44	

MISSISSIPPI DEPARTMENT OF TRANSPORTATION
SUMMARY OF QUANTITIES



Working Number: SQ-1
 Sheet Number: 2

PROJ NO: STBG-0054-01(061)
 COUNTY: LAWRENCE

FILENAME: 109246 SQS
 Design Team: _____
 Checked: _____
 Date: _____



DESIGNED BY: _____
 CHECKED BY: _____
 DATE: _____

FMS CON: 109246/301000
 PROJECT NO.: STBG-0054-01(61)
 COUNTY: LAWRENCE

Notice To Bidder - 1589 - Control Signs

WV NO. TC 90-1
 SHEET NO. 3

SIGNS REQUIRED

SIGN NO.	SIZE	UNIT AREA REQ'D	TOTAL SIGN AREA PTT	REMARKS
G20-1	60" X 24"	10,000	2	ROAD WORK NEXT XX MILES
G20-2	48" X 24"	9,000	8	END ROAD WORK
G20-4	36" X 18"	4,500	64	PILOT CAR FOLLOW DIE
M1-1	24" X 24"	4,000		1 OR 2 DIGIT
M1-1	30" X 24"	5,000		3 DIGIT
M1-4	24" X 24"	4,000		1 OR 2 DIGIT
M1-4	30" X 24"	5,000		3 DIGIT
M1-5	24" X 24"	4,000		1 OR 2 DIGIT
M1-5	30" X 24"	5,000		3 DIGIT
M3-1	24" X 15"	3,13		NORTH-1 OR 2 DIGIT RITE-MARKER
M3-1	30" X 15"	3,13		DIGIT RITE-MARKER
M3-2	24" X 15"	3,13		EAST-1 OR 2 DIGIT RITE-MARKER
M3-2	30" X 15"	3,13		DIGIT RITE-MARKER
M3-3	24" X 15"	3,13		WEST-1 OR 2 DIGIT RITE-MARKER
M3-3	30" X 15"	3,13		DIGIT RITE-MARKER
M3-4	24" X 15"	3,13		SOUTH-1 OR 2 DIGIT RITE-MARKER
M3-4	30" X 15"	3,13		DIGIT RITE-MARKER
M4-8	24" X 15"	2,000		DIGIT RITE-MARKER
M4-8	30" X 15"	3,13		DIGIT RITE-MARKER
M4-9	48" X 36"	12,000		DETOUR ↑
M4-9L	48" X 36"	12,000		DETOUR ←
M4-9BL	48" X 36"	12,000		DETOUR ↖
M4-9SL	48" X 36"	12,000		DETOUR ↗
M4-9BSL	48" X 36"	12,000		DETOUR ↘
M4-9BR	48" X 36"	12,000		DETOUR ↙
M4-9BR	48" X 36"	12,000		DETOUR ↗
M4-10L	48" X 18"	6,000		DETOUR ↖
M4-10R	48" X 18"	6,000		DETOUR ↗
M4-5	24" X 12"	2,000		TO
M5-1R	21" X 15"	2,19		↑
M5-2L	21" X 15"	2,19		↓
M5-2R	21" X 15"	2,19		↖
M5-2L	21" X 15"	2,19		↗
M6-1R	21" X 15"	2,19		↖
M6-2L	21" X 15"	2,19		↗
M6-2R	21" X 15"	2,19		↖
M6-3	21" X 15"	2,19		↑

SIGNS REQUIRED

SIGN NO.	SIZE	UNIT AREA REQ'D	TOTAL SIGN AREA PTT	REMARKS
R1-1	36" OCTAGON	7,46		STOP
R1-1	48" OCTAGON	13,25		STOP
R1-2	36" X 36" X 36"	3,90		YIELD
R1-2	48" X 48" X 48"	6,93		YIELD
R1-2	60" X 60" X 60"	10,83		3-WAY 4-WAY, ETC.
R1-3	18" X 9"	1,13		SPEED LIMIT
R1-3	24" X 12"	2,00		SPEED LIMIT
R2-1	24" X 30"	5,00		SPEED LIMIT
R2-1	36" X 48"	12,00		SPEED LIMIT
R2-1	48" X 60"	20,00		SPEED LIMIT
R3-1	36" X 36"	9,00		NO LEFT TURN
R3-1	48" X 48"	16,00		NO LEFT TURN
R3-2	36" X 36"	9,00		NO RIGHT TURN
R3-2	48" X 48"	16,00		NO RIGHT TURN
R3-4	36" X 36"	9,00		NO U-TURN
R3-4	48" X 48"	16,00		NO U-TURN
R3-5L	30" X 36"	7,50		ONLY
R3-5R	30" X 36"	7,50		ONLY
R3-6L	30" X 36"	7,50		ONLY
R3-6R	30" X 36"	7,50		ONLY
R3-7L	30" X 30"	6,25		LEFT LANE MUST TURN LEFT
R3-7R	30" X 30"	6,25		RIGHT LANE MUST TURN RIGHT
R4-1	24" X 30"	5,00	59	DO NOT PASS
R4-1	48" X 60"	20,00		DO NOT PASS
R4-2	24" X 30"	5,00	19	PASS WITH CARE
R4-2	48" X 60"	20,00		PASS WITH CARE
R4-7	48" X 60"	20,00		↑
R4-8	48" X 60"	20,00		↓
R5-1	48" X 48"	16,00		DO NOT ENTER
R5-1a	42" X 30"	8,75		WRONG WAY
R6-1L	36" X 12"	3,00		ONE WAY
R6-1R	36" X 12"	3,00		ONE WAY
R6-2L	24" X 30"	5,00		ONE WAY
R6-2R	24" X 30"	5,00		ONE WAY
R11-2	48" X 30"	10,00		ROAD CLOSED
R11-2a	60" X 30"	12,50		ROAD CLOSED
R11-3a	60" X 30"	12,50		ROAD CLOSED
R11-3b	60" X 30"	12,50		ROAD CLOSED
R11-4	60" X 30"	12,50		ROAD CLOSED
R12-1	36" X 48"	12,00		WHEN WORKERS ARE PRESENT
R16-3	36" X 48"	12,00		WHEN WORKERS ARE PRESENT
R16-3	48" X 60"	20,00		WHEN WORKERS ARE PRESENT

SIGNS REQUIRED

SIGN NO.	SIZE	UNIT AREA REQ'D	TOTAL SIGN AREA PTT	REMARKS
W1-1L	48" X 48"	16,00		↑
W1-1R	48" X 48"	16,00		↓
W1-2R	48" X 48"	16,00		↖
W1-2L	48" X 48"	16,00		↗
W1-3L	48" X 48"	16,00		↖
W1-3R	48" X 48"	16,00		↗
W1-4L	48" X 48"	16,00		↖
W1-4R	48" X 48"	16,00		↗
W1-5L	48" X 48"	16,00		↖
W1-5R	48" X 48"	16,00		↗
W1-6L	48" X 24"	9,00		←
W1-6L	60" X 30"	12,50		←
W1-6R	48" X 24"	9,00		→
W1-6R	60" X 30"	12,50		→
W1-7	48" X 24"	9,00		↔
W1-7	60" X 30"	12,50		↔
W1-8L	18" X 24"	3,00		↙
W1-8L	36" X 48"	12,00		↙
W1-8R	18" X 24"	3,00		↘
W1-8R	36" X 48"	12,00		↘
W1-9L	48" X 48"	16,00		↙
W1-9L	48" X 48"	16,00		↘
W2-6	36" X 36"	9,00		↻
W3-2a	48" X 48"	16,00		↻
W3-3	48" X 48"	16,00		↻
W3-5	48" X 48"	16,00		↻
W4-1L	48" X 48"	16,00		↙
W4-1R	48" X 48"	16,00		↘
W4-2L	48" X 48"	16,00		↖
W4-2R	48" X 48"	16,00		↗
W4-3L	48" X 48"	16,00		↖
W4-3R	48" X 48"	16,00		↗
W4-6	48" X 48"	16,00		↖
W5-1a	48" X 48"	16,00		↖
W6-2	48" X 48"	16,00		↖
W6-3	48" X 48"	16,00		↖
W8-1	48" X 48"	16,00		BUMP
W8-4	48" X 48"	16,00		SOFT PAVEMENT
W8-6	48" X 48"	16,00		TRUCK CROSSING
TOTAL SIGN AREA LESS THAN 10 SQ. FT.				782 SQ. FT.
TOTAL SIGN AREA GREATER THAN 10 SQ. FT.				500 SQ. FT.

SIGNS REQUIRED

SIGN NO.	SIZE	UNIT AREA REQ'D	TOTAL SIGN AREA PTT	REMARKS
W8-7	48" X 48"	16,00		LOOSE GRAVEL
W8-9	48" X 48"	16,00		LOW SHOULDER
W8-11	36" X 36"	9,00		UNEVEN LANES
W8-12	48" X 48"	16,00		NO CENTER STRIPE
W10-1	36" DIA.	7,07		XX MPH
W10-1	24" X 24"	4,00		NO PASSING ZONE
W14-3	36" X 48" X 48"	5,56	59	XXX FEET
W14-3	48" X 64" X 64"	9,89		BRIDGE MAY BE IN COLD WEATHER
W19-2	48" X 48"	16,00		ADVANCE ROAD WORK
W20-1	36" X 36"	9,00		ADVANCE DETOUR
W20-2	48" X 48"	16,00		ROAD CLOSED
W20-3	48" X 48"	16,00		ADVANCE ROAD CLOSED
W20-4	48" X 48"	16,00		ADVANCE ROAD CLOSED
W20-4b	48" X 48"	16,00		ADVANCE ROAD CLOSED
W20-5L	48" X 48"	16,00		RT. LN. CLOSED
W20-5R	48" X 48"	16,00		RT. LN. CLOSED
W20-7a	48" X 48"	16,00		WORKERS
W21-1	36" X 36"	9,00		WORKERS
W21-1a	36" X 36"	9,00		WORKERS
W21-2	36" X 36"	9,00		WORKERS
W21-3	48" X 48"	16,00		WORKERS
W21-5	48" X 48"	16,00		WORKERS
W21-6	36" X 36"	9,00		WORKERS
W24-1L	48" X 48"	16,00		WORKERS
W24-1R	48" X 48"	16,00		WORKERS
W24-1aL	48" X 48"	16,00		WORKERS
W24-1aR	48" X 48"	16,00		WORKERS
W24-1bL	48" X 48"	16,00		WORKERS
W24-1bR	48" X 48"	16,00		WORKERS
VP-1L	12" X 36"	3,00		WORKERS
VP-1R	12" X 36"	3,00		WORKERS
OM-3L	12" X 36"	3,00		WORKERS
OM-3R	12" X 36"	3,00		WORKERS

NOTES

- STANDARD
 - SPECIAL (USE WHERE WARRANTED)
 - INTERSTATE ROUTE MARKER
 - UNITED STATES ROUTE MARKER
 - STATE ROUTE MARKER
 - COLORS OF CARDINAL DIRECTION MARKERS AND DIRECTIONAL ROUTE MARKERS.
 - BLACK STRIPES ON YELLOW BACKGROUND
 - INTERSTATE USE ONLY
 - TOP OF SIGN - BLACK LETTERING ON ORANGE BACKGROUND.
 - BOTTOM OF SIGN - BLACK LETTERING ON WHITE BACKGROUND.
- THE BACKGROUND OF ALL WARNING SIGNS ("W" SERIES) EXCEPT W10-1 SHALL BE ORANGE. THE W10-1 BACKGROUND SHALL BE YELLOW IN ALL CASES.



DESIGNED BY:
 CHECKED BY:
 DATE: 11-13-2022

FMS CON: 109246/301000
 PROJECT NO.: STBG-0054-1(0611)
 COUNTY: LAWRENCE

Notice To Bidders No. 5589 Cont'd

W.P. No. 1
 D.P. No. 1
 SHEET NO. 4

NOTE: W20-1 (48"X48") SHALL BE REQ'D ON ALL LOCAL ROADS.

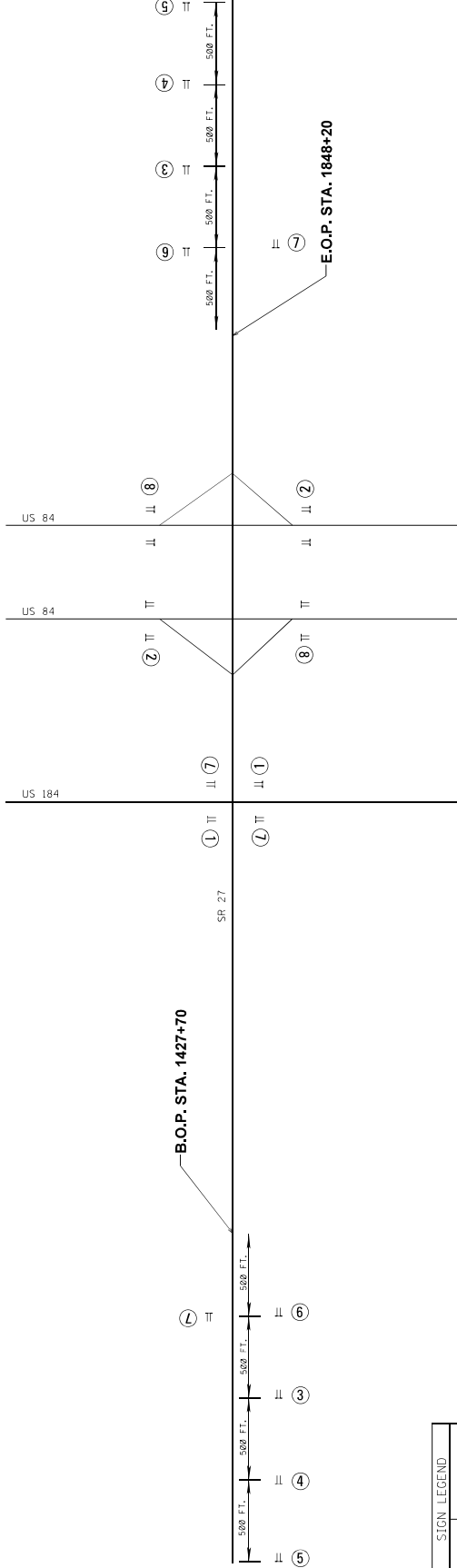

*** NOT TO SCALE ***

SIGN LEGEND	
①	W20-1 (48" X 48") 500 FT. ANCHOR TYPE III BARRIQUADE (SINGLE FACED)
②	W20-1 (48" X 48") 500 FT. ANCHOR TYPE III BARRIQUADE (DOUBLE FACED)
③	W20-1 (48" X 48") 500 FT. ANCHOR TYPE III BARRIQUADE (SINGLE FACED)
④	W20-1 (48" X 48") 1000 FT. ANCHOR TYPE III BARRIQUADE (SINGLE FACED)
⑤	W20-1 (48" X 48") 1500 FT. ANCHOR TYPE III BARRIQUADE (SINGLE FACED)
⑥	W20-1 (48" X 48") 1500 FT. ANCHOR TYPE III BARRIQUADE (SINGLE FACED)
⑦	W20-1 (48" X 48") 1500 FT. ANCHOR TYPE III BARRIQUADE (SINGLE FACED)
⑧	W20-1 (48" X 48") 1500 FT. ANCHOR TYPE III BARRIQUADE (SINGLE FACED)

ADDITIONAL TRAFFIC CONTROL SIGNS REQUIRED:

R4-1 "DO NOT PASS", R4-2 "PASS WITH CARE", AND W14-3 "NO PASSING ZONE" SIGNS ARE REQUIRED IN ACCORDANCE WITH SUB-SECTION 907-618 AND AS SPECIFIED IN THE MANUAL ON UNIFORM TRAFFIC CONTROL DEVICES. IF "NO PASSING ZONES" ARE 1,000' OR MORE, INSTALL ADDITIONAL "DO NOT PASS" & "NO PASSING ZONE" SIGNS ON MAXIMUM SPACING OF 750'.

ALL TRAFFIC CONTROL ITEMS SHALL BE INCLUDED IN BID FOR PAY ITEM 618-A001, MAINTENANCE OF TRAFFIC. ALL PREVIOUS STRANGES SHALL BE USED ON ALL COMING FROM AND TRAFFIC CONTROL SIGNS EXCEPT FOR THOSE DESIGNATED ON THE PLANS TO BE BLACK LEGEND AND BORDER ON WHITE BACKGROUND.



MISSISSIPPI DEPARTMENT OF TRANSPORTATION
MDOT

DESIGNED BY:	
DETAILED BY:	
CHECKED BY:	
DATE:	

FMS CON: 109246/301000
PROJECT NO.: STBG-0054-01(61)
COUNTY: LAWRENCE

Notice To Bidders No. 5589 - Concrete

WKS NO.:	
DISTRICT:	
SHEET NO.:	5

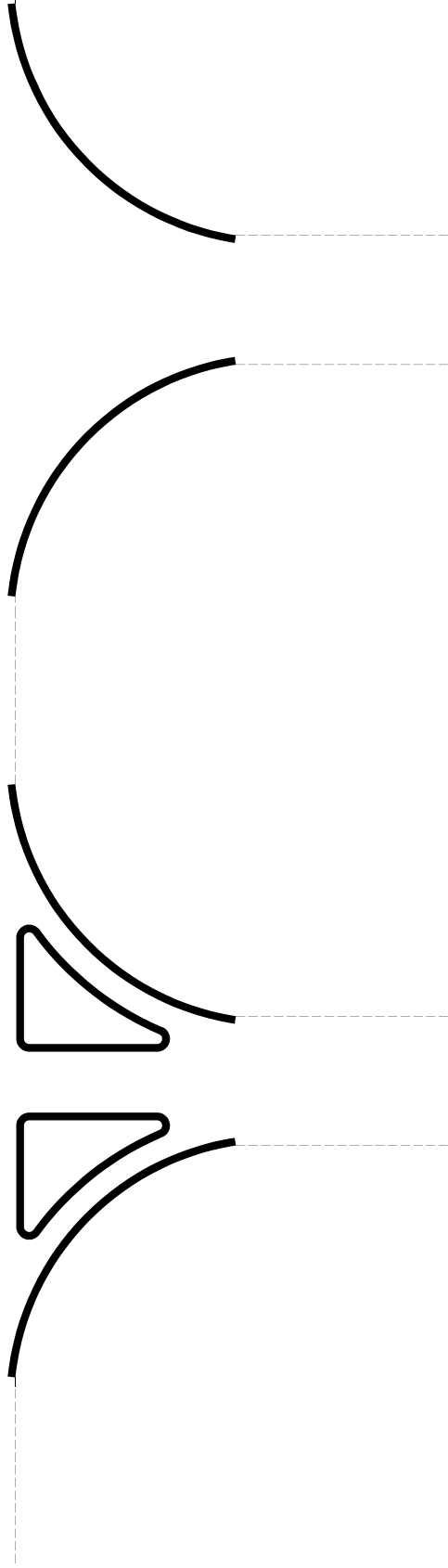

** ALL ASPHALT AND CONCRETE CURBS ALONG RAMP, LOCAL ROADS, ETC. FROM B.O.P. TO E.O.P. SHALL BE PAINTED (TWO APPLICATIONS) WITH WHITE TRAFFIC PAINT AND TRAFFIC BEADS; COST TO BE ABSORBED IN OTHER PAY ITEMS.



DESIGNED BY: _____
 DETAILED BY: _____
 CHECKED BY: _____
 DATE: _____

FMS CON: 109246/301000
 PROJECT NO.: STBG-0054-1(01)
 COUNTY: LAWRENCE

10 - Notice To Bidders No. 5589 - Cont'd

WV NO. _____
 SD SEP-1
 SHEET NO. 6

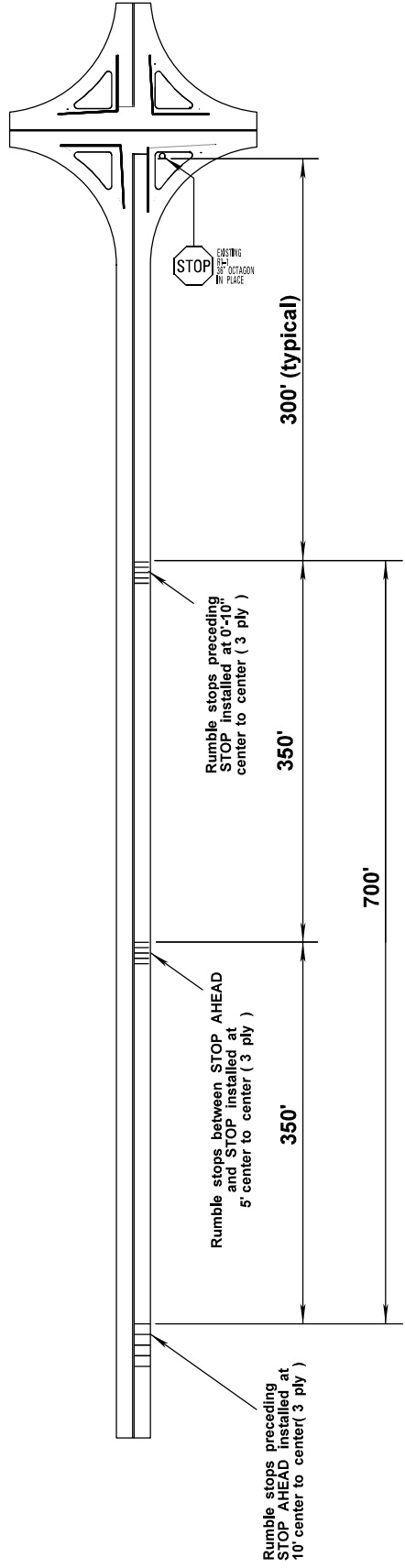

- NOTES:**
 Install rumble stop bars as shown :
1. 1 set of rumble stops approx. 250' from STOP AHEAD
 2. 1 set of rumble stops approx. 300' from STOP
 3. 1 set of rumble stops approx. Halfway between first and last set
 4. Rumble stops to be 6" thermoplastic (120 mil/each ply, 360 mil total)
 5. 5 rumble stops per set minimum
 6. Installation may vary due to terrain
 7. Signs should be 48" for channelized intersection, 36" for non-channelized intersection



MISSISSIPPI DEPARTMENT OF TRANSPORTATION

DESIGNED BY: _____
 CHECKED BY: _____
 DATE: _____

FMS CON: 109246/301000
 PROJECT NO.: STBG-0054-001 (11)
 COUNTY: LAWRENCE

DETAIL OF STRIPING
 NON-CHANNELIZED INTERSECTIONS
 Z-LANE HIGHWAY

WV NO. _____
 PAVED _____
 SHEET NO. 7

PAVEMENT MARKING			
SYMBOL	DESCRIPTION	TYPE	QUANTITY
①	TWO-WAY YELLOW REFLC. RAISED MARKER	FACH	
②	6" DETAIL SKIP WHITE (2'-12")	PLASTIC	
③	6" DETAIL STRIPE WHITE (SOLID)	PLASTIC	
④	6" DETAIL STRIPE WHITE (STOP BARY)	PLASTIC	
⑤	24" THERMO LEGEND WHITE (STOP BARY)	PLASTIC	
⑥	6" CONTINUOUS EDGE WHITE (SOLID)	PLASTIC	
⑦	6" TRAFFIC SKIP YELLOW (10'-30')	PLASTIC	

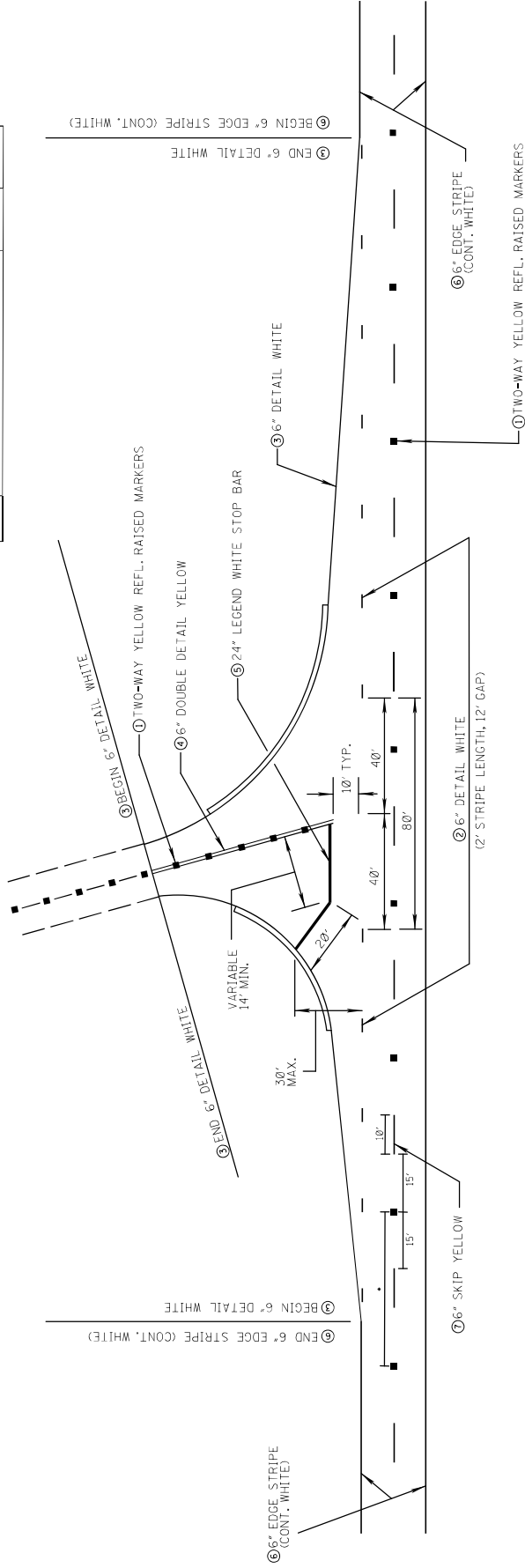

GENERAL NOTES:
 • SPACING OF REFLECTIVE RAISED PAVEMENT MARKERS IS AS FOLLOWS:

TANGENT SECTIONS	URBAN AREA CFT - IN	RURAL AREA CFT - IN
HORIZONTAL CURVES	40' - 0"	80' - 0"
INTERCHANGE LIMITS	40' - 0"	40' - 0"



MISSISSIPPI DEPARTMENT OF TRANSPORTATION
MDOT

DESIGNED BY:
 CHECKED BY:
 DATE:

FMS CON: 109246/301000
 PROJECT NO.: STBG-0054-2(11)
 COUNTY: LAWRENCE

12 - Notice To Bidders
 CHANNELS IN STRIPES
 Z-LANE HIGHWAY
 DETAIL OF STRIPING

WK NO. 9
 PIMS
 SHEET NO. 8

PAVEMENT MARKING			
SYMBOL	DESCRIPTION	UNIT	QUANTITY
(1)	TWO-WAY - CLEAR REFL. RAISED MARKERS	EACH	
(2)	RED-CLEAR REFLECTIVE RAISED MARKERS	EACH	
(3)	TWO-WAY YELLOW REFLECTIVE RAISED MARKERS	EACH	
(4)	6" TRAFFIC SKIP WHITE (10"-38")	PLASTIC	
(5)	6" CONTINUOUS EDGE WHITE (SOLID)	PLASTIC	
(6)	6" CONTINUOUS EDGE YELLOW (SOLID)	PLASTIC	
(7)	6" CONTINUOUS TRAFFIC WHITE (SOLID)	PLASTIC	
(8)	6" DETAIL STRIPE WHITE (SOLID)	M/A	
(9)	6" DETAIL STRIPE WHITE (12"-12")	PLASTIC	
(10)	6" DETAIL STRIPE WHITE (SOLID)	PLASTIC	
(11)	6" TRAFFIC SKIP WHITE (12"-12")	PLASTIC	
(12)	24" THERMO LEGEND WHITE (STOP BAR)	PLASTIC	
(13)	24" THERMO LEGEND WHITE (YIELD BAR)	PLASTIC	
(14)	24" THERMO LEGEND WHITE (YIELD BAR)	PLASTIC	

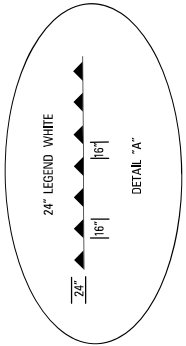
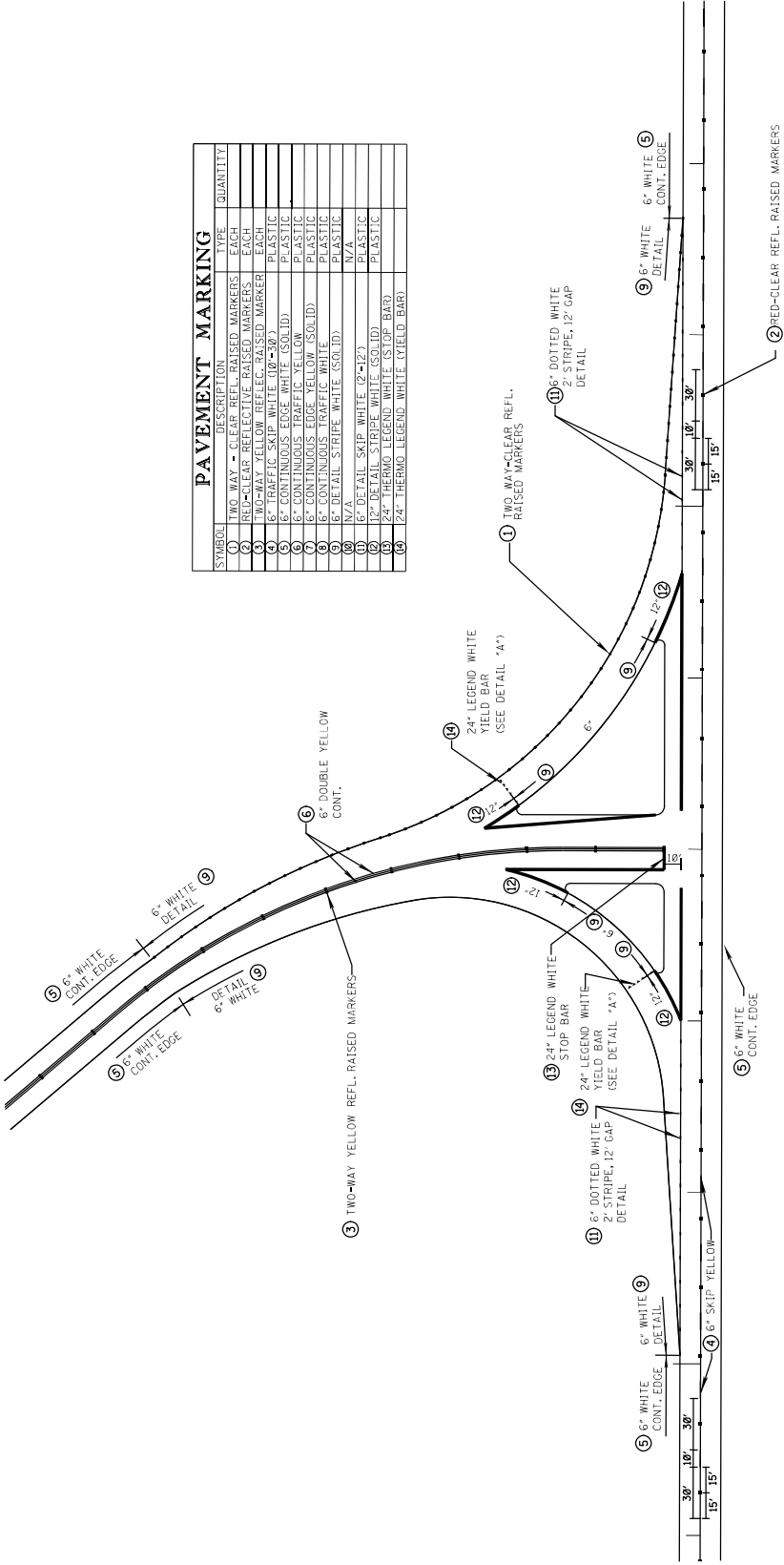



MISSISSIPPI DEPARTMENT OF TRANSPORTATION

DESIGNED BY:	
DETAILED BY:	
CHECKED BY:	
DATE:	

FMS CON: 109246/301000
PROJECT NO.: STBG-0054-001
COUNTY: LAWRENCE

13 - Notice To Bidder No. 5589 - Cont'd

WKS. NO. PAID	
SHEET NO.	9

- GENERAL NOTES**
- GROUND-IN RUMBLE STRIPES SHALL BE APPLIED ON LEFT AND RIGHT SHOULDERS OF ALL PAVED SHOULDERS ON THIS PROJECT
 - GROUND-IN RUMBLE STRIPES SHALL BE OMITTED ACROSS PRINCIPAL INTERSECTING ROADWAYS OR OTHER INTERRUPTIONS IN NORMAL SHOULDER WIDTH AS DIRECTED BY THE ENGINEER
 - COST TO BE PAID FOR USING APPROPRIATE PAY ITEMS
 - GROUND-IN RUMBLE STRIPES SHALL BE APPLIED TO MAINLINE ONLY

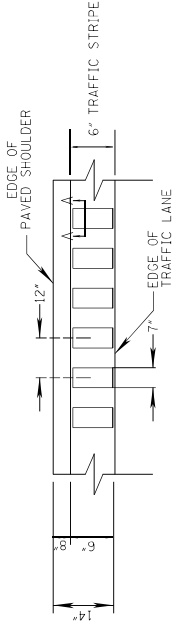

DETAIL "A"
12' PAVEMENT EDGE

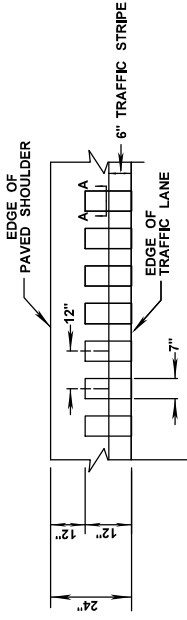

DETAIL "B"
14' PAVEMENT EDGE

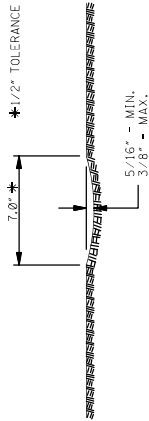

SECTION "A-A"

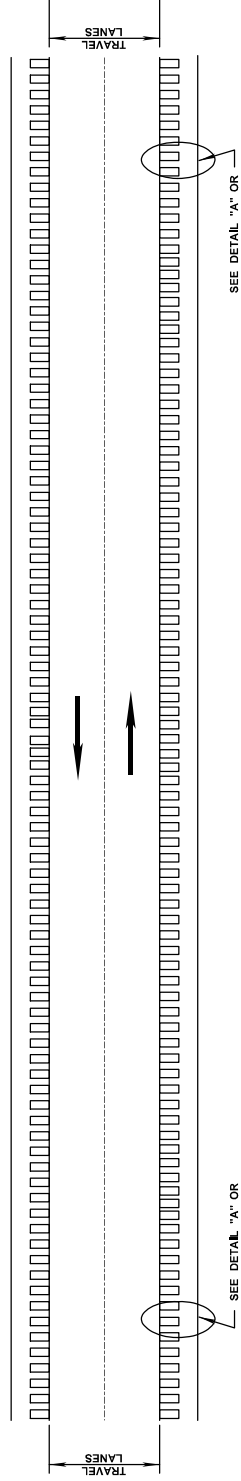

PLAN

NOT TO SCALE



MDOT
MISSISSIPPI DEPARTMENT OF TRANSPORTATION

DESIGNED BY:
CHECKED BY:
DATE:

FMS CON: 109246/301000
PROJECT NO.: STBG-0054-01(01)
COUNTY: LAWRENCE

GUARDRAIL TYPICAL INSTALLATION
AT BRIDGE APPROACHES
2-LANE, 2-WAY HIGHWAY

WORK NO.
GR-4-1110D
SHEET NO. 10

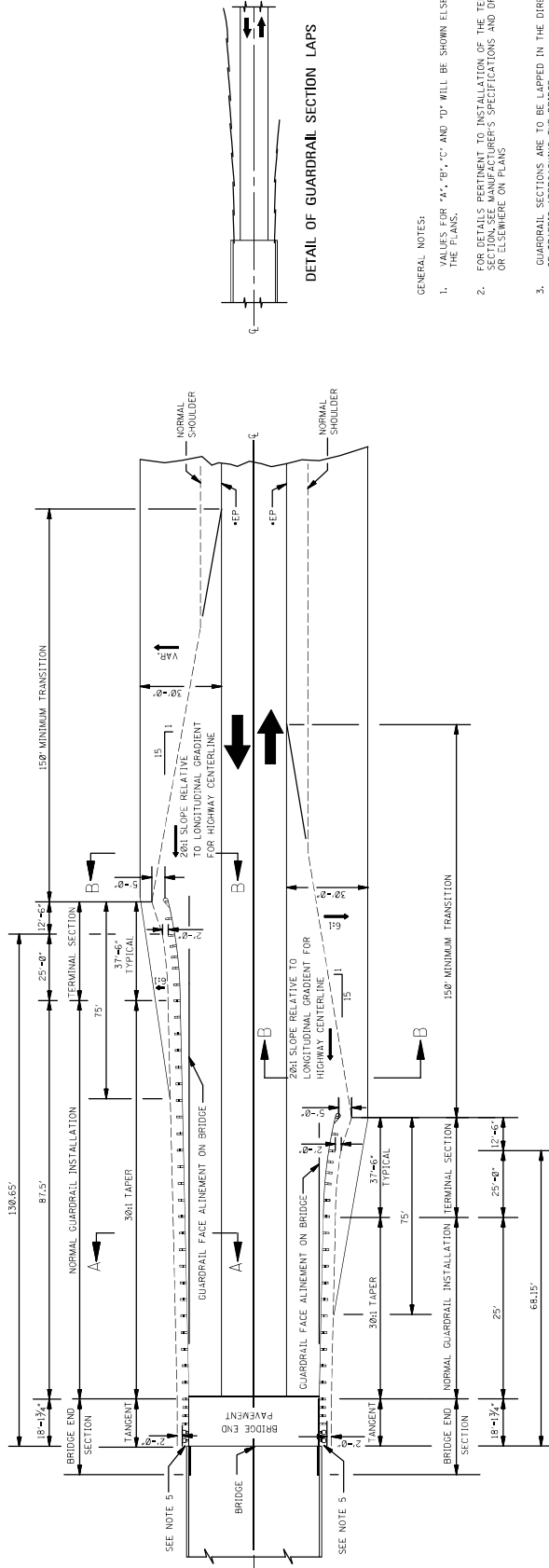

PLAN

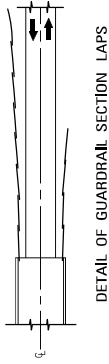

DETAIL OF GUARDRAIL SECTION LAPS

GENERAL NOTES:

- VALUES FOR "A", "B", "C" AND "D" WILL BE SHOWN ELSEWHERE ON THE PLANS.
- FOR DETAILS PERTAINING TO INSTALLATION OF THE TERMINAL SECTION, SEE MANUFACTURER'S SPECIFICATIONS AND DRAWINGS OR ELSEWHERE ON PLANS.
- GUARDRAIL SECTIONS ARE TO BE LAPPED IN THE DIRECTION OF TRAFFIC APPROACHING THE BRIDGE.
- THE OVERALL LENGTH OF GUARDRAIL IS MEASURED FROM THE CONNECTING END ON THE BRIDGE.
- THE SHOULDER WIDTH AT THE BRIDGE END SHALL BE SUFFICIENTLY WIDE TO PROVIDE A MINIMUM OF 2'-0" BEHIND THE BACK OF POST BEFORE THE SLOPE BREAK (HINGEPOINT).
- TYPE, DETAILS AND LIMITS OF GUARDRAIL BRIDGE END SECTION WILL BE SHOWN ELSEWHERE ON THE PLANS.

- 3.0' & VAR. REMOVAL OF ASPHALT PAVED SHOULDERS REQ'D.
- 6.0" CRUSHED LIMESTONE REQ'D.
- 3.0' & VAR. EXCESS EXCAVATION REQ'D.

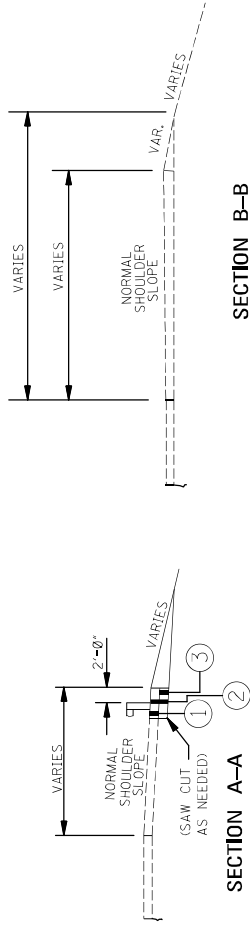

SECTION A-A

SECTION B-B



DESIGNED BY: _____
 CHECKED BY: _____
 DATE: _____

FMS CON: 109246/301000
 PROJECT NO.: STBG-0054-1(01)
 COUNTY: LAWRENCE

TRAFFIC CONTROL PLAN
 WITH FLAGGER STATIONS
 (FOR USE OF TWO-WAY TRAFFIC)

WK. NO. SDTOP-1
 SHEET NO. 11

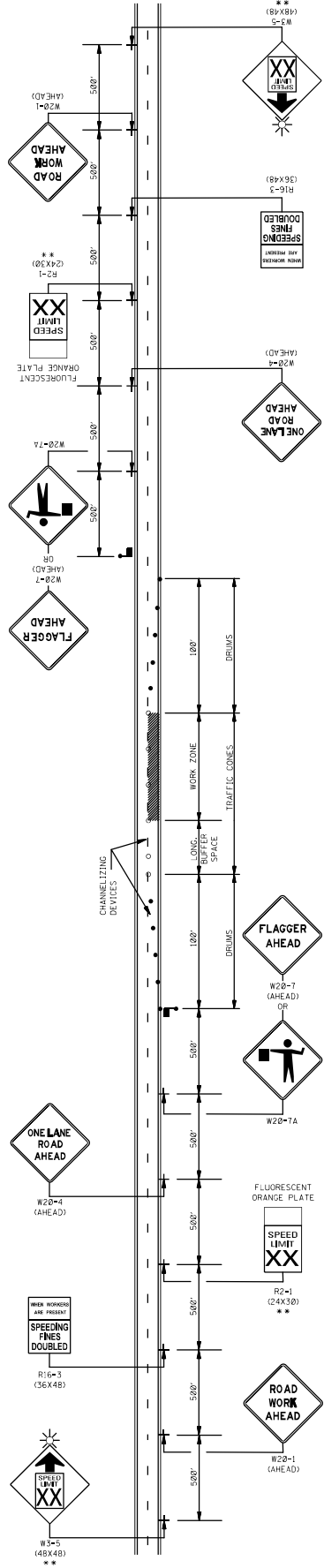

- GENERAL NOTES:
1. THE LOCATION OF CHANNELIZING DEVICES AND THE WORK AREA SHALL BE SHOWN ON THE ENGINEER'S PLAN. THE FOLLOWING TABLE, FLAGGER STATIONS SHALL BE LOGGED SUCH THAT APPROACHING VEHICLES WILL HAVE SUFFICIENT DISTANCE TO STOP. THE DISTANCE BETWEEN DEVICES IN THE COLUMN MAY BE USED AS A MINIMUM FOR THIS DISTANCE.
 2. ALL CHANNELIZING DEVICES SHALL BE A MINIMUM OF 28" IN HEIGHT.
 3. DIAMOND SHAPED TRAFFIC CONTROL SIGNS SHALL BE A MINIMUM OF 35" X 36" AND BE LOCATED ON FLUORESCENT ORANGE SHEETING.
 4. WHEN WORK ZONE IS NO LONGER NEEDED, ALL SIGNS SHALL BE COVERED AND ALL CHANNELIZING DEVICES SHALL BE MOVED TO THE SHOULDER EDGE.
 5. ADDITIONAL FLAGGERS MAY BE NEEDED AS DIRECTED BY THE ENGINEER.
 6. WHEN WORK IS REQUIRED AT NIGHT, FLAGGER STATIONS SHALL BE ILLUMINATED.
 7. CHANNELIZING DEVICE TYPES FOR:
 - A. APPROACH AND EXIT TAPERS* RETROREFLECTIVE PLASTIC DRUMS
 - B. ALONG LANE LINE AND WORK ZONE* TRAFFIC CONES (28" HEIGHT)
 8. ALL TRAFFIC CONTROL ITEMS SHOWN ON THIS SHEET WILL NOT BE MEASURED FOR SEPARATE PAYMENT. THIS WORK SHALL BE INCLUDED IN THE PRICE BID FOR MAINTENANCE OF TRAFFIC.

POSTED SPEED DESIGN SPEED	MAXIMUM CHANNELIZING DEVICE SPACING (ft)	LONGITUDINAL BUFFER SPACE (ft)	STOPPING DISTANCE		
			URBAN	RURAL	FREEWAY
25	20	50	155	155	155
30	20	60	185	185	185
35	20	70	220	220	220
40	20	80	260	260	260
45	20	90	305	305	305
50	20	100	355	355	355
55	20	110	405	405	405
60	20	120	455	455	455
65	20	130	505	505	505

* NOTE: BUFFER SPACE MAY BE ADJUSTED AS NEEDED ACCORDING TO TRAFFIC VOLUME AND SIGHT DISTANCE REQUIREMENTS. AS DIRECTED BY THE ENGINEER.

ROAD TYPE	DISTANCE BETWEEN SIGNS		
	A	B	C
URBAN (25 MPH OR LESS)	100 FT.	100 FT.	100 FT.
URBAN (30 - 40 MPH)	150 FT.	150 FT.	150 FT.
RURAL	200 FT.	200 FT.	200 FT.
EXPRESSWAY / FREEWAY	300 FT.	300 FT.	2640 FT.

LEGEND

- FLAGGER
- RETROREFLECTIVE FREE-STANDING PLASTIC DRUMS
- TRAFFIC CONES (28" HEIGHT MINIMUM)
- SPEED LIMIT SIGNS SHALL BE UNLESS OTHERWISE DIRECTED BY COMMISSION ORDER.



DESIGNED BY: _____
 CHECKED BY: _____
 DATE: _____

FMS CON: 109246/301000
 PROJECT NO.: STBG-0054-16
 COUNTY: LAWRENCE

TRAFFIC CONTROL DETAILS
 DRUM AND BARRICADE
 SHOULDER CLOSURE
 Notice To Bid # 16-0000000000

WV NO. SDT09-16
 SHEET NO. 12

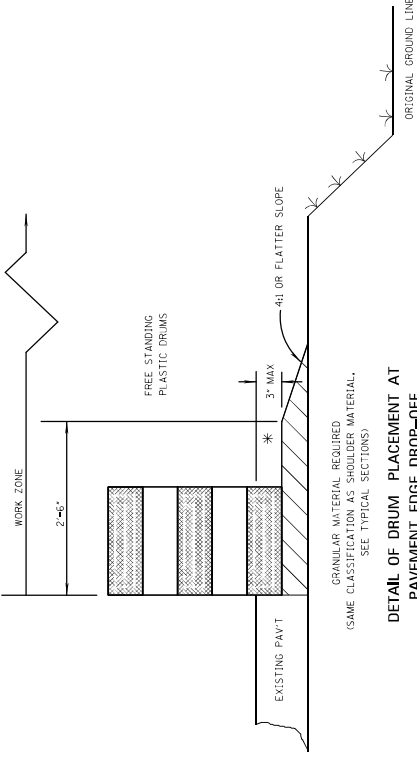

DETAIL OF DRUM PLACEMENT AT PAVEMENT EDGE DROP-OFF

NOTES:

* A. PAVEMENT EDGE DROP-OFF

- IF LESS THAN TWO AND ONE QUARTER (2.25) INCHES-NO PROTECTION REQUIRED. PLACE A SHOULDER WORK SIGN (W2-5) 500 FEET IN ADVANCE OF WORK ZONE SHOULDER AND A LOW SHOULDER SIGN (W8-6) AT THE BEGINNING AND THROUGHOUT THE WORK ZONE @ (1 MILE ±0.C.).
- TWO AND ONE QUARTER TO THREE INCHES-PLACE DRUMS, VERTICAL PANELS OR BARRICADES EVERY 100 FEET ON TANGENT SECTIONS FOR SPEEDS OF 50 MILES PER HOUR OR GREATER. CONES MAY BE USED IN PLACE OF DRUMS, PANELS, AND BARRICADES DURING DAYLIGHT HOURS. FOR TANGENT SECTIONS WITH SPEEDS LESS THAN 50 MILES PER HOUR AND FOR CURVES, DEVICES SHOULD BE PLACED EVERY 50 FEET. SPACING FOR TAPERS SHOULD BE IN ACCORDANCE WITH THE MUTCD. (1 / 3 L, WHERE L IS THE TAPER LENGTH IN FEET.)
- GREATER THAN THREE (3) INCHES-POSITIVE SEPARATION OR WEDGE WITH 4:1 OR FLATTER SLOPE NEEDED. IF THERE IS EIGHT (8) FEET OR MORE DISTANCE BETWEEN THE EDGE OF TRAVEL LANE AND DROP-OFF, THEN DRUMS, PANELS OR BARRICADES MAY BE USED.
- FOR TEMPORARY CONDITIONS, DROP-OFFS GREATER THAN THREE (3) INCHES MAY BE PROTECTED WITH DRUMS, VERTICAL PANELS OR BARRICADES FOR SHORT DISTANCES DURING DAYLIGHT HOURS WHILE WORK IS BEING DONE IN THE DROP-OFF AREA.
- LESSER TREATMENTS THAN THOSE DESCRIBED ABOVE MAY BE CONSIDERED FOR LOW-VOLUME LOCAL STREETS.

B. DRUM SPACING

- TANGENTS = $2 \times S$
- TAPERS = $L / 3$
- WHERE L = S X W
- L = TAPER LENGTH IN FEET
- S = SPEED IN MPH (POSTED OR 85 PERCENTILE)
- W = WIDTH OF OFFSET IN FEET

C. ALL TRAFFIC CONTROL ITEMS SHOWN ON THIS SHEET SHALL BE PAID FOR UNDER MAINTENANCE OF TRAFFIC.

TABLE V1-1. GUIDELINES FOR LENGTH OF LONGITUDINAL BUFFER SPACE

* SPEED (MPH)	LENGTH (FEET)
20	25
25	30
30	35
35	40
40	45
45	50
50	55
55	60
60	65
65	70
70	75
75	80
80	85
85	90
90	95
95	100
100	105
105	110
110	115
115	120
120	125
125	130
130	135
135	140
140	145
145	150
150	155
155	160
160	165
165	170
170	175
175	180
180	185
185	190
190	195
195	200
200	205
205	210
210	215
215	220
220	225
225	230
230	235
235	240
240	245
245	250
250	255
255	260
260	265
265	270
270	275
275	280
280	285
285	290
290	295
295	300
300	305
305	310
310	315
315	320
320	325
325	330
330	335
335	340
340	345
345	350
350	355
355	360
360	365
365	370
370	375
375	380
380	385
385	390
390	395
395	400
400	405
405	410
410	415
415	420
420	425
425	430
430	435
435	440
440	445
445	450
450	455
455	460
460	465
465	470
470	475
475	480
480	485
485	490
490	495
495	500

* * POSTED SPEED, OFF-PEAK 85 PERCENTILE SPEED OR 85 PERCENTILE SPEED DURING PEAK, OR THE ANTICIPATED OPERATING SPEED IN MPH.

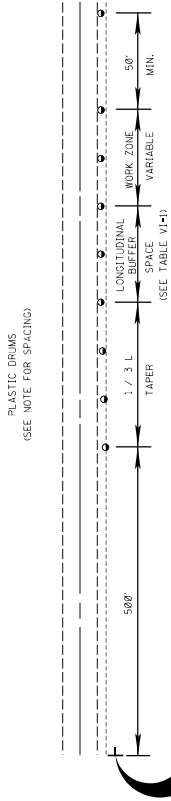

TYPICAL SHOULDER CLOSURE

- TO BE USED WITH EIGHT (8) FOOT OR GREATER WIDTH IMPROVED SHOULDER.
- TO BE USED WHEN CONSTRUCTION VEHICLES (EQUIPMENT) ENCRUSHES ON OR WITHIN TWO (2) FEET OF THE SHOULDER BREAK.

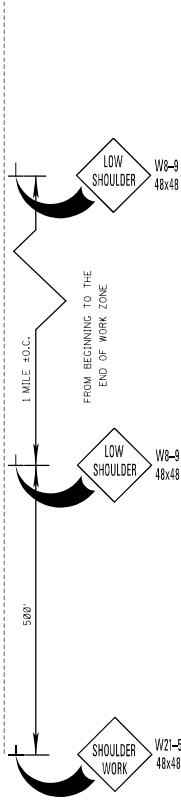

**TYPICAL SHOULDER WORK #1
 (SEE NOTE A-1 THIS SHEET)**

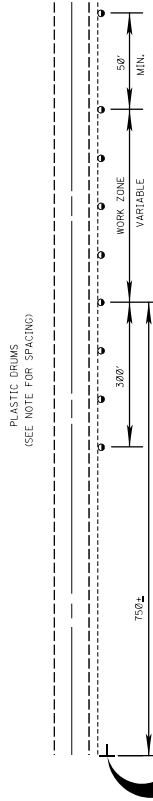

TYPICAL SHOULDER WORK #2

NOTE:
 WORK OUTSIDE TWO (2) FOOT AND WITHIN TEN (10) FEET OF THE SHOULDER BREAK MAY BE PROTECTED BY PLACING DRUMS ALONG THE SHOULDER EDGE, 300 FEET PRIOR TO AND 50 FEET BEYOND THE WORK AREA, OR SEE NOTE A-3 THIS SHEET.

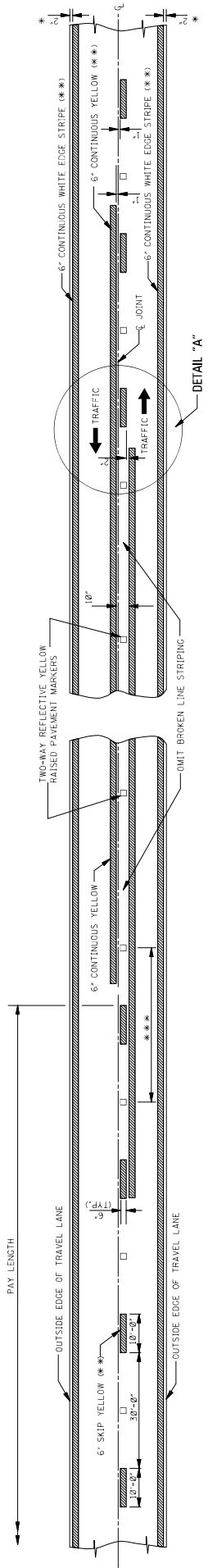

TWO-WAY TRAFFIC
(ASPHALT OR CONCRETE PAVEMENT)

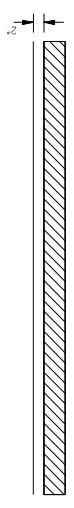

DIRECTION OF TRAFFIC

NOTE: THE CRITERIA FOR NO-PASSING ZONES CAN BE FOUND IN THE MOOT ROADWAY DESIGN MANUAL, SECTION 11-1.81.

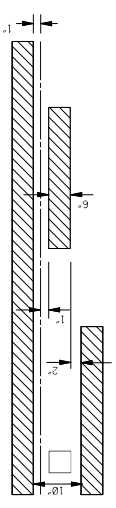

TRAFFIC

TRAFFIC

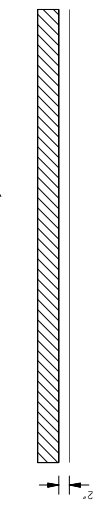

DETAIL "A"

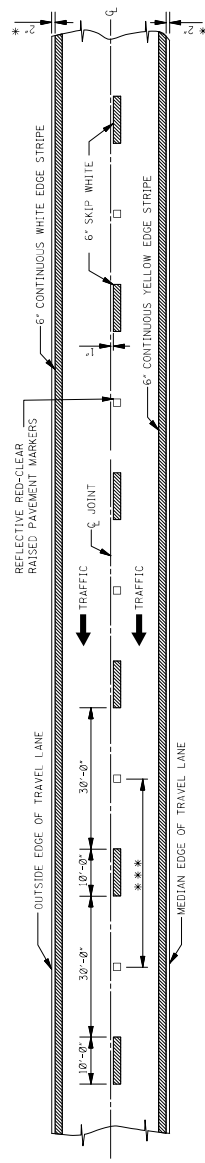

4-LANE WITH ONE-WAY TRAFFIC

GENERAL NOTES:

- * 1. 2" UNLESS SHOWN ELSEWHERE ON THE PLANS, FOR STRIPING ON RUMBLE STRIP SECTIONS REFER TO WK. SHEETS RS-1, RS-2, AND RS-3.
- ** 2. EDGE STRIPE SHALL BE SAME MATERIAL AS LANE-LINE STRIPE (PAINT OR PLASTIC AS INDICATED IN PAY ITEMS).
- *** 3. SPACING OF REFLECTIVE RAISED PAVEMENT MARKERS IS AS FOLLOWS:

TANGENT SECTIONS	RURAL AREA
40'-0"	40'-0"
80'-0"	80'-0"
40'-0"	40'-0"
INTERCHANGE LIMITS	40'-0"
	1-40'-0"

- 1. NOTE: ON THE MAIN FACILITY, REFLECTIVE RED-CLEAR RAISED PAVEMENT MARKERS ON A 40'-0" SPACING WILL BE REQUIRED THROUGHOUT THE INTERCHANGE AREAS BEGINNING 1000' FROM THE MAIN FACILITY AND ENDING 1000' FROM THE END OF THE ENTRANCE RAMP TAPER. TAPER AND CONTINUING THROUGH THE INTERCHANGE TO THE END OF THE ENTRANCE RAMP TAPER.
- 4. PAVEMENT MARKERS SHALL BE HIGH PERFORMANCE REFLECTIVE. RAISED PAVEMENT MARKERS AS LISTED IN THE MOOT *APPROVED SOURCES OF MATERIALS.*

MISSISSIPPI DEPARTMENT OF TRANSPORTATION
ROADWAY DESIGN DIVISION
STANDARD PLAN

**PAVEMENT MARKING
DETAILS FOR
2-LANE AND 4-LANE
DIVIDED ROADWAYS**

ISSUE DATE: AUGUST 01, 2017

PROJECT NUMBER: 5589
DRAWING NUMBER: 11-1.81
SHEET NUMBER: 11-1.81-1

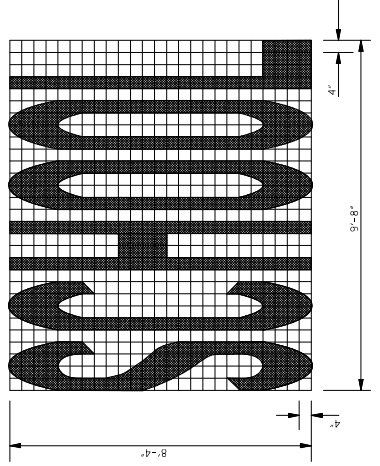
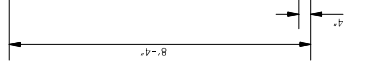
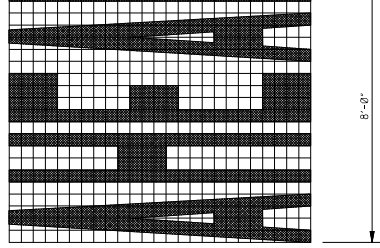
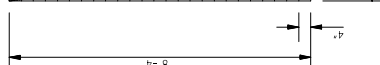
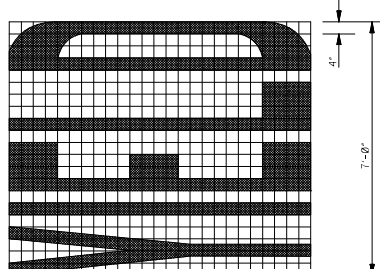
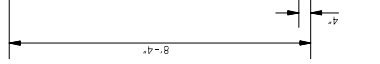
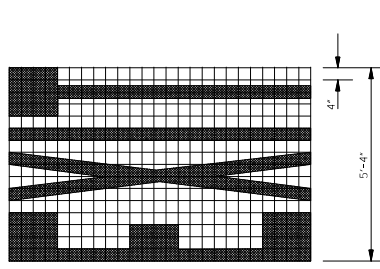
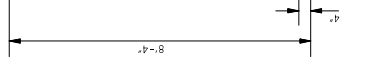
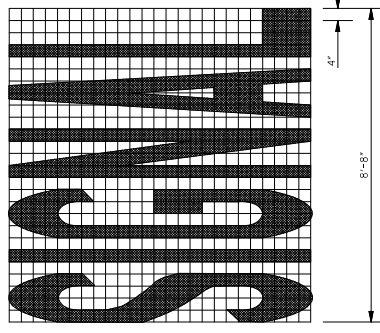
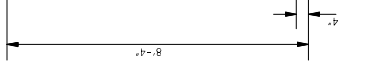
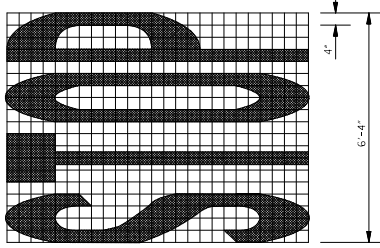
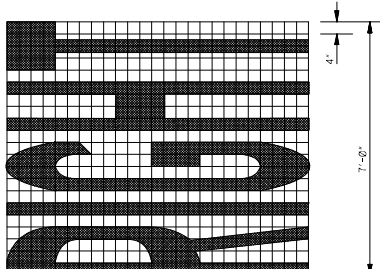
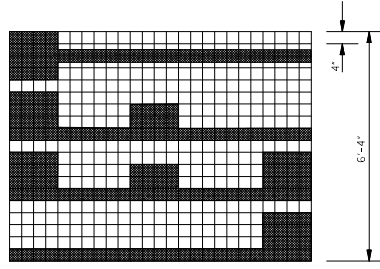
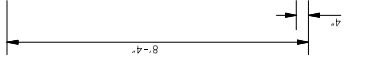
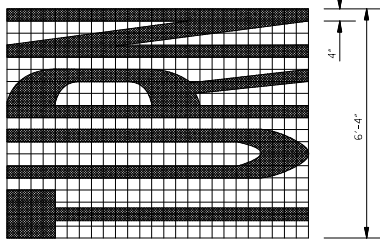
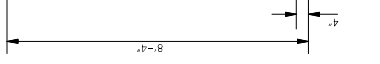
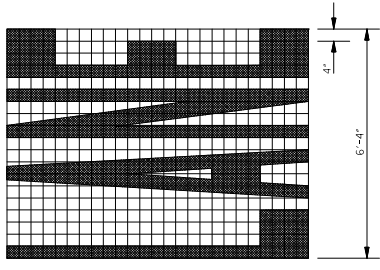

- GENERAL NOTES:
- TWO HORIZONTAL GAPS, CAUSED BY THE SPACING OF THE LETTERS, OR LESS, AND EXTENDING THE FULL WIDTH ARE PERMITTED IN EACH LETTER.
 - FOR OTHER DETAILS, SEE THE MANUAL ON UNIFORM TRAFFIC CONTROL DEVICES.
 - PAY QUANTITIES FOR PAVEMENT MARKING LEGENDS ARE AS FOLLOWS:

LEGEND	AREA (SF)
STOP	24.6
RIGHT	28.6
LEFT	31.3
TURN	27.3
LANE	22.7
AHEAD	32.3
YIELD	26.8
EXIT	18.5
SIGNAL	32.5
SCHOOL	35.5

MISSISSIPPI DEPARTMENT OF TRANSPORTATION
ROADWAY DESIGN DIVISION
STANDARD PLAN

**PAVEMENT MARKING
LEGEND DETAILS**

ISSUE DATE: AUGUST 01, 2017

PROJECT NUMBER: 6055

PLAN NUMBER: 6055

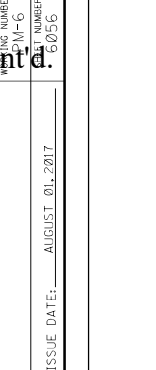
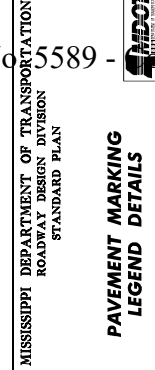
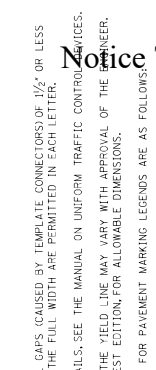
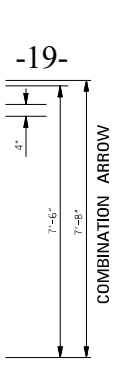
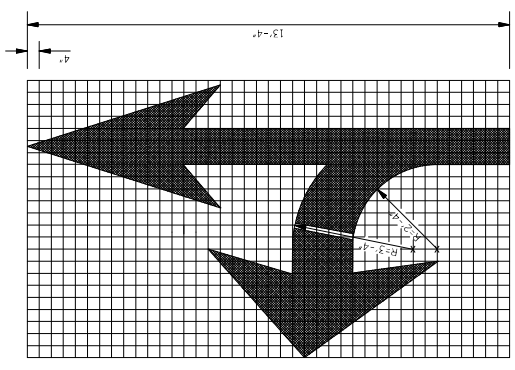

GENERAL NOTES:
1. TWO HORIZONTAL GAPS (CAUSED BY TEMPLATE CONNECTORS) OF 1/2" OR LESS AND EXTENDING THE FULL WIDTH ARE PERMITTED IN EACH LETTER.
2. FOR OTHER DETAILS, SEE THE MANUAL ON UNIFORM TRAFFIC CONTROL DEVICES.
3. DIMENSIONS OF THE YIELD LINE MAY VARY WITH APPROVAL OF THE ENGINEER. SEE MUTCD, LATEST EDITION, FOR ALLOWABLE DIMENSIONS.
4. PAY QUANTITIES FOR PAVEMENT MARKING LEGENDS ARE AS FOLLOWS:

LEGEND/SYMBOL	AREA (FT ²)
ONLY	22.0
TURN ARROW	16.4
THRU ARROW	12.3
COMB. ARROW	27.5
1-WAY ARROW	24.3
LANE-REDUCTION ARROW	40.0

Notice To Bidders No. 5589 -

MISSISSIPPI DEPARTMENT OF TRANSPORTATION
ROADWAY DESIGN DIVISION
STANDARD PLAN

PAVEMENT MARKING
LEGEND DETAILS

DATE	REVISION

ISSUE DATE: AUGUST 01, 2017

PROJECT NUMBER: 60556

PLAN NUMBER: 60556

DATE: AUGUST 01, 2017

PROJECT NUMBER: 60556

PLAN NUMBER: 60556

DATE: AUGUST 01, 2017

PROJECT NUMBER: 60556

PLAN NUMBER: 60556

DATE: AUGUST 01, 2017

PROJECT NUMBER: 60556

PLAN NUMBER: 60556

DATE: AUGUST 01, 2017

PROJECT NUMBER: 60556

PLAN NUMBER: 60556

DATE: AUGUST 01, 2017

PROJECT NUMBER: 60556

PLAN NUMBER: 60556

DATE: AUGUST 01, 2017

PROJECT NUMBER: 60556

PLAN NUMBER: 60556

DATE: AUGUST 01, 2017

PROJECT NUMBER: 60556

MISSISSIPPI DEPARTMENT OF TRANSPORTATION
ROADWAY DESIGN DIVISION
STANDARD PLAN

PAVEMENT MARKING
LEGEND DETAILS

ISSUE DATE: AUGUST 01, 2017

PROJECT NUMBER: 60556

PLAN NUMBER: 60556

DATE: AUGUST 01, 2017

PROJECT NUMBER: 60556

PLAN NUMBER: 60556

DATE: AUGUST 01, 2017

PROJECT NUMBER: 60556

PLAN NUMBER: 60556

DATE: AUGUST 01, 2017

PROJECT NUMBER: 60556

PLAN NUMBER: 60556

DATE: AUGUST 01, 2017

PROJECT NUMBER: 60556

PLAN NUMBER: 60556

DATE: AUGUST 01, 2017

PROJECT NUMBER: 60556

PLAN NUMBER: 60556

DATE: AUGUST 01, 2017

PROJECT NUMBER: 60556

PLAN NUMBER: 60556

DATE: AUGUST 01, 2017

PROJECT NUMBER: 60556

TYPICAL PLACEMENT OF RAISED PAVEMENT MARKERS ON SIDE ROAD RADIUS 2-LANE, TWO WAY TRAFFIC

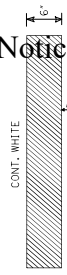
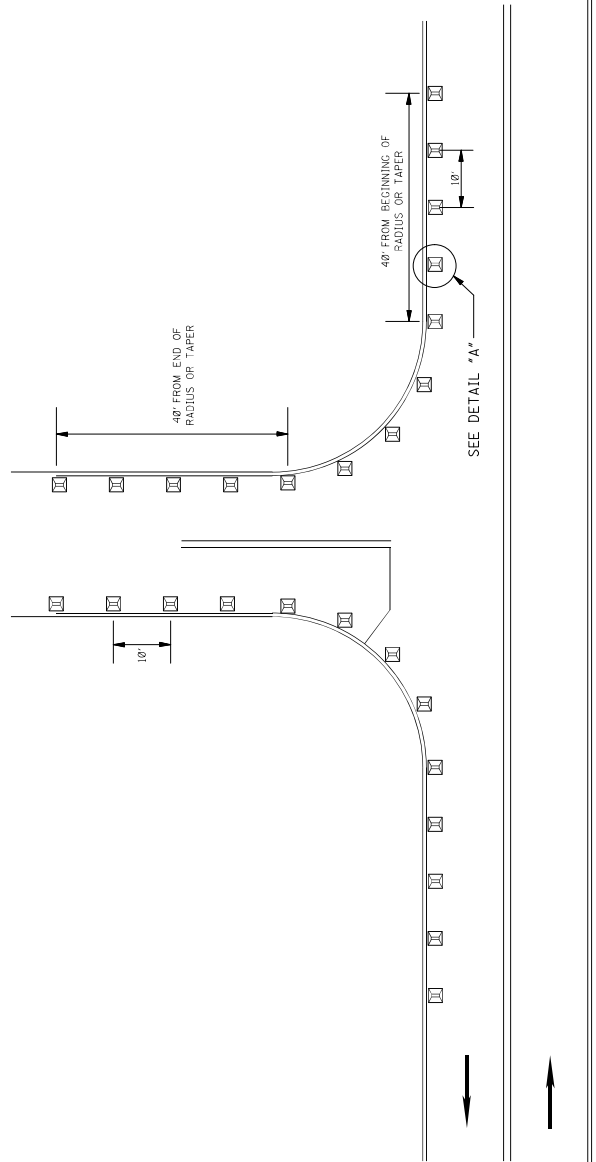

DETAIL A

GENERAL NOTES:

1. MARKERS SHALL BE VISIBLE FROM THE TRAVELING MOTORIST ON STATE DESIGNATED HIGHWAYS.
2. MARKERS SHALL BE HIGH PERFORMANCE TWO-WAY CLEAR.
3. MARKERS SHALL NOT BE ROTATED WHEN BEING PLACED ALONG RADIUS AND TANGENT SECTION OF LOCAL ROAD.
4. MARKERS SHALL BE INSTALLED AT SIMPLE AND CHANNELIZED INTERSECTIONS TO THE LIMITS SHOWN ABOVE.

MISSISSIPPI DEPARTMENT OF TRANSPORTATION
ROADWAY DESIGN DIVISION
STANDARD PLAN

2-WAY RAISED PAVEMENT MARKERS AT INTERSECTING ROADS (2-LANE)

DRAWING NUMBER: 2-W-11
REV. NUMBER: 6

DATE	REVISION

ISSUE DATE: AUGUST 01, 2017
SCALE NUMBER: 60(6)

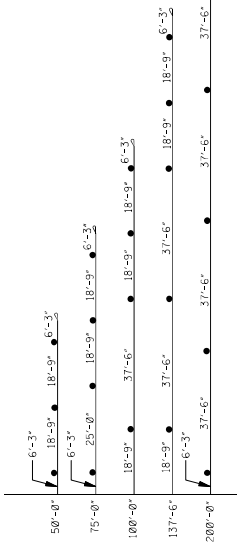

GRAPHIC SHOWING SPACINGS OF GUARDRAIL DELINEATORS AT SOME COMMONLY USED BRIDGE APPROACHES

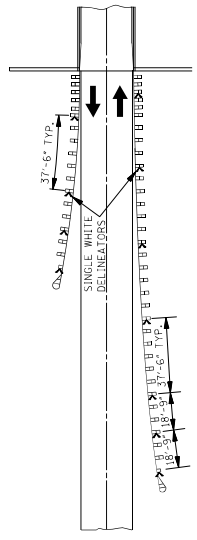

BRIDGE APPROACH INSTALLATION (TWO-WAY TRAFFIC)

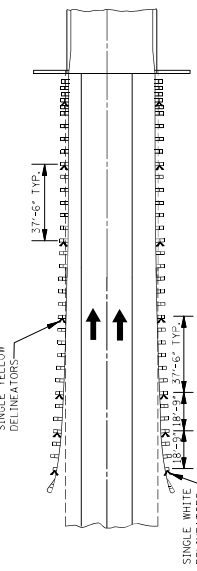

BRIDGE APPROACH INSTALLATION (ONE-WAY TRAFFIC)

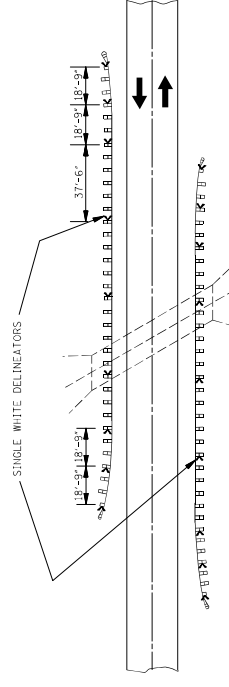

ROADSIDE OBSTACLE INSTALLATION—LENGTH 250' OR LESS (TWO-WAY TRAFFIC)

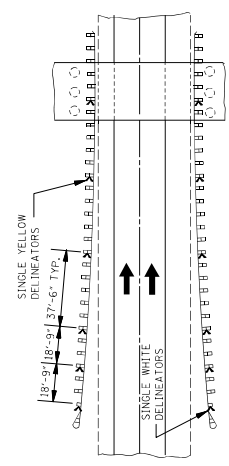

ROADSIDE OBSTACLE INSTALLATION—LENGTH 250' OR LESS (ONE-WAY TRAFFIC)

EMBANKMENT OR ROADSIDE OBSTACLE INSTALLATION—LENGTH GREATER THAN 250' (ONE-WAY TRAFFIC)

NOTE: ONE-WAY TRAFFIC SHOWN. DELINEATOR SPACING FOR TWO-WAY TRAFFIC SIMILAR. DELINEATOR COLOR WILL BE THE SAME AS THE ADJACENT PAVEMENT EDGE MARKING. THE FIRST THREE (3) MARKERS WILL FACE TRAFFIC IN OFF LANE FOR TWO-WAY TRAFFIC AS SHOWN IN DRAWING FOR OBSTACLE INSTALLATION FOR TWO-WAY TRAFFIC.

GENERAL NOTES:

1. THE UNIT PRICE OF DELINEATOR INCLUDES: COST(S) OF DELINEATOR FACE(S), POST, HARDWARE AND INSTALLATION.
2. DELINEATOR FACE WILL BE ENCAPSULATED LENS REFLECTIVE SHEETING.
3. DELINEATORS FOR GUARDRAIL SHALL BE MOUNTED ON FLEXIBLE POSTS AS FOLLOWS: THE DELINEATOR POSTS WILL BE FROM THE DEPARTMENT'S APPROVED SOURCE OF MATERIALS AND WILL BE FASTENED TO GUARDRAIL POST IN ACCORDANCE WITH THE MANUFACTURER'S RECOMMENDATION.

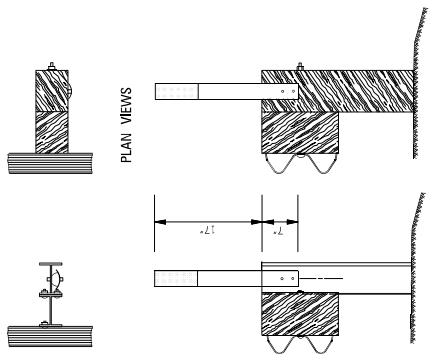

DETAIL OF FLEXIBLE GUARDRAIL DELINEATOR

TYPICAL FLEXIBLE POST DELINEATOR GUARDRAIL INSTALLATION

MISSISSIPPI DEPARTMENT OF TRANSPORTATION ROADWAY DESIGN DIVISION STANDARD PLAN	
BY	REVISION
DATE	ISSUE DATE: AUGUST 01, 2017
PROJECT NUMBER	6317
DRAWING NUMBER	SP-80
SHEET NUMBER	6

TYPICAL GUARDRAIL DELINEATION



**SHORT DURATION
CLOSING OF TWO-LANE
TWO-WAY HIGHWAYS**

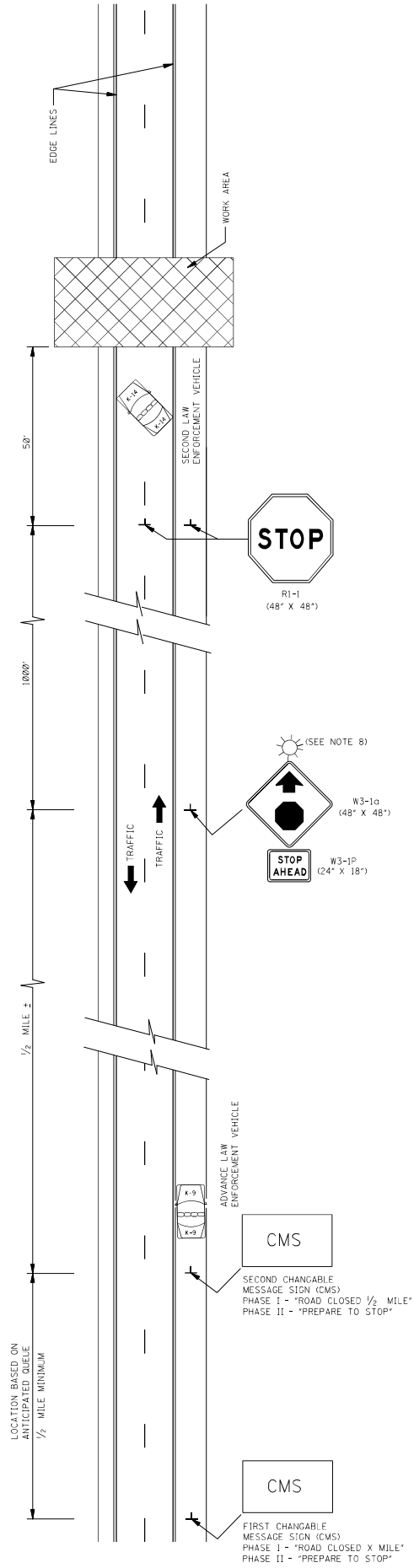

GENERAL NOTES:

- THIS TYPE OF HIGHWAY CLOSURE SHOULD ONLY BE USED FOR CONSTRUCTION OPERATIONS. THE CLOSURE SHOULD BE IN EFFECT FOR NOT EXCEED 30 MINUTES. AFTER THE HIGHWAY HAS BEEN CLOSED AND REOPENED VIA THE CLOSURE, ALL VEHICLES SHOULD ELIMINATE ANOTHER SHORT DURATION CLOSURE, EXCEPT WITH THE APPROVAL OF THE ENGINEER.
- AT LEAST TWO LAW ENFORCEMENT OFFICERS AND TWO LAW ENFORCEMENT VEHICLES SHOULD BE PROVIDED ON EACH APPROACH TO THE CLOSURE. EACH LAW ENFORCEMENT VEHICLE SHOULD HAVE A ROOF MOUNTED FLASHING BLUE LIGHT OR LIGHT BAR.
- RESTRICTIONS ON ROAD CLOSURES ARE SPECIFIED IN THE CONTRACT DOCUMENT.
- THE ADVANCE LAW ENFORCEMENT VEHICLE SHOULD BE MOVED BACK AS REQUIRED BY THE QUEUING OF STOPPED VEHICLES.
- IF QUEUE EXCEEDS THE FIRST CHANGABLE MESSAGE SIGN (CMS) AT ANY TIME DURING A CLOSURE, THE TRAFFIC CONTROL PLAN SHOULD BE ADJUSTED AS NECESSARY WITH APPROVAL OF THE ENGINEER.
- TRAFFIC CONTROL FOR THE CLOSURE SHOULD BE ACCOMPLISHED IN THE FOLLOWING ORDER:
 - FIRST CHANGABLE MESSAGE SIGN (CMS)
 - SECOND CHANGABLE MESSAGE SIGN (CMS)
 - ADVANCE LAW ENFORCEMENT VEHICLE, LIGHTS AND FLASHERS ON.
 - W3-1Q (48' X 48') AND W3-1P (24' X 18') SIGNS ERECTED.
 - R1-1 (48' X 48') SIGNS ERECTED TO STOP TRAFFIC. THE ORDER OF ERECTION SHOULD BE IN THE FOLLOWING ORDER: RIGHT SHOULDER THEN CENTER.
 - SECOND LAW ENFORCEMENT VEHICLE, LIGHTS AND FLASHERS ON.
- TRAFFIC STOPPED REMOVE THE "R1-1" SHOULDER IN THE FOLLOWING ORDER: CENTER THEN SIGN ON THE RIGHT SHOULDER. SECOND LAW ENFORCEMENT VEHICLE LEADS TRAFFIC THROUGH WORK AREA.
 - AFTER ALL STOPPED VEHICLES HAVE STARTED MOVING THE "W3-1Q (48' X 48') AND "W3-1P (24' X 18') SIGNS SHOULD BE REMOVED. THESE SIGNS MAY BE COVERED IF RE-USE IS IMMINENT.
 - AFTER ALL VEHICLES HAVE RESUMED APPROXIMATELY NORMAL SPEED, THE CHANGABLE MESSAGE SIGNS TURNED OFF.
- UNILLUMINATED SECTIONS OF HIGHWAYS SHOULD NOT BE CLOSED DURING HOURS OF DARKNESS EXCEPT FOR EMERGENCIES OR WITH THE APPROVAL OF THE ENGINEER. IF DARKNESS OCCURS DURING HOURS OF DARKNESS A TYPE B HIGH INTENSITY FLASHING BARRICADE WARNING LIGHT SHALL BE USED ON EACH W3-1Q SIGN.
- IF AN ENTRANCE RAMP IS LOCATED BETWEEN THE SECOND CMS AND R1-1, THE CMS, SIGNS SHOULD ALSO BE ERECTED ON THE RAMP SHOULDER.
- THE ABOVE DURATION WILL APPLY TO EACH APPROACH TO THE CLOSURE.
- ALL TRAFFIC CONTROL ITEMS SHOWN ON THIS SHEET WILL NOT BE MEASURED FOR SEPARATE PAYMENT. THIS WORK SHALL BE INCLUDED IN THE PRICE BID FOR MAINTENANCE OF TRAFFIC, INCLUDING SECURING LAW ENFORCEMENT SERVICES.

DATE	BY	REVISION

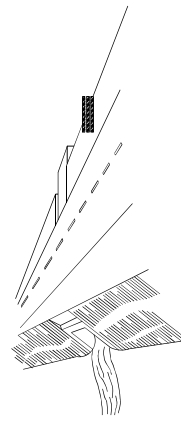

WING BARRICADES

- WING BARRICADES ARE TYPE III BARRICADES ERECTED ON THE SHOULDER ON ONE OR BOTH SIDES OF THE PAVEMENT TO GIVE THE SENSATION OF A NARROWING OR RESTRICTED ROADWAY. WING BARRICADES MAY BE USED AS A MOUNTING FOR THE ADVANCE WARNING SIGNS OR FLASHERS.
 - IN ADVANCE OF A CONSTRUCTION PROJECT EVEN WHEN NO PART OF THE ROADWAY IS ACTUALLY CLOSED.
 - IN ADVANCE OF ALL BRIDGE OR CULVERT WIDENING OPERATIONS.

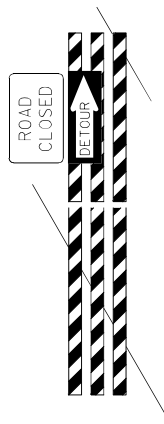
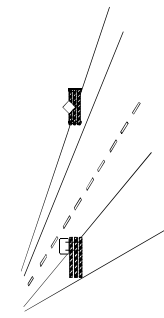

BARRICADE CLOSING A ROAD

BARRICADE CHARACTERISTICS

	I	II	III
WIDTH OF RAIL **	8" MIN. - 12" MAX.	8" MIN. - 12" MAX.	8" MIN. - 12" MAX.
LENGTH OF RAIL **	24" MIN.	24" MIN.	48" MIN.
WIDTH OF STRIPE *	6"	6"	6"
HEIGHT	36" MIN.	36" MIN.	60" MIN.
NUMBER OF VERTICALIZED RAIL FACES	2 (ONE EACH DIRECTION)	4 (TWO EACH DIRECTION)	3 IF FACING TRAFFIC IN ONE DIRECTION 6 IF FACING TRAFFIC IN TWO DIRECTIONS

- * 1. FOR RAILS LESS THAN 36" LONG, 4" WIDE STRIPES MAY BE USED.
- ** 2. BARRICADES INTENDED FOR USE ON EXPRESSWAYS, FREEWAYS AND OTHER HIGH SPEED ROADWAYS SHALL HAVE A MINIMUM OF 270 IN² OF REFLECTIVE AREA FACING TRAFFIC.

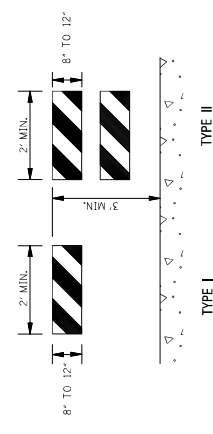

TYPE I

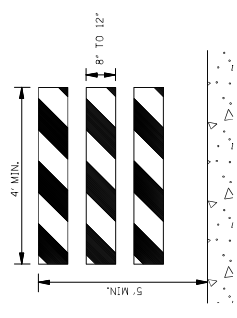

TYPE II

STANDARD BARRICADES

- THE MARKING FOR BARRICADE RAILS SHALL BE ORANGE AND WHITE (SLOPING DOWNWARD AT AN ANGLE OF 45° IN THE DIRECTION TRAFFIC IS TO PASS).
- RAIL STRIPE SHOULD BE 6 INCHES EXCEPT THAT 4-INCH WIDE STRIPES MAY BE USED IF RAIL LENGTHS ARE LESS THAN 36 INCHES.
- DO NOT PLACE SANDBAGS OR OTHER DEVICES TO PROVIDE MASS ON THE BOTTOM RAIL THAT WILL BLOCK VIEW OR RAIL FACE.
- FOR ADDITIONAL INFORMATION OR DETAILS: SEE MUTCD, LATEST EDITION.
- BARRICADES ARE CLASSIFIED BY FHWA AS CATEGORY II WORK ZONE DEVICES WHICH REQUIRE CRASHWORTHINESS ACCEPTANCE LETTERS. TO DATE, 2-IN. THICK, TIMBER RAILS HAVE NOT BEEN SUCCESSFULLY CRASH TESTED. A LIST OF CRASHWORTHY BARRICADES AND OTHER CATEGORY II DEVICES CAN BE FOUND ON FHWA'S WEBSITE: http://safety.fhwa.dot.gov/roadway_dept/policy/guide/road_hardware/cat2.cfm

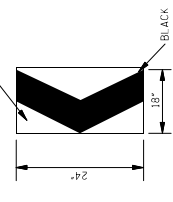

CHEVRON SIGN DETAIL

- A CHEVRON SIGN CONSISTS OF A BLACK CHEVRON TYPE MARKING ON AN ORANGE BACKGROUND AND SHALL POINT IN THE DIRECTION OF TRAFFIC FLOW.
- THE CHEVRON SIGN SHALL BE MOUNTED ON CRASHWORTHY SUPPORT.
- CHEVRON SIGNS MAY BE USED TO SUPPLEMENT OTHER STANDARD DEVICES WHERE ONE OR MORE LANES ARE CLOSED FOR CONSTRUCTION OR MAINTENANCE. THEY SHOULD BE PLACED APPROXIMATELY 2-8' BEHIND THE LANE TRANSITION STRIPE.

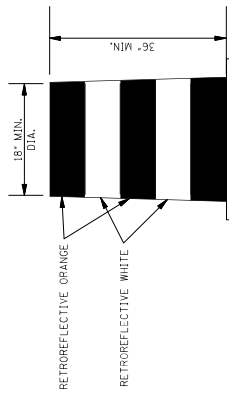

PLASTIC DRUM STRIPING DETAIL

- PLASTIC DRUMS SHALL BE ON END AND USED AS AN EXPEDITIOUS METHOD OF APPLYING STRIPING TO ROADWAYS. PLASTIC DRUMS SHALL BE USED IN CONFORMANCE WITH MARKING STANDARDS FOR BARRICADE. THE PREDOMINANT COLOR ON PLASTIC DRUMS SHALL BE ORANGE WITH FOUR (4) RETROREFLECTIVE, HORIZONTAL, CIRCUMFERENTIAL STRIPES (2 ORANGE & 2 WHITE) 6" WIDE.
- DRUMS SHOULD NEVER BE PLACED IN THE ROADWAY WITHOUT WARNING SIGNS.
- WHERE PRACTICAL PLASTIC DRUMS SHOULD BE PLACED NO CLOSER THAN 100' FROM THE EDGE OF TRAVELED LANE.

MISSISSIPPI DEPARTMENT OF TRANSPORTATION
ROADWAY DESIGN DIVISION
STANDARD PLAN

HIGHWAY SIGN AND BARRICADE DETAILS FOR CONSTRUCTION PROJECTS

ISSUE DATE: AUGUST 01, 2017

PROJECT NUMBER: 63358

PLAN NUMBER: CP-8

- GENERAL NOTES:
- UNEVEN LANE LINE:
 - A. IF EQUAL TO 1/4 MILE, NO SIGNS REQUIRED.
 - B. IF GREATER THAN 1/4 MILE AND LESS THAN OR EQUAL TO 3/4 MILE, PLACE SIGNS AS SHOWN ON THIS SHEET.
 - C. IF GREATER THAN 3/4 MILE AND LESS THAN OR EQUAL TO 1 MILE, TRAFFIC SHOULD NOT BE ALLOWED TO CROSS UNEVEN LANE LINE.
 - D. IF GREATER THAN 1 MILE, TRAFFIC SHOULD NOT BE ALLOWED TO CROSS UNEVEN LANE LINE.
 - THE WB-11 SIGNS SHOULD BE SPACED AT 1/4-MILE INTERVALS THROUGHOUT UNEVEN LANE LINE LIMITS.
 - ALL TRAFFIC CONTROL ITEMS SHOWN ON THIS SHEET SHALL BE PAID FOR UNDER MAINTENANCE OF TRAFFIC.

MISSISSIPPI DEPARTMENT OF TRANSPORTATION
ROADWAY DESIGN DIVISION
STANDARD PLAN

**TRAFFIC CONTROL PLANS
UNEVEN PAVEMENT
DETAILS**

PLANTING NUMBER: CP-12
SHEET NUMBER: 6362
ISSUE DATE: AUGUST 01, 2017

DATE	REVISION

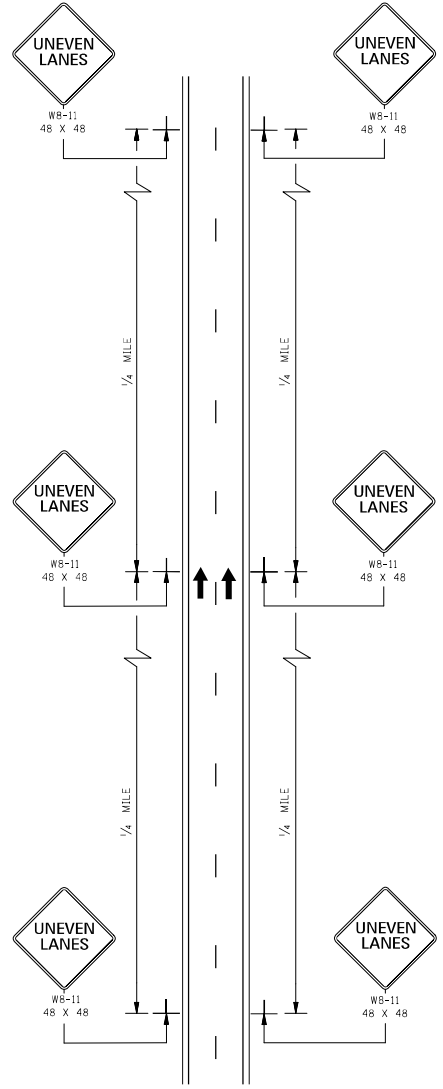
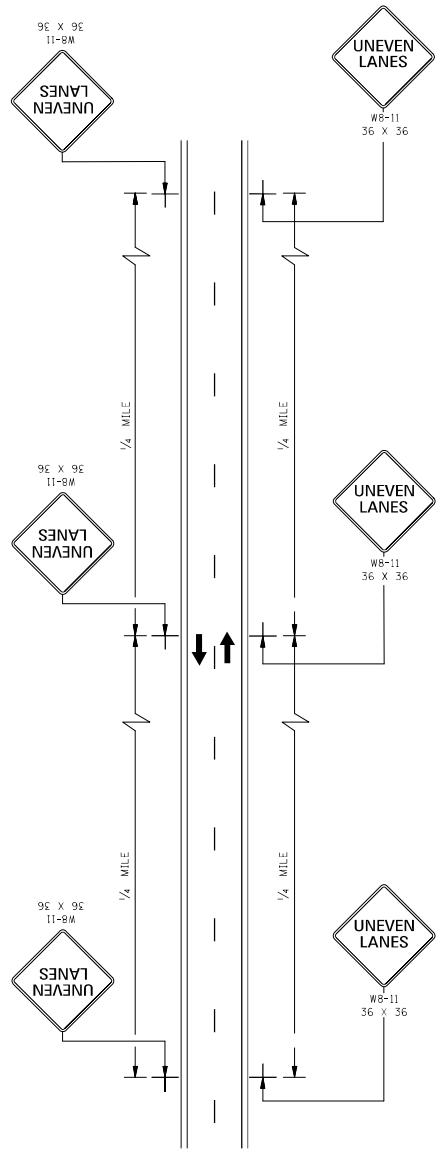

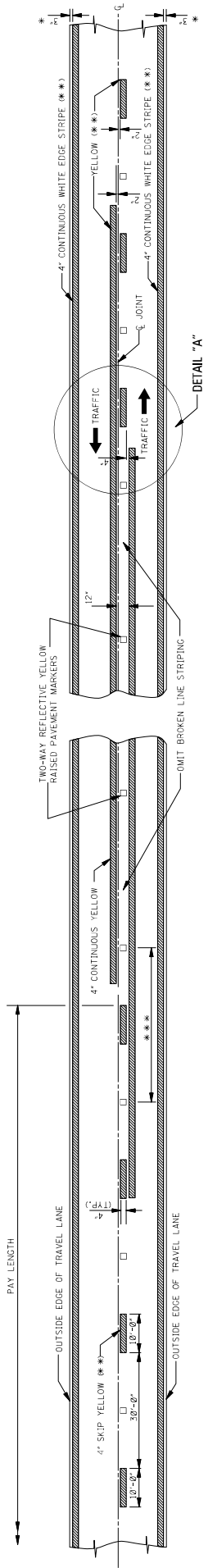

TWO-WAY TRAFFIC
(ASPHALT OR CONCRETE PAVEMENT)

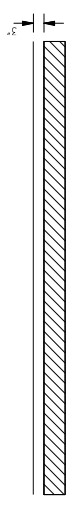

GENERAL NOTES:

- * 1. 3" UNLESS SHOWN ELSEWHERE ON THE PLANS.
- ** 2. EDGE STRIPE SHALL BE SAME MATERIAL AS LANE-LINE STRIPE (PAINT OR TAPE AS INDICATED IN PAY ITEMS).
- 3. REFLECTIVE RAISED PAVEMENT MARKERS TO BE USED IF TEMPORARY MARKINGS ARE TO REMAIN IN PLACE OVER 3 MONTHS.
- *** 4. SPACING OF REFLECTIVE RAISED PAVEMENT MARKERS IS AS FOLLOWS:

TANGENT SECTIONS	URBAN AREA (±11-in)	RURAL AREA (±11-in)
40'-0"	40'-0"	80'-0"
40'-0"	40'-0"	40'-0"
INTERCHANGE LIMITS	40'-0"	± 40'-0"

NOTE: ON THE MAIN FACILITY, REFLECTIVE RED-CLEAR RAISED PAVEMENT MARKERS ON A 40'-0" SPACING WILL BE REQUIRED ON LANE-LINES THROUGH ALL INTERCHANGE AREAS BEGINNING 1000' IN ADVANCE (IN DIRECTION OF TRAFFIC) OF THE EXIT RAMP. THIS SPACING WILL BE MAINTAINED THROUGHOUT THE END OF THE ENTRANCE RAMP TAPEL.

PAVEMENT MARKERS SHALL BE HIGH PERFORMANCE REFLECTIVE RAISED PAVEMENT MARKERS AS LISTED IN THE MOOT "APPROVED SOURCES OF MATERIALS."

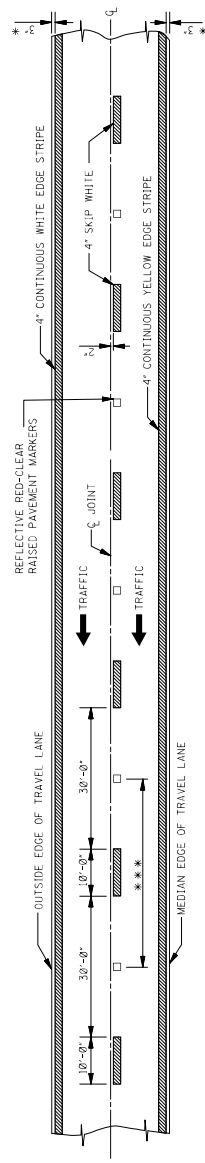

4-LANE WITH ONE-WAY TRAFFIC

MISSISSIPPI DEPARTMENT OF TRANSPORTATION
ROADWAY DESIGN DIVISION
STANDARD PLAN

**TEMPORARY STRIPING FOR TRAFFIC CONTROL
2-LANE AND 4-LANE
DIVIDED HIGHWAYS**

PLANNING NUMBER: GP-13
DRAWING NUMBER: 6363
ISSUE DATE: AUGUST 01, 2017

REVISION	DATE

MISSISSIPPI DEPARTMENT OF TRANSPORTATION

SECTION 904 - NOTICE TO BIDDERS NO. 5590

CODE: (SP)

DATE: 02/20/2024

SUBJECT: Project Number Change

**PROJECT: STBG-0054-01(061) / 109246301 & CRP-0054-01(063) / 109274301 --
Lawrence County**

Bidders are hereby advised that any references to Project Number HSIP-0054-01(063) / 109274301 in the plans or specifications shall be understood to mean Project Number CRP-0054-01(063) / 109274301.

MISSISSIPPI DEPARTMENT OF TRANSPORTATION

SECTION 904 - NOTICE TO BIDDERS NO. 5591

CODE: (SP)

DATE: 02/21/2024

SUBJECT: Pay Item Correction

**PROJECT: STBG-0054-01(061) / 109246301 & CRP-0054-01(063) / 109274301 –
Lawrence County**

Bidders are hereby advised that the Summary of Quantities sheets in the Plans for Project Number CRP-0054-01(063) / 109274301 do not include pay item no. 907-619-E3001, Changeable Message Sign. This is in error. A quantity of **4 EA** for this pay item has been added to the bid items. This item will be used in accordance with the Traffic Control Sheets in the Contract Plans unless otherwise directed by the Engineer.

MISSISSIPPI DEPARTMENT OF TRANSPORTATION

SPECIAL PROVISION NO. 907-619-5

CODE: (IS)

DATE: 01/17/2018

SUBJECT: Traffic Control for Construction Zones

Section 619, Traffic Control for Construction Zones, of the 2017 Edition of the Mississippi Standard Specifications for Road and Bridge Construction is hereby amended as follows.

907-619.02--Materials.

907-619.02.8--Traffic Signals and Flashers. Delete Subsection 619.02.8.1 on pages 452 thru 455, and substitute the following.

907-619.02.8.1-Portable Traffic Signals. Portable traffic signals shall be trailer or pedestal mounted units that provide for easy, legal transportation and quick setup and deployment. Each unit shall be self-contained. The types of portable traffic signals are as follows.

- Type 1 portable traffic signal shall include two signal heads per trailer with one signal head mounted on an overhead mast arm that can be extended over the travel lane, and the other signal head shall be mounted on the vertical upright of the trailer.
- Type 2 portable traffic signal shall include one signal head that is mounted on the vertical upright of the pedestal/cart or trailer. Pedestal/Cart mounted shall be designated as Type 2A and Trailer mounted shall be designated as Type 2B. Type 2 portable traffic signals shall be tested to MASH Standards or NCHRP Test Level 3 crash testing requirements by an accredited independent test facility, with supporting documentation available upon request.
- Type 3 portable traffic signal shall be the same as Type 1 mentioned above but with enhanced capabilities as mentioned in each applicable section below.

The portable traffic signals shall be MUTCD Compliant and utilize standard ITE signal heads, and adhere to the ITE Specifications and Standards for Vehicle Traffic Control Signal Heads, Light Emitting Diode (LED) Circular Signal Supplement. The units shall be battery powered with a solar charging system, and be equipped with an onboard battery charger capable of being used with a 120V AC power source. Portable traffic signals shall be able to communicate with other portable signals via 900 MHz or other accepted wireless communications. If wireless connectivity is not feasible, hardwired connectivity shall be an acceptable alternative, as approved by the Engineer. Portable Traffic Signals shall include all the major components listed below or be able to perform the functions of these components. The major components of the unit shall include, but are not limited to, the trailer or pedestal/cart, telescoping mast arm (on Type 1 and 3), signal head(s) and back plates, traffic signal controller with operating software, solar charging system with batteries, input and output devices, vehicle detection, flasher units, conflict monitor, relays,

communications system and other equipment required for the safe operation and installation of the unit.

907-619.02.8.1.1--Signal Heads. The signal heads and all applicable components of the portable traffic signal shall meet the physical display and operational requirements of conventional traffic signals as specific in the Manual on Uniform Traffic Control Devices (MUTCD). The signal heads shall be cast aluminum or polycarbonate and shall meet the requirements laid out in the Mississippi Standard Specification for traffic signal heads and associated MDOT material specifications for traffic signal heads. The signal heads shall accommodate standard 12-inch LED indications meeting the ITE Specification “Vehicle Traffic Control Signal Heads” and ITE Specifications and Standards for Vehicle Traffic Control Signal Heads, Light Emitting Diode (LED) Circular Signal Supplement.

For Type 1, Type 2 and Type 3 portable traffic signals, the signal heads shall have the ability to be rotated 180 degrees to face in the opposite direction and shall have the ability to rotate and lock in approximately 10 degree increments to position the signal head for the optimum visibility to motorists.

For Type 1 portable traffic signals, each unit shall contain two signal heads with one signal head mounted on an overhead mast arm that can be extended over the travel lane with a minimum clearance of 17 feet measured from the bottom of the signal head unit to the road surface. The lower signal head shall be mounted to the vertical upright of the trailer at a minimum height of eight feet (8') from the bottom of the signal head unit to the road surface.

For Type 2 portable traffic signals, the signal head shall be mounted to the vertical upright of the trailer at a minimum height of eight feet (8') from the bottom of the signal head unit to the road surface.

For Type 3 portable traffic signals, each unit shall be the same as Type 1 mentioned above but with enhanced capabilities as mentioned below.

907-619.02.8.1.2--Controller and Operating Requirements. The portable traffic signal (Types 1, 2, and 3) shall include a solid state Controller Unit (CU) that is in compliance with NEMA TS 5 Performance Standard. The CU shall have an easy to read front panel backlit display for viewing and programming the configuration settings and CU status. The CU shall be capable of operating the portable traffic signal system in a fixed time, traffic actuated or manual control mode. Multiple portable traffic signals shall have the capability to be interconnected to form a portable traffic signal system. Each portable traffic signal within a connected system shall have the capability to serve as either the master or remote signal. Each portable traffic signal shall include a Conflict Monitor Unit (CMU), or Malfunction Management Unit (MMU) to ensure phase conflicts do not exist during operation.

For Type 1 and Type 2 portable traffic signals, a minimum of five (5) automatic time-of-day timing plans within a 24-hour period should be available in fixed time mode. The CU should have the ability to control a minimum of four (4) traffic phases with programmable cycle time adjustments and user adjustable red, amber, minimum green and maximum green times. The CU shall have

the capability of programming green and red times from 1 to 999 seconds and yellow times up to 15 seconds in one-second increments. The CU shall also have the capability of facilitating standby modes of red, red flash and yellow flash.

For Type 3 portable traffic signals, a minimum of ten (10) automatic time-of-day timing plans within a 24-hour period should be available in fixed time mode. The CU should have the ability to control a minimum of 16 traffic phases with programmable cycle time adjustments and user adjustable red, amber, minimum green and maximum green times. The CU shall have the capability of programming green and red times from 1 to 999 seconds and yellow times up to 15 seconds in one-second increments. The CU shall also have the capability of facilitating standby modes of red, red flash and yellow flash.

The system shall also have the ability to operate in vehicle actuation mode when vehicle detection components are used. The operating system shall have the capability to allow the Portable Traffic Signal to be connected to and controlled by a standard NEMA controller.

The system shall have the capability to be controlled remotely using a hardwired or wireless remote. The wireless radio remote shall be capable of communicating at a clear line of site distance up to ¼ mile from the master.

The CU shall have the capability of interfacing with a Remote Monitoring System (RMS) capable of reporting signal location, battery voltage, and system faults. The RMS shall include a password-protected web site, viewable via an internet connection. In the event of a system fault, the RMS shall provide specific information concerning the cause of the system fault (example: "red lamp on signal number 1 out"). The RMS shall immediately contact previously designated individuals via SMS text messaging or email, upon a fault event.

The active timing program operating the PTS system shall be available and viewable through the RMS website at all times. The RMS shall maintain a history of the operating system in each signal including total operating hours, alerts, and the location of the PTS trailer.

907-619.02.8.1.3--Wireless Communications. The portable traffic signals shall communicate with other portable traffic signals within the signal system via license-free wireless 900 MHZ radio link communications as specified in Subsection 662.02.2 of the radio Interconnect System specification. The radio units shall maintain communications at a minimum distance of one (1) mile. The radio system shall conform to the applicable Federal Communications Commission requirements and all applicable state and local requirements.

The portable traffic signals shall be in direct communication at all times either by wireless or hardware connection to provide for the required conflict monitoring / malfunction management system.

907-619.02.8.1.4--Power Requirements. Each Portable Traffic Signal shall be equipped with a power source consisting of a solar collection array, solar controller and/or charging unit and batteries sufficient to operate the signal system. The number and size of batteries shall be sufficient to operate the Type 1 and Type 3 signals for a minimum of 30 days and Type 2A signals for

minimum of five (5) days, and Type 2B signals for minimum of 15 days without additional charging or assist from the solar array. An on-board battery charger shall be compatible with both the solar array and with a 120V AC power source.

For Type 1 signals, the solar panel array shall provide for a minimum of 440 watts of solar collection capability.

For Type 2A signals, the solar panel array shall provide for a minimum of 90 watts of solar collection capability.

For Type 2B signals, the solar panel array shall provide for a minimum of 110 watts of solar collection capability.

For Type 3 signals, the solar panel array shall provide for a minimum of 480 watts of solar collection capability and shall include a tilt and rotate system to optimally position the panels.

All instrumentation for the electrical system and battery compartment shall be contained in a lockable weatherproof enclosure. Solar panels shall be secured to the mounting brackets for theft prevention.

907-619.02.8.1.5--Trailer and Lift System. The trailer or pedestal/cart and all mounted components shall conform to the wind loading requirements as follows: 100 mph minimum for Type 1 portable traffic signals, 55 mph minimum for Type 2A portable traffic signals, 75 mph minimum for Type 2B portable traffic signals, and 90 mph minimum for Type 3 portable traffic signals as described in the AASHTO *Standard Specifications for Highway Signs, Luminaries and Traffic Signals*, as specified in the plans including all interims and updates. At the request of the Engineer, proof of conformance to these wind load ratings shall be verified by a third-party. No additional loose ballast shall be used to meet these wind load requirements. The trailer shall be made of structural steel and shall include four (4) leveling/stabilizer jacks capable of lifting the trailer a minimum of six inches (6”).

The trailer or pedestal shall be equipped with a mechanical, hydraulic or electric lift system sufficient for one person to be able to raise and lower the vertical upright and/or horizontal mast arm to and from the operating position.

For Type 1, 2B, and Type 3 signals, the trailer shall be equipped to provide legal and safe transport on the public highway system at speeds up to 55 mph.

All exterior metal surfaces, except signal heads and back plates, shall be powder-coat painted highway safety orange.

907-619.02.9--Impact Attenuators. Delete the sentence in the first paragraph of Subsection 619.02.9 on page 455, and substitute the following.

Impact attenuators must be listed on the Department's APL.

907-619.02.11--Snap-Back Delineators. Delete the sentence in the paragraph of Subsection 619.02.11 on page 456, and substitute the following.

Snap-back delineators shall be selected from the list of surface mounted flexible delineator posts as shown on the Department's APL.

907-619.02.14--Changeable Message Sign.

907-619.02.14.5--PCMS Controller and Storage Cabinets. Delete the fifth sentence in the first paragraph of Subsection 619.02.14.5 on pages 462 and 463, and substitute the following.

The controller cabinet shall be illuminated.

907-619.05--Basis of Payment. Add the following to the list of pay items ending on page 480.

907-619-E3: Changeable Message Sign ***** - per each

907-619-H2: Traffic Signal, Portable, Type ____ - per each

Overlay approximately 8 miles of SR 27 from Dewey Ballard Road to just north of US 84, known as Federal Aid Project No. STBG-0054-01(061) / 109246301 & Roundabout Construction on SR 27 at West Thomas E Jolly Drive, known as Federal Aid Project No. CRP-0054-01(063) / 109274301 in Lawrence County.

Line No.	Item Code	Adj Code	Quantity	Units	Description [Fixed Unit Price]
Roadway Items					
0010	202-B006		830	Square Yard	Removal of Asphalt Paved Shoulders, All Depths
0020	202-B007		5,814	Square Yard	Removal of Asphalt Pavement, All Depths
0030	202-B059		518	Square Yard	Removal of Concrete Median & Island Pavement, All Depths
0040	202-B088		1,473	Linear Feet	Removal of Curb & Gutter, All Types
0050	202-B150		1,553	Linear Feet	Removal of Guard Rail Including Post, Blockouts & Hardware
0060	202-B172		154	Square Feet	Removal of Legend, All Types
0070	202-B240		11,010	Linear Feet	Removal of Traffic Stripe
0080	203-A002	(E)	1,097	Cubic Yard	Unclassified Excavation, LVM, AH
0090	203-EX040	(E)	275	Cubic Yard	Borrow Excavation, AH, LVM, Class B9
0100	203-G002	(E)	2,727	Cubic Yard	Excess Excavation, LVM, AH
0110	209-A005		5,761	Square Yard	Geotextile Stabilization, Type V, Non-Woven
0120	211-B001	(E)	269	Cubic Yard	Topsoil for Slope Treatment, Contractor Furnished
0130	213-C001		1	Ton	Superphosphate
0140	216-A001		172	Square Yard	Solid Sodding
0150	219-A001		4	Thousand Gallon	Watering [\$20.00]
0160	220-A001		1	Acre	Insect Pest Control [\$30.00]
0170	221-A001	(S)	49	Cubic Yard	Concrete Paved Ditch
0180	223-A001		5	Acre	Mowing [\$50.00]
0190	225-A001		1	Acre	Grassing
0200	225-B001		1	Ton	Agricultural Limestone
0210	225-C001		2	Ton	Mulch, Vegetative Mulch
0220	226-A001		1	Acre	Temporary Grassing
0230	237-A002		200	Linear Feet	Wattles, 20"
0240	245-A001		100	Linear Feet	Silt Dike
0250	246-A002		75	Each	Sandbags
0260	249-A001		29	Ton	Riprap for Erosion Control
0270	249-B001		18	Cubic Yard	Remove and Reset Riprap
0280	304-A008	(GY)	1,816	Cubic Yard	Granular Material, LVM, Class 6, Group D
0290	403-A003	(BA1)	773	Ton	12.5-mm, ST, Asphalt Pavement
0300	403-A006	(BA1)	141	Ton	19-mm, ST, Asphalt Pavement
0310	403-A015	(BA1)	15,073	Ton	9.5-mm, ST, Asphalt Pavement
0320	403-B012	(BA1)	811	Ton	9.5-mm, ST, Asphalt Pavement, Leveling

Line No.	Item Code	Adj Code	Quantity	Units	Description [Fixed Unit Price]
0330	406-D001		52,194	Square Yard	Fine Milling of Bituminous Pavement, All Depths
0340	407-A001	(A2)	19,083	Gallon	Asphalt for Tack Coat
0350	412-A001		1,584	Square Feet	Pre-Grinding [\$3.25]
0360	423-A001		15	Mile	Rumble Strips, Ground In
0370	503-C010		6,811	Linear Feet	Saw Cut, Full Depth
0380	601-B001	(S)	1	Cubic Yard	Class "B" Structural Concrete, Minor Structures
0390	606-B002		619	Linear Feet	Guard Rail, Class A, Type 1, 'W' Beam
0400	606-D019		8	Each	Guard Rail, Bridge End Section, Type H
0410	606-E005		10	Each	Guard Rail, Terminal End Section, Flared
0420	609-B003	(S)	530	Linear Feet	Concrete Curb, Special Design
0430	609-C001	(S)	290	Linear Feet	Concrete Integral Curb, Type 1
0440	609-D009	(S)	3,930	Linear Feet	Combination Concrete Curb and Gutter Type 3A Mod1
0450	616-A001	(S)	54	Square Yard	Concrete Median and/or Island Pavement, 10-inch
0460	616-A003	(S)	384	Square Yard	Concrete Median and/or Island Pavement, 12-inch
0470	616-A004	(S)	837	Square Yard	Concrete Median and/or Island Pavement, 4-inch
0480	618-A001		1	Lump Sum	Maintenance of Traffic
0490	618-B001		1	Square Feet	Additional Construction Signs [\$10.00]
0500	619-A1001		15	Mile	Temporary Traffic Stripe, Continuous White
0510	619-A1002		5,721	Linear Feet	Temporary Traffic Stripe, Continuous White
0520	619-A2001		10	Mile	Temporary Traffic Stripe, Continuous Yellow
0530	619-A2002		4,981	Linear Feet	Temporary Traffic Stripe, Continuous Yellow
0540	619-A4002		6	Mile	Temporary Traffic Stripe, Skip Yellow
0550	619-A5001		34,039	Linear Feet	Temporary Traffic Stripe, Detail
0560	619-A6001		561	Square Feet	Temporary Traffic Stripe, Legend
0570	619-A6002		5,400	Linear Feet	Temporary Traffic Stripe, Legend
0580	619-D1001		246	Square Feet	Standard Roadside Construction Signs, Less than 10 Square Feet
0590	619-D2001		630	Square Feet	Standard Roadside Construction Signs, 10 Square Feet or More
0600	619-F1001		791	Linear Feet	Concrete Median Barrier, Precast
0610	619-G4005		36	Linear Feet	Barricades, Type III, Single Faced
0620	619-G5001		139	Each	Free Standing Plastic Drums
0630	619-G7001		78	Each	Warning Lights, Type "B"
0640	620-A001		1	Lump Sum	Mobilization
0650	626-C001		2,597	Linear Feet	6" Thermoplastic Double Drop Edge Stripe, Continuous White
0660	626-C002		15	Mile	6" Thermoplastic Double Drop Edge Stripe, Continuous White

Line No.	Item Code	Adj Code	Quantity	Units	Description [Fixed Unit Price]
0670	626-D001		6	Mile	6" Thermoplastic Double Drop Traffic Stripe, Skip Yellow
0680	626-D002		271	Linear Feet	6" Thermoplastic Double Drop Traffic Stripe, Skip Yellow
0690	626-E001		9	Mile	6" Thermoplastic Double Drop Traffic Stripe, Continuous Yellow
0700	626-E002		279	Linear Feet	6" Thermoplastic Double Drop Traffic Stripe, Continuous Yellow
0710	626-F002		1,886	Linear Feet	6" Thermoplastic Double Drop Edge Stripe, Continuous Yellow
0720	626-G002		21,695	Linear Feet	Thermoplastic Detail Stripe, White
0730	626-G003		12,275	Linear Feet	Thermoplastic Detail Stripe, Yellow
0740	626-G004		156	Linear Feet	Thermoplastic Double Drop Detail Stripe, White
0750	626-G005		2,277	Linear Feet	Thermoplastic Double Drop Detail Stripe, Yellow
0760	626-H001		505	Square Feet	Thermoplastic Double Drop Legend, White
0770	626-H004		502	Square Feet	Thermoplastic Legend, White
0780	626-H005		4,752	Linear Feet	Thermoplastic Legend, White
0790	627-J001		1,013	Each	Two-Way Clear Reflective High Performance Raised Markers
0800	627-K001		24	Each	Red-Clear Reflective High Performance Raised Markers
0810	627-L001		1,518	Each	Two-Way Yellow Reflective High Performance Raised Markers
0820	630-A001		90	Square Feet	Standard Roadside Signs, Sheet Aluminum, 0.080" Thickness
0830	630-A003		72	Square Feet	Standard Roadside Signs, Sheet Aluminum, 0.125" Thickness
0840	630-C001		142	Linear Feet	Square Tube Posts, 4.0 lb/ft
0850	630-C005		200	Linear Feet	Square Tube Posts, 2.0 lb/ft
0860	630-F006		44	Each	Delineators, Guard Rail, White
0870	682-A018		1,420	Linear Feet	Underground Branch Circuit, AWG 2, 3 Conductor
0880	682-A028		1,048	Linear Feet	Underground Branch Circuit, AWG 4, 3 Conductor
0890	682-B016		240	Linear Feet	Underground Branch Circuit, Jacked or Bored, AWG 2, 3 Conductor
0900	682-B025		85	Linear Feet	Underground Branch Circuit, Jacked or Bored, AWG 4, 3 Conductor
0910	682-E003		16	Each	Underground Junction Box With Concrete Pad
0920	682-F001		1	Each	Secondary Power Controller
0930	683-B200		16	Each	Lighting Assembly, Low Mast, LED, Type 30-1-10-17
0940	684-A004		21	Cubic Yard	Pole Foundation, 30" Diameter
0950	699-A001		1	Lump Sum	Roadway Construction Stakes
0960	907-234-A001		2,000	Linear Feet	Temporary Silt Fence
0970	907-619-B001		132	Linear Feet	Temporary Portable Rumble Strips
0972	907-619-E3001		4	Each	Changeable Message Sign

ALTERNATE GROUP AA NUMBER 1

Line No.	Item Code	Adj Code	Quantity	Units	Description [Fixed Unit Price]
0980	304-F001	(GT)	3,839	Ton	3/4" and Down Crushed Stone Base
ALTERNATE GROUP AA NUMBER 2					
0990	304-F002	(GT)	3,839	Ton	Size 610 Crushed Stone Base
ALTERNATE GROUP AA NUMBER 3					
1000	304-F003	(GT)	3,839	Ton	Size 825B Crushed Stone Base



DESIGNED BY: KIMLEY-HORN	FMS CON: 109274/301000
DETAILED BY: KIMLEY-HORN	PROJECT NO.: HSP-0054-01(063)
CHECKED BY: KIMLEY-HORN	COUNTY: LAWRENCE
DATE: 02/14/2024	

REVISIONS

WK. NO. REV 1
SHEET NO. 4

ADDENDUM

SUMMARY OF REVISIONS					
DATE	1st ORDER	ADDENDUM	2nd ORDER	BY	DESCRIPTION
02/14/2024		X		DED	REVISED FOOTING CLASS "B" CONCRETE (601-B001) QUANTITY



DESIGNED BY: KIMLEY-HORN
 CHECKED BY: KIMLEY-HORN
 DATE: 02/14/2024

PROJECT NO.: HSP1-0054-01(063)
 COUNTY: LAWRENCE

FMS CON: 109274/301000

SUMMARY OF QUANTITIES

WK. NO. **50-1**
 SHEET NO. **11**

ADDENDUM

- ① ITEM INCLUDES 679 TONS FOR LEVELING.
- ② ITEM INCLUDES A 20% INCREASE FROM CALCULATED QUANTITY.
- ③ ITEM INCLUDES 78 TONS FOR DRIVES.
- ④ ITEM INCLUDES 3 TONS FOR DRIVES.
- ⑤ ITEM INCLUDES 427 GALLONS FOR USE WITH LEVELING COURSES.
- ⑥ ITEM INCLUDES 1 CY FOR SIGN ASSEMBLY FOOTINGS.
- ⑦ ITEM INCLUDES 696 LF FOR REMOVAL OF IS-LAND PAVEMENT.

SUMMARY OF QUANTITIES (SHEET 1)

PAY ITEM NO.	PAY ITEM	UNIT	LAWRENCE : 109274-301000	
			Prelim	Final
202-B007	Removal of Asphalt Pavement, All Depths	SY	5,814	
202-B059	Removal of Concrete Median & Island Pavement, All Depths	SY	518	
202-B088	Removal of Curb & Gutter, All Types	LF	1,473	
202-B172	Removal of Legend, All Types	SF	154	
202-B240	Removal of Traffic Stripe	LF	8,510	
203-A002	Unclassified Excavation, LVM, AH	CY	1,097	
203-EX040	Borrow Excavation, AH, LVM, Class B9	CY	275	
203-G002	Excess Excavation, LVM, AH	CY	2,669	
209-A005	Geotextile Stabilization, Type V, Non-Woven	SY	5,761	
211-B001	Topsoil for Slope Treatment, Contractor Furnished	CY	269	
213-C001	Superphosphate	TON	1	
216-A001	Solid Sodding	SY	172	
219-A001	Watering	KGAL	4	
220-A001	Insect Pest Control	ACRE	1	
221-A001	Concrete Paved Ditch	CY	49	
223-A001	Mowing	ACRE	5	
225-A001	Grassing	ACRE	1	
225-B001	Agricultural Limestone	TON	1	
225-C001	Mulch, Vegetative Mulch	TON	2	
226-A001	Temporary Grassing	ACRE	1	
907-234-A001	Temporary Silt Fence	LF	2,000	
237-A002	Wattles, 20"	LF	200	
245-A001	Silt Dike	LF	100	
246-A002	Sandbags	EA	75	
249-A001	Riprap for Erosion Control	TON	29	
249-B001	Remove and Reset Riprap	CY	18	
304-F001	3/4" and Down Crushed Stone Base	TON	3,606	② ③
304-F002	OR			
304-F002	Size 610 Crushed Stone Base	TON	3,606	② ③
304-F003	OR			
304-F003	Size 825B Crushed Stone Base	TON	3,606	② ③
403-A003	12.5-mm, ST, Asphalt Pavement	TON	773	①
403-A006	19-mm, ST, Asphalt Pavement	TON	141	
403-A015	9.5-mm, ST, Asphalt Pavement	TON	620	④
406-D001	Fine Milling of Bituminous Pavement, All Depths	SY	6,624	⑤
407-A001	Asphalt for Tack Coat	GAL	1,052	⑦
503-C010	Saw Cut, Full Depth	LF	5,456	⑦
601-B001	Class "B" Structural Concrete, Minor Structures	CY	1	⑥ △
609-B003	Concrete Curb, Special Design	LF	530	
609-C001	Concrete Integral Curb, Type 1	LF	290	
609-D009	Combination Concrete Curb and Gutter Type 3A Mod1	LF	3,930	
616-A001	Concrete Median and/or Island Pavement, 10-inch	SY	54	
616-A003	Concrete Median and/or Island Pavement, 12-inch	SY	384	
616-A004	Concrete Median and/or Island Pavement, 4-inch	SY	837	
618-A001	Maintenance of Traffic	LS	1	
619-A1002	Temporary Traffic Stripe, Continuous White	LF	5,721	

ADDENDUM

SUMMARY OF QUANTITIES (SHEET 2)

PAY ITEM NO.	PAY ITEM	UNIT	LAWRENCE : 109274-301000	
			Prelim	Final
619-A2002	Temporary Traffic Stripe, Continuous Yellow	LF	4,981	
619-A5001	Temporary Traffic Stripe, Detail	LF	69	
619-A6001	Temporary Traffic Stripe, Legend	SF	32	
619-A6002	Temporary Traffic Stripe, Legend	LF	16	
619-D1001	Standard Roadside Construction Signs, Less than 10 Square Feet	SF	246	
619-D2001	Standard Roadside Construction Signs, 10 Square Feet or More	SF	630	
619-F1001	Concrete Median Barrier, Precast	LF	791	
619-G4005	Barricades, Type III, Single Faced	LF	36	
619-G5001	Free Standing Plastic Drums	EA	139	
619-G7001	Warning Lights, Type "B"	EA	78	
620-A001	Mobilization	LS	1	
626-C001	6" Thermoplastic Double Drop Edge Stripe, Continuous White	LF	2,597	
626-D002	6" Thermoplastic Double Drop Traffic Stripe, Skip Yellow	LF	271	
626-E002	6" Thermoplastic Double Drop Traffic Stripe, Continuous Yellow	LF	279	
626-F002	6" Thermoplastic Double Drop Edge Stripe, Continuous Yellow	LF	1,886	
626-G004	Thermoplastic Double Drop Detail Stripe, White	LF	156	
626-G005	Thermoplastic Double Drop Detail Stripe, Yellow	LF	2,277	
626-H001	Thermoplastic Double Drop Legend, White	SF	505	
627-J001	Two-Way Clear Reflective High Performance Raised Markers	EA	20	
627-L001	Two-Way Yellow Reflective High Performance Raised Markers	EA	95	
630-A001	Standard Roadside Signs, Sheet Aluminum, 0.080" Thickness	SF	90	
630-A003	Standard Roadside Signs, Sheet Aluminum, 0.125" Thickness	SF	72	
630-C001	Square Tube Posts, 4.0 lb/ft	LF	142	
630-C005	Square Tube Posts, 2.0 lb/ft	LF	200	
682-A018	Underground Branch Circuit, AWG 2, 3 Conductor	LF	1,420	
682-A028	Underground Branch Circuit, AWG 4, 3 Conductor	LF	1,048	
682-B016	Underground Branch Circuit, Jacked or Bored, AWG 2, 3 Conductor	LF	240	
682-B025	Underground Branch Circuit, Jacked or Bored, AWG 4, 3 Conductor	LF	85	
682-E003	Underground Junction Box With Concrete Pad	EA	16	
682-F001	Secondary Power Controller	EA	1	
683-B200	Lighting Assembly, Low Mast, LED, Type 30-1-10-17	EA	16	
684-A004	Pole Foundation, 30" Diameter	CY	21	
699-A001	Roadway Construction Stakes	LS	1	



DESIGNED BY: KIMLEY-HORN
 DETAILED BY: KIMLEY-HORN
 CHECKED BY: KIMLEY-HORN
 DATE: 02/14/2024

FMS CON: 109274/301000
 PROJECT NO.: HSP-0054-01(063)
 COUNTY: LAWRENCE

SUMMARY OF QUANTITIES

WK. NO. **SQ-2**
 SHEET NO. **12**



DESIGNED BY: KIMLEY-HORN
 CHECKED BY: KIMLEY-HORN
 PROJECT NO.: HSP-0054-01(1063)
 COUNTY: LAWRENCE
 DATE: 02/14/2024

FMS CON: 109274/301000
 ESTIMATED QUANTITIES
 PAVEMENT MARKINGS, STANDARD ROADSIDE SIGNS
 AND STANDARDS ROADSIDE SIGN ASSEMBLIES

WK. NO. EQ-5
 SHEET NO. 11

SUMMARY OF PERMANENT PAVEMENT MARKINGS

THERMOPLASTIC (DOUBLE DROP)

WK. SH. NO.	STATION TO STATION	CONTINUOUS				EDGE				DETAIL				SKIP				LEGEND				MARKERS				REMARKS
		WHITE	YELLOW	WHITE	YELLOW	WHITE	YELLOW	WHITE	YELLOW	WHITE	YELLOW	WHITE	YELLOW	WHITE	YELLOW	WHITE	YELLOW	WHITE	YELLOW	RED-CLEAR	RED-CLEAR	RED-CLEAR	RED-CLEAR	YELLOW-2WAY	YELLOW-2WAY	
PMD-1		91	1382	1074	156	277	91	1074	277	20	327.7	26	20	20	20	20	20	20								
PMD-2		188	1215	812	180	2000	180	2000	177.3	177.3	177.3	177.3	177.3	177.3	177.3	177.3	177.3	177.3								
UNITS		L.F.	L.F.	L.F.	L.F.	L.F.	L.F.	L.F.	L.F.	L.F.	L.F.	L.F.	L.F.	L.F.	L.F.	L.F.	L.F.	L.F.	S.F.	S.F.	S.F.	S.F.	EACH	EACH	EACH	EACH
TOTALS		0	279	2597	1886	156	2277	0	271	0	505	26	0	95	26	0	0	0	0	0	0	0	0	0	0	0

STANDARD ROADSIDE SIGNS

SHEET ALUMINUM - 0.080" THICKNESS

SIGN NUMBER	SIZE	UNIT AREA (SQ. FT.)	QUANTITY REQUIRED	TOTAL SIGN AREA (SQ. FT.)	REMARKS
M1-5	30" x 24"	5.00	2	10.00	
M0-1	24" x 12"	2.00	1	2.00	
M0-3	24" x 12"	2.00	1	2.00	
M6-2R	21" x 15"	2.19	2	4.38	
R1-2	36" x 36" x 36"	3.89	8	15.56	
R4-7	24" x 30"	5.00	4	20.00	
R6-4	30" x 24"	5.00	4	20.00	
W13-1	24" x 24"	4.00	4	16.00	
TOTAL			EACH 26	SQ. FT. 90	

STANDARD ROADSIDE SIGNS

SHEET ALUMINUM - 0.1250" THICKNESS

SIGN NUMBER	SIZE	UNIT AREA (SQ. FT.)	QUANTITY REQUIRED	TOTAL SIGN AREA (SQ. FT.)	REMARKS
W2-6	36" x 36"	9.00	4	36.00	
W3-2A	36" x 36"	9.00	4	36.00	
TOTAL			EACH 8	SQ. FT. 72	

STANDARD ROADSIDE SIGN ASSEMBLIES REQUIRED

WORKING NUMBER	CODE LETTER THIS SHEET	STANDARD ROADSIDE SIGNS TO BE MOUNTED				SQUARE MOUNTING POST		FOOTING CLASS "B" CONCRETE	PERMANENT BARRICADE SINGLE FACED
		W2-6, W13-1	W3-2A	R4-7	R1-2	4 LB/FT	2 LB/FT		
PSP-1	A	W2-6, W13-1	W3-2A	R4-7	R1-2	15.125	13.000	0.09	
PSP-1	B	W3-2A		R4-7	R1-2	13.000	13.000	0.09	
PSP-1	C	R4-7		R1-2		12.500	12.500	0.09	
PSP-1	D	R1-2				12.500	12.500	0.09	
PSP-1	E	R1-2				12.500	12.500	0.09	
PSP-1	F	M0-3 M1-5, M6-2R				14.500	14.500	0.09	
PSP-1	G	W2-6, W13-1				15.125	15.125	0.09	
PSP-1	H	W3-2A				12.500	12.500	0.09	
PSP-1	I	R4-7				13.000	13.000	0.09	
PSP-1	J	R1-2				12.500	12.500	0.09	
PSP-1	K	R1-2				12.500	12.500	0.09	
PSP-1	L	W2-6, W13-1				15.125	15.125	0.09	
PSP-1	M	W3-2A				13.000	13.000	0.09	
PSP-1	N	R4-7				13.000	13.000	0.09	
PSP-1	O	R1-2				12.500	12.500	0.09	
PSP-1	P	R1-2				12.500	12.500	0.09	
PSP-1	Q	M0-1, M1-5, M6-2R				14.500	14.500	0.09	
PSP-1	R	W2-6, W13-1				15.125	15.125	0.09	
PSP-1	S	W3-2A				13.000	13.000	0.09	
PSP-1	T	R4-7				13.000	13.000	0.09	
PSP-1	U	R1-2				12.500	12.500	0.09	
PSP-1	V	R1-2				12.500	12.500	0.09	
PSP-1	W	RE-4				12.000	12.000	0.09	
PSP-1	X	RE-4				12.000	12.000	0.09	
PSP-1	Y	RE-4				12.000	12.000	0.09	
PSP-1	Z	RE-4				12.000	12.000	0.09	
UNITS						CU. YDS.	CU. YDS.		
TOTAL						200	142	0.9	0.0
						LN. FT.	LN. FT.		LN. FT.

