

STATE	PROJECT NUMBER	SHEET NO.
MISSISSIPPI	STBG-2901-00(025)	1

GENERAL INDEX

INCLUDED THIS PROJECT	BEGIN WITH SHEET
<input checked="" type="checkbox"/> ROADWAY .....	1
<input checked="" type="checkbox"/> PERMANENT SIGNS .....	1001
<input type="checkbox"/> TRAFFIC SIGNALS .....	2001
<input type="checkbox"/> ITS COMPONENTS .....	3001
<input type="checkbox"/> LIGHTING .....	4001
<input type="checkbox"/> (RESERVED) .....	5001
<input checked="" type="checkbox"/> ROADWAY STANDARD DWGS .....	6001
<input type="checkbox"/> BOX CULVERT STD. DRAWINGS (LRFD) .....	7001
<input type="checkbox"/> BOX CULVERT STD. DRAWINGS (STD. SPEC.)	7501
<input checked="" type="checkbox"/> BRIDGE .....	8001
<input checked="" type="checkbox"/> CROSS SECTIONS .....	9001

STATE OF MISSISSIPPI

MISSISSIPPI DEPARTMENT OF TRANSPORTATION

PLAN AND PROFILE OF PROPOSED  
STATE HIGHWAY  
FEDERAL AID PROJECT NO. STBG-2901-00(025)

US HWY 51 BRIDGE REPLACEMENTS (BRIDGE NUMBERS 224.7, 227.0, 227.6, & 228.6)  
IN YALOBUSHA COUNTY

FMS. CONST. NO. 103332 /301000

SCALES

PLAN	1 IN. = 100 FT.
PROFILE { HOR. VERT.	1 IN. = 100 FT.
LAYOUT	1 IN. = 10 FT.
	1 IN. = 4000 FT.

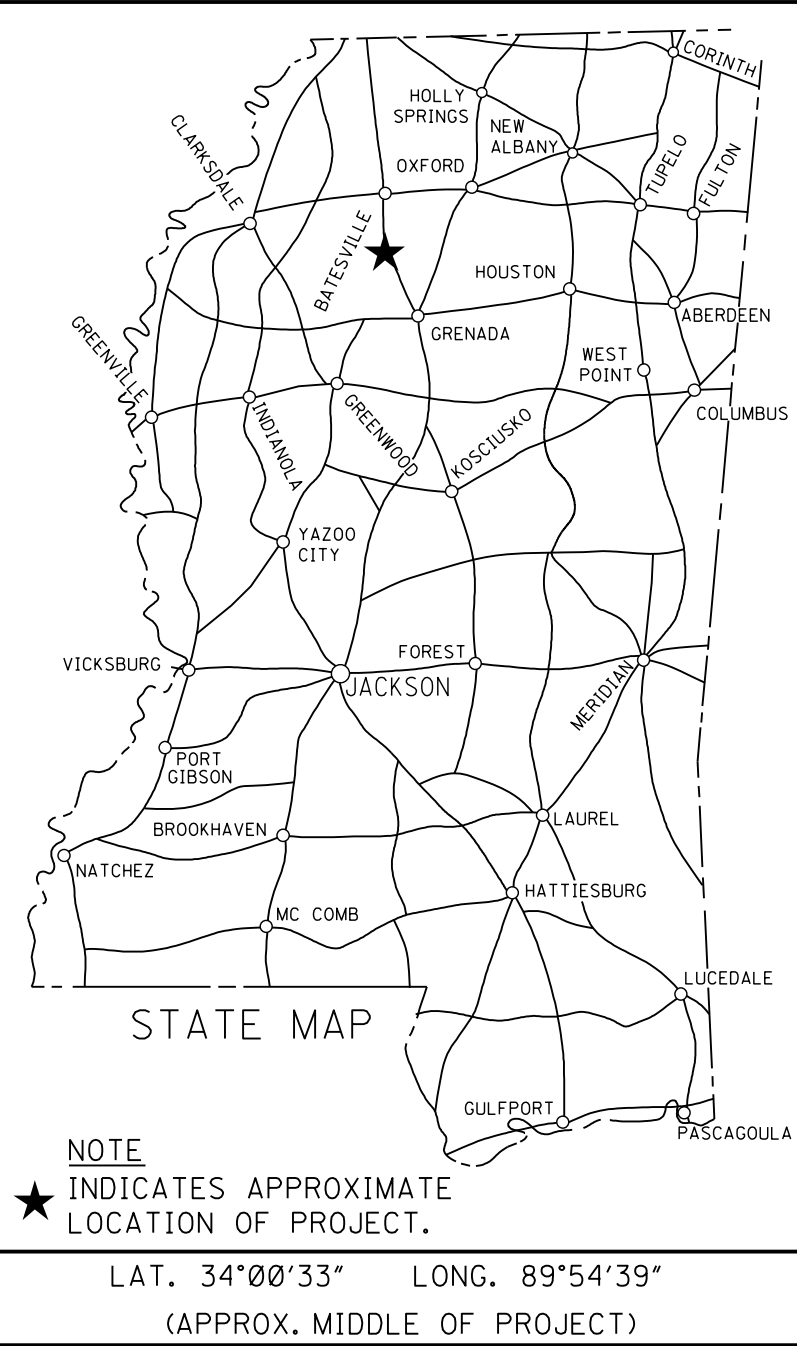

DESIGN CONTROL
55 MPH = V (SPEED DESIGN)
ADT (2022) = 1600 ; ADT (2042) = 2000
DHV = 237 ; D = 50 % T = 8 %

PERMITS ACQUIRED BY MDOT
WETLANDS AND WATERS PERMITS
NATIONWIDE #14 <input type="checkbox"/> WATERS <input checked="" type="checkbox"/> WETLANDS <input checked="" type="checkbox"/>
NATIONWIDE (OTHER)* <input checked="" type="checkbox"/> WATERS <input checked="" type="checkbox"/> WETLANDS <input checked="" type="checkbox"/>
GENERAL* <input type="checkbox"/> WATERS <input type="checkbox"/> WETLANDS <input type="checkbox"/>
INDIVIDUAL (404)* <input type="checkbox"/> WATERS <input type="checkbox"/> WETLANDS <input type="checkbox"/>
STORMWATER PERMIT <input checked="" type="checkbox"/>
Y REQUIRED, CNOI SUBMITTED BY MDOT (DISTURBED AREA = 5 ACRES)
S REQUIRED, CNOI TO BE SUBMITTED BY CONTRACTOR (1 TO 4.99 ACRES)
N NO STORMWATER PERMIT REQUIRED (<1 ACRE)
APPROVED BY: _____

BRIDGE STRUCTURES REQ'D.

SITE 1

A BRIDGE # 224.7  
STA. 322+93.88 TO 326+76.12  
BRIDGE LENGTH 380' SKEW 15° RT. FWD.  
SPANS REQUIRED 1@75', 1@150', 1@90', 1@65'

SITE 2

B BRIDGE # 227.0  
STA. 446+74.92 TO 448+27.08  
BRIDGE LENGTH 150'  
SPANS REQUIRED 1@150'

SITE 3

C BRIDGE # 227.6  
STA. 477+21.07 TO 480+24.13  
BRIDGE LENGTH 300' SKEW 45° LT. FWD.  
SPANS REQUIRED 1@85', 1@145', 1@70'

SITE 4

D BRIDGE # 228.6  
STA. 525+93.92 TO 528+66.08  
BRIDGE LENGTH 270'  
SPANS REQUIRED 1@80', 1@110', 1@80'

CONVENTIONAL SYMBOLS

COUNTY LINE .....	
TOWN CORPORATION LINE .....	
SECTION LINE .....	
EXISTING ROAD OR TRAVELED WAY .....	
PROPOSED ROAD OR TRAVELED WAY .....	
RAILROAD .....	
SURVEY LINE .....	
BRIDGES .....	

END PROJECT  
1543+66.441  
(HWY 51 STATIONING)

SITE 4

BRIDGE# 228.6

SITE 3

BRIDGE# 227.6

SITE 2

BRIDGE# 227.0

SITE 1

BRIDGE# 224.7

BEGIN PROJECT  
314+40.000  
(HWY 51 STATIONING)

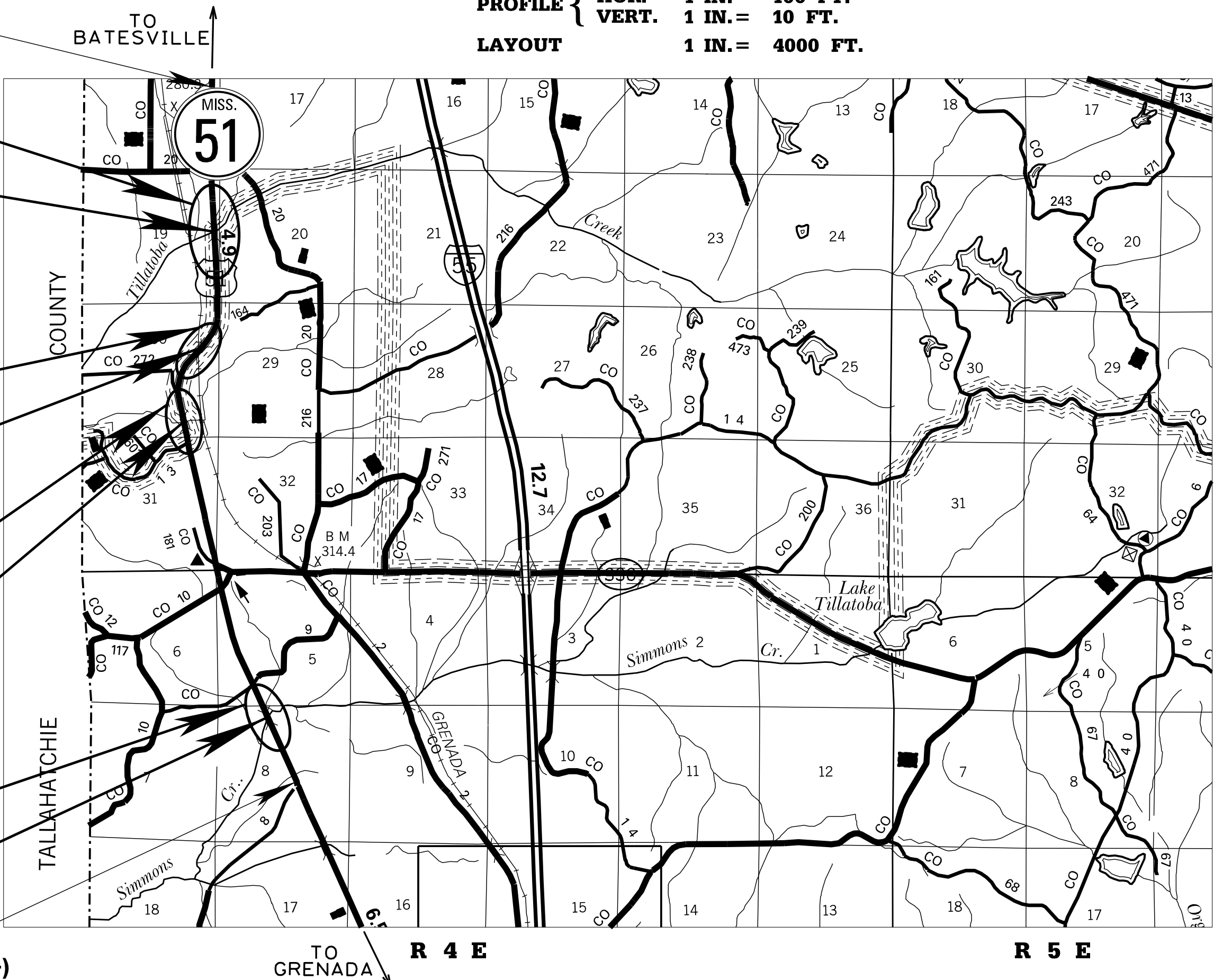

11/30/23  
ROADWAY











## GENERAL NOTES (CONTINUED)

- (18) THE CONTRACTOR SHALL COVER ANY TEMPORARY TRAFFIC CONTROL SIGNS SHOWN IN THE TRAFFIC CONTROL PLAN THAT DO NOT APPLY TO THE CURRENT PHASE.
- (19) CLEARING IN WETLANDS AREA UNDERNEATH BRIDGES IS PROHIBITED, EXCEPT WHERE NECESSARY FOR BRIDGE CONSTRUCTION. THIS CLEARING MUST BE DONE WITH SAWS, DOZERS OR OTHER MECHANIZED CLEARING WHICH WILL DISTURB NATURAL GROUND SURFACE ARE NOT ALLOWED.
- (19) REMOVAL OF RAISED PAVEMENT MARKERS THAT ARE IN CONFLICT WITH REQUIRED CONSTRUCTION IS NOT CONSIDERED A SEPARATE PAY ITEM. COST TO BE ABSORBED IN OTHER ITEMS BID.
- (20) REMOVAL OF OBJECT MARKERS IS NOT CONSIDERED A SEPARATE PAY ITEM, AND SHALL BE ABSORBED IN OTHER ITEMS BID.
- (21) WHERE MILLING IS REQUIRED, THE CONTRACTOR SHALL PROVIDE OUTLETS IN THE EXISTING SHOULDERS AT SUFFICIENT INTERVALS TO PREVENT POOLING OR STANDING WATER ON THE MILLED SURFACE, THE COST OF WHICH SHALL BE ABSORBED IN OTHER ITEMS BID.
- (22) THE EROSION CONTROL DEVICES REFERENCED IN THESE PLANS ARE A MINIMUM REQUIREMENT. IT IS THE RESPONSIBILITY OF THE CONTRACTOR TO ENSURE THAT SILT DOES NOT LEAVE THE RIGHT OF WAY OR CONTAMINATE WATERS OF THE U. S. DURING CONSTRUCTION. THE CONTRACTOR SHALL SUBMIT AN EROSION CONTROL PLAN PRIOR TO COMMENCEMENT OF WORK AND MAINTAIN THE PLAN DURING CONSTRUCTION. ANY ADDITIONAL SILT BASINS NOT SHOWN IN THE PLANS SHALL BE INCLUDED IN THE CONTRACTOR'S EROSION CONTROL PLAN PRIOR TO SUBMITTING FOR APPROVAL.
- (23) THIN LAYERS OF ROCK ENCOUNTERED DURING EXCAVATION WILL BE PAID FOR AS UNCLASSIFIED EXCAVATION.
- (24) PRIOR TO EARTHWORK OPERATIONS, THE EXISTING TOP 6" TOPSOIL IS TO BE STRIPPED AND STOCKPILED. AFTER THE GRADING OPERATIONS ARE COMPLETED, SAID TOPSOIL SHALL BE PLACED ON ALL AREAS THAT ARE NOT TO BE PAVED OR OTHERWISE PROTECTED, IN ACCORDANCE WITH SECTION 211 OF THE SPECIFICATIONS, OR THE VEGETATION SCHEDULE (SEE WK. SH. VS-1). EXISTING TOPSOIL AND ALL COSTS ASSOCIATED WITH STRIPPING, HAULING, STOCKPILING, AND PLACEMENT OF THE EXISTING TOPSOIL IS TO BE ABSORBED IN OTHER EARTHWORK ITEMS.
- (25) FOR CLEARING LIMITS ADJACENT TO THE STREAMS AT STATIONS 323+50, 447+00 & 527+00, SEE WORKING SHEET NUMBERS ECP-RB-3, 4, & 6. THE CLEARING LIMITS SHOWN ON THESE SHEETS ARE ONLY FOR THE RIPARIAN BUFFER CLEARING. CLEARING AT OTHER LOCATIONS SHOULD STILL APPLY.
- (26) THE CONTRACTOR IS RESPONSIBLE FOR FIELD-VERIFICATION OF EXISTING GRADES AND MAKING ADJUSTMENTS AS NECESSARY WITH THE APPROVAL OF THE PROJECT ENGINEER.
- (27) TEMPORARY STRIPING SHALL CONFORM TO FINISHED STRIPE SPECIFICATIONS FOR ALIGNMENT, NEATNESS, AND STRAIGHTNESS.
- (28) ALL ITEMS OF WORK ASSOCIATED WITH THE INSTALLATION OF A CONSTRUCTION ENTRANCE SHALL BE ABSORBED IN OTHER ITEMS OF WORK.
- (29) IF COLORS ARE USED ON PLAN/PROFILE SHEETS, THEY ARE INTENDED TO VISUALLY EASE THE LOCATION OF ELEMENTS FOR USERS OF THESE DRAWINGS. ALTHOUGH THE INTENT IS TO CATEGORIZE EVERYTHING AS EITHER EXISTING OR PROPOSED, IT IS THE END USER'S RESPONSIBILITY TO ENSURE ALL ELEMENTS ARE INTERPRETED CORRECTLY, REGARDLESS OF COLOR.
- (30) SEE BRIDGE PLANS FOR DETAILED INDEX SHEET(S), ESTIMATED AND SUMMARY OF QUANTITY SHEETS, AND EROSION CONTROL SHEETS.
- (31) ALL ADDENDA TO THESE PLANS WILL BE POSTED TO [WWW.MDOT.MS.GOV](http://WWW.MDOT.MS.GOV) UNDER THE PROPOSAL ADDENDA COLUMN. BIDDERS ARE ADVISED THAT HARD COPIES OF ANY ADDENDA FOR THIS PROJECT WILL NOT BE MAILED. IT IS THE BIDDER'S RESPONSIBILITY TO CHECK AND SEE IF ANY ADDENDA HAVE BEEN POSTED FOR THIS PROJECT.

[illegible]



- (32) THE CONTRACTOR SHALL BE RESPONSIBLE FOR MAINTAINING AND RELOCATING MAIL BOXES AS NECESSARY TO MAINTAIN CONTINUOUS MAIL SERVICE THROUGHOUT THE LIFE OF THE PROJECT, THE COST OF WHICH SHALL BE ABSORBED IN OTHER ITEMS BID.
- (33) THE BRIDGE DECKS SHALL BE GROOVED AND ALL BRIDGE JOINTS SHALL BE SEALED PRIOR TO OPENING THE BRIDGES TO TRAFFIC.
- (34) STORAGE OF FLAMMABLE MATERIALS WILL NOT BE ALLOWED UNDER ANY BRIDGE STRUCTURES WITHOUT WRITTEN APPROVAL FROM THE PROJECT ENGINEER. SEE NOTICE TO BIDDERS ENTITLED "MATERIAL STORAGE UNDER BRIDGES" FOR MORE INFORMATION.
- (35) INSTALLATION DATES SHALL BE CLEARLY WRITTEN IN BOLD BLACK MARKINGS ON THE BACK BOTTOM HALF OF ALL SIGNS WITH A PERMANENT MARKING STICK THAT IS WATERPROOF, FADE RESISTANT AND MARKS ON WET OR DRY SURFACES.
- (36) ALL POST, PIPE, AND I-BEAM LENGTHS IN THESE PLANS ARE ESTIMATES. POST LENGTHS FOR ALL SIGNS SHALL BE VERIFIED IN THE FIELD BY THE CONTRACTOR PRIOR TO FABRICATION.
- (37) ALL EXISTING SIGNS WHICH ARE TO BE REMOVED AS A PART OF THIS PROJECT THAT ARE NOT IN CONFLICT WITH CONSTRUCTION SHALL REMAIN IN PLACE UNTIL NEW SIGNS ARE INSTALLED UNLESS NOTED OR DIRECTED OTHERWISE BY THE PROJECT ENGINEER. ROADWAY SIGNS THAT ARE IN CONFLICT WITH CONSTRUCTION SHALL BE REMOVED AND RELOCATED BY THE CONTRACTOR AS DIRECTED BY THE ENGINEER, THE COST OF WHICH SHALL BE ABSORBED IN OTHER ITEMS BID.
- (38) ALL PERMANENT SIGNS SHALL CONFORM TO THE LATEST EDITION OF THE MANUAL ON UNIFORM TRAFFIC CONTROL DEVICES.
- (39) ALL SIGN LOCATIONS SHALL BE APPROVED BY THE PROJECT ENGINEER PRIOR TO INSTALLATION.
- (40) THE RETROREFLECTIVE SIGN SHEETING ON PERMANENT GROUND-MOUNTED SIGNS SHALL BE AS FOLLOWS: BROWN BACKGROUND SHEETING ON GUIDE SIGNS SHALL BE MINIMUM TYPE VII; GREEN AND BLUE BACKGROUND SHEETING ON GUIDE SIGNS SHALL BE MINIMUM TYPE IX; ALL WHITE, YELLOW, FLUORESCENT YELLOW AND FLUORESCENT YELLOW/GREEN SHEETING SHALL BE TYPE XI. ALL SIGN SHEETING ON OVERHEAD SIGNS SHALL BE TYPE XI.
- (41) THE RETROREFLECTIVE SIGN SHEETING ON RIGID, TEMPORARY TRAFFIC CONTROL (ORANGE) SIGNS SHALL BE MINIMUM TYPE IX.
- (42) ALL EXISTING SIGNS AND SUPPORTS REMOVED UNDER THIS PROJECT SHALL BECOME THE PROPERTY OF THE CONTRACTOR AND ARE NOT A SEPARATE PAY ITEM; HOWEVER, ALL ALUMINUM SIGN FACE MATERIAL SHALL BECOME THE PROPERTY OF MDOT. THE ALUMINUM SIGN FACE MATERIAL SHALL BE SORTED ACCORDING TO SIZE AND SHAPE AND STORED ON PALLETS AT A LOCATION APPROVED BY THE PROJECT ENGINEER. CONTRACTOR SHALL ARRANGE WITH THE PROJECT ENGINEER A SUITABLE TIME FOR PICK-UP BY MDOT. MDOT RESERVES THE RIGHT TO REFUSE ANY MATERIAL THAT IS DAMAGED OR UNSUITABLE FOR REFURBISHMENT. ANY REJECTED ALUMINUM SIGN FACE MATERIAL SHALL BECOME THE PROPERTY OF THE CONTRACTOR.
- (43) THE CONTRACTOR SHALL COORDINATE AND CONDUCT WORK AT LOCAL ROADS AND DRIVEWAYS IN A MANNER SUCH THAT ACCESS IS NOT INTERRUPTED UNNECESSARILY. ACCESS SHALL BE PRESERVED IN THE BEST MANNER POSSIBLE. COORDINATION AND COMMUNICATION WITH LANDOWNERS MAY BE NECESSARY TO PREVENT INTERRUPTION OF DRIVEWAY ACCESS.
- (44) GRENADA RAILROAD, LLC. CONTACT INFORMATION: (662)-226-8364

[illegible]