

**GENERAL INDEX**

INCLUDED THIS PROJECT	BEGIN WITH SHEET
<input checked="" type="checkbox"/> ROADWAY.....	1
<input type="checkbox"/> PERMANENT SIGNS.....	1001
<input type="checkbox"/> TRAFFIC SIGNALS.....	2001
<input type="checkbox"/> ITS COMPONENTS.....	3001
<input type="checkbox"/> LIGHTING.....	4001
<input type="checkbox"/> (RESERVED).....	5001
<input checked="" type="checkbox"/> ROADWAY STD. DWGS.....	6001
<input type="checkbox"/> BOX CULVERT STD. DWGS (LRFD).....	7001
<input type="checkbox"/> BOX CULVERT STD. DWGS (STD. SPEC.)....	7501
<input checked="" type="checkbox"/> BRIDGE.....	8001
<input type="checkbox"/> CROSS SECTIONS.....	9001

**STATE OF MISSISSIPPI  
MISSISSIPPI DEPARTMENT OF TRANSPORTATION**

**PLAN AND PROFILE OF  
PROPOSED STATE HIGHWAY  
FEDERAL AID PROJECT NO. STBG-0612-00(011)**

**SR 442 over Sunflower River (16.2)  
SUNFLOWER COUNTY**

**WORK SITE  
BR. NO. 16.2**

BRIDGE STRUCTURES REQ'D.

**NONE**

BOX BRIDGES REQ'D.

**NONE**

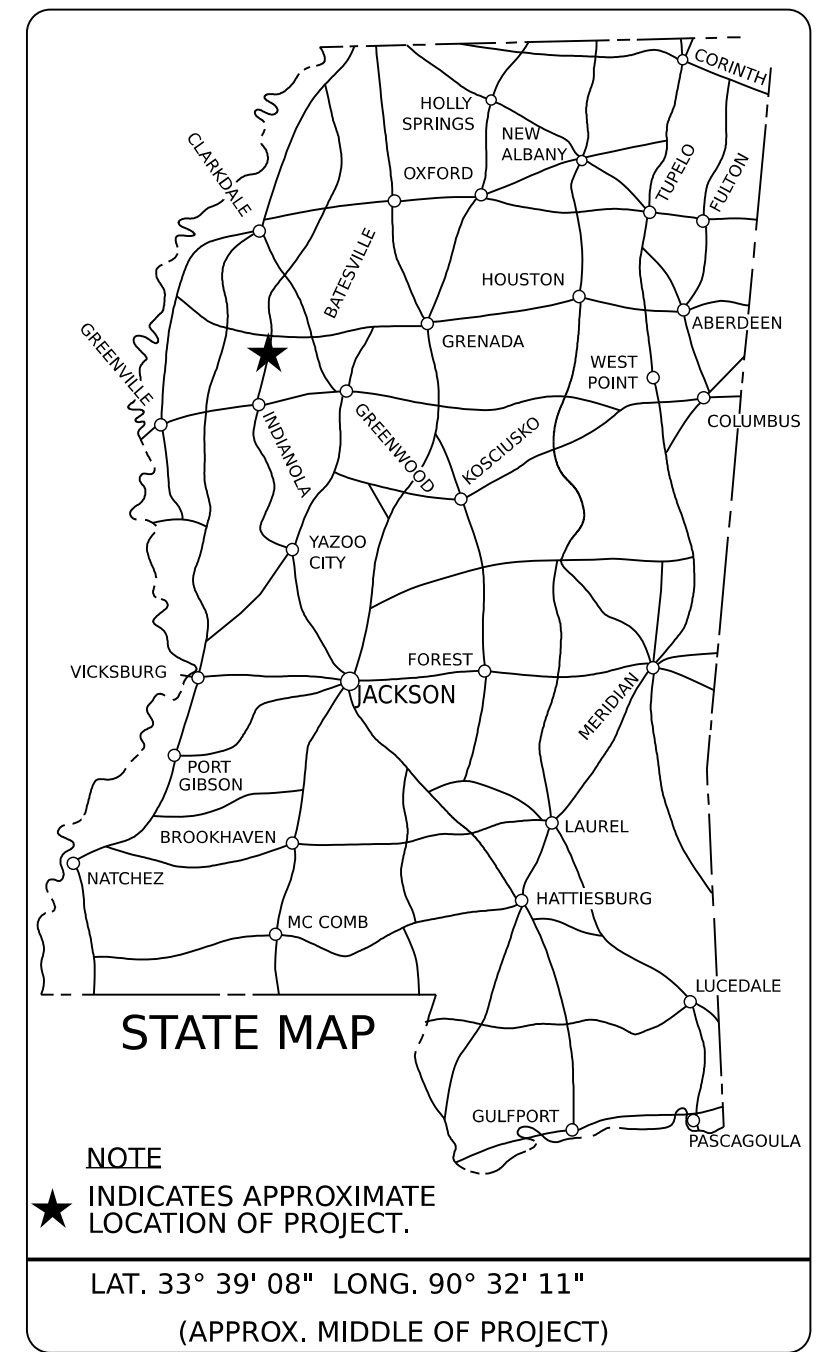
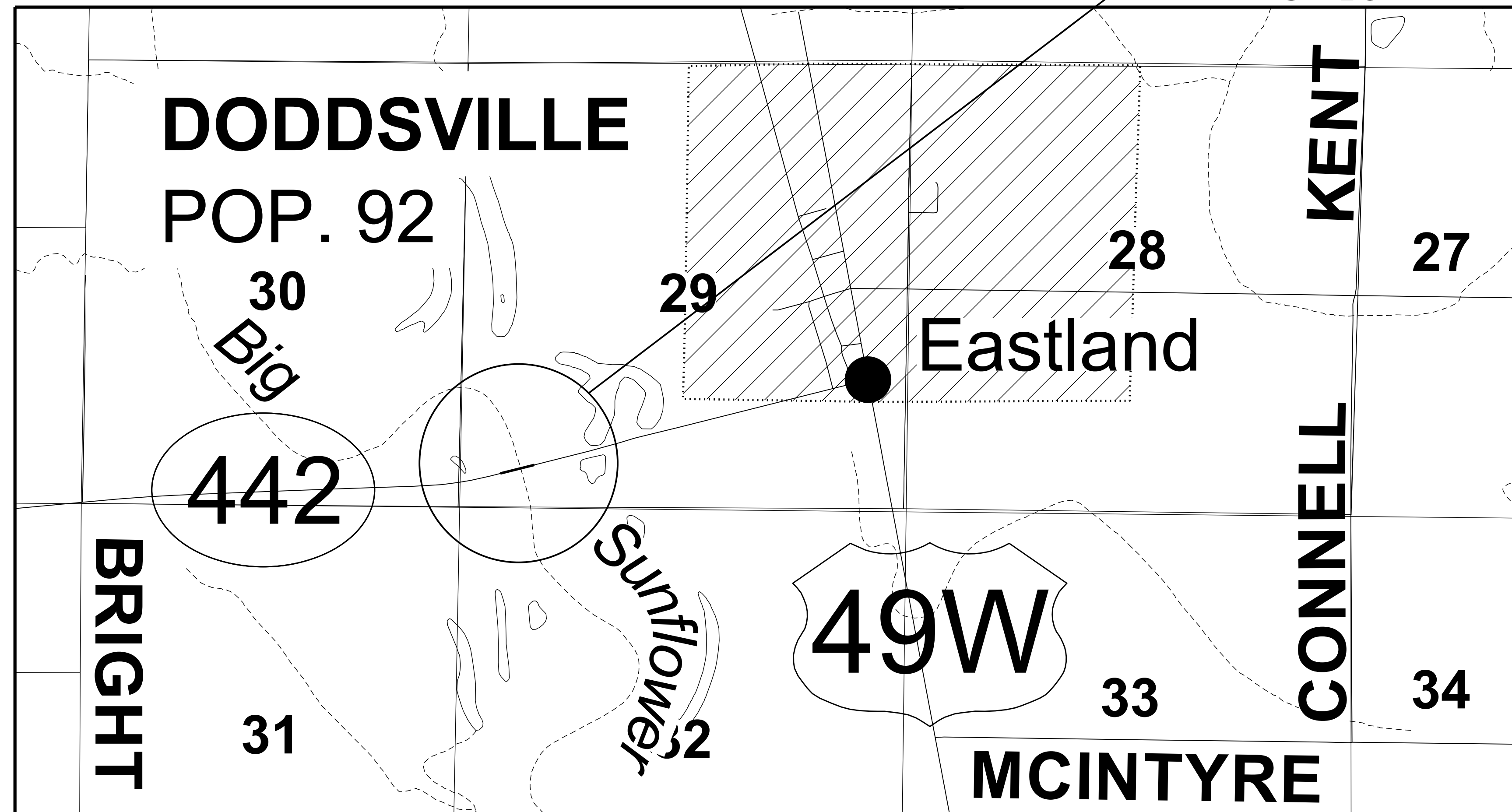

**DESIGN CONTROL**  
MPH = V (SPEED DESIGN)

ADT ( ) = : ADT ( ) =  
DHV = : D = % T = %

**PERMITS ACQUIRED BY MDOT**

WETLANDS AND WATERS PERMITS

	N	W
NATIONWIDE #14	<input checked="" type="checkbox"/>	<input checked="" type="checkbox"/>
NATIONWIDE (OTHER)*	<input checked="" type="checkbox"/>	<input checked="" type="checkbox"/>
GENERAL*	<input checked="" type="checkbox"/>	<input checked="" type="checkbox"/>
INDIVIDUAL (404)*	<input checked="" type="checkbox"/>	<input checked="" type="checkbox"/>

STORMWATER PERMIT

Y REQUIRED, CNOI SUBMITTED BY MDOT (DISTURBED AREA=5 ACRES)

S REQUIRED, SCNOI TO BE SUBMITTED BY CONTRACTOR (1 TO 4.99 ACRES)

N NO STORMWATER PERMIT REQUIRED (<1 ACRE)

APPROVED BY: \_\_\_\_\_

DESIGNED BY: WALDON

**CONSTRUCTION PROJECT DATA**

EXTERNAL PROJECT NUMBER	STBG-0612-00(011)
FMS & DETAIL	109502/301000

P S & E DATE: 2/20/2024

APPROVED:  
  
DEPUTY EXECUTIVE DIRECTOR / CHIEF ENGINEER  
  
EXECUTIVE DIRECTOR



PLAN SHEET

DATE 2:52:10 PM TITLE-442.dgn

**CONVENTIONAL SYMBOLS**

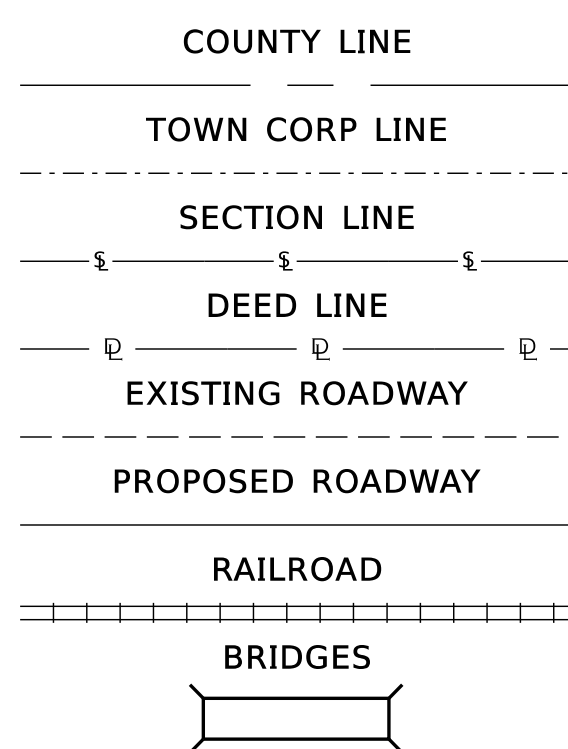

**LENGTH DATA**

LENGTH OF ROADWAY	FT.	MI.
LENGTH OF BRIDGES	FT.	MI.
LENGTH OF PROJECT (NET)	FT.	MI.
LENGTH OF EXCEPTIONS	FT.	MI.
LENGTH OF PROJECT (GROSS)	FT.	MI.

EQUATIONS

**NONE**

**SCALES**

PLAN 1 IN. = 100 FT.  
PROFILE 1 IN. = 100 FT.  
LAYOUT 1 IN. = 10 FT.  
1 IN. = 1000 FT.

EXCEPTIONS

**NONE**

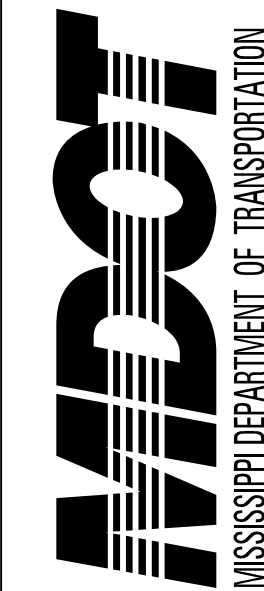

DESIGNED BY: WALDON  
 DETAILED BY:  
 CHECKED BY:  
 DATE:

FMS CON: 109502/301000  
 PROJECT NO.: STBG-0612-00(011)  
 COUNTY: SUNFLOWER

**DETAILED INDEX**

WK. NO.  
**DI-1**  
 SHEET NO.  
**2**

<u>DESCRIPTION OF SHEET</u>	<u>WK. NO. SHEET NO.</u>	
<b>TITLE SHEET (1)</b>		1
<b>DETAILED INDEX &amp; GENERAL NOTES (2)</b>		
DETAILED INDEX	DI-1	2
GENERAL NOTES	GN-1	3
<b>QUANTITY SHEETS (2)</b>		
SUMMARY OF QUANTITIES	SQ-1	4
ESTIMATED QUANTITIES - TRAFFIC CONTROL SIGNS	TCPQ-1	5
<b>SPECIAL DESIGN SHEETS (4)</b>		
DETAIL OF CONSTRUCTION SIGNING	DCS-1	6
TRAFFIC CONTROL PLAN - ROAD CLOSURE	TC-1	7
SIGN SUPPORT HARDWARE - 2.0" SQUARE POST	TSS-2	8
DETAIL OF RELOCATED RANPS	SD-1	9
<b>STANDARD DRAWINGS (14)</b>		
PAVEMENT MARKING DETAILS FOR 2-LANE & 4-LANE DIVIDED ROADWAYS	PM-1	6051
GUARDRAIL: "W" BEAM (STEEL POSTS)	GR-1B	6203
GUARDRAIL: BRIDGE END SECTIONS-TYPE "A" & "C"	GR-2	6204
GUARDRAIL: TYPICAL INSTALLATION AT BRIDGE APPROACHES FOR 2-LANE, 2-WAY HIGHWAY	GR-4A	6215
GUARDRAIL: RUB RAIL HARDWARE	GR-RR	6218
GUARDRAIL: MISCELLANEOUS HARDWARE	GR-HW	6221
TYPICAL INSTALLATION AND DETAILS OF DELINEATORS AND DISTANCE REFERENCE SIGNS	SN-8	6314
TYPICAL GUARDRAIL DELINEATION	SN-8C	6317
SIGNING DETAILS FOR BRIDGE APPROACHES	SN-9	6318
TRAFFIC CONTROL PLAN WITH FLAGGER (ONE-LANE CLOSURE OF TWO-WAY TRAFFIC)	TCP-1	6351
HIGHWAY SIGN AND BARRICADE DETAILS FOR CONSTRUCTION PROJECTS	TCP-8	6358
TRAFFIC CONTROL PLAN MOBIL OPERATIONS MULTILANE ROADS AND TWO-LANE ROADS	TCP-9	6359
TEMPORARY STRIPING FOR TRAFFIC CONTROL 2-LANE AND 4-LANE DIVIDED HIGHWAYS	TCP-13	6363
TRAFFIC CONTROL PLAN DETAILS DRUM PLACEMENT AND SHOULDER CLOSURE	TCP-16	6366
<b>SPECIAL DESIGN SHEETS - BRIDGE (SEE BRIDGE DETAILED INDEX, SHEET 8001)</b>		
<b>TOTAL SHEETS (NOT INCLUDING BRIDGE SHEETS) (23)</b>		

**WALDON**

PS & E PLANS-DATE 2/20/2024		
FMS CON. # 109502/301000		
REVISIONS		
DATE	SHEET NO.	BY

DATE 2:52:18 PM DI-1.dgn PLAN SHEET

# GENERAL NOTES

## BRIDGES AND WALLS

- ① THE BRIDGE DECKS SHALL BE GROOVED AND ALL BRIDGE JOINTS SHALL BE SEALED PRIOR TO OPENING THE BRIDGES TO TRAFFIC.
- ② STORAGE OF FLAMMABLE MATERIALS WILL NOT BE ALLOWED UNDER ANY BRIDGE STRUCTURES WITHOUT WRITTEN APPROVAL FROM THE PROJECT ENGINEER. SEE NOTICE TO BIDDERS ENTITLED "MATERIAL STORAGE UNDER BRIDGES" FOR MORE INFORMATION.

## DRAINAGE STRUCTURES

- ③ THE CONTRACTOR SHALL BE RESPONSIBLE FOR PROTECTING EXISTING STRUCTURES SUCH AS, BUT NOT LIMITED TO, PIPES, INLETS, APRONS, AND BRIDGES FROM DAMAGE WHICH MIGHT OCCUR DURING CONSTRUCTION. THE CONTRACTOR SHALL REPLACE OR REPAIR, AS DIRECTED BY THE ENGINEER, ANY STRUCTURES DAMAGED DURING THE LIFE OF THE CONTRACT. NO PAYMENT WILL BE MADE FOR REPLACEMENT OR REPAIR OF DAMAGED ITEMS.

## PLANS

- ④ IF COLORS ARE USED ON PLAN/PROFILE SHEETS, THEY ARE INTENDED TO VISUALLY EASE THE LOCATION OF ELEMENTS FOR USERS OF THESE DRAWINGS. ALTHOUGH THE INTENT IS TO CATEGORIZE EVERYTHING AS EITHER EXISTING OR PROPOSED, IT IS THE END USER'S RESPONSIBILITY TO ENSURE ALL ELEMENTS ARE INTERPRETED CORRECTLY, REGARDLESS OF COLOR.
- ⑤ ALL ADDENDA TO THESE PLANS WILL BE POSTED TO [WWW.MDOT.MS.GOV](http://WWW.MDOT.MS.GOV) UNDER THE PROPOSAL ADDENDA COLUMN. BIDDERS ARE ADVISED THAT HARD COPIES OF ANY ADDENDA FOR THIS PROJECT WILL NOT BE MAILED. IT IS THE BIDDER'S RESPONSIBILITY TO CHECK AND SEE IF ANY ADDENDA HAVE BEEN POSTED FOR THIS PROJECT.

- ⑥ SEE BRIDGE PLANS FOR DETAILED INDEX SHEET(S), ESTIMATED AND SUMMARY OF QUANTITY SHEETS, AND EROSION CONTROL SHEETS.

## TRAFFIC CONTROL - TEMPORARY

- ⑦ THE LOCATION AND SPACING OF SIGNS, SHOWN ON THE TRAFFIC CONTROL PLANS, ARE APPROXIMATE AND MAY BE ADJUSTED AS NECESSARY TO FIT FIELD CONDITIONS.
- ⑧ ALL TRAFFIC CONTROL DEVICES ON THIS PROJECT SHALL COMPLY WITH PART VI OF THE **MUTCD** (LATEST EDITION).
- ⑨ ALL PLASTIC DRUMS SHALL HAVE A BALLASTING COLLAR MADE FROM RECYCLED TRUCK TIRES OR OTHER SUITABLE MATERIAL.
- ⑩ FLUORESCENT ORANGE SHEETING SHALL BE USED ON ALL CONSTRUCTION AND TRAFFIC CONTROL SIGNS EXCEPT FOR THOSE DESIGNATED ON THE PLANS TO BE BLACK LEGEND AND BORDER ON WHITE BACKGROUND.
- ⑪ THE CONTRACTOR SHALL COORDINATE WITH THE CONTRACTOR FROM ADJACENT PROJECT(S) IN IMPLEMENTING THE TRAFFIC CONTROL PLAN AS DIRECTED BY THE ENGINEER. ALL CONFLICTING SIGNS SHALL BE COVERED OR REMOVED AS DIRECTED BY THE ENGINEER.

## TRAFFIC CONTROL - PERMANENT

- ⑫ INSTALLATION DATES SHALL BE CLEARLY WRITTEN IN BOLD BLACK MARKINGS ON THE BACK BOTTOM HALF OF ALL SIGNS WITH A PERMANENT MARKING STICK THAT IS WATERPROOF, FADE RESISTANT AND MARKS ON WET OR DRY SURFACES.
- ⑬ ALL EXISTING SIGNS WHICH ARE TO BE REMOVED AS A PART OF THIS PROJECT THAT ARE NOT IN CONFLICT WITH CONSTRUCTION SHALL REMAIN IN PLACE UNTIL NEW SIGNS ARE INSTALLED UNLESS NOTED OR DIRECTED OTHERWISE BY THE PROJECT ENGINEER. ROADWAY SIGNS THAT ARE IN CONFLICT WITH CONSTRUCTION SHALL BE REMOVED AND RELOCATED BY THE CONTRACTOR AS DIRECTED BY THE ENGINEER, THE COST OF WHICH SHALL BE ABSORBED IN OTHER ITEMS BID.
- ⑭ ALL PERMANENT SIGNS SHALL CONFORM TO THE LATEST EDITION OF THE MANUAL ON UNIFORM TRAFFIC CONTROL DEVICES.
- ⑮ THE RETROREFLECTIVE SIGN SHEETING ON PERMANENT GROUND-MOUNTED SIGNS SHALL BE AS FOLLOWS: BROWN BACKGROUND SHEETING ON GUIDE SIGNS SHALL BE MINIMUM TYPE VIII; GREEN AND BLUE BACKGROUND SHEETING ON GUIDE SIGNS SHALL BE MINIMUM TYPE IX; ALL WHITE, YELLOW, FLUORESCENT YELLOW AND FLUORESCENT YELLOW/GREEN SHEETING SHALL BE TYPE XI. ALL SIGN SHEETING ON OVERHEAD SIGNS SHALL BE TYPE XI.
- ⑯ ALL EXISTING SIGNS AND SUPPORTS REMOVED UNDER THIS PROJECT SHALL BECOME THE PROPERTY OF THE CONTRACTOR AND ARE NOT A SEPARATE PAY ITEM.

- ⑰ REMOVAL OF RAISED PAVEMENT MARKERS THAT ARE IN CONFLICT WITH REQUIRED CONSTRUCTION IS NOT CONSIDERED A SEPARATE PAY ITEM. COST TO BE ABSORBED IN OTHER ITEMS BID.

- ⑱ REMOVAL OF OBJECT MARKERS IS NOT CONSIDERED A SEPARATE PAY ITEM, AND SHALL BE ABSORBED IN OTHER ITEMS BID.

## TRAFFIC CONTROL - TEMPORARY

- ⑲ THE LOCATION AND SPACING OF SIGNS, SHOWN ON THE TRAFFIC CONTROL PLANS, ARE APPROXIMATE AND MAY BE ADJUSTED AS NECESSARY TO FIT FIELD CONDITIONS.
- ⑳ ALL TRAFFIC CONTROL DEVICES ON THIS PROJECT SHALL COMPLY WITH PART VI OF THE **MUTCD** (LATEST EDITION).
- ㉑ ALL PLASTIC DRUMS SHALL HAVE A BALLASTING COLLAR MADE FROM RECYCLED TRUCK TIRES OR OTHER SUITABLE MATERIAL.
- ㉒ FLUORESCENT ORANGE SHEETING SHALL BE USED ON ALL CONSTRUCTION AND TRAFFIC CONTROL SIGNS EXCEPT FOR THOSE DESIGNATED ON THE PLANS TO BE BLACK LEGEND AND BORDER ON WHITE BACKGROUND.
- ㉓ THE CONTRACTOR SHALL COORDINATE WITH THE CONTRACTOR FROM ADJACENT PROJECT(S) IN IMPLEMENTING THE TRAFFIC CONTROL PLAN AS DIRECTED BY THE ENGINEER. ALL CONFLICTING SIGNS SHALL BE COVERED OR REMOVED AS DIRECTED BY THE ENGINEER.
- ㉔ THE CONTRACTOR SHALL COVER OR REMOVE ANY TEMPORARY TRAFFIC CONTROL SIGNS SHOWN IN THE TRAFFIC CONTROL PLAN THAT DO NOT APPLY TO THE CURRENT PHASE.
- ㉕ THE RETROREFLECTIVE SIGN SHEETING ON RIGID, TEMPORARY TRAFFIC CONTROL (ORANGE) SIGNS SHALL BE MINIMUM TYPE IX.
- ㉖ TEMPORARY STRIPING SHALL CONFORM TO FINISHED STRIPE SPECIFICATIONS FOR ALIGNMENT, NEATNESS, AND STRAIGHTNESS.

## MISCELLANEOUS

- ㉗ SOME WORK IS REQUIRED OUTSIDE THE PROJECT LIMITS. NO ADDITIONAL COMPENSATION WILL BE MADE FOR SUCH WORK EXCEPT AS PROVIDED BY SPECIFIC PAY ITEMS INCLUDED IN THE PLANS.
- ㉘ THE CONTRACTOR IS RESPONSIBLE FOR FIELD-VERIFICATION OF EXISTING GRADES AND MAKING ADJUSTMENTS AS NECESSARY WITH THE APPROVAL OF THE PROJECT ENGINEER.
- ㉙ THE CONTRACTOR SHALL COORDINATE AND CONDUCT WORK AT LOCAL ROADS AND DRIVEWAYS IN A MANNER SUCH THAT ACCESS IS NOT INTERRUPTED UNNECESSARILY. ACCESS SHALL BE PRESERVED IN THE BEST MANNER POSSIBLE. COORDINATION AND COMMUNICATION WITH LANDOWNERS MAY BE NECESSARY TO PREVENT INTERRUPTION OF DRIVEWAY ACCESS.

## NOTICE:

THE NOTES CONTAINED HEREON ARE SPECIFIC TO THE SUBJECT PROJECT AND SHOULD BE REVIEWED IN DETAIL BY THE CONTRACTOR, PER SECTION 102.05 OF THE STANDARD SPECIFICATIONS, "THE BIDDER IS REQUIRED TO EXAMINE CAREFULLY THE SITE OF THE PROPOSED WORK, THE PROPOSAL, PLAN, STANDARD SPECIFICATION, SPECIAL PROVISIONS, NOTICES TO BIDDERS AND CONTRACT FORMS BEFORE SUBMITTING A PROPOSAL."

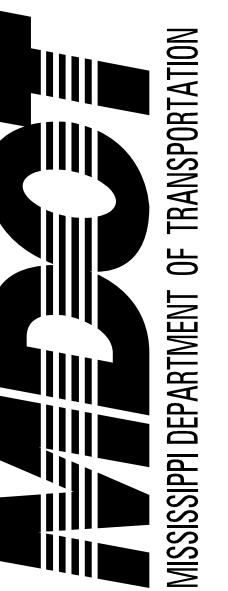

DESIGNED BY: WALDON  
 DETAILED BY:  
 CHECKED BY:  
 DATE:

FMS CON: 109502/301000  
 PROJECT NO.: STBG-0612-00(011)  
 COUNTY: SUNFLOWER

## GENERAL NOTES

WK. NO.  
**GN-1**

SHEET NO.  
**3**

PLAN SHEET

2:52:27 PM GN-1.dgn

DATE