

PLANS STAGE	DATE PRINTED
<input type="checkbox"/> FIELD REVIEW	
<input type="checkbox"/> OFFICE REVIEW	
<input type="checkbox"/> PSE	
<input type="checkbox"/> STREET READY	

STATE	PROJECT NO.
MISS	STP-0000-00(000)LPA/111111-701000

# CITY OF MAYBERRY, MISSISSIPPI

## FEDERAL AID PROJECT NO. STP-0000-00(000)LPA/111111-701000

**BRIDGE STRUCTURES REQ'D.**  
(NONE)

**BOX BRIDGES REQ'D.**  
(NONE)

**EQUATIONS**  
(NONE)

**EXCEPTIONS**  
(NONE)

### MUNICIPAL OFFICIALS

**MAYOR** ROYCE PIKE

**ALDERMEN** SAM JONES  
RAFE HOLLISTER  
JOHN MASTERS  
BEN WEAVER  
MALCOLM MERRIWEATHER

**CITY CLERK** HOWARD SPRAGUE

**PUBLIC WORKS DIRECTOR** ERNEST T. BASS

### CONSTRUCTION OF ERNEST T. BOULEVARD FROM DARLIN CIRCLE TO GOMER PYLE HIGHWAY

**SCALES**

PLAN	1 IN. = 20 FT.
PROFILE	HOR. 1 IN. = 20 FT.
	VERT. 1 IN. = 5 FT.
LAYOUT	1 IN. = 400 FT.

B.O.P. STA. 10+33.96

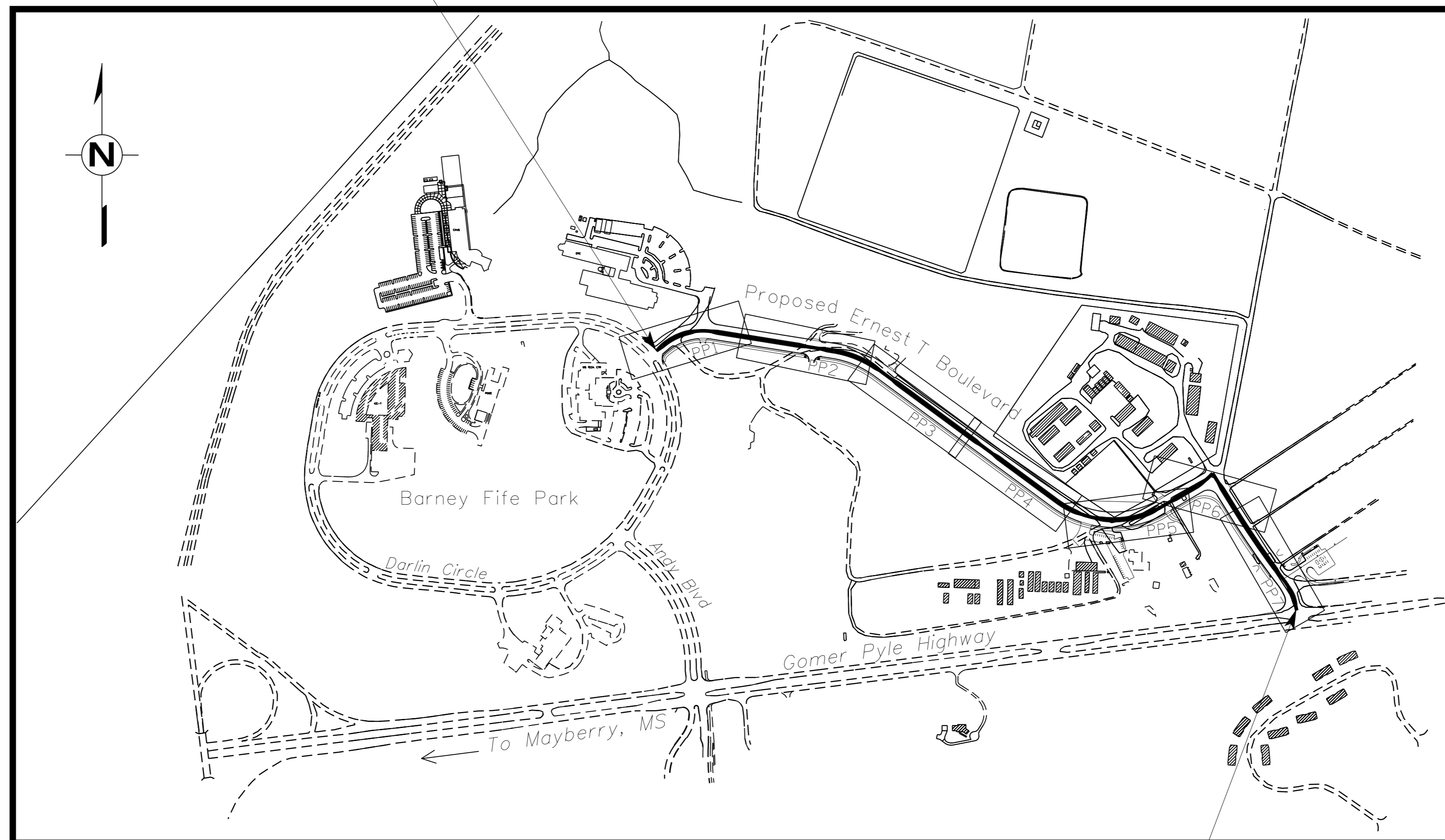

E.O.P. STA. 48+49.73

### LENGTH DATA

**CONVENTIONAL SYMBOLS**

COUNTY LINE	-----
TOWN CORPORATION LINE	-----
SECTION LINE	-----
EXISTING ROAD OR TRAVELED WAY	-----
PROPOSED ROAD OR TRAVELED WAY	-----
RAILROAD	-----
SURVEY LINE	-----
BRIDGES	-----

LENGTH OF ROADWAY	3,815.77 FT.	0.722 MI.
LENGTH OF BRIDGES	0.00 FT.	0.00 MI.
LENGTH OF PROJECT (NET)		0.722 MI.
LENGTH OF EXCEPTIONS	0.00 FT.	0.00 MI.
LENGTH OF PROJECT (GROSS)		0.722 MI.

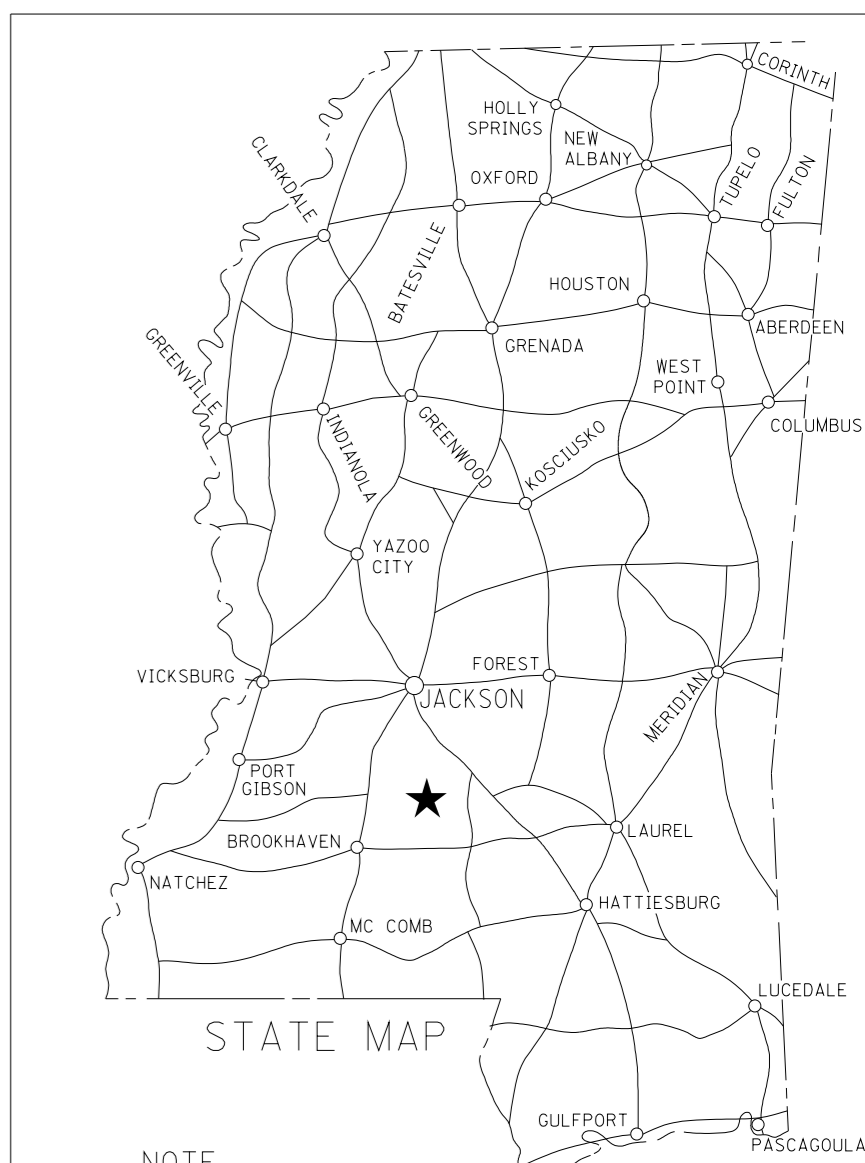

NOTE  
★ INDICATES APPROXIMATE LOCATION OF PROJECT.

LAT. 33°28'14.28" N LONG. 88°47'03.25" W  
(APPROX. MIDDLE OF PROJECT)

39730-5623  
(ZIPCODE FOR APPROX. MIDDLE OF PROJECT)

**DESIGN CONTROL**

30 MPH = V (SPEED DESIGN)

ADT (2020) = 2,900 ADT (2030) = 3,600

DHV = 480 D = 60% T = 10%

**PERMITS**

WETLANDS AND WATERS PERMITS (NECESSARY FOR ULTIMATE IMPROVEMENTS ONLY):

	WATERS	WETLANDS
NATIONWIDE #14	<input checked="" type="checkbox"/> Y	<input type="checkbox"/> N
NATIONWIDE (OTHER)*	<input type="checkbox"/> N	<input type="checkbox"/> N
GENERAL*	<input type="checkbox"/> N	<input type="checkbox"/> N
INDIVIDUAL (404)*	<input type="checkbox"/> N	<input type="checkbox"/> N

\* ACQUISITION OF PERMITS FOR TEMPORARY IMPACTS DURING CONSTRUCTION ARE THE RESPONSIBILITY OF THE LPA

**STORMWATER PERMIT**  Y

Y REQUIRED, CNOI SUBMITTED BY LPA (DISTURBED AREA=5 ACRES+)

S REQUIRED, SCNOI TO BE SUBMITTED BY LPA (1 TO 4.99 ACRES)

N NO STORMWATER PERMIT REQUIRED (<1 ACRE)

APPROVED BY: F.M.L. DATE: 5-4-11

ROYCE PIKE, MAYOR DATE

PREPARED BY: ANDY GRIFFITH, P.E.  
MS LICENSE NO. 1111

DATE

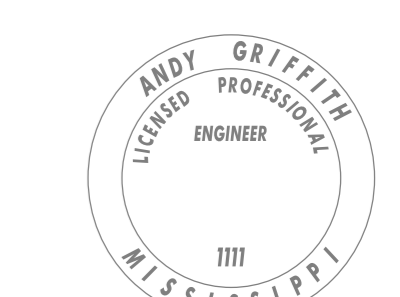

11/15/2012 9:31 AM TITLEXAMPLE.DGN