

1st O. REV. GENERAL INDEX

FOR DETAILED INDEX OF PLANS SEE SHEET NO. 2

DESCRIPTION	NUMBER OF SHEETS
TITLE SHEET	1
INDEX	1
ARCHITECTURAL	13
STRUCTURAL	6
MECHANICAL	5
PLUMBING	2
ELECTRICAL	5

TOTAL SHEETS 33

STATE OF MISSISSIPPI
MISSISSIPPI DEPARTMENT OF TRANSPORTATION

ALTERATIONS AND ADDITIONS TO DISTRICT FIVE LAB AT NEWTON

STATE PROJECT NO. BWO-5052-51(003)
501501

NEWTON COUNTY

01-9-07

FED. ROAD REG. NO.	STATE	PROJECT NO.	SHEET NO.
4	MISS.		1

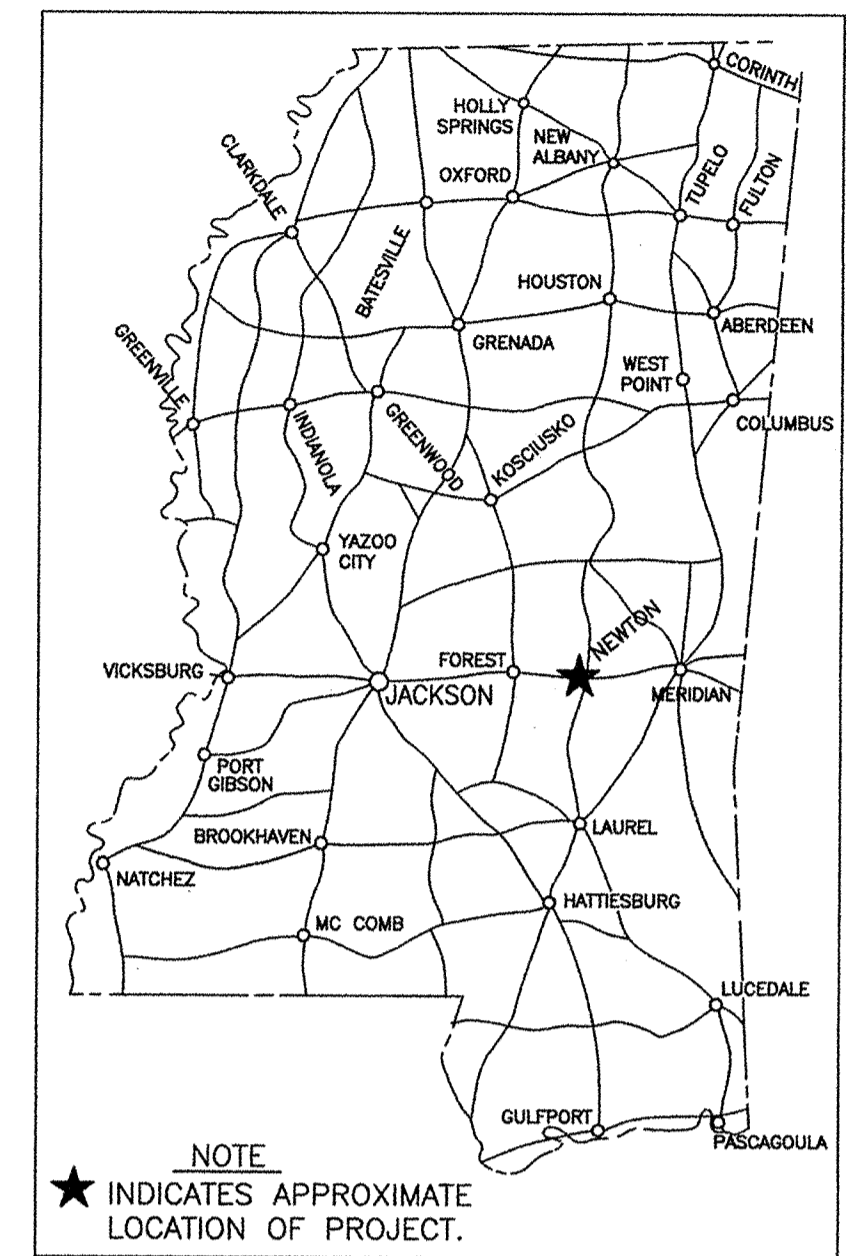

DESIGN CONTROL
MPH = V (SPEED DESIGN)

ADT () = : ADT () =

DHV = : D = % T = %

PERMITS ACQUIRED BY MDOT

WETLANDS AND WATERS PERMITS (NECESSARY FOR ULTIMATE IMPROVEMENTS ONLY):

	WATERS	WETLANDS
NATIONWIDE #14	<input checked="" type="checkbox"/>	<input checked="" type="checkbox"/>
NATIONWIDE (OTHER)*	<input checked="" type="checkbox"/>	<input checked="" type="checkbox"/>
GENERAL*	<input checked="" type="checkbox"/>	<input checked="" type="checkbox"/>
INDIVIDUAL (404)*	<input checked="" type="checkbox"/>	<input checked="" type="checkbox"/>

* ACQUISITION OF PERMITS FOR TEMPORARY IMPACTS DURING CONSTRUCTION ARE THE RESPONSIBILITY OF THE CONTRACTOR.

STORMWATER PERMIT

Y REQUIRED, CNOI SUBMITTED BY MDOT (DISTRIBUTED AREA=6 ACRES)(NTB 6484)

S REQUIRED, CNOI TO BE SUBMITTED BY CONTRACTOR (1 TO 4.99 ACRES)(NTB 6483)

N NO STORMWATER PERMIT REQUIRED (<1 ACRE)

APPROVED BY: _____ DATE: _____

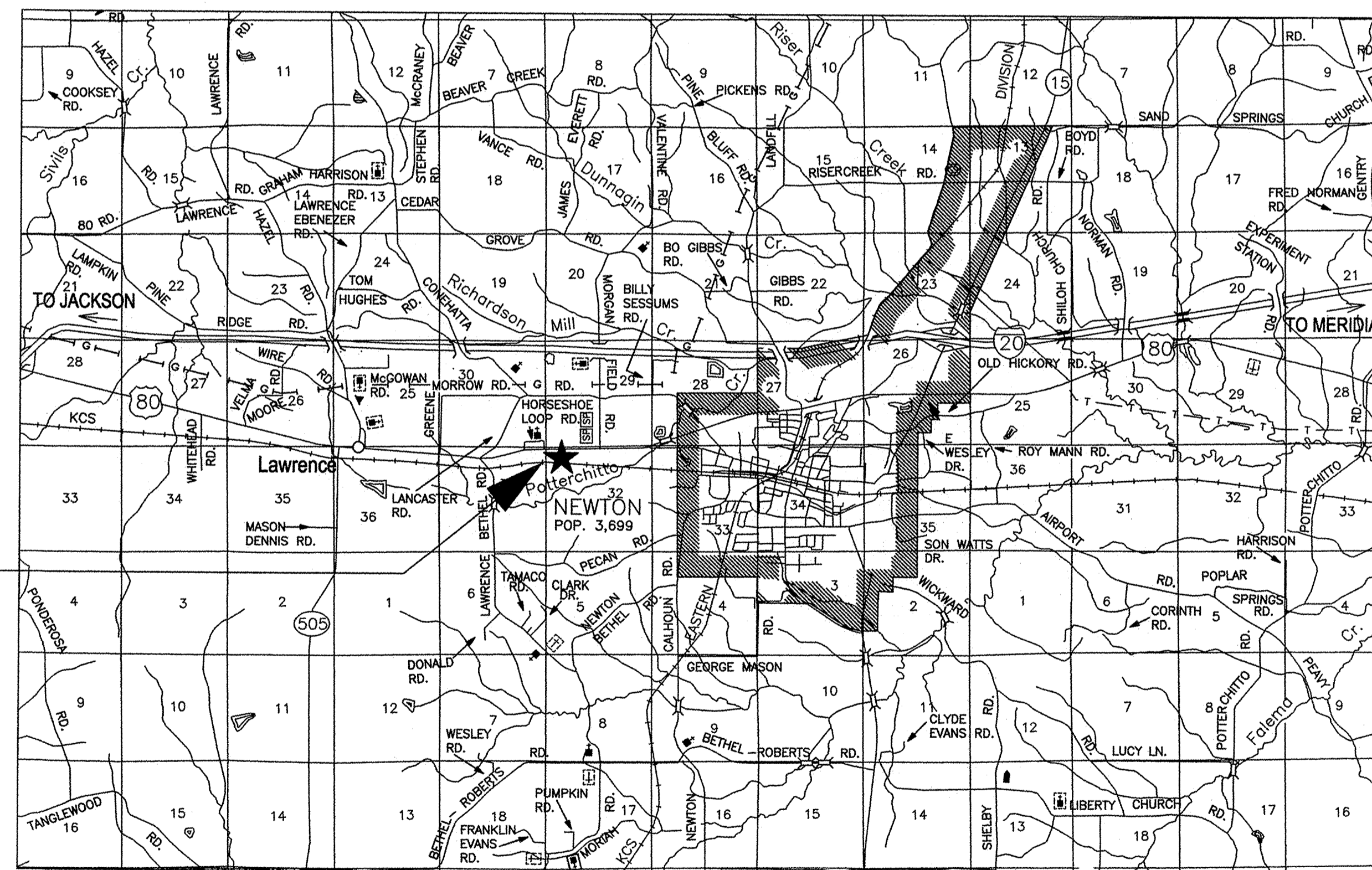

DISTRICT OFFICE
7759 HWY 80W

CONVENTIONAL SYMBOLS

- COUNTY LINE _____
- TOWN CORPORATION LINE _____
- SECTION LINE _____
- EXISTING ROAD OR TRAVELED WAY _____
- EXISTING DIVIDED HIGHWAY _____
- RAILROAD _____
- SURVEY LINE _____
- BRIDGES _____

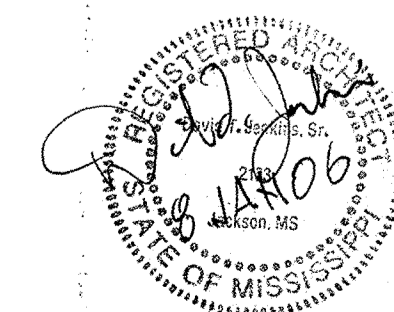

REV. NO.	REV. JOB TITLE	DATE	BY
1	REVISED	1/9/07	ASW
2	REVISED	1-9-07	

APPROVED: *James L. James* 1/9/07
CHIEF ENGINEER DATE

Samuel R. Brown 1-9-07
EXECUTIVE DIRECTOR DATE

MISSISSIPPI DEPARTMENT OF TRANSPORTATION

APPROVED: _____
DIVISION ADMINISTRATOR DATE

FEDERAL HIGHWAY ADMINISTRATION
DEPARTMENT OF TRANSPORTATION

TITLE: ROADWAY DESIGN, DISTRICT FIVE LABORATORY AT NEWTON, MISSISSIPPI DEPARTMENT OF TRANSPORTATION

STANDARD ARCHITECTURAL ABBREVIATIONS:

ABBREV.	ABBREVIATION	F.E.	FIRE EXTINGUISHER
A.B.	ANCHOR BOLT	F.F.	FINISH FLOOR
A/C.	AIR CONDITIONED	FIN.	FINISH
A.C.T.	ACOUSTICAL CEILING TILE	FL.	FLOOR
A.C.U.	AIR CONDITIONING UNIT	F.P.	FIRE PARTITION
A.D.	ACCESS DOOR	FR.	FRAME
ADJ.	ADJUSTABLE	F.S.	FULL SIZE
A.F.F.	ABOVE FINISH FLOOR	FTG.	FOOTING
ALT.	ALTERNATE	F.V.	FIRE HOSE VALVE
ALUM.	ALUMINUM	GA.	GAUGE
A.M.	ACOUSTICAL MATERIAL	G.B.	GRAB BAR
A.P.	ACCESS PANEL	G.C.	GENERAL CONTRACTOR
BAMT.	BASEMENT	G.I.	GALVANIZED IRON
B.BD.	BULLITEN BOARD	GL.	GLASS
BIT.	BITUMINOUS	GR.	GRADE
BLDG.	BUILDING	GWB.	GYPSON WALL BOARD
BLK.	BLOCKING	GYP.	GYPSON
B/O	BY OWNER	H.B.	HOSE BIBB
B/OF	BY OWNER-FUTURE	HDW.	HARDWARE
BRL	BRICK LEDGE	H.M.	HOLLOW METAL
CAB.	CABINET	H.P.	HIGH POINT
C.B.	CHALK BOARD	H.R.	HAND RAIL
CEM.	CEMENT	HT.	HEIGHT
C.G.	CORNER GUARD	HTG.	HEATING
C.I.P.	CAST-IN-PLACE	H.W.	HOT WATER
C.J.	CONTROL JOINT	1 HR.	ONE HOUR
CL.	CLEAR	2 HR.	TWO HOUR
CLG.	CEILING	I.D.	INSIDE DIAMETER
CLO.	CLOSET	IN.	INCH
CMU	CONCRETE MASONRY UNIT	INSUL.	INSULATION
C.O.	CASED OPENING	INT.	INTERIOR
COL.	COLUMN	I.P.S.	INSIDE PIPE SIZE
CONC.	CONCRETE	JAN.	JANITOR
CONF.	CONFERENCE	JT.	JOINT
CONST.	CONSTRUCTION	KIT.	KITCHEN
CONT.	CONTINUOUS	K.P.	KICK-PLATE
CONTR.	CONTRACTOR	LAB.	LABORATORY
COORD.	COORDINATE	LAM.	LAMINATE
CORR.	CORRIDOR	L.A.T.	LAY-IN ACOUSTICAL TILE
CPT.	CARPET	LAV.	LAVATORY
C.R.S.	CORRISION RESISTIVE STEEL	LKR.	LOCKER
C.S.	CLEAR SEALED	L.P.	LOW POINT
C.T.	CERAMIC TILE	LT.	LIGHT
C.T.P.	CERAMIC TILE PANEL	LTG.	LIGHTING
CTR.	COUNTER	LVR.	LOUVER
C.W.	COLD WATER	MATL.	MATERIAL
DET.	DETAIL	MAX.	MAXIMUM
DIA.	DIAMETER	M.C.O.	METAL CASED OPENING
DIAG.	DIAGONAL	M.D.S.	METAL DIVIDER STRIP
DIM.	DIMENSION	MECH.	MECHANICAL
DISP.	DISPENSER	M.E.S.	METAL EDGE STRIP
DN.	DOWN	MET.	METAL
D.S.	DOWN SPOUT	MFG.	MANUFACTURER
DWG.(S)	DRAWING(S)	MGMT.	MANAGEMENT
E.C.	ELECTRICAL CLOSET	MIN.	MINIMUM
EL.	ELEVATION	MIR.	MIRROR
ELEC.	ELECTRICAL	MISC.	MISCELLANEOUS
ELEV.	ELEVATION	MLDG.	MOULDING
E.J.	EXPANSION JOINT	M.O.	MASONRY OPENING
E.O.	ELECTRICAL OUTLET	MOD.	MODIFIED
E.P.	ELECTRICAL PANEL	M.P.	MOVABLE PARTITION
EPY.	EPOXY COATING	M.T.	METAL THRESHOLD
EQUIP.	EQUIPMENT	MTD.	MOUNTED
E.W.C.	ELECTRIC WATER COOLER	N/A	NOT APPLICABLE
EXIST.	EXISTING	(N)	NEW
EXP.	EXPANSION	N.C.	NON-CORROSIVE
EXT.	EXTERIOR	N.I.C.	NOT IN CONTRACT
F.A.I.	FRESH AIR INTAKE	N.L.	NEOPRENE LATEX
FBR.	FACE BRICK	NOM.	NOMINAL
F.C.U.	FAN COIL UNIT	OBS.	OBSOLETE
F.D.	FLOOR DRAIN	O.C.	ON CENTER

1 st O. REV.

INDEX OF DRAWINGS

COVER INDEX	COVER SHEET INDEX SHEET
D1.1	DEMOLITION PLAN
A1.1	FLOOR PLAN
A1.2	REFLECTED CEILING PLAN
A1.3	ROOF PLAN
A2.1	BUILDING ELEVATIONS
A3.0	PARTITION TYPES, PLAN DETAILS, & MISC. DETAILS
A3.1	WALL SECTIONS
A3.2	WALL SECTIONS
A3.3	SECTION DETAILS
A3.4	SECTION DETAILS
A4.1	PLAN ENLARGEMENTS, INTERIOR ELEVATIONS, MILLWORK SECTIONS
A5.1	FINISH SCHEDULE, DOOR SCHEDULE, & DOOR/WINDOW DETAILS
A5.2	DOOR/WINDOW DETAILS
S1.1	FOUNDATION PLAN
S1.2	ROOF FRAMING PLAN
S2.1	BUILDING SECTIONS
S3.1	FOUNDATION DETAILS
S3.2	ROOF DETAILS
S3.3	ROOF DETAILS
M1	FLOOR PLAN - DEMOLITION
M2	FLOOR PLAN -H.V.A.C.
M3	DETAILS
M4	SCHEDULES
M5	CONTROLS
P1	FLOOR PLAN - PLUMBING DEMOLITION
P2	FLOOR PLAN - PLUMBING
E1.1	ELECTRICAL LEGEND /ELECTRICAL SITE PLAN
E2.1	LIGHTING FLOOR PLAN/DEMOLITION FLOOR PLAN
E2.2	POWER & COMMUNICATIONS FLOOR PLAN
E3.2	ELECTRICAL TYPICAL DETAILS
E4.1	ELECTRICAL SCHEDULES/POWER RISER DIAGRAM

STATE	PROJECT NO.
MISS.	BWO-5052-51(003)

ARCHITECTURAL SYMBOLS:

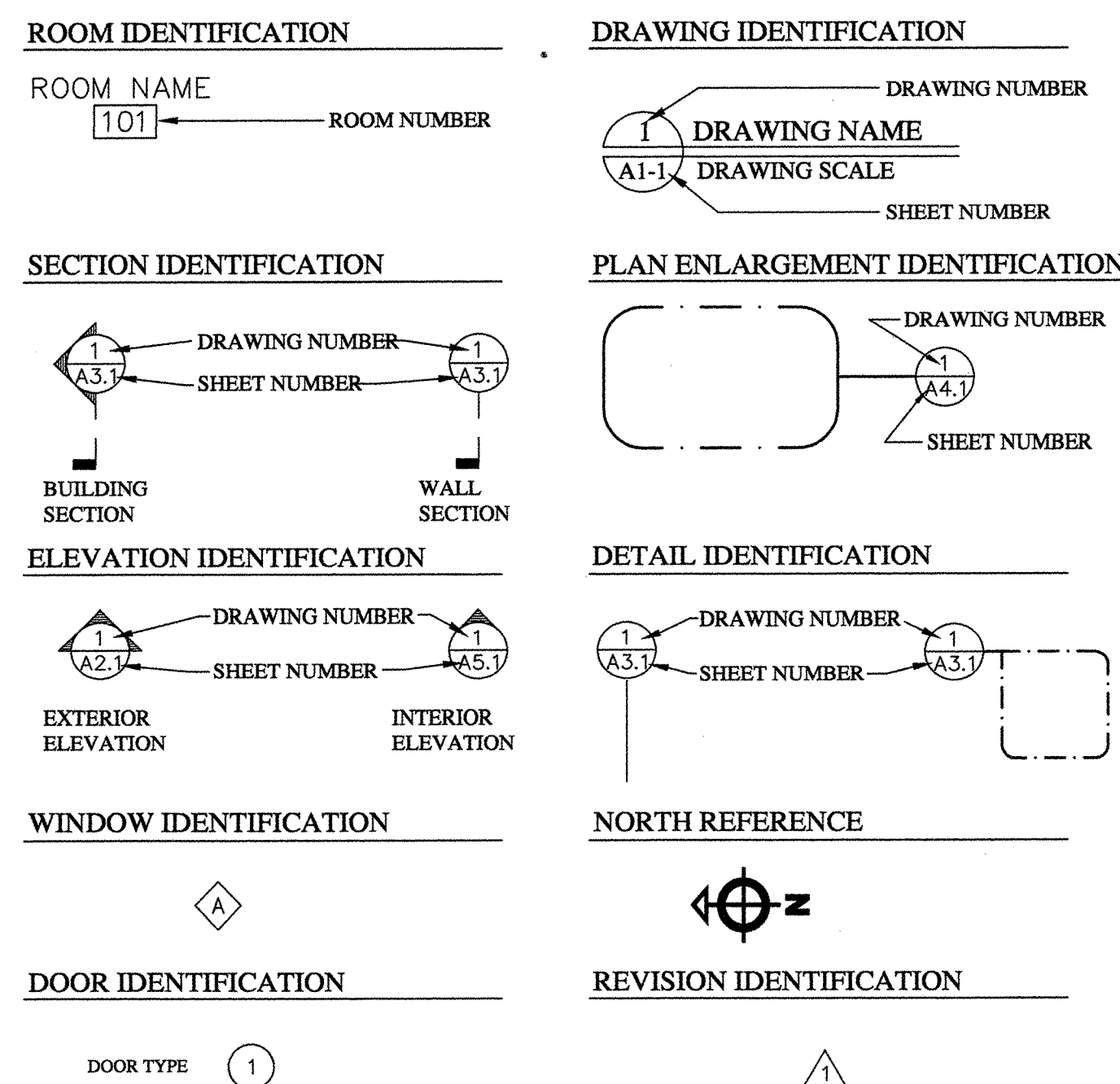

PS & E PLANS-DATE 01/09/07		
REVISIONS		
DATE	SHEET NO.	BY
1-11-07	1	BC

Architect:
 Barlow • Eddy • Jenkins, P.A.
 Architecture • Planning
 1530 North State Street
 Jackson, Mississippi 39202

Mechanical:
 Scott C. Woods & Associates, P.A.
 112 Lone Wolf Dr.
 Madison, Mississippi 39110

Structural:
 2nd Moment, LLC
 P.O. Box 889
 Florence, Mississippi 39073

Electrical:
 Watkins - O'Gwynn
 4523 OFFICE PARK DRIVE
 Jackson, Mississippi 39206

Asu

MISSISSIPPI DEPARTMENT OF TRANSPORTATION
 ALTERATIONS AND ADDITIONS TO
 DISTRICT FIVE LAB AT NEWTON

INDEX SHEET

WORKING NUMBER	BWO-5052-51(003) NEWTON COUNTY
INDEX	INDEX
SHEET NUMBER	2

FILENAME: INDEX.DGN
 DESIGN TEAM B E J P.A. CHECKED DTJ DATE 01/10/07



120806 08:00 AM INDEX.DGN MISSISSIPPI DEPARTMENT OF TRANSPORTATION ROADWAY DESIGN DIVISION