

SECTION 905 -- PROPOSAL (CONTINUED)

I (We) hereby certify by digital signature and electronic submission via Bid Express of the Section 905 proposal below, that all certifications, disclosures and affidavits incorporated herein are deemed to be duly executed in the aggregate, fully enforceable and binding upon delivery of the bid proposal. I (We) further acknowledge that this certification shall not extend to the bid bond or alternate security which must be separately executed for the benefit of the Commission. This signature does not cure deficiencies in any required certifications, disclosures and/or affidavits. I (We) also acknowledge the right of the Commission to require full and final execution on any certification, disclosure or affidavit contained in the proposal at the Commission's election upon award. Failure to so execute at the Commission's request within the time allowed in the Standard Specifications for execution of all contract documents will result in forfeiture of the bid bond or alternate security.

Bidder acknowledges receipt of and has added to and made a part of the proposal and contract documents the following addendum (addenda):

ADDENDUM NO. 1 DATED 6/21/2017 ADDENDUM NO. DATED
 ADDENDUM NO. DATED ADDENDUM NO. DATED

Number	Description
1	Revised NTB No. 146; Amendment EBS Download Required.

TOTAL ADDENDA: 1
 (Must agree with total addenda issued prior to opening of bids)

Respectfully Submitted,

DATE _____

 Contractor

BY _____
 Signature

TITLE _____

ADDRESS _____

CITY, STATE, ZIP _____

PHONE _____

FAX _____

E-MAIL _____

(To be filled in if a corporation)

Our corporation is chartered under the Laws of the State of _____ and the names, titles and business addresses of the executives are as follows:

 President Address

 Secretary Address

 Treasurer Address

The following is my (our) itemized proposal.

MP-2000-00(084)/ 306163301000

District 2 County(ies)

MISSISSIPPI DEPARTMENT OF TRANSPORTATION

SECTION 904 - NOTICE TO BIDDERS NO. 146

CODE: (SP)

DATE: 05/20/2017

SUBJECT: Scope of Work

PROJECT: MP-2000-00(084) / 306163301 – District Wide

The contract documents do not include an official set of construction plans but may, by reference; include some Standard Drawings when so specified in a Notice to Bidders entitled, "Standard Drawings". All other references to plans in the contract documents and Standard Specifications for Road and Bridge Construction are to be disregarded.

Work on the project shall consist of the following:

The Contractor is advised to follow the written description in the tables below for the placement of raised pavement markers rather than the county maps. The Contractor shall be responsible for furnishing and placing High Performance Raised Pavement Markers (HPRPMs) in accordance with Section 627 of the Standard Specifications and in accordance with the enclosed Standard Drawings PM-1, PM-2, PM-3, PM-4 and PM-8 as applicable. Also enclosed are maps of each county within the District showing the routes or the segments of routes on which HPRPMs are to be placed. Estimated quantities are shown by County.

The Contractor shall be responsible for removal of all existing raised pavement markers (RPMs) on any routes where they are currently located prior to placement of the new HPRPMs. The Contractor shall take all necessary precautions to insure that the underlying pavement is not damaged during removal of the existing RPMs and shall be responsible for any pavement damage resulting from the removal process. At the discretion of the Engineer, existing RPMs that are severely embedded into the pavement may be allowed to remain in place. In no case shall existing RPMs be removed more than one week prior to the placement of the new HPRPMs. This work will not be measured for separate payment, the cost shall be included in the unit prices of other items bid.

The Contractor will be further responsible for establishing all the necessary controls to insure that the HPRPMs are installed in a uniform line in accordance with the above mentioned detail sheets. The Contractor is also responsible for all pavement surface cleaning or other preparation necessary prior to placement of the HPRPMs to insure a proper bond. This work will not be measured for separate payment, the cost shall be included in the unit prices of other items bid.

The Contractor shall provide all signs and traffic handling devices necessary to safely maintain traffic around and through the work area. This shall include both vehicular and pedestrian traffic.

The Contractor is further advised that at the final inspection, all HPRPMs that are missing or damaged shall be replaced and will not be measured for separate payment.

Incidental work that is necessary to complete the work will not be measured for separate payment and the cost will be included in the unit prices of other items bid.

County	Length	HPRPMs	
		Yellow	Red-Clear
Attala	39.224	4,849	641
Calhoun	74.155	7,087	
Carroll	60.542	4,245	3,318
Grenada	66.301	9,815	2,503
Lafayette	72.728	4,772	5,023
Leflore	60.931	5,895	3,396
Montgomery	45.911	4,367	1,981
Quitman	63.301	5,570	
Tallahatchie	87.618	8,584	237
Yalobusha	108.654	9,077	4,658
Total	679.365	64,261	21,757

Attala County					
Route	Termini		Length	HPRPMs	
	Begin	End		Yellow	Red-Clear
14	SR 43	SR19/SR 14	10.119	911	
19	Winston Cnty Line	SR 14	10.705	963	
35	Kosciusko CL	SR 12	2.465	1,282	641
429	SR 14	SR 12	6.540	654	
731	SR 35 Bypass	Gilliland Street	1.319	132	
	Begin State Main.	SR 12	0.089	26	
735	SR 12	Urban Limit	0.614	61	
	Urban Limit	End State Main.	1.441	241	
	Begin State Main.	SR 12	1.482	148	
736			2.020	202	
739			1.800	166	
741			0.630	63	
Total			39.224	4,849	641

Calhoun County					
Route	Termini		Length	HPRPMs	
	Begin	End		Yellow	Red-Clear
8	Grenada Cnty Line	SR 9	9.747	975	
8	SR 9	SR 8	4.016	402	
9	Webster Cnty Line	SR 8	6.406	538	
330	Yalobusha Cnty Line	SR 32	7.180	718	
32	Yalobusha Cnty Line	SR330	11.146	1,003	
341	Chickasaw Cnty Line	SR 8	4.683	468	
	SR 8	SR 32	13.291	1,329	
	SR 32	Pontotoc Cnty Line	1.376	138	
9W	SR 9	Lafayette Cnty Line	11.520	1,037	
331	SR 9	Lafayette Cnty Line	4.790	479	
Total			74.155	7,087	

Carroll County					
Route	Termini		Length	HPRPMs	
	Begin	End		Yellow	Red-Clear
35	Attala Cnty Line	US 51	4.357	436	
	US 51	I-55	2.234	223	
	Begin State Main.	Grenada Cnty Line	13.800	1,380	
51	Holmes Cnty Line	Montgomery Cnty Line	14.480	1,448	
82	SR 17	Montgomery Cnty Line	10.710		1,842
7	Leflore Cnty Line	Grenada Cnty Line	5.660	566	
17	US 82	End State Main.	1.390	139	
404	I-55	Montgomery Cnty Line	0.530	53	
I-55	0.5 mi S/O SR 35	Montgomery Cnty Line	5.984		1,197
	Montgomery Cnty Line	SR 404	1.397		279
Total			60.542	4,245	3,318

Grenada County					
Route	Termini		Length	HPRPMs	
	Begin	End		Yellow	Red-Clear
7	Carroll Cnty Line	SR 8	8.380	804	
8	Tallahatchie Cnty Line	SR 35	6.017	542	
	SR 35 (North)	SR 35 (South)	3.765	339	
	SR 35 (South)	I-55	8.210	1,807	589
	US 51	SR 333	1.209	431	314
	SR 333	Calhoun Cnty Line	16.863	2,050	315
51	Montgomery Cnty Line	1 m/so SR 8	6.318	1,410	674
	1 m/so SR 8	SR 8	1.063	553	276
	SR 8	SR 332	1.759	730	335
	SR 332	SR 7	5.172	465	
	SR 7	Yalobusha Cnty Line	2.829	240	
35	SR 8	Tallahatchie Cnty Line	1.906	191	
332	US 51	End State Main.	2.810	253	
Total			66.301	9,815	2,503

Lafayette County					
Route	Termini		Length	HPRPMs	
	Begin	End		Yellow	Red-Clear
7	Yalobusha Cnty Line	SR 9W	12.058	1,206	
278	Panola Cnty Line	West Oxford CL	8.654		1,731
	East Oxford CL	Pontotoc Cnty Line	15.493		3,099
30	Begin State Main.	SR 7	0.200		40
	SR 7	Union Cnty Line	16.250	1,592	66
331	Calhoun Cnty Line	SR 334	8.630	863	
334	Begin State Main.	1 mile E/O CR# 418	5.479	548	
738			0.536	20	87
315	Yalobusha Cnty Line	Panola Cnty Line	4.158	416	
733	SR 328	End State Main.	0.890	89	
812			0.380	38	
Total			72.728	4,772	5,023

Leflore County					
Route	Termini		Length	HPRPMs	
	Begin	End		Yellow	Red-Clear
49E	SR 442	Tallahatchie Cnty Line	4.608	461	
82	Sunflower Cnty Line	US 49E	13.799		2,760
7	Humphreys Cnty Line	US 82	21.485	2,149	
	US 82	Greenwood CL	1.150	598	299
	Greenwood CL	Carroll Cnty Line	6.035	815	16
8	Sunflower Cnty Line	Tallahatchie Cnty Line	8.600	860	
706	US 49E	RR Crossing	0.370	56	
430	US 82	Carroll Cnty Line	4.244	933	239
744			0.230	23	
743			0.410		82
Total			60.931	5,895	3,396

Montgomery County					
Route	Termini		Length	HPRPMs	
	Begin	End		Yellow	Red-Clear
51	Winona CL (South)	US 82	2.762	2,034	139
	Winona CL (North)	Grenada Cnty Line	11.543	1,304	
82	Carroll Cnty Line	End Conc. Section	1.498		389
	End Conc. Section	Webster Cnty Line	22.294	222	1,453
407	Attala Cnty Line	Winston Cnty Line	3.800	380	
	Winston Cnty Line	US 51	3.374	337	
745	Vaiden-Kilmicrael Rd	SR 413	0.640	90	
Total			45.911	4,367	1,981

Quitman County					
Route	Termini		Length	HPRPMs	
	Begin	End		Yellow	Red-Clear
3	SR 278	Panola Cnty Line	14.770	1,182	
278	Coahoma Cnty Line	SR 3	10.701	803	
322	Coahoma Cnty Line	SR 3	8.574	857	
	SR 3	Panola Cnty Line	9.803	980	
316	Coahoma Cnty Line	SR 6	6.043	604	
315	Coahoma Cnty Line	SR 3	12.320	1,047	
	SR 3	Panola Cnty Line	0.800	68	
714	RR (Sledge)	SR 3	0.290	29	
Total			63.301	5,570	

Tallahatchie County					
Route	Termini		Length	HPRPMs	
	Begin	End		Yellow	Red-Clear
49E	Leflore Cnty Line	SR 32 E	10.175	1,018	
	SR 32 E	US 49 W	6.429	643	
49	US 49 W	Coahoma Cnty Line	1.886	161	21
49 W	Coahoma Cnty Line	US 49	1.930	193	
321	SR 32	Brazil	5.908	591	
32	Sunflower Cnty Line	US 49 E	7.761	776	
	Cassidy Bayou	SR 35	15.250	1,525	
	SR 35	Yalobusha Cnty Line	11.089	1,053	216
734			0.250	40	
35	Grenada Cnty Line	SR 32 E	12.480	1,148	
	SR 32	Panola Cnty Line	10.980	1,098	
728			0.660	66	
724			0.820	98	
726			0.660	40	
732			1.140	114	
727			0.200	20	
Total			87.618	8,584	237

Yalobusha County					
Route	Termini		Length	HPRPMs	
	Begin	End		Yellow	Red-Clear
51	SR 727	Panola Cnty Line	7.600	760	
330	US 51	I-55	2.391	239	
	I-55	SR 7	11.900	1,190	
	SR 7	SR 32	11.800	1,180	
32	Tallahatchie Cnty Line	US 51	1.183	106	
	US 51	SR 315	17.457	1,746	
	SR 315	Calhoun Cnty Line	10.169	1,017	
315	Blackmur Library	SR 32	8.125	813	
	SR 7	Lafayette Cnty Line	0.810	100	
727			0.990	89	
7	Grenada Cnty Line	Lafayette Cnty Line	23.828	1,837	1,433
55	0.4 mi N/O 330	Panola Cnty Line	12.401		3,225
Total			108.654	9,077	4,658

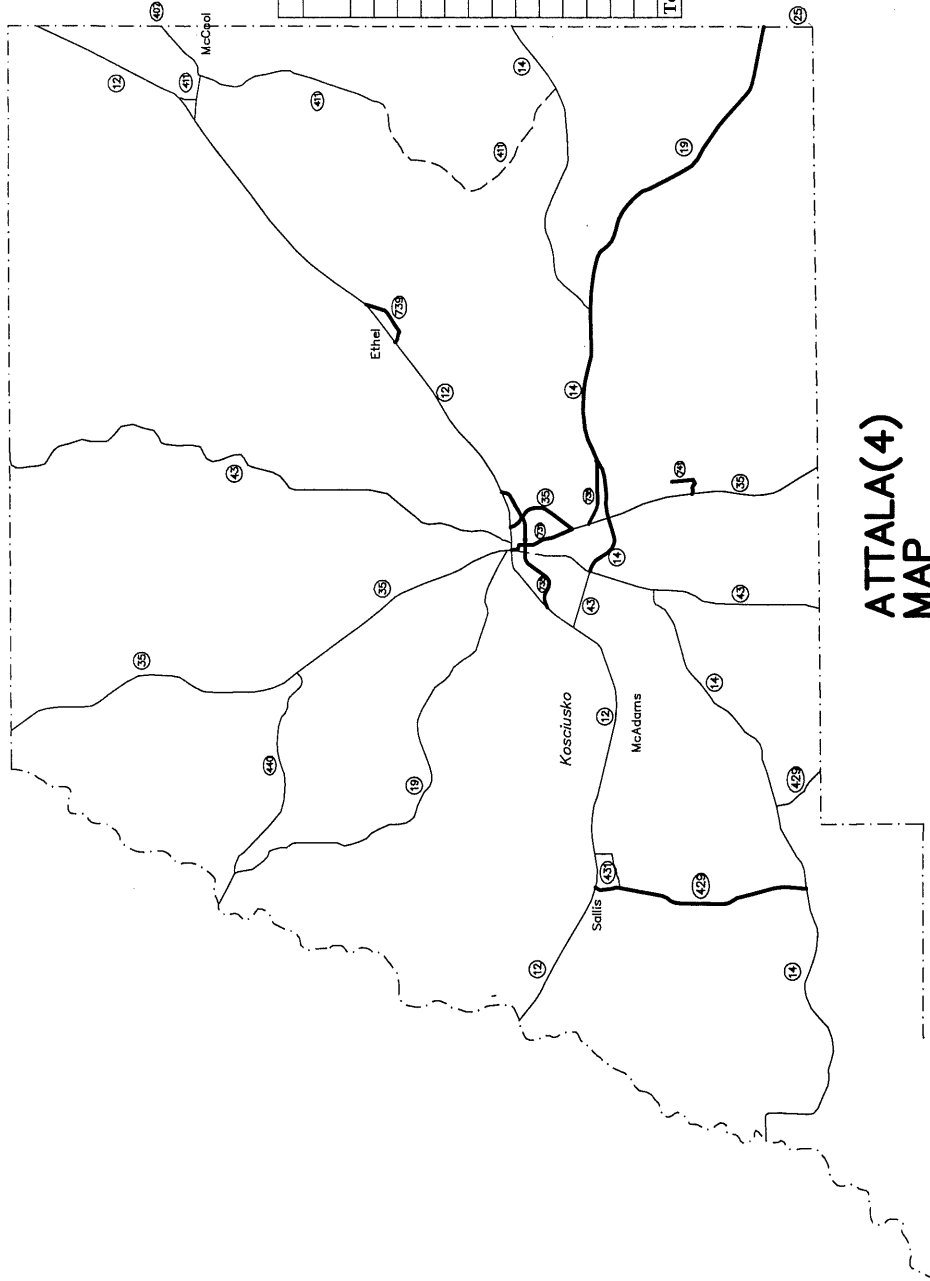

**ATTALA(4)
MAP**

Route	Termini		Length	HPRPMs	
	Begin	End		Yellow	Red-Clear
14	SR 43	SR19/SR 14	10.119	911	
19	Winston Cmty Line	SR 14	10.705	963	
35	Kosciusko CL	SR 12	2.465	1,282	641
429	SR 14	SR 12	6.540	654	
731	SR 35 Bypass	Gilliland Street	1.319	132	
735	Begin State Main.	SR 12	0.089	26	
	Urban Limit	SR 12	0.614	61	
	Urban Limit	End State Main.	1.441	241	
	Begin State Main.	SR 12	1.482	148	
736			2.020	202	
739			1.800	166	
741			0.630	63	
Total			39.224	4,849	641

Route	Termini		Length	HPRPMs	
	Begin	End		Yellow	Red-Clear
8	Grenada Cnty Line	SR 9	9,747	975	
8	SR 9	SR 8	4,016	402	
9	Webster Cnty Line	SR 8	6,406	538	
330	Yalobusha Cnty Line	SR 32	7,180	718	
32	Yalobusha Cnty Line	SR330	11,146	1,003	
341	Chickasaw Cnty Line	SR 8	4,683	468	
	SR 8	SR 32	13,291	1,329	
	SR 32	Ponatoe Cnty Line	1,376	138	
9W	SR 9	Lafayette Cnty Line	11,520	1,037	
331	SR 9	Lafayette Cnty Line	4,790	479	
Total			74,155	7,087	0

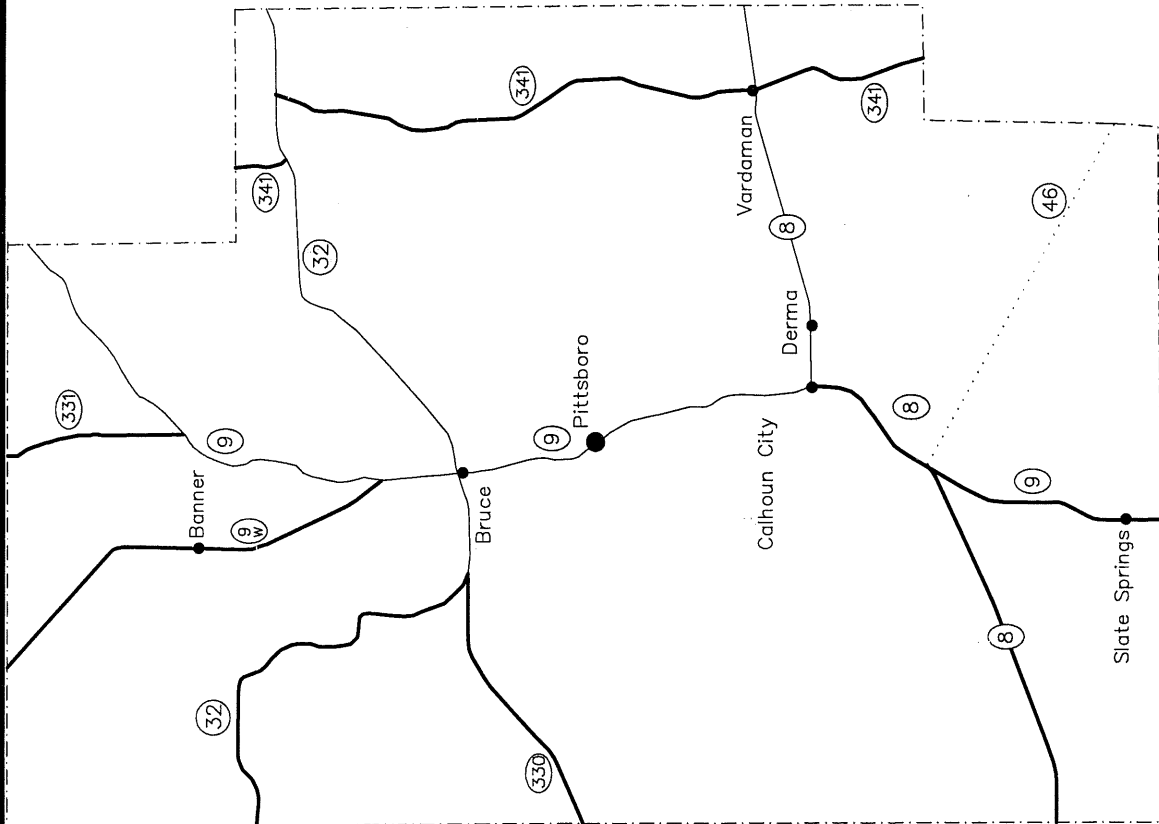

CALHOUN (7)

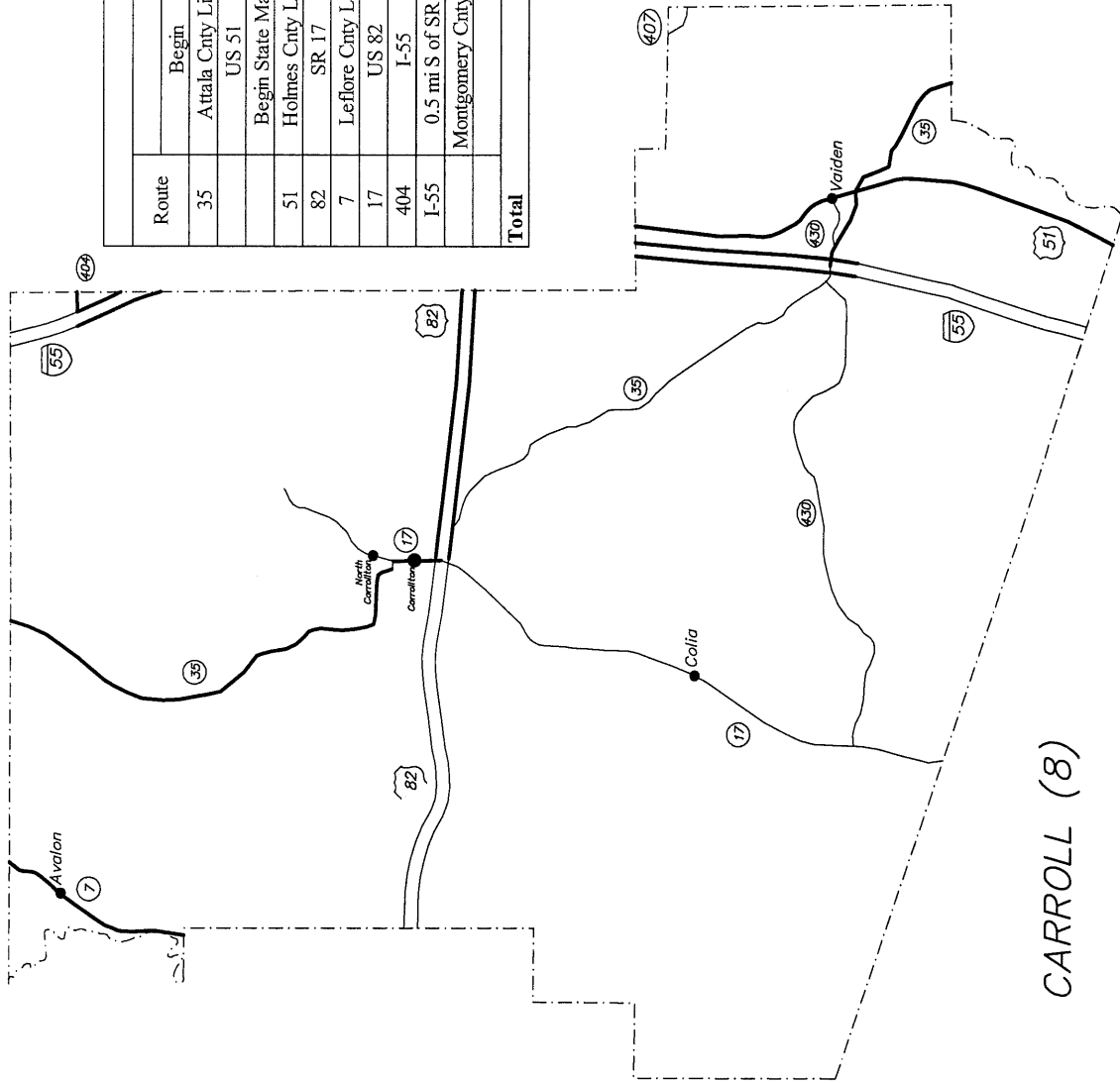

Route	Termini		Length	HPRPMs	
	Begin	End		Yellow	Red-Clear
35	Attala Cnty Line US 51	US 51 I-55	4.357	436	
51	Begin State Main. Holmes Cnty Line	Grenada Cnty Line Montgomery Cnty Line	2.234	223	
82	SR 17	Montgomery Cnty Line	13.800	1,380	
7	Leflore Cnty Line	Montgomery Cnty Line	14.480	1,448	1,842
17	US 82	Grenada Cnty Line	5.660	566	
404	I-55	End State Main. Montgomery Cnty Line	1.390	139	
I-55	0.5 mi S of SR 35 Montgomery Cnty Line	Montgomery Cnty Line	0.530	53	
		SR 404	5.984	1,197	1,197
		Montgomery Cnty Line	1.397	279	
Total			60.542	4,245	3,318

CARROLL (8)

Route	Grenada County		Length	HPRPMs	
	Begin	End		Yellow	Red-Clear
7	Carroll Cnty Line	SR 8	8.380	804	
8	Tallahatchie Cnty Lin	SR 35	6.017	542	
	SR 35 (North)	SR 35 (South)	3.765	339	
	SR 35 (South)	I-55	8.210	1,807	589
	US 51	SR 333	1.209	431	314
	SR 333	Calhoun Cnty Line	16.863	2,050	315
51	Montgomery Cnty Lin	1 m/so SR 8	6.318	1,410	674
	1 m/so SR 8	SR 8	1.063	553	276
	SR 8	SR 332	1.759	730	335
	SR 332	SR 7	5.172	465	
	SR 7	Yaobusha Cnty Line	2.829	240	
35	SR 8	Tallahatchie Cnty Lin	1.906	191	
332	US 51	End State Main.	2.810	253	
Total			66.301	9,815	2,503

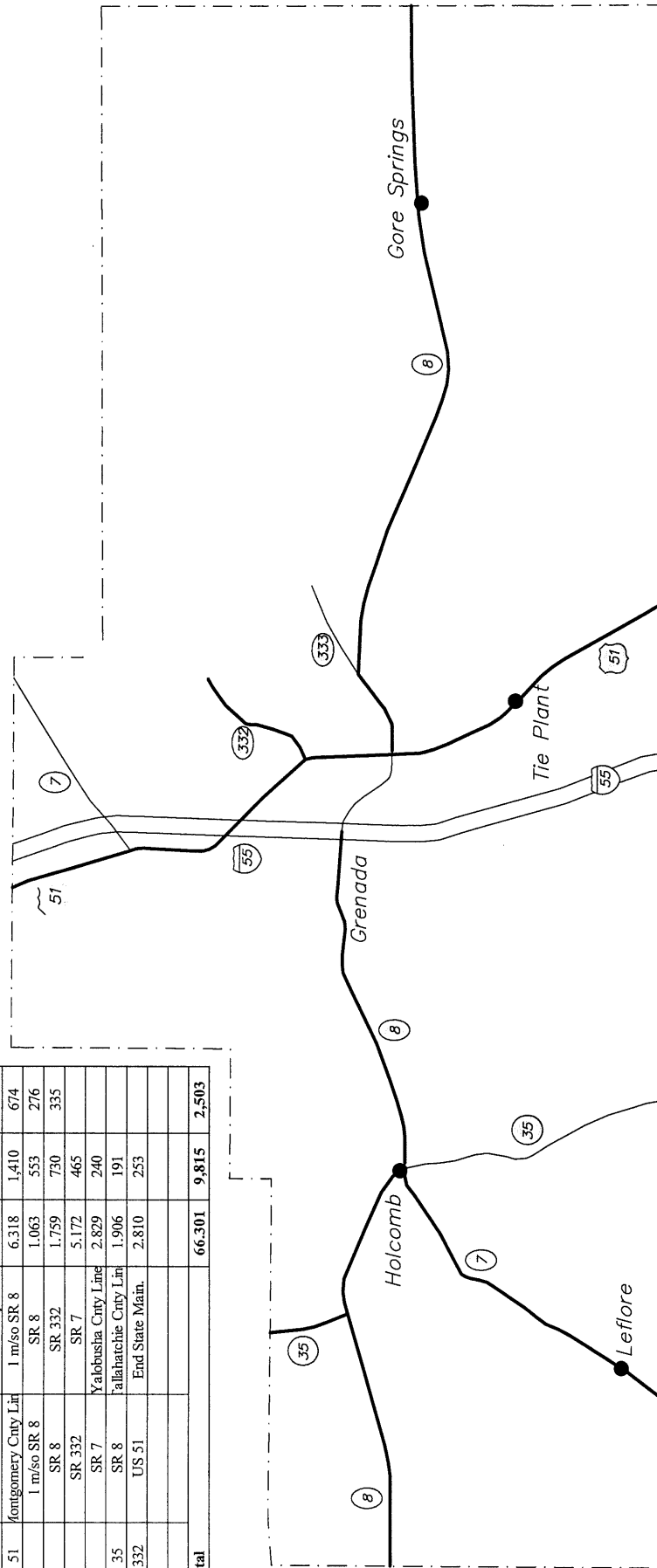

GRENADA (22)

LAFAYETTE (36)

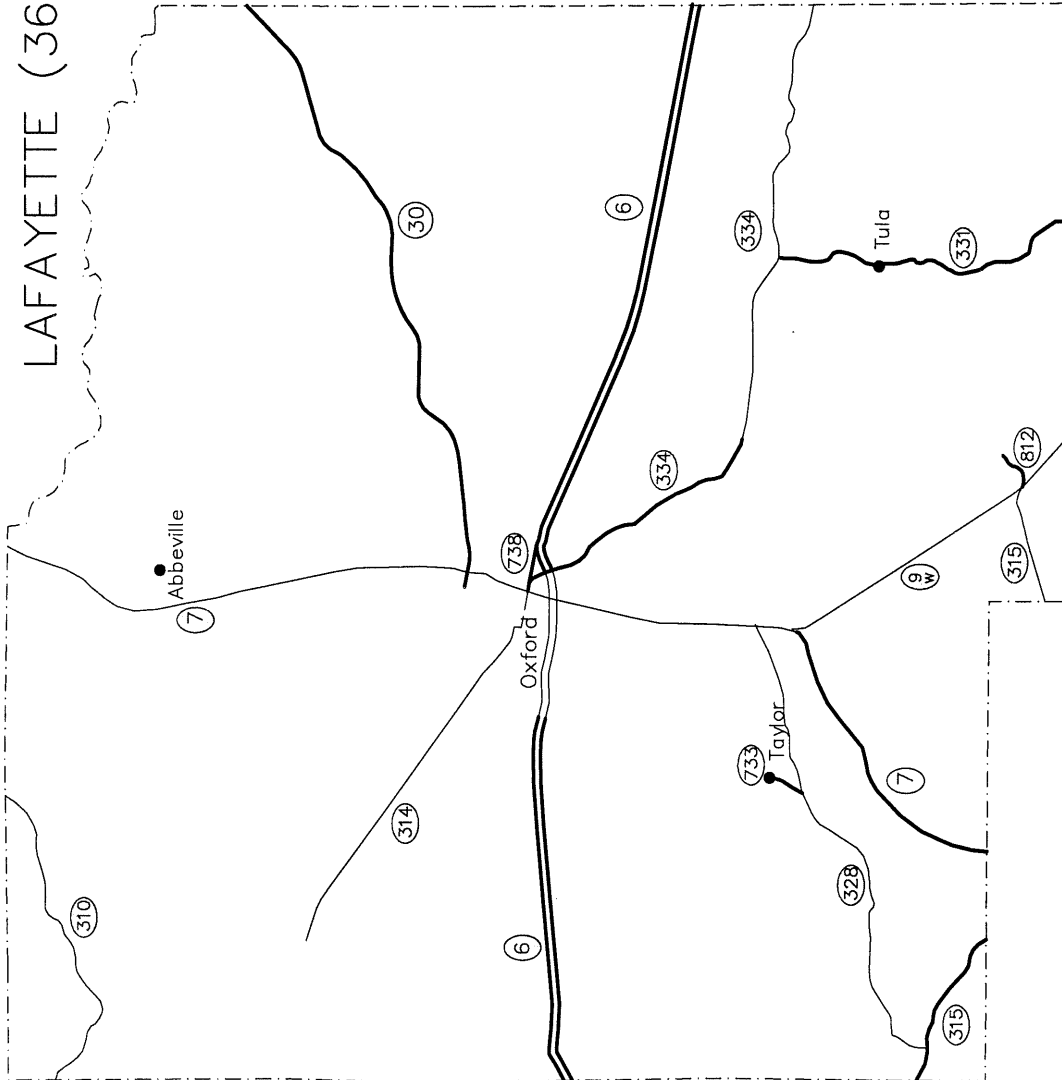

Route	Termini		Length	HPRPMs		
	Begin	End		Yellow	Red	Clear
7	Yalobusha Cnty Line	SR 9W	12.058	1,206		
278	Panola Cnty Line	West Oxford CL	8.654		1,731	
	East Oxford CL	Ponotoc Cnty Line	15.493		3,099	
30	Begin State Main.	SR 7	0.200		40	
	SR 7	Union Cnty Line	16.250	1,592		66
331	Calhoun Cnty Line	Hwy 334	8.630	863		
334	Begin State Main.	1 mile E/O CR# 418	5.479	548		
738			0.536	20		87
315	Yalobusha Cnty Line	Panola Cnty Line	4.158	416		
733	SR 328	End State Main.	0.890	89		
812			0.380	38		
Total			72.728	4,772		5,023

Leflore County					
Route	Termini		Length	HPRPMs	
	Begin	End		Yellow	Red-Clear
49E	SR 442	Tallahatchie Cnty Lin	4.608	461	
82	Sunflower Cnty Line	US 49E	13.799		2,760
7	Humphreys Cnty Line	US 82	21.485	2,149	
	US 82	Greenwood CL	1.150	598	299
	Greenwood CL	Carroll Cnty Line	6.035	815	16
8	Sunflower Cnty Line	Tallahatchie Cnty Lin	8.600	860	
706	US 49E	RR Crossing	0.370	56	
430	US 82	Carroll Cnty Line	4.244	933	239
744			0.230	23	
743			0.410		82
Total			60.931	5,895	3,396

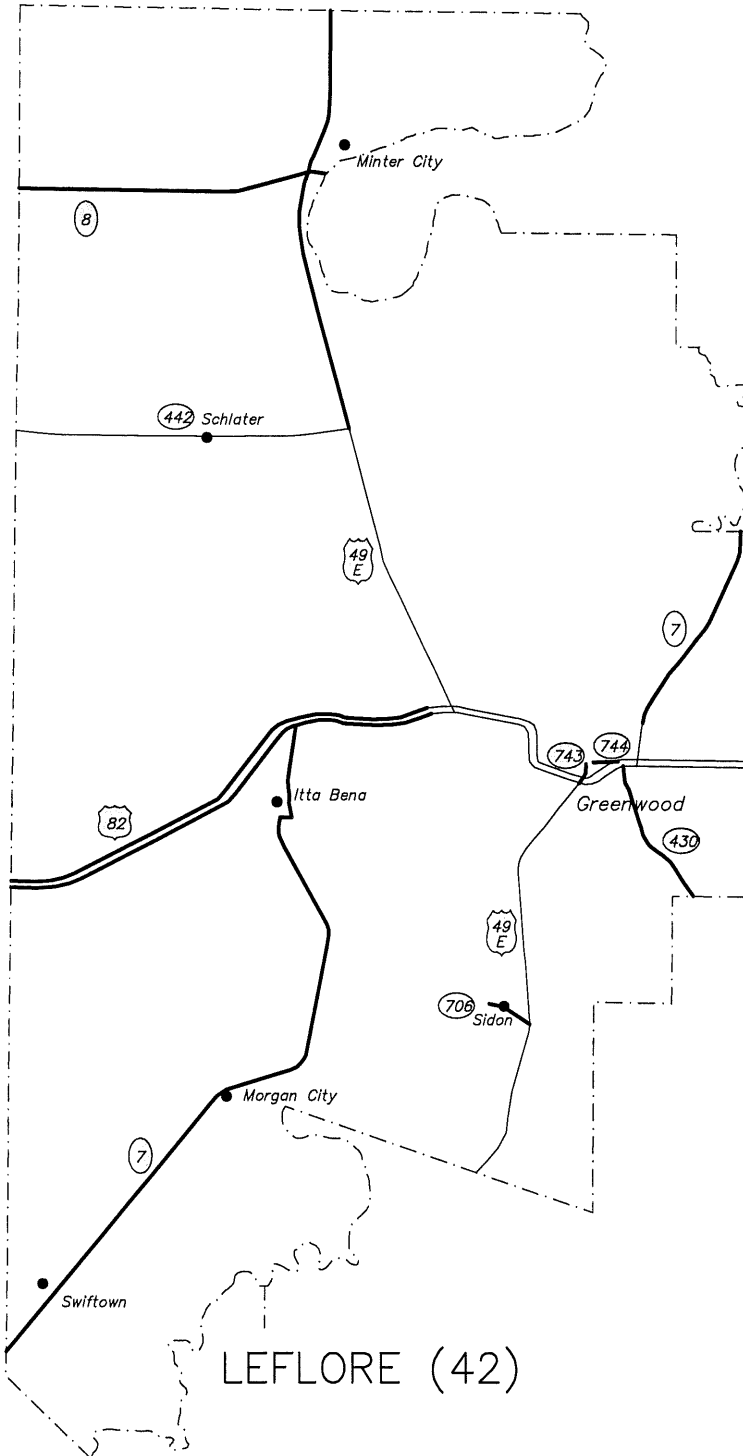

Montgomery County						
Route	Termini		Length	HPRPMs		
	Begin	End		Yellow	Red-Clear	
51	Winona CL (South)	US 82	2.762	2,034	139	
	Winona CL (North)	Grenand Cnty Line	11.543	1,304		389
82	Carroll Cnty Line	End Conc. Section	1.498			
	End Conc. Section	Webster Cnty Line	22.294	222	1,453	
407	Attala Cnty Line	Winston Cnty Line	3.800	380		
	Winston Cnty Line	US 51	3.374	337		
745	Vaiden-Kilmicrael Rd	SR 413	0.640	90		
Total			45.911	4,367	1,981	

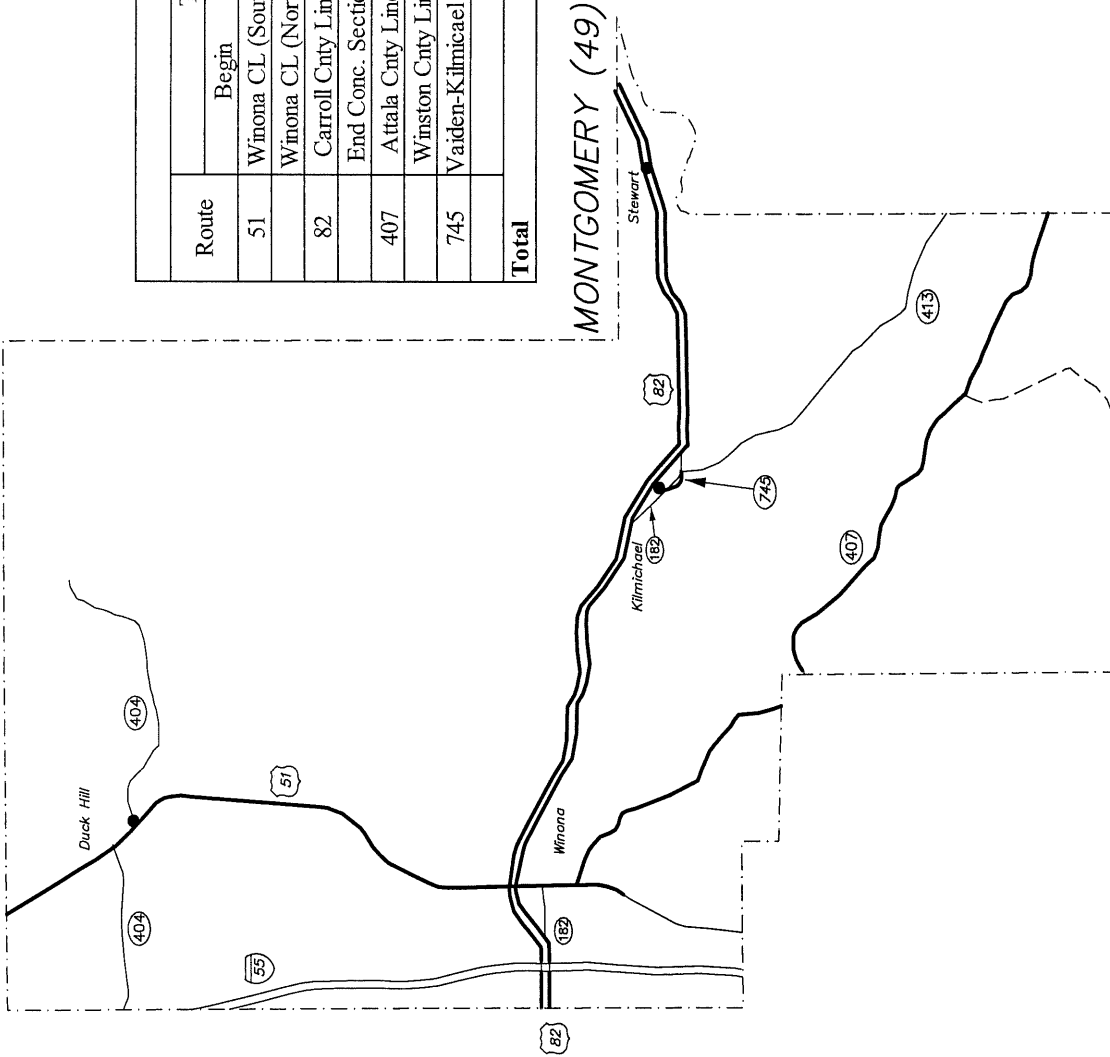

MONTGOMERY (49)

Route	Termini		Length	HPRPMs	
	Begin	End		Yellow	Red-Clear
3	SR 278	Panola Cnty Line	14.770	1,182	
278	Coahoma Cnty Line	SR 3	10.701	803	
322	Coahoma Cnty Line	SR 3	8.574	857	
	SR 3	Panola Cnty Line	9.803	980	
316	Coahoma Cnty Line	SR 6	6.043	604	
315	Coahoma Cnty Line	SR 3	12.320	1,047	
	SR 3	Panola Cnty Line	0.800	68	
714	RR (Sledge)	SR 3	0.290	29	
Total			63.301	5,570	0

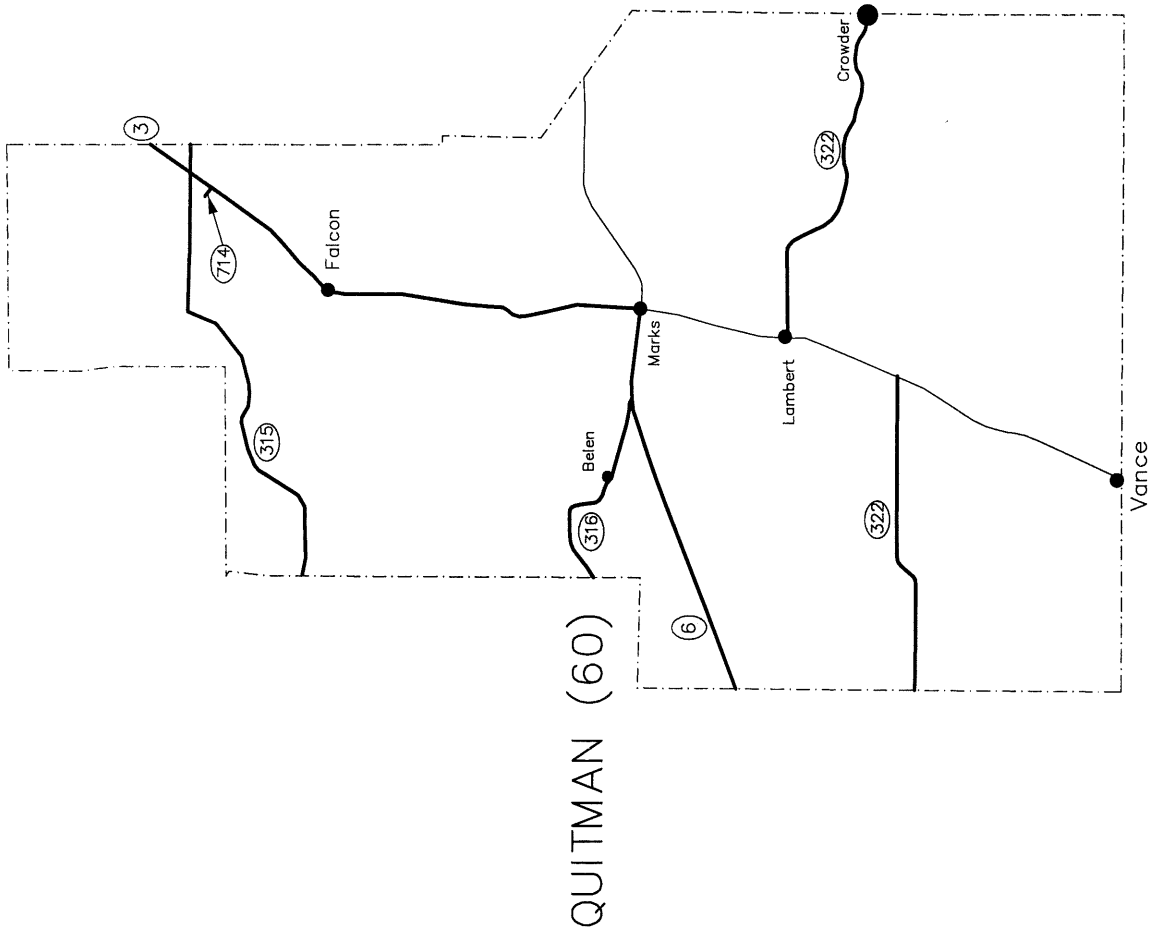

QUITMAN (60)

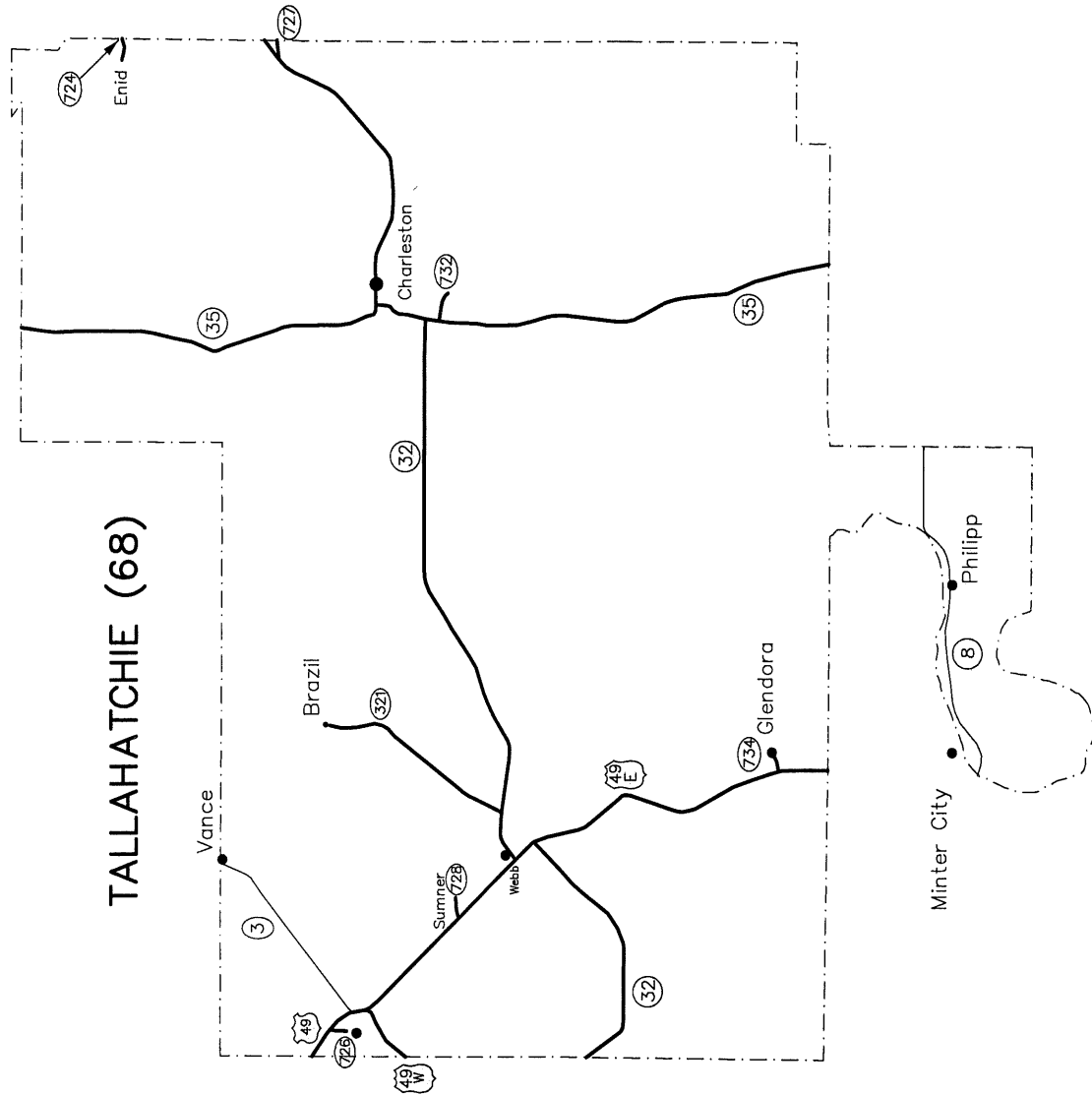

Route	Tallahatchie County				HPRPMs	
	Termini		Length	Yellow	Red-Clear	
	Begin	End				
49E	Leflore Cnty Line	SR 32 E	10.175	1,018		
	SR 32 E	US 49 W	6.429	643		
49	US 49 W	Coahoma Cnty Line	1.886	161	21	
49 W	Coahoma Cnty Line	US 49	1.930	193		
321	SR 32	Brazil	5.908	591		
32	Sunflower Cnty Line	US 49 E	7.761	776		
	Cassidy Bayou	SR 35	15.250	1,525		
	SR 35	Yalobusha Cnty Line	11.089	1,053	216	
734			0.250	40		
35	Grenada Cnty Line	SR 32 E	12.480	1,148		
	SR 32	Panola Cnty Line	10.980	1,098		
728			0.660	66		
724			0.820	98		
726			0.660	40		
732			1.140	114		
727			0.200	20		
Total			87.618	8,584	237	

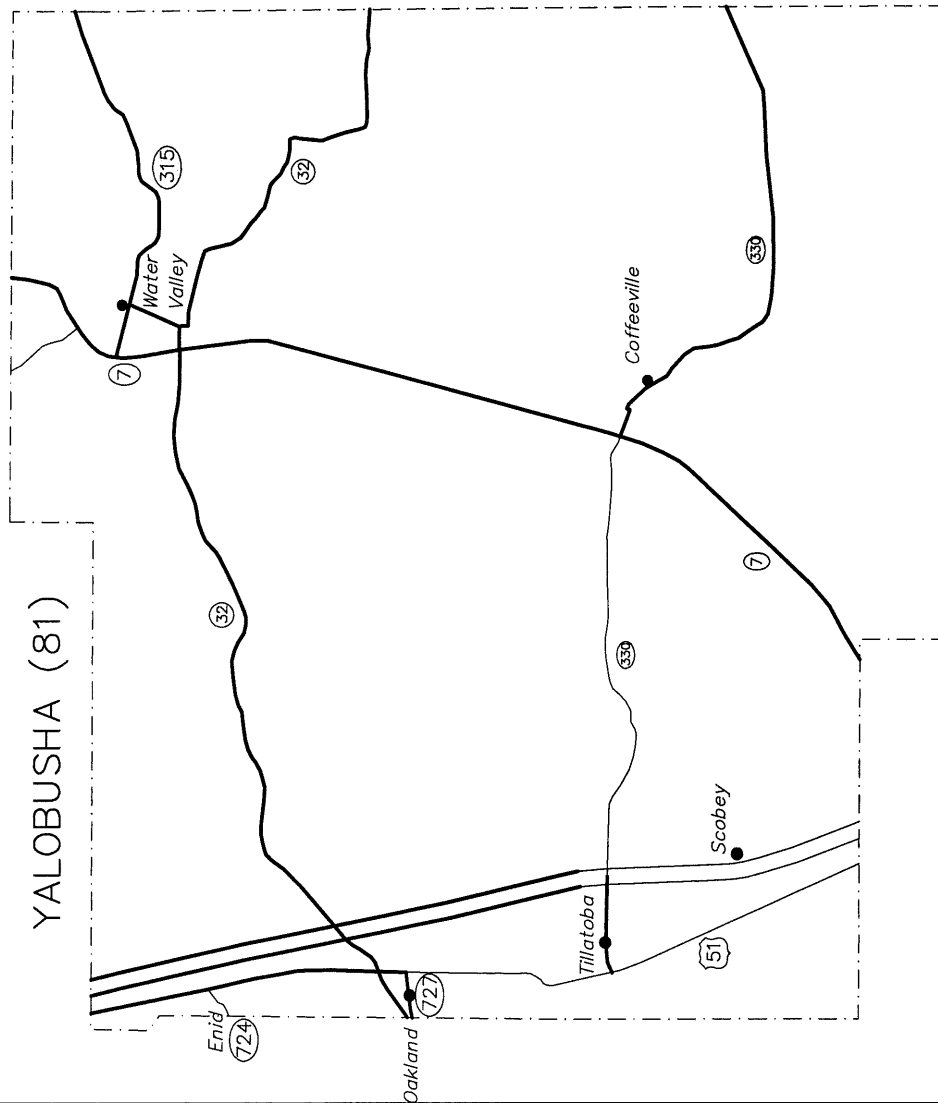

Route	Yalobusha County					HPRPMPs	
	Termimi		Length	Yellow	Red-Clear	Yellow	Red-Clear
	Begin	End					
51	SR 727	Panola CntyLine	7.600	760			
330	US 51	I-55	2.391	239			
	I-55	SR 7	11.900	1,190			
	SR 7	SR 32	11.800	1,180			
32	Tallahatchie Cnty Lin	US 51	1.183	106			
	US 51	SR 315	17.457	1,746			
	SR 315	Calhoun Cnty Line	10.169	1,017			
315	Blackmur Library	SR 32	8.125	813			
	SR 7	Lafayette Cnty Line	0.810	100			
727			0.990	89			
7	Grenada Cnty Line	Lafayette Cnty Line	23.828	1,837		1,433	
55	0.4 mi N/O 330	Panola CntyLine	12.401			3,225	
Total			108.654	9,077		4,658	