

SECTION 905 -- PROPOSAL (CONTINUED)

I (We) hereby certify by digital signature and electronic submission via Bid Express of the Section 905 proposal below, that all certifications, disclosures and affidavits incorporated herein are deemed to be duly executed in the aggregate, fully enforceable and binding upon delivery of the bid proposal. I (We) further acknowledge that this certification shall not extend to the bid bond or alternate security which must be separately executed for the benefit of the Commission. This signature does not cure deficiencies in any required certifications, disclosures and/or affidavits. I (We) also acknowledge the right of the Commission to require full and final execution on any certification, disclosure or affidavit contained in the proposal at the Commission's election upon award. Failure to so execute at the Commission's request within the time allowed in the Standard Specifications for execution of all contract documents will result in forfeiture of the bid bond or alternate security.

Bidder acknowledges receipt of and has added to and made a part of the proposal and contract documents the following addendum (addenda):

ADDENDUM NO.	<u>1</u>	DATED	<u>2/17/2022</u>	ADDENDUM NO.	_____	DATED	_____
ADDENDUM NO.	<u>2</u>	DATED	<u>2/18/2022</u>	ADDENDUM NO.	_____	DATED	_____
ADDENDUM NO.	_____	DATED	_____	ADDENDUM NO.	_____	DATED	_____

Number

Description

- 1 Revised Notice To Bidders No. 3897; Revised Bid Items; Amendment EBSx Download Required.
- 2 Revised Table of Contents; Added Notice To Bidders No. 3900; Revised Bid Items; Amendment EBSx Download Required.

TOTAL ADDENDA: 2

(Must agree with total addenda issued prior to opening of bids)

Respectfully Submitted,

DATE _____

Contractor

BY _____

Signature

TITLE _____

ADDRESS _____

CITY, STATE, ZIP _____

PHONE _____

FAX _____

E-MAIL _____

(To be filled in if a corporation)

Our corporation is chartered under the Laws of the State of _____ and the names, titles and business addresses of the executives are as follows:

President

Address

Secretary

Address

Treasurer

Address

The following is my (our) itemized proposal.

SP-0491-00(003)/ 108799301000 & SP-0493-00(001)/ 108799302000

Hinds County(ies)

Revised 01/26/2016

MISSISSIPPI DEPARTMENT OF TRANSPORTATION
TABLE OF CONTENTS

PROJECT: SP-0491-00(003)/108799301 - Hinds
SP-0493-00(001)/108799302 - Hinds

Section 901 - Advertisement

Section 904 - Notice to Bidders

#1	Governing Specification, w/ Supplement
#3	Final Cleanup
#9	Federal Bridge Formula
#13	Safety Edge
#113	Tack Coat
#296	Reduced Speed Limit Signs
#445	Mississippi Agent or Qualified Nonresident Agent
#516	Errata and Modifications to the 2017 Standard Specifications
#1225	Early Notice to Proceed
#1226	Material Storage Under Bridges
#1241	Fuel and Material Adjustments
#1963	Guardrail Pads
#2206	MASH Compliant Devices
#2273	Mississippi Special Fuel Tax Law
#2365	Special Project Sign
#2654	Disadvantaged Business Enterprises In Special Funded Projects, w/ Supplement
#2954	Reflective Sheeting for Signs
#3318	DBE Prebid Meeting
#3599	Standard Drawings w/Supplement
#3895	Contract Time
#3897	Scope of Work
#3898	Underground Utilities
#3899	Temporary Construction Signs
#3900	Scope of Work Corrections

Section 907 - Special Provisions

907-102-2	Bidding Requirements and Conditions
907-103-2	Award and Execution of Contract
907-105-1	Authority of the Engineer
907-108-4	Subletting of Contract
907-109-3	Measurement and Payment
907-619-6	Temporary Portable Rumble Strips
907-626-4	Thermoplastic Blue ADA Markings
907-701-3	Hydraulic Cement
907-702-4	Bituminous Materials
907-703-1	Gradation
907-705-1	Stone Riprap
907-707-3	Joint Materials
907-711-2	Plain Steel Wire
907-712-1	Fence and Guardrail
907-714-3	Miscellaneous Materials

PROJECT: SP-0491-00(003)/108799301 - Hinds
SP-0493-00(001)/108799302 - Hinds

907-718-1	Timber and Dimension Lumber
907-720-2	Acceptance Procedure for Glass Beads
907-721-2	Materials for Signs

Section 905 - Proposal, Proposal Bid Items, Combination Bid Proposal
State Board of Contractors Requirement
State Certification Regarding Non-Collusion, Debarment and Suspensions
Section 902 - Contract Form
Section 903 - Contract Bond Forms

Progress Schedule

(REVISIONS TO THE ABOVE WILL BE INDICATED ON THE SECOND SHEET
OF SECTION 905 AS ADDENDA)

02/18/2022 09:00 AM

MISSISSIPPI DEPARTMENT OF TRANSPORTATION

SECTION 904 -NOTICE TO BIDDERS NO. 3900

CODE: (SP)

DATE: 2/17/2022

SUBJECT: Scope of Work Corrections

PROJECT: IM-0059-01(117) / 107069301 & 302 – Lamar & Pearl River Counties

The Bidder's attention is called to the Summary of Quantities and Construction Signing Details.

The Summary of Quantities and Construction Signing Detail sheets contained in the original Scope of Work (Notice to Bidders No. 3897) of the contract proposal documents, and as issued in Addendum No. 1, are to be disregarded. The attached Summary of Quantities and Construction Signing Detail Sheets shall govern.

The Bid Sheets are correct.

STATE	MISS
PROJECT NO.	SP-0493-00(001)

SUMMARY OF QUANTITIES (SHEET 1)

PAY ITEM NO.	PAY ITEM	UNIT	HINDS : 108799-302000	
			Prelim	Final
202-B009	Removal of Asphalt Pavement, Failed Areas	SY	448	
202-B158	Removal of Guard Rail, Including Rails, Posts and Terminal Ends	LF	664	
203-G001	Excess Excavation, FM, AH	CY	81	
304-B003	Granular Material, Class 5, Group C	TON	239	
403-A003	12.5-mm, ST, Asphalt Pavement	TON	1,869	
403-B003	12.5-mm, ST, Asphalt Pavement, Leveling	TON	145	
406-D001	Fine Milling of Bituminous Pavement, All Depths	SY	16,178	
407-A001	Asphalt for Tack Coat	GAL	2,022	
503-C010	Saw Cut, Full Depth	LF	1,090	
606-B002	Guard Rail, Class A, Type 1, W/ Beam	LF	500	
606-E001	Guard Rail, Terminal End Section	EA	4	
606-G001	Special Sections, Bridge Connector	EA	4	
618-A001	Maintenance of Traffic	LS	1	
619-A1001	Temporary Traffic Stripe, Continuous White	MI	5	
619-A2001	Temporary Traffic Stripe, Continuous Yellow	MI	5	
619-A5001	Temporary Traffic Stripe, Detail	LF	11,566	
619-A6002	Temporary Traffic Stripe, Legend	LF	5,988	
907-619-B001	Temporary Portable Rumble Strips	LF	66	
619-D1001	Standard Roadside Construction Signs, Less than 10 Square Feet	SF	16	
619-D2001	Standard Roadside Construction Signs, 10 Square Feet or More	SF	128	
619-G4001	Barricades, Type III, Double Faced	LF	24	
620-A001	Mobilization	LS	1	
626-B002	6" Thermoplastic Double Drop Traffic Stripe, Continuous White	MI	2	
626-E001	6" Thermoplastic Double Drop Traffic Stripe, Continuous Yellow	MI	2	
626-G004	Thermoplastic Double Drop Detail Stripe, White	LF	1,859	
626-G005	Thermoplastic Double Drop Detail Stripe, Yellow	LF	657	
626-H002	Thermoplastic Double Drop Legend, White	LF	824	
627-K001	Red-Clear Reflective High Performance Raised Markers	EA	318	
627-L001	Two-Way Yellow Reflective High Performance Raised Markers	EA	97	
630-F006	Delineators, Guard Rail, White	EA	32	
630-G004	Type 3 Object Markers, OM-3R or OM-3L	EA	4	

MISSISSIPPI DEPARTMENT OF TRANSPORTATION	
SUMMARY OF QUANTITIES	
Revision	Working Number
	SQ-1
PROJ NO: SP-0493-00(001)	Sheet Number
COUNTY: HINDS	
FILENAME: 855 SQS	1
Design Team	Checked
	Date

STATE	MISS
PROJECT NO.	SP-0491-00(003)

SUMMARY OF QUANTITIES (SHEET 1)

PAY ITEM NO.	PAY ITEM	UNIT	HINDS : 108799-301000	
			Prelim	Final
202-B069	Removal of Concrete Pavement w/ Variable Depth Overlay	SY	263	
203-G001	Excess Excavation, FM, AH	CY	44	
304-B003	Granular Material, Class 5, Group C	TON	246	
403-A003	12.5-mm, ST, Asphalt Pavement	TON	2,754	
403-B003	12.5-mm, ST, Asphalt Pavement, Leveling	TON	106	
406-D001	Fine Milling of Bituminous Pavement, All Depths	SY	23,838	
407-A001	Asphalt for Tack Coat	GAL	2,411	
413-D002	Cleaning and Filling Joints	LF	660	
413-E001	Sawing and Sealing Transverse Joints in Asphalt Pavement	LF	8,134	
503-C010	Saw Cut, Full Depth	LF	560	
618-A001	Maintenance of Traffic	LS	1	
619-A1001	Temporary Traffic Stripe, Continuous White	MI	9	
619-A2001	Temporary Traffic Stripe, Continuous Yellow	MI	9	
619-A5001	Temporary Traffic Stripe, Detail	LF	4,440	
619-A6002	Temporary Traffic Stripe, Legend	LF	1,980	
907-619-B001	Temporary Portable Rumble Strips	LF	66	
619-D1001	Standard Roadside Construction Signs, Less than 10 Square Feet	SF	16	
619-D2001	Standard Roadside Construction Signs, 10 Square Feet or More	SF	256	
619-G4001	Barricades, Type III, Double Faced	LF	24	
620-A001	Mobilization	LS	1	
626-B002	6" Thermoplastic Double Drop Traffic Stripe, Continuous White	MI	3	
626-E001	6" Thermoplastic Double Drop Traffic Stripe, Continuous Yellow	MI	3	
626-G001	Thermoplastic Detail Stripe, Blue-ADA	LF	48	
626-G004	Thermoplastic Double Drop Detail Stripe, White	LF	1,376	
626-G005	Thermoplastic Double Drop Detail Stripe, Yellow	LF	194	
907-626-H001	Thermoplastic Legend, Blue-ADA Handicap Symbol	EA	1	
626-H002	Thermoplastic Double Drop Legend, White	LF	1,102	
627-J001	Two-Way Clear Reflective High Performance Raised Markers	EA	196	
627-L001	Two-Way Yellow Reflective High Performance Raised Markers	EA	195	

MISSISSIPPI DEPARTMENT OF TRANSPORTATION	
SUMMARY OF QUANTITIES	
Revision	Working Number
	SQ-1
PROJ NO: SP-0491-00(003)	Sheet Number
COUNTY: HINDS	1
FILENAME: SQS 108799-301000	Date
Design Team	Checked

CONSTRUCTION SIGNING DETAIL
HWY 855 HINDS COUNTY

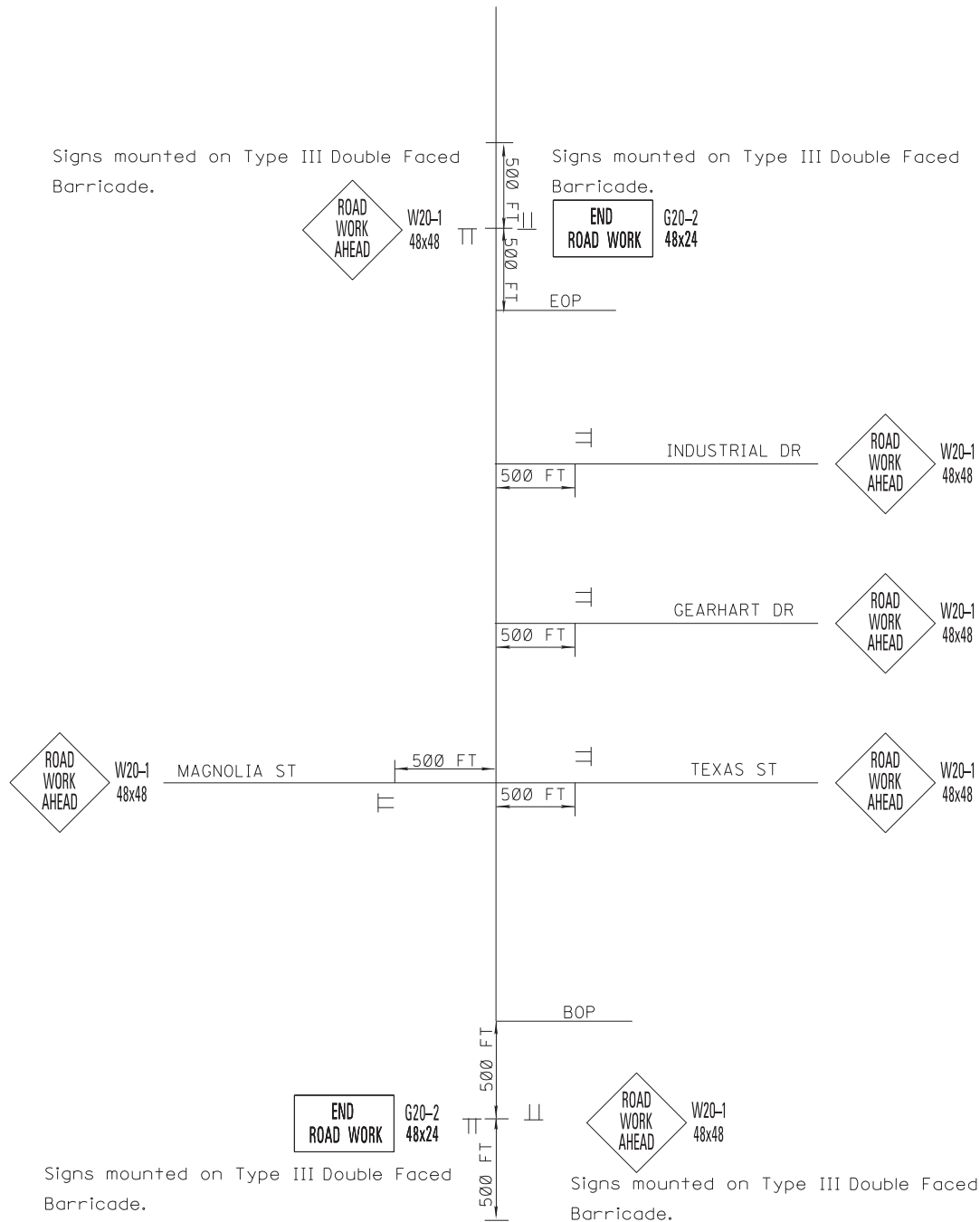

ESTIMATED

Traffic Control Signs Required:

- 2 - G20-2 "END ROAD WORK"
8 - W20-1 "ROAD WORK AHEAD"
0 - R4-1 "DO NOT PASS"
0 - R4-2 "PASS WITH CARE"
0 - W14-3 "NO PASSING ZONE"
24 - TYPE III DBL. FACE BARRICADES

NOTES: One (1) W20-1 "ROAD WORK AHEAD" Sign is Required at each Local Road, Street or Highway Entering the Project.

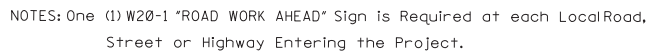

Mill & Overlay approximately 1.5 miles on SR 890 from the BOSM to the EOSM near the Bolton Corp. Limit & approximately 0.75 miles on SR 855 from the BOSM to the EOSM north of I-20, known as State Project Nos. SP-0491-00(003) & SP-0493-00(001) / 108799301 & 302 in Hinds County.

Line No.	Item Code	Adj Code	Quantity	Units	Description [Fixed Unit Price]
Roadway Items					
0010	202-B009		448	Square Yard	Removal of Asphalt Pavement, Failed Areas
0020	202-B069		263	Square Yard	Removal of Concrete Pavement w/ Variable Depth Overlay
0030	202-B158		664	Linear Feet	Removal of Guard Rail, Including Rails, Posts and Terminal Ends
0040	203-G001	(E)	125	Cubic Yard	Excess Excavation, FM, AH
0050	304-B003	(GT)	485	Ton	Granular Material, Class 5, Group C
0060	403-A003	(BA1)	4,623	Ton	12.5-mm, ST, Asphalt Pavement
0070	403-B003	(BA1)	251	Ton	12.5-mm, ST, Asphalt Pavement, Leveling
0080	406-D001		40,016	Square Yard	Fine Milling of Bituminous Pavement, All Depths
0090	407-A001	(A2)	4,433	Gallon	Asphalt for Tack Coat
0100	413-D002		660	Linear Feet	Cleaning and Filling Joints
0110	413-E001		8,134	Linear Feet	Sawing and Sealing Transverse Joints in Asphalt Pavement
0120	503-C010		1,650	Linear Feet	Saw Cut, Full Depth
0130	606-B002		500	Linear Feet	Guard Rail, Class A, Type 1, 'W' Beam
0140	606-E001		4	Each	Guard Rail, Terminal End Section
0150	606-G001		4	Each	Special Sections, Bridge Connector
0160	618-A001		1	Lump Sum	Maintenance of Traffic
0170	619-A1001		14	Mile	Temporary Traffic Stripe, Continuous White
0180	619-A2001		14	Mile	Temporary Traffic Stripe, Continuous Yellow
0190	619-A5001		16,006	Linear Feet	Temporary Traffic Stripe, Detail
0200	619-A6002		7,968	Linear Feet	Temporary Traffic Stripe, Legend
0210	619-D1001		32	Square Feet	Standard Roadside Construction Signs, Less than 10 Square Feet
0220	619-D2001		384	Square Feet	Standard Roadside Construction Signs, 10 Square Feet or More
0230	619-G4001		48	Linear Feet	Barricades, Type III, Double Faced
0240	620-A001		1	Lump Sum	Mobilization
0250	626-B002		5	Mile	6" Thermoplastic Double Drop Traffic Stripe, Continuous White
0260	626-E001		5	Mile	6" Thermoplastic Double Drop Traffic Stripe, Continuous Yellow
0270	626-G001		48	Linear Feet	Thermoplastic Detail Stripe, Blue-ADA
0280	626-G004		3,235	Linear Feet	Thermoplastic Double Drop Detail Stripe, White
0290	626-G005		851	Linear Feet	Thermoplastic Double Drop Detail Stripe, Yellow
0300	626-H002		1,926	Linear Feet	Thermoplastic Double Drop Legend, White
0310	627-J001		196	Each	Two-Way Clear Reflective High Performance Raised Markers
0320	627-K001		318	Each	Red-Clear Reflective High Performance Raised Markers

Line No.	Item Code	Adj Code	Quantity	Units	Description [Fixed Unit Price]
0330	627-L001		292	Each	Two-Way Yellow Reflective High Performance Raised Markers
0340	630-F006		32	Each	Delineators, Guard Rail, White
0350	630-G004		4	Each	Type 3 Object Markers, OM-3R or OM-3L
0360	907-619-B001		132	Linear Feet	Temporary Portable Rumble Strips
0370	907-626-H001		1	Each	Thermoplastic Legend, Blue-ADA Handicap Symbol