

GENERAL INDEX		
INCLUDED THIS PROJECT		BEGIN WITH SHEET
<input checked="" type="checkbox"/> ROADWAY.....	1	
<input type="checkbox"/> PERMANENT SIGNS.....	1001	
<input type="checkbox"/> TRAFFIC SIGNALS.....	2001	
<input type="checkbox"/> ITS COMPONENTS.....	3001	
<input type="checkbox"/> LIGHTING.....	4001	
<input type="checkbox"/> (RESERVED).....	5001	
<input checked="" type="checkbox"/> ROADWAY STD. DWGS.....	6001	
<input type="checkbox"/> BOX CULVERT STD. DWGS (LRFD).....	7001	
<input type="checkbox"/> BOX CULVERT STD. DWGS (STD. SPEC.)....	7501	
<input checked="" type="checkbox"/> BRIDGE.....	8001	
<input type="checkbox"/> CROSS SECTIONS.....	9001	

STATE OF MISSISSIPPI
MISSISSIPPI DEPARTMENT OF TRANSPORTATION

PLAN AND PROFILE OF
PROPOSED STATE HIGHWAY
STATE PROJECT NO. SP-0211-00(022)

SR 37 over Oakohay Creek - Temporary Repair (Bridge # 4.3)
COVINGTON COUNTY

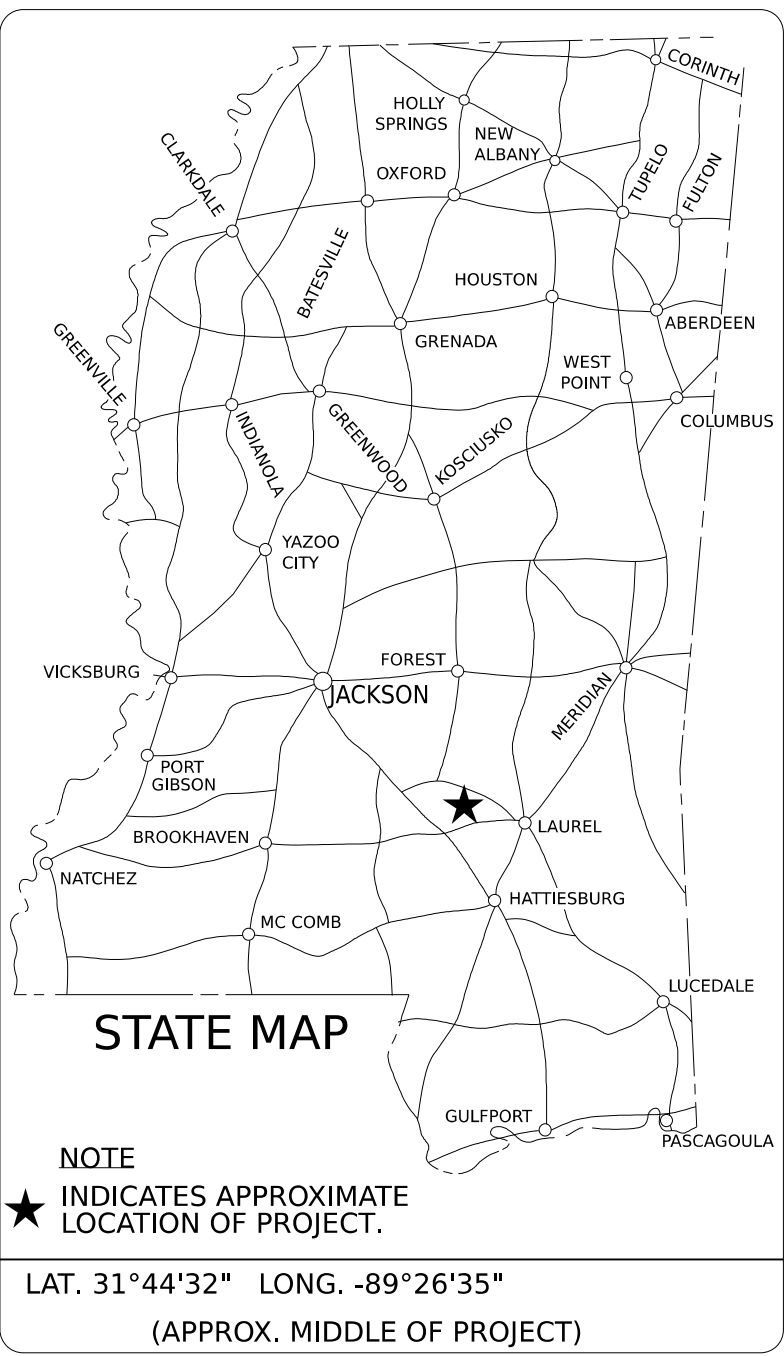

BRIDGE STRUCTURES REQ'D.
NONE

BOX BRIDGES REQ'D.
NONE

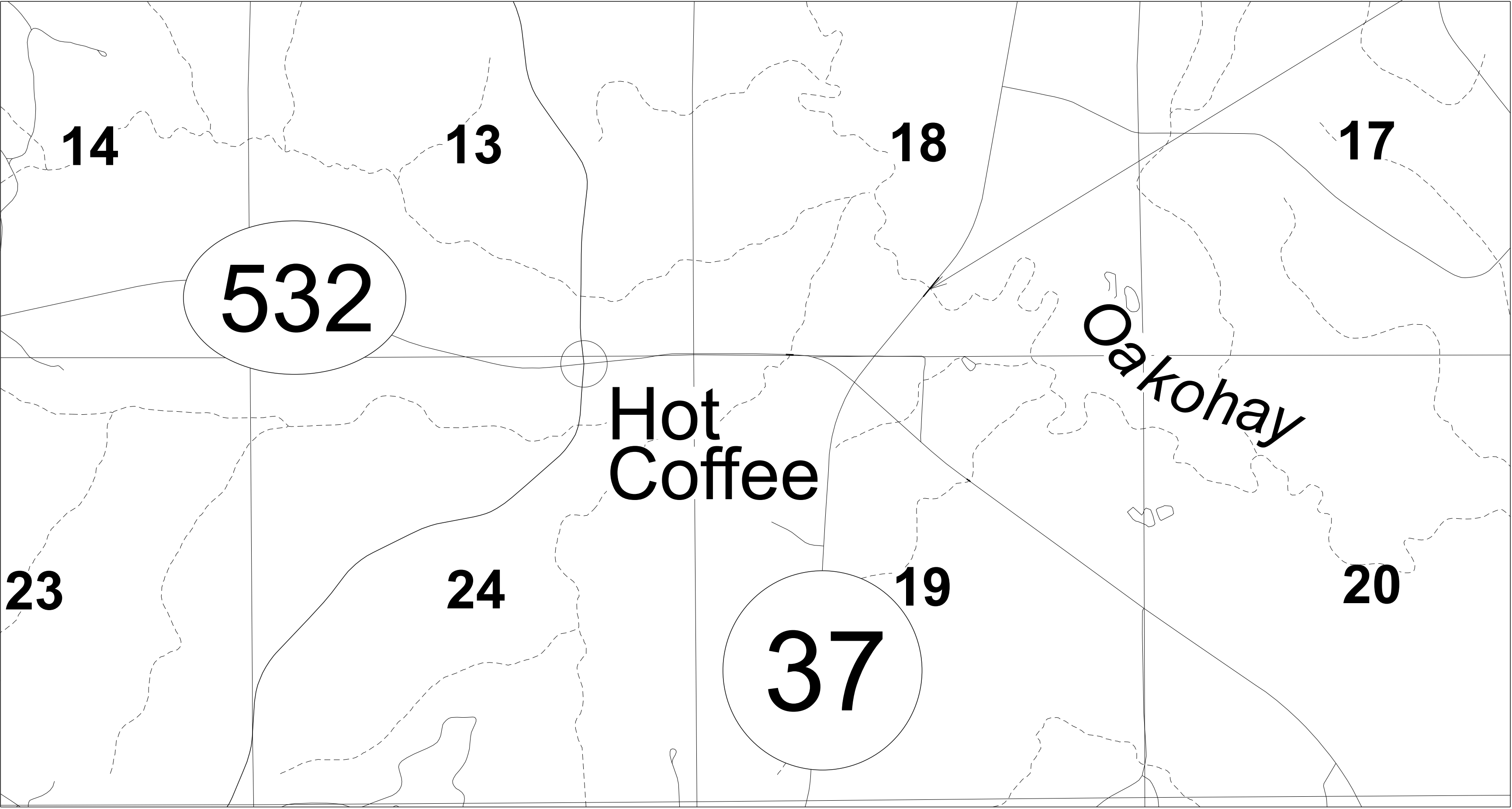

DESIGN CONTROL			
MPH = V (SPEED DESIGN)			
ADT () =	:	ADT () =	:
DHV =	:	D =	% T = %

PERMITS ACQUIRED BY MDOT		
WETLANDS AND WATERS PERMITS		
	WATERS	WETLANDS
NATIONWIDE #14	<input type="checkbox"/>	<input type="checkbox"/>
NATIONWIDE (OTHER)*	<input type="checkbox"/>	<input type="checkbox"/>
GENERAL*	<input type="checkbox"/>	<input type="checkbox"/>
INDIVIDUAL (404)*	<input type="checkbox"/>	<input type="checkbox"/>
STORMWATER PERMIT		<input type="checkbox"/>
Y	REQUIRED, CNOI SUBMITTED BY MDOT (DISTURBED AREA=5 ACRES)	
S	REQUIRED, SCNOI TO BE SUBMITTED BY CONTRACTOR (1 TO 4.99 ACRES)	
N	NO STORMWATER PERMIT REQUIRED (<1 ACRE)	
APPROVED BY: _____		

CONVENTIONAL SYMBOLS	
COUNTY LINE	_____
TOWN CORP LINE	-----
SECTION LINE	-----
DEED LINE	-----
EXISTING ROADWAY	-----
PROPOSED ROADWAY	-----
RAILROAD	-----
BRIDGES	-----

LENGTH DATA		
LENGTH OF ROADWAY	FT.	MI.
LENGTH OF BRIDGES	FT.	MI.
LENGTH OF PROJECT (NET)	FT.	MI.
LENGTH OF EXCEPTIONS	FT.	MI.
LENGTH OF PROJECT (GROSS)	FT.	MI.

EQUATIONS
NONE

PLAN
PROFILE
LAYOUT

SCALES
1 IN.= 100 FT.
1 IN.= 100 FT.
1 IN.= 10 FT.
1 IN.= 1000 FT.

EXCEPTIONS
NONE



DESIGNED BY: RUST

CONSTRUCTION PROJECT DATA	
EXTERNAL PROJECT NUMBER	SP-0211-00(022)
FMS & DETAIL	108817/302000

P S & E DATE: 3/28/2022	
APPROVED:	
DEPUTY EXECUTIVE DIRECTOR / CHIEF ENGINEER	
EXECUTIVE DIRECTOR	

	REVISION DATE	WORKING NO.	SHEET NO.
TITLE SHEET (1)			1
DETAILED INDEX & GENERAL NOTES (2)			
DETAILED INDEX		DI-1	2
GENERAL NOTES		GN-1	3
QUANTITY SHEETS (1)			
SUMMARY OF QUANTITIES		SQ-1	4
STANDARD DRAWINGS - ROADWAY SHEETS (4)			
TRAFFIC CONTROL PLAN WITH FLAGGER		TCP-1	6351
SHORT DURATION CLOSING OF TWO-LANE TWO-WAY HIGHWAYS		TCP-6	6356
HIGHWAY SIGN & BARRICADE DETAILS FOR CONSTRUCTION PROJECTS		TCP-8	6358
TRAFFIC CONTROL DETAILS DRUM PLACEMENT & SHOULDER CLOSURE		TCP-16	6366
SPECIAL DESIGN SHEETS - BRIDGE (SEE BRIDGE DETAILED INDEX, SHEET 8001)			
TOTAL SHEETS (NOT INCLUDING BRIDGE SHEETS) (8)			

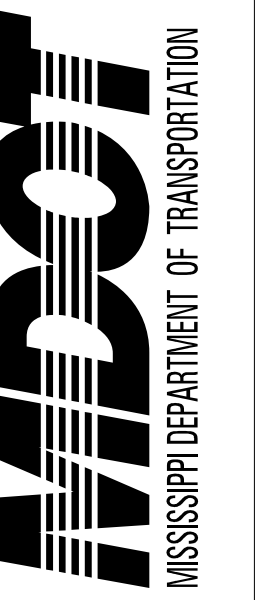

DESIGNED BY: RUST

DETAILED BY:

CHECKED BY:

DATE:

FMS CON: 108817/302000

PROJECT NO.: SP-0211-00(022)

COUNTY: COVINGTON

DETAILED INDEX

WK. NO.
DI-1

SHEET NO.
2

GENERAL NOTES

- (1) THE LOCATION AND SPACING OF SIGNS, SHOWN ON THE TRAFFIC CONTROL PLANS, ARE APPROXIMATE AND MAY BE ADJUSTED AS NECESSARY TO FIT FIELD CONDITIONS.
- (2) ALL TRAFFIC CONTROL DEVICES ON THIS PROJECT SHALL COMPLY WITH PART VI OF THE **MUTCD** (LATEST EDITION).
- (3) ALL PLASTIC DRUMS SHALL HAVE A BALLASTING COLLAR MADE FROM RECYCLED TRUCK TIRES OR OTHER SUITABLE MATERIAL.
- (4) THE CONTRACTOR SHALL BE RESPONSIBLE FOR PROTECTING EXISTING STRUCTURES SUCH AS, BUT NOT LIMITED TO, PIPES, INLETS, APRONS, AND BRIDGES FROM DAMAGE WHICH MIGHT OCCUR DURING CONSTRUCTION. THE CONTRACTOR SHALL REPLACE OR REPAIR, AS DIRECTED BY THE ENGINEER, ANY STRUCTURES DAMAGED DURING THE LIFE OF THE CONTRACT. NO PAYMENT WILL BE MADE FOR REPLACEMENT OR REPAIR OF DAMAGED ITEMS.
- (5) WORK ON STRUCTURES FOR THIS PROJECT REQUIRES EXCAVATION IN THE IMMEDIATE VICINITY OF TRAFFIC AND ADJACENT PROPERTIES. THEREFORE, THE RISK OF A FAILURE OCCURRING DURING EXCAVATION REQUIRES THAT EXTREME CAUTION BE EXERCISED. THE CONTRACTOR SHALL BE RESPONSIBLE FOR PLACING WHAT BRACING, SHORING, OR GROUND SUPPORT SYSTEM THAT IS DEEMED NECESSARY TO PREVENT A FAILURE AND PROTECT THE PERSONS WORKING NEAR THE EXCAVATION, THE PUBLIC THAT MAY BE ABOVE THE EXCAVATION, OR ANY STRUCTURES ADJACENT TO THE EXCAVATION. ALL COSTS FOR DESIGNING, DRAWING, AND CONSTRUCTING THE FACILITY SHALL BE INCLUDED IN THE PRICE BID FOR CONTRACT ITEMS.
- (6) FLUORESCENT ORANGE SHEETING SHALL BE USED ON ALL CONSTRUCTION AND TRAFFIC CONTROL SIGNS EXCEPT FOR THOSE DESIGNATED ON THE PLANS TO BE BLACK LEGEND AND BORDER ON WHITE BACKGROUND.
- (7) THE CONTRACTOR SHALL COVER ANY TEMPORARY TRAFFIC CONTROL SIGNS SHOWN IN THE TRAFFIC CONTROL PLAN THAT DO NOT APPLY TO THE CURRENT PHASE.
- (8) ALL ITEMS OF WORK ASSOCIATED WITH THE INSTALLATION OF A CONSTRUCTION ENTRANCE SHALL BE ABSORBED IN OTHER ITEMS OF WORK.
- (9) SEE BRIDGE PLANS FOR DETAILED INDEX SHEET(S), ESTIMATED AND SUMMARY OF QUANTITY SHEETS, AND EROSION CONTROL SHEETS.
- (10) ALL ADDENDA TO THESE PLANS WILL BE POSTED TO WWW.MDOT.MS.GOV UNDER THE PROPOSAL ADDENDA COLUMN. BIDDERS ARE ADVISED THAT HARD COPIES OF ANY ADDENDA FOR THIS PROJECT WILL NOT BE MAILED. IT IS THE BIDDER'S RESPONSIBILITY TO CHECK AND SEE IF ANY ADDENDA HAVE BEEN POSTED FOR THIS PROJECT.
- (11) STORAGE OF FLAMMABLE MATERIALS WILL NOT BE ALLOWED UNDER ANY BRIDGE STRUCTURES WITHOUT WRITTEN APPROVAL FROM THE PROJECT ENGINEER. SEE NOTICE TO BIDDERS ENTITLED "MATERIAL STORAGE UNDER BRIDGES" FOR MORE INFORMATION.

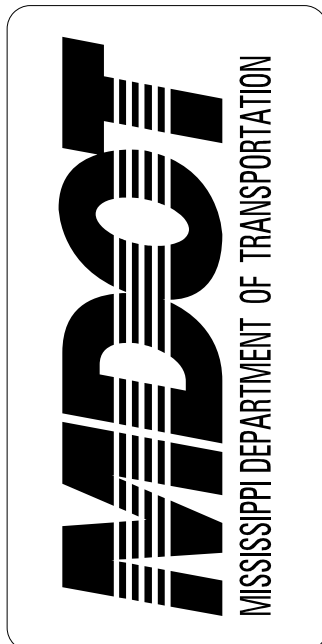

DESIGNED BY: RUST
DETAILED BY:
CHECKED BY:
DATE:

FMS CON: 108817/302000
PROJECT NO.: SP-0211-00(022)
COUNTY: COVINGTON

GENERAL NOTES

WK. NO. GN-1
SHEET NO. 3