

## SECTION 905 -- PROPOSAL (CONTINUED)

I (We) hereby certify by digital signature and electronic submission via Bid Express of the Section 905 proposal below, that all certifications, disclosures and affidavits incorporated herein are deemed to be duly executed in the aggregate, fully enforceable and binding upon delivery of the bid proposal. I (We) further acknowledge that this certification shall not extend to the bid bond or alternate security which must be separately executed for the benefit of the Commission. This signature does not cure deficiencies in any required certifications, disclosures and/or affidavits. I (We) also acknowledge the right of the Commission to require full and final execution on any certification, disclosure or affidavit contained in the proposal at the Commission's election upon award. Failure to so execute at the Commission's request within the time allowed in the Standard Specifications for execution of all contract documents will result in forfeiture of the bid bond or alternate security.

Bidder acknowledges receipt of and has added to and made a part of the proposal and contract documents the following addendum (addenda):

ADDENDUM NO.	<u>1</u>	DATED	<u>4/11/2022</u>	ADDENDUM NO.	_____	DATED	_____
ADDENDUM NO.	_____	DATED	_____	ADDENDUM NO.	_____	DATED	_____
ADDENDUM NO.	_____	DATED	_____	ADDENDUM NO.	_____	DATED	_____

Number

Description

1 Revised Notice To Bidders No. 4066; Amendment EBSx  
Download Required.

TOTAL ADDENDA: 1

(Must agree with total addenda issued prior to opening of bids)

Respectfully Submitted,

DATE \_\_\_\_\_

Contractor

BY \_\_\_\_\_

Signature

TITLE \_\_\_\_\_

ADDRESS \_\_\_\_\_

CITY, STATE, ZIP \_\_\_\_\_

PHONE \_\_\_\_\_

FAX \_\_\_\_\_

E-MAIL \_\_\_\_\_

(To be filled in if a corporation)

Our corporation is chartered under the Laws of the State of \_\_\_\_\_ and the names, titles and business addresses of the executives are as follows:

President

Address

Secretary

Address

Treasurer

Address

The following is my (our) itemized proposal.

MP-7043-39(015)/ 307522301000

Lawrence County(ies)

Revised 01/26/2016

# MISSISSIPPI DEPARTMENT OF TRANSPORTATION

**SECTION 904 – NOTICE TO BIDDERS NO. 4066**

**CODE: (SP)**

**DATE: 03/09/2022**

**SUBJECT: Scope of Work**

**PROJECT: MP-7043-39(015) / 307522301 – Lawrence County**

The contract documents do not include an official set of construction plans, but may, by reference, include some Standard Drawings when so specified in a Notice to Bidders entitled, “Standard Drawings.”

The work to be accomplished using the pay items and corresponding specifications set forth in the contract is to overlay the following sections of SR 43 in Lawrence County from (1) the Jefferson Davis County Line to Arm and (2) from the Beginning of State Maintenance to County Road 43A.

<b><u>Route</u></b>	<b><u>Length (Mile)</u></b>	<b><u>Width (Feet)</u></b>	<b><u>Surface Lift</u></b>	<b><u>Thickness (Inches)</u></b>	<b><u>Level Lift</u></b>	<b><u>Thickness</u></b>
(1) SR 43	5.7	24'	9.5-mm, ST	1”	9.5-mm, ST	1”
(2) SR 43	1.6	24'	9.5-mm, ST	1”	-	-

See Typical Sections TS-1 and TS-2 for more details.

Work on the Project shall consist of the following:

1. The Contractor shall erect and maintain construction signing, provide all signs, set up night time lane closures (if needed), and traffic handling devices in accordance with the Traffic Control Plan. The cost for this work shall be in the standards to be black legend and border on white background. included in the price bid for pay item 618-A: Maintenance of Traffic. All traffic control devices on this project should comply with the latest version of the MUTCD. Fluorescent orange sheeting shall be used on all construction and traffic control signs except for those designated
2. Prior to the overlay, the existing shoulders shall be clipped and surplus material shall be spread along the edge of the shoulders, fore slopes, or other adjacent areas as directed by the Engineer, and will be an absorbed item.
3. The Contractor shall fine mill at the following locations:

<u>ROUTE</u>	<u>LOCATION</u>	<u>LENGTH</u>	<u>REMARKS</u>
(1)SR 43	BOP	150'	Tie In
(1)SR 43	EOP	150'	Tie In
(1)SR 43	122+27 & 125+57	Variable	Bridge Ends
(2)SR 43	BOP	150'	Tie In
(2)SR 43	EOP	150'	Tie In
(2)SR 43	404+12 & 408+92	Variable	Bridge Ends
(2)SR 43	414+80 & 417+18	Variable	Bridge Ends

- The Contractor shall remove the existing asphalt pavement at various locations throughout the project designated by the Engineer. Approximately 55 individual areas are expected to require removal. The average size area is approximately 100' long by 1 lane wide.

Approximately 50 locations shall be backfilled with 19-mm, ST asphalt. The remainder will require an additional six inches (6") of excess to be backfilled with crushed stone. See details on TS-2.

- The Contractor shall perform pre-leveling operations by placing 1" and variable of 9.5-mm, ST, Leveling asphalt from the (1) BOP to the (1) EOP as shown on TS-2. Included in this lift shall be a variable width trench widening left and right of centerline such that the overall width of finished pavement will be 24'. The trench shall be 1" in depth. See TS-2 for details.

The Contractor shall remove existing pavement markers prior to placing asphalt. The cost of removing these pavement markers is to be absorbed in other items bid.

The Contractor shall take due care to maintain a uniform outside edge of pavement, and shall place asphalt to establish an approximate vertical face in order for granular material to be placed directly against the surface and not on a shelf of an underlying course. A rubber tire roller shall be used in addition to a steel wheel roller in obtaining compaction in the wheel ruts on this leveling lift of asphalt.

- The Contractor shall place the top lift of asphalt on the roadway left and right of the centerline from BOP to EOP as shown on sheets TS-1 and TS-2. The finished cross-slope is to be 2% in tangent sections and match the existing super elevation rate in horizontal curves.

Asphalt surface shall be placed on all local roads and driveway aprons. Asphalt thickness shall match the finished roadway or be placed as directed by the Engineer.

The surface asphalt on the following local roads has deteriorated to the point that the remaining granular material will require minor grading and replacing with additional depth (approximately 1½") of 9.5-mm, ST asphalt as directed by the Engineer. This will yield a total of approximately 3½" of asphalt being placed on these local roads.

- Third Avenue
- Fourth Avenue
- Sixth Avenue
- WB Speights Road
- Harlen Ward Road
- GW Smith Lane
- Stewart Lane

Driveway aprons shall be paved 10' wide as directed by the Engineer. All local roads shall be paved to the normal right of way line or as directed by the Engineer.

Note: The Contractor shall be responsible for traffic control while MDOT personnel conduct density testing on the asphalt. The cost shall be included in the price in the bid price for pay item 618-A: Maintenance of Traffic.

7. The Contractor shall place granular material on the shoulders to raise the existing shoulders to the new grade, bladed, shaped, and compacted to a minimum slope of 4%. Granular material will not be allowed to be placed directly on the top lift of asphalt, but must be placed directly on the gravel shoulder by means of a road widener machine approved by the Project Engineer. Light blading or mowing of the shoulders will be required prior to placement of the granular material.
8. The Contractor shall place rumble strips in the locations indicated in the typical sections on sheets TS-1 and TS-2.
9. The Contractor shall place all permanent pavement markings, including stripe and raised pavement markers, throughout the project as required by the Standard Drawings or as directed by the Engineer. Existing pavement markings located on bridges shall be removed as required prior to placing new markings.

An asphalt taper shall be placed at the temporary joints caused by the milling or overlay in order to provide for the safe movement of traffic. The taper shall be three feet (3') in length per one inch of depth and will be an absorbed item.

Temporary striping shall be required after milling and overlaying operations. Temporary striping shall be placed in the same locations and layout as permanent stripe. All centerline, lane lines, edge lines, and no passing stripes that have been removed during the day's operations shall be replaced with temporary stripe before work is discontinued for the day or as soon thereafter as weather conditions will permit, except that:

- Replacement of no-passing stripes may be delayed for a period not to exceed three (3) days for a two or three lane road.
- Temporary edge lines on projects requiring shoulders constructed of granular material may be delayed for a period not to exceed three (3) days.

All asphalt and concrete curbs along local roads from BOP to EOP shall be painted (two applications) with white traffic paint and traffic beads as shown on sheet DCIS-1; such costs shall be included in other items bid.

It shall be the responsibility of the Contractor to protect the roadway and all existing structures, such as bridges, culverts, signs, and curbs, from damage occurring as a result of the Contractor's operations. Damages to existing structures caused by the Contractor's operations shall be repaired or replaced at no cost to the Department.

Incidental work such as removing vegetation, shaping and compaction of shoulders, removing excess asphalt material, project clean-up, and other incidental work necessary to complete the project will not be measured for separate payment. Such costs shall be included in the price of other items bid.

It is the Contractor's responsibility to insure the drainage of surface water from milled areas. Where applicable, existing shoulder material is to remain in place to be incorporated into final sloping of the shoulders. Temporary wedges (paper joints) of full lane width asphalt shall be placed by the Contractor immediately after the fine milling process to allow the safe transition of traffic. These wedges shall be maintained in a satisfactory condition by the Contractor until the permanent asphalt is placed, cost to be absorbed.

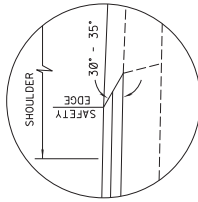

**SAFETY EDGE REQ'D  
TOP 2 LIFTS ONLY  
(NOT A PAY ITEM)  
OVERLAY**

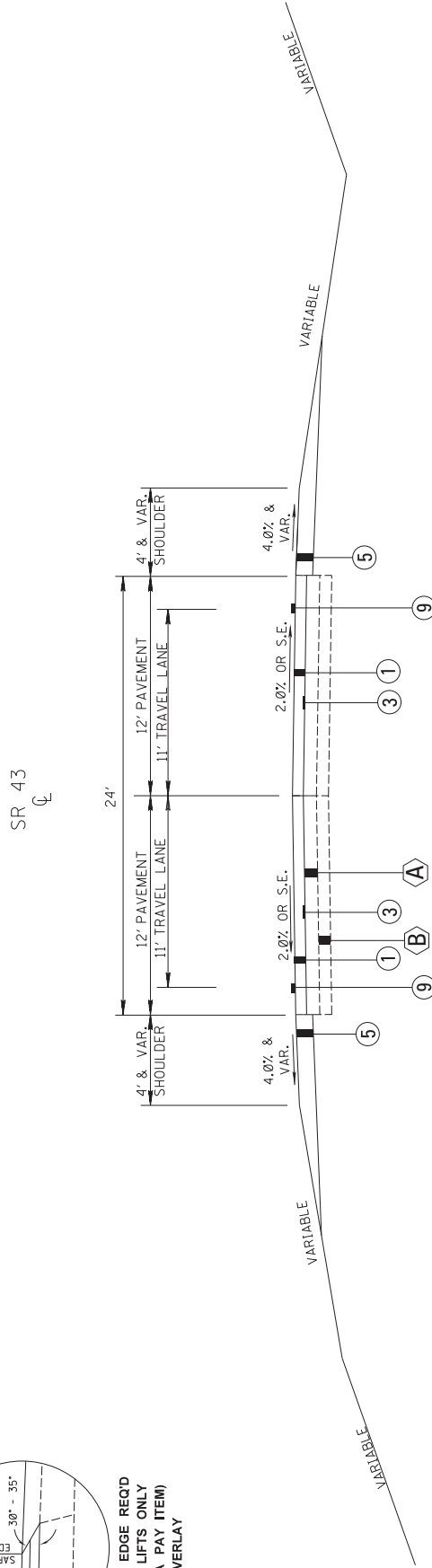

## TYPICAL SECTION

**B.O.P. STA. 347+58 - E.O.P. STA. 430+38  
Begin State Maintenance to County Road 43A  
NOT TO SCALE**

**NOT TO SCALE**

## PROPOSED

- ① 1" OF 9.5MM ST ASPHALT REQ'D
- ② 1" & VAR. FINE MILLING WHERE REQ'D
- ③ TACK COAT REQ'D
- ④ 1" & VAR. OF 9.5 MM ST ASPHALT, LEVELING REQ'D (NOT USED ON THIS PAGE)
- ⑤ 1" & VAR. OF CL. 6, GR. D GRANULAR MATERIAL REQ'D
- ⑥ 3.5" AND VAR. 19MM ST ASPHALT REQ'D (NOT USED ON THIS PAGE)
- ⑦ 6" OF EXCESS EXCAVATION (NOT USED ON THIS PAGE)
- ⑧ 6" & VAR. OF CL. 6, GR. D CRUSHED STONE REQ'D (NOT USED ON THIS PAGE)
- ⑨ RUMBLE STRIPE REQ'D (SEE SHEET RS-2 DETAIL A 12" PAVEMENT EDGE)
- ⑩ REMOVAL OF ASPHALT PAVEMENT, ALL DEPTHS (NOT USED ON THIS PAGE)

EXISTING

- A** BITUMINOUS PAVEMENT IN PLACE
- B** GRANULAR SUBGRADE IN PLACE

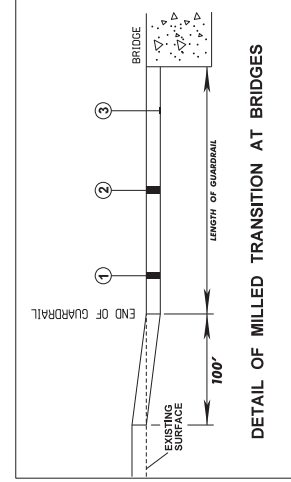
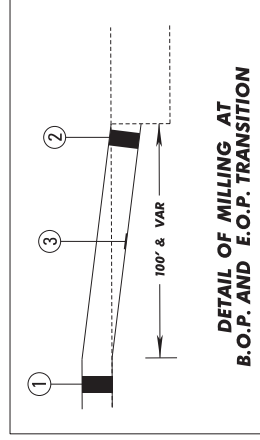
[illegible]



STATE	MISS
PROJECT NO.	MP-7043-39(015)

## SUMMARY OF QUANTITIES (SHEET 1)

PAY ITEM NO.	PAY ITEM	UNIT	LAWRENCE : 307522-301000	
			Prelim	Final
202-B007	Removal of Asphalt Pavement, All Depths	SY	1,086	
202-B240	Removal of Traffic Stripe	LF	3,220	
203-G001	Excess Excavation, FM, AH	CY	92	
304-A008	Granular Material, LVM, Class 6, Group D	CY	2,720	
304-H001	3/4" and Down Crushed Stone Base, LVM	CY	139	
	OR			
304-H002	Size 610 Crushed Stone Base, LVM	CY	139	
	OR			
304-H003	Size 825B Crushed Stone Base, LVM	CY	139	
403-A006	19-mm, ST, Asphalt Pavement	TON	1,032	
403-A015	9.5-mm, ST, Asphalt Pavement	TON	6,017	
403-B012	9.5-mm, ST, Asphalt Pavement, Leveling	TON	3,741	
406-D001	Fine Milling of Bituminous Pavement, All Depths	SY	6,061	
407-A001	Asphalt for Tack Coat	GAL	9,387	
423-A001	Rumble Strips, Ground In	MI	15	
503-C010	Saw Cut, Full Depth	LF	5,781	
618-A001	Maintenance of Traffic	LS	1	
618-B001	Additional Construction Signs	SF	1	
619-A1001	Temporary Traffic Stripe, Continuous White	MI	28	
619-A2001	Temporary Traffic Stripe, Continuous Yellow	MI	21	
619-A4002	Temporary Traffic Stripe, Skip Yellow	MI	7	
619-A5001	Temporary Traffic Stripe, Detail	LF	6,799	
619-A6002	Temporary Traffic Stripe, Legend	LF	2,868	
907-619-B001	Temporary Portable Rumble Strips	LF	132	
620-A001	Mobilization	LS	1	
626-C002	6" Thermoplastic Double Drop Edge Stripe, Continuous White	MI	14	
626-D001	6" Thermoplastic Double Drop Traffic Stripe, Skip Yellow	MI	3	
626-E001	6" Thermoplastic Double Drop Traffic Stripe, Continuous Yellow	MI	10	
626-G002	Thermoplastic Detail Stripe, White	LF	1,775	
626-G003	Thermoplastic Detail Stripe, Yellow	LF	908	
626-H005	Thermoplastic Legend, White	LF	495	
627-J001	Two-Way Clear Reflective High Performance Raised Markers	EA	353	
627-L001	Two-Way Yellow Reflective High Performance Raised Markers	EA	489	

Pay item to be used in conjunction with the Removal of Asphalt Pavement operations at the contractor's discretion. If other means or equipment is used in lieu of Saw Cut, Full Depth, no payment will be made under this item.

MISSISSIPPI DEPARTMENT OF TRANSPORTATION SUMMARY OF QUANTITIES		 Working Number SQ-1 Sheet Number 3
PROJ NO: MP-7043-39(015) COUNTY: LAWRENCE	FILENAME: 307522 SQS Design Team Checked Date 2-28-2022	



STATE	PROJECT NO.
MISS.	MP-7043-39(015)

SIGNS REQUIRED

SIGN NO.	SIZE	UNIT SQ. FT.	QUAN. REQD.	TOTAL AREA SQ. FT.	REMARKS
G20 - 1	60" X 24"	10.00	2	20.00	NO. 1 WORKS
G20 - 2	48" X 24"	8.00	2	16.00	END ROAD WORK
G20 - 4	36" X 18"	4.50			PILOT CAR FOLLOW W/
M1 - 1	24" X 24"	4.00			1 OR 2 DIGIT
M1 - 1	30" X 24"	5.00			3 DIGIT
M1 - 4	24" X 24"	4.00			1 OR 2 DIGIT
M1 - 4	30" X 24"	5.00			3 DIGIT
M1 - 5	24" X 24"	4.00			1 OR 2 DIGIT
M1 - 5	30" X 24"	5.00			3 DIGIT
M3 - 1	24" X 12"	2.00			EMER. RITE MARKER
M3 - 1	30" X 15"	3.13			EMER. RITE MARKER
M3 - 2	24" X 12"	2.00			EMER. RITE MARKER
M3 - 2	30" X 15"	3.13			EMER. RITE MARKER
M3 - 3	24" X 12"	2.00			EMER. RITE MARKER
M3 - 3	30" X 15"	3.13			EMER. RITE MARKER
M3 - 4	24" X 12"	2.00			EMER. RITE MARKER
M3 - 4	30" X 15"	3.13			EMER. RITE MARKER
M4 - 8	24" X 12"	2.00			DETOUR 1 OR 2
M4 - 8a	24" X 12"	2.00			END DETOUR
M4 - 8	30" X 15"	3.13			DETOUR 3
M4 - 9	48" X 36"	12.00			DETOUR
M4 - 9L	48" X 36"	12.00			DETOUR
M4 - 9BL	48" X 36"	12.00			DETOUR
M4 - 9SL	48" X 36"	12.00			DETOUR
M4 - 9BSL	48" X 36"	12.00			DETOUR
M4 - 9R	48" X 36"	12.00			DETOUR
M4 - 9BR	48" X 36"	12.00			DETOUR
M4 - 9SR	48" X 36"	12.00			DETOUR
M4 - 9BSR	48" X 36"	12.00			DETOUR
M4 - 10L	48" X 18"	6.00			DETOUR
M4 - 10R	48" X 18"	6.00			DETOUR
M4 - 5	24" X 12"	2.00			TO
M5 - 1R	21" X 15"	2.19			TO
M5 - 2L	21" X 15"	2.19			TO
M5 - 2R	21" X 15"	2.19			TO
M6 - 1L	21" X 15"	2.19			TO
M6 - 1R	21" X 15"	2.19			TO
M6 - 2L	21" X 15"	2.19			TO
M6 - 2R	21" X 15"	2.19			TO
M6 - 3	21" X 15"	2.19			TO
R1 - 1	36" OCTAGON	7.46			STOP
R1 - 1	48" OCTAGON	13.25			STOP
R1 - 2	36" X 36" X 36"	3.90			YIELD
R1 - 2	48" X 48" X 48"	6.93			YIELD
R1 - 3	18" X 9"	1.13			3-WAY
R1 - 3	24" X 12"	2.00			4 WAY, ETC.

SIGNS REQUIRED

SIGN NO.	SIZE	UNIT SQ. FT.	QUAN. REQD.	TOTAL AREA SQ. FT.	REMARKS
R2 - 1	24" X 30"	5.00			SPEED LIMIT 1
R2 - 1	36" X 48"	12.00			SPEED LIMIT 2
R2 - 1	48" X 60"	20.00			SPEED LIMIT 3
R3 - 1	36" X 36"	9.00			NO LEFT TURN
R3 - 1	48" X 48"	16.00			NO LEFT TURN
R3 - 2	36" X 36"	9.00			NO LEFT TURN
R3 - 2	48" X 48"	16.00			NO LEFT TURN
R3 - 3	36" X 36"	9.00			NO LEFT TURN
R3 - 3	48" X 48"	16.00			NO LEFT TURN
R3 - 5L	30" X 36"	7.50			LEFT LANE TURN LEFT
R3 - 5R	30" X 36"	7.50			RIGHT LANE TURN RIGHT
R3 - 6L	30" X 36"	7.50			LEFT LANE TURN LEFT
R3 - 6R	30" X 36"	7.50			RIGHT LANE TURN RIGHT
R3 - 7L	30" X 30"	6.25			DO NOT PASS
R3 - 7R	30" X 30"	6.25			DO NOT PASS
R4 - 1	24" X 30"	5.00	73	365	PASS WITH CARE 1
R4 - 2	24" X 30"	5.00			PASS WITH CARE 2
R4 - 2	48" X 60"	20.00	11	220	PASS WITH CARE 3
R4 - 7	48" X 60"	20.00			DO NOT ENTER
R4 - 8	48" X 60"	20.00			DO NOT ENTER
R5 - 1	48" X 48"	16.00			WRONG WAY
R5 - 1a	42" X 30"	8.75			WRONG WAY
R6 - 1L	36" X 12"	3.00			ONE WAY
R6 - 1R	36" X 12"	3.00			ONE WAY
R6 - 2L	24" X 30"	5.00			ONE WAY
R6 - 2R	24" X 30"	5.00			ONE WAY
R11 - 2	48" X 30"	10.00			ROAD CLOSED
R11 - 3a	60" X 30"	12.50			ROAD CLOSED
R11 - 3b	60" X 30"	12.50			ROAD CLOSED
R11 - 4	60" X 30"	12.50			ROAD CLOSED
R12 - 1	36" X 48"	12.00			WEIGHT LIMIT
R16 - 3	36" X 48"	12.00			WEIGHT LIMIT
W1 - 1L	48" X 48"	16.00			WHEN WORKERS ARE PRESENT
W1 - 1R	48" X 48"	16.00			WHEN WORKERS ARE PRESENT
W1 - 2L	48" X 48"	16.00			WHEN WORKERS ARE PRESENT
W1 - 2R	48" X 48"	16.00			WHEN WORKERS ARE PRESENT
W1 - 3L	48" X 48"	16.00			WHEN WORKERS ARE PRESENT
W1 - 3R	48" X 48"	16.00			WHEN WORKERS ARE PRESENT
W1 - 4aL	48" X 48"	16.00			WHEN WORKERS ARE PRESENT
W1 - 4aR	48" X 48"	16.00			WHEN WORKERS ARE PRESENT
W1 - 5L	48" X 48"	16.00			WHEN WORKERS ARE PRESENT
W1 - 5R	48" X 48"	16.00			WHEN WORKERS ARE PRESENT
W1 - 6L	48" X 24"	8.00			WHEN WORKERS ARE PRESENT
W1 - 6R	48" X 24"	8.00			WHEN WORKERS ARE PRESENT
W1 - 6R	60" X 30"	12.50			WHEN WORKERS ARE PRESENT
W1 - 7	60" X 24"	8.00			WHEN WORKERS ARE PRESENT
W1 - 7	60" X 30"	12.50			WHEN WORKERS ARE PRESENT
W1 - 8L	18" X 24"	3.00			WHEN WORKERS ARE PRESENT
W1 - 8L	36" X 48"	12.00			WHEN WORKERS ARE PRESENT
W1 - 8R	18" X 24"	3.00			WHEN WORKERS ARE PRESENT
W1 - 8R	36" X 48"	12.00			WHEN WORKERS ARE PRESENT

SIGNS REQUIRED

SIGN NO.	SIZE	UNIT SQ. FT.	QUAN. REQD.	TOTAL AREA SQ. FT.	REMARKS
W1 - 9L	48" X 48"	16.00			WHEN WORKERS ARE PRESENT
W1 - 9R	48" X 48"	16.00			WHEN WORKERS ARE PRESENT
W2 - 6	36" X 36"	9.00			WHEN WORKERS ARE PRESENT
W3 - 1a	48" X 48"	16.00			WHEN WORKERS ARE PRESENT
W3 - 2a	48" X 48"	16.00			WHEN WORKERS ARE PRESENT
W3 - 3	48" X 48"	16.00			WHEN WORKERS ARE PRESENT
W3 - 5	48" X 48"	16.00			WHEN WORKERS ARE PRESENT
W4 - 1L	48" X 48"	16.00			WHEN WORKERS ARE PRESENT
W4 - 1R	48" X 48"	16.00			WHEN WORKERS ARE PRESENT
W4 - 2L	48" X 48"	16.00			WHEN WORKERS ARE PRESENT
W4 - 2R	48" X 48"	16.00			WHEN WORKERS ARE PRESENT
W4 - 3L	48" X 48"	16.00			WHEN WORKERS ARE PRESENT
W4 - 3R	48" X 48"	16.00			WHEN WORKERS ARE PRESENT
W4 - 6	48" X 48"	16.00			WHEN WORKERS ARE PRESENT
W5 - 1a	48" X 48"	16.00			WHEN WORKERS ARE PRESENT
W6 - 1	48" X 48"	16.00			WHEN WORKERS ARE PRESENT
W6 - 2	48" X 48"	16.00			WHEN WORKERS ARE PRESENT
W6 - 3	48" X 48"	16.00			WHEN WORKERS ARE PRESENT
W8 - 1	48" X 48"	16.00			WHEN WORKERS ARE PRESENT
W8 - 4	48" X 48"	16.00			WHEN WORKERS ARE PRESENT
W8 - 6	48" X 48"	16.00			WHEN WORKERS ARE PRESENT
W8 - 7	48" X 48"	16.00			WHEN WORKERS ARE PRESENT
W8 - 9	48" X 48"	16.00			WHEN WORKERS ARE PRESENT
W8 - 11	36" X 36"	9.00			WHEN WORKERS ARE PRESENT
W8 - 12	48" X 48"	16.00			WHEN WORKERS ARE PRESENT
W10 - 1	36" DIA.	7.07			WHEN WORKERS ARE PRESENT
W13 - 1	24" X 24"	4.00			WHEN WORKERS ARE PRESENT
W14 - 3	36" X 48" X 48"	5.56	73	405.88	WHEN WORKERS ARE PRESENT
W16-2	24" X 18"	3.00			WHEN WORKERS ARE PRESENT
W19 - 2	48" X 48"	16.00			WHEN WORKERS ARE PRESENT
W20 - 1	48" X 48"	16.00			WHEN WORKERS ARE PRESENT
W20 - 1	36" X 36"	9.00	19	304	WHEN WORKERS ARE PRESENT
W20 - 2	48" X 48"	16.00			WHEN WORKERS ARE PRESENT
W20 - 3	48" X 48"	16.00			WHEN WORKERS ARE PRESENT
W20 - 4	48" X 48"	16.00			WHEN WORKERS ARE PRESENT
W20 - 4B	48" X 48"	16.00			WHEN WORKERS ARE PRESENT
W20 - 5L	48" X 48"	16.00			WHEN WORKERS ARE PRESENT
W20 - 5R	48" X 48"	16.00			WHEN WORKERS ARE PRESENT
W20 - 7a	48" X 48"	16.00			WHEN WORKERS ARE PRESENT
W21 - 1	36" X 36"	9.00			WHEN WORKERS ARE PRESENT
W21 - 1a	36" X 36"	9.00			WHEN WORKERS ARE PRESENT

SIGNS REQUIRED

SIGN NO.	SIZE	UNIT SQ. FT.	QUAN. REQD.	TOTAL AREA SQ. FT.	REMARKS
W21 - 2	36" X 36"	9.00			FRESH OIL (TAR )
W21 - 3	48" X 48"	16.00			ADVANCE ROAD MACHINERY
W21 - 5	48" X 48"	16.00			SHOULDER WORK
W21 - 6	36" X 36"	9.00			SURVEY CREW
W24 - 1L	48" X 48"	16.00			W24 - 1R
W24 - 1A	48" X 48"	16.00			W24 - 1B
W24 - 1A	48" X 48"	16.00			W24 - 1B
W24 - 1B	48" X 48"	16.00			W24 - 1C
W24 - 1C	48" X 48"	16.00			W24 - 1D
VP - 1L	12" X 36"	3.00			VP - 1R
VP - 1R	12" X 36"	3.00			VP - 1S
OM - 3L	12" X 36"	3.00			OM - 3R
OM - 3R	12" X 36"	3.00			OM - 3S
TOTAL SIGN AREA				786.88 SQ. FT.	
TOTAL SIGN AREA				10 SQ. FT. OR MORE	544.00 SQ. FT.
1 STANDARD					
2 SPECIAL (USE WHERE WARRANTED)					

NOTES

- INTERSTATE ROUTE MARKER
- UNITED STATES ROUTE MARKER
- STATE ROUTE MARKER
- COLORS OF CARDINAL DIRECTION MARKERS AND DIRECTIONAL ARROWS SHALL BE APPROPRIATE TO MATCH ACCOMPANYING ROUTE MARKERS.
- BLACK STRIPES ON YELLOW BACKGROUND
- INTERSTATE USE ONLY
- TOP OF SIGN - BLACK LETTERING ON ORANGE BACKGROUND. BOTTOM OF SIGN - BLACK LETTERING ON WHITE BACKGROUND.
- THE BACKGROUND OF ALL WARNING SIGNS ("W" SERIES EXCEPT "W10-1" SHALL BE ORANGE. THE "W10-1" BACKGROUND SHALL BE YELLOW IN ALL CASES.

Notice to Bidders No. 4066

MISSISSIPPI DEPARTMENT OF TRANSPORTATION	
ESTIMATED QUANTITIES FOR TRAFFIC CONTROL SIGNS	
PROJ. NO.: MP-7043-39(015)	
COUNTY: LAWRENCE	
WORKING NUMBER	SHEET NUMBER
DP-1	4
FILE NAME:	DATE
DESIGN TEAM	DATE 08-20-21



FMS CON: 307522301000	PROJECT NO.
STATE	MISS.
MISS.	MP-7043-39(015)

NOTE: W20-1 (48"X48") SHALL BE REQ'D ON ALL LOCAL ROADS.

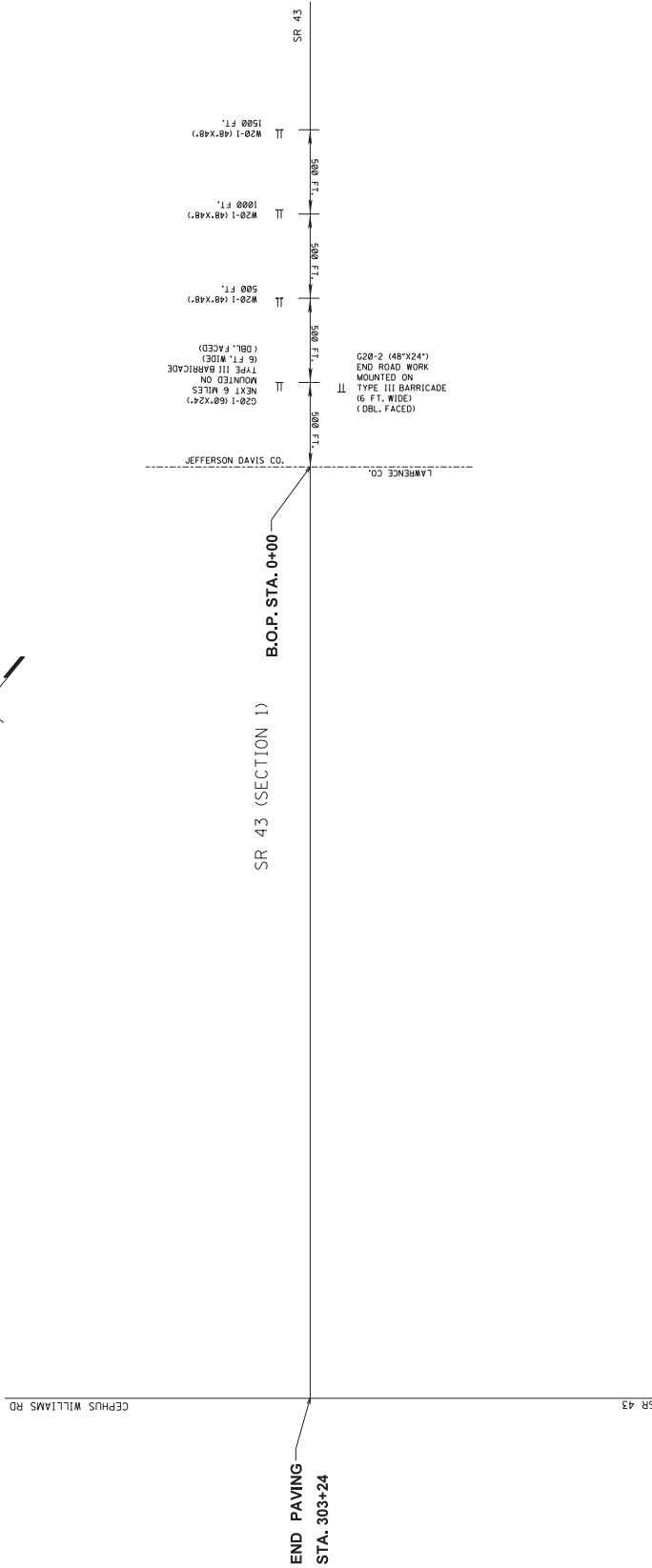

W14-3  
(NPF2)

R4-2  
(PWC)

R4-1  
(ONP)

W14-3  
(NPF2)

R4-2  
(PWC)

R4-1  
(ONP)

\*\*\* NOT TO SCALE \*\*\*

<b>MISSISSIPPI DEPARTMENT OF TRANSPORTATION</b>	
<b>DETAIL OF CONSTRUCTION SIGNING</b>	<div style="border: 1px solid black; padding: 5px;"> <div style="display: flex; justify-content: space-between;"> <div> <b>PROJECT NO.:</b> MP-7043-39(015)  <b>COUNTY:</b> LAWRENCE  <b>FILE NAME:</b> </div> <div> <b>DESIGN TEAM</b>  <div style="display: flex; justify-content: space-between;"> <div> <b>BY</b>  <div style="border-bottom: 1px solid black; width: 100px;"></div> </div> <div> <b>DATE</b>  <div style="border-bottom: 1px solid black; width: 100px;"></div> </div> </div> </div> </div> </div>



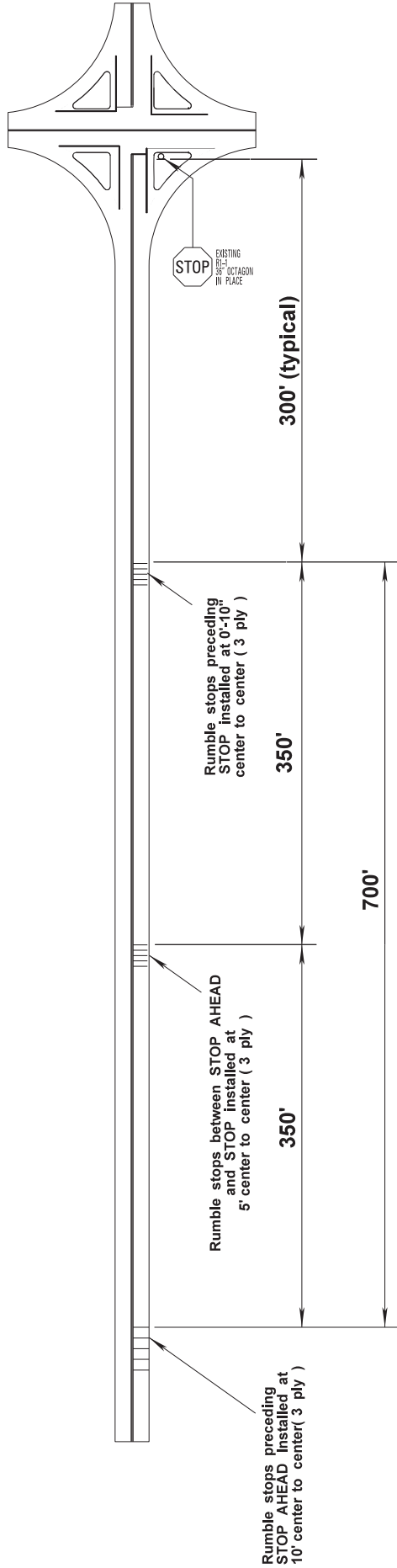

**NOTES:**

**Install rumble stop bars as shown :**

1. 1 set of rumble stops approx. 250' from STOP AHEAD
2. 1 set of rumble stops approx. 300' from STOP
3. 1 set of rumble stops approx. Halfway between first and last set
4. Rumble stops to be 6" thermoplastic (120 mil/each ply, 360 mil total)
5. 5 rumble stops per set minimum
6. Installation may vary due to terrain
7. Signs should be 48" for channelized intersection, 36" for non-channelized intersection

[illegible]

STATE	PROJECT NO.
MISS.	MP-7043-39(015)

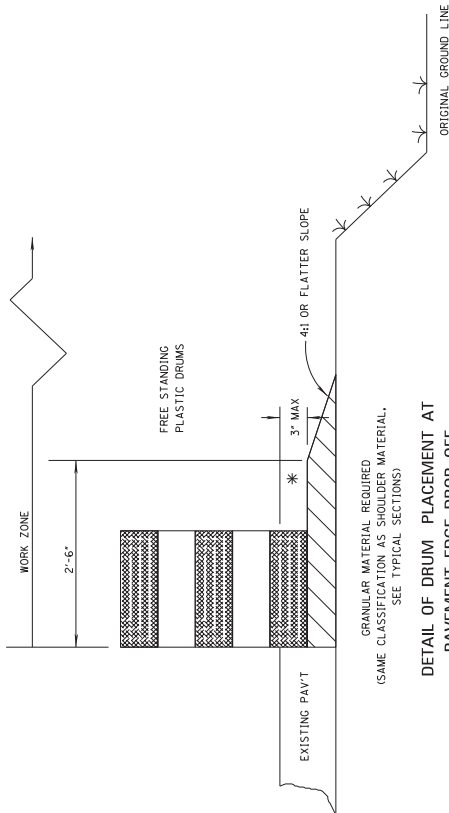

GRANULAR MATERIAL REQUIRED  
(SAME CLASSIFICATION AS SHOULDER MATERIAL,  
SEE TYPICAL SECTIONS)

### DETAIL OF DRUM PLACEMENT AT PAVEMENT EDGE DROP-OFF

#### NOTES:

\* A. PAVEMENT EDGE DROP-OFF

1. IF LESS THAN TWO AND ONE QUARTER (2.25) INCHES-NO PROTECTION REQUIRED. PLACE A SHOULDER WORK SIGN (W21-5) 500 FEET IN ADVANCE OF WORK ZONE SHOULDER AND A LOW SHOULDER SIGN (W8-3) AT THE BEGINNING AND THROUGHOUT THE WORK ZONE @ (1 MILE ±0.C.).
2. TWO AND ONE QUARTER TO THREE INCHES-PLACE DRUMS, VERTICAL PANELS OR BARRICADES EVERY 100 FEET ON TANGENT SECTIONS FOR SPEEDS OF 50 MILES PER HOUR OR GREATER. CONES MAY BE USED IN PLACE OF DRUMS, PANELS, AND BARRICADES DURING DAYLIGHT HOURS. FOR TANGENT SECTIONS WITH SPEEDS LESS THAN 50 MILES PER HOUR AND FOR CURVES, DEVICES SHOULD BE PLACED EVERY 50 FEET. SPACING FOR TAPERS SHOULD BE IN ACCORDANCE WITH THE MULTIPLYING FACTOR (L / 3), WHERE L IS THE TAPER LENGTH IN FEET.
3. GREATER THAN THREE (3) INCHES-POSITIVE SEPARATION OR WEDGE WITH 4:1 OR FLATTER SLOPE NEEDED. IF THERE IS EIGHT (8) FEET OR MORE DISTANCE BETWEEN THE EDGE OF TRAVEL LANE AND DROP-OFF, THEN DRUMS, PANELS OR BARRICADES MAY BE USED.
4. FOR TEMPORARY CONDITIONS, DROP-OFFS GREATER THAN THREE (3) INCHES MAY BE PROTECTED WITH DRUMS, VERTICAL PANELS OR BARRICADES FOR SHORT DISTANCES DURING DAYLIGHT HOURS WHILE WORK IS BEING DONE IN THE DROP-OFF AREA.
5. LESSER TREATMENTS THAN THOSE DESCRIBED ABOVE MAY BE CONSIDERED FOR LOW-VOLUME LOCAL STREETS.

#### B. DRUM SPACING

1. TANGENTS =  $2 \times S$
2. TAPERS =  $L / 3$   
WHERE  $L =$  TAPER LENGTH IN FEET  
 $S =$  SPEED IN MPH (POSTED OR 85 PERCENTILE)  
 $W =$  WIDTH OF OFFSET IN FEET

C. ALL TRAFFIC CONTROL ITEMS SHOWN ON THIS SHEET SHALL BE PAID FOR UNDER MAINTENANCE OF TRAFFIC.

TABLE VI-1. GUIDELINES FOR LENGTH OF  
LONGITUDINAL BUFFER SPACE

POSTED SPEED (MPH)	LENGTH (FEET)
20	25
25	30
30	35
35	40
40	45
45	50
50	55
55	60
60	65
65	70
70	75
75	80
80	85
85	90
90	95
95	100
100	105
105	110
110	115
115	120
120	125
125	130
130	135
135	140
140	145
145	150
150	155
155	160
160	165
165	170
170	175
175	180
180	185
185	190
190	195
195	200
200	205
205	210
210	215
215	220
220	225
225	230
230	235
235	240
240	245
245	250
250	255
255	260
260	265
265	270
270	275
275	280
280	285
285	290
290	295
295	300
300	305
305	310
310	315
315	320
320	325
325	330
330	335
335	340
340	345
345	350
350	355
355	360
360	365
365	370
370	375
375	380
380	385
385	390
390	395
395	400
400	405
405	410
410	415
415	420
420	425
425	430
430	435
435	440
440	445
445	450
450	455
455	460
460	465
465	470
470	475
475	480
480	485
485	490
490	495
495	500
500	505
505	510
510	515
515	520
520	525
525	530
530	535
535	540
540	545
545	550
550	555
555	560
560	565
565	570
570	575
575	580
580	585
585	590
590	595
595	600
600	605
605	610
610	615
615	620
620	625
625	630
630	635
635	640
640	645
645	650
650	655
655	660
660	665
665	670
670	675
675	680
680	685
685	690
690	695
695	700
700	705
705	710
710	715
715	720
720	725
725	730
730	735
735	740
740	745
745	750
750	755
755	760
760	765
765	770
770	775
775	780
780	785
785	790
790	795
795	800
800	805
805	810
810	815
815	820
820	825
825	830
830	835
835	840
840	845
845	850
850	855
855	860
860	865
865	870
870	875
875	880
880	885
885	890
890	895
895	900
900	905
905	910
910	915
915	920
920	925
925	930
930	935
935	940
940	945
945	950
950	955
955	960
960	965
965	970
970	975
975	980
980	985
985	990
990	995
995	1000

\* \* POSTED SPEED, OFF-PEAK 85 PERCENTILE SPEED  
PRIOR TO WORK STARTING, OR THE ANTICIPATED  
OPERATING SPEED IN MPH.

PLASTIC DRUMS  
(SEE NOTE FOR SPACING)

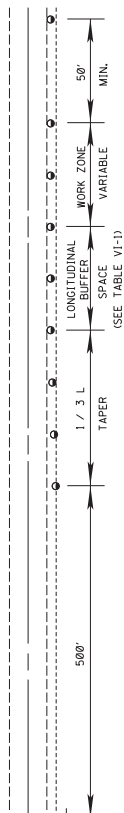

### TYPICAL SHOULDER CLOSURE

- (1) TO BE USED WITH EIGHT (8) FOOT OR GREATER WIDTH IMPROVED SHOULDER.
- (2) TO BE USED WHEN CONSTRUCTION VEHICLES (EQUIPMENT) ENCROACHES ON OR WITHIN TWO (2) FEET OF THE SHOULDER BREAK.

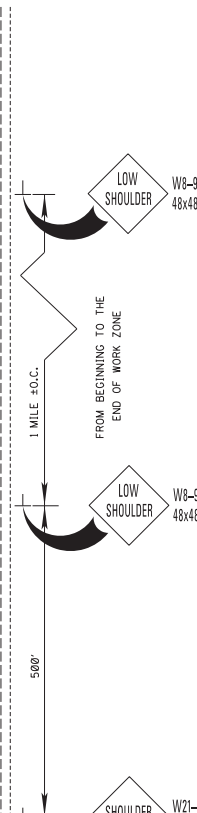

### TYPICAL SHOULDER WORK #1 (SEE NOTE A-1 THIS SHEET)

PLASTIC DRUMS  
(SEE NOTE FOR SPACING)

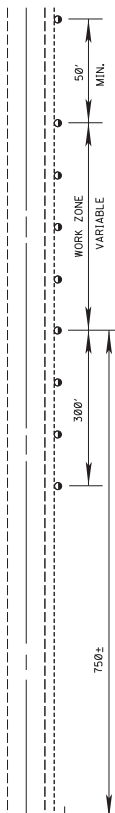

### TYPICAL SHOULDER WORK #2

NOTE:  
WORK OUTSIDE TWO (2) FOOT AND WITHIN TEN (10) FEET OF THE SHOULDER BREAK MAY BE PROTECTED BY  
PLACING DRUMS ALONG THE SHOULDER EDGE, 300 FEET PRIOR TO AND 50 FEET BEYOND THE WORK AREA, OR  
SEE NOTE A-3 THIS SHEET.

MISSISSIPPI DEPARTMENT OF TRANSPORTATION	
BY	REVISION
TRAFFIC CONTROL DETAILS DRUM PLACEMENT AND SHOULDER CLOSURE	
PROJECT NO.: MP-7043-39(015)	
COUNTY: LAWRENCE	
DATE	DESIGN TEAM
FILE NAME:	CHECKED
DATE	DATE
NUMBER	9
NUMBER	9



PAVEMENT MARKING

SYMBOL	DESCRIPTION	TYPE
(1)	TWO WAY - CLEAR REFL. RAISED MARKERS	EACH
(2)	RED-CLEAR REFLECTIVE RAISED MARKERS	EACH
(3)	TWO-WAY YELLOW REFLC. RAISED MARKER	EACH
(4)	6" TRAFFIC SKIP WHITE (10'-30')	PLASTIC
(5)	6" CONTINUOUS EDGE WHITE (SOLID)	PLASTIC
(6)	6" CONTINUOUS TRAFFIC YELLOW	PLASTIC
(7)	6" CONTINUOUS EDGE YELLOW (SOLID)	PLASTIC
(8)	6" CONTINUOUS TRAFFIC WHITE	PLASTIC
(9)	6" DETAIL STRIPE WHITE (SOLID)	PLASTIC
(10)	6" DETAIL STRIPE YELLOW (SOLID)	PLASTIC
(11)	6" DETAIL SKIP WHITE (2'-12')	PLASTIC
(12)	12" DETAIL STRIPE WHITE (SOLID)	PLASTIC
(13)	24" THERMO LEGEND WHITE (STOP BAR)	PLASTIC
(14)	24" THERMO LEGEND WHITE (YIELD BAR)	PLASTIC

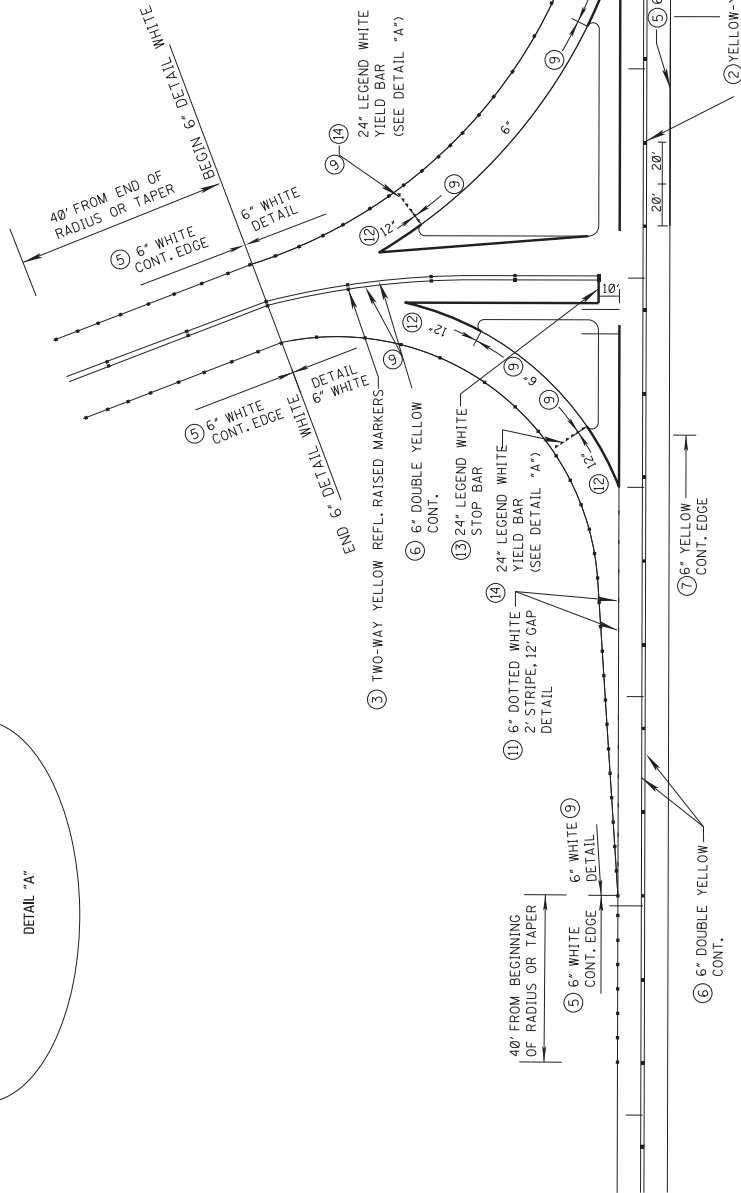
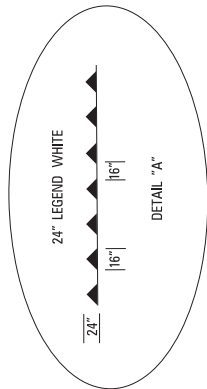

TANGENT SECTIONS	URBAN AREA (FT - IN)	RURAL AREA (FT - IN)
HORIZONTAL CURVES	40' - 0"	80' - 0"
INTERCHANGE LIMITS	40' - 0"	40' - 0"

MISSISSIPPI DEPARTMENT OF TRANSPORTATION

DETAIL OF STRIPING  
CHANNELIZED INTERSECTIONS  
2-LANE HIGHWAY

WORKING NUMBER  
MPD-3

PROJECT NO.: MP-7043-39(015)  
COUNTY: LAWRENCE

DATE: \_\_\_\_\_  
DESIGN TEAM: \_\_\_\_\_  
CHECKED: \_\_\_\_\_  
DATE: \_\_\_\_\_



STATE	PROJECT NO.
MISS.	MP-7043-39(015)

PAVEMENT MARKING

SYMBOL	DESCRIPTION	UNIT	TYPE	QUANTITY
①	6" THERMOPLASTIC TRAFFIC STRIPE SKIP WHITE	LF	PLASTIC	
②	6" THERMOPLASTIC TRAFFIC STRIPE CONT. WHITE	LF	PLASTIC	
③	6" THERMOPLASTIC EDGE STRIPE CONT. WHITE	LF	PLASTIC	
④	6" THERMOPLASTIC TRAFFIC STRIPE CONT. YELLOW	LF	PLASTIC	
⑤	6" THERMOPLASTIC TRAFFIC STRIPE CONT. YELLOW	LF	PLASTIC	
⑥	6" THERMOPLASTIC DETAIL STRIPE, WHITE	LF	PLASTIC	
⑦	6" THERMOPLASTIC DETAIL STRIPE, YELLOW	LF	PLASTIC	
⑧	THERMOPLASTIC LEGEND, WHITE	LF	PLASTIC	
⑨	THERMOPLASTIC LEGEND, YELLOW	SF	PLASTIC	
⑩	RED-REFLECTIVE HIGH PERF. RAISED MARKERS			
⑪	RED-CLEAR REFLECTIVE HIGH PERF. RAISED MARKERS			
⑫	TWO-WAY YELLOW REFLECTIVE HIGH PERF. RAISED MARKERS			
⑬				
⑭				

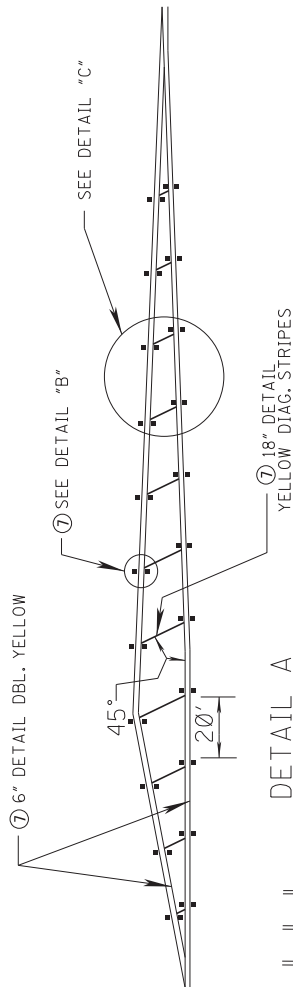

DETAIL A

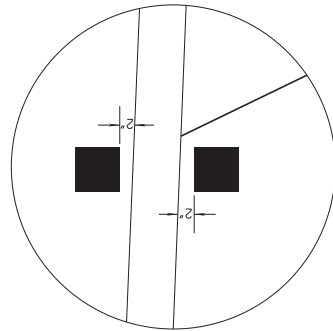

DETAIL B

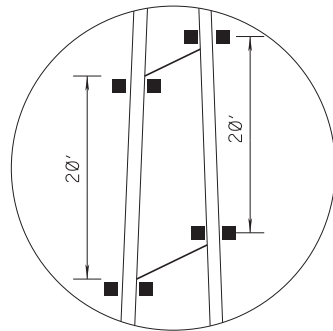

DETAIL C

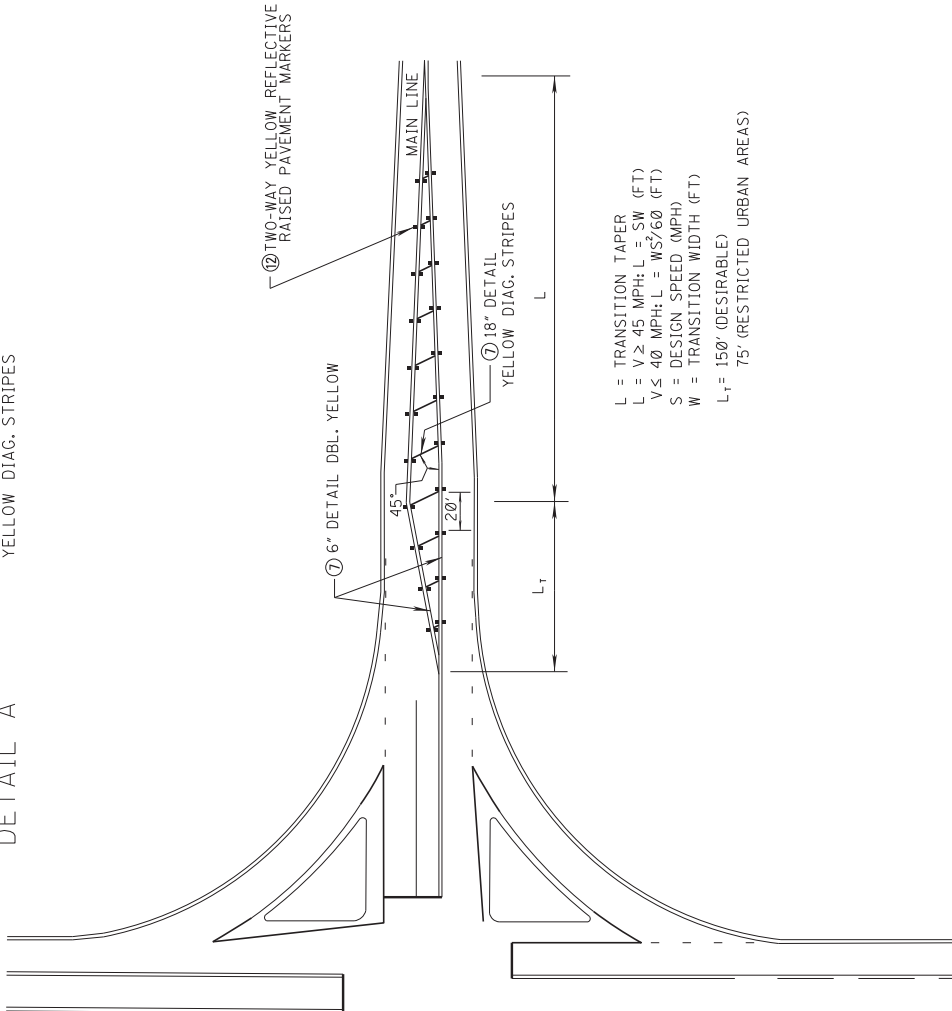

L = TRANSITION TAPER  
L =  $V \geq 45$  MPH; L = SW (FT)  
V ≤ 40 MPH; L =  $WS^2/60$  (FT)  
S = DESIGN SPEED (MPH)  
W = TRANSITION WIDTH (FT)  
L<sub>1</sub> = 150' (DESIRABLE)  
75' (RESTRICTED URBAN AREAS)

MISSISSIPPI DEPARTMENT OF TRANSPORTATION	
BY	REVISION
PAVEMENT MARKING DETAILS FOR GORE AREAS	
PROJECT NO.: MP-7043-39(015)	
COUNTY: LAWRENCE	
FILE NAME:	DESIGN TEAM
DATE	CHECKED
	12



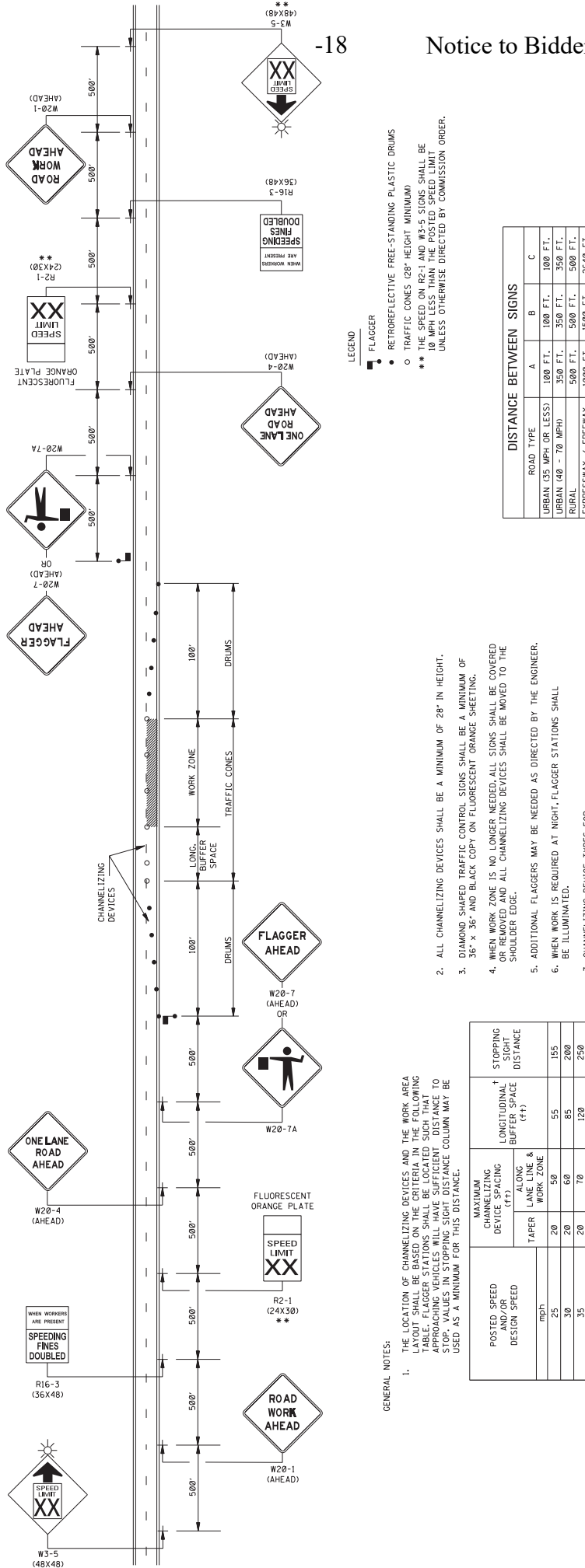

-18

Notice to Bidders No. 4066 — Construction

- LEGEND
- FLAGGER
  - RETROREFLECTIVE FREE-STANDING PLASTIC DRUMS
  - TRAFFIC CONES (28" HEIGHT MINIMUM)
  - THE SPEED ON R2-1 AND W3-5 SIGNS SHALL BE THE SPEED LIMIT UNLESS OTHERWISE DIRECTED BY COMMISSION ORDER.

DISTANCE BETWEEN SIGNS			
ROAD TYPE	A	B	C
URBAN (35 MPH OR LESS)	100 FT.	100 FT.	100 FT.
URBAN (40 - 70 MPH)	350 FT.	350 FT.	350 FT.
RURAL	500 FT.	500 FT.	500 FT.
EXPRESSWAY / FREEWAY	1000 FT.	1500 FT.	2640 FT.

- ALL CHANNELIZING DEVICES SHALL BE A MINIMUM OF 28" IN HEIGHT.
- DIAMOND SHAPED TRAFFIC CONTROL SIGNS SHALL BE A MINIMUM OF 36" x 36" AND BLACK COPY ON FLUORESCENT ORANGE SHEETING.
- WHEN WORK ZONE IS NO LONGER NEEDED, ALL SIGNS SHALL BE COVERED OR REMOVED AND ALL CHANNELIZING DEVICES SHALL BE MOVED TO THE SHOULDER EDGE.
- ADDITIONAL FLAGGERS MAY BE NEEDED AS DIRECTED BY THE ENGINEER.
- WHEN WORK IS REQUIRED AT NIGHT, FLAGGER STATIONS SHALL BE ILLUMINATED.
- CHANNELIZING DEVICE TYPES FOR:  
A. APPROACH AND EXIT TAPERS - RETROREFLECTIVE PLASTIC DRUMS  
B. ALONG LANE LINE AND WORK ZONE - TRAFFIC CONES (28" HEIGHT)
- ALL TRAFFIC CONTROL ITEMS SHOWN ON THIS SHEET WILL NOT BE MEASURED FOR SEPARATE PAYMENT. THIS WORK SHALL BE INCLUDED IN THE PRICE BID FOR MAINTENANCE OF TRAFFIC.

POSTED SPEED AND/OR DESIGN SPEED	MAXIMUM CHANNELIZING DEVICE SPACING (ft)		LONGITUDINAL BUFFER SPACE (ft)	STOPPING DISTANCE
	TAPER	LANE LINE & WORK ZONE		
25	20	50	55	155
30	20	60	85	200
35	20	70	120	250
40	20	80	170	305
45	20	90	220	360
50	20	100	280	425
55	20	110	335	495
60	20	120	415	570
65	20	130	485	645

- GENERAL NOTES:
- THE LOCATION OF CHANNELIZING DEVICES AND THE WORK AREA LAYOUT SHALL BE BASED ON THE CRITERIA IN THE FOLLOWING TABLE. FLAGGER STATIONS SHALL BE LOCATED SUCH THAT APPROACHING VEHICLES WILL HAVE SUFFICIENT DISTANCE TO STOP. VALUES IN STOPPING DISTANCE COLUMN MAY BE USED AS A MINIMUM FOR THIS DISTANCE.
- † NOTE: BUFFER SPACE MAY BE ADJUSTED AS NEEDED ACCORDING TO ROADWAY GEOMETRY TO MEET SIGHT DISTANCE REQUIREMENTS, AS DIRECTED BY THE ENGINEER.

MISSISSIPPI DEPARTMENT OF TRANSPORTATION

TRAFFIC CONTROL PLAN  
WITH FLAGGER  
(ONE-LANE CLOSURE OF  
TWO-WAY TRAFFIC)

PROJECT NO.: MP-7043-39(015)  
COUNTY: LAWRENCE

WORK ORDER NUMBER: SDTCP-1  
SHEET NUMBER: 14

DATE: \_\_\_\_\_  
DESIGN TEAM: \_\_\_\_\_

FMS CON: 307522301000	PROJECT NO.
STATE	MISS.
MISS.	MP-7043-39(015)

- GENERAL NOTES
1. GROUND-IN RUMBLE STRIPES SHALL BE APPLIED ON LEFT AND RIGHT SHOULDERS OF ALL PAVED SHOULDERS ON THIS PROJECT
  2. GROUND-IN RUMBLE STRIPES SHALL BE OMITTED ACROSS PRINCIPAL INTERSECTING ROADWAYS OR OTHER INTERRUPTIONS IN NORMAL SHOULDER WIDTH AS DIRECTED BY THE ENGINEER
  3. COST TO BE PAID FOR USING APPROPRIATE PAY ITEMS
  4. GROUND-IN RUMBLE STRIPES SHALL BE APPLIED TO MAINLINE ONLY

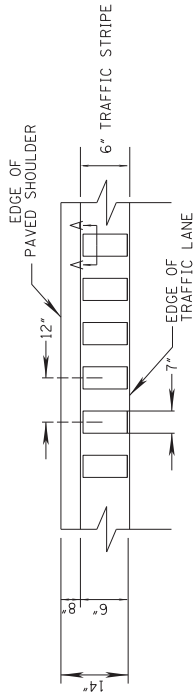

**DETAIL "A"**  
**12' PAVEMENT EDGE**

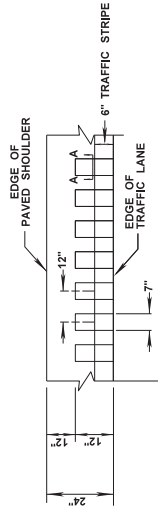

**DETAIL "A"**  
**14' PAVEMENT EDGE**

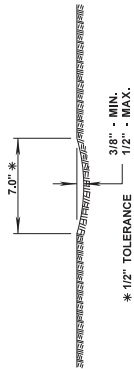

**SECTION "A-A"**

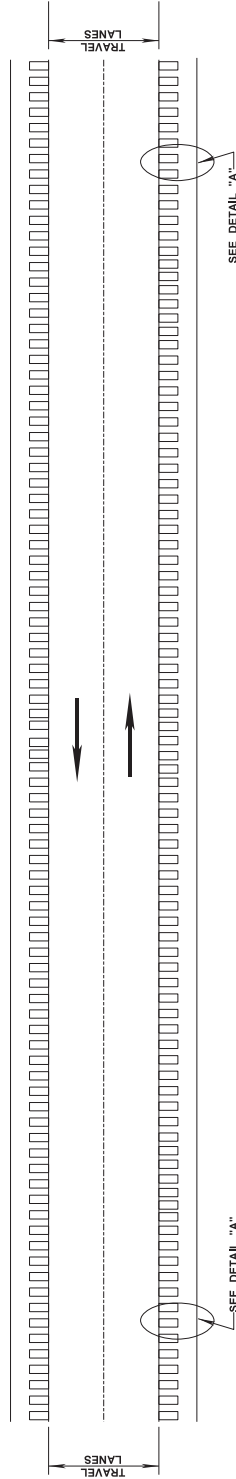

**PLAN**  
**NOT TO SCALE**

MISSISSIPPI DEPARTMENT OF TRANSPORTATION	PROJECT NO.
DETAIL OF RUMBLE STRIPS (GROUND IN)	MISS.
PROJ. NO.: MP-7043-39(015)	FILE NAME:
COUNTY: LAWRENCE	DESIGN TEAM
DATE	CHECKED
DATE	DATE

WORKING NUMBER	15
FILE NUMBER	15