

INCLUDED THIS PROJECT		BEGIN WITH SHEET
<input checked="" type="checkbox"/>	ROADWAY	1
<input checked="" type="checkbox"/>	PERMANENT SIGNS	12
<input checked="" type="checkbox"/>	TRAFFIC SIGNALS	17
<input type="checkbox"/>	ITS COMPONENTS	3001
<input type="checkbox"/>	LIGHTING	4001
<input type="checkbox"/>	(RESERVED)	5001
<input checked="" type="checkbox"/>	ROADWAY STANDARD DWGS	6001
<input type="checkbox"/>	BOX CULVERT STD. DRAWINGS (LRFD) ...	7001
<input type="checkbox"/>	BOX CULVERT STD. DRAWINGS (STD. SPEC.)	7501
<input type="checkbox"/>	STRUCTURES	8001
<input type="checkbox"/>	CROSS SECTIONS	9001

BOX BRIDGES REQ'D.
NONE

BOP
STA. 30 + 00

COUNTY LINE -----

TOWN CORPORATION LINE -----

SECTION LINE -----

EXISTING ROAD OR TRAVELED WAY -----

PROPOSED ROAD OR TRAVELED WAY -----

RAILROAD -----

SURVEY LINE -----

BRIDGES -----

LENGTH DATA

LENGTH OF ROADWAY	40,648	FT.	7.698	MI.
LENGTH OF BRIDGES	0	FT.	<u>0</u>	MI.
LENGTH OF PROJECT (NET)	40,648		7.698	MI.
LENGTH OF EXCEPTIONS	0	FT.	<u>0</u>	MI.
LENGTH OF PROJECT (GROSS)	40,648		7.698	MI.

MISSISSIPPI DEPARTMENT OF TRANSPORTATION

**PLAN AND PROFILE OF PROPOSED
STATE HIGHWAY
FEDERAL AID PROJECT NO. NH-0002-05(087)**

**FROM END DIVIDED HIGHWAY TO 0.3 MILES
NORTH OF GATLIN ROAD 5 LANE
COLUMBUS LOWNDES COUNTY**

SCALES			
PLAN		1 IN. =	100 FT.
PROFILE	{	HOR.	1 IN. = 100 FT.
		VERT.	1 IN. = 10 FT.
LAYOUT		1 IN. =	FT.

FMS. CONST. NO. 107678/301000

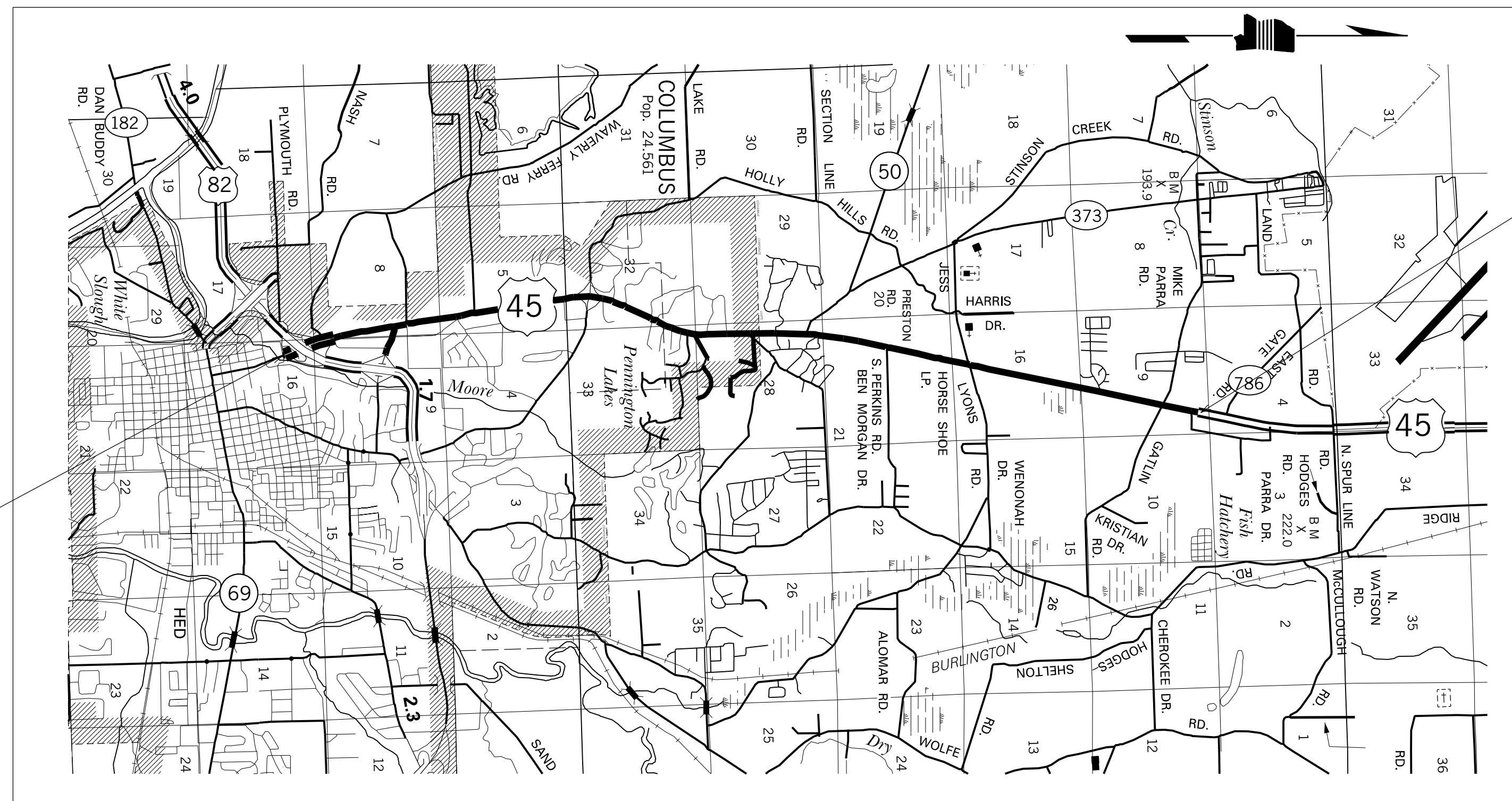

EOP
STA. 436 + 48

STATE	PROJECT NUMBER	SHEET NO.
MISSISSIPPI	NH-0002-05(087)	1

STATE MAP

NOTE
★ INDICATES APPROXIMATE LOCATION OF PROJECT.

LAT. 33°33'41" N LONG. 88°25'25" W
(APPROX. MIDDLE OF PROJECT)

<h2 style="margin: 0;">DESIGN CONTROL</h2>		
<div style="border-bottom: 1px solid black; height: 20px; margin-bottom: 5px;"></div> <div style="display: flex; justify-content: space-between; align-items: center;"> MPH = V (SPEED DESIGN) </div>		
<div style="display: flex; justify-content: space-between;"> ADT () = : ADT () = : </div>		
<div style="display: flex; justify-content: space-between;"> DHV = : D = % T = % </div>		
<h3 style="margin: 0;">PERMITS ACQUIRED BY MDOT</h3>		
WETLANDS AND WATERS PERMITS (NECESSARY FOR ULTIMATE IMPROVEMENTS ONLY):		
	WATERS	WETLANDS
NATIONWIDE #14	<input type="checkbox"/>	<input type="checkbox"/>
NATIONWIDE (OTHER)*	<input type="checkbox"/>	<input type="checkbox"/>
GENERAL*	<input type="checkbox"/>	<input type="checkbox"/>
INDIVIDUAL (404)*	<input type="checkbox"/>	<input type="checkbox"/>
<small>* ACQUISITION OF PERMITS FOR TEMPORARY IMPACTS DURING CONSTRUCTION ARE THE RESPONSIBILITY OF THE CONTRACTOR</small>		
STORMWATER PERMIT		<input type="checkbox"/>
Y	REQUIRED. CNOI SUBMITTED BY MDOT (DISTURBED AREA = 5 ACRES)	
S	REQUIRED. SCNOI TO BE SUBMITTED BY CONTRACTOR (1 TO 4.99 ACRES)	
N	NO STORMWATER PERMIT REQUIRED (<1 ACRE)	
APPROVED BY:		

		P S & E DATE: 1/4/2022	
		BY	APPROVED:
		REVISIONS	DEPUTY EXECUTIVE DIRECTOR / CHIEF ENGINEER
			EXECUTIVE DIRECTOR
		DATE	

MMDDYY 00:00 AM PM DGNFI LENAME

- ① WHERE MILLING OF THE ROADWAY LANES IS REQUIRED, THE CONTRACTOR SHALL PROVIDE OUTLETS IN THE EXISTING SHOULDERS AT SUFFICIENT INTERVALS TO PREVENT POOLING OR STANDING WATER ON THE MILLED SURFACE. (ABSORBED COST)
- ② FLUORESENT ORANGE SHEETING SHALL BE USED ON ALL CONSTRUCTION AND TRAFFIC CONTROL SIGNS EXCEPT FOR THOSE DESIGNATED ON THE PLANS TO BE BLACK LEGEND AND BORDER ON THE WHITE BACKGROUND.
- ③ THE LOCATION AND SPACING OF SIGNS, SHOWN ON THE TRAFFIC CONTROL PLANS, ARE APPROXIMATE AND MAY BE ADJUSTED AS NECESSARY TO FIT FIELD CONDITIONS.
- ④ ALL TRAFFIC CONTROL DEVICES ON THIS PROJECT SHALL COMPLY WITH PART VI OF THE MUTCD (LATEST EDITION).
- ⑤ THIS CONTRACT IS TO INCLUDE FINE GRADING OF EXISTING AGGREGATE BASE
- ⑥ REMOVAL OF RAISED PAVEMENT MARKERS THAT ARE IN CONFLICT WITH REQUIRED CONSTRUCTION IS NOT CONSIDERED A SEPARATE PAY ITEM. COST TO BE ABSORBED INTO OTHER ITEMS BID.
- ⑦ BIDDERS ARE ADVISED THAT HARD COPIES OF ANY ADDENDA FOR THIS PROJECT WILL NO LONGER BE MAILED. ALL ADDENDA FOR THIS PROJECT WILL BE POSTED TO www.mdot.ms.gov UNDER THE PROPOSAL ADDENDA COLUMN. IT IS THE BIDDERS RESPONSIBILITY TO CHECK AND SEE IF ANY ADDENDA HAVE BEEN POSTED FOR THIS PROJECT. PLEASE CONTACT CONTRACT ADMINISTRATION DIVISION AT 601-359-7700 FOR ANY QUESTION REGARDING ELECTRONIC ADDENDA.

- ① REPAIR OF FAILED AREAS AS DIRECTED
- ② COLD MILLING
- ③ PLACEMENT OF SURFACE COURSE
- ④ PLACEMENT OF TEMPORARY STRIPE.
- ⑤ PLACEMENT OF PERMANENT STRIPE.

[illegible]