

STATE	PROJECT NUMBER	SHEET NO.
MISSISSIPPI	SP-0938-00(011)	1

GENERAL INDEX

INCLUDED THIS PROJECT	BEGIN WITH SHEET
<input checked="" type="checkbox"/> ROADWAY	1
<input type="checkbox"/> PERMANENT SIGNS	1001
<input type="checkbox"/> TRAFFIC SIGNALS	2001
<input type="checkbox"/> ITS COMPONENTS	3001
<input type="checkbox"/> LIGHTING	4001
<input type="checkbox"/> (RESERVED)	5001
<input checked="" type="checkbox"/> ROADWAY STANDARD DWGS	6001
<input type="checkbox"/> BOX CULVERT STD. DRAWINGS (LRFD)	7001
<input type="checkbox"/> BOX CULVERT STD. DRAWINGS (STD. SPEC.)	7501
<input type="checkbox"/> BRIDGE	8001
<input type="checkbox"/> CROSS SECTIONS	9001

BRIDGE STRUCTURES REQ'D.
NONE

BOX BRIDGES REQ'D.
NONE

STATE OF MISSISSIPPI

MISSISSIPPI DEPARTMENT OF TRANSPORTATION

PLAN AND PROFILE OF PROPOSED STATE HIGHWAY STATE PROJECT NO. SP-0938-00(011)

SR 370 FM SR 4 TO 0.1 MILES EAST OF DUMAS FIRE DEPARTMENT TIPPDAH COUNTY

FMS CON. NO. 108910 / 301000

SCALES

PLAN	1 IN. = 100 FT.
PROFILE	HOR. 1 IN. = 100 FT.
	VERT. 1 IN. = 10 FT.
LAYOUT	1 IN. = FT.

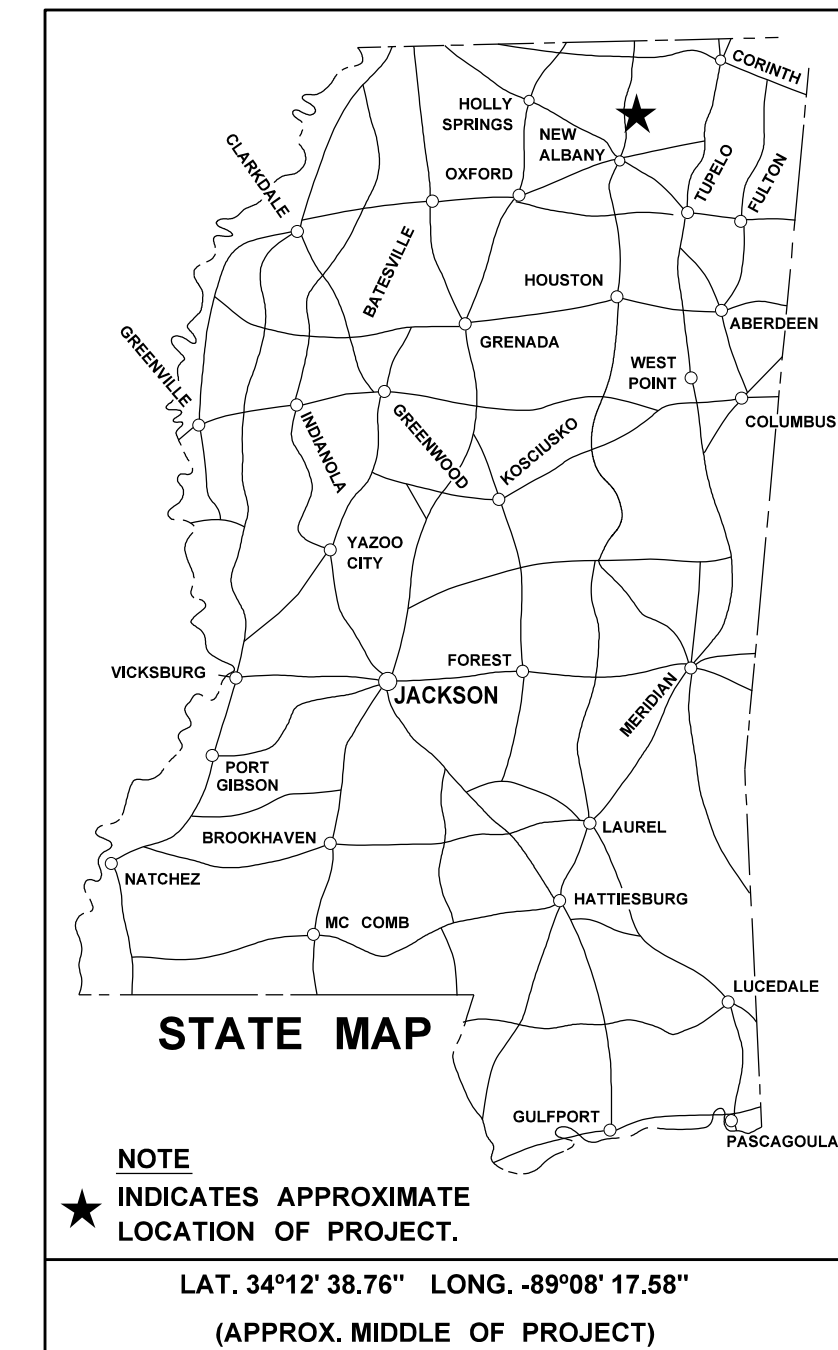

DESIGN CONTROL

MPH = V (SPEED DESIGN)
ADT () = : ADT () =
DHW = : D = % T = %

PERMITS ACQUIRED BY MDOT

WETLANDS AND WATERS PERMITS		
	WATERS	WETLANDS
NATIONWIDE #14	N	N
NATIONWIDE (OTHER)*	N	N
GENERAL*	N	N
INDIVIDUAL (404)*	N	N
STORMWATER PERMIT <input checked="" type="checkbox"/>		
Y	REQUIRED, CNQI SUBMITTED BY MDOT (DISTURBED AREA = 5 ACRES)	
S	REQUIRED, SCNO TO BE SUBMITTED BY CONTRACTOR (1 TO 4.99 ACRES)	
N	NO STORMWATER PERMIT REQUIRED (<1 ACRE)	
APPROVED BY: _____		

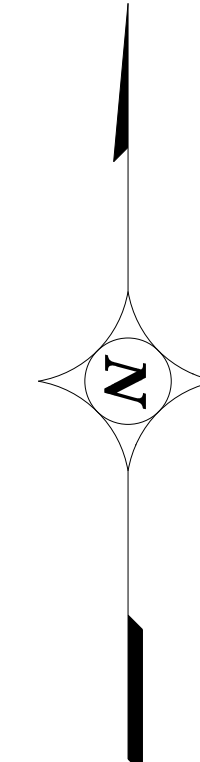
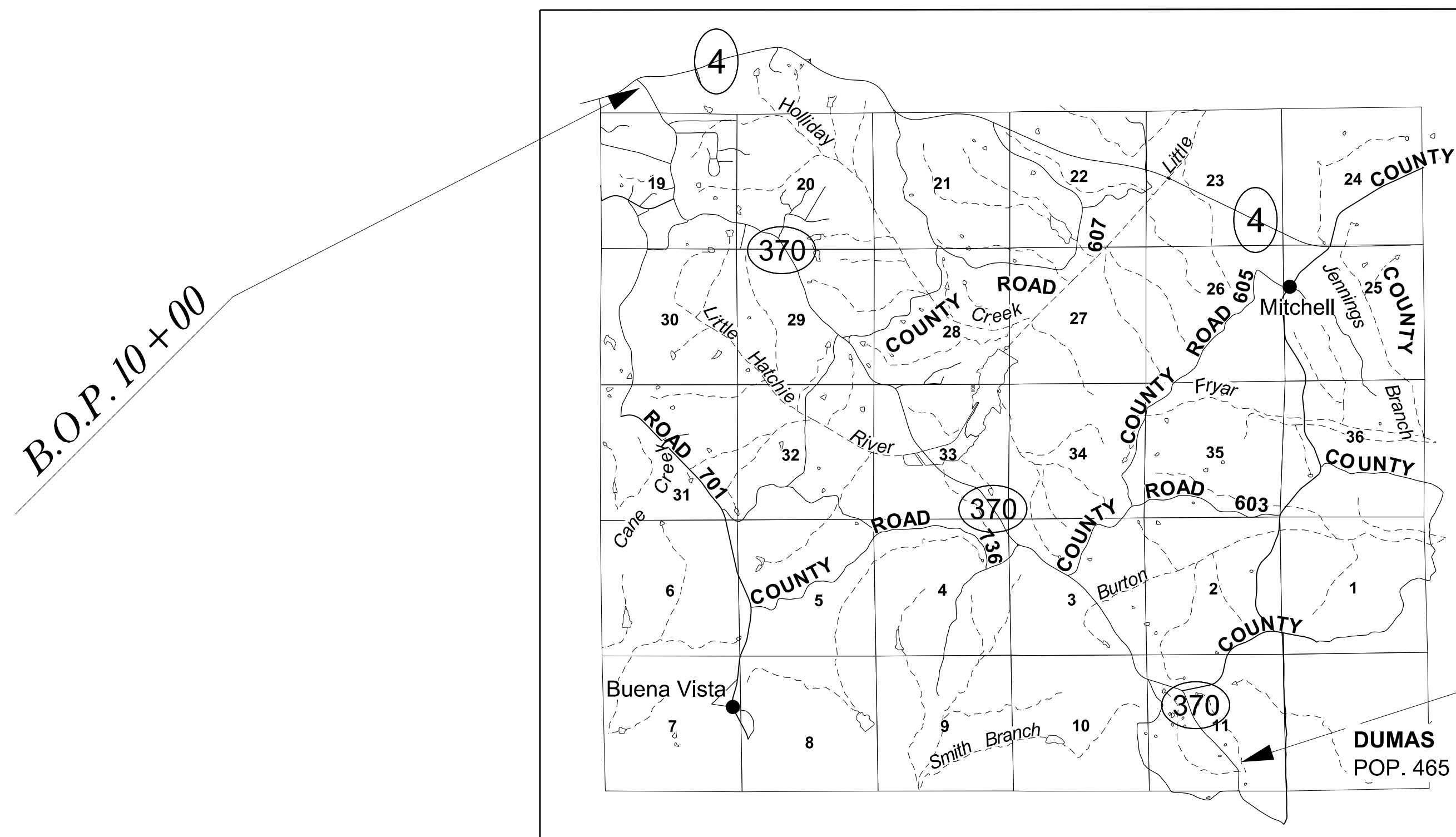

LENGTH DATA

LENGTH OF ROADWAY	47,445	FT.	8.986	MI.
LENGTH OF BRIDGES	0	FT.	0	MI.
LENGTH OF PROJECT (NET)	47,445		8.986	MI.
LENGTH OF EXCEPTIONS	0	FT.	0	MI.
LENGTH OF PROJECT (GROSS)	47,445		8.986	MI.

EQUATIONS NONE

EXCEPTIONS NONE

CONVENTIONAL SYMBOLS

COUNTY LINE	-----
TOWN CORPORATION LINE	-----
SECTION LINE	-----
EXISTING ROAD OR TRAVELED WAY	-----
PROPOSED ROAD OR TRAVELED WAY	-----
RAILROAD	-----
SURVEY LINE	-----
BRIDGES	-----

P S & E DATE: 11/04/21

APPROVED: _____
DEPUTY EXECUTIVE DIRECTOR / CHIEF ENGINEER
EXECUTIVE DIRECTOR



2/25/2022 10:50 AM TITLE SHEET

DESCRIPTION OF SHEET

	<u>WKG. NO.</u>	<u>SH. NO.</u>
TITLE SHEET (1)		1
DETAILED INDEX & GENERAL NOTES (1)		
DETAILED INDEX & GENERAL NOTES	DI-1	2
TYPICAL SECTION SHEETS (1)		
TYPICAL MILLING & OVERLAY SECTION	TS-1	3
QUANTITY SHEETS (1)		
SUMMARY OF QUANTITIES	SQ-1	4
SPECIAL DESIGN SHEETS (8)		
DETAIL OF CONSTRUCTION SIGNING	DCS-1	5
SR 370 SIGN REPLACEMENT	SR-1	6
SR 370 SIGN REPLACEMENT	SR-2	7
SIGNING DETAILS FOR TWO-LANE TWO-WAY INTERSECTION	RSP-1	8
ROADSIDE SIGN PLACEMENT DETAILS	RSP-20	9
PIPE POST FOOTING DETAIL	RSP-23	10
SIGN SUPPORT HARDWARE, 2.5" SQUARE POST	TSS-1	11
SIGN SUPPORT HARDWARE, 2.0" SQUARE POST	TSS-2	12
STANDARD DRAWINGS - ROADWAY SHEETS (13)		
PAVEMENT MARKING DETAILS FOR 2 AND 4-LANE DIVIDED ROADWAYS	08-01-17 PM-1	6051
PAVEMENT MARKING LEGEND DETAILS	08-01-17 PM-6	6056
TWO-WAY CLEAR RAISED PAVEMENT MARKERS ON SIDE ROADS	08-01-17 PM-11	6061
STANDARD ROADSIDE SIGNS	08-01-17 SN-3	6303
STANDARD ROADSIDE SIGNS	08-01-17 SN-3A	6304
STANDARD ROADSIDE SIGNS	08-01-17 SN-3B	6305
TYPICAL INSTALLATION AND DETAILS OF DELINEATORS	08-01-17 SN-8	6314
TRAFFIC CONTROL PLAN WITH FLAGGER (ONE-LANE CLOSURE OF TWO-WAY TRAFFIC)	08-01-17 TCP-1	6351
SHORT DURATION CLOSING OF TWO-LANE TWO-WAY HIGHWAYS	08-01-17 TCP-6	6356
HIGHWAY SIGN AND BARRICADE DETAILS FOR CONSTRUCTION PROJECTS	08-01-17 TCP-8	6358
TRAFFIC CONTROL PLAN MOBILE OPERATIONS MULTILANE ROADS AND TWO-LANE ROADS	08-01-17 TCP-9	6359
TRAFFIC CONTROL PLANS UNEVEN PAVEMENT DETAILS	08-01-17 TCP-12	6362
TEMPORARY STRIPING FOR TRAFFIC CONTROL 2-LANE AND 4-LANE DIVIDED HIGHWAYS	08-01-17 TCP-13	6363
 TOTAL NUMBER OF SHEETS (25)		

GENERAL NOTES

- (1) THE LOCATION AND SPACING OF SIGNS, SHOWN ON THE TRAFFIC CONTROL PLANS, ARE APPROXIMATE AND MAY BE ADJUSTED AS NECESSARY TO FIT FIELD CONDITIONS.
- (2) MAXIMUM LANE CLOSURE ALLOWED IS 1 MILE. A MINIMUM DISTANCE OF 3 MILES IS REQUIRED FOR CLOSURES IN ADJACENT LANES. A MINIMUM OF 2 MILES IS REQUIRED FOR CLOSURES IN THE SAME LANE.
- (3) FLUORESCENT ORANGE SHEETING SHALL BE USED ON ALL CONSTRUCTION AND TRAFFIC CONTROL SIGNS EXCEPT FOR THOSE DESIGNATED ON THE PLANS TO BE BLACK LEGEND AND BORDER ON WHITE BACKGROUND.
- (4) ALL TRAFFIC CONTROL DEVICES ON THIS PROJECT SHALL COMPLY WITH PART VI OF THE MUTCD (LATEST EDITION).
- (5) BIDDERS ARE ADVISED THAT HARD COPIES OF ANY ADDENDA FOR THIS PROJECT WILL NO LONGER BE MAILED. ALL ADDENDA FOR THIS PROJECT WILL BE POSTED TO WWW.MDOT.MS.GOV UNDER THE PROPOSAL ADDENDA COLUMN. IT IS THE BIDDERS RESPONSIBILITY TO CHECK AND SEE IF ANY ADDENDA HAVE BEEN POSTED FOR THIS PROJECT. PLEASE CONTACT CONTRACT ADMINISTRATION DIVISION AT 601-359-7700 FOR ANY QUESTIONS REGARDING ELECTRONIC ADDENDA.
- (6) WHERE TREE ROOTS ARE ENCOUNTERED IN DIGOUTS, SOIL STERILIZATION PELLETS WILL BE REQUIRED PRIOR TO BACKFILLING THE AREA (NOT A PAY ITEM).
- (7) PRIOR TO PLACING ANY BITUMINOUS PAVEMENT AND FINE MILLING, THE EXISTING SHOULDERS ARE TO BE BLADED FOR A MINIMUM OF 1' BEYOND THE EDGE OF THE EXISTING PAVEMENT TO REMOVE VEGETATION AND EXCESS SHOULDER MATERIAL (NOT A PAY ITEM).



PS & E PLANS-DATE...11/04/21		
FMS CON. # 108910/301000		
REVISIONS		
DATE	SHEET NO.	BY

MISSISSIPPI DEPARTMENT OF TRANSPORTATION	
DETAILED INDEX	
PROJECT NO.: SP-0938-00(011)	
COUNTY : TIPPAH	
WORKING NUMBER	DI-1
SHEET NUMBER	2
DATE	FILENAME: INDEX.DGN
DESIGN TEAM	CHECKED _____ DATE _____



DITCH LOCATIONS FOR PLACEMENT OF 100# RIPRAP	
187+00-190+00 Rt - 8' Width	399+00-403+00 Lt - 6' Width
308+00-314+00 Lt - 8' Width	398+00-403+00 Rt - 8' Width
387+00-393+00 Rt - 6' Width	426+00-429+00 Rt - 6' Width
396+00 Lt & Rt 100' x 8'	442+00-444+00 Rt - 6' Width

FAILED AREAS	
89+25 RT - 6'X15' ROOTS	224+00-226+50 RT - 8'
125+90 LT - 6'X15' ROOTS	258+50 RT - 10'X15' ROOTS
127+50 LT - 75'X8'	260+00 RT - 10'X75'
218+00-222+00 RT - 8'	

*ALL LOCATIONS AND SIZES ARE APPROXIMATE AND MAY BE ADJUSTED TO FIT FIELD CONDITIONS. ADDITIONAL AREAS MAY ARISE PRIOR TO CONSTRUCTION WHICH WILL BE PAID FOR USING THE INCLUDED PAY ITEMS. ANY AND ALL SITE GRADING REQUIRED FOR PLACEMENT OF RIPRAP SHALL BE ABSORBED INTO THE COST OF THE RIPRAP.

*ALL LOCATIONS AND SIZES ARE APPROXIMATE AND MAY BE ADJUSTED TO FIT FIELD CONDITIONS. ADDITIONAL LOCATIONS MAY BE REQUIRED AS FIELD CONDITIONS MAY CHANGE.

- ① REMOVE AND UNDERCUT FAILED AREAS AS DIRECTED BY THE ENGINEER. REMOVE ASPHALT PAVEMENT TO BE PAID FOR UNDER PAY ITEM 202-B007 AND SAW CUT FULL DEPTH, PAY ITEM 503-C010. UNDERCUT TO A DEPTH OF 3 FT BELOW FINISHED GRADE. BACKFILL WITH CRUSHED STONE TO A DEPTH OF 1 FT BELOW FINISHED GRADE WITH REMOVAL OF UNDERCUT MATERIAL TO BE PAID FOR UNDER PAY ITEM NO. 203-G001, EXCESS EXCAVATION (FM) (AH). BACKFILL WITH 9.5 MM, ST, ASPHALT PAVEMENT PAY ITEM NO. 403-A015 TO A MAXIMUM DEPTH OF 1 FT.
- ② GEOGRID, TYPE II, BIAXIAL PAY ITEM NO. 204-A003 AND GEOTEXTILE STABILIZATION, TYPE VII, NON-WOVEN PAY ITEM NO. 209-A009.
- ③ 1½" & VAR. FINE MILLING OF BITUMINOUS PAVEMENT, PAY ITEM NO. 406-D001.
- ④ PRELIMINARY PATCHING AND LEVELING REQUIRED AS DIRECTED BY ENGINEER.
- ⑤ 1½" & VAR. 9.5 MM, ST ASPHALT PAVEMENT, PAY ITEM NO. 403-A015.
- ⑥ GRANULAR MATERIAL (CL. 3 GP. C) REQUIRED ON SHOULDER AS DIRECTED BY THE ENGINEER, PAY ITEM NO. 304-A002.

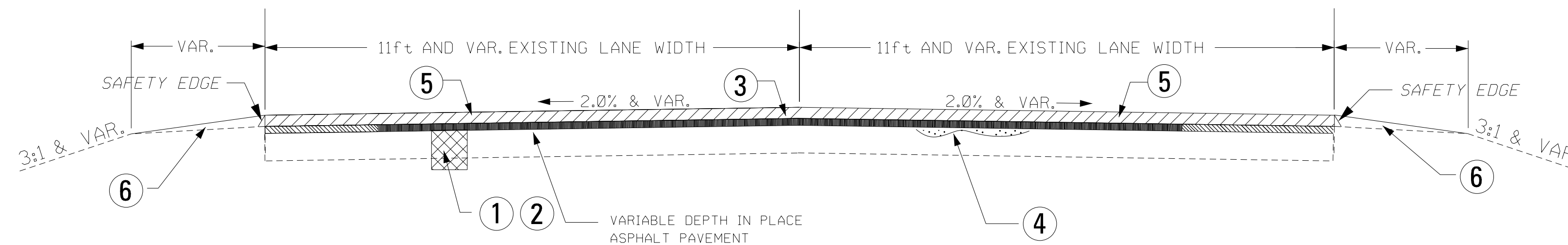

TYPICAL SECTION 2-LANE

STA. 10+00 TO STA. 484+45

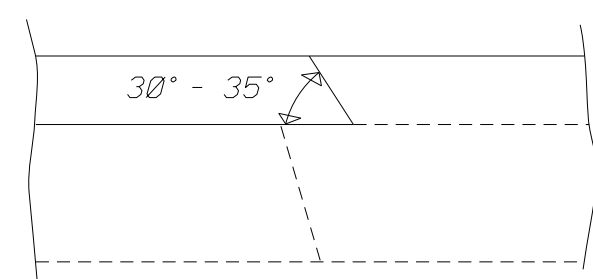

SAFETY EDGE REQUIRED (NOT A PAY ITEM)
SAFETY EDGE DETAIL

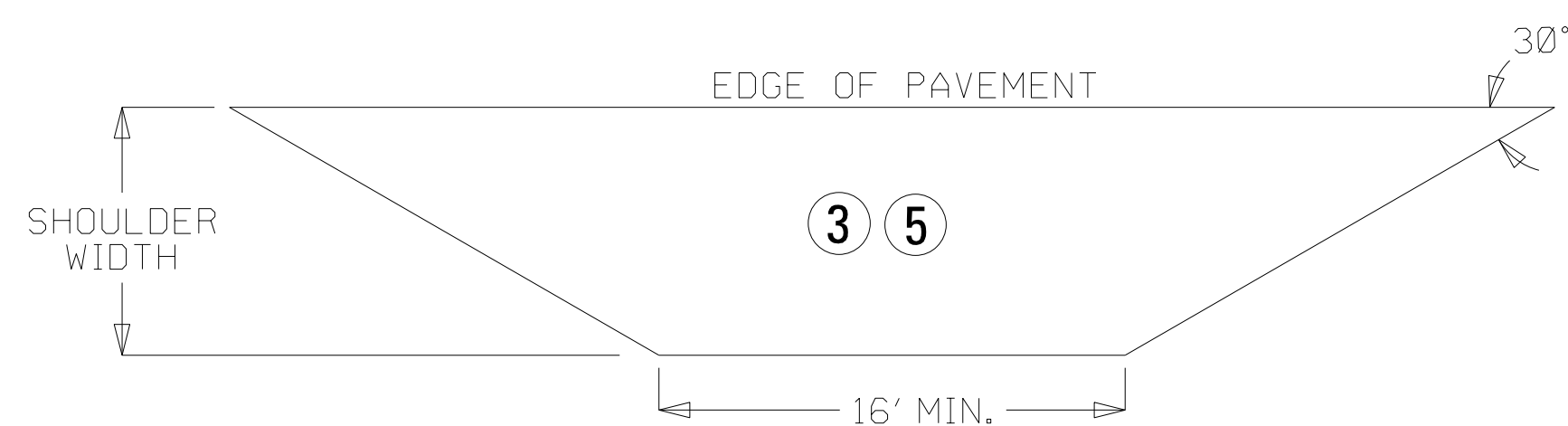

DETAIL OF RAMP APRON

IN AREAS WITH CONCRETE ISLANDS, PAVE TO THE BACK OF THE ISLAND.



DETAIL FOR LOCAL ROAD TURNOUTS

BY		MISSISSIPPI DEPARTMENT OF TRANSPORTATION	
REVISION		TYPICAL SECTION MILLING & OVERLAY	
DATE		PROJECT NO.: SP-0938-00(011) COUNTY: TIPPAAH	
DESIGN TEAM		SCALE: NTS	
CHECKED		WORKING NUMBER TS-1	
DATE		SHEET NUMBER 3	

