

STATE	PROJECT NUMBER	SHEET NO.
MISSISSIPPI	BRNH-0008-01(154)	1

STATE OF MISSISSIPPI

MISSISSIPPI DEPARTMENT OF TRANSPORTATION

# PLAN AND PROFILE OF PROPOSED STATE HIGHWAY FEDERAL AID PROJECT NO. BRNH-0008-01(154)

US-49 FROM O'NEAL ROAD TO LITTLE BILOXI RIVER HARRISON COUNTY

FMS CON. NO. 102111 / 301000

**SCALES**  
 PLAN 1 IN. = 100 FT.  
 PROFILE { HOR. 1 IN. = 100 FT.  
 VERT. 1 IN. = 10 FT.  
 LAYOUT 1 IN. = 3000 FT.

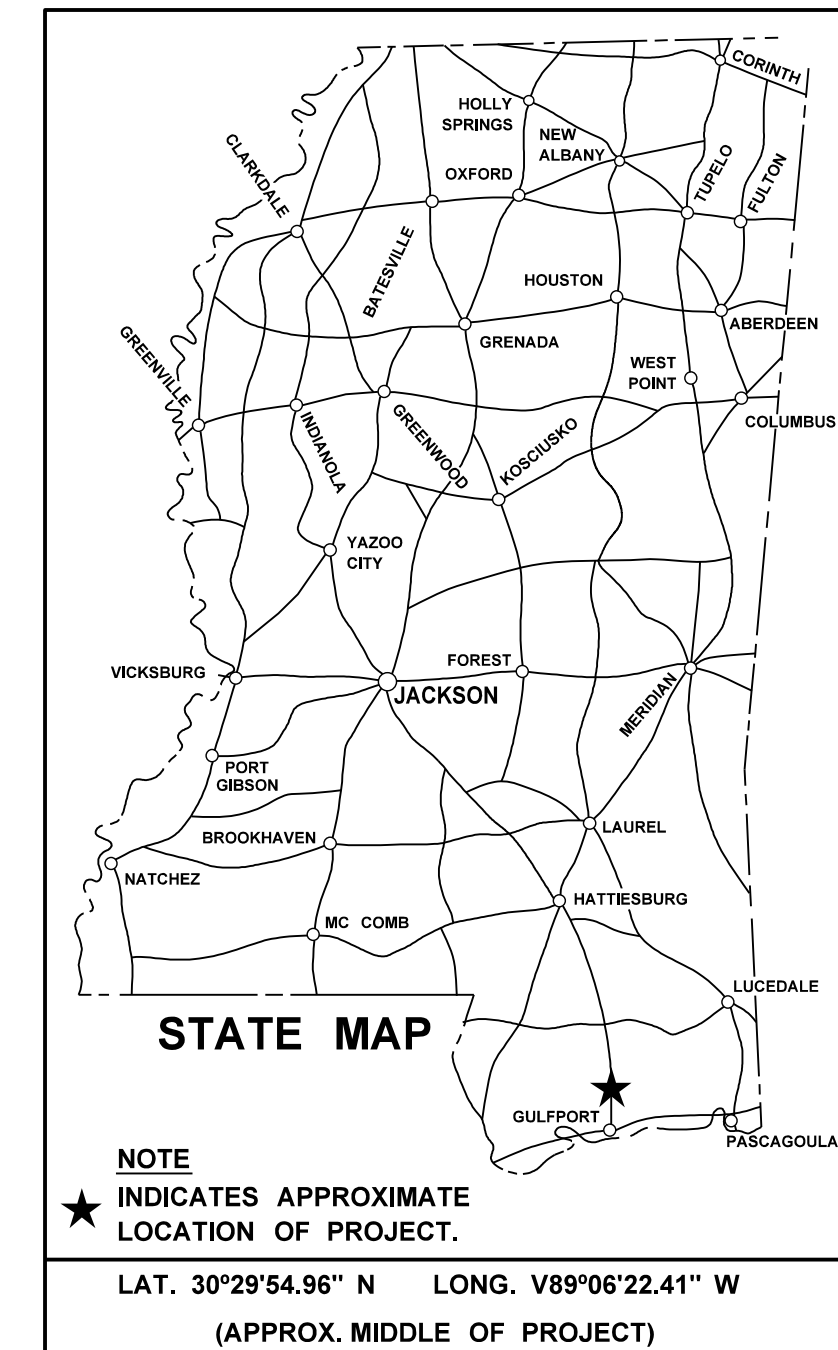

**GENERAL INDEX**

INCLUDED THIS PROJECT	BEGIN WITH SHEET
<input checked="" type="checkbox"/> ROADWAY	1
<input checked="" type="checkbox"/> PERMANENT SIGNS	1001
<input checked="" type="checkbox"/> TRAFFIC SIGNALS	2001
<input checked="" type="checkbox"/> ITS COMPONENTS	3001
<input type="checkbox"/> LIGHTING	4001
<input type="checkbox"/> (RESERVED)	5001
<input checked="" type="checkbox"/> ROADWAY STANDARD DWGS	6001
<input type="checkbox"/> BOX CULVERT STD. DRAWINGS (LRFD)	7001
<input checked="" type="checkbox"/> BOX CULVERT STD. DRAWINGS (STD. SPEC.)	7501
<input checked="" type="checkbox"/> BRIDGE	8001
<input checked="" type="checkbox"/> CROSS SECTIONS	9001

**BRIDGE STRUCTURES REQ'D.**

NONE

**BOX BRIDGES REQ'D.**

NONE

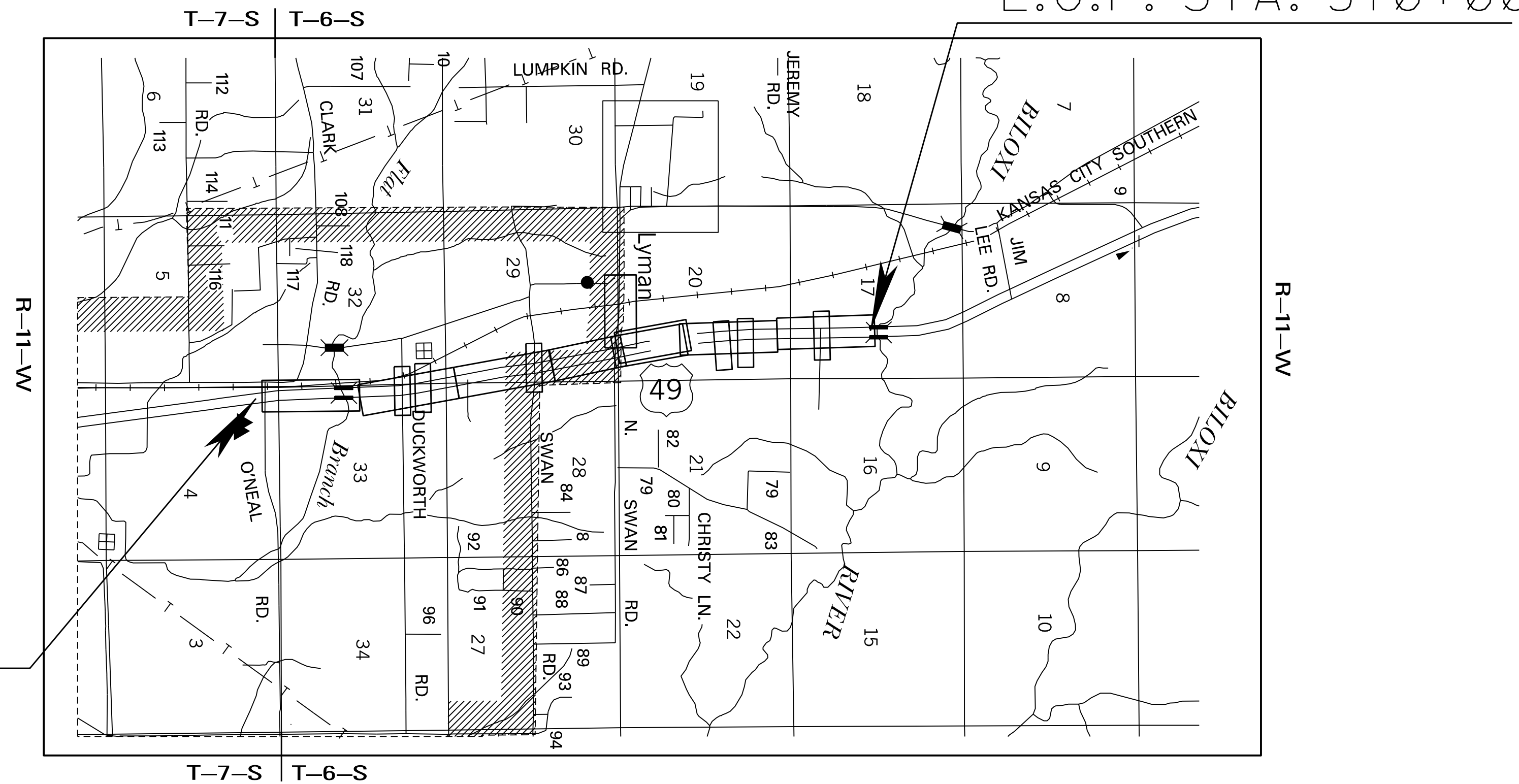

**EQUATIONS**

STA. 275 + 58.910 BACK = STA. 275 + 58.250 AHEAD = -0.660 FT.  
 STA. 292 + 41.901 BACK = STA. 292 + 41.400 AHEAD = -0.501 FT.  
 -1.161 FT.

**LENGTH DATA**

LENGTH OF ROADWAY	18938.84 FT.	3.587 MI.
LENGTH OF BRIDGES	0 FT.	0.000 MI.
LENGTH OF PROJECT (NET)	0 FT.	3.587 MI.
LENGTH OF EXCEPTIONS	0 FT.	0 MI.
LENGTH OF PROJECT (GROSS)	0 FT.	3.587 MI.

**EXCEPTIONS**

NONE

**CONVENTIONAL SYMBOLS**

COUNTY LINE	-----
TOWN CORPORATION LINE	-----
SECTION LINE	-----
EXISTING ROAD OR TRAVELED WAY	-----
PROPOSED ROAD OR TRAVELED WAY	-----
RAILROAD	-----
SURVEY LINE	-----
BRIDGES	-----

**Brown, Mitchell & Alexander** **Stantec** **Stantec** **Stantec**

**ROADWAY** **ROADWAY** **ROADWAY HYDRAULICS** **TRAFFIC**

**DESIGN CONTROL**  
 65 MPH = V (SPEED DESIGN)  
 ADT (2017) = 26000 ; ADT (2031) = 39000  
 DHV = 3900 ; D = 55 % T = 8 %

**PERMITS ACQUIRED BY MDOT**

WETLANDS AND WATERS PERMITS		
	WATERS	WETLANDS
NATIONWIDE #14	<input type="checkbox"/>	<input type="checkbox"/>
NATIONWIDE (OTHER)*	<input checked="" type="checkbox"/>	<input type="checkbox"/>
GENERAL*	<input type="checkbox"/>	<input type="checkbox"/>
INDIVIDUAL (404)*	<input type="checkbox"/>	<input type="checkbox"/>
<b>STORMWATER PERMIT</b> <input checked="" type="checkbox"/>		
Y	REQUIRED, (NOI SUBMITTED BY MDOT (DISTURBED AREA = 5 ACRES))	
S	REQUIRED, (NOI TO BE SUBMITTED BY CONTRACTOR (1 TO 4.99 ACRES))	
N	NO STORMWATER PERMIT REQUIRED (<1 ACRE)	
APPROVED BY: _____		

P S & E DATE: 07/19/2023

APPROVED:	_____
DEPUTY EXECUTIVE DIRECTOR / CHIEF ENGINEER	_____
EXECUTIVE DIRECTOR	_____



B.1.22023 10:01 AM LAYOUT.DGN TITLE DIVISION MISSISSIPPI DEPARTMENT OF TRANSPORTATION

STATE	PROJECT NO.
MISS.	BRNH-0008-01(154)

DESCRIPTION OF SHEET

WKG. NO. SH. NO.

DESCRIPTION OF SHEET

WKG. NO. SH. NO.

TITLE SHEET (1)			1
DETAILED INDEX & GENERAL NOTES (8)			
DETAILED INDEX	DI-1		2
DETAILED INDEX	DI-2		3
DETAILED INDEX	DI-3		4
DETAILED INDEX	DI-4		5
DETAILED INDEX	DI-5		6
DETAILED INDEX	DI-6		7
GENERAL NOTES	GN-1		8
GENERAL NOTES	GN-2		9
TYPICAL SECTION SHEETS (14)			
TYPICAL SECTION - MAINLINE SOUTHBOUND LANES	TS-1		10
TYPICAL SECTION - MAINLINE NORTHBOUND LANES	TS-2		11
INTERSECTION LAYOUT - OVERALL GEOMETRY	INT-1		12
TYPICAL SECTIONS - U.S. 49 - STA 233+00 TO STA 251+00	TS-3		13
TYPICAL SECTIONS - U.S. 49 - STA 251+00 TO STA 258+70	TS-4		14
TYPICAL SECTIONS - U.S. 49 - STA 258+70 - STA 278+00	TS-5		15
LOCAL ROAD	TS-6		16
LOCAL ROAD	TS-7		17
LOCAL ROAD	TS-8		18
LOCAL ROAD	TS-9		19
TYPICAL SECTIONS - SR 53 - STA 422+50 TO STA 427+19 AND STA 433+00 TO 437+10	TS-10		20
TYPICAL SECTIONS - SR 53 - STA 427+19 TO STA 433+00 AND STA 437+10 TO 444+25	TS-11		21
TYPICAL SECTIONS - NORTH SWAN ROAD - STA 10+00 TO STA 19+51	TS-12		22
TYPICAL SECTIONS - NORTH SWAN ROAD - STA 19+51 - STA 23+00/FRONTAGE ROADS	TS-13		23
QUANTITY SHEETS (30)			
SUMMARY OF QUANTITIES	SQ-1		24
SUMMARY OF QUANTITIES	SQ-2		25
SUMMARY OF QUANTITIES	SQ-3		26
SUMMARY OF QUANTITIES	SQ-4		27
SUMMARY OF QUANTITIES	SQ-5		28
SUMMARY OF QUANTITIES	SQ-6		29
ESTIMATED QUANTITIES FOR TRAFFIC CONTROL SIGNS	TCQ-1		30
ESTIMATED QUANTITIES - TRAFFIC CONTROL ITEMS	EQ-1		31
ESTIMATED QUANTITIES - TRAFFIC CONTROL ITEMS	EQ-2		32
ESTIMATED QUANTITIES - EARTHWORK AND EROSION CONTROL	EQ-3		33
ESTIMATED QUANTITIES - PUNCHOUT	EQ-4		34
ESTIMATED QUANTITIES - REMOVAL ITEMS	EQ-5		35
ESTIMATED QUANTITIES - REMOVAL ITEMS	EQ-6		36
ESTIMATED QUANTITIES - REMOVAL ITEMS	EQ-7		37
ESTIMATED QUANTITIES - REMOVAL ITEMS	EQ-8		38
ESTIMATED QUANTITIES - REMOVAL ITEMS	EQ-9		39
ESTIMATED QUANTITIES - REMOVAL ITEMS	EQ-10		40
ESTIMATED QUANTITIES - JUNCTION BOXES, BOX CULVERTS AND PAVED FLUMES	EQ-11		41
ESTIMATED QUANTITIES - DRAINAGE STRUCTURES	EQ-12		42
ESTIMATED QUANTITIES - DRAINAGE STRUCTURES	EQ-13		43
ESTIMATED QUANTITIES - SIDE DRAINS	EQ-14		44
ESTIMATED QUANTITIES - DRIVEWAYS	EQ-15		45
ESTIMATED QUANTITIES - CURB AND GUTTER	EQ-16		46
ESTIMATED QUANTITIES - GUARD RAIL	EQ-17		47
ESTIMATED QUANTITIES - PAVEMENT MARKINGS	EQ-18		48
ESTIMATED QUANTITIES - TRAFFIC SIGNS	EQ-19		49
ESTIMATED QUANTITIES - TRAFFIC SIGNS	EQ-20		50
ESTIMATED QUANTITIES - TRAFFIC SIGNS	EQ-21		51
ESTIMATED QUANTITIES - TRAFFIC SIGNALS & ITS	EQ-22		52
ESTIMATED QUANTITIES - OVERHEAD STANDARD TRAFFIC SIGNS	EQ-23		53

PLAN & PROFILE SHEETS (36)			
B.O.P. TO STA. 175+00 MAINLINE LEFT		3-LT	54
B.O.P. TO STA. 175+00 MAINLINE RIGHT		3-RT	55
DETOUR - STA. 10+00 TO STA. 25+00		3A	56
DETOUR - STA. 10+00 TO STA. 23+32.23		3B	57
STA. 180+60 TO STA. 205+00 MAINLINE LEFT		4-LT	58
STA. 180+60 TO STA. 205+00 MAINLINE RIGHT		4-RT	59
DUCKWORTH ROAD - STA. 7+50 TO STA. 13+50		4A	60
TOURIEL ROAD - STA. 10+00 TO STA. 13+00		4B	61
STA. 205+00 TO 233+00 MAINLINE LEFT		5-LT	62
STA. 205+00 TO 233+00 MAINLINE RIGHT		5-RT	63
SOUTH SWAN ROAD - STA. 7+00 TO STA. 13+50		5A	64
PLAN AND PROFILE - U.S. 49 SOUTHBOUND - STA 233+00 TO STA 241+50		6-LT	65
PLAN AND PROFILE - U.S. 49 NORTHBOUND - STA 233+00 TO STA 241+50		6-RT	66
PLAN AND PROFILE - SOUTH FRONTAGE ROAD		6A	67
PLAN AND PROFILE - U.S. 49 SOUTHBOUND - STA 241+50 TO STA 257+50		7-LT	68
PLAN AND PROFILE - U.S. 49 NORTHBOUND - STA 241+50 TO STA 257+50		7-RT	69
PLAN AND PROFILE - CFI SOUTH		7A	70
PLAN AND PROFILE - SOUTHWEST RAMP		7B	71
PLAN AND PROFILE - CFI NORTH		7C	72
PLAN AND PROFILE - NORTHEAST RAMP		7D	73
PLAN AND PROFILE - SR 53		7E	74
PLAN AND PROFILE - SR 53		7F	75
PLAN AND PROFILE - SOUTHWEST FRONTAGE (3RD AVE.)		7G	76
PLAN AND PROFILE - NORTH SWAN ROAD		7H	77
PLAN AND PROFILE - SOUTHEAST FRONTAGE ROAD		7I	78
PLAN AND PROFILE - U.S. 49 SOUTHBOUND - STA 257+50 TO STA 273+50		8 LT	79
PLAN AND PROFILE - U.S. 49 NORTHBOUND - STA 257+50 TO STA 273+50		8 RT	80
PLAN AND PROFILE - U.S. 49 SOUTHBOUND - STA 273+50 TO STA 289+50		9 LT	81
PLAN AND PROFILE - U.S. 49 NORTHBOUND - STA 273+50 TO STA 289+50		9 RT	82
STA. 278+00 TO 305+00 MAINLINE LEFT		10-LT	83
STA. 278+00 TO 305+00 MAINLINE RIGHT		10-RT	84
VICK ROAD - STA. 10+00 TO STA. 14+00		10A	85
JIM BANKS ROAD - STA. 10+00 TO STA. 12+80		10B	86
STA. 305+00 TO E.O.P. MAINLINE LEFT		11-LT	87
STA. 305+00 TO E.O.P. MAINLINE RIGHT		11-RT	88
SCHOOL ROAD - STA. 10+00 TO STA. 13+20		11A	89
DETAIL OF INTERSECTION SHEETS (18)			
DETAIL OF INTERSECTION - DUCKWORTH ROAD		DOI-1	90
DETAIL OF INTERSECTION - TOURIEL ROAD		DOI-2	91
DETAIL OF INTERSECTION - SOUTH SWAN ROAD		DOI-3	92
DETAIL OF INTERSECTION - LAYOUT		DOI-4	93
DETAIL OF INTERSECTION - U.S. 49 - STA 233+00 TO STA 239+00		DOI-5	94
DETAIL OF INTERSECTION - U.S. 49 - STA 239+00 TO STA 245+00		DOI-6	95
DETAIL OF INTERSECTION - U.S. 49 - STA 245+00 TO STA 251+00		DOI-7	96
DETAIL OF INTERSECTION - U.S. 49 - STA 251+00 TO STA 257+00		DOI-8	97
DETAIL OF INTERSECTION - U.S. 49 - STA 257+00 TO STA 263+00		DOI-9	98
DETAIL OF INTERSECTION - U.S. 49 - STA 263+00 TO STA 275+00		DOI-10	99
DETAIL OF INTERSECTION - SR 53 - STA 420+00 TO STA 432+00		DOI-11	100
DETAIL OF INTERSECTION - SR 53 - STA 432+00 TO STA 438+00		DOI-12	101
DETAIL OF INTERSECTION - SR 53 - STA 438+00 TO STA 443+00		DOI-13	102
DETAIL OF INTERSECTION - NORTH SWAN ROAD - STA 12+00 TO STA 18+00		DOI-14	103
DETAIL OF INTERSECTION - NORTH SWAN ROAD - STA 18+00 TO STA 23+00		DOI-15	104

PS & E PLANS-DATE 07/19/2023		
FMS CON. # 102111/301000		
REVISIONS		
DATE	SHEET NO.	BY

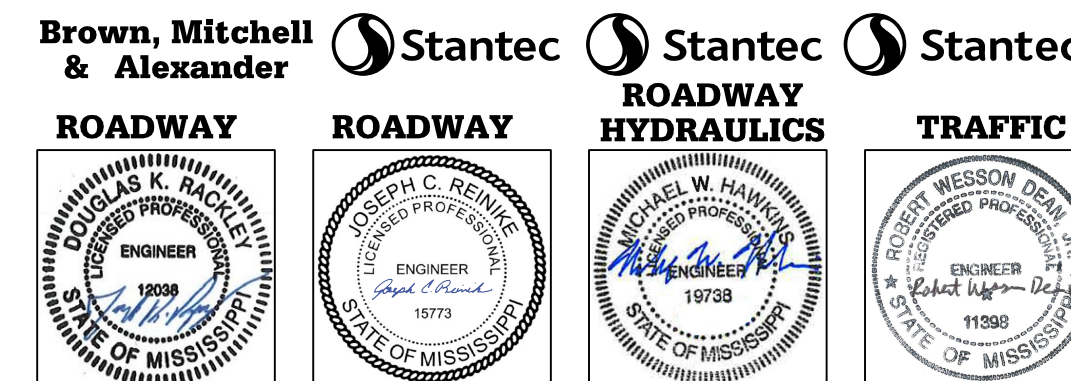

MISSISSIPPI DEPARTMENT OF TRANSPORTATION	
<b>DETAILED INDEX</b>	
PROJECT: BRNH-0008-01(154)	WORKING NUMBER
COUNTY: HARRISON	DI-1
FILENAME: DI-1.dgn	SHEET NUMBER
DESIGN TEAM BMA	2

B:\1\2023\102111\01.dgn DI-1.dgn

STATE	PROJECT NO.
MISS.	BRNH-0008-01(154)

DESCRIPTION OF SHEET

WKG. NO.    SH. NO.

DETAIL OF INTERSECTION SHEETS CONT.		
DETAIL OF INTERSECTION - VICK ROAD	DOI-16	105
DETAIL OF INTERSECTION - JIM BANKS ROAD	DOI-17	106
DETAIL OF INTERSECTION - SCHOOL ROAD	DOI-18	107
DRAINAGE DESIGN SHEETS (17)		
DRAINAGE DESIGN - U.S. 49 SOUTHBOUND - STA 233+00 TO STA 239+00	DD-3LT	108
DRAINAGE DESIGN - U.S. 49 NORTHBOUND - STA 233+00 TO STA 239+00	DD-3RT	109
DRAINAGE DESIGN - U.S. 49 SOUTHBOUND - STA 239+00 TO STA 245+00	DD-4LT	110
DRAINAGE DESIGN - U.S. 49 NORTHBOUND - STA 239+00 TO STA 245+00	DD-4RT	111
DRAINAGE DESIGN - U.S. 49 SOUTHBOUND - STA 245+00 TO STA 251+00	DD-5LT	112
DRAINAGE DESIGN - U.S. 49 NORTHBOUND - STA 245+00 TO STA 251+00	DD-5RT	113
DRAINAGE DESIGN - CFI SOUTH	DD-5A	114
DRAINAGE DESIGN - CFI SOUTH	DD-5B	115
DRAINAGE DESIGN - SOUTHWEST RAMP	DD-5C	116
DRAINAGE DESIGN - U.S. 49 SOUTHBOUND - STA 251+00 TO STA 257+00	DD-6LT	117
DRAINAGE DESIGN - U.S. 49 NORTHBOUND - STA 251+00 TO STA 257+00	DD-6RT	118
DRAINAGE DESIGN - CFI NORTH	DD-6A	119
DRAINAGE DESIGN - CFI NORTH	DD-6B	120
DRAINAGE DESIGN - U.S. 49 SOUTHBOUND - STA 257+00 TO STA 263+00	DD-7LT	121
DRAINAGE DESIGN - U.S. 49 NORTHBOUND - STA 257+00 TO STA 263+00	DD-7RT	122
DRAINAGE DESIGN - U.S. 49 SOUTHBOUND - STA 263+00 TO STA 269+00	DD-8LT	123
DRAINAGE DESIGN - U.S. 49 NORTHBOUND - STA 263+00 TO STA 269+00	DD-8RT	124
EROSION CONTROL PLAN SHEETS (29)		
EROSION CONTROL PLAN - STA. 175+00 TO STA. 205+00 MAINLINE LEFT	ECP-4	125
EROSION CONTROL PLAN - DUCKWORTH ROAD - STA. 7+50 TO STA. 13+50	ECP-4A	126
EROSION CONTROL PLAN - TOURIEL ROAD - STA. 10+00 TO STA. 13+00	ECP-4B	127
EROSION CONTROL PLAN - STA. 205+00 TO 233+00 MAINLINE LEFT	ECP-5	128
EROSION CONTROL PLAN - SOUTH SWAN ROAD - STA. 7+00 TO STA. 13+50	ECP-5A	129
EROSION CONTROL PLAN - U.S. 49 SOUTHBOUND - STA 233+00 TO STA 241+50	ECP-6 LT	130
EROSION CONTROL PLAN - U.S. 49 NORTHBOUND - STA 233+00 TO STA 241+50	ECP-6 RT	131
EROSION CONTROL PLAN - SOUTH FRONTAGE ROAD	ECP-6A	132
EROSION CONTROL PLAN - U.S. 49 SOUTHBOUND - STA 241+50 TO STA 257+50	ECP-7 LT	133
EROSION CONTROL PLAN - U.S. 49 NORTHBOUND - STA 241+50 TO STA 257+50	ECP-7 RT	134
EROSION CONTROL PLAN - CFI SOUTH	ECP-7A	135
EROSION CONTROL PLAN - SOUTHWEST RAMP	ECP-7B	136
EROSION CONTROL PLAN - CFI NORTH	ECP-7C	137
EROSION CONTROL PLAN - NORTHEAST RAMP	ECP-7D	138
EROSION CONTROL PLAN - SR 53 - STA. 422+00 TO STA. 435+00	ECP-7E	139
EROSION CONTROL PLAN - SR 53 - STA. 435+00 TO STA. 444+00	ECP-7F	140
EROSION CONTROL PLAN - SOUTHWEST FRONTAGE (3RD AVE.)	ECP-7G	141
EROSION CONTROL PLAN - NORTH SWAN ROAD	ECP-7H	142
EROSION CONTROL PLAN - SOUTHEAST FRONTAGE ROAD	ECP-7I	143
EROSION CONTROL PLAN - U.S. 49 SOUTHBOUND - STA 257+50 TO STA 273+50	ECP-8 LT	144
EROSION CONTROL PLAN - U.S. 49 NORTHBOUND - STA 257+50 TO STA 273+50	ECP-8 RT	145
EROSION CONTROL PLAN - U.S. 49 SOUTHBOUND - STA 273+50 TO STA 278+00	ECP-9 LT	146
EROSION CONTROL PLAN - U.S. 49 NORTHBOUND - STA 273+50 TO STA 278+00	ECP-9 RT	147
EROSION CONTROL PLAN - STA. 278+00 TO 305+00 MAINLINE LEFT	ECP-10	148
EROSION CONTROL PLAN - VICK ROAD - STA. 10+00 TO STA. 14+00	ECP-10A	149
EROSION CONTROL PLAN - MS POWER ROAD - STA. 10+00 TO STA. 12+80	ECP-10B	150
EROSION CONTROL PLAN - STA. 305+00 TO E.O.P. MAINLINE LEFT	ECP-11	151
EROSION CONTROL PLAN - SCHOOL ROAD - STA. 10+00 TO STA. 13+20	ECP-11A	152
VEGETATION SCHEDULE	VS-1	153
FORM GRADE SHEETS (16)		
FORM GRADES - WEST DUCKWORTH ROAD	FG-1	154
FORM GRADES - EAST DUCKWORTH ROAD	FG-2	155
FORM GRADES - TOURIEL ROAD	FG-3	156
FORM GRADES - SOUTH SWAN ROAD (WEST)	FG-4	157
FORM GRADES - SOUTH SWAN ROAD (EAST)	FG-5	158

DESCRIPTION OF SHEET

WKG. NO.    SH. NO.

FORM GRADE SHEETS CONT.		
FORM GRADES - LAYOUT	FG-6	159
FORM GRADES - U.S. 49 - STA 233+00 TO STA 239+00	FG-7	160
FORM GRADES - U.S. 49 - STA 239+00 TO STA 245+00	FG-8	161
FORM GRADES - U.S. 49 - STA 245+00 TO STA 251+00	FG-9	162
FORM GRADES - U.S. 49 - STA 251+00 TO STA 257+00	FG-10	163
FORM GRADES - U.S. 49 - STA 257+00 TO STA 263+00	FG-11	164
FORM GRADES - U.S. 49 - STA 263+00 TO STA 267+00	FG-12	165
FORM GRADES - SR 53 - STA 438+00 TO STA 440+00	FG-13	166
FORM GRADES - NORTH SWAN ROAD - STA 12+00 TO STA 18+00	FG-14	167
FORM GRADES - JIM BANKS ROAD	FG-15	168
FORM GRADES - SCHOOL ROAD	FG-16	169
REMOVAL PLAN - CFI SHEETS (5)		
REMOVAL PLAN - CFI - U.S. 49 - STA 233+00 TO STA 248+00	RP-1	170
REMOVAL PLAN - CFI - U.S. 49 - STA 248+00 TO STA 263+00/SR 53 - STA 438+00 TO STA 444+00/ NORTH SWAN ROAD - STA 10+00 TO STA 13+00	RP-2	171
REMOVAL PLAN - CFI - U.S. 49 - STA 263+00 TO STA 277+00	RP-3	172
REMOVAL PLAN - CFI - SR 53 - STA 423+00 TO STA 438+00	RP-4	173
REMOVAL PLAN - CFI - NORTH SWAN ROAD - STA 13+00 TO STA 23+00	RP-5	174
CONSTRUCTION SIGNING (2)		
CONSTRUCTION SIGNING	CS-1	175
CONSTRUCTION SIGNING	CS-2	176
TRAFFIC CONTROL PLAN SHEETS (49)		
TRAFFIC CONTROL PLAN - U.S. 49	TC-1	177
TRAFFIC CONTROL PLAN - DUCKWORTH ROAD	TC-2	178
TRAFFIC CONTROL PLAN - TOURIEL ROAD	TC-3	179
TRAFFIC CONTROL PLAN - SOUTH SWAN ROAD	TC-4	180
TRAFFIC CONTROL PLAN - VICK ROAD	TC-5	181
TRAFFIC CONTROL PLAN - JIM BANKS ROAD	TC-6	182
TRAFFIC CONTROL PLAN - SCHOOL ROAD	TC-7	183
TRAFFIC CONTROL - PHASE 1 - WORK ZONE LAYOUT	TC-8	184
TRAFFIC CONTROL - PHASE 1 - TYPICAL SECTION	TC-9	185
TRAFFIC CONTROL - PHASE 2, 2A & 2B - WORK ZONE LAYOUT	TC-10	186
TRAFFIC CONTROL - PHASE 2 - TYPICAL SECTION - U.S. 49	TC-11	187
TRAFFIC CONTROL - PHASE 2 - TYPICAL SECTION - U.S. 49	TC-12	188
TRAFFIC CONTROL - PHASE 2, 2A & 2B - TYPICAL SECTION SR 53 & N SWAN RD	TC-13	189
TRAFFIC CONTROL - PHASE 2 - U.S. 49 - STA 233+00 TO STA 239+00	TC-14	190
TRAFFIC CONTROL - PHASE 2 - U.S. 49 - STA 239+00 TO STA 245+00	TC-15	191
TRAFFIC CONTROL - PHASE 2 - U.S. 49 - STA 245+00 TO STA 251+00	TC-16	192
TRAFFIC CONTROL - PHASE 2 - U.S. 49 - STA 251+00 TO STA 256+00	TC-17	193
TRAFFIC CONTROL - PHASE 2 - U.S. 49 - STA 256+00 TO STA 260+50	TC-18	194
TRAFFIC CONTROL - PHASE 2 - U.S. 49 - STA 260+50 TO STA 266+50	TC-19	195

B:\1\2023\10101.AWK\DI-1.dgn

MISSISSIPPI DEPARTMENT OF TRANSPORTATION	
<b>DETAILED INDEX</b>	
PROJECT: BRNH-0008-01(154)	WORKING NUMBER DI-2
COUNTY: HARRISON	SHEET NUMBER 3
FILENAME: DI-1.dgn	
DESIGN TEAM: BMA	CHECKED: _____ DATE: _____

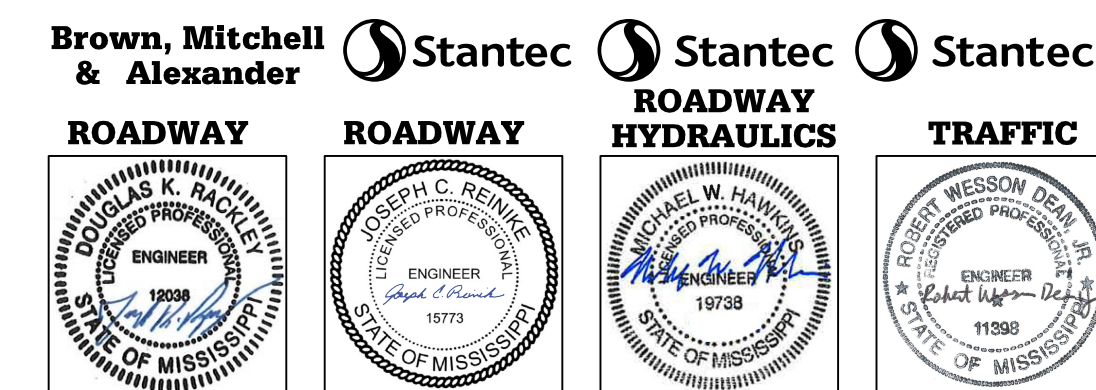



STATE	PROJECT NO.
MISS.	BRNH-0008-01(154)

DESCRIPTION OF SHEET

WKG. NO.    SH. NO.

PERMANENT SIGNING PLAN SHEETS (45)		
PERMANENT SIGNING PLAN - LAYOUT	PSP-LAY	1001
PERMANENT SIGNING PLAN - GENERAL NOTES & LEGEND	PSP-GN1	1002
PERMANENT SIGNING PLAN - U.S. 49 - STA 179+00 TO STA 185+00	PSP-1	1003
PERMANENT SIGNING PLAN - U.S. 49 - STA 185+00 TO STA 191+00	PSP-2	1004
PERMANENT SIGNING PLAN - U.S. 49 - STA 191+00 TO STA 197+00	PSP-3	1005
PERMANENT SIGNING PLAN - U.S. 49 - STA 197+00 TO STA 203+00	PSP-4	1006
PERMANENT SIGNING PLAN - U.S. 49 - STA 203+00 TO STA 209+00	PSP-5	1007
PERMANENT SIGNING PLAN - U.S. 49 - STA 209+00 TO STA 215+00	PSP-6	1008
PERMANENT SIGNING PLAN - U.S. 49 - STA 215+00 TO STA 221+00	PSP-7	1009
PERMANENT SIGNING PLAN - U.S. 49 - STA 221+00 TO STA 227+00	PSP-8	1010
PERMANENT SIGNING PLAN - U.S. 49 - STA 227+00 TO STA 233+00	PSP-9	1011
PERMANENT SIGNING PLAN - U.S. 49 - STA 233+00 TO STA 239+00	PSP-10	1012
PERMANENT SIGNING PLAN - U.S. 49 - STA 239+00 TO STA 245+00	PSP-11	1013
PERMANENT SIGNING PLAN - U.S. 49 - STA 245+00 TO STA 251+00	PSP-12	1014
PERMANENT SIGNING PLAN - U.S. 49 - STA 251+00 TO STA 257+00	PSP-13	1015
PERMANENT SIGNING PLAN - SR 53 - STA 420+00 TO STA 432+00	PSP-13A	1016
PERMANENT SIGNING PLAN - SR 53 - STA 432+00 TO STA 438+00	PSP-13B	1017
PERMANENT SIGNING PLAN - SR 53 - STA 438+00 TO STA 443+00	PSP-13C	1018
PERMANENT SIGNING PLAN - NORTH SWAN RD - STA 12+00 TO STA 18+00	PSP-13D	1019
PERMANENT SIGNING PLAN - NORTH SWAN RD - STA 18+00 TO STA 24+80	PSP-13E	1020
PERMANENT SIGNING PLAN - U.S. 49 - STA 257+00 TO STA 263+00	PSP-14	1021
PERMANENT SIGNING PLAN - U.S. 49 - STA 263+00 TO STA 269+00	PSP-15	1022
PERMANENT SIGNING PLAN - U.S. 49 - STA 269+00 TO STA 275+00	PSP-16	1023
PERMANENT SIGNING PLAN - U.S. 49 - STA 275+00 TO STA 281+00	PSP-17	1024
PERMANENT SIGNING PLAN - U.S. 49 - STA 281+00 TO STA 287+00	PSP-18	1025
PERMANENT SIGNING PLAN - U.S. 49 - STA 287+00 TO STA 293+00	PSP-19	1026
PERMANENT SIGNING PLAN - U.S. 49 - STA 293+00 TO STA 299+00	PSP-20	1027
PERMANENT SIGNING PLAN - U.S. 49 - STA 299+00 TO STA 305+00	PSP-21	1028
PERMANENT SIGNING PLAN - U.S. 49 - STA 305+00 TO STA 311+00	PSP-22	1029
PERMANENT SIGNING PLAN - U.S. 49 - STA 311+00 TO STA 317+00	PSP-23	1030
PERMANENT SIGNING PLAN - U.S. 49 - STA 317+00 TO STA 323+00	PSP-24	1031
PERMANENT SIGNING PLAN - U.S. 49 - STA 323+00 TO STA 329+00	PSP-25	1032
PERMANENT SIGNING PLAN - U.S. 49 - STA 329+00 - E.O.P.	PSP-26	1033
OVERHEAD SIGNING DETAIL - U.S. 49 NB @ STA 243+00	OH-1	1034
OVERHEAD SIGNING DETAIL - U.S. 49 SB @ STA 262+75	OH-2	1035
DIRECTIONAL SIGNING DETAIL - DETAIL OF GUIDE SIGNS	DSD-1	1036
DIRECTIONAL SIGNING DETAIL - DETAIL OF OVERHEAD SIGNS	DSD-2	1037
SIGNING REMOVAL PLAN SHEETS (7)		
SIGNING REMOVAL PLAN - U.S. 49 - STA 173+00 TO STA 203+00	SRP-1	1038
SIGNING REMOVAL PLAN - U.S. 49 - STA 203+00 TO STA 233+00	SRP-2	1039
SIGNING REMOVAL PLAN - U.S. 49 - STA 233+00 TO STA 264+00	SRP-3	1040
SIGNING REMOVAL PLAN - U.S. 49 - STA 264+00 TO STA 294+00	SRP-4	1041
SIGNING REMOVAL PLAN - U.S. 49 - STA 294+00 TO STA 325+00	SRP-5	1042
SIGNING REMOVAL PLAN - U.S. 49 - STA 325+00 TO E.O.P.	SRP-6	1043
SIGNING REMOVAL PLAN - SR 53 - STA 440+50 TO E.O.P.	SRP-7	1044

DESCRIPTION OF SHEET

WKG. NO.    SH. NO.

TRAFFIC SIGNAL INSTALLATION SHEETS (9)		
TRAFFIC SIGNAL INSTALLATION - U.S. 49 @ O'NEAL ROAD	TSI-1	2001
TRAFFIC SIGNAL INSTALLATION - U.S. 49 @ DUCKWORTH ROAD	TSI-2	2002
TRAFFIC SIGNAL INSTALLATION - U.S. 49 @ DUCKWORTH ROAD - RAILROAD INTERCONNECT	TSI-3	2003
TRAFFIC SIGNAL INSTALLATION - U.S. 49 @ SR 53 - CFI SOUTH LEG	TSI-4	2004
TRAFFIC SIGNAL INSTALLATION - U.S. 49 @ SR 53 - CFI	TSI-5	2005
TRAFFIC SIGNAL INSTALLATION - U.S. 49 @ SR 53 - CFI TRAFFIC SIGNAL PHASING	TSI-6	2006
TRAFFIC SIGNAL INSTALLATION - U.S. 49 @ SR 53 - CFI TRAFFIC SIGNAL PHASING PREEMPTION DETAILS	TSI-7	2007
TRAFFIC SIGNAL INSTALLATION - U.S. 49 @ SCHOOL RD	TSI-8	2008
TRAFFIC SIGNAL INSTALLATION - U.S. 49 @ SCHOOL RD - ADVANCED WARNING FLASHERS	TSI-9	2009
TRAFFIC SIGNAL REMOVAL SHEETS (2)		
TRAFFIC SIGNAL REMOVAL - U.S. 49 @ O'NEAL ROAD	TSR-1	2010
TRAFFIC SIGNAL REMOVAL - U.S. 49 @ N SWAN RD/SR 53	TSR-2	2011
TRAFFIC SIGNAL DETAIL SHEETS (15)		
TRAFFIC SIGNAL DETAIL - TRAFFIC SIGNAL GENERAL NOTES	TSD-1	2012
TRAFFIC SIGNAL DETAIL - TRAFFIC SIGNAL HEADS, SIGNS, AND WIND SPEEDS	TSD-2	2013
TRAFFIC SIGNAL DETAIL - CURVED MAST ARM AND PEDESTAL POLE DETAILS	TSD-3C	2014
TRAFFIC SIGNAL DETAIL - SIGNAL POLE AND PEDESTAL FOUNDATION DETAILS	TSD-4	2015
TRAFFIC SIGNAL DETAIL - TRAFFIC SIGNAL GROUNDING DETAILS	TSD-5	2016
TRAFFIC SIGNAL DETAIL - CONTROLLER CABINET AND POWER SERVICE DETAILS	TSD-6	2017
TRAFFIC SIGNAL DETAIL - POWER SERVICE PEDESTAL	TSD-7	2018
TRAFFIC SIGNAL DETAIL - PULL BOX AND CONDUIT TRENCHING DETAILS FOR TRAFFIC SIGNAL INSTALLATION	TSD-8	2019
TRAFFIC SIGNAL DETAIL - VIDEO/MULTI-SENSOR DETECTION INSTALLATION FOR TRAFFIC SIGNALS	TSD-9V	2020
TRAFFIC SIGNAL DETAIL - TRAFFIC CONTROL PLAN (TYPICAL SIGNAL INSTALLATION)	TSD-10	2021
TRAFFIC SIGNAL DETAIL - STREET NAME SIGN DETAILS	TSD-11	2022
TRAFFIC SIGNAL DETAIL - TYPICAL INTERSECTION LAYOUT	TSD-14	2023
TRAFFIC SIGNAL DETAIL - RADIO/CAMERA MOUNTING DETAILS	TSD-15	2024
TRAFFIC SIGNAL DETAIL - ARM GROUND DETAILS	TSD-18	2025
TRAFFIC SIGNAL DETAIL - PREPARE TO STOP WHEN FLASHING ASSEMBLY (VERTICAL)	TSD-19V	2026
ITS GENERAL NOTES AND LEGEND (1)	ITS-GN1	3001
ITS PROJECT LOCATION PLAN (1)	LP-1	3002
ITS PLAN SHEETS (7)		
U.S. 49 - STA. 147+94.18 TO STA. 176+00	ITS-1	3003
U.S. 49 - STA. 176+00 TO STA. 208+00	ITS-2	3004
U.S. 49 - STA. 208+00 TO STA. 240+00	ITS-3	3005
U.S. 49 - STA. 240+00 TO STA. 272+00	ITS-4	3006
U.S. 49 - STA. 272+00 TO STA. 305+00	ITS-5	3007
U.S. 49 - STA. 305+00 TO STA. 337+00	ITS-6	3008
U.S. 49 - STA. 337+00 TO STA. 370+00	ITS-7	3009

B:\1\2023\10401.AM\DI-1.DGN



MISSISSIPPI DEPARTMENT OF TRANSPORTATION	
<b>DETAILED INDEX</b>	
PROJECT: BRNH-0008-01(154)	WORKING NUMBER DI-4
COUNTY: HARRISON	SHEET NUMBER 5
FILENAME: DI-1.dgn	
DESIGN TEAM: BMA	CHECKED:      DATE:

STATE	PROJECT NO.
MISS.	BRNH-0008-01(154)

DESCRIPTION OF SHEET

WKG. NO.    SH. NO.

ITS DETAIL SHEETS (16)		
AERIAL SUPPORTED CONDUIT - NOTES & TYPICAL DETAILS	ASC-1	3010
AERIAL SUPPORTED CONDUIT - NOTES & TYPICAL DETAILS	ASC-2	3011
ITS CABINET DETAILS - TYPE B AND C CABINET DETAILS	CAB-1	3012
ITS CABINET DETAILS - TYPE C COMM. CABINET DETAILS	CAB-2	3013
ITS CABINET DETAILS - CABINET ENTRANCE DETAIL	CAB-3	3014
CCTV / RDS DETAILS - POLE-MOUNTED CCTV DETAILS	CCTV-1	3015
CCTV DETAILS - SIGNAL POLE, VERTICAL AND LATERAL POLE EXTENSION CCTV AND BDS DETAILS	CCTV-2	3016
DMS DETAILS - DMS SITE #1 - U.S. 49 NORTHBOUND - STA. 212+75	DMS-1	3017
DMS DETAILS - DMS SITE #2 - U.S. 49 SOUTHBOUND - STA. 363+00	DMS-2	3018
ITS EQUIPMENT DETAILS - SITE BLOCK DIAGRAMS	ED-1	3019
FIBER OPTIC DETAILS - PULLBOX AND CONDUIT TRENCHING DETAILS	FO-1	3020
FIBER OPTIC DETAILS - FIBER SPLICING DETAILS	FO-2	3021
FIBER OPTIC DETAILS - TERMINATION CABINET TABLES	FO-3	3022
FIBER OPTIC DETAILS - TERMINATION CABINET TABLES	FO-4	3023
FIBER OPTIC DETAILS - CABLE MANAGEMENT DETAILS	FO-5	3024
FIBER OPTIC DETAILS - SYSTEM BLOCK DIAGRAM	FO-6	3025
STANDARD DRAWINGS - ROADWAY SHEETS (95)		
PAVEMENT		
BRIDGE END PAVEMENT WITH RAIL, OVERLAY, AND SLEEPER SLAB (NEW CONSTRUCTION)	BE-1	6007
CONCRETE ISLAND PAVEMENT DETAILS	CIP-1	6011
PAVEMENT MARKINGS		
PAVEMENT MARKING DETAILS FOR 2-LANE & 4-LANE DIVIDED ROADWAYS	PM-1	6051
PAVEMENT MARKING LEGEND DETAILS	PM-5	6055
PAVEMENT MARKING LEGEND DETAILS	PM-6	6056
TYPICAL PLACEMENT OF WARNING SIGNS AND PAVEMENT MARKINGS AT R.R. - HIGHWAY GRADE CROSSINGS	PM-7	6057
TYPICAL PAVEMENT MARKING DETAIL FOR MEDIAN CROSSEOVERS	PM-9	6059
2-WAY RAISED PAVEMENT MARKER AT INTERSECTING ROADWAYS ROADS (4-LANE)	PM-12	6062
RUMBLE STRIPES 4-LANE HIGHWAYS (ASPHALT LANES, 2-FT OR WIDER ASPHALT SHOULDERS)	RS-2	6065
EROSION CONTROL		
TYPICAL TEMPORARY EROSION CONTROL/SEDIMENT CONTROL APPLICATIONS	ECD-1	6101
DETAILS OF SEDIMENT BARRIER APPLICATIONS	ECD-2	6102
DETAILS OF SILT FENCE INSTALLATION	ECD-3	6103
DITCH CHECK STRUCTURES, TYPICAL APPLICATIONS AND DETAILS	ECD-4	6104
TEMPORARY EROSION, SEDIMENT AND WATER POLLUTION CONTROL MEASURES, SILT FENCE AND HAY BALE DITCH CHECKS	ECD-5	6105
DETAILS OF EROSION CONTROL WATTLE DITCH CHECK	ECD-6	6106
DETAILS OF EROSION CONTROL SILT DIKE DITCH CHECK	ECD-7	6107
ROCK DITCH CHECK	ECD-8	6108
ROCK FILTER DAM	ECD-9	6109
ROCK DITCH CHECK WITH SUMP EXCAVATION AND ROCK FILTER DAM	ECD-10	6110
INLET PROTECTION TYPICAL APPLICATIONS AND DETAILS	ECD-11	6111
INLET PROTECTION DETAILS FOR COARSE AGGREGATE ON GRADES & SAGS	ECD-12	6112
INLET PROTECTION DETAILS OF WATTLES	ECD-13	6113
INLET PROTECTION DETAILS OF MANUFACTURED INLET PROTECTION DEVICE	ECD-14	6114
INLET PROTECTION DETAILS OF SAND BAG	ECD-15	6115
STABILIZED CONSTRUCTION ENTRANCE	ECD-16	6116
TEMPORARY STREAM DIVERSION	ECD-18	6118
TEMPORARY STREAM DIVERSION (BOX EXTENSIONS)	ECD-19	6119
FLOATING TURBIDITY CURTAIN	ECD-20	6120
DETAILS OF EROSION CONTROL SANDBAG DITCH CHECK	ECD-21	6121
SEDIMENT RETENTION BARRIER	ECD-22	6122

DESCRIPTION OF SHEET

WKG. NO.    SH. NO.

STANDARD DRAWINGS - ROADWAY SHEETS (CONT'D)		
EROSION CONTROL (CONT'D)		
DETAILS OF TYPICAL DITCH TREATMENTS	DT-1	6123
DITCH TREATMENT INSTALLATION DETAIL FOR SOIL REINFORCING MAT	DT-1A	6124
TYPICAL TEMPORARY EROSION CONTROL MEASURES (SLOPE DRAIN AND TYPE A SILT BASIN)	BAS-A	6125
TYPICAL TEMPORARY EROSION CONTROL MEASURES (TYPE D SILT BASIN) (135 CU. YDS. CAPACITY PER ACRE OF DRAINAGE)	BAS-D	6129
SUPER SILT FENCE	SSF-1	6130
PROTECTIVE BARRIERS		
GUARDRAIL: THRIE BEAM (WOOD POSTS)	GR-1A	6202
GUARDRAIL: "W" BEAM (STEEL POSTS)TREATMENTS	GR-1B	6203
GUARDRAIL: BRIDGE END SECTION-TYPE I (STEEL POSTS)(NEW CONSTRUCTION)	GR-2G	6211
GUARDRAIL: TYPE I CABLE ANCHORAGE (FOUNDATION TUBE)	GR-3	6212
GUARDRAIL: TYPE I CABLE ANCHORAGE (CONCRETE FOOTING)	GR-3A	6213
GUARDRAIL: TYPICAL INSTALLATION AT BRIDGE APPROACHES FOR DIVIDED HIGHWAY	GR-4	6214
GUARDRAIL: TYPICAL INSTALLATION FOR ROADSIDE HAZARDS ON DIVIDED HIGHWAYS	GR-4B	6216
GUARDRAIL: TYPICAL INSTALLATION FOR ROADSIDE HAZARDS ON 2-LANE, 2-WAY HIGHWAYS	GR-4C	6217
GUARDRAIL: RUB RAIL HARDWARE	GR-RR	6218
GUARDRAIL (TEMPORARY): TYPICAL INSTALLATION AT DETOUR BRIDGE ENDS	TGR-1	6219
GUARDRAIL (TEMPORARY): TYPICAL INSTALLATION AT BRIDGE END DURING CONSTRUCTION PHASES	TGR-2	6220
GUARDRAIL: MISCELLANEOUS HARDWARE	GR-HW	6221
SIGNING		
STANDARD DIRECTIONAL (GUIDE) SIGNS	SN-1	6301
ROUTE SHIELDS AND "EXIT ONLY" PANELS	SN-2	6302
STANDARD ROADSIDE SIGNS	SN-3	6303
STANDARD ROADSIDE SIGNS	SN-3A	6304
STANDARD ROADSIDE SIGNS	SN-3B	6305
STANDARD ROADSIDE SIGN ASSEMBLY AND INSTALLATION	SN-4	6306
STANDARD ROADSIDE SIGN ASSEMBLY AND INSTALLATION	SN-4A	6307
STANDARD ROADSIDE SIGN ASSEMBLY AND INSTALLATION	SN-4B	6308
TYPICAL INSTALLATION OF GROUND MOUNTED DIRECTIONAL SIGNS	SN-5	6309
BREAKAWAY SIGN SUPPORTS	SN-6	6310
BREAKAWAY SIGN SUPPORTS	SN-6A	6311
BREAKAWAY SIGN SUPPORTS	SN-6B	6312
SIGN FACE CONST. AND ATTACHMENT OF GROUND MOUNTED DIRECTIONAL SIGNS TO STEEL BEAMS (EXTRUDED ALUMINUM PANELS)	SN-7	6313
TYPICAL INSTALLATION OF DELINEATORS	SN-8	6315
TYPICAL CROSSEOVER DELINEATION	SN-8B	6316
TYPICAL GUARDRAIL DELINEATION	SN-8C	6317
SIGNING DETAILS FOR BRIDGE APPROACHES	SN-9	6318

B:\1\2023\10401.AWK DI-1.dgn MISSISSIPPI DEPARTMENT OF TRANSPORTATION

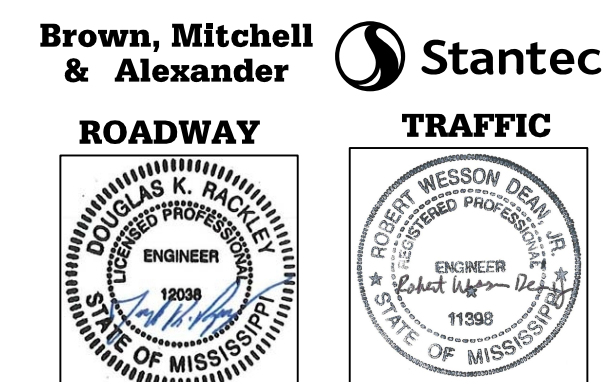

MISSISSIPPI DEPARTMENT OF TRANSPORTATION	
<b>DETAILED INDEX</b>	
PROJECT: BRNH-0008-01(154)	WORKING NUMBER
COUNTY: HARRISON	DI-5
FILENAME: DI-1.dgn	SHEET NUMBER
DESIGN TEAM BMA	6

STATE	PROJECT NO.
MISS.	BRNH-0008-01(154)

DESCRIPTION OF SHEET

WKG. NO.    SH. NO.

STANDARD DRAWINGS - ROADWAY SHEETS (CONT'D)		
TRAFFIC CONTROL PLAN		
TRAFFIC CONTROL PLAN WITH FLAGGER (ONE-LANE CLOSURE OF TWO-WAY TRAFFIC)	TCP-1	6351
TRAFFIC CONTROL PLAN FOR POSTED SPEED LIMIT LESS THAN 65 MPH (4-LANE; MEDIAN LANE OR OUTSIDE LANE CLOSURE) (WORK DAY ONLY)	TCP-2	6352
TRAFFIC CONTROL PLAN FOR POSTED SPEED LIMIT LESS THAN 65 MPH (4-LANE; MEDIAN LANE OR OUTSIDE LANE CLOSURE) (EXTENDED PERIOD)	TCP-3	6353
TRAFFIC CONTROL PLAN FOR POSTED SPEED LIMIT OF 65 OR 70 MPH (INTERSTATES AND OTHER 4-LANE DIVIDED HIGHWAYS) (MEDIAN LANE OR OUTSIDE LANE CLOSURE) (EXTENDED PERIOD)	TCP-4	6354
TRAFFIC CONTROL PLAN FOR POSTED SPEED LIMIT OF 65 OR 70 MPH (INTERSTATES AND OTHER 4-LANE DIVIDED HIGHWAYS) (MEDIAN LANE OR OUTSIDE LANE CLOSURE) (WORK DAY ONLY)	TCP-5	6355
SHORT DURATION CLOSING OF DIVIDED HIGHWAYS	TCP-7	6357
HIGHWAY SIGN AND BARRICADE DETAILS FOR CONSTRUCTION PROJECTS	TCP-8	6358
TRAFFIC CONTROL PLAN MOBILE OPERATIONS MULTILANE ROADS AND TWO-LANE ROADS	TCP-9	6359
TRAFFIC CONTROL PLAN; UNEVEN PAVEMENT DETAILS	TCP-12	6362
TEMPORARY STRIPING FOR TRAFFIC CONTROL 2-LANE AND 4-LANE DIVIDED HIGHWAYS	TCP-13	6363
LOCATION OF R16-3 SIGNS (SPEEDING FINES DOUBLED)	TCP-15	6365
TRAFFIC CONTROL DETAILS DRUM PLACEMENT AND SHOULDER CLOSURE	TCP-16	6366
MISCELLANEOUS ROADWAY DETAILS		
RIGHT-OF-WAY MARKER	RW-1	6401
RURAL DRIVEWAYS	RD-1	6403
TYPICAL GRADING TRANSITION BETWEEN CUTS & FILLS	GT-1	6404
SIGHT FLARE	SF-1	6405
DRIVEWAYS, CURB & GUTTER, & SIDEWALK	SD-1	6419
MISCELLANEOUS DETAIL SHEET 1. STACKED PIPE JOINTS 2. EXCAVATION AT GRADE POINTS	MDS-1	6425
DETAILS OF PAVED FLUMES	PF-1	6426
DRAINAGE		
PIPE CULVERT INSTALLATION	PI-1	6501
CONCRETE PIPE COLLAR	PC-1	6503
JUNCTION BOX FOR PIPE CULVERTS	JB-1	6504
JUNCTION BOX FOR BOX CULVERTS TO CONCRETE ARCH PIPE	JB-1A	6505
JUNCTION BOX TYPE 2 FOR TRAFFIC LOAD (MAXIMUM "W" = 9.3 FT.)	JB-2	6506
BRANCH CONNECTIONS	BC-1	6507
TYPE I MEDIAN INLET (24" PIPE AND UNDER)	MI-1	6508
DETAILS OF GRATES FOR MEDIAN INLETS	IG-1	6516
DETAILS OF GRATES FOR GUTTER INLETS	IG-2	6517
GUTTER INLET FOR TYPE 2 CURB (OUTLET 90° TO ROADWAY)	GI-1	6518
GUTTER INLET FOR TYPE 2 CURB (STORM SEWER ALONG ROADWAY)	GI-1A	6519
STORM SEWER INLET - TYPE SS-2	SS-2	6524
FLARED END SECTION FOR CONCRETE PIPE	FE-1	6530
FLARED END SECTION FOR CONCRETE ARCH PIPE	FE-1A	6531

DESCRIPTION OF SHEET

WKG. NO.    SH. NO.

CROSS SECTIONS (121)		
MAINLINE FACILITY - B.O.P. (STA. 180+60) TO E.O.P. (STA. 335+00)		9001 - 9045
LOCAL ROAD DUCKWORTH (WEST)		9046 - 9047
LOCAL ROAD DUCKWORTH (EAST)		9048 - 9049
LOCAL ROAD TOURIEL		9050 - 9051
LOCAL ROAD SOUTH SWAN (WEST)		9052 - 9053
LOCAL ROAD SOUTH SWAN (EAST)		9054 - 9055
SOUTH FRONTAGE ROAD		9056 - 9061
CFI SOUTH		9062 - 9070
SOUTHWEST RAMP		9071 - 9074
CFI NORTH		9075 - 9080
NORTHEAST RAMP		9081 - 9083
SR 53		9084 - 9093
SOUTHWEST FRONTAGE ROAD		9094 - 9095
NORTH SWAN		9096 - 9102
SOUTHEAST FRONTAGE ROAD		9103 - 9108
LOCAL ROAD VICK		9109 - 9110
LOCAL ROAD MS POWER		9111 - 9112
LOCAL ROAD SCHOOL		9113 - 9114

B:\1\2023\10401.AM DI-1.dgn MISSISSIPPI DEPARTMENT OF TRANSPORTATION ROADWAY PLAN DIVISION

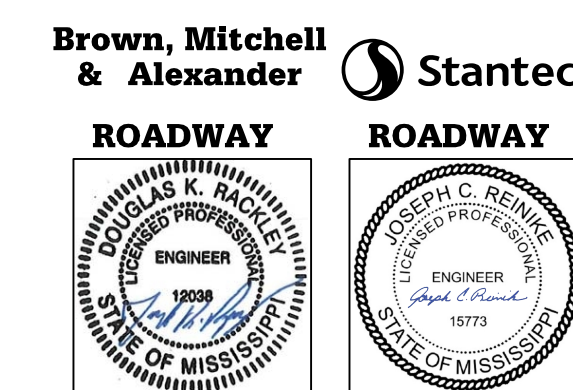

MISSISSIPPI DEPARTMENT OF TRANSPORTATION	
<b>DETAILED INDEX</b>	
PROJECT: BRNH-0008-01(154)	WORKING NUMBER
COUNTY: HARRISON	DI-6
FILENAME: DI-1.dgn	SHEET NUMBER
DESIGN TEAM BMA	7

STATE	PROJECT NO.
MISS.	BRNH-0008-01(154)

GENERAL NOTES

- (1) THE LOCATION AND SPACING OF SIGNS, SHOWN ON THE TRAFFIC CONTROL PLANS, ARE APPROXIMATE AND MAY BE ADJUSTED AS NECESSARY TO FIT FIELD CONDITIONS.
- (2) ALL TRAFFIC CONTROL DEVICES ON THIS PROJECT SHALL COMPLY WITH PART VI OF THE MUTCD (LATEST EDITION).
- (3) ALL PLASTIC DRUMS SHALL HAVE A BALLASTING COLLAR MADE FROM RECYCLED TRUCK TIRES OR OTHER SUITABLE MATERIAL.
- (4) 25% SHRINKAGE FACTOR USED IN THE EARTHWORK CALCULATIONS IS FOR DESIGN ESTIMATING PURPOSES ONLY.
- (5) THE CONTRACTOR SHALL BE RESPONSIBLE FOR PROTECTING EXISTING STRUCTURES SUCH AS, BUT NOT LIMITED TO, PIPES, INLETS, APRONS, BRIDGES, RAILROAD SIGNALS AND RAILROAD SURFACE FROM DAMAGE WHICH MIGHT OCCUR DURING CONSTRUCTION. THE CONTRACTOR SHALL REPLACE OR REPAIR, AS DIRECTED BY THE ENGINEER, ANY STRUCTURES DAMAGED DURING THE LIFE OF THE CONTRACT. NO PAYMENT WILL BE MADE FOR REPLACEMENT OR REPAIR OF DAMAGED ITEMS.
- (6) ALL PIPE JOINTS ARE TO BE WRAPPED IN 24-INCH WIDE TYPE V GEOTEXTILE FABRIC. ALL PICKUP HOLES SHALL BE PLUGGED AND COVERED WITH TYPE V GEOTEXTILE FABRIC , THE COST OF WHICH SHALL BE ABSORBED IN OTHER BID ITEMS.
- (7) VOIDS CREATED BY THE REMOVAL OF, BUT NOT LIMITED TO, POSTS, CONCRETE ANCHORS, AND FOOTINGS SHALL BE BACKFILLED AND TAMPED IN ACCORDANCE WITH SECTION 203 OF THE MISSISSIPPI STANDARD SPECIFICATIONS FOR ROAD AND BRIDGE CONSTRUCTION, THE COST OF WHICH WILL BE ABSORBED IN OTHER ITEMS BID.
- (8) UTILITIES ON THE DRAWINGS ARE SHOWN IN THEIR ORIGINAL LOCATION BASED UPON THE BEST INFORMATION AVAILABLE TO THE ENGINEER. UTILITIES THAT WERE FOUND TO BE IN CONFLICT WITH CONSTRUCTION HAVE BEEN RELOCATED. PERMITS ARE ON FILE WITH THE DEPARTMENT SHOWING THE APPROXIMATE LOCATION OF UTILITIES RELOCATED WITHIN THE RIGHT-OF-WAY. THE ENGINEER CAN NOT AND DOES NOT WARRANT THAT THIS INFORMATION IS COMPLETE OR ACCURATE. THE CONTRACTOR MUST COORDINATE DIRECTLY WITH THE INVOLVED UTILITY OWNERS TO HAVE UNDERGROUND UTILITY LINES FIELD LOCATED IN ADVANCE OF CONSTRUCTION.
- (9) WORK ON STRUCTURES FOR THIS PROJECT REQUIRES EXCAVATION IN THE IMMEDIATE VICINITY OF TRAFFIC AND ADJACENT PROPERTIES. THEREFORE, THE RISK OF A FAILURE OCCURRING DURING EXCAVATION REQUIRES THAT EXTREME CAUTION BE EXERCISED. THE CONTRACTOR SHALL BE RESPONSIBLE FOR PLACING WHAT BRACING, SHORING, OR GROUND SUPPORT SYSTEM THAT IS DEEMED NECESSARY TO PREVENT A FAILURE AND PROTECT THE PERSONS WORKING NEAR THE EXCAVATION, THE PUBLIC THAT MAY BE ABOVE THE EXCAVATION OR ANY STRUCTURES ADJACENT TO THE EXCAVATION. ALL COSTS FOR DESIGNING, DRAWING, AND CONSTRUCTING THE FACILITY SHALL BE INCLUDED IN THE PRICE BID FOR CONTRACT ITEMS.
- (10) SOME WORK IS REQUIRED OUTSIDE THE PROJECT LIMITS. NO ADDITIONAL COMPENSATION WILL BE MADE FOR SUCH WORK EXCEPT AS PROVIDED BY SPECIFIC PAY ITEMS INCLUDED IN THE PLANS.
- (11) WIRE FENCE BACKING WILL BE REQUIRED FOR ALL SILT FENCE. (SEE WK. NO. ECD-3)
- (12) FULL COLLARS ARE TO BE USED AT ALL BOX CULVERT EXTENSIONS AND AT ALL BOX CULVERT CONSTRUCTION JOINTS. (SEE WK. NO. ICJ-1 FOR DETAILS)
- (13) LIST OF PUBLIC UTILITIES
 

A. MISSISSIPPI POWER	228-435-6025
B. CENTER POINT ENERGY-ENTEX	896-7500
C. BELL SOUTH	1-800-555-1155
D. CABLE ONE	228-374-5900
E. CITY OF GULFPORT	868-5792
- (14) ALL POST LENGTHS FOR SIGNS SHALL BE VERIFIED IN THE FIELD PRIOR TO FABRICATION.

GENERAL NOTES (CONT.)

- (15) FLUORESCENT ORANGE SHEETING SHALL BE USED ON ALL CONSTRUCTION AND TRAFFIC CONTROL SIGNS EXCEPT FOR THOSE DESIGNATED ON THE PLANS TO BE BLACK LEGEND AND BORDER ON WHITE BACKGROUND.
- (16) VEGETATIVE MATERIAL WILL BE REMOVED PRIOR TO PLACEMENT OF GRANULAR MATERIAL. THE COST OF WHICH SHALL BE ABSORBED IN OTHER BID ITEMS.
- (17) ALL DIMENSIONS AND SPACINGS FOR BRIDGE RAIL CONNECTORS SHALL BE VERIFIED IN THE FIELD BY THE CONTRACTOR PRIOR TO FABRICATION.
- (18) THE CONTRACTOR SHALL COORDINATE WITH THE CONTRACTOR FROM ADJACENT PROJECT(S) IN IMPLEMENTING THE TRAFFIC CONTROL PLAN AS DIRECTED BY THE ENGINEER. ALL CONFLICTING SIGNS SHALL BE COVERED OR REMOVED AS DIRECTED BY THE ENGINEER.
- (19) THE CONTRACTOR SHALL COVER ANY TEMPORARY TRAFFIC CONTROL SIGNS SHOWN IN THE TRAFFIC CONTROL PLAN THAT DO NOT APPLY TO THE CURRENT PHASE
- (20) ROADWAY SIGNS THAT ARE IN CONFLICT WITH CONSTRUCTION OF THIS PROJECT SHALL BE REMOVED AND RELOCATED BY THE CONTRACTOR AS DIRECTED BY THE ENGINEER, THE COST OF WHICH SHALL BE ABSORBED IN OTHER ITEMS BID.
- (21) RAILROAD CROSSING IMPROVEMENTS WILL BE CONSTRUCTED BY OTHERS, POSSIBLY AT THE SAME TIME AS ROADWAY CONSTRUCTION. CONTRACTOR IS REQUIRED TO COORDINATE CONSTRUCTION ACTIVITIES.
- (22) REMOVAL OF RAISED PAVEMENT MARKERS THAT ARE IN CONFLICT WITH REQUIRED CONSTRUCTION IS NOT CONSIDERED A SEPARATE PAY ITEM. COST TO BE ABSORBED IN OTHER ITEMS BID.
- (23) REMOVAL OF OBJECT MARKERS IS NOT CONSIDERED A SEPARATE PAY ITEM, AND SHALL BE ABSORBED IN OTHER ITEMS BID.
- (24) WHERE MILLING IS REQUIRED, THE CONTRACTOR SHALL PROVIDE OUTLETS IN THE EXISTING SHOULDERS AT SUFFICIENT INTERVALS TO PREVENT POOLING OR STANDING WATER ON THE MILLED SURFACE, THE COST OF WHICH SHALL BE ABSORBED IN OTHER ITEMS BID. TRAFFIC WILL BE ALLOWED TO DRIVE ON FINE MILLED SURFACE FOR A MAXIMUM OF 5 CALENDER DAYS
- (25) THE EROSION CONTROL DEVICES REFERENCED IN THESE PLANS ARE A MINIMUM REQUIREMENT. IT IS THE RESPONSIBILITY OF THE CONTRACTOR TO ENSURE THAT SILT DOES NOT LEAVE THE RIGHT OF WAY OR CONTAMINATE WATERS OF THE U. S. DURING CONSTRUCTION. THE CONTRACTOR SHALL SUBMIT AN EROSION CONTROL PLAN AT THE PRECONSTRUCTION CONFERENCE OR PRIOR TO COMMENCEMENT OF WORK AND MAINTAIN THE PLAN DURING CONSTRUCTION. ANY ADDITIONAL SILT BASINS NOT SHOWN IN THE PLANS SHALL BE INCLUDED IN THE CONTRACTOR'S EROSION CONTROL PLAN PRIOR TO SUBMITTING FOR APPROVAL.
- (26) PRIOR TO EARTHWORK OPERATIONS, THE EXISTING TOP 4" TOPSOIL IS TO BE STRIPPED AND STOCKPILED. AFTER THE GRADING OPERATIONS ARE COMPLETED, SAID TOPSOIL SHALL BE PLACED ON ALL AREAS THAT ARE NOT TO BE PAVED OR OTHERWISE PROTECTED, IN ACCORDANCE WITH SECTION 211 OF THE SPECIFICATIONS, OR THE VEGETATION SCHEDULE (SEE WK. SH. VS-1). EXISTING TOPSOIL AND ALL COSTS ASSOCIATED WITH STRIPPING, HAULING, STOCKPILING, AND PLACEMENT OF THE EXISTING TOPSOIL IS TO BE PAID FOR AS UNCLASSIFIED EXCAVATION. ANY OTHER TOPSOIL REQ'D SHALL BE PAID FOR UNDER PAY ITEM 211-B001.

ROADWAY DESIGN PLAN C.A.S. SECTION MISSISSIPPI DEPARTMENT OF TRANSPORTATION

MISSISSIPPI DEPARTMENT OF TRANSPORTATION			
<b>GENERAL NOTES</b>			
PROJECT: BRNH-0008-01(154)			WORKING NUMBER
COUNTY: HARRISON			GN-1
FILENAME: GN-1.DGN			SHEET NUMBER
DESIGN TEAM BMA			8
DATE	CHECKED	DATE	



STATE	PROJECT NO.
MISS.	BRNH-0008-01(154)

GENERAL NOTES

- (27) THE CONTRACTOR IS RESPONSIBLE FOR FIELD-VERIFICATION OF EXISTING GRADES AND MAKING ADJUSTMENTS AS NECESSARY WITH THE APPROVAL OF THE PROJECT ENGINEER.
- (28) ERECTION DATES ARE TO BE LEGIBLY WRITTEN IN BOLD, BLACK MARKINGS ON THE BACK OF ALL PERMANENT SIGNS WITH A PERMANENT MARKING STICK THAT IS WATERPROOF, FADE RESISTANT, AND MARKS ON WET OR DRY SURFACES.
- (29) ALL ADDENDA TO THESE PLANS WILL BE POSTED TO WWW.MDOT.MS.GOV UNDER THE PROPOSAL ADDENDA COLUMN. BIDDERS ARE ADVISED THAT HARD COPIES OF ANY ADDENDA FOR THIS PROJECT WILL NOT BE MAILED. IT IS THE BIDDER'S RESPONSIBILITY TO CHECK AND SEE IF ANY ADDENDA HAVE BEEN POSTED FOR THIS PROJECT.
- (30) CURB AND GUTTER VERTICAL DIMENSIONS SHOWN IN THE DETAIL DRAWINGS ARE FOR A CURB IN THE "CATCH" CONFIGURATION AND SHALL BE CONSIDERED TO BE MINIMUM DIMENSIONS. THE DIMENSIONS MAY BE MODIFIED AS NECESSARY FOR "SPILL" CURB AND GUTTER, BUT SHALL NOT BE LESS THAN THE MINIMUM SHOWN.
- (31) THE COST FOR REMOVAL OF ALL HEADWALLS AND WINGWALLS (PIPES, BOX CULVERTS, BOX BRIDGES) SHALL BE ABSORBED IN OTHER ITEMS BID.
- (32) THE CONTRACTOR SHALL BE RESPONSIBLE FOR MAINTAINING AND RELOCATING MAIL BOXES AS NECESSARY TO MAINTAIN CONTINUOUS MAIL SERVICE THROUGHOUT THE LIFE OF THE PROJECT, THE COST OF WHICH SHALL BE ABSORBED IN OTHER ITEMS BID.
- (33) CLEARING IN WETLANDS IS LIMITED TO TEN (10) FEET BEYOND CONSTRUCTION LIMITS EXCEPT UNDER BRIDGES AND IN SIGHT FLARES. CLEARING UNDER BRIDGES (IN WETLANDS) IS LIMITED TO WITHIN TWENTY-FIVE (25) FEET ON ONE SIDE OF THE CENTERLINE AND FIFTY (50) FEET ON THE OTHER SIDE OF THE CENTERLINE. WITHIN THIS SEVENTY-FIVE (75) FOOT WIDE AREA, THE CONTRACTOR SHALL BE PERMITTED TO CONSTRUCT A TEMPORARY HAUL ROAD. UPON COMPLETION OF THE BRIDGE, THIS ROAD SHALL BE REMOVED BY THE CONTRACTOR TO NATURAL GROUND ELEVATION. ALL COSTS ASSOCIATED WITH THE HAUL ROAD ARE TO BE INCLUDED IN OTHER ITEMS. ADDITIONAL CLEARING IN THE VICINITY OF THE BRIDGE, OUTSIDE THE SEVENTY-FIVE (75) FOOT WIDE AREA, IS TO BE DONE WITH SAWS ONLY (NO DOZERS OR OTHER MECHANIZED CLEARING WHICH WILL DISTURB THE NATURAL GROUND SURFACE).
- (34) TEMPORARY STRIPING SHALL CONFORM TO FINISHED STRIPE SPECIFICATIONS FOR ALIGNMENT, NEATNESS, AND STRAIGHTNESS.
- (35) ALL ITEMS OF WORK ASSOCIATED WITH THE INSTALLATION OF A CONSTRUCTION ENTRANCE SHALL BE ABSORBED IN OTHER ITEMS OF WORK.
- (36) IF COLORS ARE USED ON PLAN/PROFILE SHEETS, THEY ARE INTENDED TO VISUALLY EASE THE LOCATION OF ELEMENTS FOR USERS OF THESE DRAWINGS. ALTHOUGH THE INTENT IS TO CATEGORIZE EVERYTHING AS EITHER EXISTING OR PROPOSED, IT IS THE END USER'S RESPONSIBILITY TO ENSURE ALL ELEMENTS ARE INTERPRETED CORRECTLY REGARDLESS OF COLOR.
- (37) ALL WEATHER ACCESS TO RESIDENCE & BUSINESS SHALL BE REQ'D.
- (38) LANE CLOSURES WILL ONLY BE ALLOWED DURING THE HOURS OF 7:00 P.M. TO 5:00 A.M. SUNDAY THRU THURSDAY
- (39) THE CONTRACTOR SHALL SECURE APPROVAL OF HIS OPERATIONS FROM THE STATE AND THE RAIL COMPANY. THE RAIL COMPANY WILL PERFORM AN ENGINEERING REVIEW OF METHODS OF OPERATIONS AND ENGINEERING SUPERVISION OF CONSTRUCTION, THE CONTRACTOR SHALL SECURE THE NECESSARY LICENSE(S) FROM THE RAILROAD FOR THE INSTALLATION OF ALL PIPES. THE CONTRACTOR SHALL OBTAIN THE STANDARD RIGHT OF ENTRY FORM FOR OBTAINING FLAGMEN AND RAILROAD CABLE LOCATES AND FOR PERMISSION TO WORK ON THE RAILROAD R.O.W.

- (40) THE CONTRACTOR SHALL CO-OPERATE WITH THE RAILROAD OFFICIALS CONCERNING WORK ADJACENT TO RAILROAD TRACKS, IN ORDER TO AVOID DELAY TO, OR INTERFERENCE WITH RAILROAD TRAFFIC, AND SHALL NOTIFY THE COMPANY 10 BUSINESS DAYS IN ADVANCE OF CONSTRUCTION OPERATIONS. THE CONTRACTOR SHALL HAVE SECURED THE RIGHT OF ENTRY IN ADVANCE TO ORDER FLAGMEN FOR ANY CONSTRUCTION OPERATIONS WITHIN 25 FEET OR USING EQUIPMENT THAT HAS POTENTIAL TO FOUL THE TRACKS, PER FEDERAL RAILROAD ADMINISTRATION REGULATIONS.
- (41) ANY EXCAVATION OF MUCK WILL BE PAID FOR AS EXCESS EXCAVATION.
- (42) MDOT WILL IDENTIFY ANY ADDITIONAL CONCRETE PAVEMENT PUNCHOUTS PRIOR TO THE START OF CONSTRUCTION.
- (43) STORAGE OF FLAMMABLE MATERIALS WILL NOT BE ALLOWED UNDER ANY BRIDGE STRUCTURES.

PLAN, C.A.S. SECTION  
 MISSISSIPPI DEPARTMENT OF TRANSPORTATION

		MISSISSIPPI DEPARTMENT OF TRANSPORTATION	
		<b>GENERAL NOTES</b>	
		PROJECT: BRNH-0008-01(154)	WORKING NUMBER
		COUNTY: HARRISON	GN-2
		FILENAME: GN-1.DGN	SHEET NUMBER
		DESIGN TEAM: BMA	9
DATE	CHECKED	DATE	