

GENERAL INDEX

| INCLUDED THIS PROJECT | BEGIN WITH SHEET |
|---|------------------|
| <input checked="" type="checkbox"/> ROADWAY..... | 1 |
| <input type="checkbox"/> PERMANENT SIGNS..... | 1001 |
| <input type="checkbox"/> TRAFFIC SIGNALS..... | 2001 |
| <input type="checkbox"/> ITS COMPONENTS..... | 3001 |
| <input type="checkbox"/> LIGHTING..... | 4001 |
| <input type="checkbox"/> (RESERVED)..... | 5001 |
| <input checked="" type="checkbox"/> ROADWAY STD. DWGS..... | 6001 |
| <input type="checkbox"/> BOX CULVERT STD. DWGS (LRFD)..... | 7001 |
| <input type="checkbox"/> BOX CULVERT STD. DWGS (STD. SPEC.).... | 7501 |
| <input type="checkbox"/> BRIDGE..... | 8001 |
| <input type="checkbox"/> CROSS SECTIONS..... | 9001 |

STATE OF MISSISSIPPI
MISSISSIPPI DEPARTMENT OF TRANSPORTATION
PLAN AND PROFILE OF
PROPOSED STATE HIGHWAY
STATE PROJECT NO. SP-0033-02(005)
SR 2 FM TIPPDAH CL TO US 72
ALCORN COUNTY

| PLAN STAGE | DATE PRINTED |
|--|--------------|
| <input type="checkbox"/> CONCEPTUAL | _____ |
| <input type="checkbox"/> PRE-R.O.W. | _____ |
| <input type="checkbox"/> FIELD INSPECTION | _____ |
| <input type="checkbox"/> R.O.W. PLANS TO SMD | _____ |
| <input type="checkbox"/> FINAL R.O.W. | _____ |
| <input type="checkbox"/> R.O.W. REVISION | _____ |
| <input type="checkbox"/> OFFICE REVIEW | _____ |

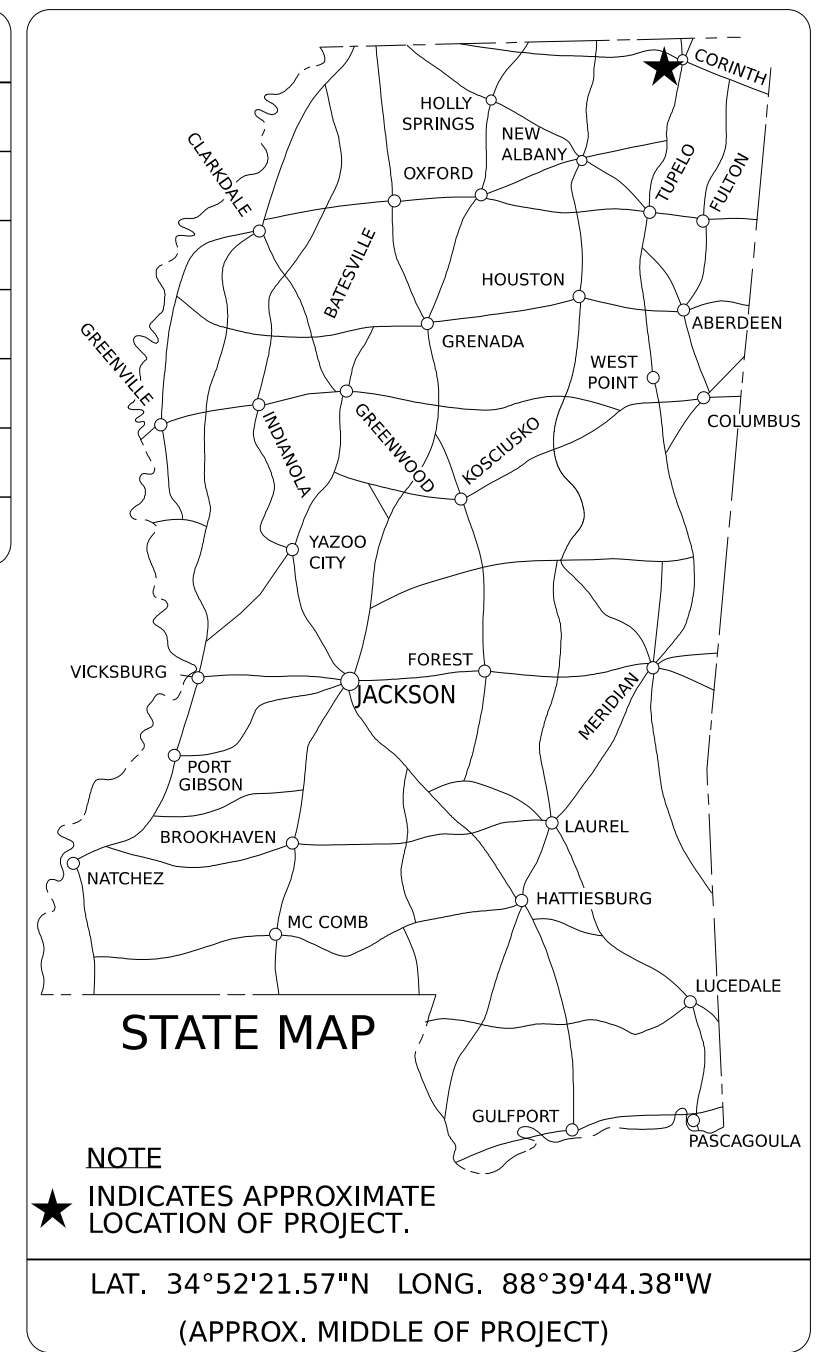

BRIDGE STRUCTURES REQ'D.

BOX BRIDGES REQ'D.

BEGINNING OF PROJECT STA. 100+00

END OF PROJECT STA. 874+11

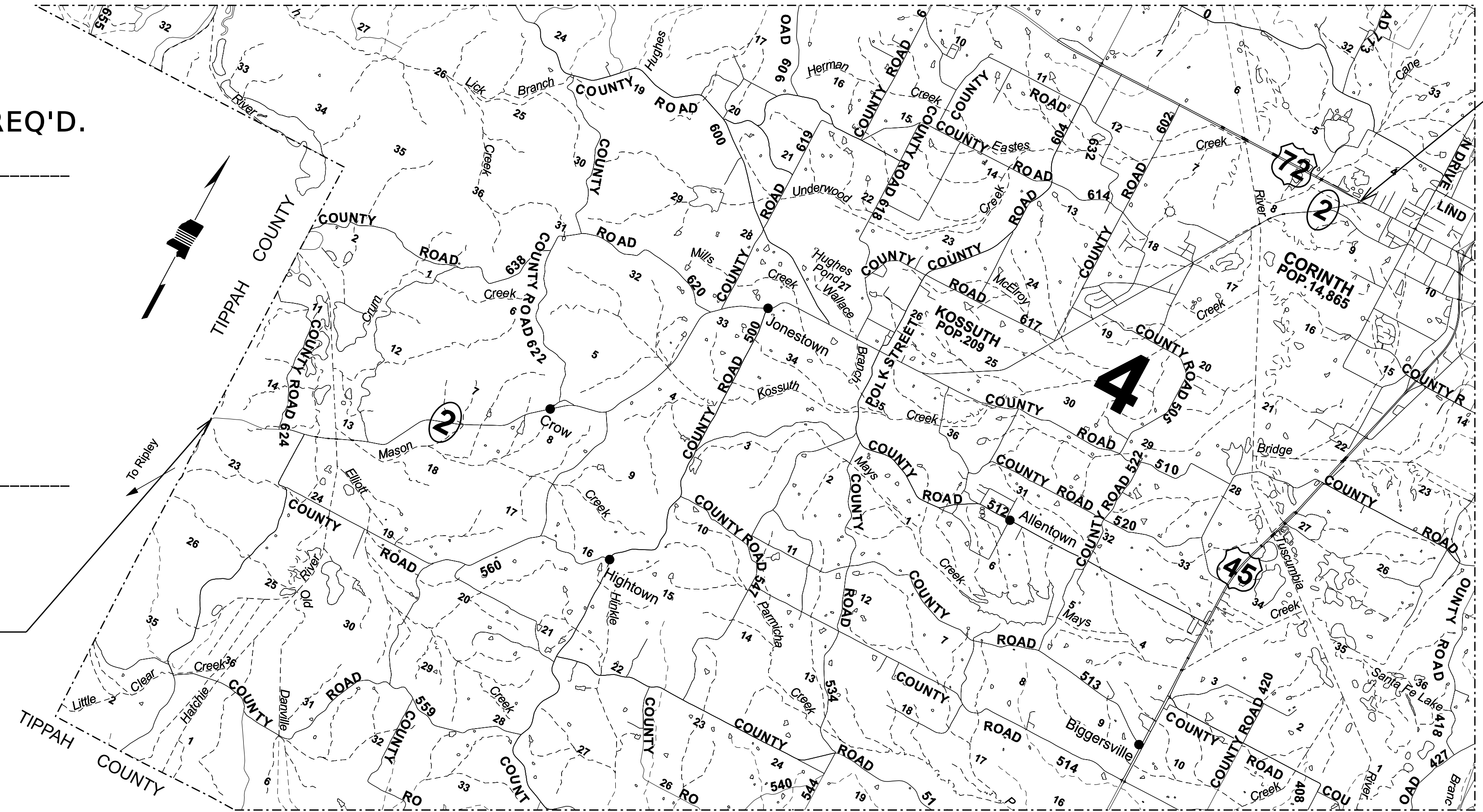

DESIGN CONTROL
 ___ MPH = V (SPEED DESIGN)
 ADT (___) = ___ : ADT (___) = ___
 DHV = ___ : D = ___ % T = ___ %

PERMITS ACQUIRED BY MDOT

| WETLANDS AND WATERS PERMITS | |
|---|---|
| | WATERS WETLANDS |
| NATIONWIDE #14 | <input type="checkbox"/> <input type="checkbox"/> |
| NATIONWIDE (OTHER)* | <input type="checkbox"/> <input type="checkbox"/> |
| GENERAL* | <input type="checkbox"/> <input type="checkbox"/> |
| INDIVIDUAL (404)* | <input type="checkbox"/> <input type="checkbox"/> |
| STORMWATER PERMIT <input type="checkbox"/> | |
| Y REQUIRED, CNOI SUBMITTED BY MDOT (DISTURBED AREA=5 ACRES) | |
| S REQUIRED, SCNOI TO BE SUBMITTED BY CONTRACTOR (1 TO 4.99 ACRES) | |
| N NO STORMWATER PERMIT REQUIRED (<1 ACRE) | |
| APPROVED BY: _____ | |

PLAN SHEET

5/19/2023 12:08:33 PM TITLE.dgn

CONVENTIONAL SYMBOLS

- COUNTY LINE
- TOWN CORP LINE
- SECTION LINE
- DEED LINE
- EXISTING ROADWAY
- PROPOSED ROADWAY
- RAILROAD
- BRIDGES

LENGTH DATA

| | | |
|---------------------------|-------|----------------|
| LENGTH OF ROADWAY | 75895 | FT. 14.374 MI. |
| LENGTH OF BRIDGES | 1516 | FT. 00.287 MI. |
| LENGTH OF PROJECT (NET) | 77411 | FT. 14.661 MI. |
| LENGTH OF EXCEPTIONS | 0 | FT. 00.000 MI. |
| LENGTH OF PROJECT (GROSS) | 77411 | FT. 14.661 MI. |

EQUATIONS

SCALES

| | |
|---------|-----------------|
| PLAN | 1 IN. = 100 FT. |
| PROFILE | 1 IN. = 100 FT. |
| LAYOUT | 1 IN. = 10 FT. |
| | 1 IN. = FT. |

EXCEPTIONS

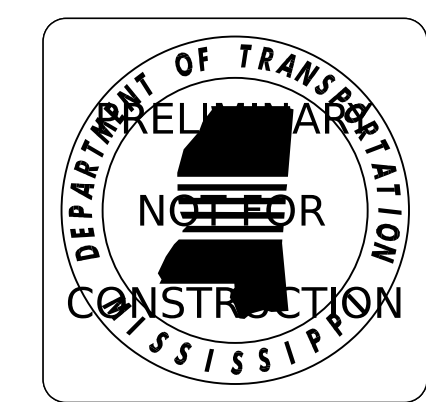

DESIGNED BY: _____

CONSTRUCTION PROJECT DATA

| | |
|-------------------------|-----------------|
| EXTERNAL PROJECT NUMBER | SP-0033-02(005) |
| FMS & DETAIL | 108918/301000 |

P S & E DATE: _____

APPROVED: _____

DEPUTY EXECUTIVE DIRECTOR / CHIEF ENGINEER

EXECUTIVE DIRECTOR

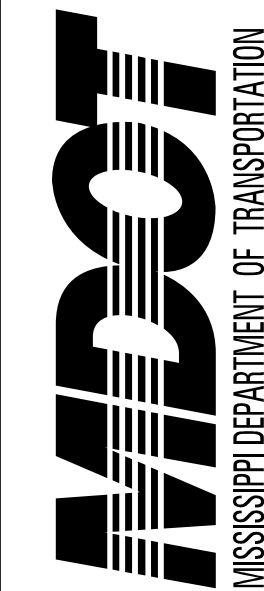

DESIGNED BY:
 DETAILED BY:
 CHECKED BY:
 DATE:

FMS CON: 108918/301000
 PROJECT NO.: SP-0033-02(005)
 COUNTY: ALCORN

DETAILED INDEX & GENERAL NOTES

WK. NO.
DI-1
 SHEET NO.
2

REVISION
 5/19/2023
 WKG.
 NO.
 SH.
 NO.

DESCRIPTION OF SHEET

| | | | |
|--|--------|------|----|
| TITLE SHEET | | | 1 |
| DETAILED INDEX & GENERAL NOTES (1) | | | |
| DETAILED INDEX & GENERAL NOTES | DI-1 | | 2 |
| TYPICAL SECTION SHEETS (4) | | | |
| TYPICAL SECTION - MILL AND OVERLAY | TS-1 | | 3 |
| TYPICAL SECTION - MILL AND OVERLAY | TS-2 | | 4 |
| TYPICAL SECTION - DIGOUT | TS-3 | | 5 |
| QUANTITY SHEETS (6) | | | |
| SUMMARY OF QUANTITIES | SQ-1 | | 6 |
| SUMMARY OF QUANTITIES | SQ-2 | | 7 |
| ESTIMATED QUANTITIES (SIGNS) | EQ-1 | | 8 |
| ESTIMATED QUANTITIES (SIGNS) | EQ-2 | | 9 |
| ESTIMATED QUANTITIES (SIGNS) | EQ-3 | | 10 |
| ESTIMATED QUANTITIES (SIGNS) | EQ-4 | | 11 |
| SPECIAL DESIGN SHEETS (6) | | | |
| DETAIL OF CONSTRUCTION SIGNING | DSC-1 | | 12 |
| DETAIL OF CONSTRUCTION SIGNING | DSC-2 | | 13 |
| DETAIL OF CONSTRUCTION SIGNING | DSC-3 | | 14 |
| SIGNING OF TWO-WAY TRAFFIC FOR NO PASSING ZONES | TC-1 | | 15 |
| SIGN SUPPORT HARDWARE - 2.0" SQUARE POST | TSS-1 | | 16 |
| RUMBLE STRIPES 2-LANE HIGHWAY (ASPHALT LANES, 2-FT ASPHALT SHOULDERS) | RS-1 | | 17 |
| STANDARD DRAWING- ROADWAY SHEETS (13) | | | |
| PAVEMENT MARKING DETAILS FOR 2-LANE AND 4-LANE DIVIDED HIGHWAYS | PM-1 | 6051 | |
| PAVEMENT MARKING LEGEND DETAILS | PM-6 | 6056 | |
| 2-WAY RAISED PAVEMENT MARKERS AT INTERSECTING ROADS (2-LANE) | PM-11 | 6061 | |
| STANDARD ROADSIDE SIGNS | SN-3 | 6303 | |
| STANDARD ROADSIDE SIGNS | SN-3A | 6304 | |
| STANDARD ROADSIDE SIGNS | SN-3B | 6305 | |
| TYPICAL GUARDRAIL DELINEATION | SN-8C | 6317 | |
| TRAFFIC CONTROL PLAN WITH FLAGGER (ONE-LANE CLOSURE OF TWO-WAY TRAFFIC) | TCP-1 | 6351 | |
| HIGHWAY SIGN AND BARRICADE DETAILS FOR CONSTRUCTION PROJECTS | TCP-8 | 6358 | |
| TRAFFIC CONTROL PLAN MOBILE OPERATIONS MULTILANE ROADS AND TWO-LANE ROADS | TCP-9 | 6359 | |
| TRAFFIC CONTROL PLANS UNEVEN PAVEMENT DETAILS | TCP-12 | 6362 | |
| TEMPORARY STRIPING FOR TRAFFIC CONTROL, 2-LANE AND 4-LANE DIVIDED HIGHWAYS | TCP-13 | 6363 | |
| TRAFFIC CONTROL DETAILS DRUM PLACEMENT AND SHOULDER CLOSURE | TCP-16 | 6366 | |

GENERAL NOTES:

- (1) THE LOCATION AND SPACING OF SIGNS, SHOWN ON THE TRAFFIC CONTROL PLANS, ARE APPROXIMATE AND MAY BE ADJUSTED AS NECESSARY TO FIT FIELD CONDITIONS.
- (2) ALL TRAFFIC CONTROL DEVICES ON THIS PROJECT SHALL COMPLY WITH PART VI OF THE MUTCD (LATEST EDITION).
- (3) ALL PLASTIC DRUMS SHALL HAVE A BALLASTING COLLAR MADE FROM RECYCLED TRUCK TIRES OR OTHER SUITABLE MATERIAL.
- (4) THE CONTRACTOR SHALL BE RESPONSIBLE FOR PROTECTING EXISTING STRUCTURES SUCH AS, BUT NOT LIMITED TO, PIPES, INLETS, APRONS, AND BRIDGES FROM DAMAGE WHICH MIGHT OCCUR DURING CONSTRUCTION. THE CONTRACTOR SHALL REPLACE OR REPAIR, AS DIRECTED BY THE ENGINEER, ANY STRUCTURES DAMAGED DURING THE LIFE OF THE CONTRACT. NO PAYMENT WILL BE MADE FOR REPLACEMENT OR REPAIR OF DAMAGED ITEMS.
- (5) FLUORESCENT ORANGE SHEETING SHALL BE USED ON ALL CONSTRUCTION AND TRAFFIC CONTROL SIGNS EXCEPT FOR THOSE DESIGNATED ON THE PLANS TO BE BLACK LEGEND AND BORDER ON WHITE BACKGROUND.
- (6) VEGETATIVE MATERIAL WILL BE REMOVED PRIOR TO PLACEMENT OF GRANULAR MATERIAL. THE COST OF WHICH SHALL BE ABSORBED IN OTHER BID ITEMS.
- (7) ROADWAY SIGNS THAT ARE IN CONFLICT WITH CONSTRUCTION OF THIS PROJECT SHALL BE REMOVED AND RELOCATED BY THE CONTRACTOR AS DIRECTED BY THE ENGINEER, THE COST OF WHICH SHALL BE ABSORBED IN OTHER ITEMS BID.
- (8) REMOVAL OF RAISED PAVEMENT MARKERS THAT ARE IN CONFLICT WITH REQUIRED CONSTRUCTION IS NOT CONSIDERED A SEPARATE PAY ITEM. COST TO BE ABSORBED IN OTHER ITEMS BID.
- (9) WHERE MILLING IS REQUIRED, THE CONTRACTOR SHALL PROVIDE OUTLETS IN THE EXISTING SHOULDERS AT SUFFICIENT INTERVALS TO PREVENT POOLING OR STANDING WATER ON THE MILLED SURFACE, THE COST OF WHICH SHALL BE ABSORBED IN OTHER ITEMS BID.
- (10) TEMPORARY STRIPING SHALL CONFORM TO FINISHED STRIPE SPECIFICATIONS FOR ALIGNMENT, NEATNESS, AND STRAIGHTNESS.
- (11) ERECTION DATES ARE TO BE LEGIBLY WRITTEN IN BOLD, BLACK MARKINGS ON THE BACK OF ALL PERMANENT SIGNS WITH A PERMANENT MARKING STICK THAT IS WATERPROOF, FADE RESISTANT, AND MARKS ON WET OR DRY SURFACES.
- (12) ALL ADDENDA TO THESE PLANS WILL BE POSTED TO WWW.MDOT.MS.GOV UNDER THE PROPOSAL ADDENDA COLUMN. BIDDERS ARE ADVISED THAT HARD COPIES OF ANY ADDENDA FOR THIS PROJECT WILL NOT BE MAILED. IT IS THE BIDDER'S RESPONSIBILITY TO CHECK AND SEE IF ANY ADDENDA HAVE BEEN POSTED FOR THIS PROJECT.
- (13) WHERE A PAPER JOINT IS REQUIRED, A TAPER SHALL BE PLACED IN ACCORDANCE WITH SECTION 904-NOTICE TO BIDDERS TITLED "TEMPORARY TRANSVERSE JOINTS".
- (14) GUARDRAIL PADS ARE TO BE CLEARED OF DEBRIS FOR POSITIVE DRAINAGE.

| | | |
|-----------------------------|-----------|----|
| PS & E PLANS-DATE: 05/19/23 | | |
| FMS CON. # 108918/301000 | | |
| REVISIONS | | |
| 5/19/2023 | SHEET NO. | BY |
| | | |
| | | |
| | | |
| | | |

PLAN SHEET

5/19/2023 12:29:42 PM PLANS.dgn