

STATE	PROJECT NUMBER	SHEET NO.
MISSISSIPPI	STBG-0858-00(016)	1

**GENERAL INDEX**

INCLUDED THIS PROJECT	BEGIN WITH SHEET
<input checked="" type="checkbox"/> ROADWAY	1
<input checked="" type="checkbox"/> PERMANENT SIGNS	1001
<input type="checkbox"/> TRAFFIC SIGNALS	2001
<input type="checkbox"/> ITS COMPONENTS	3001
<input type="checkbox"/> LIGHTING	4001
<input type="checkbox"/> (RESERVED)	5001
<input checked="" type="checkbox"/> ROADWAY STANDARD DWGS	6001
<input checked="" type="checkbox"/> BOX CULVERT STD. DRAWINGS (LRFD)	7001
<input type="checkbox"/> BOX CULVERT STD. DRAWINGS (STD. SPEC.)	7501
<input checked="" type="checkbox"/> BRIDGE	8001
<input checked="" type="checkbox"/> CROSS SECTIONS	9001

STATE OF MISSISSIPPI

MISSISSIPPI DEPARTMENT OF TRANSPORTATION

**PLAN AND PROFILE OF PROPOSED STATE HIGHWAY FEDERAL AID PROJECT .NO. STBG-0858-00(016)**

SR 346 OVER MUD CREEK AND DITCH (BRIDGE NOS. 3.6 & 3.8) PONTOTOC

FMS CON. NO. 107862/301000

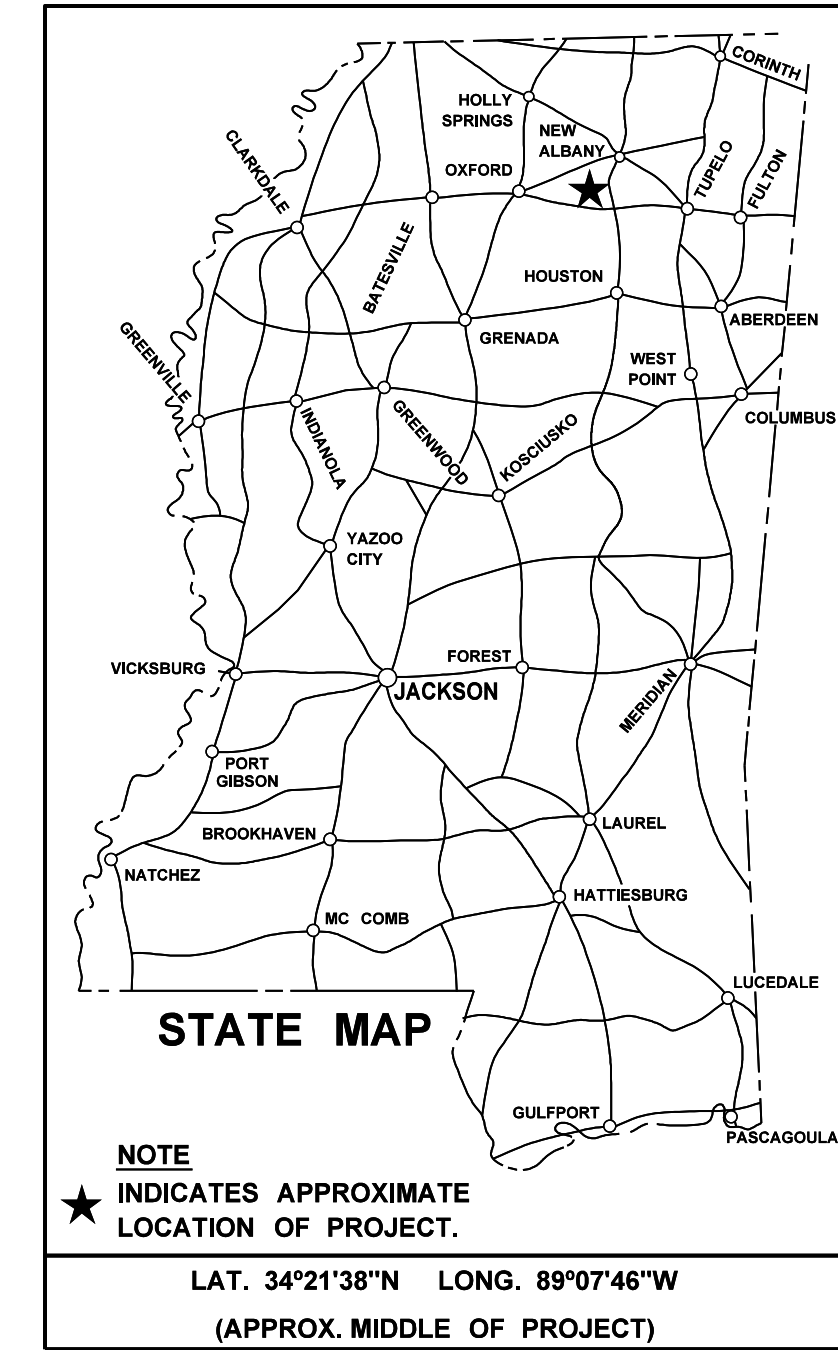

**SCALES**

PLAN	1 IN. = 100 FT.
PROFILE	HOR. 1 IN. = 100 FT.
	VERT. 1 IN. = 10 FT.
LAYOUT	1 IN. = 1000 FT.

**BRIDGE STRUCTURES REQ'D.**

**BRIDGE NO. 3.6**  
 STA. 202 + 41.92 - STA. 205 + 34.08  
 SPANS: 1@91'-1", 1@110'-0", 1@91'-1"  
 SKEW: 0°  
 LENGTH ALONG CL = 292'-2"

**BOX BRIDGES REQ'D.**

STA. 215 + 72  
 84.6' - DBL. 16'X8'  
 SKEW: 0°

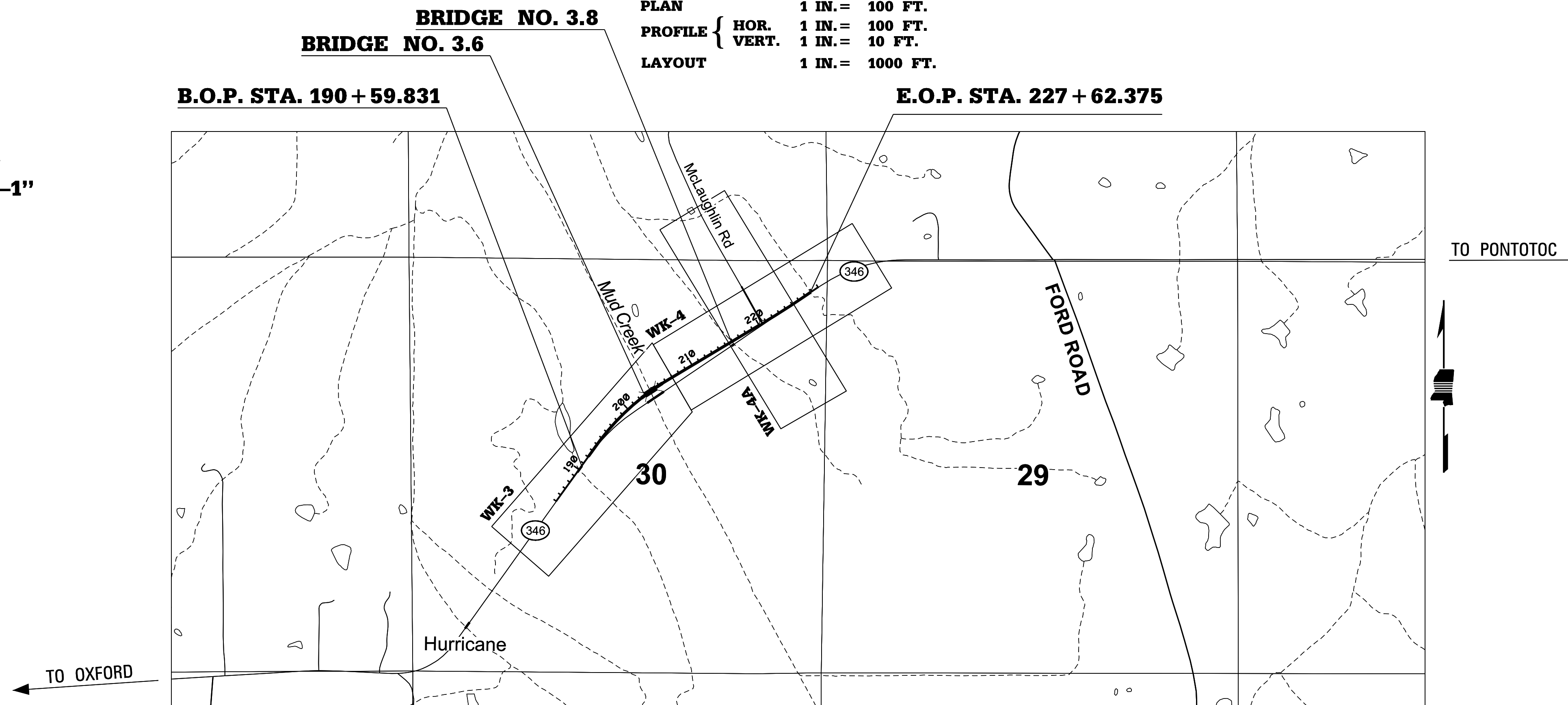

**DESIGN CONTROL**

60 MPH = V (SPEED DESIGN)

ADT (2024) = 2060 ; ADT (2044) = 2510  
 DHV = 270 ; D = 60 % T = 7 %

**PERMITS ACQUIRED BY MDOT**

WETLANDS AND WATERS PERMITS		
	WATERS	WETLANDS
NATIONWIDE #14	<input type="checkbox"/> N	<input type="checkbox"/> N
NATIONWIDE (OTHER)*	<input type="checkbox"/> Y	<input type="checkbox"/> Y
GENERAL*	<input type="checkbox"/> N	<input type="checkbox"/> N
INDIVIDUAL (404)*	<input type="checkbox"/> N	<input type="checkbox"/> N

**STORMWATER PERMIT**  Y

Y REQUIRED, CNDI SUBMITTED BY MDOT (DISTURBED AREA = 5 ACRES)  
 S REQUIRED, SCNDI TO BE SUBMITTED BY CONTRACTOR (1 TO 4.99 ACRES)  
 N NO STORMWATER PERMIT REQUIRED (<1 ACRE)

APPROVED BY: \_\_\_\_\_

**CONVENTIONAL SYMBOLS**

COUNTY LINE	-----
TOWN CORPORATION LINE	-----
SECTION LINE	-----
EXISTING ROAD OR TRAVELED WAY	-----
PROPOSED ROAD OR TRAVELED WAY	-----
RAILROAD	-----
SURVEY LINE	-----
BRIDGES	-----

**EQUATIONS**

STA. 225 + 85.406 BK =  
 STA. 225 + 67.780 AH = + 17.626

**LENGTH DATA**

LENGTH OF ROADWAY	3428.003	FT.	0.650	MI.
LENGTH OF BRIDGES	292.167	FT.	0.055	MI.
LENGTH OF PROJECT (NET)	3720.170	FT.	0.705	MI.
LENGTH OF EXCEPTIONS	0.000	FT.	0.000	MI.
LENGTH OF PROJECT (GROSS)	3720.170	FT.	0.705	MI.

**EXCEPTIONS**

NONE



ROADWAY

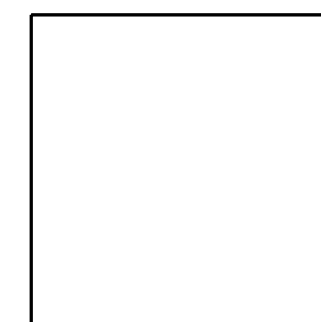

BRIDGE

P S & E DATE: 06/25/2024

APPROVED:	_____
DEPUTY EXECUTIVE DIRECTOR / CHIEF ENGINEER	_____
EXECUTIVE DIRECTOR	_____



6/24/2024 4:42:08 PM TITLE.DGN



STATE	PROJECT NO.
MISS.	STBG-0858-00(016)

DESCRIPTION OF SHEET	WKG. NO.	SH. NO.	DESCRIPTION OF SHEET	WKG. NO.	SH. NO.
TITLE SHEET (1)		1	PAVEMENT MARKING DETAIL SHEET (1)		
SUMMARY OF PLAN REVISION SHEET (1)			PAVEMENT MARKING DETAILS - SR 346	PMD-1	44
SUMMARY OF PLAN REVISIONS	SPR-1	2	REMOVAL PLAN SHEET (1)		
DETAILED INDEX & GENERAL NOTES (4)			REMOVAL PLAN SHEET - SR 346	RP-1	45
DETAILED INDEX	DI-1	3	SPECIAL DESIGN SHEETS (8)		
DETAILED INDEX	DI-2	4			
GENERAL NOTES	GN-1	5	RIGHT-OF-WAY COORDINATES - RIGHT-OF-WAY MARKERS	RWC-1	46
GENERAL NOTES	GN-2	6	RIGHT-OF-WAY COORDINATES - TEMPORARY EASEMENTS	RWC-2	47
			VEGETATION SCHEDULE - RURAL - GRADE & DRAIN AND/OR BRIDGES	VS-1	48
			EXCLUDING MS DELTA DISTRICT 1 OR 2		
TYPICAL SECTION SHEETS (3)			TRAFFIC SIGN SUPPORTS 2" PSST	TSS-1	49
TYPICAL SECTIONS - SR 346 - WIDENING & OVERLAY/NEW CONSTRUCTION	TS-1	7	BRIDGE END PAVEMENT WITH RAIL, OVERLAY, AND SLEEPER SLAB (NEW CONSTRUCTION)	SDBE-1	50
TYPICAL SECTIONS - LOCAL ROAD	TS-2	8	BRIDGE END REPAIR 37.5" BRIDGE END PAVEMENT RAIL	SDBER-1	51
TYPICAL SECTIONS - MISCELLANEOUS DETAILS	TS-3	9	PAVEMENT MARKING DETAILS FOR 2-LANE OR 4-LANE DIVIDED HIGHWAYS		
			RUMBLE STRIPES 2-LANE HIGHWAYS (ASPH. LANES, 2-FT ASPH. SHLD)	SDPM-1	52
			REVISIONS	SDRS-1	53
SUMMARY OF QUANTITY SHEETS (3)					
SUMMARY OF QUANTITIES	SQ-1	10			
SUMMARY OF QUANTITIES	SQ-2	11			
SUMMARY OF QUANTITIES	SQ-3	12			
ESTIMATED QUANTITIES SHEETS (12)			PERMANENT SIGNING SHEETS (1)		
ESTIMATED QUANTITIES - REMOVAL ITEMS	EQ-1	13			
ESTIMATED QUANTITIES - EARTHWORK ITEMS	EQ-2	14	PERMANENT SIGNING PLAN - SR 346	PSP-1	1001
ESTIMATED QUANTITIES - GRASSING & SOLID SOD ITEMS	EQ-3	15			
ESTIMATED QUANTITIES - PERMANENT & TEMPORARY EROSION CONTROL ITEMS	EQ-4	16			
ESTIMATED QUANTITIES - PAVING ITEMS	EQ-5	17			
ESTIMATED QUANTITIES - GUARDRAIL & BRIDGE END PAVEMENT ITEMS	EQ-6	18			
ESTIMATED QUANTITIES - DRIVEWAY ITEMS	EQ-7	19			
ESTIMATED QUANTITIES - DRAINAGE ITEMS	EQ-8	20			
ESTIMATED QUANTITIES - PAVEMENT MARKING ITEMS	EQ-9	21			
ESTIMATED QUANTITIES - TRAFFIC CONTROL ITEMS	EQ-10	22			
ESTIMATED QUANTITIES - PERMANENT SIGNS	EQ-11	23			
ESTIMATED QUANTITIES - TRAFFIC CONTROL SIGNS	EQ-12	24			
PLAN & PROFILE SHEETS (3)					
PLAN & PROFILE - SR 346	3	25			
PLAN & PROFILE - SR 346	4	26			
PLAN & PROFILE - SR 346 - LR 220+50 (MCLAUGHLIN ROAD)	4A	27			
EROSION CONTROL SHEETS (3)					
EROSION CONTROL PLAN - SR 346	ECP-3	28			
EROSION CONTROL PLAN RIPARIAN BUFFER - SR 346	ECP-RB-3	29			
EROSION CONTROL PLAN - SR 346	ECP-4	30			
DETAIL CONSTRUCTION SIGNS (1)					
DETAIL CONSTRUCTION SIGNS - SR 346	DCS-1	31			
TRAFFIC CONTROL PLAN SHEETS (12)					
TRAFFIC CONTROL PLAN - PHASE 1 - OVERVIEW	TC-1	32			
TRAFFIC CONTROL PLAN - PHASE 1	TC-2	33			
TRAFFIC CONTROL PLAN - PHASE 1	TC-3	34			
TRAFFIC CONTROL PLAN - PHASE 1	TC-4	35			
TRAFFIC CONTROL PLAN - PHASE 2 - OVERVIEW	TC-5	36			
TRAFFIC CONTROL PLAN - PHASE 2	TC-6	37			
TRAFFIC CONTROL PLAN - PHASE 2	TC-7	38			
TRAFFIC CONTROL PLAN - PHASE 2	TC-8	39			
TRAFFIC CONTROL PLAN - PHASE 3 - OVERVIEW	TC-9	40			
TRAFFIC CONTROL PLAN - PHASE 3	TC-10	41			
TRAFFIC CONTROL PLAN - CONNECTION AT BOP	TC-11	42			
TRAFFIC CONTROL PLAN - CONNECTION AT EOP	TC-12	43			

6/24/2024 4:42:10 PM DI.DGN



MISSISSIPPI DEPARTMENT OF TRANSPORTATION <b>DETAILED INDEX</b>	
PROJ. NO.: STBG-0858-00(016) COUNTY: PONTOTOC	
WORKING NUMBER <b>DI-1</b>	SHEET NUMBER <b>3</b>
FILE NAME: DI.dgn DESIGN TEAM: MENDROP CHECKED: DATE:	REVISION BY:



STATE	PROJECT NO.
MISS.	STBG-0858-00(016)

DESCRIPTION OF SHEET

WKG. NO. SH. NO.

STANDARD DRAWINGS - ROADWAY SHEETS (65)

PAVEMENT MARKING DETAILS FOR 2-LANE & 4-LANE DIVIDED ROADWAYS  
 2-WAY RAISED PAVEMENT MARKERS AT INTERSECTING ROADS (2 LANE)  
 RUMBLE STRIPES 2-LANES HIGHWAYS (ASPHALT LANES, 2-FT ASPHALT SHOULDERS)  
 TYPICAL TEMPORARY EROSION / SEDIMENT CONTROL APPLICATIONS  
 DETAILS OF SEDIMENT BARRIER APPLICATIONS  
 DETAILS OF SILT FENCE INSTALLATION  
 DITCH CHECK STRUCTURES, TYPICAL APPLICATIONS AND DETAILS  
 TEMPORARY EROSION, SEDIMENT AND WATER POLLUTION CONTROL MEASURES,  
 (SILT FENCE AND HAY BALE DITCH CHECKS)  
 DETAILS OF EROSION CONTROL WATTLE DITCH CHECK  
 DETAILS OF EROSION CONTROL SILT DIKE DITCH CHECK  
 ROCK DITCH CHECK  
 ROCK FILTER DAM  
 ROCK DITCH CHECK WITH SUMP EXCAVATION AND ROCK FILTER DAM  
 TYPICAL APPLICATIONS AND DETAILS FOR INLET PROTECTION  
 INLET PROTECTION DETAILS FOR SEDIMENT CONTROL STONE ON GRADES AND SAGS  
 INLET PROTECTION DETAILS OF WATTLES  
 INLET PROTECTION DETAILS OF MANUFACTURED INLET PROTECTION DEVICE  
 INLET PROTECTION DETAILS OF SANDBAGS  
 STABILIZED CONSTRUCTION ENTRANCE  
 FLOATING TURBIDITY CURTAIN  
 DETAILS OF EROSION CONTROL SANDBAG DITCH CHECK  
 SEDIMENT RETENTION BARRIER  
 DETAILS OF TYPICAL DITCH TREATMENTS  
 TYPICAL TEMPORARY EROSION CONTROL MEASURES (SLOPE DRAIN & TYPE A SILT BASIN)  
 SUPER SILT FENCE  
 EROSION CONTROL BLANKET  
 GUARDRAIL: "W" BEAM (WOOD POSTS)  
 GUARDRAIL: "W" BEAM (STEEL POSTS)  
 GUARDRAIL: BRIDGE END SECTION TYPE "I" (WOOD POSTS) (NEW CONSTRUCTION)  
 GUARDRAIL: BRIDGE END SECTION TYPE "I" (STEEL POSTS) (NEW CONSTRUCTION)  
 GUARDRAIL: TYPICAL INSTALLATION AT BRIDGE APPROACHES FOR 2-LANE, 2-WAY HIGHWAY  
 GUARDRAIL: RUB RAIL HARDWARE  
 GUARDRAIL: MISCELLANEOUS HARDWARE  
 STANDARD ROADSIDE SIGNS  
 STANDARD ROADSIDE SIGNS  
 STANDARD ROADSIDE SIGN ASSEMBLY AND INSTALLATION  
 STANDARD ROADSIDE SIGN ASSEMBLY AND INSTALLATION  
 STANDARD ROADSIDE SIGN ASSEMBLY AND INSTALLATION  
 BREAKAWAY SIGN SUPPORTS  
 BREAKAWAY SIGN SUPPORTS  
 TYPICAL INSTALLATION AND DETAILS OF DELINEATORS AND DISTANCE REFERENCE SIGNS  
 TYPICAL GUARDRAIL DELINEATION  
 SIGNING DETAILS FOR BRIDGE APPROACHES

PM-1 6051  
 PM-11 6061  
 RS-1 6064  
 ECD-1 6101  
 ECD-2 6102  
 ECD-3 6103  
 ECD-4 6104  
 ECD-5 6105  
  
 ECD-6 6106  
 ECD-7 6107  
 ECD-8 6108  
 ECD-9 6109  
 ECD-10 6110  
 ECD-11 6111  
 ECD-12 6112  
 ECD-13 6113  
 ECD-14 6114  
 ECD-15 6115  
 ECD-16 6116  
 ECD-20 6120  
 ECD-21 6121  
 ECD-22 6122  
 DT-1 6123  
 BAS-A 6129  
 SSF-1 6130  
 ECB-1 6131  
 GR-1 6201  
 GR-1B 6203  
 GR-2F 6210  
 GR-2G 6211  
 GR-4A 6215  
 GR-RR 6218  
 GR-HW 6221  
 SN-3A 6304  
 SN-3B 6305  
 SN-4 6306  
 SN-4A 6307  
 SN-4B 6308  
 SN-6A 6311  
 SN-6B 6312  
 SN-8 6314  
 SN-8C 6317  
 SN-9 6318

DESCRIPTION OF SHEET

STANDARD DRAWINGS - ROADWAY SHEETS (CONTINUED)

TRAFFIC CONTROL PLAN WITH FLAGGER (ONE-LANE CLOSURE OF TWO-WAY TRAFFIC)  
 SHORT DURATION CLOSING OF TWO-LANE TWO-WAY HIGHWAYS  
 HIGHWAY SIGN AND BARRICADE DETAILS FOR CONSTRUCTION PROJECTS  
 TRAFFIC CONTROL PLAN MOBILE OPERATIONS MULTILANE ROADS AND TWO-LANE ROADS  
 TRAFFIC CONTROL PLANS UNEVEN PAVEMENT DETAILS  
 TEMPORARY STRIPING FOR TRAFFIC CONTROL 2-LANE AND 4-LANE DIVIDED HIGHWAYS  
 LOCATION OF R16-3 SIGNS (SPEEDING FINES DOUBLED)  
 TRAFFIC CONTROL DETAILS - DRUM PLACEMENT AND SHOULDER CLOSURE  
 RIGHT-OF-WAY MARKER  
 RURAL DRIVEWAYS  
 TYPICAL GRADING TRANSITION BETWEEN CUTS AND FILLS  
 GUIDE BANK (SPUR DIKE): EARTH  
 SUPERELEVATION CASE 1 ROTATION ABOUT CENTERLINE  
 SUPERELEVATION RUNOFF CASE 1 ROTATION ABOUT CENTERLINE  
 MISCELLANEOUS DETAIL SHEET 1. STACKED PIPE JOINT 2. EXCAVATION AT GRADE POINTS  
 DETAILS OF PAVED FLUMES  
 PIPE CULVERT INSTALLATION  
 FLEXIBLE PIPE CULVERT INSTALLATION  
 FLARED END SECTION FOR CONCRETE PIPE  
 FLARED END SECTION FOR CONCRETE ARCH PIPE  
 DETAILS OF NORMAL UNDERDRAIN AND STORM DRAIN USED AS UNDERDRAIN  
 NORMAL UNDERDRAIN TYPE II  
  
 LRFD BOX CULVERT STANDARD DRAWINGS (7)  
  
 BASIC CULVERT DRAWINGS - COLLAR LOCATIONS - NORMAL AND SKEWED CULVERTS - GROUP I DIAGRAMS  
 BARREL DETAILS - DOUBLE CELL - HEIGHT 8 FT. - SPANS 16-32 FT.  
 BARREL DETAILS - DOUBLE CELL - HEIGHT 8 FT. - SPANS 16-32 FT.  
 BARREL DETAILS - DOUBLE CELL - HEIGHT 8 FT. - SPANS 16-32 FT.  
 WINGS WITH 3:1 SLOPE FOR BASIC CULVERT DRAWING - DOUBLE CELL - 15° SKEW DETAILS -  
 HEIGHT 8 FT. - SPANS 16-32 FT.  
 WINGS WITH 3:1 SLOPE FOR BASIC CULVERT DRAWING - DOUBLE CELL - 15° SKEW DETAILS -  
 HEIGHT 8 FT. - SPANS 16-32 FT.  
 WINGS WITH 3:1 SLOPE FOR BASIC CULVERT DRAWING - DOUBLE CELL - 15° SKEW DETAILS -  
 HEIGHT 8 FT. - SPANS 16-32 FT.  
  
 CROSS-SECTION SHEETS (22)  
  
 SR 346  
 LR220+55 (MCLAUGHLIN)  
  
 TOTAL SHEETS (EXCLUDING BRIDGE SHEETS) (148)

WKG. NO. SH. NO.

TCP-1 6351  
 TCP-6 6356  
 TCP-8 6358  
 TCP-9 6359  
 TCP-12 6362  
 TCP-13 6363  
 TCP-15 6365  
 TCP-16 6366  
 RW-1 6401  
 RD-1 6403  
 GT-1 6404  
 ED-1 6406  
 SE-2A 6408  
 SE-3A 6413  
 MDS-1 6425  
 PF-1 6426  
 PI-1 6501  
 PI-2 6502  
 FE-1 6530  
 FE-1A 6531  
 UD-1 6533  
 UD-2 6534

IBJL-1 7005  
 IBD-8 7118  
 IBD-8 7119  
 IBD-8 7120  
 IWD-8-3W-15 7149  
 IWD-8-3W-15 7150  
 IWD-8-3W-15 7151

9001-9022

6/24/2024 4:42:10 PM DI.DGN



MISSISSIPPI DEPARTMENT OF TRANSPORTATION <b>DETAILED INDEX</b>	
PROJ. NO.: STBG-0858-00(016) COUNTY: PONTOTOC	
FILE NAME: DI.dgn DESIGN TEAM: MENDROP CHECKED: _____ DATE: _____	WORKING NUMBER <b>DI-2</b> SHEET NUMBER <b>4</b>

STATE	PROJECT NO.
MISS.	STBG-0858-00(016)

**GENERAL NOTES**

**BRIDGES AND WALLS**

(1) THE BRIDGE DECKS SHALL BE GROOVED AND ALL BRIDGE JOINTS SHALL BE SEALED PRIOR TO OPENING THE BRIDGES TO TRAFFIC.

(2) STORAGE OF FLAMMABLE MATERIALS WILL NOT BE ALLOWED UNDER ANY BRIDGE STRUCTURES WITHOUT WRITTEN APPROVAL FROM THE PROJECT ENGINEER. SEE NOTICE TO BIDDERS ENTITLED "MATERIAL STORAGE UNDER BRIDGES" FOR MORE INFORMATION.

**DRAINAGE STRUCTURES**

(3) ALL PIPE JOINTS ARE TO BE WRAPPED IN 24-INCH WIDE TYPE V GEOTEXTILE FABRIC. ALL PICKUP HOLES SHALL BE PLUGGED AND COVERED WITH TYPE V GEOTEXTILE FABRIC, THE COST OF WHICH SHALL BE ABSORBED IN OTHER ITEMS BID.

(4) FULL COLLARS ARE TO BE USED AT ALL BOX CULVERT EXTENSIONS AND AT ALL BOX CULVERT CONSTRUCTION JOINTS. (SEE WK. NO. ICJ-1 FOR DETAILS)

(5) THE COST OF ANY COLLARS REQUIRED TO CONNECT CONCRETE FLARED END SECTIONS TO NON-CONCRETE PIPE SECTIONS SHALL BE ABSORBED IN THE COST FOR NON-CONCRETE PIPE.

(6) CURB AND GUTTER VERTICAL DIMENSIONS SHOWN IN THE DETAIL DRAWINGS ARE FOR A CURB IN THE "CATCH" CONFIGURATION AND SHALL BE CONSIDERED TO BE MINIMUM DIMENSIONS. THE DIMENSIONS MAY BE MODIFIED AS NECESSARY FOR "SPILL" CURB AND GUTTER, BUT SHALL NOT BE LESS THAN THE MINIMUM SHOWN.

(7) THE COST FOR REMOVAL OF ALL HEADWALLS AND WINGWALLS (PIPES, BOX CULVERTS, BOX BRIDGES) SHALL BE ABSORBED IN OTHER ITEMS BID.

(8) THE CONTRACTOR SHALL BE RESPONSIBLE FOR PROTECTING EXISTING STRUCTURES SUCH AS, BUT NOT LIMITED TO, PIPES, INLETS, APRONS, AND BRIDGES FROM DAMAGE WHICH MIGHT OCCUR DURING CONSTRUCTION. THE CONTRACTOR SHALL REPLACE OR REPAIR, AS DIRECTED BY THE ENGINEER, ANY STRUCTURES DAMAGED DURING THE LIFE OF THE CONTRACT. NO PAYMENT WILL BE MADE FOR REPLACEMENT OR REPAIR OF DAMAGED ITEMS.

**EARTHWORK**

(9) A SOIL PROFILE HAS BEEN PREPARED FOR THIS PROJECT USING SAMPLES TAKEN FROM HOLES AT THE LOCATIONS INDICATED IN THE TEST REPORTS. THIS SOIL PROFILE IS ON FILE IN THE DISTRICT AND CENTRAL CONSTRUCTION OFFICES AND IS AVAILABLE FOR EXAMINATION. THE DEPARTMENT DOES NOT GUARANTEE THAT THE MATERIALS AS SHOWN IN THE REPORTS ARE NECESSARILY TO BE FOUND OUTSIDE THE TEST HOLES.

(10) 25% SHRINKAGE FACTOR USED IN THE EARTHWORK CALCULATIONS IS FOR DESIGN ESTIMATING PURPOSES ONLY.

(11) VOIDS CREATED BY THE REMOVAL OF, BUT NOT LIMITED TO, POSTS, CONCRETE ANCHORS, AND FOOTINGS SHALL BE BACKFILLED AND TAMPED IN ACCORDANCE WITH SECTION 203 OF THE MISSISSIPPI STANDARD SPECIFICATIONS FOR ROAD AND BRIDGE CONSTRUCTION, THE COST OF WHICH WILL BE ABSORBED IN OTHER ITEMS BID.

(12) WORK ON STRUCTURES FOR THIS PROJECT REQUIRES EXCAVATION IN THE IMMEDIATE VICINITY OF TRAFFIC AND ADJACENT PROPERTIES. THEREFORE, THE RISK OF A FAILURE OCCURRING DURING EXCAVATION REQUIRES THAT EXTREME CAUTION BE EXERCISED. THE CONTRACTOR SHALL BE RESPONSIBLE FOR PLACING WHAT BRACING, SHORING, OR GROUND SUPPORT SYSTEM THAT IS DEEMED NECESSARY TO PREVENT A FAILURE AND PROTECT THE PERSONS WORKING NEAR THE EXCAVATION, THE PUBLIC THAT MAY BE ABOVE THE EXCAVATION, OR ANY STRUCTURES ADJACENT TO THE EXCAVATION. ALL COSTS FOR DESIGNING, DRAWING, AND CONSTRUCTING THE FACILITY SHALL BE INCLUDED IN THE PRICE BID FOR CONTRACT ITEMS.

(13) VEGETATIVE MATERIAL WILL BE REMOVED PRIOR TO PLACEMENT OF GRANULAR MATERIAL. THE COST OF WHICH SHALL BE ABSORBED IN OTHER ITEMS BID.

(14) THIN LAYERS OF ROCK ENCOUNTERED DURING EXCAVATION WILL BE PAID FOR AS UNCLASSIFIED EXCAVATION.

(15) PRIOR TO EARTHWORK OPERATIONS, THE EXISTING TOP 4" TOPSOIL IS TO BE STRIPPED AND STOCKPILED. AFTER THE GRADING OPERATIONS ARE COMPLETED, SAID TOPSOIL SHALL BE PLACED ON ALL AREAS THAT ARE NOT TO BE PAVED OR OTHERWISE PROTECTED, IN ACCORDANCE WITH SECTION 211 OF THE SPECIFICATIONS, OR THE VEGETATION SCHEDULE (SEE WK. SH. VS-1). EXISTING TOPSOIL AND ALL COSTS ASSOCIATED WITH STRIPPING, HAULING, STOCKPILING, AND PLACEMENT OF THE EXISTING TOPSOIL IS TO BE ABSORBED IN OTHER EARTHWORK ITEMS.

**GENERAL NOTES (CONT.)**

**ENVIRONMENTAL & CLEARING**

(16) NO TEMPORARY CULVERT STREAM CROSSINGS WILL BE ALLOWED.

(17) FOR CLEARING LIMITS ADJACENT TO THE STREAMS AT STATION(S) 202+43 - 205+33, SEE WORKING SHEET NUMBERS ECP-RB-3 THE CLEARING LIMITS SHOWN ON THESE SHEETS ARE ONLY FOR THE RIPARIAN BUFFER CLEARING. CLEARING AT OTHER LOCATIONS SHOULD STILL APPLY.

**EROSION CONTROL - TEMPORARY**

(18) WIRE FENCE BACKING WILL BE REQUIRED FOR ALL SILT FENCE. (SEE WK. NO. ECD-3)

(19) THE EROSION CONTROL DEVICES REFERENCED IN THESE PLANS ARE A MINIMUM REQUIREMENT. IT IS THE RESPONSIBILITY OF THE CONTRACTOR TO ENSURE THAT SILT DOES NOT LEAVE THE RIGHT OF WAY OR CONTAMINATE WATERS OF THE U.S. DURING CONSTRUCTION. THE CONTRACTOR SHALL SUBMIT AN EROSION CONTROL PLAN PRIOR TO COMMENCEMENT OF WORK AND MAINTAIN THE PLAN DURING CONSTRUCTION. ANY ADDITIONAL SILT BASINS NOT SHOWN IN THE PLANS SHALL BE INCLUDED IN THE CONTRACTOR'S EROSION CONTROL PLAN PRIOR TO SUBMITTING FOR APPROVAL.

(20) ALL ITEMS OF WORK ASSOCIATED WITH THE INSTALLATION OF A CONSTRUCTION ENTRANCE SHALL BE ABSORBED IN OTHER ITEMS OF WORK.

**PAVEMENT, BASE, AND SHOULDERS**

(21) THE CONTRACTOR SHALL REPAIR ANY DAMAGE TO THE PAVED OR UNPAVED SHOULDER THAT MIGHT OCCUR DURING CONSTRUCTION. ANY REPAIR TO SHOULDER WILL BE IN ACCORDANCE WITH THE APPLICABLE SECTIONS OF THE MISSISSIPPI STANDARD SPECIFICATIONS FOR ROAD AND BRIDGE CONSTRUCTION. NO PAYMENT WILL BE MADE FOR REPAIR OF DAMAGED SHOULDER.

(22) TEMPORARY PAVEMENT JOINTS (PAPER JOINTS) SHALL BE EMPLOYED AT ALL LOCATIONS REQUIRING TRAFFIC TO TRAVERSE AN UNEVEN PAVEMENT JOINT. PAPER JOINTS SHALL BE A MINIMUM OF 9 FEET IN LENGTH AND SHALL BE ADEQUATELY MAINTAINED.

(23) WHERE MILLING IS REQUIRED, THE CONTRACTOR SHALL PROVIDE OUTLETS IN THE EXISTING SHOULDERS AT SUFFICIENT INTERVALS TO PREVENT POOLING OR STANDING WATER ON THE MILLED SURFACE, THE COST OF WHICH SHALL BE ABSORBED IN OTHER ITEMS BID.

**NOTICE:**

THE NOTES CONTAINED HEREON ARE SPECIFIC TO THE SUBJECT PROJECT AND SHOULD BE REVIEWED IN DETAIL BY THE CONTRACTOR, PER SECTION 102.05 OF THE STANDARD SPECIFICATIONS, "THE BIDDER IS REQUIRED TO EXAMINE CAREFULLY THE SITE OF THE PROPOSED WORK, THE PROPOSAL, PLANS, STANDARD SPECIFICATIONS, SPECIAL PROVISIONS, NOTICES TO BIDDERS AND CONTRACT FORMS BEFORE SUBMITTING A PROPOSAL."



MISSISSIPPI DEPARTMENT OF TRANSPORTATION	
<b>GENERAL NOTES</b>	
PROJ. NO.: STBG-0858-00(016) COUNTY: PONTOTOC	
WORKING NUMBER <b>GN-1</b>	SHEET NUMBER <b>5</b>
FILE NAME: GN.dgn DESIGN TEAM: MENDROP CHECKED: DATE:	REVISION DATE

6/24/2024 4:42:10 PM DGN.DGN

STATE	PROJECT NO.
MISS.	STBG-0858-00(016)

**GENERAL NOTES**

**PLANS**

(24) IF COLORS ARE USED ON PLAN/PROFILE SHEETS, THEY ARE INTENDED TO VISUALLY EASE THE LOCATION OF ELEMENTS FOR USERS OF THESE DRAWINGS. ALTHOUGH THE INTENT IS TO CATEGORIZE EVERYTHING AS EITHER EXISTING OR PROPOSED, IT IS THE END USER'S RESPONSIBILITY TO ENSURE ALL ELEMENTS ARE INTERPRETED CORRECTLY, REGARDLESS OF COLOR.

(25) ALL ADDENDA TO THESE PLANS WILL BE POSTED TO WWW.MDOT.MS.GOV UNDER THE PROPOSAL ADDENDA COLUMN. BIDDERS ARE ADVISED THAT HARD COPIES OF ANY ADDENDA FOR THIS PROJECT WILL NOT BE MAILED. IT IS THE BIDDER'S RESPONSIBILITY TO CHECK AND SEE IF ANY ADDENDA HAVE BEEN POSTED FOR THIS PROJECT.

(26) SEE BRIDGE PLANS FOR DETAILED INDEX SHEET(S), ESTIMATED AND SUMMARY OF QUANTITY SHEETS, AND EROSION CONTROL SHEETS.

**ROADSIDE BARRIERS**

(27) ALL DIMENSIONS AND SPACINGS FOR BRIDGE RAIL CONNECTORS SHALL BE VERIFIED IN THE FIELD BY THE CONTRACTOR PRIOR TO FABRICATION.

**TRAFFIC CONTROL - PERMANENT**

(28) INSTALLATION DATES SHALL BE CLEARLY WRITTEN IN BOLD BLACK MARKINGS ON THE BACK BOTTOM HALF OF ALL SIGNS WITH A PERMANENT MARKING STICK THAT IS WATERPROOF, FADE RESISTANT AND MARKS ON WET OR DRY SURFACES.

(29) ALL POST, PIPE, AND I-BEAM LENGTHS IN THESE PLANS ARE ESTIMATES. POST LENGTHS FOR ALL SIGNS SHALL BE VERIFIED IN THE FIELD BY THE CONTRACTOR PRIOR TO FABRICATION.

(30) ALL EXISTING SIGNS WHICH ARE TO BE REMOVED AS A PART OF THIS PROJECT THAT ARE NOT IN CONFLICT WITH CONSTRUCTION SHALL REMAIN IN PLACE UNTIL NEW SIGNS ARE INSTALLED UNLESS NOTED OR DIRECTED OTHERWISE BY THE PROJECT ENGINEER. ROADWAY SIGNS THAT ARE IN CONFLICT WITH CONSTRUCTION SHALL BE REMOVED AND RELOCATED BY THE CONTRACTOR AS DIRECTED BY THE ENGINEER, THE COST OF WHICH SHALL BE ABSORBED IN OTHER ITEMS BID.

(31) DIRECT-APPLIED LEGEND, BORDER, AND/OR SHIELDS ARE TO BE USED ON ALL GUIDE SIGNS. DIGITALLY PRODUCED SIGN COPY, SHIELDS, LEGEND, SYMBOLS, OR IMAGES WILL NOT BE ALLOWED WITHOUT WRITTEN APPROVAL FROM MDOT'S PROJECT ENGINEER.

(32) ALL PERMANENT SIGNS SHALL CONFORM TO THE LATEST EDITION OF THE MANUAL ON UNIFORM TRAFFIC CONTROL DEVICES.

(33) ALL SIGN LOCATIONS SHALL BE APPROVED BY THE PROJECT ENGINEER PRIOR TO INSTALLATION.

(34) THE RETROREFLECTIVE SIGN SHEETING ON PERMANENT GROUND-MOUNTED SIGNS SHALL BE AS FOLLOWS: BROWN BACKGROUND SHEETING ON GUIDE SIGNS SHALL BE MINIMUM TYPE VIII; GREEN AND BLUE BACKGROUND SHEETING ON GUIDE SIGNS SHALL BE MINIMUM TYPE IX; ALL WHITE, YELLOW, FLUORESCENT YELLOW AND FLUORESCENT YELLOW/GREEN SHEETING SHALL BE TYPE XI. ALL SIGN SHEETING ON OVERHEAD SIGNS SHALL BE TYPE XI.

(35) ALL EXISTING SIGNS AND SUPPORTS REMOVED UNDER THIS PROJECT SHALL BECOME THE PROPERTY OF THE CONTRACTOR AND ARE NOT A SEPARATE PAY ITEM.

(36) ALL SIDE ROAD, STOP SIGN MOUNTED STREET NAME SIGNS TO BE SALVAGED AND STORED AT THE DIRECTION OF THE PROJECT ENGINEER FOR DELIVERY TO THE COUNTY (NOT A SEPARATE PAY ITEM).

(37) REMOVAL OF RAISED PAVEMENT MARKERS THAT ARE IN CONFLICT WITH REQUIRED CONSTRUCTION IS NOT CONSIDERED A SEPARATE PAY ITEM. COST TO BE ABSORBED IN OTHER ITEMS BID.

(38) REMOVAL OF OBJECT MARKERS IS NOT CONSIDERED A SEPARATE PAY ITEM, AND SHALL BE ABSORBED IN OTHER ITEMS BID.

**GENERAL NOTES (CONT.)**

**TRAFFIC CONTROL - TEMPORARY**

(39) THE LOCATION AND SPACING OF SIGNS, SHOWN ON THE TRAFFIC CONTROL PLANS, ARE APPROXIMATE AND MAY BE ADJUSTED AS NECESSARY TO FIT FIELD CONDITIONS.

(40) ALL TRAFFIC CONTROL DEVICES ON THIS PROJECT SHALL COMPLY WITH PART VI OF THE MUTCD (LATEST EDITION).

(41) ALL PLASTIC DRUMS SHALL HAVE A BALLASTING COLLAR MADE FROM RECYCLED TRUCK TIRES OR OTHER SUITABLE MATERIAL.

(42) FLUORESCENT ORANGE SHEETING SHALL BE USED ON ALL CONSTRUCTION AND TRAFFIC CONTROL SIGNS EXCEPT FOR THOSE DESIGNATED ON THE PLANS TO BE BLACK LEGEND AND BORDER ON WHITE BACKGROUND.

(43) THE CONTRACTOR SHALL COORDINATE WITH THE CONTRACTOR FROM ADJACENT PROJECT(S) IN IMPLEMENTING THE TRAFFIC CONTROL PLAN AS DIRECTED BY THE ENGINEER. ALL CONFLICTING SIGNS SHALL BE COVERED OR REMOVED AS DIRECTED BY THE ENGINEER.

(44) THE CONTRACTOR SHALL COVER OR REMOVE ANY TEMPORARY TRAFFIC CONTROL SIGNS SHOWN IN THE TRAFFIC CONTROL PLAN THAT DO NOT APPLY TO THE CURRENT PHASE.

(45) THE RETROREFLECTIVE SIGN SHEETING ON RIGID, TEMPORARY TRAFFIC CONTROL (ORANGE) SIGNS SHALL BE MINIMUM TYPE IX.

(46) TEMPORARY STRIPING SHALL CONFORM TO FINISHED STRIPE SPECIFICATIONS FOR ALIGNMENT, NEATNESS, AND STRAIGHTNESS.

**UTILITIES**

(47) UTILITIES ON THE DRAWINGS ARE SHOWN IN THEIR ORIGINAL LOCATION BASED UPON THE BEST INFORMATION AVAILABLE TO THE ENGINEER. UTILITIES THAT WERE FOUND TO BE IN CONFLICT WITH CONSTRUCTION HAVE BEEN RELOCATED. PERMITS ARE ON FILE WITH THE DEPARTMENT SHOWING THE APPROXIMATE LOCATION OF UTILITIES RELOCATED WITHIN THE RIGHT-OF-WAY. THE ENGINEER CAN NOT AND DOES NOT WARRANT THAT THIS INFORMATION IS COMPLETE OR ACCURATE. THE CONTRACTOR MUST COORDINATE DIRECTLY WITH THE INVOLVED UTILITY OWNERS TO HAVE UNDERGROUND UTILITY LINES FIELD LOCATED IN ADVANCE OF CONSTRUCTION.

- (48) LIST OF PUBLIC UTILITIES
  - A. MUD CREEK WATER ASSOCIATION
  - B. PONTOTOC ELECTRIC POWER ASSOCIATION
  - C. AT&T

**MISCELLANEOUS**

(49) SOME WORK IS REQUIRED OUTSIDE THE PROJECT LIMITS. NO ADDITIONAL COMPENSATION WILL BE MADE FOR SUCH WORK EXCEPT AS PROVIDED BY SPECIFIC PAY ITEMS INCLUDED IN THE PLANS.

(50) THE CONTRACTOR SHALL BE RESPONSIBLE FOR MAINTAINING AND RELOCATING MAIL BOXES AS NECESSARY TO MAINTAIN CONTINUOUS MAIL SERVICE THROUGHOUT THE LIFE OF THE PROJECT, THE COST OF WHICH SHALL BE ABSORBED IN OTHER ITEMS BID.

(51) THE CONTRACTOR IS RESPONSIBLE FOR FIELD-VERIFICATION OF EXISTING GRADES AND MAKING ADJUSTMENTS AS NECESSARY WITH THE APPROVAL OF THE PROJECT ENGINEER.

(52) THE CONTRACTOR SHALL COORDINATE AND CONDUCT WORK AT LOCAL ROADS AND DRIVEWAYS IN A MANNER SUCH THAT ACCESS IS NOT INTERRUPTED UNNECESSARILY. ACCESS SHALL BE PRESERVED IN THE BEST MANNER POSSIBLE. COORDINATION AND COMMUNICATION WITH LANDOWNERS MAY BE NECESSARY TO PREVENT INTERRUPTION OF DRIVEWAY ACCESS.

**NOTICE:**  
THE NOTES CONTAINED HEREON ARE SPECIFIC TO THE SUBJECT PROJECT AND SHOULD BE REVIEWED IN DETAIL BY THE CONTRACTOR, PER SECTION 102.05 OF THE STANDARD SPECIFICATIONS, "THE BIDDER IS REQUIRED TO EXAMINE CAREFULLY THE SITE OF THE PROPOSED WORK, THE PROPOSAL, PLANS, STANDARD SPECIFICATIONS, SPECIAL PROVISIONS, NOTICES TO BIDDERS AND CONTRACT FORMS BEFORE SUBMITTING A PROPOSAL."



MISSISSIPPI DEPARTMENT OF TRANSPORTATION	
<b>GENERAL NOTES</b>	
PROJ. NO.: STBG-0858-00(016) COUNTY: PONTOTOC	
WORKING NUMBER <b>GN-2</b>	SHEET NUMBER <b>6</b>
FILE NAME: GN.dgn DESIGN TEAM: MENDROP    CHECKED:    DATE:	REVISION DATE

6/24/2024 4:42:10 PM CN.DGN