

GENERAL INDEX

INCLUDED THIS PROJECT	BEGIN WITH SHEET
<input checked="" type="checkbox"/> ROADWAY.....	1
<input checked="" type="checkbox"/> PERMANENT SIGNS.....	1001
<input type="checkbox"/> TRAFFIC SIGNALS.....	2001
<input type="checkbox"/> ITS COMPONENTS.....	3001
<input type="checkbox"/> LIGHTING.....	4001
<input type="checkbox"/> (RESERVED).....	5001
<input checked="" type="checkbox"/> ROADWAY STD. DWGS.....	6001
<input type="checkbox"/> BOX CULVERT STD. DWGS (LRFD).....	7001
<input type="checkbox"/> BOX CULVERT STD. DWGS (STD. SPEC.)....	7501
<input type="checkbox"/> BRIDGE.....	8001
<input type="checkbox"/> CROSS SECTIONS.....	9001

**STATE OF MISSISSIPPI
MISSISSIPPI DEPARTMENT OF TRANSPORTATION**

**PLAN OF
PROPOSED STATE HIGHWAY
FEDERAL AID PROJECT NO. HSIP-0080-01(020)
FMS. CON NO.: 109129-301000**

**US 49 from WSF Tatum Blvd. to Sims Rd
FORREST COUNTY**

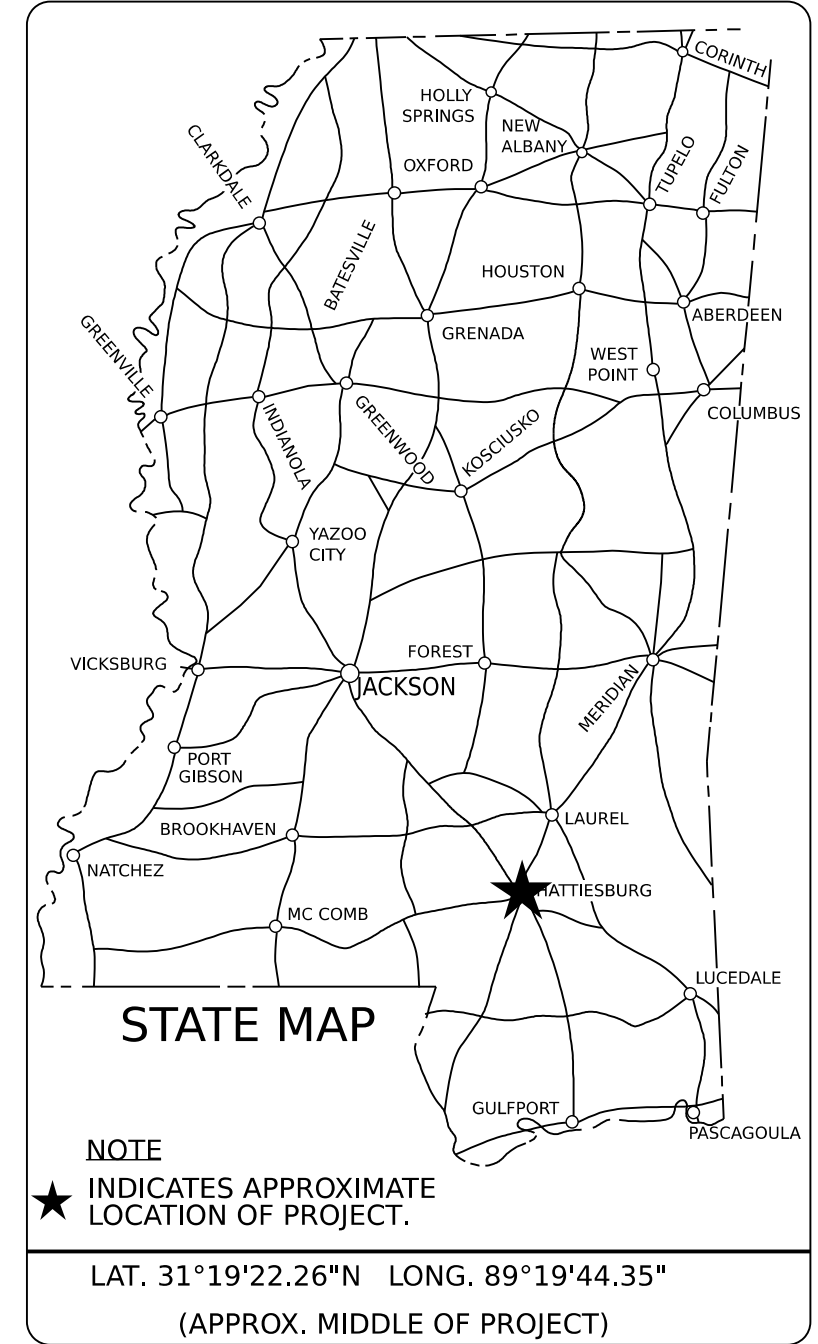

BRIDGE STRUCTURES REQ'D.
(NONE)

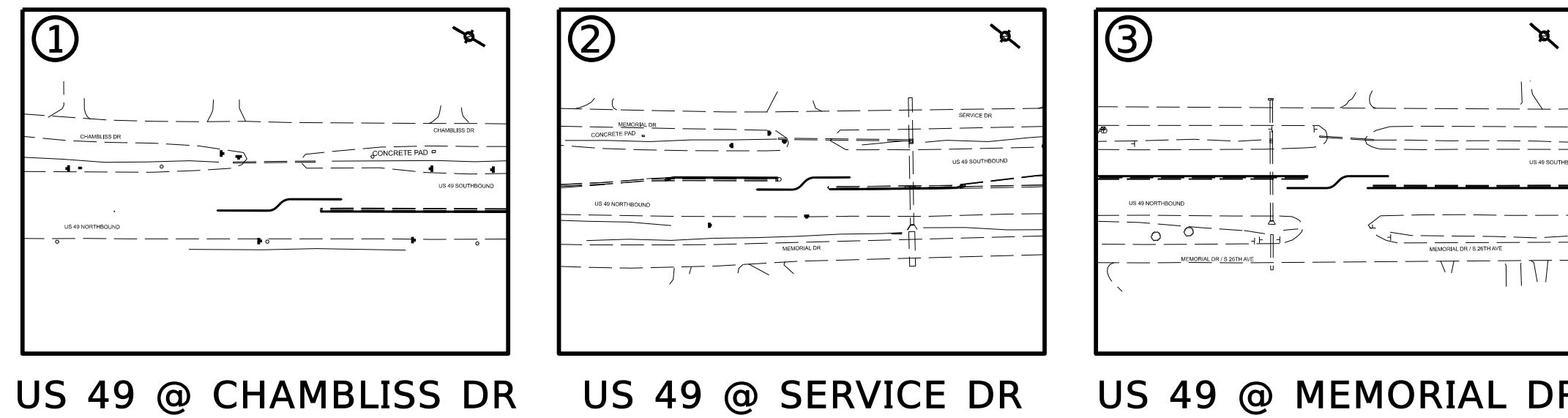

BOX BRIDGES REQ'D.
(NONE)

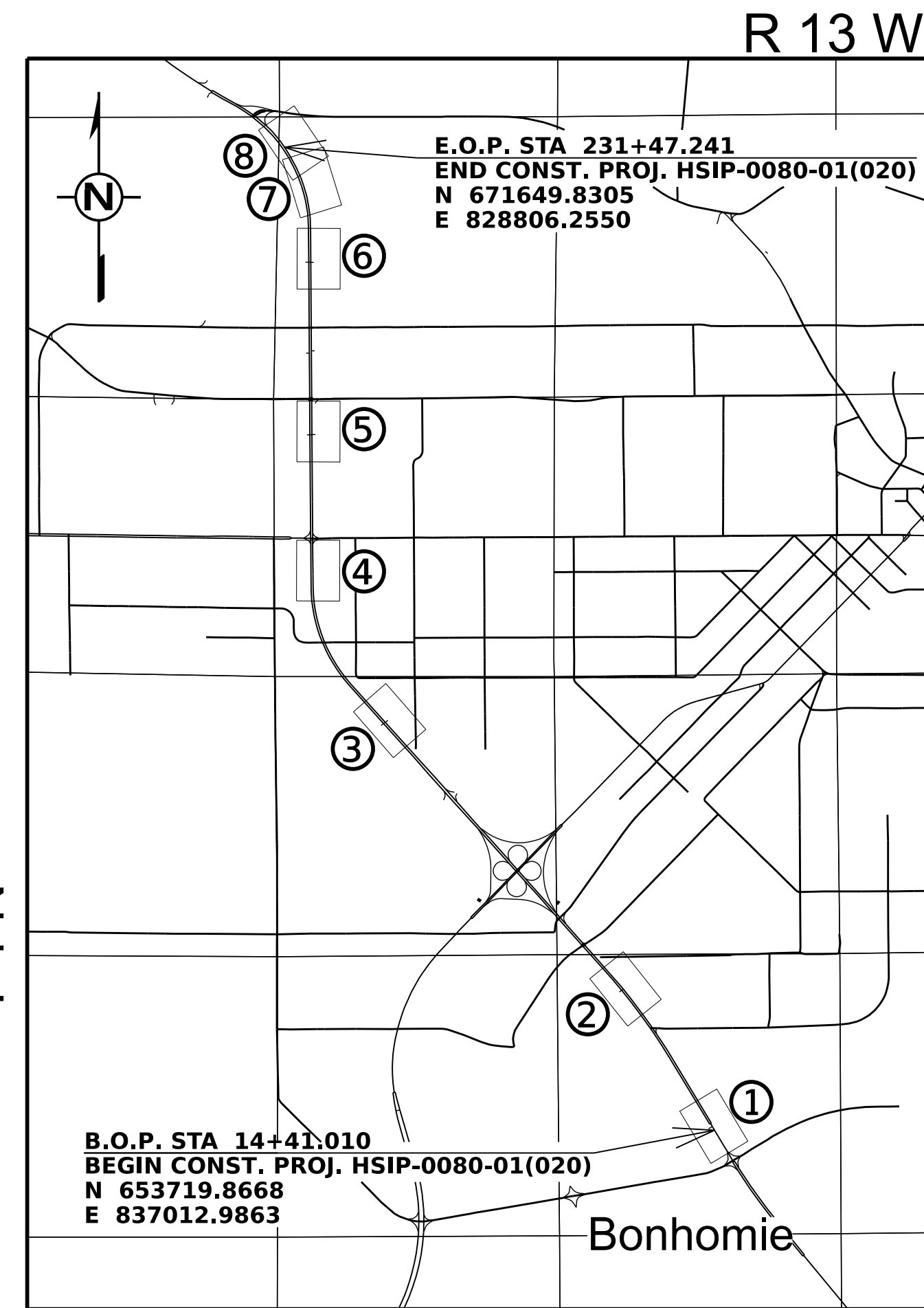
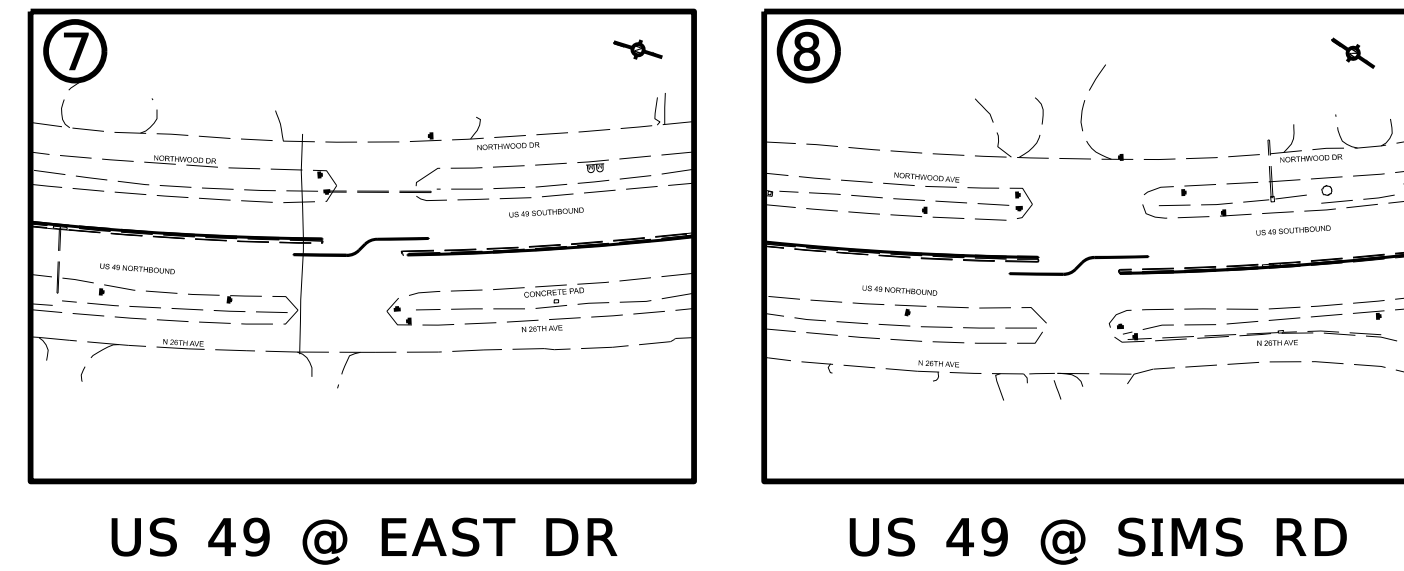
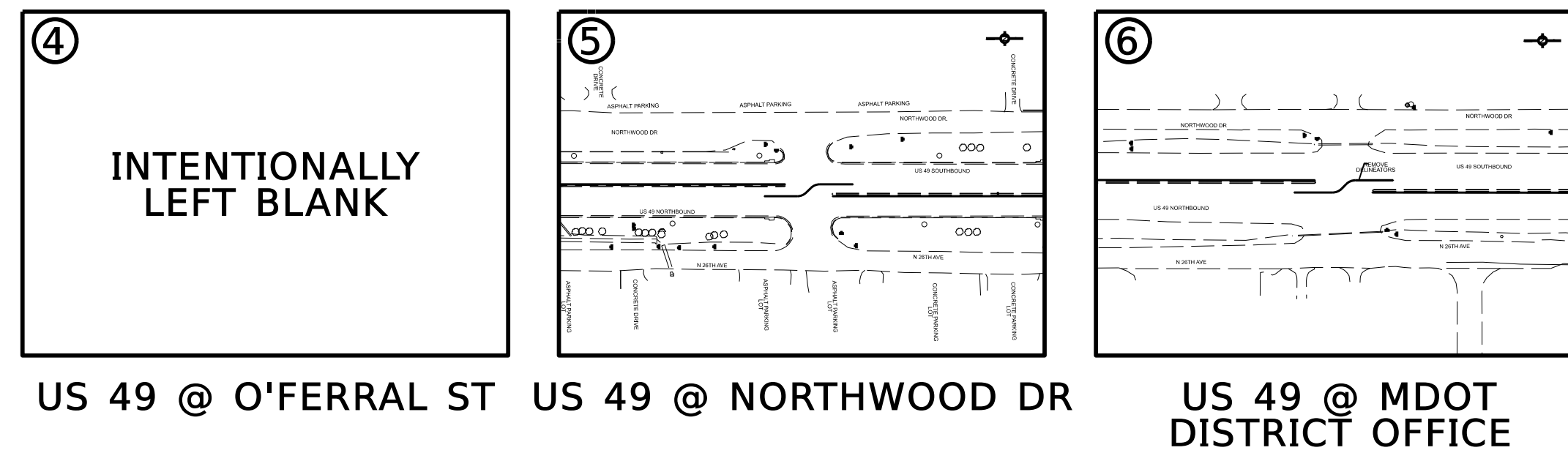

DESIGN CONTROL

45, 55 MPH = V (SPEED DESIGN)
ADT () = N/A : ADT () = N/A
DHV = N/A : D = N/A % T = N/A %

PERMITS ACQUIRED BY MDOT

WETLANDS AND WATERS PERMITS	
	WATERS WETLANDS
NATIONWIDE #14	<input checked="" type="checkbox"/> <input checked="" type="checkbox"/>
NATIONWIDE (OTHER)*	<input checked="" type="checkbox"/> <input checked="" type="checkbox"/>
GENERAL*	<input checked="" type="checkbox"/> <input checked="" type="checkbox"/>
INDIVIDUAL (404)*	<input checked="" type="checkbox"/> <input checked="" type="checkbox"/>
STORMWATER PERMIT <input checked="" type="checkbox"/>	
Y	REQUIRED, CNOI SUBMITTED BY MDOT (DISTURBED AREA=5.0 ACRES)
S	REQUIRED, SCNOI TO BE SUBMITTED BY CONTRACTOR (1 TO 4.99 ACRES)
N	NO STORMWATER PERMIT REQUIRED (<1 ACRE)
APPROVED BY: _____	

CONVENTIONAL SYMBOLS

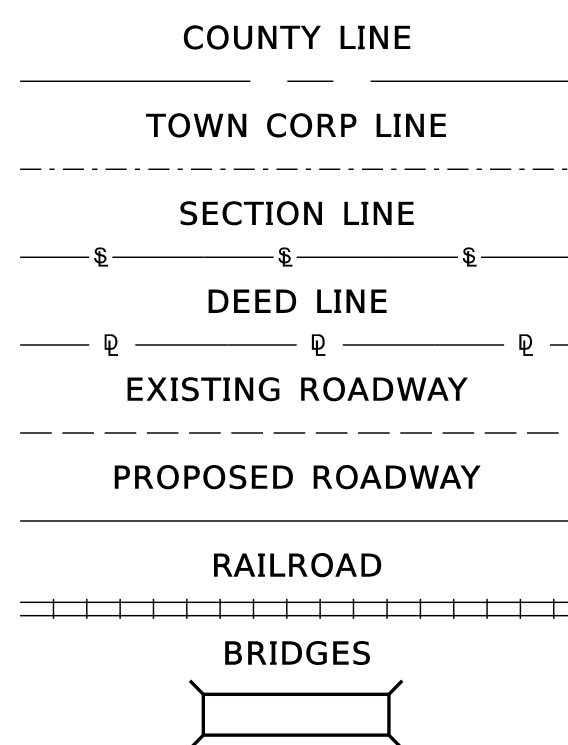

LENGTH DATA

LENGTH OF ROADWAY	21709	FT.	4.11	MI.
LENGTH OF BRIDGES		FT.		MI.
LENGTH OF PROJECT (NET)	4619	FT.	0.87	MI.
LENGTH OF EXCEPTIONS	17090	FT.	3.23	MI.
LENGTH OF PROJECT (GROSS)	21709	FT.	4.11	MI.

EQUATIONS

(NONE)

SCALES

PLAN 1 IN. = 40 FT. / 1 IN. = 20 FT.
FORM GRADE 1 IN. = 10 FT.
PROFILE { HOR. VERT. N/A N/A
LAYOUT 1 IN. = 300 FT.
1 IN. = 1 MILE

EXCEPTIONS

(NONE)

DESIGNED BY: ARCADIS WA No. ARC-TRD 2022-02

CONSTRUCTION PROJECT DATA

EXTERNAL PROJECT NUMBER	HSIP-0080-01(020)
FMS & DETAIL	109129/301000

P S & E DATE: 7/17/24

APPROVED:

DEPUTY EXECUTIVE DIRECTOR / CHIEF ENGINEER

EXECUTIVE DIRECTOR

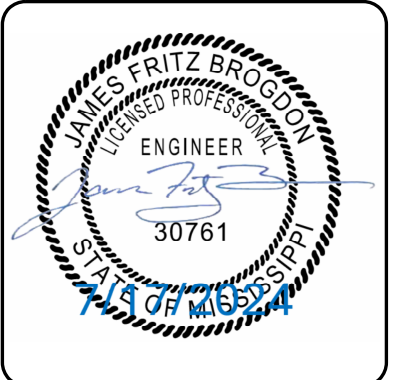

DESIGNED BY: MDB
 DETAILED BY: SEH
 CHECKED BY: JFB
 DATE: 07-17-2024

FMS CON: 109129/301000
 PROJECT NO.: HSIP-0080-01(020)
 COUNTY: FORREST

DETAIL INDEX

WK. NO.
DI-1
 SHEET NO.
2

DESCRIPTION OF SHEET

WK. NO. SH. NO.

DESCRIPTION OF SHEET

WK. NO. SH. NO.

TITLE SHEET (1)		1	
DETAIL INDEX & GENERAL NOTES (2)			
DETAIL INDEX	DI- 1	2	
GENERAL NOTES	GN- 1	3	
TYPICAL SECTION SHEETS (4)			
TYPICAL SECTION - US 49 @ CHAMBLISS DR	TS- 1	4	
TYPICAL SECTION - US 49 @ SERVICE DR, MEMORIAL DR / S 26TH AVE, NORTHWOOD DR, EAST DR, SIMS RD	TS- 2	5	
TYPICAL SECTION - US 49 @ O'FERRAL ST (INTENTIONALLY LEFT BLANK)	TS- 3	6	
TYPICAL SECTION - US 49 @ DISTRICT OFFICE	TS- 4	7	
SPECIAL DETAIL SHEET (2)			
SPECIAL CURB AND MEDIAN TRANSITION DETAILS	MD- 1	8	
EXISTING DRAINAGE STRUCTURE MODIFICATION DETAILS	MD- 2	9	
QUANTITY SHEETS (4)			
SUMMARY OF QUANTITIES	SQ- 1	10	
SUMMARY OF QUANTITIES	SQ- 2	11	
ESTIMATED QUANTITIES	EQ- 1	12	
ESTIMATED QUANTITIES	EQ- 2	13	
PLAN SHEETS (8)			
US 49 @ CHAMBLISS DR	WK- 3	14	
US 49 @ SERVICE DR	WK- 4	15	
US 49 @ MEMORIAL DR / S 26TH AVE	WK- 5	16	
US 49 @ O'FERRAL ST (INTENTIONALLY LEFT BLANK)	WK- 6	17	
US 49 @ NORTHWOOD DR / N 26TH AVE	WK- 7	18	
US 49 @ MDOT DISTRICT OFFICE	WK- 8	19	
US 49 @ EAST DR	WK- 9	20	
US 49 @ SIMS RD	WK- 10	21	
INTERSECTION DETAILS (8)			
INTERSECTION DETAILS - US 49 @ CHAMBLISS DR	ID- 1	22	
INTERSECTION DETAILS - US 49 @ SERVICE DR	ID- 2	23	
INTERSECTION DETAILS - US 49 @ MEMORIAL DR / S 26TH AVE	ID- 3	24	
INTERSECTION DETAILS - US 49 @ O'FERRAL ST (INTENTIONALLY LEFT BLANK)	ID- 4	25	
INTERSECTION DETAILS - US 49 @ NORTHWOOD DR / N 26TH AVE	ID- 5	26	
INTERSECTION DETAILS - US 49 @ MDOT DISTRICT OFFICE	ID- 6	27	
INTERSECTION DETAILS - US 49 @ EAST DR	ID- 7	28	
INTERSECTION DETAILS - US 49 @ SIMS RD	ID- 8	29	
FORM GRADE (13)			
FORM GRADE - US 49 @ CHAMBLISS DR	FG- 1	30	
FORM GRADE - US 49 @ SERVICE DR	FG- 2	31	
FORM GRADE - US 49 @ MEMORIAL DR / S 26TH AVE	FG- 3A	32	
FORM GRADE - US 49 @ MEMORIAL DR / S 26TH AVE	FG- 3B	33	
FORM GRADE - US 49 @ O'FERRAL ST (INTENTIONALLY LEFT BLANK)	FG- 4	34	
FORM GRADE - US 49 @ NORTHWOOD DR / N 26TH AVE	FG- 5A	35	
FORM GRADE - US 49 @ NORTHWOOD DR / N 26TH AVE	FG- 5B	36	
FORM GRADE - US 49 @ MDOT DISTRICT OFFICE	FG- 6A	37	
FORM GRADE - US 49 @ MDOT DISTRICT OFFICE	FG- 6B	38	
FORM GRADE - US 49 @ EAST DR	FG- 7A	39	
FORM GRADE - US 49 @ EAST DR	FG- 7B	40	
FORM GRADE - US 49 @ SIMS RD	FG- 8A	41	
FORM GRADE - US 49 @ SIMS RD	FG- 8B	42	

SPECIAL DESIGN SHEETS (4)			
DETAIL OF CONSTRUCTION SIGNS			DCS- 1 43
DETAIL OF CONSTRUCTION SIGNS			DCS- 2 44
DETAIL OF CONSTRUCTION SIGNS			DCS- 3 45
SIGN SUPPORT HARDWARE			TSS- 2 46
SIGNING AND PAVEMENT MARKING DETAIL SHEETS (8)			
SIGNING AND PAVEMENT MARKING DETAIL - US 49 @ CHAMBLISS DR			SPMD- 1 1001
SIGNING AND PAVEMENT MARKING DETAIL - US 49 @ SERVICE DR			SPMD- 2 1002
SIGNING AND PAVEMENT MARKING DETAIL - US 49 @ MEMORIAL DR / S 26TH AVE			SPMD- 3 1003
SIGNING AND PAVEMENT MARKING DETAIL - US 49 @ O'FERRAL ST (INTENTIONALLY LEFT BLANK)			SPMD- 4 1004
SIGNING AND PAVEMENT MARKING DETAIL - US 49 @ NORTHWOOD DR / N 26TH AVE			SPMD- 5 1005
SIGNING AND PAVEMENT MARKING DETAIL - US 49 @ MDOT DISTRICT OFFICE			SPMD- 6 1006
SIGNING AND PAVEMENT MARKING DETAIL - US 49 @ EAST DR			SPMD- 7 1007
SIGNING AND PAVEMENT MARKING DETAIL - US 49 @ SIMS RD			SPMD- 8 1008
STANDARD DRAWINGS - ROADWAY SHEETS (17)			
PAVEMENT MARKING DETAILS FOR 2- LANE & 4- LANE DIVIDED ROADWAYS			PM- 1 6051
PAVEMENT MARKING DETAILS FOR 3, 4 & 5- LANE UNDIVIDED ROADWAYS			PM- 2 6052
PAVEMENT MARKING LEGEND DETAILS			PM- 6 6056
TYPICAL PAVEMENT MARKING DETAIL FOR MEDIAN CROSSOVERS			PM- 9 6059
2- WAY RAISED PAVEMENT MARKERS AT INTERSECTING ROADS (4- LANE)			PM- 12 6062
TYPICAL APPLICATIONS & DETAILS FOR INLET CONSTRUCTION			ECD- 11 6111
INLET PROTECTION DETAILS FOR WATTLES			ECD- 13 6113
INLET PROTECTION DETAILS OF MANUFACTURED INLET PROTECTION DEVICE			ECD- 14 6114
INLET PROTECTION DETAILS OF SANDBAGS			ECD- 15 6115
STANDARD ROADSIDE SIGNS			SN- 3A 6304
STANDARD ROADSIDE SIGN ASSEMBLY AND INSTALLATION			SN- 4 6306
STANDARD ROADSIDE SIGN ASSEMBLY AND INSTALLATION			SN- 4A 6307
STANDARD ROADSIDE SIGN ASSEMBLY AND INSTALLATION			SN- 4B 6308
TRAFFIC CONTROL PLAN FOR POSTED SPEED LIMIT LESS THAN 65 MPH (4- LANE: MEDIAN LANE OR OUTSIDE LANE CLOSURE) (WORK DAY ONLY)			TCP- 2 6352
HIGHWAY SIGN AND BARRICADE DETAILS FOR CONSTRUCTION PROJECTS			TCP- 8 6358
TEMPORARY STRIPING FOR TRAFFIC CONTROL 2- LANE AND 4- LANE DIVIDED HIGHWAYS			TCP- 13 6363
TEMPORARY STRIPING FOR TRAFFIC CONTROL 4- LANE AND 5- LANE UNDIVIDED ROADWAYS			TCP- 14 6364
TOTAL SHEETS (71)			



PS & E PLANS- 7/17/24		
FMS CON. # 109129/301000		
REVISIONS		
DATE	SHEET NO.	BY

PLAN SHEET

3:42:22 PM Di.dgn

DATE

GENERAL NOTES

DRAINAGE STRUCTURES

- (1) THE CONTRACTOR SHALL BE RESPONSIBLE FOR PROTECTING EXISTING STRUCTURES SUCH AS, BUT NOT LIMITED TO, PIPES, INLETS, APRONS, AND BRIDGES FROM DAMAGE WHICH MIGHT OCCUR DURING CONSTRUCTION. THE CONTRACTOR SHALL REPLACE OR REPAIR, AS DIRECTED BY THE ENGINEER, ANY STRUCTURES DAMAGED DURING THE LIFE OF THE CONTRACT. NO PAYMENT WILL BE MADE FOR REPLACEMENT OR REPAIR OF DAMAGED ITEMS.

EARTHWORK

- (2) VOIDS CREATED BY THE REMOVAL OF, BUT NOT LIMITED TO, POSTS, CONCRETE ANCHORS, AND FOOTINGS SHALL BE BACKFILLED AND TAMPED IN ACCORDANCE WITH SECTION 203 OF **THE MISSISSIPPI STANDARD SPECIFICATIONS FOR ROAD AND BRIDGE CONSTRUCTION**, THE COST OF WHICH WILL BE ABSORBED IN OTHER ITEMS BID.
- (3) SMALL AMOUNTS OF EXCAVATION MAY BE NECESSARY AT SOME OF THE SITES. THIS MATERIAL MAY BE USED AS E.S.F.E. MATERIAL AND WILL BE PAID FOR AND WILL BE ABSORBED INTO OTHER PAY ITEMS. NO E.S.F.E. MATERIAL SHALL BE REMOVED FROM THE PROJECT WITHOUT THE APPROVAL OF THE ENGINEER.

EROSION CONTROL - TEMPORARY

- (4) THE CONTRACTOR SHALL SUBMIT AN EROSION CONTROL PLAN PRIOR TO COMMENCEMENT OF WORK AND MAINTAIN THE PLAN DURING CONSTRUCTION. ANY ADDITIONAL SILT BASINS NOT SHOWN IN THE PLANS SHALL BE INCLUDED IN THE CONTRACTOR'S EROSION CONTROL PLAN PRIOR TO SUBMITTING FOR APPROVAL.

PAVEMENT, BASE, AND SHOULDERS

- (5) THE CONTRACTOR SHALL REPAIR ANY DAMAGE TO EXISTING LANE PAVEMENT AND/OR PAVED OR UNPAVED SHOULDER THAT MIGHT OCCUR DURING CONSTRUCTION. ANY REPAIR TO SHOULDER WILL BE IN ACCORDANCE WITH THE APPLICABLE SECTIONS OF **THE MISSISSIPPI STANDARD SPECIFICATIONS FOR ROAD AND BRIDGE CONSTRUCTION**. NO PAYMENT WILL BE MADE FOR REPAIR OF DAMAGED EXISTING LANE PAVEMENT AND/OR SHOULDER.
- (6) TEMPORARY PAVEMENT JOINTS (PAPER JOINTS) SHALL BE EMPLOYED AT ALL LOCATIONS REQUIRING TRAFFIC TO TRAVERSE AN UNEV PAVEMENT JOINT. PAPER JOINTS SHALL BE A MINIMUM OF OF 9 FEET IN LENGTH AND SHALL BE ADEQUATELY MAINTAINED.
- (7) WHERE MILLING IS REQUIRED, THE CONTRACTOR SHALL PROVIDE OUTLETS IN THE EXISTING SHOULDERS AT SUFFICIENT INTERVALS TO PREVENT POOLING OR STANDING WATER ON THE MILLED SURFACE, THE COST OF WHICH SHALL BE ABSORBED IN OTHER ITEMS BID.

PLANS

- (8) IF COLORS ARE USED ON PLAN/PROFILE SHEETS, THEY ARE INTENDED TO VISUALLY EASE THE LOCATION OF ELEMENTS FOR USERS OF THESE DRAWINGS. ALTHOUGH THE INTENT IS TO CATEGORIZE EVERYTHING AS EITHER EXISTING OR PROPOSED, IT IS THE END USER'S RESPONSIBILITY TO ENSURE ALL ELEMENTS ARE INTERPRETED CORRECTLY, REGARDLESS OF COLOR.
- (9) ALL ADDENDA TO THESE PLANS WILL BE POSTED TO WWW.MDOT.MS.GOV UNDER THE PROPOSAL ADDENDA COLUMN. BIDDERS ARE ADVISED THAT HARD COPIES OF ANY ADDENDA FOR THIS PROJECT WILL NOT BE MAILED. IT IS THE BIDDER'S RESPONSIBILITY TO CHECK AND SEE IF ANY ADDENDA HAVE BEEN POSTED FOR THIS PROJECT.

TRAFFIC CONTROL - PERMANENT

- (10) INSTALLATION DATES SHALL BE CLEARLY WRITTEN IN BOLD BLACK MARKINGS ON THE BACK BOTTOM HALF OF ALL SIGNS WITH A PERMANENT MARKING STICK THAT IS WATERPROOF, FADE RESISTANT AND MARKS ON WET OR DRY SURFACES.
- (11) ALL POST, PIPE, AND I-BEAM LENGTHS IN THESE PLANS ARE ESTIMATES. POST LENGTHS FOR ALL SIGNS SHALL BE VERIFIED IN THE FIELD BY THE CONTRACTOR PRIOR TO FABRICATION.
- (12) ALL EXISTING SIGNS WHICH ARE TO BE REMOVED AS A PART OF THIS PROJECT THAT ARE NOT IN CONFLICT WITH CONSTRUCTION SHALL REMAIN IN PLACE UNTIL NEW SIGNS ARE INSTALLED UNLESS NOTED OR DIRECTED OTHERWISE BY THE PROJECT ENGINEER. ROADWAY SIGNS THAT ARE IN CONFLICT WITH CONSTRUCTION SHALL BE REMOVED AND RELOCATED BY THE CONTRACTOR AS DIRECTED BY THE ENGINEER, THE COST OF WHICH SHALL BE ABSORBED IN OTHER ITEMS BID.
- (13) DIRECT-APPLIED LEGEND, BORDER, AND/OR SHIELDS ARE TO BE USED ON ALL SIGNS. DIGITALLY PRODUCED SIGN COPY, SHIELDS, LEGEND, SYMBOLS, OR IMAGES WILL NOT BE ALLOWED WITHOUT WRITTEN APPROVAL FROM MDOT'S PROJECT ENGINEER.
- (14) ALL PERMANENT SIGNS SHALL CONFORM TO THE LATEST EDITION OF THE MANUAL ON UNIFORM TRAFFIC CONTROL DEVICES.
- (15) ALL SIGN LOCATIONS SHALL BE APPROVED BY THE PROJECT ENGINEER PRIOR TO INSTALLATION.

GENERAL NOTES (CONT.)

- (16) THE RETROREFLECTIVE SIGN SHEETING ON PERMANENT GROUND-MOUNTED SIGNS SHALL BE AS FOLLOWS: BROWN BACKGROUND SHEETING ON GUIDE SIGNS SHALL BE MINIMUM TYPE VIII; GREEN AND BLUE BACKGROUND SHEETING ON GUIDE SIGNS SHALL BE MINIMUM TYPE IX; ALL WHITE, YELLOW, FLUORESCENT YELLOW AND FLUORESCENT YELLOW/GREEN SHEETING SHALL BE TYPE XI. ALL SIGN SHEETING ON OVERHEAD SIGNS SHALL BE TYPE XI.
- (17) ALL EXISTING SIGNS AND SUPPORTS REMOVED UNDER THIS PROJECT SHALL BECOME THE PROPERTY OF THE CONTRACTOR AND ARE NOT A SEPARATE PAY ITEM.
- (18) ALL SIDE ROAD, STOP SIGN MOUNTED STREET NAME SIGNS TO BE SALVAGED AND STORED AT THE DIRECTION OF THE PROJECT ENGINEER FOR DELIVERY TO THE CITY (NOT A SEPARATE PAY ITEM).
- (19) REMOVAL OF RAISED PAVEMENT MARKERS THAT ARE IN CONFLICT WITH REQUIRED CONSTRUCTION IS NOT CONSIDERED A SEPARATE PAY ITEM. COST TO BE ABSORBED IN OTHER ITEMS BID.

TRAFFIC CONTROL - TEMPORARY

- (20) THE LOCATION AND SPACING OF SIGNS, SHOWN ON THE TRAFFIC CONTROL PLANS, ARE APPROXIMATE AND MAY BE ADJUSTED AS NECESSARY TO FIT FIELD CONDITIONS.
- (21) ALL TRAFFIC CONTROL DEVICES ON THIS PROJECT SHALL COMPLY WITH PART VI OF THE **MUTCD** (LATEST EDITION).
- (22) ALL PLASTIC DRUMS SHALL HAVE A BALLASTING COLLAR MADE FROM RECYCLED TRUCK TIRES OR OTHER SUITABLE MATERIAL.
- (23) FLUORESCENT ORANGE SHEETING SHALL BE USED ON ALL CONSTRUCTION AND TRAFFIC CONTROL SIGNS EXCEPT FOR THOSE DESIGNATED ON THE PLANS TO BE BLACK LEGEND AND BORDER ON WHITE BACKGROUND.
- (24) THE CONTRACTOR SHALL COORDINATE WITH THE CONTRACTOR FROM ADJACENT PROJECT(S) IN IMPLEMENTING THE TRAFFIC CONTROL PLAN AS DIRECTED BY THE ENGINEER. ALL CONFLICTING SIGNS SHALL BE COVERED OR REMOVED AS DIRECTED BY THE ENGINEER.
- (25) THE CONTRACTOR SHALL COVER OR REMOVE ANY TEMPORARY TRAFFIC CONTROL SIGNS SHOWN IN THE TRAFFIC CONTROL PLAN THAT DO NOT APPLY TO THE CURRENT PHASE.
- (26) THE RETROREFLECTIVE SIGN SHEETING ON RIGID, TEMPORARY TRAFFIC CONTROL (ORANGE) SIGNS SHALL BE MINIMUM TYPE IX.
- (27) TEMPORARY STRIPING SHALL CONFORM TO FINISHED STRIPE SPECIFICATIONS FOR ALIGNMENT, NEATNESS, AND STRAIGHTNESS.

UTILITIES

- (28) UTILITIES ON THE DRAWINGS ARE SHOWN IN THEIR ORIGINAL LOCATION BASED UPON THE BEST INFORMATION AVAILABLE TO THE ENGINEER. UTILITIES THAT WERE FOUND TO BE IN CONFLICT WITH CONSTRUCTION HAVE BEEN RELOCATED. PERMITS ARE ON FILE WITH THE DEPARTMENT SHOWING THE APPROXIMATE LOCATION OF UTILITIES RELOCATED WITHIN THE RIGHT-OF-WAY. THE ENGINEER CAN NOT AND DOES NOT WARRANT THAT THIS INFORMATION IS COMPLETE OR ACCURATE. THE CONTRACTOR MUST COORDINATE DIRECTLY WITH THE INVOLVED UTILITY OWNERS TO HAVE UNDERGROUND UTILITY LINES FIELD LOCATED IN ADVANCE OF CONSTRUCTION.
- (29) LIST OF PUBLIC UTILITIES
- A. MISSISSIPPI POWER (DISTRIBUTION) - 601-545-4126
 - B. MISSISSIPPI POWER (TRANSMISSION) - 601-545-4070
 - C. SOUTHERN PINE ELECTRIC - 601-785-6511
 - D. DIXIE PIPELINE - 601-582-4343
 - E. GULF SOUTH - 601-583-3782
 - F. GLENDALE WATER ASSOCIATION - 601-583-0647
 - G. COMCAST - 601-579-3967
 - H. AT&T - 601-544-9096
 - I. SPIRE ENERGY - 601-544-6001
 - J. DIXIE EPA PETAL - 601-549-7338
 - K. SOUTHWEST JONES WATER ASSOCIATION - 601-315-1135
 - L. AT&T - 601-765-0180

MISCELLANEOUS

- (30) THE CONTRACTOR IS RESPONSIBLE FOR FIELD-VERIFICATION OF EXISTING GRADES AND MAKING ADJUSTMENTS AS NECESSARY WITH THE APPROVAL OF THE PROJECT ENGINEER.
- (31) THE CONTRACTOR SHALL COORDINATE AND CONDUCT WORK AT LOCAL ROADS AND DRIVEWAYS IN A MANNER SUCH THAT ACCESS IS NOT INTERRUPTED UNNECESSARILY. ACCESS SHALL BE PRESERVED IN THE BEST MANNER POSSIBLE. COORDINATION AND COMMUNICATION WITH LANDOWNERS MAY BE NECESSARY TO PREVENT INTERRUPTION OF DRIVEWAY ACCESS.

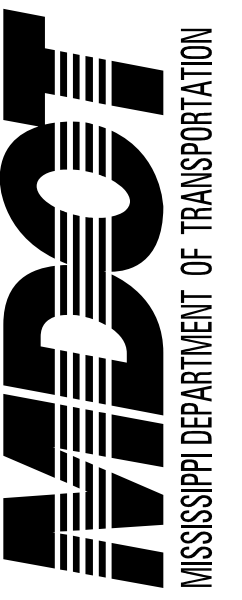
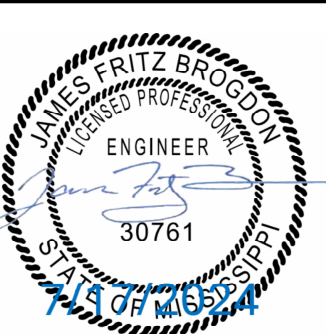

DESIGNED BY: MDB

DETAILED BY: SEH

CHECKED BY: JFB

DATE: 07-17-2024

FMS CON: 109129/301000

PROJECT NO.: HSIP-0080-01(020)

COUNTY: FORREST

GENERAL NOTES

WK. NO.
GN-1

SHEET NO.
3

PLAN SHEET

11:36:35 AM GN.dgn

DATE