

GENERAL INDEX

INCLUDED THIS PROJECT	BEGIN WITH SHEET
<input checked="" type="checkbox"/> ROADWAY.....	1
<input checked="" type="checkbox"/> PERMANENT SIGNS.....	1001
<input type="checkbox"/> TRAFFIC SIGNALS.....	2001
<input type="checkbox"/> ITS COMPONENTS.....	3001
<input type="checkbox"/> LIGHTING.....	4001
<input type="checkbox"/> (RESERVED).....	5001
<input checked="" type="checkbox"/> ROADWAY STD. DWGS.....	6001
<input type="checkbox"/> BOX CULVERT STD. DWGS (LRFD).....	7001
<input type="checkbox"/> BOX CULVERT STD. DWGS (STD. SPEC.)....	7501
<input type="checkbox"/> BRIDGE.....	8001
<input checked="" type="checkbox"/> CROSS SECTIONS.....	9001

**STATE OF MISSISSIPPI
MISSISSIPPI DEPARTMENT OF TRANSPORTATION**

**PLAN AND PROFILE OF
PROPOSED STATE HIGHWAY
FEDERAL AID PROJECT NO. HSIP-0056-01(115)**

**SR 25 at Mt Helms, SR 25 at Pisgah Rd
RANKIN COUNTY**

SR-25 & PISGAH RD.

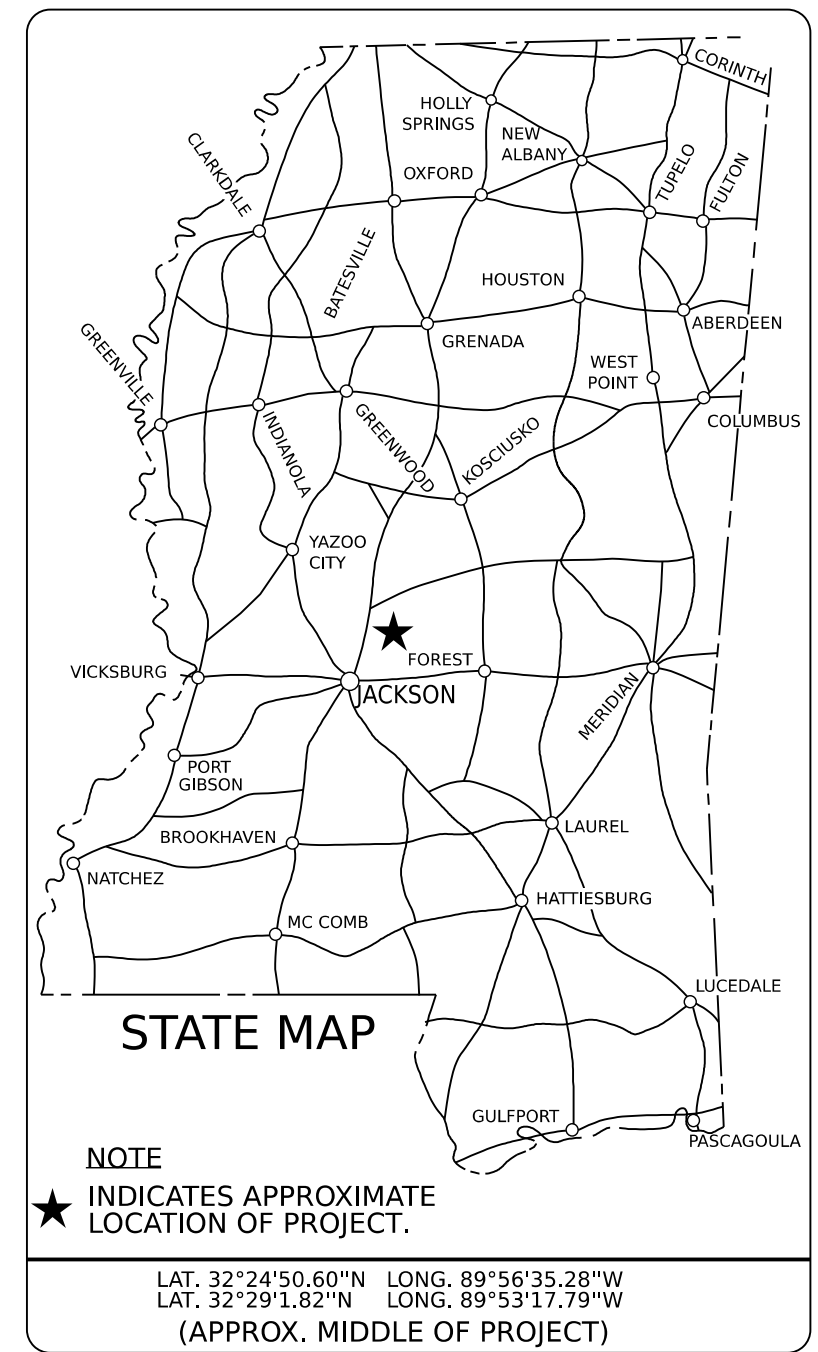

BRIDGE STRUCTURES REQ'D.
NONE

BOX BRIDGES REQ'D.
NONE

SR 25 & MT. HELM RD.

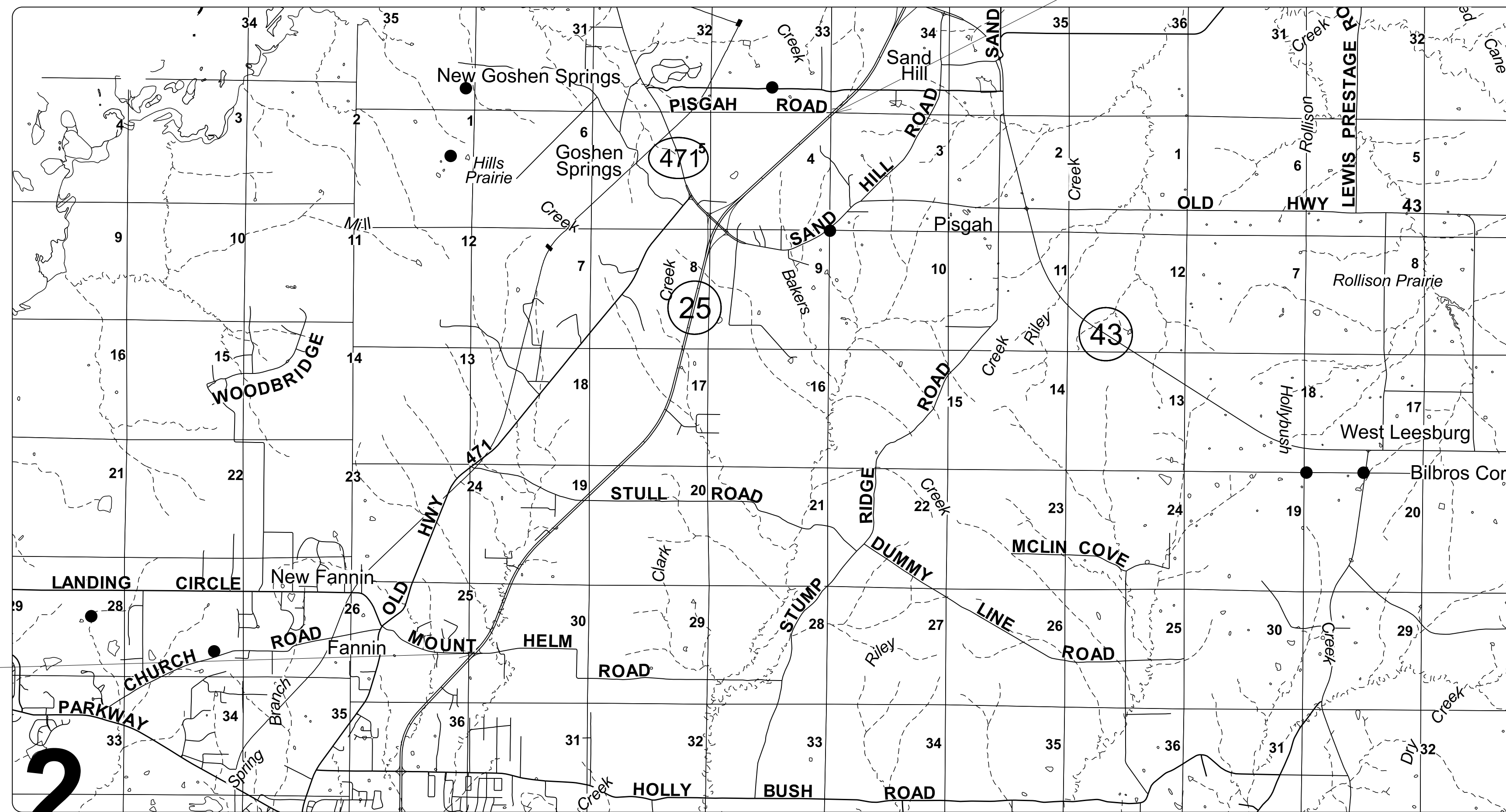

DESIGN CONTROL

MPH = 65 MPH
ADT (2025) = 1750 : ADT (2045) = 2200
1300 : DHV = 230 : D = 60 % T = 15 %
170 : 60

PERMITS ACQUIRED BY MDOT

WETLANDS AND WATERS PERMITS	
	WATERS WETLANDS
NATIONWIDE #14	<input type="checkbox"/> <input type="checkbox"/>
NATIONWIDE (OTHER)*	<input type="checkbox"/> <input type="checkbox"/>
GENERAL*	<input type="checkbox"/> <input type="checkbox"/>
INDIVIDUAL (404)*	<input type="checkbox"/> <input type="checkbox"/>
STORMWATER PERMIT <input checked="" type="checkbox"/>	
Y REQUIRED, CNOI SUBMITTED BY MDOT (DISTURBED AREA=5 ACRES)	
S REQUIRED, SCNOI TO BE SUBMITTED BY CONTRACTOR (1 TO 4.99 ACRES)	
N NO STORMWATER PERMIT REQUIRED (<1 ACRE)	
APPROVED BY: _____	

DESIGNED BY: WEAVER

CONSTRUCTION PROJECT DATA

EXTERNAL PROJECT NUMBER	HSIP-0056-01(115)
FMS & DETAIL	109316/301000

P S & E DATE:

APPROVED:

DEPUTY EXECUTIVE DIRECTOR / CHIEF ENGINEER

EXECUTIVE DIRECTOR



CONVENTIONAL SYMBOLS

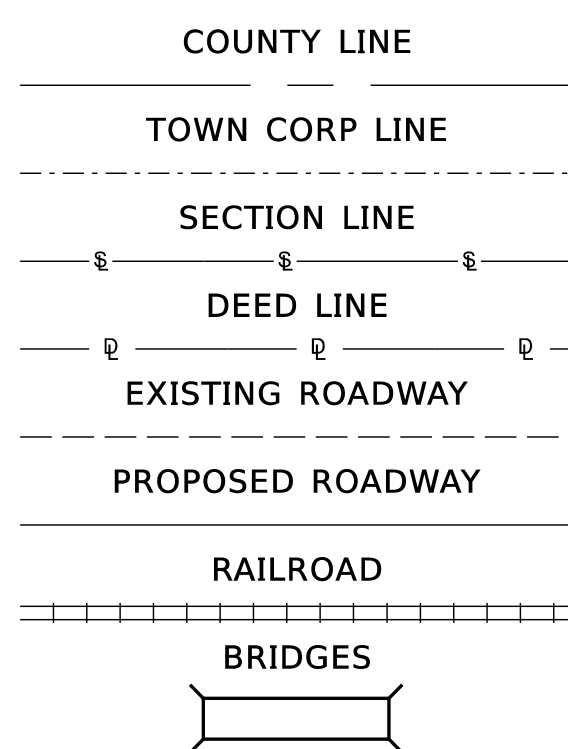

LENGTH DATA

	FT.	MI.
LENGTH OF ROADWAY		
LENGTH OF BRIDGES		
LENGTH OF PROJECT (NET)		
LENGTH OF EXCEPTIONS		
LENGTH OF PROJECT (GROSS)		

EQUATIONS

NONE

SCALES

PLAN 1 IN. = 100 FT.
PROFILE { HOR. 1 IN. = 100 FT.
VERT. 1 IN. = 10 FT.
LAYOUT 1 IN. = 45,000 FT.

EXCEPTIONS

NONE

TITLE SHEET

8/14/2024 1:38:27 PM TITLE_SH.dgn

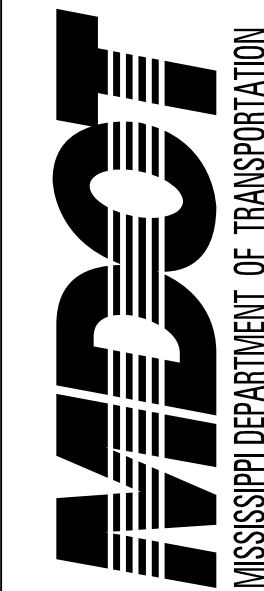

DESIGNED BY: WEAVER

DETAILED BY:

CHECKED BY:

DATE:

FMS CON: 109316/301000

PROJECT NO.: HSP-0056-01(115)

COUNTY: RANKIN

DETAILED INDEX

SHEET ID
DI-1

SHEET NO.
2

DETAILED INDEX

	SH. ID	SH. NO.
TITLE SHEET		1
DETAILED INDEX (2)		
DETAILED INDEX	DI-1	2
DETAILED INDEX	DI-2	3
REVISION SHEET	REV-1	4
GENERAL NOTES (2)		
GENERAL NOTES	GN-1	5
GENERAL NOTES	GN-2	6
TYPICAL SECTION SHEETS (6)		
HWY-25 @ MT. HELM RD.	TS-1	7
HWY-25 @ MT. HELM RD.	TS-2	8
HWY-25 @ MT. HELM RD.	TS-3	9
HWY-25 @ PISGAH RD.	TS-4	10
HWY-25 @ PISGAH RD.	TS-5	11
SPECIAL CURB DETAILS	TS-6	12
SUMMARY OF QUANTITY SHEETS (2)		
SUMMARY OF QUANTITIES	SQ-1	13
SUMMARY OF QUANTITIES	SQ-2	14
ESTIMATED QUANTITY SHEETS (7)		
REMOVAL ITEMS, EARTHWORK, GRASSING, DRAINAGE STRUCTURES	EQ-1	15
MILLING, CURB & GUTTER / SLOTTED CURB, PAVEMENT MARKINGS	EQ-2	16
SUMMARY OF TRAFFIC CONTROL	EQ-3	17
TRAFFIC CONTROL SIGNS ESTIMATED QUANTITIES	EQ-4	18
SIGNS	EQ-5	19
STANDARD ROADSIDE SIGNS (POSTS) - SITE 1	EQ-6	20
STANDARD ROADSIDE SIGNS (POSTS) - SITE 2	EQ-7	21
PLAN / PROFILE SHEETS (5)		
HWY-25 @ MT. HELM RD.	WK-3	22
HWY-25 @ MT. HELM RD.	WK-4	23
HWY-25 @ MT. HELM RD.	WK-5	24
HWY-25 @ PISGAH RD.	WK-6	25
HWY-25 @ PISGAH RD.	WK-7	26
SPECIAL DESIGN SHEETS (51)		
EROSION CONTROL PLAN - HWY-25 @ MT. HELM RD.	ECP-3	27
EROSION CONTROL PLAN - HWY-25 @ MT. HELM RD.	ECP-4	28
EROSION CONTROL PLAN - HWY-25 @ MT. HELM RD.	ECP-5	29
EROSION CONTROL PLAN - HWY-25 @ PISGAH RD.	ECP-6	30
EROSION CONTROL PLAN - HWY-25 @ PISGAH RD.	ECP-7	31
DETAIL OF CONSTRUCTION SIGNING - HWY-25 @ MT. HELM RD.	DCS-1	32
DETAIL OF CONSTRUCTION SIGNING - HWY-25 @ MT. HELM RD.	DCS-2	33
DETAIL OF CONSTRUCTION SIGNING - HWY-25 @ PISGAH RD.	DCS-3	34
DETAIL OF CONSTRUCTION SIGNING - HWY-25 @ PISGAH RD.	DCS-4	35

TRAFFIC CONTROL - HWY-25 @ MT. HELM RD. - PHASE I	TC-1	36
TRAFFIC CONTROL - HWY-25 @ MT. HELM RD. - PHASE I	TC-2	37
TRAFFIC CONTROL - HWY-25 @ MT. HELM RD. - PHASE I	TC-3	38
TRAFFIC CONTROL - HWY-25 @ MT. HELM RD. - PHASE I	TC-4	39
TRAFFIC CONTROL - HWY-25 @ MT. HELM RD. - PHASE II	TC-5	40
TRAFFIC CONTROL - HWY-25 @ MT. HELM RD. - PHASE II	TC-6	41
TRAFFIC CONTROL - HWY-25 @ MT. HELM RD. - PHASE II	TC-7	42
TRAFFIC CONTROL - HWY-25 @ MT. HELM RD. - PHASE II	TC-8	43
TRAFFIC CONTROL - HWY-25 @ MT. HELM RD. - PHASE III	TC-9	44
TRAFFIC CONTROL - HWY-25 @ MT. HELM RD. - PHASE III	TC-10	45
TRAFFIC CONTROL - HWY-25 @ MT. HELM RD. - PHASE III	TC-11	46
TRAFFIC CONTROL - HWY-25 @ MT. HELM RD. - PHASE IV	TC-12	47
TRAFFIC CONTROL - HWY-25 @ MT. HELM RD. - PHASE IV	TC-13	48
TRAFFIC CONTROL - HWY-25 @ MT. HELM RD. - PHASE IV	TC-14	49
TRAFFIC CONTROL - HWY-25 @ PISGAH RD. - PHASE I	TC-15	50
TRAFFIC CONTROL - HWY-25 @ PISGAH RD. - PHASE I	TC-16	51
TRAFFIC CONTROL - HWY-25 @ PISGAH RD. - PHASE II	TC-17	52
TRAFFIC CONTROL - HWY-25 @ PISGAH RD. - PHASE II	TC-18	53
TRAFFIC CONTROL - HWY-25 @ PISGAH RD. - PHASE III	TC-19	54
TRAFFIC CONTROL - HWY-25 @ PISGAH RD. - PHASE III	TC-20	55
TRAFFIC CONTROL - HWY-25 @ PISGAH RD. - PHASE III	TC-21	56
TRAFFIC CONTROL - HWY-25 @ PISGAH RD. - PHASE IV	TC-22	57
TRAFFIC CONTROL - HWY-25 @ PISGAH RD. - PHASE IV	TC-23	58
INTERSECTION DETAIL - HWY-25 @ MT. HELM RD.	ID-1	59
INTERSECTION DETAIL - HWY-25 @ MT. HELM RD.	ID-2	60
INTERSECTION DETAIL - HWY-25 @ MT. HELM RD.	ID-3	61
INTERSECTION DETAIL - HWY-25 @ PISGAH RD.	ID-4	62
INTERSECTION DETAIL - HWY-25 @ PISGAH RD.	ID-5	63
FORM GRADES - HWY-25 @ MT. HELM RD.	FG-1	64
FORM GRADES - HWY-25 @ MT. HELM RD.	FG-2	65
FORM GRADES - HWY-25 @ MT. HELM RD.	FG-3	66
FORM GRADES - HWY-25 @ MT. HELM RD.	FG-4	67
FORM GRADES - HWY-25 @ PISGAH RD.	FG-5	68
FORM GRADES - HWY-25 @ PISGAH RD.	FG-6	69
PAVEMENT MARKING DETAIL- HWY-25 @ MT. HELM RD.	PMD-1	70
PAVEMENT MARKING DETAIL- HWY-25 @ MT. HELM RD.	PMD-2	71
PAVEMENT MARKING DETAIL- HWY-25 @ MT. HELM RD.	PMD-3	72
PAVEMENT MARKING DETAIL - HWY-25 @ PISGAH RD.	PMD-4	73
PAVEMENT MARKING DETAIL - HWY-25 @ PISGAH RD.	PMD-5	74
SIGN SUPPORT HARDWARE 2.5" SQUARE POST	TSS-1	75
SIGN SUPPORT HARDWARE 2.0" SQUARE POST	TSS-2	76
VEGETATION SCHEDULE	VS-1	77
PERMANENT SIGNING SHEETS (5)		
PERMANENT SIGNING PLAN - HWY-25 @ MT. HELM RD.	PSP-1	1001
PERMANENT SIGNING PLAN - HWY-25 @ MT. HELM RD.	PSP-2	1002
PERMANENT SIGNING PLAN - HWY-25 @ MT. HELM RD.	PSP-3	1003
PERMANENT SIGNING PLAN - HWY-25 @ PISGAH RD.	PSP-4	1004
PERMANENT SIGNING PLAN - HWY-25 @ PISGAH RD.	PSP-5	1005
DIRECTIONAL SIGNING DETAIL	PSP-6	1006

PLAN SHEET

8/14/2024 1:23:22 PM RWD-DI.dgn

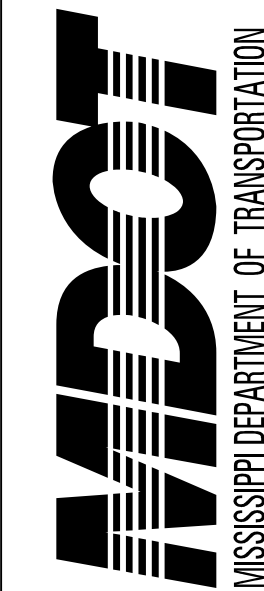

DESIGNED BY: WEAVER

DETAILED BY:

CHECKED BY:

DATE:

FMS CON: 109316/301000

PROJECT NO.: HSIP-0056-01(115)

COUNTY: RANKIN

DETAILED INDEX

SHEET ID
DI-2

SHEET NO.
3

STANDARD DRAWINGS - ROADWAY SHEETS (45)		
CONCRETE ISLAND PAVEMENT DETAILS	CIP-1	6011
PAVEMENT MARKING DETAILS FOR 2-LANE & 4-LANE DIVIDED ROADWAYS	PM-1	6051
PAVEMENT MARKING LEGEND DETAILS	PM-5	6055
PAVEMENT MARKING LEGEND DETAILS	PM-6	6056
2-WAY RAISED PAVEMENT MARKERS AT INTERSECTING ROADS (4-LANE)	PM-12	6062
RUMBLE STRIPES 4-LANE HIGHWAYS (ASPHALT LANES, 2-FT OR WIDER ASPHALT SHOULDERS)	RS-2	6064
TYPICAL TEMPORARY EROSION CONTROL APPLICATIONS	ECD-1	6101
DETAILS OF SEDIMENT BARRIER APPLICATIONS	ECD-2	6102
DETAILS OF SILT FENCE INSTALLATION	ECD-3	6103
DITCH CHECK STRUCTURES, TYPICAL APPLICATIONS AND DETAILS	ECD-4	6104
TEMPORARY EROSION, SEDIMENT, & WATER POLLUTION CONTROL MEASURES (SILT FENCE & HAY BALES DITCH CHECKS)	ECD-5	6105
DETAILS OF EROSION CONTROL WATTE DITCH CHECK	ECD-6	6106
DETAILS OF EROSION CONTROL SILT DIKE DITCH CHECK	ECD-7	6107
STABILIZED CONSTRUCTION ENTRANCE	ECD-16	6116
DETAILS OF TYPICAL DITCH TREATMENTS	DT-1	6123
CONCRETE MEDIAN BARRIER (PRECAST) (32")	CMB-3	6226
ROUTE SHIELDS & "EXIT ONLY" PANELS	SN-2	6302
STANDARD ROADSIDE SIGNS	SN-3	6303
STANDARD ROADSIDE SIGNS	SN-3A	6304
STANDARD ROADSIDE SIGNS	SN-3B	6305
STANDARD ROADSIDE SIGNS ASSEMBLY & INSTALLATION	SN-4	6306
STANDARD ROADSIDE SIGNS ASSEMBLY & INSTALLATION	SN-4A	6307
STANDARD ROADSIDE SIGNS ASSEMBLY & INSTALLATION	SN-4B	6308
TYPICAL INSTALLATION OF GROUND MOUNTED DIRECTIONAL SIGNS	SN-5	6309
BREAKAWAY SIGN SUPPORTS	SN-6	6310
BREAKAWAY SIGN SUPPORTS	SN-6A	6311
BREAKAWAY SIGN SUPPORTS	SN-6B	6312
SIGN FACE CONST. & ATTACHMENT OF GROUND MOUNTED DIRECTIONAL SIGNS TO STEEL BEAMS (EXTRUDED ALUMINUM PANELS)	SN-7	6313
TYPICAL CROSSOVER DELINEATION	SN-8B	6316

TRAFFIC CONTROL PLAN WITH FLAGGER (ONE-LANE-CLOSURE OF TWO-WAY TRAFFIC)	TCP-1	6351
TRAFFIC CONTROL PLAN FOR POSTED SPEED LIMIT OF 65 OR 70 MPH (INTERSTATES & OTHER 4-LANE DIVIDED HIGHWAYS) (MEDIAN LANE OR OUTSIDE LANE CLOSURE) (EXTENDED PERIOD)	TCP-4	6354
TRAFFIC CONTROL PLAN FOR POSTED SPEED LIMIT OF 65 OR 70 MPH (INTERSTATES & OTHER 4-LANE DIVIDED HIGHWAYS) (MEDIAN LANE OR OUTSIDE LANE CLOSURE) (WORK DAY ONLY)	TCP-5	6355
HIGHWAY SIGN & BARRICADE DETAILS FOR CONSTRUCTION PROJECTS	TCP-8	6358
TRAFFIC CONTROL PLAN MOBILE OPERATIONS MULTILANE ROADS AND TWO-LANE ROADS	TCP-9	6359
TRAFFIC CONTROL PLANS UNEVEN PAVEMENT DETAILS	TCP-12	6362
TEMPORARY STRIPING FOR TRAFFIC CONTROL 2-LANE & 4-LANE DIVIDED HIGHWAYS	TCP-13	6363
LOCATION OF R16-3 SIGNS (SPEEDING FINES DOUBLED)	TCP-15	6365
TRAFFIC CONTROL DETAILS DRUM PLACEMENT & SHOULDER CLOSURE	TCP-16	6366
SUPERELEVATION CASE II ROTATION ABOUT EDGE OF TRAVELED WAY	SE-2B	6409
SUPERELEVATION RUNOFF CASE I ROTATION ABOUT CENTERLINE	SE-3A	6413
PIPE CULVERT INSTALLATION	PI-1	6501
CONCRETE PIPE COLLAR	PC-1	6503
TYPE I MEDIAN INLET (29" TO 51" PIPE)	MI-1A	6509
DETAILS OF GRATES FOR MEDIAN INLETS	IG-1	6516
FLARED END SECTION FOR CONCRETE PIPE	FE-1	6530
CROSS SECTIONS (33)		
HWY-25 @ MT. HELM RD.	9001 - 9020	
HWY-25 @ PISGAH RD.	9021 - 9033	
TOTAL SHEETS (NOT INCLUDING BRIDGE SHEETS)	160	

PS & E PLANS-DATE 8/14/2024		
FMS CON. # 109316-301000		
REVISIONS		
DATE	SHEET NO.	BY
9/3/2024	4,13,14,74	ME

PLAN SHEET

9/5/2024 9:03:58 AM RWD-DI.dgn



**1ST ORD.
REVISION**

SUMMARY OF REVISIONS						
DATE	1st ORDER	ADDENDUM	2nd ORDER	BY	SH. NO.	DESCRIPTION
09/05/2024	UPDATED QUANTITY & ADDED FOOTNOTE			HW	13	
09/13/2024	ADDED PAY ITEM			HW	13	
09/13/2024	UPDATED QUANTITY			HW	13	
09/13/2024	UPDATED QUANTITY			HW	13	
09/13/2024	UPDATED QUANTITY			HW	13	
09/05/2024	UPDATED PAY ITEM, QUANTITY & DELETED FOOTNOTE			HW	13	
09/05/2024	UPDATED FOOTNOTE			HW	13	
09/05/2024	UPDATED QUANTITY & ADDED FOOTNOTE			HW	14	
09/05/2024	UPDATED QUANTITY			HW	14	
09/05/2024	DELETED PAY ITEM			HW	14	
09/05/2024	UPDATED PAVEMENT MARKINGS			HW	74	
09/05/2024	UPDATED PAVEMENT MARKINGS			HW	74	

DESIGNED BY: WEAVER

DETAILED BY:

CHECKED BY:

DATE:

FMS CON: 109316/301000

PROJECT NO.: H5IP-0056-01(115)

COUNTY: RANKIN

REVISION

SHEET ID
REV-1

SHEET NO.
4



DESIGNED BY:
 DETAILED BY:
 CHECKED BY:
 DATE:

FMS CON: 109316/301000
 PROJECT NO.: H5IP-0056-01(115)
 COUNTY: RANKIN

GENERAL NOTES

SHEET ID
GN-1

SHEET NO.
5

GENERAL NOTES

DRAINAGE STRUCTURES

- 1 ALL PIPE JOINTS ARE TO BE WRAPPED IN 24-INCH WIDE TYPE V GEOTEXTILE FABRIC. ALL PICKUP HOLES SHALL BE PLUGGED AND COVERED WITH TYPE V GEOTEXTILE FABRIC, THE COST OF WHICH SHALL BE ABSORBED IN OTHER ITEMS BID.
- 2 CURB AND GUTTER VERTICAL DIMENSIONS SHOWN IN THE DETAIL DRAWINGS ARE FOR A CURB IN THE "CATCH" CONFIGURATION AND SHALL BE CONSIDERED TO BE MINIMUM DIMENSIONS. THE DIMENSIONS MAY BE MODIFIED AS NECESSARY FOR "SPILL" CURB AND GUTTER, BUT SHALL NOT BE LESS THAN THE MINIMUM SHOWN.
- 3 THE CONTRACTOR SHALL BE RESPONSIBLE FOR PROTECTING EXISTING STRUCTURES SUCH AS, BUT NOT LIMITED TO, PIPES, INLETS, APRONS, AND BRIDGES FROM DAMAGE WHICH MIGHT OCCUR DURING CONSTRUCTION. THE CONTRACTOR SHALL REPLACE OR REPAIR, AS DIRECTED BY THE ENGINEER, ANY STRUCTURES DAMAGED DURING THE LIFE OF THE CONTRACT. NO PAYMENT WILL BE MADE FOR REPLACEMENT OR REPAIR OF DAMAGED ITEMS.

EARTHWORK

- 4 A SOIL PROFILE HAS BEEN PREPARED FOR THIS PROJECT USING SAMPLES TAKEN FROM HOLES AT THE LOCATIONS INDICATED IN THE TEST REPORTS. THIS SOIL PROFILE IS ON FILE IN THE DISTRICT AND CENTRAL CONSTRUCTION OFFICES AND IS AVAILABLE FOR EXAMINATION. THE DEPARTMENT DOES NOT GUARANTEE THAT THE MATERIALS AS SHOWN IN THE REPORTS ARE NECESSARILY TO BE FOUND OUTSIDE THE TEST HOLES.
- 5 25 % SHRINKAGE FACTOR USED IN THE EARTHWORK CALCULATIONS IS FOR DESIGN ESTIMATING PURPOSES ONLY.
- 6 THE TOP THREE FEET AND VARIABLE OF THE DESIGN SOILS (BOTH NATURAL AND EMBANKMENT) SHALL BE CONSTRUCTED OF SOIL CLASSIFIED B15 OR BETTER, PER MDOT SPECIFICATIONS 703.21, EXCEPT AT UNDERCUT LOCATIONS DESIGNATED ON THE PLANS OR AS DIRECTED BY THE ENGINEER TO RECEIVE CLASS B-15 BORROW EXCAVATION. EXTREME CARE SHALL BE EXERCISED IN UNDERCUT AREAS, AND THE UNDERCUT DEPTH MAY BE ADJUSTED AT CROSS DRAINS AS DIRECTED BY THE ENGINEER. FOR ADDITIONAL DETAILS THE CONTRACTOR IS REFERRED TO THE NOTICE TO BIDDERS ON DESIGN SOIL MATERIAL IN THE CONTRACT PROPOSAL DOCUMENT.
- 7 VOIDS CREATED BY THE REMOVAL OF, BUT NOT LIMITED TO, POSTS, CONCRETE ANCHORS, AND FOOTINGS SHALL BE BACKFILLED AND TAMPED IN ACCORDANCE WITH SECTION 203 OF THE MISSISSIPPI STANDARD SPECIFICATIONS FOR ROAD AND BRIDGE CONSTRUCTION, THE COST OF WHICH WILL BE ABSORBED IN OTHER ITEMS BID.
- 8 WORK ON STRUCTURES FOR THIS PROJECT REQUIRES EXCAVATION IN THE IMMEDIATE VICINITY OF TRAFFIC AND ADJACENT PROPERTIES. THEREFORE, THE RISK OF A FAILURE OCCURRING DURING EXCAVATION REQUIRES THAT EXTREME CAUTION BE EXERCISED. THE CONTRACTOR SHALL BE RESPONSIBLE FOR PLACING WHAT BRACING, SHORING, OR GROUND SUPPORT SYSTEM THAT IS DEEMED NECESSARY TO PREVENT A FAILURE AND PROTECT THE PERSONS WORKING NEAR THE EXCAVATION, THE PUBLIC THAT MAY BE ABOVE THE EXCAVATION, OR ANY STRUCTURES ADJACENT TO THE EXCAVATION. ALL COSTS FOR DESIGNING, DRAWING, AND CONSTRUCTING THE FACILITY SHALL BE INCLUDED IN THE PRICE BID FOR CONTRACT ITEMS.
- 9 VEGETATIVE MATERIAL WILL BE REMOVED PRIOR TO PLACEMENT OF GRANULAR MATERIAL. THE COST OF WHICH SHALL BE ABSORBED IN OTHER ITEMS BID.
- 10 PRIOR TO EARTHWORK OPERATIONS, THE EXISTING TOP 4" TOPSOIL IS TO BE STRIPPED AND STOCKPILED. AFTER THE GRADING OPERATIONS ARE COMPLETED, SAID TOPSOIL SHALL BE PLACED ON ALL AREAS THAT ARE NOT TO BE PAVED OR OTHERWISE PROTECTED, IN ACCORDANCE WITH SECTION 211 OF THE SPECIFICATIONS, OR THE VEGETATION SCHEDULE (SEE WK. SH. VS-1). EXISTING TOPSOIL AND ALL COSTS ASSOCIATED WITH STRIPPING, HAULING, STOCKPILING, AND PLACEMENT OF THE EXISTING TOPSOIL IS TO BE ABSORBED IN OTHER EARTHWORK ITEMS.

EROSION CONTROL - TEMPORARY

- 11 WIRE FENCE BACKING WILL BE REQUIRED FOR ALL SILT FENCE. (SEE WK. NO. ECD-3)
- 12 THE EROSION CONTROL DEVICES REFERENCED IN THESE PLANS ARE A MINIMUM REQUIREMENT. IT IS THE RESPONSIBILITY OF THE CONTRACTOR TO ENSURE THAT SILT DOES NOT LEAVE THE RIGHT OF WAY OR CONTAMINATE WATERS OF THE U. S. DURING CONSTRUCTION. THE CONTRACTOR SHALL SUBMIT AN EROSION CONTROL PLAN PRIOR TO COMMENCEMENT OF WORK AND MAINTAIN THE PLAN DURING CONSTRUCTION. ANY ADDITIONAL SILT BASINS NOT SHOWN IN THE PLANS SHALL BE INCLUDED IN THE CONTRACTOR'S EROSION CONTROL PLAN PRIOR TO SUBMITTING FOR APPROVAL.
- 13 ALL ITEMS OF WORK ASSOCIATED WITH THE INSTALLATION OF A CONSTRUCTION ENTRANCE SHALL BE ABSORBED IN OTHER ITEMS OF WORK.

PAVEMENT, BASE, AND SHOULDERS

- 14 THE CONTRACTOR SHALL REPAIR ANY DAMAGE TO THE PAVED OR UNPAVED SHOULDER THAT MIGHT OCCUR DURING CONSTRUCTION. ANY REPAIR TO SHOULDER WILL BE IN ACCORDANCE WITH THE APPLICABLE SECTIONS OF THE MISSISSIPPI STANDARD SPECIFICATIONS FOR ROAD AND BRIDGE CONSTRUCTION. NO PAYMENT WILL BE MADE FOR REPAIR OF DAMAGED SHOULDER.
- 15 TEMPORARY PAVEMENT JOINTS (PAPER JOINTS) SHALL BE EMPLOYED AT ALL LOCATIONS REQUIRING TRAFFIC TO TRAVERSE AN UNEVEN PAVEMENT JOINT. PAPER JOINTS SHALL BE A MINIMUM OF 9 FEET IN LENGTH AND SHALL BE ADEQUATELY MAINTAINED.
- 16 WHERE MILLING IS REQUIRED, THE CONTRACTOR SHALL PROVIDE OUTLETS IN THE EXISTING SHOULDERS AT SUFFICIENT INTERVALS TO PREVENT POOLING OR STANDING WATER ON THE MILLED SURFACE, THE COST OF WHICH SHALL BE ABSORBED IN OTHER ITEMS BID.

PLANS

- 17 IF COLORS ARE USED ON PLAN/PROFILE SHEETS, THEY ARE INTENDED TO VISUALLY EASE THE LOCATION OF ELEMENTS FOR USERS OF THESE DRAWINGS. ALTHOUGH THE INTENT IS TO CATEGORIZE EVERYTHING AS EITHER EXISTING OR PROPOSED, IT IS THE END USER'S RESPONSIBILITY TO ENSURE ALL ELEMENTS ARE INTERPRETED CORRECTLY, REGARDLESS OF COLOR.
- 18 ALL ADDENDA TO THESE PLANS WILL BE POSTED TO WWW.MDOT.MS.GOV UNDER THE PROPOSAL ADDENDA COLUMN. BIDDERS ARE ADVISED THAT HARD COPIES OF ANY ADDENDA FOR THIS PROJECT WILL NOT BE MAILED. IT IS THE BIDDER'S RESPONSIBILITY TO CHECK AND SEE IF ANY ADDENDA HAVE BEEN POSTED FOR THIS PROJECT.

TRAFFIC CONTROL - PERMANENT

- 19 INSTALLATION DATES SHALL BE CLEARLY WRITTEN IN BOLD BLACK MARKINGS ON THE BACK BOTTOM HALF OF ALL SIGNS WITH A PERMANENT MARKING STICK THAT IS WATERPROOF, FADE RESISTANT AND MARKS ON WET OR DRY SURFACES.
- 20 ALL POST, PIPE, AND I-BEAM LENGTHS IN THESE PLANS ARE ESTIMATES. POST LENGTHS FOR ALL SIGNS SHALL BE VERIFIED IN THE FIELD BY THE CONTRACTOR PRIOR TO FABRICATION.
- 21 ALL EXISTING SIGNS WHICH ARE TO BE REMOVED AS A PART OF THIS PROJECT THAT ARE NOT IN CONFLICT WITH CONSTRUCTION SHALL REMAIN IN PLACE UNTIL NEW SIGNS ARE INSTALLED UNLESS NOTED OR DIRECTED OTHERWISE BY THE PROJECT ENGINEER. ROADWAY SIGNS THAT ARE IN CONFLICT WITH CONSTRUCTION SHALL BE REMOVED AND RELOCATED BY THE CONTRACTOR AS DIRECTED BY THE ENGINEER, THE COST OF WHICH SHALL BE ABSORBED IN OTHER ITEMS BID.
- 22 DIRECT-APPLIED LEGEND, BORDER, AND/OR SHIELDS ARE TO BE USED ON ALL GUIDE SIGNS. DIGITALLY PRODUCED SIGN COPY, SHIELDS, LEGEND, SYMBOLS, OR IMAGES WILL NOT BE ALLOWED WITHOUT WRITTEN APPROVAL FROM MDOT'S PROJECT ENGINEER.
- 23 ALL PERMANENT SIGNS SHALL CONFORM TO THE LATEST EDITION OF THE MANUAL ON UNIFORM TRAFFIC CONTROL DEVICES.
- 24 ALL SIGN LOCATIONS SHALL BE APPROVED BY THE PROJECT ENGINEER PRIOR TO INSTALLATION.
- 25 THE RETROREFLECTIVE SIGN SHEETING ON PERMANENT GROUND-MOUNTED SIGNS SHALL BE AS FOLLOWS: BROWN BACKGROUND SHEETING ON GUIDE SIGNS SHALL BE MINIMUM TYPE VIII; GREEN AND BLUE BACKGROUND SHEETING ON GUIDE SIGNS SHALL BE MINIMUM TYPE IX; ALL WHITE, YELLOW, FLUORESCENT YELLOW AND FLUORESCENT YELLOW/GREEN SHEETING SHALL BE TYPE XI. ALL SIGN SHEETING ON OVERHEAD SIGNS SHALL BE TYPE XI.
- 26 ALL EXISTING SIGNS AND SUPPORTS REMOVED UNDER THIS PROJECT SHALL BECOME THE PROPERTY OF THE CONTRACTOR AND ARE NOT A SEPARATE PAY ITEM.
- 27 ALL SIDE ROAD, STOP SIGN MOUNTED STREET NAME SIGNS TO BE SALVAGED AND STORED AT THE DIRECTION OF THE PROJECT ENGINEER FOR DELIVERY TO THE COUNTY (NOT A SEPARATE PAY ITEM).
- 28 REMOVAL OF RAISED PAVEMENT MARKERS THAT ARE IN CONFLICT WITH REQUIRED CONSTRUCTION IS NOT CONSIDERED A SEPARATE PAY ITEM. COST TO BE ABSORBED IN OTHER ITEMS BID.
- 29 REMOVAL OF OBJECT MARKERS IS NOT CONSIDERED A SEPARATE PAY ITEM, AND SHALL BE ABSORBED IN OTHER ITEMS BID.

PLAN SHEET

8/14/2024 1:23:41 PM RWD-GN.dgn

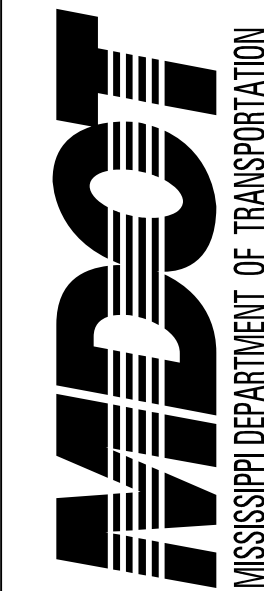

DESIGNED BY: WEAVER

DETAILED BY:

CHECKED BY:

DATE:

FMS CON: 109316/301000

PROJECT NO.: HSIP-0056-01(115)

COUNTY: RANKIN

GENERAL NOTES

SHEET ID
GN-2

SHEET NO.
6

TRAFFIC CONTROL - TEMPORARY

- 30 THE LOCATION AND SPACING OF SIGNS, SHOWN ON THE TRAFFIC CONTROL PLANS, ARE APPROXIMATE AND MAY BE ADJUSTED AS NECESSARY TO FIT FIELD CONDITIONS.
- 31 ALL TRAFFIC CONTROL DEVICES ON THIS PROJECT SHALL COMPLY WITH PART VI OF THE MUTCD (LATEST EDITION).
- 32 ALL PLASTIC DRUMS SHALL HAVE A BALLASTING COLLAR MADE FROM RECYCLED TRUCK TIRES OR OTHER SUITABLE MATERIAL.
- 33 FLUORESCENT ORANGE SHEETING SHALL BE USED ON ALL CONSTRUCTION AND TRAFFIC CONTROL SIGNS EXCEPT FOR THOSE DESIGNATED ON THE PLANS TO BE BLACK LEGEND AND BORDER ON WHITE BACKGROUND.
- 34 THE CONTRACTOR SHALL COORDINATE WITH THE CONTRACTOR FROM ADJACENT PROJECT(S) IN IMPLEMENTING THE TRAFFIC CONTROL PLAN AS DIRECTED BY THE ENGINEER. ALL CONFLICTING SIGNS SHALL BE COVERED OR REMOVED AS DIRECTED BY THE ENGINEER.
- 35 THE CONTRACTOR SHALL COVER OR REMOVE ANY TEMPORARY TRAFFIC CONTROL SIGNS SHOWN IN THE TRAFFIC CONTROL PLAN THAT DO NOT APPLY TO THE CURRENT PHASE.
- 36 THE RETROREFLECTIVE SIGN SHEETING ON RIGID, TEMPORARY TRAFFIC CONTROL (ORANGE) SIGNS SHALL BE MINIMUM TYPE IX.
- 37 TEMPORARY STRIPING SHALL CONFORM TO FINISHED STRIPE SPECIFICATIONS FOR ALIGNMENT, NEATNESS, AND STRAIGHTNESS.

UTILITIES

- 38 UTILITIES ON THE DRAWINGS ARE SHOWN IN THEIR ORIGINAL LOCATION BASED UPON THE BEST INFORMATION AVAILABLE TO THE ENGINEER. UTILITIES THAT WERE FOUND TO BE IN CONFLICT WITH CONSTRUCTION HAVE BEEN RELOCATED. PERMITS ARE ON FILE WITH THE DEPARTMENT SHOWING THE APPROXIMATE LOCATION OF UTILITIES RELOCATED WITHIN THE RIGHT-OF-WAY. THE ENGINEER CAN NOT AND DOES NOT WARRANT THAT THIS INFORMATION IS COMPLETE OR ACCURATE. THE CONTRACTOR MUST COORDINATE DIRECTLY WITH THE INVOLVED UTILITY OWNERS TO HAVE UNDERGROUND UTILITY LINES FIELD LOCATED IN ADVANCE OF CONSTRUCTION.
- 39 FOR LIST OF PUBLIC UTILITIES, SEE WK-3 & WK-6

MISCELLANEOUS

- 40 SOME WORK IS REQUIRED OUTSIDE THE PROJECT LIMITS. NO ADDITIONAL COMPENSATION WILL BE MADE FOR SUCH WORK EXCEPT AS PROVIDED BY SPECIFIC PAY ITEMS INCLUDED IN THE PLANS.
- 41 THE CONTRACTOR SHALL BE RESPONSIBLE FOR MAINTAINING AND RELOCATING MAIL BOXES AS NECESSARY TO MAINTAIN CONTINUOUS MAIL SERVICE THROUGHOUT THE LIFE OF THE PROJECT, THE COST OF WHICH SHALL BE ABSORBED IN OTHER ITEMS BID.
- 42 THE CONTRACTOR IS RESPONSIBLE FOR FIELD-VERIFICATION OF EXISTING GRADES AND MAKING ADJUSTMENTS AS NECESSARY WITH THE APPROVAL OF THE PROJECT ENGINEER.
- 43 THE CONTRACTOR SHALL COORDINATE AND CONDUCT WORK AT LOCAL ROADS AND DRIVEWAYS IN A MANNER SUCH THAT ACCESS IS NOT INTERRUPTED UNNECESSARILY. ACCESS SHALL BE PRESERVED IN THE BEST MANNER POSSIBLE. COORDINATION AND COMMUNICATION WITH LANDOWNERS MAY BE NECESSARY TO PREVENT INTERRUPTION OF DRIVEWAY ACCESS.

NOTICE:
THE NOTES CONTAINED HEREON ARE SPECIFIC TO THE SUBJECT PROJECT AND SHOULD BE REVIEWED IN DETAIL BY THE CONTRACTOR, PER SECTION 102.05 OF THE STANDARD SPECIFICATIONS, "THE BIDDER IS REQUIRED TO EXAMINE CAREFULLY THE SITE OF THE PROPOSED WORK, THE PROPOSAL PLANS, STANDARD SPECIFICATIONS, SPECIAL PROVISIONS, NOTICES TO BIDDERS AND CONTRACT FORMS BEFORE SUBMITTING A PROPOSAL."