

**GENERAL INDEX**

INCLUDED THIS PROJECT	BEGIN WITH SHEET
<input checked="" type="checkbox"/> ROADWAY.....	1
<input type="checkbox"/> PERMANENT SIGNS.....	1001
<input type="checkbox"/> TRAFFIC SIGNALS.....	2001
<input type="checkbox"/> ITS COMPONENTS.....	3001
<input type="checkbox"/> LIGHTING.....	4001
<input type="checkbox"/> (RESERVED).....	5001
<input checked="" type="checkbox"/> ROADWAY STD. DWGS.....	6001
<input type="checkbox"/> BOX CULVERT STD. DWGS (LRFD).....	7001
<input type="checkbox"/> BOX CULVERT STD. DWGS (STD. SPEC.)....	7501
<input checked="" type="checkbox"/> BRIDGE.....	8001
<input type="checkbox"/> CROSS SECTIONS.....	9001

**STATE OF MISSISSIPPI  
MISSISSIPPI DEPARTMENT OF TRANSPORTATION**

**PLAN AND PROFILE OF  
PROPOSED STATE HIGHWAY  
FEDERAL AID PROJECT NO. STBG-0071-06(012)**

**SR 4 OVER HATCHIE RIVER AND RELIEF (124.0 & 124.1)  
TIPPAH COUNTY**

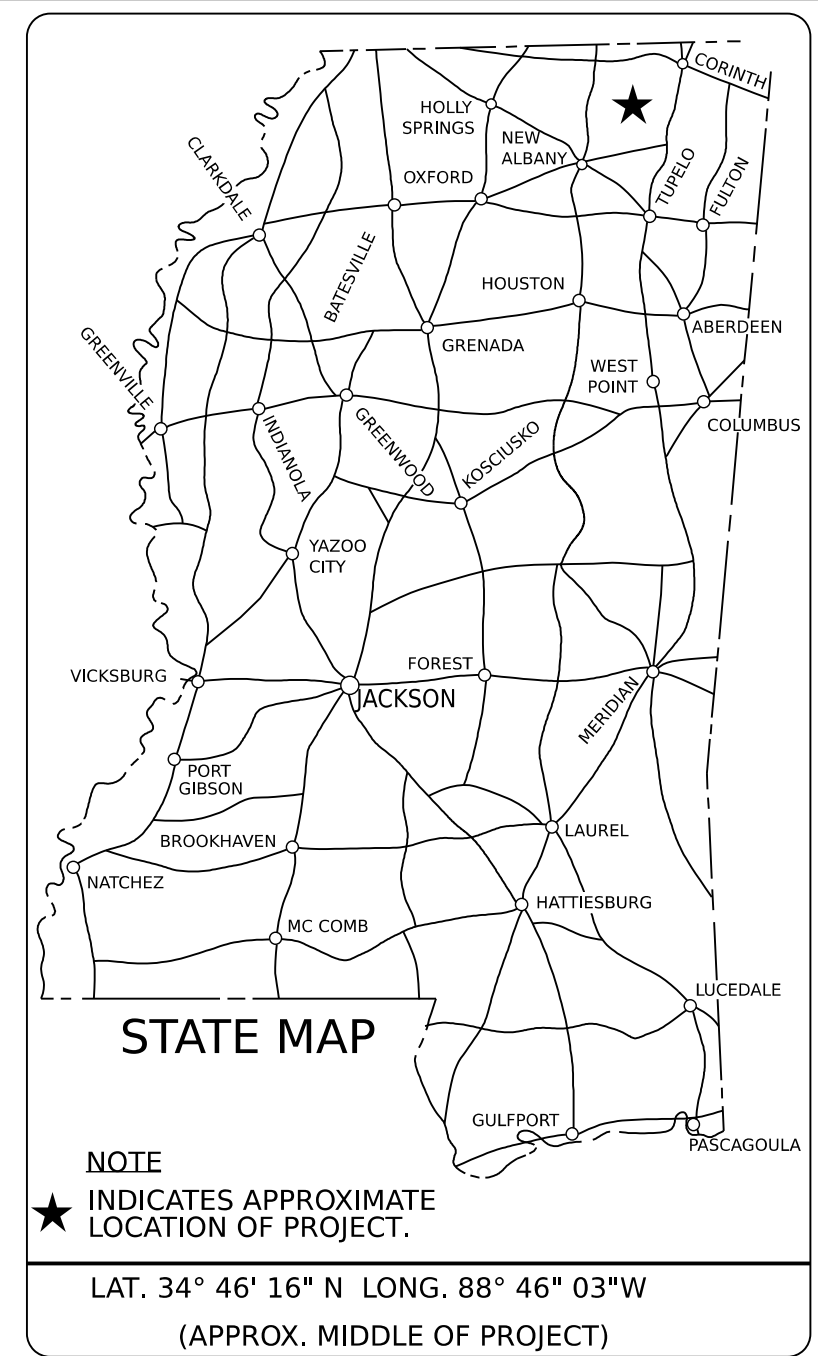

BRIDGE STRUCTURES REQ'D.

NONE

BOX BRIDGES REQ'D.

NONE

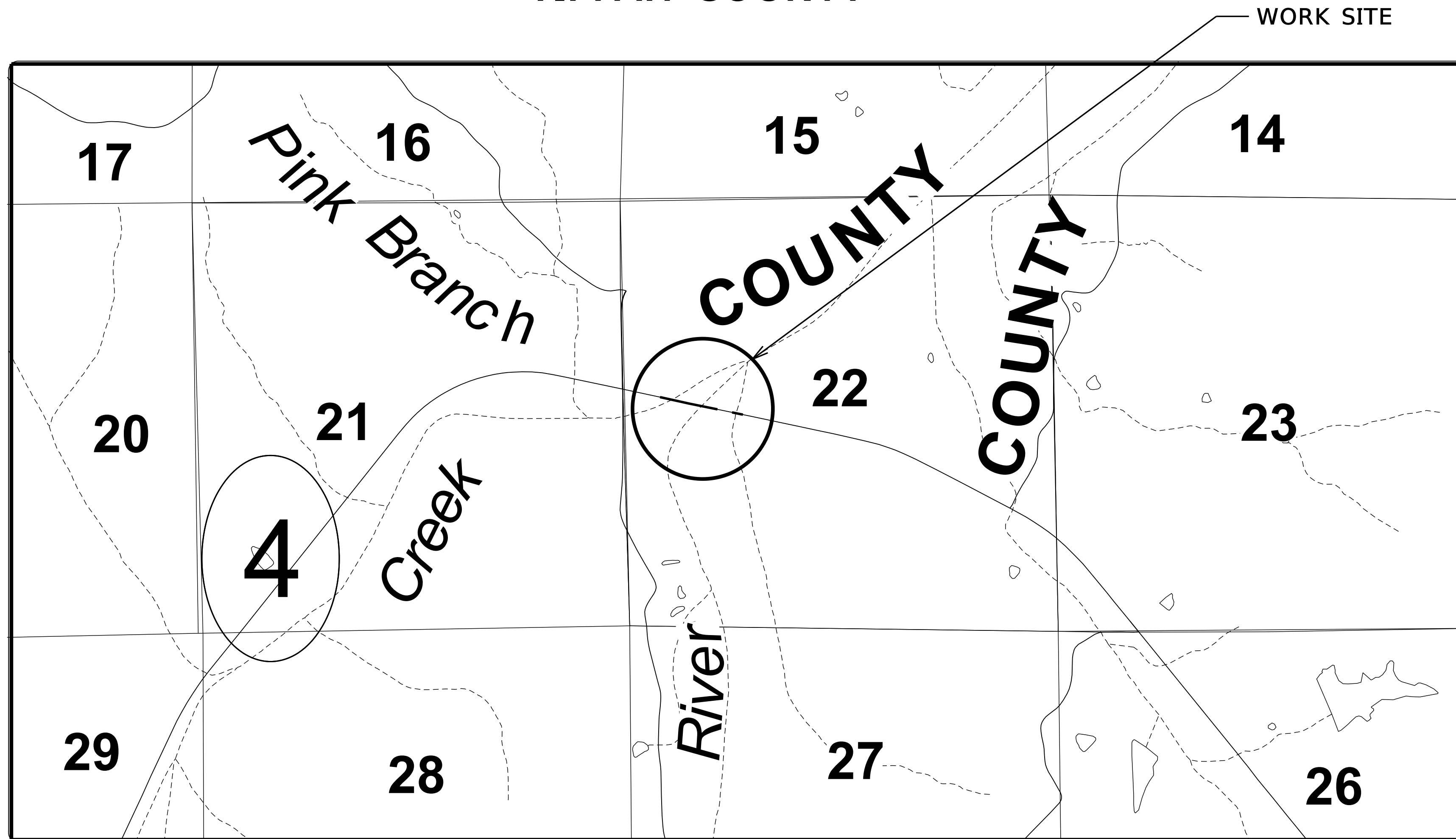

**DESIGN CONTROL**

MPH = V (SPEED DESIGN)

ADT ( ) = : ADT ( ) =  
DHV = : D = % T = %

**PERMITS ACQUIRED BY MDOT**

WETLANDS AND WATERS PERMITS

	WATERS	WETLANDS
NATIONWIDE #14	N	N
NATIONWIDE (OTHER)*	N	N
GENERAL*	N	N
INDIVIDUAL (404)*	N	N

STORMWATER PERMIT

Y REQUIRED, CNOI SUBMITTED BY MDOT (DISTURBED AREA=5 ACRES)

S REQUIRED, SCNOI TO BE SUBMITTED BY CONTRACTOR (1 TO 4.99 ACRES)

N NO STORMWATER PERMIT REQUIRED (<1 ACRE)

APPROVED BY: \_\_\_\_\_



DESIGNED BY: WALDON

**CONSTRUCTION PROJECT DATA**

EXTERNAL PROJECT NUMBER	STBG-0071-06(012)
FMS & DETAIL	109573/301000

P S & E DATE: 7/24/2024

APPROVED:  
  
DEPUTY EXECUTIVE DIRECTOR / CHIEF ENGINEER  
  
EXECUTIVE DIRECTOR



**CONVENTIONAL SYMBOLS**

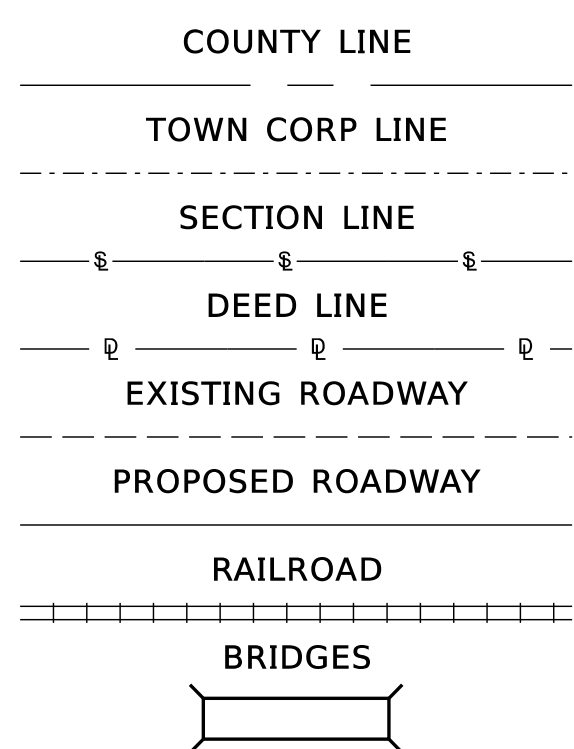

**LENGTH DATA**

LENGTH OF ROADWAY	FT.	MI.
LENGTH OF BRIDGES	FT.	MI.
LENGTH OF PROJECT (NET)	FT.	MI.
LENGTH OF EXCEPTIONS	FT.	MI.
LENGTH OF PROJECT (GROSS)	FT.	MI.

**EQUATIONS**

NONE

**SCALES**

PLAN	1 IN. = 100 FT.
PROFILE	{ HOR. 1 IN. = 100 FT. VERT. 1 IN. = 10 FT.
LAYOUT	1 IN. = FT.

**EXCEPTIONS**

NONE

TITLE SHEET

7/24/2024 9:46:26 AM TITLE-SR4.dgn

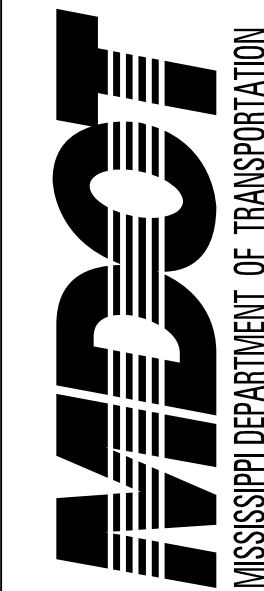

DESIGNED BY: WALDON  
 DETAILED BY:  
 CHECKED BY:  
 DATE:

FMS CON: 109573/301000  
 PROJECT NO.: STBG-0071-06(012)  
 COUNTY: TIPPAH

**DETAILED INDEX**

SHEET ID  
**DI-1**  
 SHEET NO.  
**2**

<u>DESCRIPTION OF SHEET</u>	<u>WK. NO.</u>	<u>SHEET NO.</u>
-----------------------------	----------------	------------------

<b>TITLE SHEET (1)</b>	1	1
------------------------	---	---

<b>DETAILED INDEX &amp; GENERAL NOTES (3)</b>		
DETAILED INDEX	DI-1	2
SUMMARY OF REVISIONS	REV-1	3
GENERAL NOTES	GN-1	4

<b>QUANTITY SHEETS (2)</b>		
SUMMARY OF QUANTITIES	SQ-1	5
ESTIMATED QUANTITIES - TRAFFIC CONTROL SIGNS	TCP-Q	6

<b>SPECIAL DESIGN SHEETS (6)</b>		
DETAIL OF CONSTRUCTION SIGNING	DCS-1	7
TRAFFIC CONTROL PLAN - PH. 1	TC-1	8
TRAFFIC CONTROL PLAN - PH. 1	TC-2	9
TRAFFIC CONTROL PLAN - PH. 2	TC-3	10
TRAFFIC CONTROL PLAN - PH.2	TC-4	11
TEMPORARY TRAFFIC SIGNAL	TTS-1	12

<b>STANDARD DRAWINGS (8)</b>		
PAVEMENT MARKING DETAILS FOR 2-LANE & 4-LANE DIVIDED ROADWAYS	PM-1	6051
CONCRETE MEDIAN BARRIER (PRECAST) (32")	CMB-3	6226
TRAFFIC CONTROL PLAN WITH FLAGGER (ONE-LANE CLOSURE OF TWO-WAY TRAFFIC)	TCP-1	6351
HIGHWAY SIGN AND BARRICADE DETAILS FOR CONSTRUCTION PROJECTS	TCP-8	6358
TRAFFIC CONTROL PLAN MOBILE OPERATIONS MULTILANE ROADS AND TWO-LANE ROADS	TCP-9	6359
TEMPORARY STRIPING FOR TRAFFIC CONTROL 2-LANE AND 4-LANE DIVIDED HIGHWAYS	TCP-13	6363
LOCATION OF R16-3 SIGNS (SPEEDING FINES DOUBLED)	TCP-15	6365
TRAFFIC CONTROL DETAILS DRUM PLACEMENT AND SHOULDER CLOSURE	TCP-16	6366

**SPECIAL DESIGN SHEETS - BRIDGE (SEE BRIDGE DETAILED INDEX, SHEET 8001)**

**TOTAL SHEETS (NOT INCLUDING BRIDGE SHEETS) (20)**

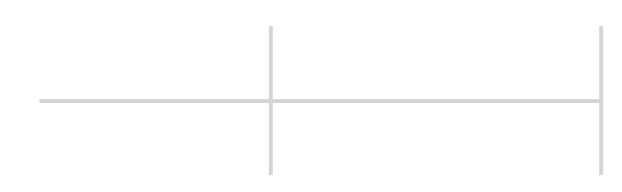

PLAN SHEET

7/24/2024 9:46:35 AM DI-1.dgn



SUMMARY OF REVISIONS						
DATE	1st ORDER	ADDENDUM	2nd ORDER	BY	WK. NO.	DESCRIPTION

DESIGNED BY: WALDON

DETAILED BY:

CHECKED BY:

DATE:

FMS CON: 109573/301000

PROJECT NO.: STBG-0071-06(012)

COUNTY: TIPPAH

**SUMMARY OF REVISIONS**

SHEET ID  
**REV-1**

SHEET NO.  
**3**

# GENERAL NOTES

## BRIDGES AND WALLS

- ① THE BRIDGE DECKS SHALL BE GROOVED AND ALL BRIDGE JOINTS SHALL BE SEALED PRIOR TO OPENING THE BRIDGES TO TRAFFIC.
- ② STORAGE OF FLAMMABLE MATERIALS WILL NOT BE ALLOWED UNDER ANY BRIDGE STRUCTURES WITHOUT WRITTEN APPROVAL FROM THE PROJECT ENGINEER. SEE NOTICE TO BIDDERS ENTITLED "MATERIAL STORAGE UNDER BRIDGES" FOR MORE INFORMATION.

## DRAINAGE STRUCTURES

- ③ THE CONTRACTOR SHALL BE RESPONSIBLE FOR PROTECTING EXISTING STRUCTURES SUCH AS, BUT NOT LIMITED TO, PIPES, INLETS, APRONS, AND BRIDGES FROM DAMAGE WHICH MIGHT OCCUR DURING CONSTRUCTION. THE CONTRACTOR SHALL REPLACE OR REPAIR, AS DIRECTED BY THE ENGINEER, ANY STRUCTURES DAMAGED DURING THE LIFE OF THE CONTRACT. NO PAYMENT WILL BE MADE FOR REPLACEMENT OR REPAIR OF DAMAGED ITEMS.

## PAVEMENT, BASE, AND SHOULDERS

- ④ THE CONTRACTOR SHALL REPAIR ANY DAMAGE TO THE PAVED OR UNPAVED SHOULDER THAT MIGHT OCCUR DURING CONSTRUCTION. ANY REPAIR TO SHOULDER WILL BE IN ACCORDANCE WITH THE APPLICABLE SECTIONS OF *THE MISSISSIPPI STANDARD SPECIFICATIONS FOR ROAD AND BRIDGE CONSTRUCTION*. NO PAYMENT WILL BE MADE FOR REPAIR OF DAMAGED SHOULDER.

## PLANS

- ⑤ IF COLORS ARE USED ON PLAN/PROFILE SHEETS, THEY ARE INTENDED TO VISUALLY EASE THE LOCATION OF ELEMENTS FOR USERS OF THESE DRAWINGS. ALTHOUGH THE INTENT IS TO CATEGORIZE EVERYTHING AS EITHER EXISTING OR PROPOSED, IT IS THE END USER'S RESPONSIBILITY TO ENSURE ALL ELEMENTS ARE INTERPRETED CORRECTLY, REGARDLESS OF COLOR.
- ⑥ ALL ADDENDA TO THESE PLANS WILL BE POSTED TO [WWW.MDOT.MS.GOV](http://WWW.MDOT.MS.GOV) UNDER THE PROPOSAL ADDENDA COLUMN. BIDDERS ARE ADVISED THAT HARD COPIES OF ANY ADDENDA FOR THIS PROJECT WILL NOT BE MAILED. IT IS THE BIDDER'S RESPONSIBILITY TO CHECK AND SEE IF ANY ADDENDA HAVE BEEN POSTED FOR THIS PROJECT.
- ⑦ SEE BRIDGE PLANS FOR DETAILED INDEX SHEET(S), ESTIMATED AND SUMMARY OF QUANTITY SHEETS, AND EROSION CONTROL SHEETS.

## TRAFFIC CONTROL - TEMPORARY

- ⑧ THE LOCATION AND SPACING OF SIGNS, SHOWN ON THE TRAFFIC CONTROL PLANS, ARE APPROXIMATE AND MAY BE ADJUSTED AS NECESSARY TO FIT FIELD CONDITIONS.
- ⑨ ALL TRAFFIC CONTROL DEVICES ON THIS PROJECT SHALL COMPLY WITH PART VI OF THE *MUTCD* (LATEST EDITION).
- ⑩ ALL PLASTIC DRUMS SHALL HAVE A BALLASTING COLLAR MADE FROM RECYCLED TRUCK TIRES OR OTHER SUITABLE MATERIAL.
- ⑪ FLUORESCENT ORANGE SHEETING SHALL BE USED ON ALL CONSTRUCTION AND TRAFFIC CONTROL SIGNS EXCEPT FOR THOSE DESIGNATED ON THE PLANS TO BE BLACK LEGEND AND BORDER ON WHITE BACKGROUND.
- ⑫ THE CONTRACTOR SHALL COORDINATE WITH THE CONTRACTOR FROM ADJACENT PROJECT(S) IN IMPLEMENTING THE TRAFFIC CONTROL PLAN AS DIRECTED BY THE ENGINEER. ALL CONFLICTING SIGNS SHALL BE COVERED OR REMOVED AS DIRECTED BY THE ENGINEER.
- ⑬ THE CONTRACTOR SHALL COVER OR REMOVE ANY TEMPORARY TRAFFIC CONTROL SIGNS SHOWN IN THE TRAFFIC CONTROL PLAN THAT DO NOT APPLY TO THE CURRENT PHASE.
- ⑭ THE RETROREFLECTIVE SIGN SHEETING ON RIGID, TEMPORARY TRAFFIC CONTROL (ORANGE) SIGNS SHALL BE MINIMUM TYPE IX.
- ⑮ TEMPORARY STRIPING SHALL CONFORM TO FINISHED STRIPE SPECIFICATIONS FOR ALIGNMENT, NEATNESS, AND STRAIGHTNESS.

## MISCELLANEOUS

- ⑯ SOME WORK IS REQUIRED OUTSIDE THE PROJECT LIMITS. NO ADDITIONAL COMPENSATION WILL BE MADE FOR SUCH WORK EXCEPT AS PROVIDED BY SPECIFIC PAY ITEMS INCLUDED IN THE PLANS.
- ⑰ THE CONTRACTOR SHALL BE RESPONSIBLE FOR MAINTAINING AND RELOCATING MAIL BOXES AS NECESSARY TO MAINTAIN CONTINUOUS MAIL SERVICE THROUGHOUT THE LIFE OF THE PROJECT, THE COST OF WHICH SHALL BE ABSORBED IN OTHER ITEMS BID.
- ⑱ THE CONTRACTOR IS RESPONSIBLE FOR FIELD-VERIFICATION OF EXISTING GRADES AND MAKING ADJUSTMENTS AS NECESSARY WITH THE APPROVAL OF THE PROJECT ENGINEER.
- ⑲ THE CONTRACTOR SHALL COORDINATE AND CONDUCT WORK AT LOCAL ROADS AND DRIVEWAYS IN A MANNER SUCH THAT ACCESS IS NOT INTERRUPTED UNNECESSARILY. ACCESS SHALL BE PRESERVED IN THE BEST MANNER POSSIBLE. COORDINATION AND COMMUNICATION WITH LANDOWNERS MAY BE NECESSARY TO PREVENT INTERRUPTION OF DRIVEWAY ACCESS.
- ⑳ VEHICLE DETECTION SHALL BE USED IN CONJUNCTION WITH PORTABLE TRAFFIC SIGNALS.
- ㉑ TRAFFIC SIGNAL TIMINGS AND CLEARANCE INTERVALS TO BE APPROVED BY TRAFFIC ENGINEERING DIVISION PRIOR TO IMPLEMENTATION.
- ㉒ THE TEMPORARY PORTABLE TRAFFIC SIGNALS SHALL DISPLAY A MINIMUM OF TWO (2) SIGNAL HEADS FOR EACH APPROACH.
- ㉓ THE BUFFER SPACE SHOULD BE EXTENDED SO THAT THE TWO-WAY TRAFFIC TAPER IS PLACED BEFORE A HORIZONTAL OR VERTICAL (CREST) CURVETO PROVIDE ADEQUATE SIGHT DISTANCE FOR THE SIGNAL AND A QUEUE OF STOPPED VEHICLES.
- ㉔ MAINTAIN A MINIMUM DISTANCE OF 200' FOR SPACING BETWEEN SIGNS.
- ㉕ IF APPLICABLE, THE TEMPORARY TRAFFIC SIGNAL TRAILER SHOULD BE DELINEATED BY BARRELS OR CONES.

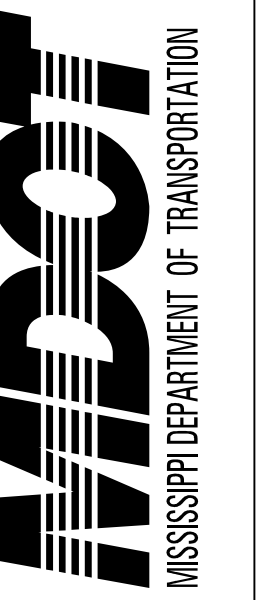

DESIGNED BY: WALDON

DETAILED BY:

CHECKED BY:

DATE:

FMS CON: 109573/301000

PROJECT NO.: STBG-0071-06(012)

COUNTY: TIPPAH

GENERAL NOTES

SHEET ID  
GN-1

SHEET NO.  
4