

STATE OF MISSISSIPPI
MISSISSIPPI DEPARTMENT OF TRANSPORTATION
PLAN AND PROFILE OF
PROPOSED STATE HIGHWAY
FEDERAL AID PROJECT NO. CRP-0024-04(031)
CRP-0024-04(032)
CRP-0024-04(033)
SR 15/SR 16 ROUNDABOUT
NESHOBA COUNTY

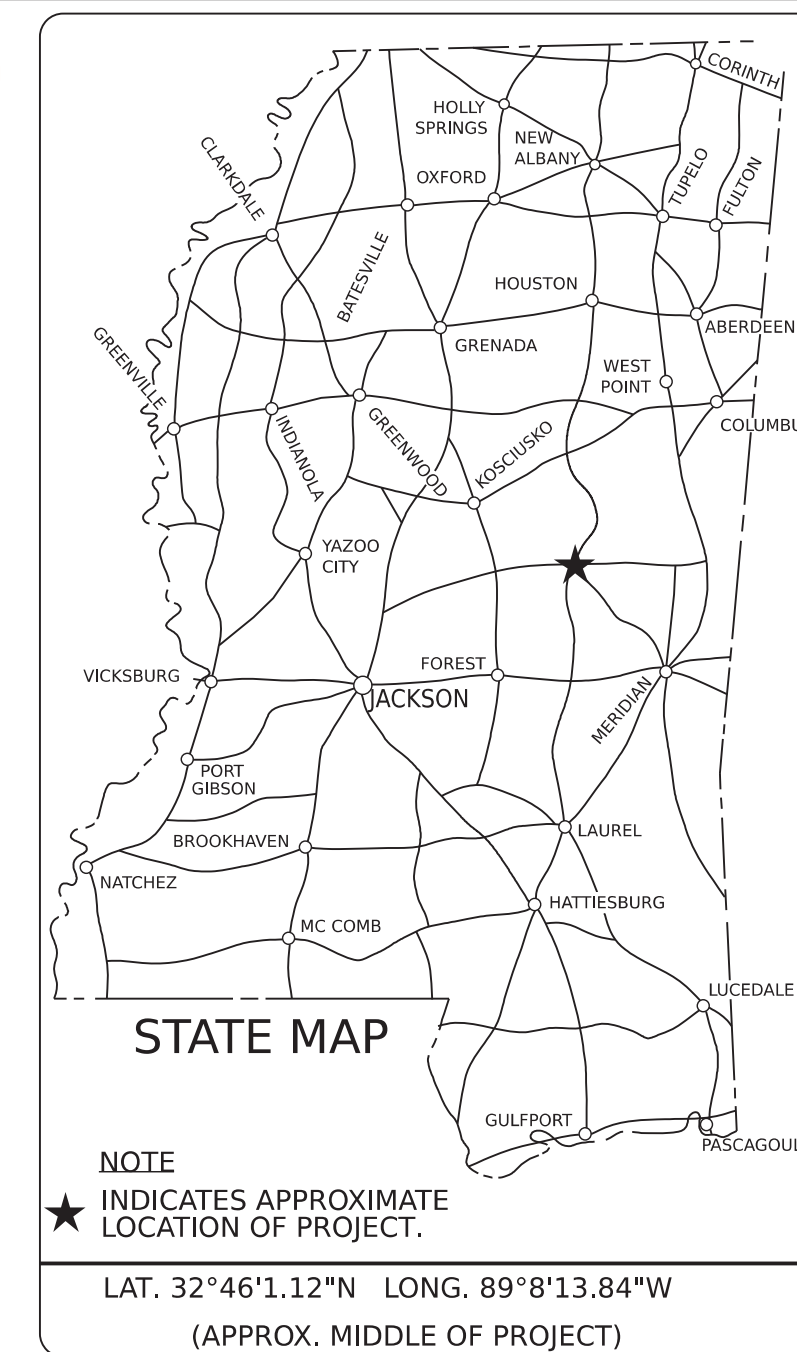

| GENERAL INDEX | |
|---|------------------|
| INCLUDED THIS PROJECT | BEGIN WITH SHEET |
| <input checked="" type="checkbox"/> ROADWAY..... | 1 |
| <input checked="" type="checkbox"/> PERMANENT SIGNS..... | 1001 |
| <input checked="" type="checkbox"/> TRAFFIC SIGNALS..... | 2001 |
| <input type="checkbox"/> ITS COMPONENTS..... | 3001 |
| <input checked="" type="checkbox"/> LIGHTING..... | 4001 |
| <input type="checkbox"/> (RESERVED)..... | 5001 |
| <input checked="" type="checkbox"/> ROADWAY STD. DWGS..... | 6001 |
| <input type="checkbox"/> BOX CULVERT STD. DWGS (LRFD)..... | 7001 |
| <input type="checkbox"/> BOX CULVERT STD. DWGS (STD. SPEC.).... | 7501 |
| <input checked="" type="checkbox"/> BRIDGE..... | 8001 |
| <input checked="" type="checkbox"/> CROSS SECTIONS..... | 9001 |

BRIDGE STRUCTURES REQ'D.
 LAKESIDE DR OVER KENTAWKA CREEK RELIEF
 STA. 13+79.31
 SPANS: 4@19'
 LENGTH: 76'
 WEYERHAEUSER ST OVER BRANCH
 STA. 12+35.97
 SPANS: 1@18', 1@31', 1@19'
 LENGTH: 69'

BOX BRIDGES REQ'D.
 NONE

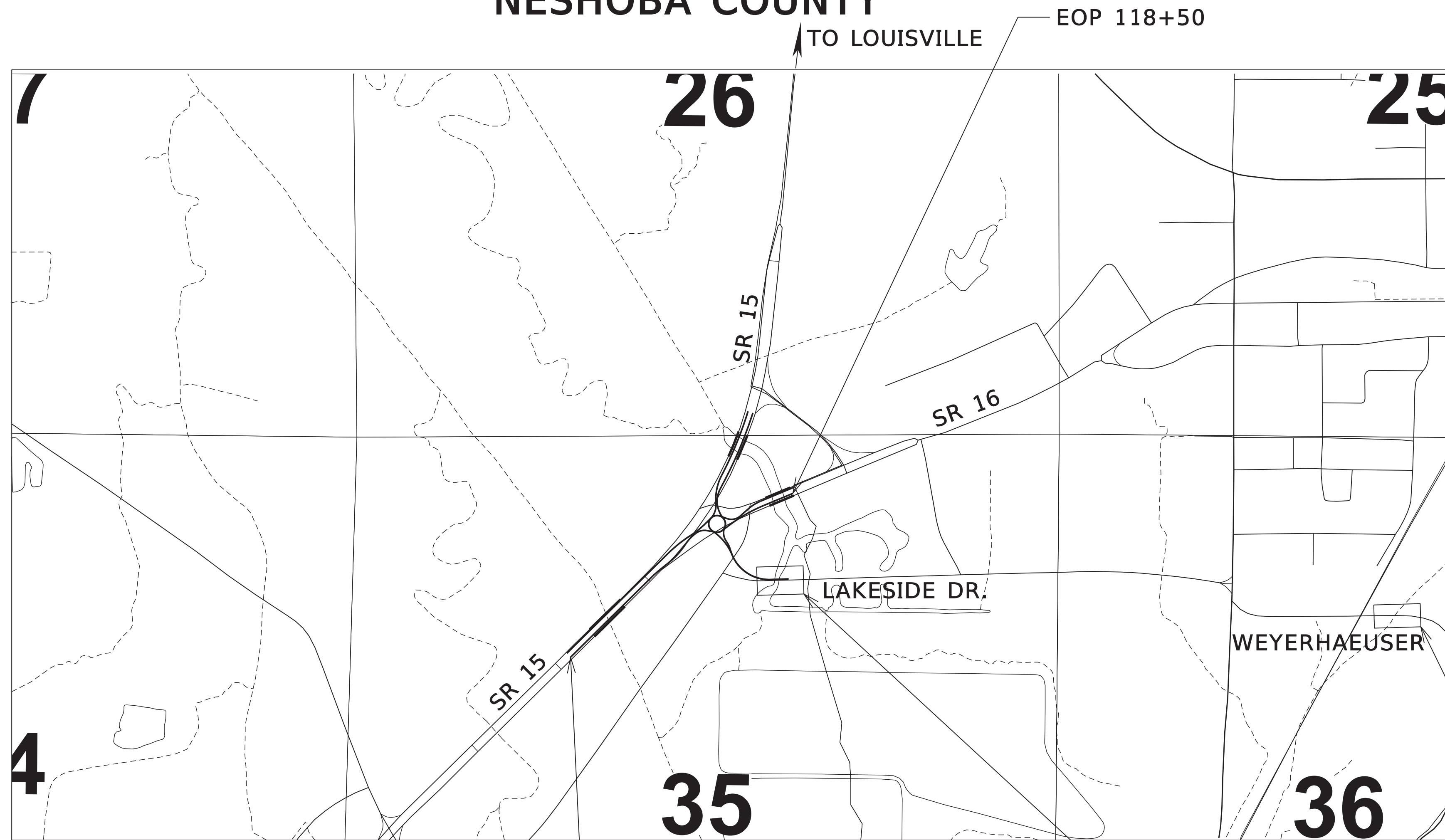

DESIGN CONTROL
 MPH = V (SPEED DESIGN)
 ADT (2025) = 20400 : ADT (2045) = 24900
 DHV = 2380 : D = 50 % T = 13 %

PERMITS ACQUIRED BY MDOT

| WETLANDS AND WATERS PERMITS | |
|---|---------------------------------------|
| | WATERS WETLANDS |
| NATIONWIDE #14 | <input type="checkbox"/> N |
| NATIONWIDE (OTHER)* | <input checked="" type="checkbox"/> Y |
| GENERAL* | <input type="checkbox"/> N |
| INDIVIDUAL (404)* | <input type="checkbox"/> N |
| STORMWATER PERMIT <input checked="" type="checkbox"/> A | |
| Y REQUIRED, CNOI SUBMITTED BY MDOT (DISTURBED AREA=5 ACRES) | |
| S REQUIRED, SCNOI TO BE SUBMITTED BY CONTRACTOR (1 TO 4.99 ACRES) | |
| N NO STORMWATER PERMIT REQUIRED (<1 ACRE) | |
| APPROVED BY: _____ | |

WEYERHAEUSER BRIDGE SITE
 B.O.P. = 12+35.97
 E.O.P. = 13+04.93

DESIGNED BY: VOLKERT, INC.

CONSTRUCTION PROJECT DATA

| | |
|-------------------------|--|
| EXTERNAL PROJECT NUMBER | CRP-0024-04(031) CRP-0024-04(032) CRP-0024-04(033) |
| FMS & DETAIL | 103896/303000 103896/303100 103896/303200 |

P S & E DATE: 10/23/2024
 APPROVED:
 DEPUTY EXECUTIVE DIRECTOR / CHIEF ENGINEER
 EXECUTIVE DIRECTOR

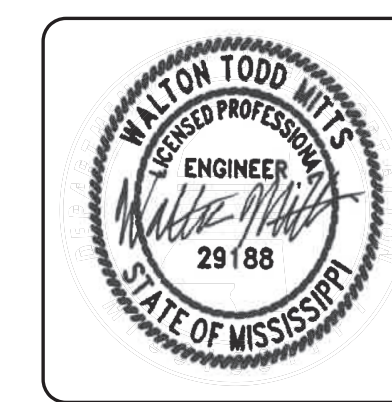

CONVENTIONAL SYMBOLS

- COUNTY LINE
- TOWN CORP LINE
- SECTION LINE
- DEED LINE
- EXISTING ROADWAY
- PROPOSED ROADWAY
- RAILROAD
- BRIDGES

LENGTH DATA

| | | |
|---------------------------|-------------|----------|
| LENGTH OF ROADWAY | 2194.92 FT. | 0.41 MI. |
| LENGTH OF BRIDGES | 145.00 FT. | 0.03 MI. |
| LENGTH OF PROJECT (NET) | 2339.92 FT. | 0.44 MI. |
| LENGTH OF EXCEPTIONS | FT. | MI. |
| LENGTH OF PROJECT (GROSS) | 2339.92 FT. | 0.44 MI. |

EQUATIONS
 NONE

EXCEPTIONS
 NONE

BOP 107+50
 SCALES
 PLAN 1 IN. = 100 FT.
 PROFILE 1 IN. = 100 FT.
 LAYOUT 1 IN. = 10 FT.
 VERT. 1 IN. = 600 FT.

PLAN SHEET

DATE 12:55:37 PM TITLE_SH.dgn

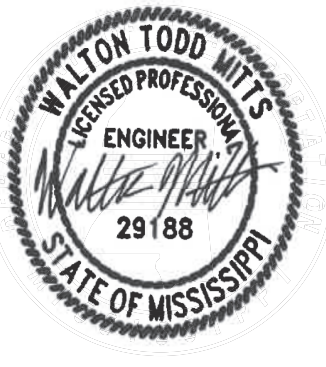

| SUMMARY OF REVISIONS | | | | | | |
|----------------------|-----------|----------|-----------|---------|----------|----------------------------|
| DATE | 1st ORDER | ADDENDUM | 2nd ORDER | BY | SHEET ID | DESCRIPTION |
| 11-12-24 | X | | | VOLKERT | TITLE | STORMWATER PERMIT UPDATED. |
| 11-12-24 | X | | | VOLKERT | SQ-1 | UPDATED GRASSING QUANTITY. |
| 11-12-24 | X | | | VOLKERT | SQ-2 | UPDATED GRASSING QUANTITY. |
| 11-12-24 | X | | | VOLKERT | SQ-3 | UPDATED GRASSING QUANTITY. |
| 11-12-24 | X | | | VOLKERT | SQ-4 | UPDATED GRASSING QUANTITY. |
| 11-12-24 | X | | | VOLKERT | SQ-5 | UPDATED GRASSING QUANTITY. |
| 11-12-24 | X | | | VOLKERT | SQ-6 | UPDATED GRASSING QUANTITY. |
| 11-12-24 | X | | | VOLKERT | SQ-7 | UPDATED GRASSING QUANTITY. |
| 11-12-24 | X | | | VOLKERT | SQ-8 | UPDATED GRASSING QUANTITY. |
| 11-12-24 | X | | | VOLKERT | SQ-9 | UPDATED GRASSING QUANTITY. |
| 11-12-24 | X | | | VOLKERT | SQ-10 | UPDATED GRASSING QUANTITY. |
| 11-12-24 | X | | | VOLKERT | SQ-11 | UPDATED GRASSING QUANTITY. |

PLAN SHEET

11/11/2024 2:05:03 PM Sheet-Revisions.dgn

| | |
|-------------------------------|--------------|
| FMS CON: 103896/303000 | DESIGNED BY: |
| PROJECT NO.: CRP-0024-04(031) | DETAILED BY: |
| COUNTY: NESHOMA | CHECKED BY: |
| | DATE: |

| |
|-----------------|
| REVISION |
|-----------------|

| |
|--------------------------|
| SHEET ID REV-1 |
| SHEET NO. 2 |

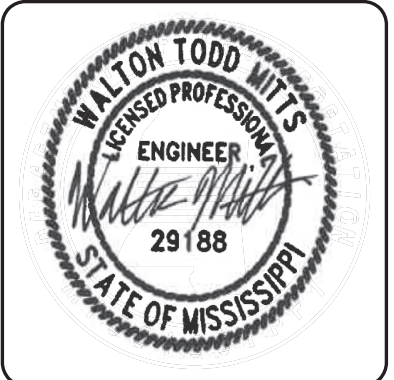

DESIGNED BY:
 DETAILED BY:
 CHECKED BY:
 DATE:

FMS CON: 103896/303000
 PROJECT NO.: CRP-0024-04(031)
 COUNTY: NESHOMA

DETAILED INDEX

SHEET ID
DI-1
 SHEET NO.
3

| DESCRIPTION OF SHEET | WORKING NO. | SHEET NO. | DESCRIPTION OF SHEET | WORKING NO. | SHEET NO. |
|---|-------------|-----------|--|-------------|-----------|
| <u>TITLE SHEET</u> | | 1 | <u>PLAN & PROFILE SHEETS (9)</u> | | |
| <u>REVISION</u> | REV-1 | 2 | SR 15/SR 16 EASTBOUND | WK-3 | 36 |
| | | | SR 15/SR 16 WESTBOUND | WK-4 | 37 |
| <u>DETAILED INDEX AND GENERAL NOTES (5)</u> | | | LAKESIDE-SR 15 NORTHBOUND | WK-5 | 38 |
| | | | LAKESIDE-SR 15 SOUTHBOUND | WK-6 | 39 |
| DETAILED INDEX | DI-1 | 3 | CIRCULATORY ROADWAY | WK-7 | 40 |
| DETAILED INDEX | DI-2 | 4 | CR 375 | WK-8 | 41 |
| DETAILED INDEX | DI-3 | 5 | SR 15/SR 16 BYPASS | WK-9 | 42 |
| GENERAL NOTES | GN-1 | 6 | LAKESIDE BRIDGE SITE | WK-10 | 43 |
| GENERAL NOTES | GN-2 | 7 | WEYERHAEUSER BRIDGE SITE | WK-11 | 44 |
| <u>TYPICAL SECTIONS (10)</u> | | | <u>INTERSECTION DETAIL SHEETS (3)</u> | | |
| LAKESIDE NEW CONSTRUCTION & WIDENING | TS-1 | 8 | INTERSECTION DETAILS | ID-1 | 45 |
| LAKESIDE NEW CONSTRUCTION | TS-2 | 9 | INTERSECTION DETAILS | ID-2 | 46 |
| 15-16 BOP | TS-3 | 10 | INTERSECTION DETAILS | ID-3 | 47 |
| 15-16 BOP SPLITTER ISLAND | TS-4 | 11 | | | |
| 15-16 EOP SPLITTER ISLAND | TS-5 | 12 | <u>FORM GRADES (4)</u> | | |
| 15-16 EOP | TS-6 | 13 | | | |
| ROUNDAABOUT, CR 375 | TS-7 | 14 | FORM GRADES | FG-1 | 48 |
| 15-16 BYPASS | TS-8 | 15 | FORM GRADES | FG-2 | 49 |
| 15-16 OVERLAY | TS-9 | 16 | FORM GRADES | FG-3 | 50 |
| 15-16 OVERLAY , SR 885 OVERLAY | TS-10 | 17 | FORM GRADES | FG-4 | 51 |
| <u>QUANTITY SHEETS (18)</u> | | | <u>TRAFFIC CONTROL SHEETS (25)</u> | | |
| SUMMARY OF QUANTITIES | SQ-1 | 18 | SEQUENCE OF CONSTRUCTION | SC-1 | 52 |
| SUMMARY OF QUANTITIES | SQ-2 | 19 | SEQUENCE OF CONSTRUCTION | SC-2 | 53 |
| SUMMARY OF QUANTITIES | SQ-3 | 20 | SEQUENCE OF CONSTRUCTION | SC-3 | 54 |
| SUMMARY OF QUANTITIES | SQ-4 | 21 | SEQUENCE OF CONSTRUCTION | SC-4 | 55 |
| SUMMARY OF QUANTITIES | SQ-5 | 22 | DETAIL OF CONSTRUCTION SIGNING | DCS-1 | 56 |
| SUMMARY OF QUANTITIES | SQ-6 | 23 | DETAIL OF CONSTRUCTION SIGNING - LAKESIDE DRIVE BRIDGE | DCS-2 | 57 |
| SUMMARY OF QUANTITIES | SQ-7 | 24 | DETAIL OF CONSTRUCTION SIGNING - WEYERHAEUSER BRIDGE | DCS-3 | 58 |
| SUMMARY OF QUANTITIES | SQ-8 | 25 | TRAFFIC CONTROL - PHASE 1-1 | TC-1 | 59 |
| SUMMARY OF QUANTITIES | SQ-9 | 26 | TRAFFIC CONTROL - PHASE 1-2 | TC-2 | 60 |
| SUMMARY OF QUANTITIES | SQ-10 | 27 | TRAFFIC CONTROL - PHASE 2-1 | TC-3 | 61 |
| SUMMARY OF QUANTITIES | SQ-11 | 28 | TRAFFIC CONTROL - PHASE 2-2 | TC-4 | 62 |
| ESTIMATED QUANTITIES | EQ-1 | 29 | TRAFFIC CONTROL - PHASE 2-3 | TC-5 | 63 |
| ESTIMATED QUANTITIES | EQ-2 | 30 | TRAFFIC CONTROL - PHASE 2-4 | TC-6 | 64 |
| ESTIMATED QUANTITIES | EQ-3 | 31 | TRAFFIC CONTROL - PHASE 2A-1 | TC-7 | 65 |
| ESTIMATED QUANTITIES | EQ-4 | 32 | TRAFFIC CONTROL - PHASE 2A-2 | TC-8 | 66 |
| ESTIMATED QUANTITIES | EQ-5 | 33 | TRAFFIC CONTROL - PHASE 2A-3 | TC-9 | 67 |
| ESTIMATED QUANTITIES | EQ-6 | 34 | TRAFFIC CONTROL - PHASE 2A-4 | TC-10 | 68 |
| TRAFFIC CONTROL SIGNS | TCPQ-1 | 35 | TRAFFIC CONTROL - PHASE 3-1 | TC-11 | 69 |

PLAN SHEET

10/21/2024 10:59:46 PM Sheet-Detailed Index.dgn

| DESCRIPTION OF SHEET | WORKING NO. | SHEET NO. | DESCRIPTION OF SHEET | WORKING NO. | SHEET NO. |
|---|-------------|-----------|---|-------------|-----------|
| <u>STANDARD DRAWING SHEETS (CONT.)</u> | | | <u>DETAILS OF PAVED FLUMES</u> | | |
| INLET PROTECTION DETAILS | ECD-12 | 6112 | PIPE CULVERT INSTALLATION | PF-1 | 6426 |
| INLET PROTECTION OF WATTLES | ECD-13 | 6113 | STORM SEWER INLET - TYPE SS-2 | PI-1 | 6501 |
| INLET PROTECTION DEVICE | ECD-14 | 6114 | FLARED END SECTION FOR CONCRETE PIPE | SS-2 | 6524 |
| INLET PROTECTION DETAILS OF SANDBAGS | ECD-15 | 6115 | FLARED END SECTION FOR CONCRETE ARCH PIPE | FE-1 | 6530 |
| STABILIZED CONSTRUCTION ENTRANCE | ECD-16 | 6116 | | FE-1A | 6531 |
| DETAILS OF TYPICAL DITCH TREATMENTS | DT-1 | 6123 | <u>CROSS-SECTION SHEETS (17)</u> | | |
| DITCH TREATMENT INSTALLATION DETAIL FOR SOIL REINF. MAT | DT-1A | 6124 | 15-16 EASTBOUND - STA. 106+00 TO 111+50 | | 9001 |
| GUARDRAIL: "W" BEAM (WOOD POST) | GR-1 | 6201 | 15-16 EASTBOUND - STA. 112+50 TO 114+00 | | 9002 |
| GUARDRAIL: THRIE BEAM (WOOD POST) | GR-1A | 6202 | 15-16 EASTBOUND - STA. 116+00 TO 117+50 | | 9003 |
| GUARDRAIL: THRIE BEAM (STEEL POST) | GR-1B | 6203 | 15-16 EASTBOUND - STA. 118+00 TO 119+00 | | 9004 |
| GUARDRAIL: BRIDGE END SECTION TYPE I (WOOD POST) | GR-2F | 6210 | 15-16 WESTBOUND - STA. 156+50 TO 160+00 | | 9005 |
| GUARDRAIL: BRIDGE END SECTION TYPE I (STEEL POST) | GR-2G | 6211 | 15-16 WESTBOUND - STA. 160+50 TO 162+00 | | 9006 |
| GUARDRAIL: RUB RAIL HARDWARE | GR-RR | 6218 | 15-16 WESTBOUND - STA. 162+50 TO 168+00 | | 9007 |
| GUARDRAIL: MISCELLANEOUS HARDWARE | GR-HW | 6221 | 15-16 WESTBOUND - STA. 168+50 TO 169+50 | | 9008 |
| STANDARD ROADSIDE SIGNS | SN-3 | 6303 | LAKESIDE-15 NORTHBOUND - STA. 201+00 TO 205+00 | | 9009 |
| STANDARD ROADSIDE SIGNS | SN-3A | 6304 | LAKESIDE-15 NORTHBOUND - STA. 205+50 TO 206+50 | | 9010 |
| STANDARD ROADSIDE SIGNS | SN-3B | 6305 | LAKESIDE-15 NORTHBOUND - STA. 209+00 TO 212+00 | | 9011 |
| STANDARD ROADSIDE SIGN ASSEMBLY | SN-4 | 6306 | LAKESIDE-15 SOUTHBOUND - STA. 255+50 TO 260+50 | | 9012 |
| STANDARD ROADSIDE SIGN ASSEMBLY | SN-4A | 6307 | LAKESIDE-15 SOUTHBOUND - STA. 261+00 TO 263+00 | | 9013 |
| STANDARD ROADSIDE SIGN ASSEMBLY | SN-4B | 6308 | CR 375 - STA 723+50 TO 727+00 | | 9014 |
| TYPICAL INSTALLATION OF GROUND MOUNTED DIRECTIONAL | SN-5 | 6309 | CR 375 - STA 727+50 TO 727+50 | | 9015 |
| TYPICAL GUARDRAIL DELINEATION | SN-8C | 6317 | CIRCULATORY ROADWAY - STA. 300+00 TO 303+50 | | 9016 |
| TRAFFIC CONTROL PLAN WITH FLAGGER | TCP-1 | 6351 | CIRCULATORY ROADWAY - STA. 305+95.84 TO 303+95.84 | | 9017 |
| SHORT DURATION CLOSING | TCP-6 | 6356 | | | |
| HIGHWAY SIGN AND BARRIADADE DETAILS | TCP-8 | 6358 | | | |
| TRAFFIC CONTROL FOR MOBILE OPERATIONS | TCP-9 | 6359 | | | |
| DETAILS OF OUTSIDE LANE CLOSURE AT RAMPS | TCP-10 | 6360 | | | |
| TRAFFIC CONTROL PLAN: UNEVEN PAVEMENT | TCP-12 | 6362 | | | |
| TEMPORARY STRIPING FOR TRAFFIC CONTROL | TCP-13 | 6363 | | | |
| TRAFFIC CONTROL DETAILS DRUM PLACEMENT | TCP-16 | 6366 | | | |
| RURAL DRIVEWAYS | RD-1 | 6403 | | | |
| DRIVEWAYS, CURB & GUTTER, SIDEWALK | SD-1 | 6419 | | | |
| DRIVEWAYS, INTEGRAL CURB, SIDEWALK | SD-2 | 6420 | | | |
| | | | TOTAL SHEETS (194) | | |

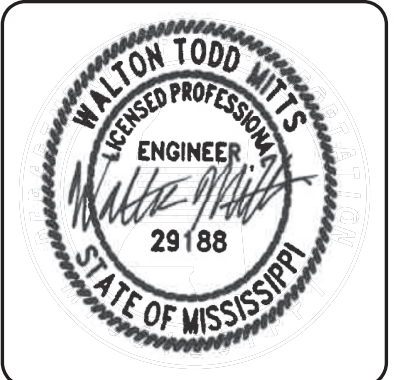

DESIGNED BY:
 DETAILED BY:
 CHECKED BY:
 DATE:

FMS CON: 103896/303000
 PROJECT NO.: CRP-0024-04(031)
 COUNTY: NESHOMA

DETAILED INDEX

SHEET ID
DI-3
 SHEET NO.
5

GENERAL NOTES

BRIDGES AND WALLS

- (1) STORAGE OF FLAMMABLE MATERIALS WILL NOT BE ALLOWED UNDER ANY BRIDGE STRUCTURES WITHOUT WRITTEN APPROVAL FROM THE PROJECT ENGINEER. SEE NOTICE TO BIDDERS ENTITLED "MATERIAL STORAGE UNDER BRIDGES" FOR MORE INFORMATION.

DRAINAGE STRUCTURES

- (2) ALL PIPE JOINTS ARE TO BE WRAPPED IN 24-INCH WIDE TYPE V GEOTEXTILE FABRIC. ALL PICKUP HOLES SHALL BE PLUGGED AND COVERED WITH TYPE V GEOTEXTILE FABRIC, THE COST OF WHICH SHALL BE ABSORBED IN OTHER ITEMS BID.
- (3) THE COST FOR REMOVAL OF ALL HEADWALLS AND WINGWALLS (PIPES, BOX CULVERTS, BOX BRIDGES) SHALL BE ABSORBED IN OTHER ITEMS BID.
- (4) THE CONTRACTOR SHALL BE RESPONSIBLE FOR PROTECTING EXISTING STRUCTURES SUCH AS, BUT NOT LIMITED TO, PIPES, INLETS, APRONS, AND BRIDGES FROM DAMAGE WHICH MIGHT OCCUR DURING CONSTRUCTION. THE CONTRACTOR SHALL REPLACE OR REPAIR, AS DIRECTED BY THE ENGINEER, ANY STRUCTURES DAMAGED DURING THE LIFE OF THE CONTRACT. NO PAYMENT WILL BE MADE FOR REPLACEMENT OR REPAIR OF DAMAGED ITEMS.
- (5) THE COST OF ANY COLLARS REQUIRED TO CONNECT CONCRETE FLARED END SECTIONS TO NON-CONCRETE PIPE SECTIONS SHALL BE ABSORBED IN THE COST FOR NON-CONCRETE PIPE.
- (6) CURB AND GUTTER VERTICAL DIMENSIONS SHOWN IN THE DETAIL DRAWINGS ARE FOR A CURB IN THE "CATCH" CONFIGURATION AND SHALL BE CONSIDERED TO BE MINIMUM DIMENSIONS. THE DIMENSIONS MAY BE MODIFIED AS NECESSARY FOR "SPILL" CURB AND GUTTER, BUT SHALL NOT BE LESS THAN THE MINIMUM SHOWN.
- (7) CURB AND GUTTER VERTICAL DIMENSIONS SHOWN IN THE DETAIL DRAWINGS ARE FOR A CURB IN THE "CATCH" CONFIGURATION AND SHALL BE CONSIDERED TO BE MINIMUM DIMENSIONS. THE DIMENSIONS MAY BE MODIFIED AS NECESSARY FOR "SPILL" CURB AND GUTTER, BUT SHALL NOT BE LESS THAN THE MINIMUM SHOWN.

EARTHWORK

- (8) 25% SHRINKAGE FACTOR USED IN THE EARTHWORK CALCULATIONS IS FOR DESIGN ESTIMATING PURPOSES ONLY.
- (9) THE TOP THREE FEET AND VARIABLE OF THE DESIGN SOILS (BOTH NATURAL AND EMBANKMENT) SHALL BE CONSTRUCTED OF SOIL CLASSIFIED AS B15 OR BETTER, PER MDOT SPECIFICATIONS 703.21, EXCEPT AT UNDERCUT LOCATIONS DESIGNATED ON THE PLANS OR AS DIRECTED BY THE ENGINEER TO RECEIVE CLASS B-15 BORROW EXCAVATION. EXTREME CARE SHALL BE EXERCISED IN UNDERCUT AREAS, AND THE UNDERCUT DEPTH MAY BE ADJUSTED AT CROSS DRAINS AS DIRECTED BY THE ENGINEER. FOR ADDITIONAL DETAILS THE CONTRACTOR IS REFERRED TO THE NOTICE TO BIDDERS ON DESIGN SOIL MATERIAL IN THE CONTRACT PROPOSAL DOCUMENT.
- (10) VOIDS CREATED BY THE REMOVAL OF, BUT NOT LIMITED TO, POSTS, CONCRETE ANCHORS, AND FOOTINGS SHALL BE BACKFILLED AND TAMPED IN ACCORDANCE WITH SECTION 203 OF **THE MISSISSIPPI STANDARD SPECIFICATIONS FOR ROAD AND BRIDGE CONSTRUCTION**, THE COST OF WHICH WILL BE ABSORBED IN OTHER ITEMS BID.
- (11) WORK ON STRUCTURES FOR THIS PROJECT REQUIRES EXCAVATION IN THE IMMEDIATE VICINITY OF TRAFFIC AND ADJACENT PROPERTIES. THEREFORE, THE RISK OF A FAILURE OCCURRING DURING EXCAVATION REQUIRES THAT EXTREME CAUTION BE EXERCISED. THE CONTRACTOR SHALL BE RESPONSIBLE FOR PLACING WHAT BRACING, SHORING, OR GROUND SUPPORT SYSTEM THAT IS DEEMED NECESSARY TO PREVENT A FAILURE AND PROTECT THE PERSONS WORKING NEAR THE EXCAVATION, THE PUBLIC THAT MAY BE ABOVE THE EXCAVATION, OR ANY STRUCTURES ADJACENT TO THE EXCAVATION. ALL COSTS FOR DESIGNING, DRAWING, AND CONSTRUCTING THE FACILITY SHALL BE INCLUDED IN THE PRICE BID FOR CONTRACT ITEMS.
- (12) VEGETATIVE MATERIAL WILL BE REMOVED PRIOR TO PLACEMENT OF GRANULAR MATERIAL. THE COST OF WHICH SHALL BE ABSORBED IN OTHER ITEMS BID.
- (13) PRIOR TO EARTHWORK OPERATIONS, THE EXISTING TOP 4" TOPSOIL IS TO BE STRIPPED AND STOCKPILED. AFTER THE GRADING OPERATIONS ARE COMPLETED, SAID TOPSOIL SHALL BE PLACED ON ALL AREAS THAT ARE NOT TO BE PAVED OR OTHERWISE PROTECTED, IN ACCORDANCE WITH SECTION 211 OF THE SPECIFICATIONS, OR THE VEGETATION SCHEDULE (SEE WK. SH. VS-1). EXISTING TOPSOIL AND ALL COSTS ASSOCIATED WITH STRIPPING, HAULING, STOCKPILING, AND PLACEMENT OF THE EXISTING TOPSOIL IS TO BE ABSORBED IN OTHER EARTHWORK ITEMS.

GENERAL NOTES (CONT'D)

EROSION CONTROL - TEMPORARY

- (14) WIRE FENCE BACKING WILL BE REQUIRED FOR ALL SILT FENCE. (SEE WK. NO. ECD-3)
- (15) THE EROSION CONTROL DEVICES REFERENCED IN THESE PLANS ARE A MINIMUM REQUIREMENT. IT IS THE RESPONSIBILITY OF THE CONTRACTOR TO ENSURE THAT SILT DOES NOT LEAVE THE RIGHT OF WAY OR CONTAMINATE WATERS OF THE U. S. DURING CONSTRUCTION. THE CONTRACTOR SHALL SUBMIT AN EROSION CONTROL PLAN PRIOR TO COMMENCEMENT OF WORK AND MAINTAIN THE PLAN DURING CONSTRUCTION. ANY ADDITIONAL SILT BASINS NOT SHOWN IN THE PLANS SHALL BE INCLUDED IN THE CONTRACTOR'S EROSION CONTROL PLAN PRIOR TO SUBMITTING FOR APPROVAL.
- (16) ALL ITEMS OF WORK ASSOCIATED WITH THE INSTALLATION OF A CONSTRUCTION ENTRANCE SHALL BE ABSORBED IN OTHER ITEMS OF WORK.

ENVIRONMENTAL & CLEARING

- (17) NO TEMPORARY CULVERT STREAM CROSSINGS WILL BE ALLOWED.

PAVEMENT, BASE, AND SHOULDERS

- (18) THE CONTRACTOR SHALL REPAIR ANY DAMAGE TO THE PAVED OR UNPAVED SHOULDER THAT MIGHT OCCUR DURING CONSTRUCTION. ANY REPAIR TO SHOULDER WILL BE IN ACCORDANCE WITH THE APPLICABLE SECTIONS OF **THE MISSISSIPPI STANDARD SPECIFICATIONS FOR ROAD AND BRIDGE CONSTRUCTION**. NO PAYMENT WILL BE MADE FOR REPAIR OF DAMAGED SHOULDER.
- (19) TEMPORARY PAVEMENT JOINTS (PAPER JOINTS) SHALL BE EMPLOYED AT ALL LOCATIONS REQUIRING TRAFFIC TO TRAVERSE AN UNEVEN PAVEMENT JOINT. PAPER JOINTS SHALL BE A MINIMUM OF OF 9 FEET IN LENGTH AND SHALL BE ADEQUATELY MAINTAINED.
- (20) WHERE MILLING IS REQUIRED, THE CONTRACTOR SHALL PROVIDE OUTLETS IN THE EXISTING SHOULDERS AT SUFFICIENT INTERVALS TO PREVENT POOLING OR STANDING WATER ON THE MILLED SURFACE, THE COST OF WHICH SHALL BE ABSORBED IN OTHER ITEMS BID.

PLANS

- (21) IF COLORS ARE USED ON PLAN/PROFILE SHEETS, THEY ARE INTENDED TO VISUALLY EASE THE LOCATION OF ELEMENTS FOR USERS OF THESE DRAWINGS. ALTHOUGH THE INTENT IS TO CATEGORIZE EVERYTHING AS EITHER EXISTING OR PROPOSED, IT IS THE END USER'S RESPONSIBILITY TO ENSURE ALL ELEMENTS ARE INTERPRETED CORRECTLY, REGARDLESS OF COLOR.
- (22) ALL ADDENDA TO THESE PLANS WILL BE POSTED TO WWW.MDOT.MS.GOV UNDER THE PROPOSAL ADDENDA COLUMN. BIDDERS ARE ADVISED THAT HARD COPIES OF ANY ADDENDA FOR THIS PROJECT WILL NOT BE MAILED. IT IS THE BIDDER'S RESPONSIBILITY TO CHECK AND SEE IF ANY ADDENDA HAVE BEEN POSTED FOR THIS PROJECT.
- (23) SEE BRIDGE PLANS FOR DETAILED INDEX SHEET(S), ESTIMATED AND SUMMARY OF QUANTITY SHEETS, AND EROSION CONTROL SHEETS.

ROADSIDE BARRIERS

- (24) ALL DIMENSIONS AND SPACINGS FOR BRIDGE RAIL CONNECTORS SHALL BE VERIFIED IN THE FIELD BY THE CONTRACTOR PRIOR TO FABRICATION.

TRAFFIC CONTROL - PERMANENT

- (25) INSTALLATION DATES SHALL BE CLEARLY WRITTEN IN BOLD BLACK MARKINGS ON THE BACK BOTTOM HALF OF ALL SIGNS WITH A PERMANENT MARKING STICK THAT IS WATERPROOF, FADE RESISTANT AND MARKS ON WET OR DRY SURFACES.
- (26) ALL POST, PIPE, AND I-BEAM LENGTHS IN THESE PLANS ARE ESTIMATES. POST LENGTHS FOR ALL SIGNS SHALL BE VERIFIED IN THE FIELD BY THE CONTRACTOR PRIOR TO FABRICATION.
- (27) ALL EXISTING SIGNS WHICH ARE TO BE REMOVED AS A PART OF THIS PROJECT THAT ARE NOT IN CONFLICT WITH CONSTRUCTION SHALL REMAIN IN PLACE UNTIL NEW SIGNS ARE INSTALLED UNLESS NOTED OR DIRECTED OTHERWISE BY THE PROJECT ENGINEER. ROADWAY SIGNS THAT ARE IN CONFLICT WITH CONSTRUCTION SHALL BE REMOVED AND RELOCATED BY THE CONTRACTOR AS DIRECTED BY THE ENGINEER, THE COST OF WHICH SHALL BE ABSORBED IN OTHER ITEMS BID.

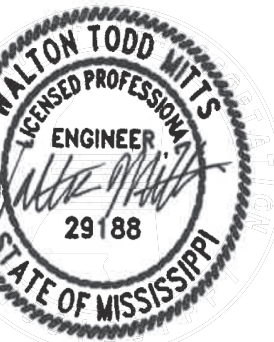

DESIGNED BY:
 DETAILED BY:
 CHECKED BY:
 DATE:

FMS CON: 103896/303000

PROJECT NO.: CRP-0024-04(031)

COUNTY: NESHOMA

GENERAL NOTES

SHEET ID
GN-1

SHEET NO.
6

GENERAL NOTES (CONT'D)

- (28) DIRECT-APPLIED LEGEND, BORDER, AND/OR SHIELDS ARE TO BE USED ON ALL GUIDE SIGNS. DIGITALLY PRODUCED SIGN COPY, SHIELDS, LEGEND, SYMBOLS, OR IMAGES WILL NOT BE ALLOWED WITHOUT WRITTEN APPROVAL FROM MDOT'S PROJECT ENGINEER.
- (29) ALL PERMANENT SIGNS SHALL CONFORM TO THE LATEST EDITION OF THE MANUAL ON UNIFORM TRAFFIC CONTROL DEVICES.
- (30) ALL SIGN LOCATIONS SHALL BE APPROVED BY THE PROJECT ENGINEER PRIOR TO INSTALLATION.
- (31) THE RETROREFLECTIVE SIGN SHEETING ON PERMANENT GROUND-MOUNTED SIGNS SHALL BE AS FOLLOWS: BROWN BACKGROUND SHEETING ON GUIDE SIGNS SHALL BE MINIMUM TYPE VIII; GREEN AND BLUE BACKGROUND SHEETING ON GUIDE SIGNS SHALL BE MINIMUM TYPE IX; ALL WHITE, YELLOW, FLUORESCENT YELLOW AND FLUORESCENT YELLOW/GREEN SHEETING SHALL BE TYPE XI. ALL SIGN SHEETING ON OVERHEAD SIGNS SHALL BE TYPE XI.
- (32) ALL EXISTING SIGNS AND SUPPORTS REMOVED UNDER THIS PROJECT SHALL BECOME THE PROPERTY OF THE CONTRACTOR AND ARE NOT A SEPARATE PAY ITEM.
- (33) ALL SIDE ROAD, STOP SIGN MOUNTED STREET NAME SIGNS TO BE SALVAGED AND STORED AT THE DIRECTION OF THE PROJECT ENGINEER FOR DELIVERY TO THE CITY (NOT A SEPARATE PAY ITEM).
- (34) REMOVAL OF RAISED PAVEMENT MARKERS THAT ARE IN CONFLICT WITH REQUIRED CONSTRUCTION IS NOT CONSIDERED A SEPARATE PAY ITEM. COST TO BE ABSORBED IN OTHER ITEMS BID.
- (35) REMOVAL OF OBJECT MARKERS IS NOT CONSIDERED A SEPARATE PAY ITEM, AND SHALL BE ABSORBED IN OTHER ITEMS BID.

TRAFFIC CONTROL - TEMPORARY

- (36) THE LOCATION AND SPACING OF SIGNS, SHOWN ON THE TRAFFIC CONTROL PLANS, ARE APPROXIMATE AND MAY BE ADJUSTED AS NECESSARY TO FIT FIELD CONDITIONS.
- (37) ALL TRAFFIC CONTROL DEVICES ON THIS PROJECT SHALL COMPLY WITH PART VI OF THE **MUTCD** (LATEST EDITION).
- (38) ALL PLASTIC DRUMS SHALL HAVE A BALLASTING COLLAR MADE FROM RECYCLED TRUCK TIRES OR OTHER SUITABLE MATERIAL.
- (39) FLUORESCENT ORANGE SHEETING SHALL BE USED ON ALL CONSTRUCTION AND TRAFFIC CONTROL SIGNS EXCEPT FOR THOSE DESIGNATED ON THE PLANS TO BE BLACK LEGEND AND BORDER ON WHITE BACKGROUND.
- (40) THE CONTRACTOR SHALL COORDINATE WITH THE CONTRACTOR FROM ADJACENT PROJECT(S) IN IMPLEMENTING THE TRAFFIC CONTROL PLAN AS DIRECTED BY THE ENGINEER. ALL CONFLICTING SIGNS SHALL BE COVERED OR REMOVED AS DIRECTED BY THE ENGINEER.
- (41) THE CONTRACTOR SHALL COVER OR REMOVE ANY TEMPORARY TRAFFIC CONTROL SIGNS SHOWN IN THE TRAFFIC CONTROL PLAN THAT DO NOT APPLY TO THE CURRENT PHASE.
- (42) THE RETROREFLECTIVE SIGN SHEETING ON RIGID, TEMPORARY TRAFFIC CONTROL (ORANGE) SIGNS SHALL BE MINIMUM TYPE IX.
- (43) TEMPORARY STRIPING SHALL CONFORM TO FINISHED STRIPE SPECIFICATIONS FOR ALIGNMENT, NEATNESS, AND STRAIGHTNESS.

UTILITIES

- (44) UTILITIES ON THE DRAWINGS ARE SHOWN IN THEIR ORIGINAL LOCATION BASED UPON THE BEST INFORMATION AVAILABLE TO THE ENGINEER. UTILITIES THAT WERE FOUND TO BE IN CONFLICT WITH CONSTRUCTION HAVE BEEN RELOCATED. PERMITS ARE ON FILE WITH THE DEPARTMENT SHOWING THE APPROXIMATE LOCATION OF UTILITIES RELOCATED WITHIN THE RIGHT-OF-WAY. THE ENGINEER CAN NOT AND DOES NOT WARRANT THAT THIS INFORMATION IS COMPLETE OR ACCURATE. THE CONTRACTOR MUST COORDINATE DIRECTLY WITH THE INVOLVED UTILITY OWNERS TO HAVE UNDERGROUND UTILITY LINES FIELD LOCATED IN ADVANCE OF CONSTRUCTION.
- (45) FOR LIST OF PUBLIC UTILITIES, SEE WORKING NO. 3.

GENERAL NOTES (CONT'D)

MISCELLANEOUS

- (46) SOME WORK IS REQUIRED OUTSIDE THE PROJECT LIMITS. NO ADDITIONAL COMPENSATION WILL BE MADE FOR SUCH WORK EXCEPT AS PROVIDED BY SPECIFIC PAY ITEMS INCLUDED IN THE PLANS.
- (47) THE CONTRACTOR SHALL BE RESPONSIBLE FOR MAINTAINING AND RELOCATING MAIL BOXES AS NECESSARY TO MAINTAIN CONTINUOUS MAIL SERVICE THROUGHOUT THE LIFE OF THE PROJECT, THE COST OF WHICH SHALL BE ABSORBED IN OTHER ITEMS BID.
- (48) THE CONTRACTOR IS RESPONSIBLE FOR FIELD-VERIFICATION OF EXISTING GRADES AND MAKING ADJUSTMENTS AS NECESSARY WITH THE APPROVAL OF THE PROJECT ENGINEER.
- (49) THE CONTRACTOR SHALL COORDINATE AND CONDUCT WORK AT LOCAL ROADS AND DRIVEWAYS IN A MANNER SUCH THAT ACCESS IS NOT INTERRUPTED UNNECESSARILY. ACCESS SHALL BE PRESERVED IN THE BEST MANNER POSSIBLE. COORDINATION AND COMMUNICATION WITH LANDOWNERS MAY BE NECESSARY TO PREVENT INTERRUPTION OF DRIVEWAY ACCESS.
- (50) ALL REFERENCE TO STP-0024-04(031), STP-0024-04(032), AND STP-0024-04(033) IS UNDERSTOOD TO REFER TO CRP-0024-04(031), CRP-0024-04(032), AND CRP-0024-04(033), RESPECTIVELY.
- (51) THE NOTES CONTAINED HEREON ARE SPECIFIC TO THE SUBJECT PROJECT AND SHOULD BE REVIEWED IN DETAIL BY THE CONTRACTOR. PER SECTION 102.05 OF THE STANDARD SPECIFICATIONS, "THE BIDDER IS REQUIRED TO EXAMINE CAREFULLY THE SITE OF THE PROPOSED WORK, THE PROPOSAL, PLANS, STANDARD SPECIFICATIONS, SPECIAL PROVISIONS, NOTICE TO BIDDERS, AND CONTRACT FORMS BEFORE SUBMITTING A PROPOSAL."

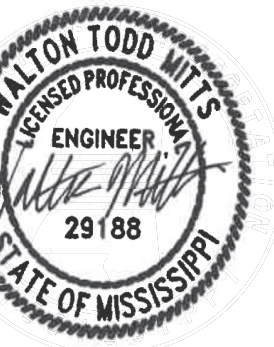

DESIGNED BY:
 DETAILED BY:
 CHECKED BY:
 DATE:

FMS CON: 103896/303000
 PROJECT NO.: CRP-0024-04(031)
 COUNTY: NESHOMA

GENERAL NOTES

SHEET ID
GN-2

SHEET NO.
7

PLAN SHEET

10/21/2024 11:00:14 PM Sheet - General Notes.dgn