

STATE	PROJECT NUMBER	SHEET NO.
MISSISSIPPI	STBG-0211-00(017)	1

**GENERAL INDEX**

INCLUDED THIS PROJECT	BEGIN WITH SHEET
<input checked="" type="checkbox"/> ROADWAY .....	1
<input type="checkbox"/> PERMANENT SIGNS .....	1001
<input type="checkbox"/> TRAFFIC SIGNALS .....	2001
<input type="checkbox"/> ITS COMPONENTS .....	3001
<input type="checkbox"/> LIGHTING .....	4001
<input type="checkbox"/> (RESERVED) .....	5001
<input checked="" type="checkbox"/> ROADWAY STANDARD DWGS .....	6001
<input type="checkbox"/> BOX CULVERT STD. DRAWINGS (LRFD) .....	7001
<input type="checkbox"/> BOX CULVERT STD. DRAWINGS (STD. SPEC.) .....	7501
<input type="checkbox"/> BRIDGE .....	8001
<input checked="" type="checkbox"/> CROSS SECTIONS .....	9001

STATE OF MISSISSIPPI

MISSISSIPPI DEPARTMENT OF TRANSPORTATION

**PLAN AND PROFILE OF PROPOSED STATE HIGHWAY STATE PROJECT NO. STBG-0211-00(017)**

SR 37 OVER OAKOHAY CREEK (4.3) FMS CON. NO. 108817/301000  
COVINGTON COUNTY

SCALES  
PLAN 1 IN. = 100 FT.  
PROFILE { HOR. AS NOTED  
          { VERT. AS NOTED  
LAYOUT 1 IN. = 3,000 FT.

BRIDGE STRUCTURES REQ'D.

NONE

BOX BRIDGES REQ'D.

NONE

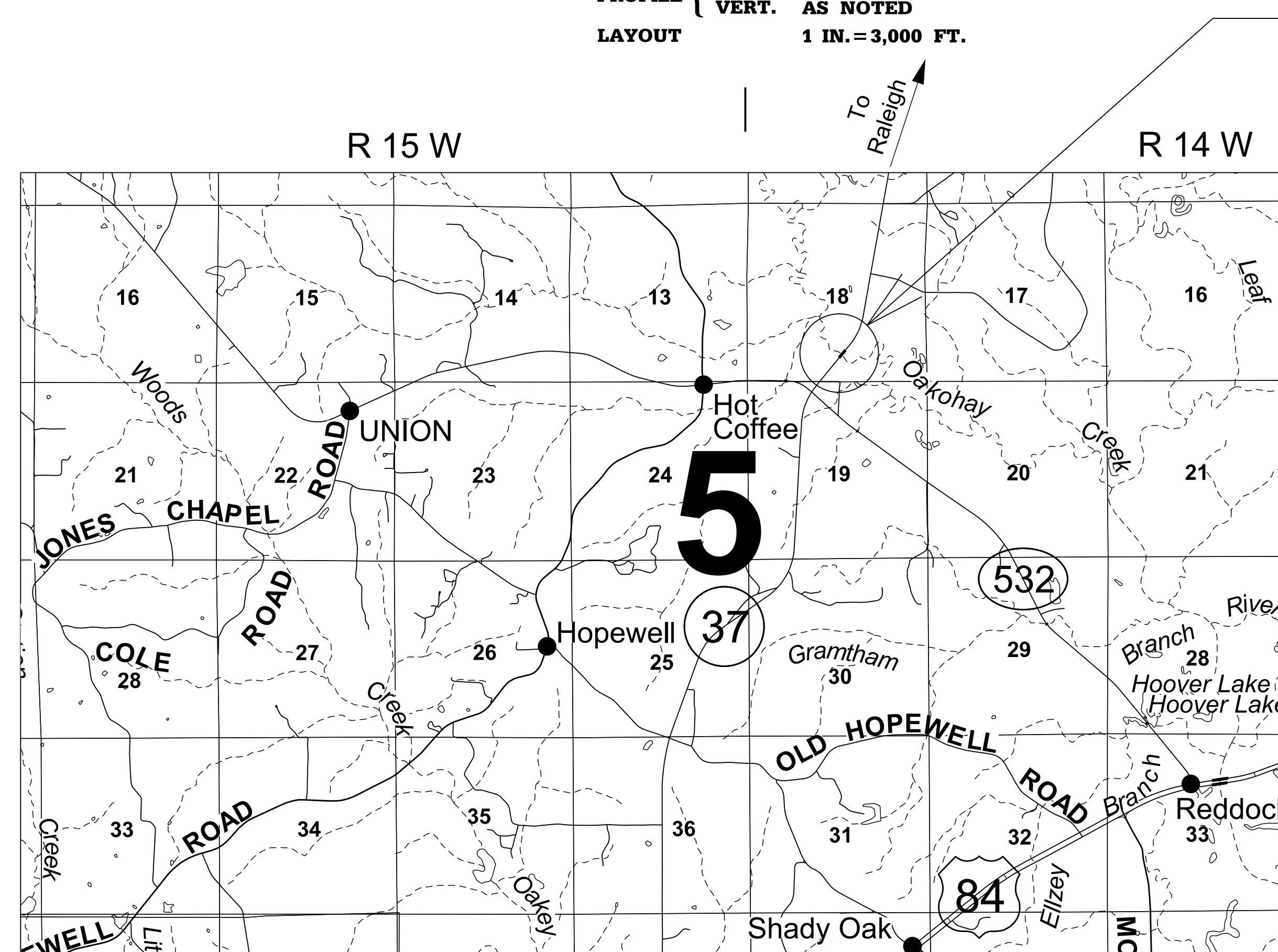

SR 37  
OAKOHAY CREEK  
BRIDGE NO. 4.3

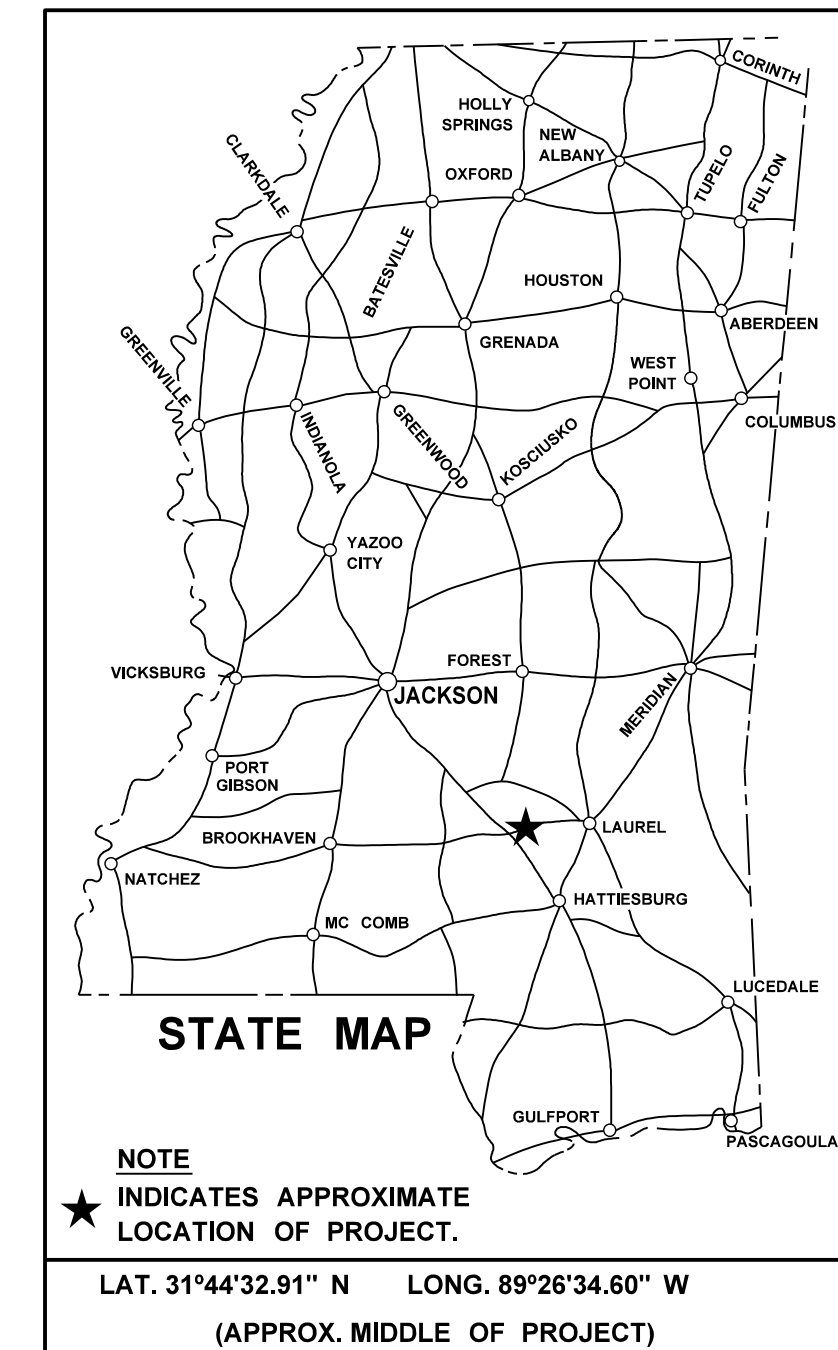

DESIGN CONTROL

MPH = V (SPEED DESIGN)

ADT ( ) = : ADT ( ) =

DHV = : D = % T = %

PERMITS ACQUIRED BY MDOT

WETLANDS AND WATERS PERMITS		
	WATERS	WETLANDS
NATIONWIDE #14	<input checked="" type="checkbox"/> N	<input type="checkbox"/> N
NATIONWIDE (OTHER)*	<input checked="" type="checkbox"/> Y	<input type="checkbox"/> N
GENERAL*	<input type="checkbox"/> N	<input type="checkbox"/> N
INDIVIDUAL (404)*	<input type="checkbox"/> N	<input type="checkbox"/> N

STORMWATER PERMIT  S

Y REQUIRED, CNOI SUBMITTED BY MDOT (DISTURBED AREA = 5 ACRES)

S REQUIRED, SCNOI TO BE SUBMITTED BY CONTRACTOR (1 TO 4.99 ACRES)

N NO STORMWATER PERMIT REQUIRED (<1 ACRE)

APPROVED BY: \_\_\_\_\_

**CONVENTIONAL SYMBOLS**

- COUNTY LINE .....
- TOWN CORPORATION LINE .....
- SECTION LINE .....
- EXISTING ROAD OR TRAVELED WAY .....
- PROPOSED ROAD OR TRAVELED WAY .....
- RAILROAD .....
- SURVEY LINE .....
- BRIDGES .....

**EQUATIONS**

NONE

**EXCEPTIONS**

NONE

**LENGTH DATA**

LENGTH OF BANK STABILIZATION	302.07	FT.	0.057	MI.
LENGTH OF PROJECT (NET)	302.07	FT.	0.057	MI.
LENGTH OF EXCEPTIONS	0.00	FT.	0.000	MI.
LENGTH OF PROJECT (GROSS)	302.07	FT.	0.057	MI.



P S & E DATE: 10-15-2024

APPROVED: \_\_\_\_\_  
DEPUTY EXECUTIVE DIRECTOR / CHIEF ENGINEER  
EXECUTIVE DIRECTOR



10/14/2024 4:49 PM TITLE.DGN



STATE	PROJECT NO.
MISS.	STBG-0211-00(017)

DESCRIPTION OF SHEET	WKG. NO.	SH. NO.	DESCRIPTION OF SHEET	WKG. NO.	SH. NO.
<u>TITLE SHEET (1)</u>	-	1	<u>STANDARD DRAWINGS – ROADWAY SHEETS (30)</u>		
<u>SUMMARY OF PLAN REVISION SHEET (1)</u>			TYPICAL TEMPORARY EROSION/SEDIMENT CONTROL APPLICATIONS	ECD-1	6101
SUMMARY OF PLAN REVISIONS	SPR-1	2	DETAILS OF SEDIMENT BARRIER APPLICATIONS	ECD-2	6102
<u>DETAILED INDEX &amp; GENERAL NOTES (2)</u>			DETAILS OF SILT FENCE INSTALLATION	ECD-3	6103
DETAILED INDEX	DI-1	3	DITCH CHECK STRUCTURES, TYPICAL APPLICATIONS AND DETAILS	ECD-4	6104
GENERAL NOTES	GN-1	4	TEMPORARY EROSION, SEDIMENT AND WATER POLLUTION CONTROL MEASURES,	ECD-5	6105
<u>TYPICAL SECTION SHEETS (2)</u>			SILT FENCE AND HAY BALE DITCH CHECKS		
TYPICAL SECTION – STONE TIEBACK AND TRANSVERSE STONE DIKE	TS-1	5	DETAILS OF EROSION CONTROL WATTLE DITCH CHECK	ECD-6	6106
TYPICAL SECTION – LONGITUDINAL PEAKED AND LONGITUDINAL FILL STONE DIKE	TS-2	6	DETAIL OF EROSION CONTROL SILT DIKE DITCH CHECKS	ECD-7	6107
<u>QUANTITY SHEETS (5)</u>			ROCK DITCH CHECK	ECD-8	6108
SUMMARY OF QUANTITIES	SQ-1	7	ROCK FILTER DAM	ECD-9	6109
ESTIMATED QUANTITIES – EARTHWORK ITEMS	EQ-1	8	ROCK DITCH CHECK WITH SUMP EXCAVATION AND ROCK FILTER DAM	ECD-10	6110
ESTIMATED QUANTITIES – PERMANENT EROSION CONTROL ITEMS	EQ-2	9	TYPICAL APPLICATIONS AND DETAILS FOR INLET PROTECTION	ECD-11	6111
ESTIMATED QUANTITIES – GRASSING ITEMS	EQ-3	10	STABILIZED CONSTRUCTION ENTRANCE	ECD-16	6116
ESTIMATED QUANTITIES – TRAFFIC CONTROL SIGNS	EQ-4	11	TEMPORARY STREAM DIVERSION	ECD-18	6118
<u>PLAN AND PROFILE SHEETS (3)</u>			FLOATING TURBIDITY CURTAIN	ECD-20	6120
PLAN AND PROFILE SHEET OAKAHAY CREEK @ SR 37	3	12	DETAILS OF EROSION CONTROL SANDBAG DITCH CHECK	ECD-21	6121
PLAN AND PROFILE SHEET OAKAHAY CREEK @ SR 37 – TIEBACKS	3A	13	SEDIMENT RETENTION BARRIER	ECD-22	6122
PLAN AND PROFILE SHEET OAKAHAY CREEK @ SR 37 – RIP RAP DITCH	3B	14	DETAILS OF TYPICAL DITCH TREATMENT	DT-1	6123
<u>EROSION CONTROL PLAN SHEETS (3)</u>			DITCH TREATMENT INSTALLATION DETAIL FOR SOIL REINFORCING MAT	DT-1A	6124
ECP-OAKOHAY CREEK @SR 37	ECP-3	15	TYPICAL TEMPORARY EROSION CONTROL MEASURES (SLOPE DRAIN AND TYPE A SILT BASIN)	BAS-A	6125
ECP-OAKOHAY CREEK @SR 37 – TIEBACKS	ECP-3A	16	TYPICAL TEMPORARY EROSION CONTROL MEASURES (TYPE B SILT BASIN)	BAS-B	6126
ECP-OAKOHAY CREEK @SR 37 – RIP RAP DITCH	ECP-3B	17	EROSION CONTROL BLANKET	ECB-1	6131
<u>SPECIAL DESIGN SHEETS (6)</u>			TRAFFIC CONTROL PLAN WITH FLAGGER (ONE-LANE CLOSURE OF TWO-WAY TRAFFIC)	TCP-1	6351
VEGETATION SCHEDULE	VS-1	18	SHORT DURATION CLOSING OF TWO-LANE TWO-WAY HIGHWAYS	TCP-6	6356
DETAIL CONSTRUCTION SIGNING	DCS-1	19	HIGHWAY SIGN AND BARRICADE DETAILS FOR CONSTRUCTION PROJECTS	TCP-8	6358
STATE HYDROGRAPH – USGS GAGE STATION 02472000 – LEAF RIVER	SH-1	20	TRAFFIC CONTROL PLAN MOBILE OPERATIONS MULTILANE ROADS AND TWO- LANE ROADS	TCP-9	6359
SURVEY CONTROL SHEET	SCS-1	21	LOCATION OF R16-3 SIGNS	TCP-15	6365
RIGHT – OF – WAY COORDINATES – RIGHT OF WAY MARKERS	RWC-1	22	TRAFFIC CONTROL DRUM PLACEMENT AND SHOULDER CLOSURE DETAIL	TCP-16	6366
RIGHT – OF – WAY COORDINATES – TEMPORARY EASEMENTS	RWC-2	23	RIGHT – OF – WAY MARKER	RW-1	6401
<u>INFORMATION BRIDGE SHEETS (3)</u>			TYPICAL GRADING TRANSITION BETWEEN CUTS AND FILLS	GT-1	6404
PROJECT NO. S-0211(5)A – BRIDGE PLANS (FOR INFORMATION ONLY) (2)	24-25	8002	MISCELLANEOUS DETAIL SHEET	MDS-1	6425
PROJECT NO. SP-0211-00(022)-108817/302000 – SHEET PILE DETAILS (FOR INFORMATION ONLY) (1)					
			<u>CROSS SECTIONS (5)</u>		
			OAKAHAY CREEK (3)		9001-9005
			RIP RAP DITCH (2)		
			<u>TOTAL SHEETS (61)</u>		

10/14/2024 5:28 PM DI.DGN



MISSISSIPPI DEPARTMENT OF TRANSPORTATION	
<b>DETAILED INDEX</b>	
PROJ. NO.: STBG-0211-00(017) COUNTY: COVINGTON	
WORKING NUMBER	<b>DI-1</b>
SHEET NUMBER	<b>3</b>
REVISION	BY
DATE	FILE NAME: prjpln.dgn
DESIGN TEAM	MENDROP CHECKED DATE

GENERAL NOTES

BRIDGES AND WALLS

(1) STORAGE OF FLAMMABLE MATERIALS WILL NOT BE ALLOWED UNDER ANY BRIDGE STRUCTURES WITHOUT WRITTEN APPROVAL FROM THE PROJECT ENGINEER. SEE NOTICE TO BIDDERS ENTITLED "MATERIAL STORAGE UNDER BRIDGES" FOR MORE INFORMATION.

DRAINAGE STRUCTURES

(2) THE COST FOR REMOVAL OF ALL HEADWALLS AND WINGWALLS (PIPES, BOX CULVERTS, BOX BRIDGES) SHALL BE ABSORBED IN OTHER ITEMS BID.

(3) THE CONTRACTOR SHALL BE RESPONSIBLE FOR PROTECTING EXISTING STRUCTURES SUCH AS, BUT NOT LIMITED TO, PIPES, INLETS, APRONS, AND BRIDGES FROM DAMAGE WHICH MIGHT OCCUR DURING CONSTRUCTION. THE CONTRACTOR SHALL REPLACE OR REPAIR, AS DIRECTED BY THE ENGINEER, ANY STRUCTURES DAMAGED DURING THE LIFE OF THE CONTRACT. NO PAYMENT WILL BE MADE FOR REPLACEMENT OR REPAIR OF DAMAGED ITEMS.

EARTHWORK

(4) 25% SHRINKAGE FACTOR USED IN THE EARTHWORK CALCULATIONS IS FOR DESIGN ESTIMATING PURPOSES ONLY.

(5) VOIDS CREATED BY THE REMOVAL OF, BUT NOT LIMITED TO, POSTS, CONCRETE ANCHORS, AND FOOTINGS SHALL BE BACKFILLED AND TAMPED IN ACCORDANCE WITH SECTION 203 OF THE MISSISSIPPI STANDARD SPECIFICATIONS FOR ROAD AND BRIDGE CONSTRUCTION, THE COST OF WHICH WILL BE ABSORBED IN OTHER ITEMS BID.

(6) WORK ON STRUCTURES FOR THIS PROJECT REQUIRES EXCAVATION IN THE IMMEDIATE VICINITY OF TRAFFIC AND ADJACENT PROPERTIES. THEREFORE, THE RISK OF A FAILURE OCCURRING DURING EXCAVATION REQUIRES THAT EXTREME CAUTION BE EXERCISED. THE CONTRACTOR SHALL BE RESPONSIBLE FOR PLACING WHAT BRACING, SHORING, OR GROUND SUPPORT SYSTEM THAT IS DEEMED NECESSARY TO PREVENT A FAILURE AND PROTECT THE PERSONS WORKING NEAR THE EXCAVATION, THE PUBLIC THAT MAY BE ABOVE THE EXCAVATION, OR ANY STRUCTURES ADJACENT TO THE EXCAVATION. ALL COSTS FOR DESIGNING, DRAWING, AND CONSTRUCTING THE FACILITY SHALL BE INCLUDED IN THE PRICE BID FOR CONTRACT ITEMS.

(7) SMALL AMOUNTS OF EXCAVATION MAY BE NECESSARY AT SOME OF THE SITES. THIS MATERIAL MAY BE USED AS E.S.F.E. MATERIAL AND WILL BE PAID FOR AS BORROW. NO E.S.F.E. MATERIAL SHALL BE REMOVED FROM THE PROJECT WITHOUT THE APPROVAL OF THE ENGINEER.

(8) THIN LAYERS OF ROCK ENCOUNTERED DURING EXCAVATION WILL BE PAID FOR AS UNCLASSIFIED EXCAVATION. SOLID ROCK AS SHOWN ON PLANS AND CROSS SECTIONS WILL BE PAID FOR AS ROCK EXCAVATION.

(9) PRIOR TO EARTHWORK OPERATIONS, THE EXISTING TOP 6" TOPSOIL IS TO BE STRIPPED AND STOCKPILED. AFTER THE GRADING OPERATIONS ARE COMPLETED, SAID TOPSOIL SHALL BE PLACED ON ALL AREAS THAT ARE NOT TO BE PAVED OR OTHERWISE PROTECTED, IN ACCORDANCE WITH SECTION 211 OF THE SPECIFICATIONS, OR THE VEGETATION SCHEDULE (SEE WK. SH. VS-1). EXISTING TOPSOIL AND ALL COSTS ASSOCIATED WITH STRIPPING, HAULING, STOCKPILING, AND PLACEMENT OF THE EXISTING TOPSOIL IS TO BE ABSORBED IN OTHER EARTHWORK ITEMS.

ENVIRONMENTAL & CLEARING

(10) NO TEMPORARY CULVERT STREAM CROSSINGS WILL BE ALLOWED.

(11) CLEARING LIMITS SHOWN THE MAXIMUM LIMITS UNLESS OTHERWISE APPROVED BY THE ENGINEER. CLEARING OF AREAS OTHER THAN THOSE AREAS DESIGNATED IS NOT REQUIRED. THE AREA TO BE CLEARED SHALL BE THE MINIMUM NECESSARY FOR CONSTRUCTION.

(12) CLEARING IN WETLANDS AREA UNDERNEATH BRIDGES IS PROHIBITED, EXCEPT WHERE NECESSARY FOR BRIDGE CONSTRUCTION. THIS CLEARING MUST BE DONE WITH SAWS, BULL DOZERS OR OTHER MECHANIZED CLEARING, WHICH WILL DISTURB NATURAL GROUND SURFACE, ARE NOT ALLOWED.

EROSION CONTROL - TEMPORARY

(13) WIRE FENCE BACKING WILL BE REQUIRED FOR ALL SILT FENCE. (SEE WK. NO. ECD-3)

(14) THE EROSION CONTROL DEVICES REFERENCED IN THESE PLANS ARE A MINIMUM REQUIREMENT. IT IS THE RESPONSIBILITY OF THE CONTRACTOR TO ENSURE THAT SILT DOES NOT LEAVE THE RIGHT OF WAY OR CONTAMINATE WATERS OF THE U. S. DURING CONSTRUCTION. THE CONTRACTOR SHALL SUBMIT AN EROSION CONTROL PLAN PRIOR TO COMMENCEMENT OF WORK AND MAINTAIN THE PLAN DURING CONSTRUCTION. ANY ADDITIONAL SILT BASINS NOT SHOWN IN THE PLANS SHALL BE INCLUDED IN THE CONTRACTOR'S EROSION CONTROL PLAN PRIOR TO SUBMITTING FOR APPROVAL.

(15) ALL ITEMS OF WORK ASSOCIATED WITH THE INSTALLATION OF A CONSTRUCTION ENTRANCE SHALL BE ABSORBED IN OTHER ITEMS OF WORK. PAVEMENT, BASE, AND SHOULDERS

(16) THE CONTRACTOR SHALL REPAIR ANY DAMAGE TO THE PAVED OR UNPAVED SHOULDER THAT MIGHT OCCUR DURING CONSTRUCTION. ANY REPAIR TO SHOULDER WILL BE IN ACCORDANCE WITH THE APPLICABLE SECTIONS OF THE MISSISSIPPI STANDARD SPECIFICATIONS FOR ROAD AND BRIDGE CONSTRUCTION. NO PAYMENT WILL BE MADE FOR REPAIR OF DAMAGED SHOULDER.

GENERAL NOTES (CONT.)

PLANS

(17) IF COLORS ARE USED ON PLAN/PROFILE SHEETS, THEY ARE INTENDED TO VISUALLY EASE THE LOCATION OF ELEMENTS FOR USERS OF THESE DRAWINGS. ALTHOUGH THE INTENT IS TO CATEGORIZE EVERYTHING AS EITHER EXISTING OR PROPOSED, IT IS THE END USER'S RESPONSIBILITY TO ENSURE ALL ELEMENTS ARE INTERPRETED CORRECTLY, REGARDLESS OF COLOR.

(18) ALL ADDENDA TO THESE PLANS WILL BE POSTED TO WWW.MDOT.MS.GOV UNDER THE PROPOSAL ADDENDA COLUMN. BIDDERS ARE ADVISED THAT HARD COPIES OF ANY ADDENDA FOR THIS PROJECT WILL NOT BE MAILED. IT IS THE BIDDER'S RESPONSIBILITY TO CHECK AND SEE IF ANY ADDENDA HAVE BEEN POSTED FOR THIS PROJECT.

TRAFFIC CONTROL - TEMPORARY

(19) THE LOCATION AND SPACING OF SIGNS, SHOWN ON THE TRAFFIC CONTROL PLANS, ARE APPROXIMATE AND MAY BE ADJUSTED AS NECESSARY TO FIT FIELD CONDITIONS.

(20) ALL TRAFFIC CONTROL DEVICES ON THIS PROJECT SHALL COMPLY WITH PART VI OF THE MUTCD (LATEST EDITION).

(21) ALL PLASTIC DRUMS SHALL HAVE A BALLASTING COLLAR MADE FROM RECYCLED TRUCK TIRES OR OTHER SUITABLE MATERIAL.

(22) FLUORESCENT ORANGE SHEETING SHALL BE USED ON ALL CONSTRUCTION AND TRAFFIC CONTROL SIGNS EXCEPT FOR THOSE DESIGNATED ON THE PLANS TO BE BLACK LEGEND AND BORDER ON WHITE BACKGROUND.

(23) THE CONTRACTOR SHALL COORDINATE WITH THE CONTRACTOR FROM ADJACENT PROJECT(S) IN IMPLEMENTING THE TRAFFIC CONTROL PLAN AS DIRECTED BY THE ENGINEER. ALL CONFLICTING SIGNS SHALL BE COVERED OR REMOVED AS DIRECTED BY THE ENGINEER

(24) THE CONTRACTOR SHALL COVER OR REMOVE ANY TEMPORARY TRAFFIC CONTROL SIGNS SHOWN IN THE TRAFFIC CONTROL PLAN THAT DO NOT APPLY TO THE CURRENT PHASE.

(25) THE RETROREFLECTIVE SIGN SHEETING ON RIGID, TEMPORARY TRAFFIC CONTROL (ORANGE) SIGNS SHALL BE MINIMUM TYPE IX.

UTILITIES

(26) UTILITIES ON THE DRAWINGS ARE SHOWN IN THEIR ORIGINAL LOCATION BASED UPON THE BEST INFORMATION AVAILABLE TO THE ENGINEER. UTILITIES THAT WERE FOUND TO BE IN CONFLICT WITH CONSTRUCTION HAVE BEEN RELOCATED. PERMITS ARE ON FILE WITH THE DEPARTMENT SHOWING THE APPROXIMATE LOCATION OF UTILITIES RELOCATED WITHIN THE RIGHT-OF-WAY. THE ENGINEER CAN NOT AND DOES NOT WARRANT THAT THIS INFORMATION IS COMPLETE OR ACCURATE. THE CONTRACTOR MUST COORDINATE DIRECTLY WITH THE INVOLVED UTILITY OWNERS TO HAVE UNDERGROUND UTILITY LINES FIELD LOCATED IN ADVANCE OF CONSTRUCTION.

(27) LIST OF PUBLIC UTILITIES

- A. AT&T
B. SOUTHERN ELECTRIC

MISCELLANEOUS

(28) SOME WORK IS REQUIRED OUTSIDE THE PROJECT LIMITS. NO ADDITIONAL COMPENSATION WILL BE MADE FOR SUCH WORK EXCEPT AS PROVIDED BY SPECIFIC PAY ITEMS INCLUDED IN THE PLANS.

(29) THE CONTRACTOR SHALL BE RESPONSIBLE FOR MAINTAINING AND RELOCATING MAIL BOXES AS NECESSARY TO MAINTAIN CONTINUOUS MAIL SERVICE THROUGHOUT THE LIFE OF THE PROJECT, THE COST OF WHICH SHALL BE ABSORBED IN OTHER ITEMS BID.

(30) THE CONTRACTOR IS RESPONSIBLE FOR FIELD-VERIFICATION OF EXISTING GRADES AND MAKING ADJUSTMENTS AS NECESSARY WITH THE APPROVAL OF THE PROJECT ENGINEER.

(31) THE CONTRACTOR SHALL COORDINATE AND CONDUCT WORK AT LOCAL ROADS AND DRIVEWAYS IN A MANNER SUCH THAT ACCESS IS NOT INTERRUPTED UNNECESSARILY. ACCESS SHALL BE PRESERVED IN THE BEST MANNER POSSIBLE. COORDINATION AND COMMUNICATION WITH LANDOWNERS MAY BE NECESSARY TO PREVENT INTERRUPTION OF DRIVEWAY ACCESS.

(32) THE CONTRACTOR SHALL REMOVE AND RESET ANY GATES REQUIRED TO TIE IN DRIVEWAYS. THE COST OF WHICH SHALL BE ABSORBED IN OTHER ITEMS BID.

(33) THE CONTRACTOR SHALL SUBMIT AN OPERATIONS PLAN FOR APPROVAL BY THE ENGINEER AT LEAST TWO WEEKS PRIOR TO ANY WORK RELATED TO THE DEMOLITION OF THE EXISTING BRIDGE.

(34) EXISTING SHEET PILE TO REMAIN IN PLACE. APPROXIMATE LOCATION SHOWN ON PLANS.

NOTICE: THE NOTES CONTAINED HEREON ARE SPECIFIC TO THE SUBJECT PROJECT AND SHOULD BE REVIEWED IN DETAIL BY THE CONTRACTOR, PER SECTION 102.05 OF THE STANDARD SPECIFICATIONS, THE BIDDER IS REQUIRED TO EXAMINE CAREFULLY THE SITE OF THE PROPOSED WORK, THE PROPOSAL, PLANS, STANDARD SPECIFICATIONS, SPECIAL PROVISIONS, NOTICES TO BIDDERS AND CONTRACT FORMS BEFORE SUBMITTING A PROPOSAL.



Table with 2 columns: STATE, PROJECT NO. and MISS., STBG-0211-00(017)

10/14/2024 4:49 PM GN.DGN

MISSISSIPPI DEPARTMENT OF TRANSPORTATION GENERAL NOTES. PROJ. NO.: STBG-0211-00(017) COUNTY: COVINGTON. WORKING NUMBER GN-1 SHEET NUMBER 4. Includes revision table and department logo.