

STATE OF MISSISSIPPI
MISSISSIPPI DEPARTMENT OF TRANSPORTATION

PLAN AND PROFILE OF PROPOSED STATE HIGHWAY

FEDERAL AID PROJECT NO. CRP-0024-04(031) CRP-0024-04(032) CRP-0024-04(033)

SR 15/SR 16 ROUNDABOUT NESHOBA COUNTY

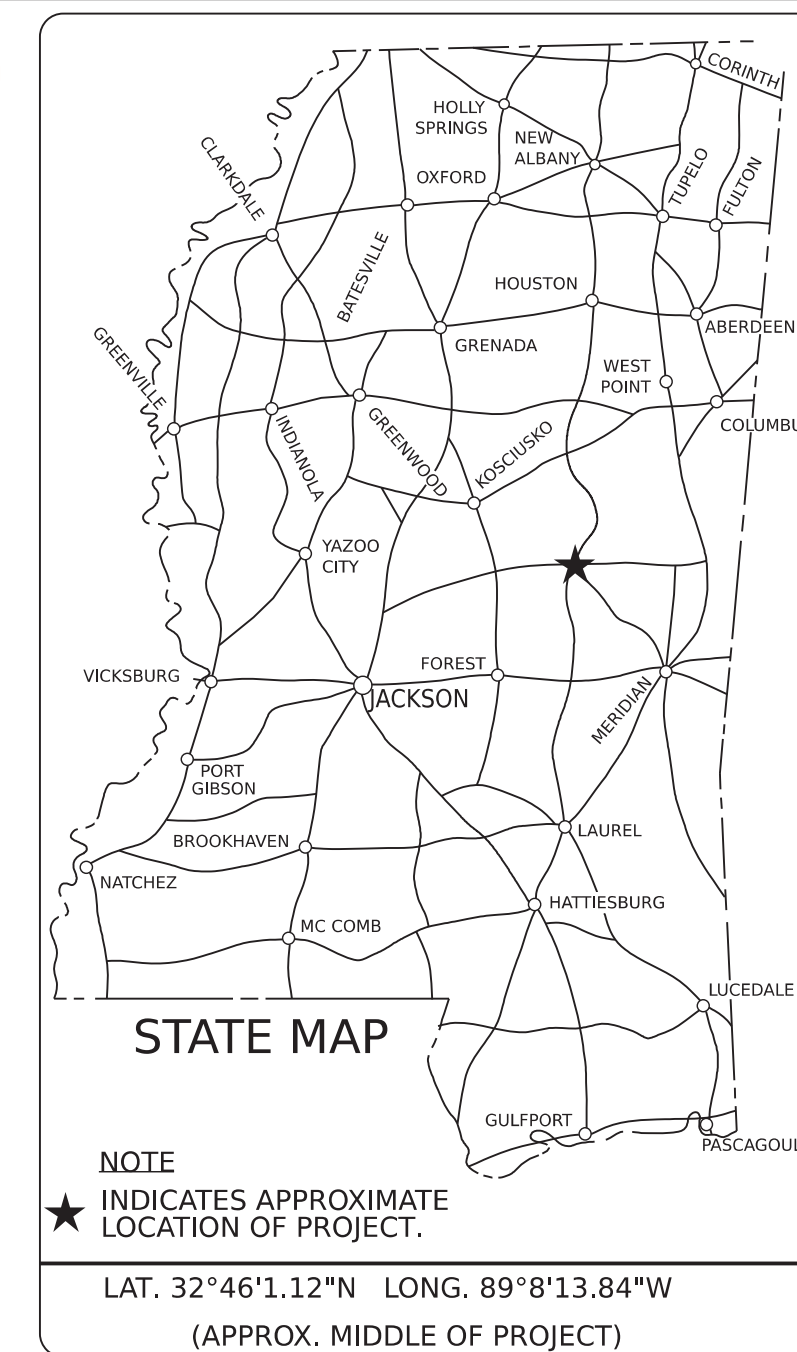

GENERAL INDEX	
INCLUDED THIS PROJECT	BEGIN WITH SHEET
<input checked="" type="checkbox"/> ROADWAY.....	1
<input checked="" type="checkbox"/> PERMANENT SIGNS.....	1001
<input checked="" type="checkbox"/> TRAFFIC SIGNALS.....	2001
<input type="checkbox"/> ITS COMPONENTS.....	3001
<input checked="" type="checkbox"/> LIGHTING.....	4001
<input type="checkbox"/> (RESERVED).....	5001
<input checked="" type="checkbox"/> ROADWAY STD. DWGS.....	6001
<input type="checkbox"/> BOX CULVERT STD. DWGS (LRFD).....	7001
<input type="checkbox"/> BOX CULVERT STD. DWGS (STD. SPEC.)....	7501
<input checked="" type="checkbox"/> BRIDGE.....	8001
<input checked="" type="checkbox"/> CROSS SECTIONS.....	9001

BRIDGE STRUCTURES REQ'D.

LAKESIDE DR OVER KENTAWKA CREEK RELIEF
STA. 13+79.31
SPANS: 4@19'
LENGTH: 76'

WEYERHAEUSER ST OVER BRANCH
STA. 12+35.97
SPANS: 1@18', 1@31', 1@19'
LENGTH: 69'

BOX BRIDGES REQ'D.

NONE

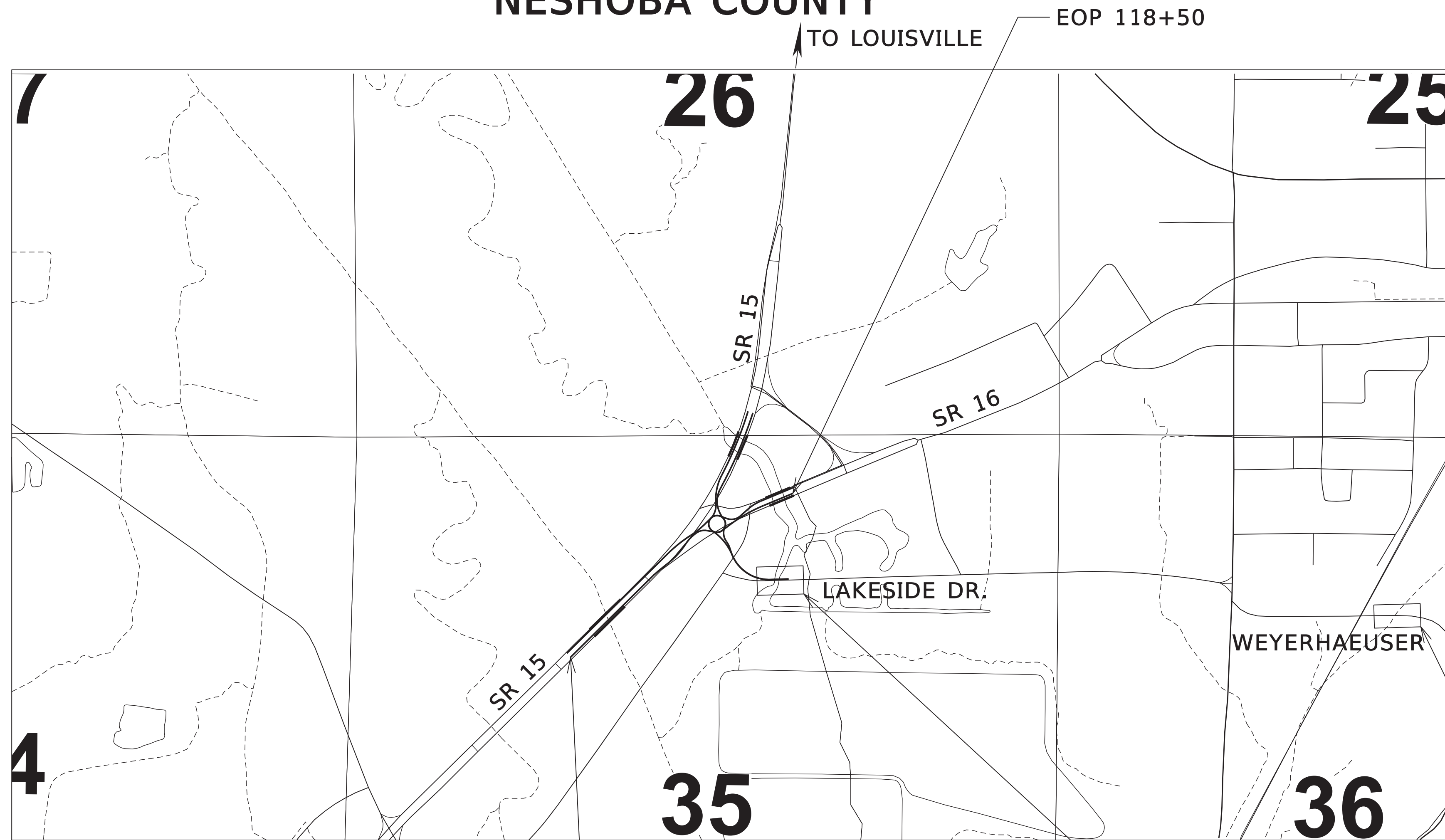

TO PHILADELPHIA

DESIGN CONTROL
MPH = V (SPEED DESIGN)

ADT (2025) = 20400 : ADT (2045) = 24900
DHV = 2380 : D = 50 % T = 13 %

PERMITS ACQUIRED BY MDOT

WETLANDS AND WATERS PERMITS	
	WATERS WETLANDS
NATIONWIDE #14	<input type="checkbox"/> N
NATIONWIDE (OTHER)*	<input checked="" type="checkbox"/> Y
GENERAL*	<input type="checkbox"/> N
INDIVIDUAL (404)*	<input type="checkbox"/> N
STORMWATER PERMIT <input checked="" type="checkbox"/> A	
Y REQUIRED, CNOI SUBMITTED BY MDOT (DISTURBED AREA=5 ACRES)	
S REQUIRED, SCNOI TO BE SUBMITTED BY CONTRACTOR (1 TO 4.99 ACRES)	
N NO STORMWATER PERMIT REQUIRED (<1 ACRE)	
APPROVED BY: _____	

WEYERHAEUSER BRIDGE SITE
B.O.P. = 12+35.97
E.O.P. = 13+04.93

DESIGNED BY: VOLKERT, INC.

CONSTRUCTION PROJECT DATA

EXTERNAL PROJECT NUMBER	CRP-0024-04(031) CRP-0024-04(032) CRP-0024-04(033)
FMS & DETAIL	103896/303000 103896/303100 103896/303200

P S & E DATE: 10/23/2024
APPROVED:

DEPUTY EXECUTIVE DIRECTOR / CHIEF ENGINEER

EXECUTIVE DIRECTOR

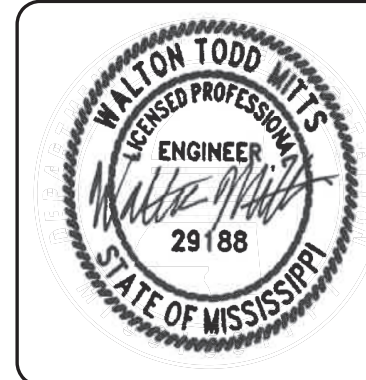

BOP 107+50
SCALES
PLAN 1 IN. = 100 FT.
PROFILE 1 IN. = 100 FT.
LAYOUT 1 IN. = 600 FT.

EQUATIONS
NONE

EXCEPTIONS
NONE

CONVENTIONAL SYMBOLS

- COUNTY LINE
- TOWN CORP LINE
- SECTION LINE
- DEED LINE
- EXISTING ROADWAY
- PROPOSED ROADWAY
- RAILROAD
- BRIDGES

LENGTH DATA

LENGTH OF ROADWAY	2194.92 FT.	0.41 MI.
LENGTH OF BRIDGES	145.00 FT.	0.03 MI.
LENGTH OF PROJECT (NET)	2339.92 FT.	0.44 MI.
LENGTH OF EXCEPTIONS	FT.	MI.
LENGTH OF PROJECT (GROSS)	2339.92 FT.	0.44 MI.

PLAN SHEET

DATE 12:55:37 PM TITLE_SH.dgn

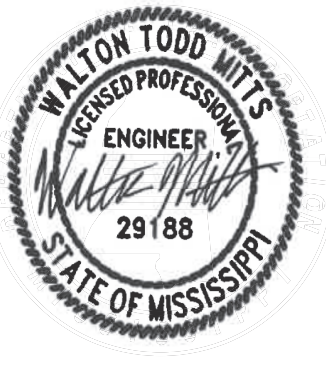

SUMMARY OF REVISIONS						
DATE	1st ORDER	ADDENDUM	2nd ORDER	BY	SHEET ID	DESCRIPTION
11-12-24	X			VOLKERT	TITLE	STORMWATER PERMIT UPDATED.
11-12-24	X			VOLKERT	SQ-1	UPDATED GRASSING QUANTITY.
11-12-24	X			VOLKERT	SQ-2	UPDATED GRASSING QUANTITY.
11-12-24	X			VOLKERT	SQ-3	UPDATED GRASSING QUANTITY.
11-12-24	X			VOLKERT	SQ-4	UPDATED GRASSING QUANTITY.
11-12-24	X			VOLKERT	SQ-5	UPDATED GRASSING QUANTITY.
11-12-24	X			VOLKERT	SQ-6	UPDATED GRASSING QUANTITY.
11-12-24	X			VOLKERT	SQ-7	UPDATED GRASSING QUANTITY.
11-12-24	X			VOLKERT	SQ-8	UPDATED GRASSING QUANTITY.
11-12-24	X			VOLKERT	SQ-9	UPDATED GRASSING QUANTITY.
11-12-24	X			VOLKERT	SQ-10	UPDATED GRASSING QUANTITY.
11-12-24	X			VOLKERT	SQ-11	UPDATED GRASSING QUANTITY.

PLAN SHEET

11/11/2024 2:05:03 PM Sheet-Revisions.dgn

DESIGNED BY:
 DETAILED BY:
 CHECKED BY:
 DATE:

FMS CON: 103896/303000
 PROJECT NO.: CRP-0024-04(031)
 COUNTY: NESHOMA

REVISION

SHEET ID
REV-1
 SHEET NO.
2



DESIGNED BY:
 DETAILED BY:
 CHECKED BY:
 DATE:

FMS CON: 103896/303000
 PROJECT NO.: CRP-0024-04(031)
 COUNTY: NESHOMA

DETAILED INDEX

SHEET ID
DI-1
 SHEET NO.
3

DESCRIPTION OF SHEET	WORKING NO.	SHEET NO.	DESCRIPTION OF SHEET	WORKING NO.	SHEET NO.
<u>TITLE SHEET</u>		1	<u>PLAN & PROFILE SHEETS (9)</u>		
<u>REVISION</u>	REV-1	2	SR 15/SR 16 EASTBOUND	WK-3	36
			SR 15/SR 16 WESTBOUND	WK-4	37
<u>DETAILED INDEX AND GENERAL NOTES (5)</u>			LAKESIDE-SR 15 NORTHBOUND	WK-5	38
			LAKESIDE-SR 15 SOUTHBOUND	WK-6	39
DETAILED INDEX	DI-1	3	CIRCULATORY ROADWAY	WK-7	40
DETAILED INDEX	DI-2	4	CR 375	WK-8	41
DETAILED INDEX	DI-3	5	SR 15/SR 16 BYPASS	WK-9	42
GENERAL NOTES	GN-1	6	LAKESIDE BRIDGE SITE	WK-10	43
GENERAL NOTES	GN-2	7	WEYERHAEUSER BRIDGE SITE	WK-11	44
<u>TYPICAL SECTIONS (10)</u>			<u>INTERSECTION DETAIL SHEETS (3)</u>		
LAKESIDE NEW CONSTRUCTION & WIDENING	TS-1	8	INTERSECTION DETAILS	ID-1	45
LAKESIDE NEW CONSTRUCTION	TS-2	9	INTERSECTION DETAILS	ID-2	46
15-16 BOP	TS-3	10	INTERSECTION DETAILS	ID-3	47
15-16 BOP SPLITTER ISLAND	TS-4	11			
15-16 EOP SPLITTER ISLAND	TS-5	12	<u>FORM GRADES (4)</u>		
15-16 EOP	TS-6	13			
ROUNDAABOUT, CR 375	TS-7	14	FORM GRADES	FG-1	48
15-16 BYPASS	TS-8	15	FORM GRADES	FG-2	49
15-16 OVERLAY	TS-9	16	FORM GRADES	FG-3	50
15-16 OVERLAY , SR 885 OVERLAY	TS-10	17	FORM GRADES	FG-4	51
<u>QUANTITY SHEETS (18)</u>			<u>TRAFFIC CONTROL SHEETS (25)</u>		
SUMMARY OF QUANTITIES	SQ-1	18	SEQUENCE OF CONSTRUCTION	SC-1	52
SUMMARY OF QUANTITIES	SQ-2	19	SEQUENCE OF CONSTRUCTION	SC-2	53
SUMMARY OF QUANTITIES	SQ-3	20	SEQUENCE OF CONSTRUCTION	SC-3	54
SUMMARY OF QUANTITIES	SQ-4	21	SEQUENCE OF CONSTRUCTION	SC-4	55
SUMMARY OF QUANTITIES	SQ-5	22	DETAIL OF CONSTRUCTION SIGNING	DCS-1	56
SUMMARY OF QUANTITIES	SQ-6	23	DETAIL OF CONSTRUCTION SIGNING - LAKESIDE DRIVE BRIDGE	DCS-2	57
SUMMARY OF QUANTITIES	SQ-7	24	DETAIL OF CONSTRUCTION SIGNING - WEYERHAEUSER BRIDGE	DCS-3	58
SUMMARY OF QUANTITIES	SQ-8	25	TRAFFIC CONTROL - PHASE 1-1	TC-1	59
SUMMARY OF QUANTITIES	SQ-9	26	TRAFFIC CONTROL - PHASE 1-2	TC-2	60
SUMMARY OF QUANTITIES	SQ-10	27	TRAFFIC CONTROL - PHASE 2-1	TC-3	61
SUMMARY OF QUANTITIES	SQ-11	28	TRAFFIC CONTROL - PHASE 2-2	TC-4	62
ESTIMATED QUANTITIES	EQ-1	29	TRAFFIC CONTROL - PHASE 2-3	TC-5	63
ESTIMATED QUANTITIES	EQ-2	30	TRAFFIC CONTROL - PHASE 2-4	TC-6	64
ESTIMATED QUANTITIES	EQ-3	31	TRAFFIC CONTROL - PHASE 2A-1	TC-7	65
ESTIMATED QUANTITIES	EQ-4	32	TRAFFIC CONTROL - PHASE 2A-2	TC-8	66
ESTIMATED QUANTITIES	EQ-5	33	TRAFFIC CONTROL - PHASE 2A-3	TC-9	67
ESTIMATED QUANTITIES	EQ-6	34	TRAFFIC CONTROL - PHASE 2A-4	TC-10	68
TRAFFIC CONTROL SIGNS	TCPQ-1	35	TRAFFIC CONTROL - PHASE 3-1	TC-11	69

PLAN SHEET

10/21/2024 10:59:46 PM Sheet-Detailed Index.dgn

DESCRIPTION OF SHEET	WORKING NO.	SHEET NO.	DESCRIPTION OF SHEET	WORKING NO.	SHEET NO.
TRAFFIC CONTROL - PHASE 3-2	TC-12	70	PERMANENT SIGNING PLANS	PSP-4	1004
TRAFFIC CONTROL - PHASE 3-3	TC-13	71	PERMANENT SIGNING PLANS - DETAILS	PSD-1	1005
TRAFFIC CONTROL - PHASE 3-4	TC-14	72	PERMANENT SIGNING PLANS - DETAILS	PSD-2	1006
TRAFFIC CONTROL - PHASE 4-1	TC-15	73			
TRAFFIC CONTROL - PHASE 4-2	TC-16	74	<u>TEMPORARY SIGNAL PLANS (8)</u>		
TRAFFIC CONTROL - PHASE 4-3	TC-17	75	PROJECT NOTES - TEMPORARY TRAFFIC SIGNALS	PN-1	2001
TRAFFIC CONTROL - PHASE 4-4	TC-18	76	TEMPORARY SIGNAL INSTALLATION - PHASE 2	TSI-1	2002
			TEMPORARY SIGNAL INSTALLATION - PHASE 3	TSI-2	2003
			TRAFFIC SIGNAL GENERAL NOTES	TSD-1	2004
			TRAFFIC SIGNAL LEGEND	TSD-2	2005
			CONTROLLER CABINET AND POWER SERVICE DETAILS	TSD-3	2006
			SPAN WIRE DETAILS	TSD-4	2007
			TEMPORARY SIGNAL POLE DETAILS	TSD-5	2008
<u>SPECIAL DESIGN SHEETS (25)</u>			<u>ROADWAY LIGHTING PLANS (7)</u>		
PAVEMENT MARKING DETAILS	PMD-1	77	LIGHTING DETAILS	LD-1	4001
PAVEMENT MARKING DETAILS	PMD-2	78	LIGHTING LAYOUT DETAILS	LL-1	4002
PAVEMENT MARKING DETAILS	PMD-3	79	LIGHTING LAYOUT DETAILS	LL-2	4003
PAVEMENT MARKING DETAILS	PMD-4	80	LIGHTING LAYOUT DETAILS	LL-3	4004
PAVEMENT MARKING DETAILS	PMD-5	81	LIGHTING DETAILS	LD-2	4005
PAVEMENT MARKING DETAILS	PMD-6	82	LIGHTING DETAILS	LD-3	4006
PAVEMENT MARKING DETAILS	PMD-7	83	LIGHTING DETAILS	LD-4	4007
PAVEMENT MARKING DETAILS	PMD-8	84			
PAVEMENT MARKING DETAILS	PMD-9	85			
VEGATATION SCHEDULE	VS-1	86	<u>STANDARD DRAWING SHEETS (55)</u>		
EROSION CONTROL PLAN	ECP-3	87	33.5" BRIDGE END PAVEMENT RAIL	BER-1	6009
EROSION CONTROL PLAN	ECP-4	88	CONCRETE ISLAND PAVEMENT DETAILS	CIP-1	6011
EROSION CONTROL PLAN	ECP-5	89	PAVEMENT MARKING DETAILS FOR 2-LANE AND 4-LANE	PM-1	6051
EROSION CONTROL PLAN	ECP-6	90	PAVEMENT MARKING LEGEND DETAILS	PM-5	6055
EROSION CONTROL PLAN	ECP-7	91	PAVEMENT MARKING LEGEND DETAILS	PM-6	6056
EROSION CONTROL PLAN	ECP-8	92	4-LANE TO 2-LANE TRANSITION AT INTERCHANGE	PM-8	6058
EROSION CONTROL PLAN	ECP-9	93	TYPICAL TEMP. EROSION CONTROL	ECD-1	6101
EROSION CONTROL PLAN	ECP-10	94	DETAILS OF SEDIMENT BARRIER APPLICATIONS	ECD-2	6102
EROSION CONTROL PLAN	ECP-11	95	DETAILS OF SILT FENCE	ECD-3	6103
RIGHT OF WAY MARKERS & EASEMENT MARKERS	ROW-COR	96	DITCH CHECK STRUCTURES	ECD-4	6104
REMOVAL AND SAW CUT DETAILS	REM-1	97	SILT FENCE AND HAY BALE DITCH CHECKS	ECD-5	6105
REMOVAL AND SAW CUT DETAILS	REM-2	98	WATTLE DITCH CHECKS	ECD-6	6106
SIGN SUPPORT HARDWARE - 2.5" SQUARE TUBE	TSS-1	99	SILT DIKE DITCH CHECKS	ECD-7	6107
SIGN SUPPORT HARDWARE - 2.0" SQUARE TUBE	TSS-2	100	ROCK DITCH CHECK	ECD-8	6108
BRIDGE END PAVEMENT DETAIL - SPECIAL DESIGN	SD-BE1	101	ROCK FILTER DAM	ECD-9	6109
			ROCK DITCH CHECK WITH SUMP	ECD-10	6110
			TYPICAL APPLICATIONS FOR INLET CONSTRUCTION	ECD-11	6111
<u>PERMANENT SIGNING PLANS (6)</u>					
PERMANENT SIGNING PLANS	PSP-1	1001			
PERMANENT SIGNING PLANS	PSP-2	1002			
PERMANENT SIGNING PLANS	PSP-3	1003			

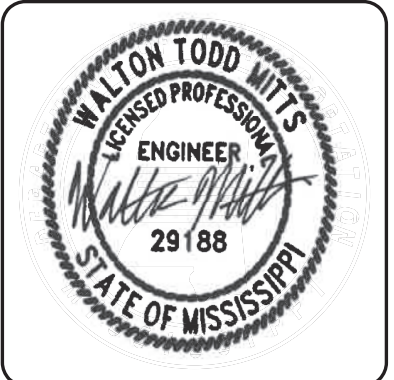

DESIGNED BY:	DETAILED BY:	CHECKED BY:	DATE:

FMS CON: 103896/303000	PROJECT NO.: CRP-0024-04(031)	COUNTY: NESHOPA
------------------------	-------------------------------	-----------------

DETAILED INDEX

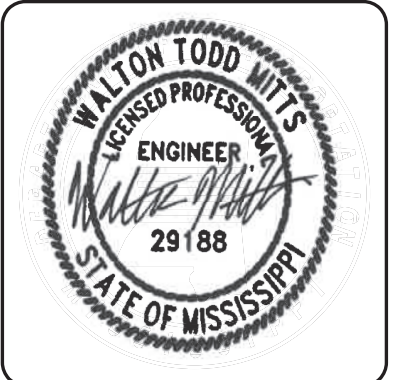

DESIGNED BY:
 DETAILED BY:
 CHECKED BY:
 DATE:

FMS CON: 103896/303000
 PROJECT NO.: CRP-0024-04(031)
 COUNTY: NESHOMA

DETAILED INDEX

SHEET ID
DI-3
 SHEET NO.
5

DESCRIPTION OF SHEET	WORKING NO.	SHEET NO.	DESCRIPTION OF SHEET	WORKING NO.	SHEET NO.
<u>STANDARD DRAWING SHEETS (CONT.)</u>			DETAILS OF PAVED FLUMES		
INLET PROTECTION DETAILS	ECD-12	6112	PIPE CULVERT INSTALLATION	PF-1	6426
INLET PROTECTION OF WATTLES	ECD-13	6113	STORM SEWER INLET - TYPE SS-2	PI-1	6501
INLET PROTECTION DEVICE	ECD-14	6114	FLARED END SECTION FOR CONCRETE PIPE	SS-2	6524
INLET PROTECTION DETAILS OF SANDBAGS	ECD-15	6115	FLARED END SECTION FOR CONCRETE ARCH PIPE	FE-1	6530
STABILIZED CONSTRUCTION ENTRANCE	ECD-16	6116		FE-1A	6531
DETAILS OF TYPICAL DITCH TREATMENTS	DT-1	6123	<u>CROSS-SECTION SHEETS (17)</u>		
DITCH TREATMENT INSTALLATION DETAIL FOR SOIL REINF. MAT	DT-1A	6124	15-16 EASTBOUND - STA. 106+00 TO 111+50		9001
GUARDRAIL: "W" BEAM (WOOD POST)	GR-1	6201	15-16 EASTBOUND - STA. 112+50 TO 114+00		9002
GUARDRAIL: THRIE BEAM (WOOD POST)	GR-1A	6202	15-16 EASTBOUND - STA. 116+00 TO 117+50		9003
GUARDRAIL: THRIE BEAM (STEEL POST)	GR-1B	6203	15-16 EASTBOUND - STA. 118+00 TO 119+00		9004
GUARDRAIL: BRIDGE END SECTION TYPE I (WOOD POST)	GR-2F	6210	15-16 WESTBOUND - STA. 156+50 TO 160+00		9005
GUARDRAIL: BRIDGE END SECTION TYPE I (STEEL POST)	GR-2G	6211	15-16 WESTBOUND - STA. 160+50 TO 162+00		9006
GUARDRAIL: RUB RAIL HARDWARE	GR-RR	6218	15-16 WESTBOUND - STA. 162+50 TO 168+00		9007
GUARDRAIL: MISCELLANEOUS HARDWARE	GR-HW	6221	15-16 WESTBOUND - STA. 168+50 TO 169+50		9008
STANDARD ROADSIDE SIGNS	SN-3	6303	LAKESIDE-15 NORTHBOUND - STA. 201+00 TO 205+00		9009
STANDARD ROADSIDE SIGNS	SN-3A	6304	LAKESIDE-15 NORTHBOUND - STA. 205+50 TO 206+50		9010
STANDARD ROADSIDE SIGNS	SN-3B	6305	LAKESIDE-15 NORTHBOUND - STA. 209+00 TO 212+00		9011
STANDARD ROADSIDE SIGN ASSEMBLY	SN-4	6306	LAKESIDE-15 SOUTHBOUND - STA. 255+50 TO 260+50		9012
STANDARD ROADSIDE SIGN ASSEMBLY	SN-4A	6307	LAKESIDE-15 SOUTHBOUND - STA. 261+00 TO 263+00		9013
STANDARD ROADSIDE SIGN ASSEMBLY	SN-4B	6308	CR 375 - STA 723+50 TO 727+00		9014
TYPICAL INSTALLATION OF GROUND MOUNTED DIRECTIONAL	SN-5	6309	CR 375 - STA 727+50 TO 727+50		9015
TYPICAL GUARDRAIL DELINEATION	SN-8C	6317	CIRCULATORY ROADWAY - STA. 300+00 TO 303+50		9016
TRAFFIC CONTROL PLAN WITH FLAGGER	TCP-1	6351	CIRCULATORY ROADWAY - STA. 305+95.84 TO 303+95.84		9017
SHORT DURATION CLOSING	TCP-6	6356			
HIGHWAY SIGN AND BARRIADADE DETAILS	TCP-8	6358			
TRAFFIC CONTROL FOR MOBILE OPERATIONS	TCP-9	6359			
DETAILS OF OUTSIDE LANE CLOSURE AT RAMPS	TCP-10	6360			
TRAFFIC CONTROL PLAN: UNEVEN PAVEMENT	TCP-12	6362			
TEMPORARY STRIPING FOR TRAFFIC CONTROL	TCP-13	6363			
TRAFFIC CONTROL DETAILS DRUM PLACEMENT	TCP-16	6366			
RURAL DRIVEWAYS	RD-1	6403			
DRIVEWAYS, CURB & GUTTER, SIDEWALK	SD-1	6419			
DRIVEWAYS, INTEGRAL CURB, SIDEWALK	SD-2	6420			
			TOTAL SHEETS (194)		

PLAN SHEET

10/21/2024 10:59:51 PM Sheet-Detailed Index.dgn

GENERAL NOTES

BRIDGES AND WALLS

- (1) STORAGE OF FLAMMABLE MATERIALS WILL NOT BE ALLOWED UNDER ANY BRIDGE STRUCTURES WITHOUT WRITTEN APPROVAL FROM THE PROJECT ENGINEER. SEE NOTICE TO BIDDERS ENTITLED "MATERIAL STORAGE UNDER BRIDGES" FOR MORE INFORMATION.

DRAINAGE STRUCTURES

- (2) ALL PIPE JOINTS ARE TO BE WRAPPED IN 24-INCH WIDE TYPE V GEOTEXTILE FABRIC. ALL PICKUP HOLES SHALL BE PLUGGED AND COVERED WITH TYPE V GEOTEXTILE FABRIC, THE COST OF WHICH SHALL BE ABSORBED IN OTHER ITEMS BID.
- (3) THE COST FOR REMOVAL OF ALL HEADWALLS AND WINGWALLS (PIPES, BOX CULVERTS, BOX BRIDGES) SHALL BE ABSORBED IN OTHER ITEMS BID.
- (4) THE CONTRACTOR SHALL BE RESPONSIBLE FOR PROTECTING EXISTING STRUCTURES SUCH AS, BUT NOT LIMITED TO, PIPES, INLETS, APRONS, AND BRIDGES FROM DAMAGE WHICH MIGHT OCCUR DURING CONSTRUCTION. THE CONTRACTOR SHALL REPLACE OR REPAIR, AS DIRECTED BY THE ENGINEER, ANY STRUCTURES DAMAGED DURING THE LIFE OF THE CONTRACT. NO PAYMENT WILL BE MADE FOR REPLACEMENT OR REPAIR OF DAMAGED ITEMS.
- (5) THE COST OF ANY COLLARS REQUIRED TO CONNECT CONCRETE FLARED END SECTIONS TO NON-CONCRETE PIPE SECTIONS SHALL BE ABSORBED IN THE COST FOR NON-CONCRETE PIPE.
- (6) CURB AND GUTTER VERTICAL DIMENSIONS SHOWN IN THE DETAIL DRAWINGS ARE FOR A CURB IN THE "CATCH" CONFIGURATION AND SHALL BE CONSIDERED TO BE MINIMUM DIMENSIONS. THE DIMENSIONS MAY BE MODIFIED AS NECESSARY FOR "SPILL" CURB AND GUTTER, BUT SHALL NOT BE LESS THAN THE MINIMUM SHOWN.
- (7) CURB AND GUTTER VERTICAL DIMENSIONS SHOWN IN THE DETAIL DRAWINGS ARE FOR A CURB IN THE "CATCH" CONFIGURATION AND SHALL BE CONSIDERED TO BE MINIMUM DIMENSIONS. THE DIMENSIONS MAY BE MODIFIED AS NECESSARY FOR "SPILL" CURB AND GUTTER, BUT SHALL NOT BE LESS THAN THE MINIMUM SHOWN.

EARTHWORK

- (8) 25% SHRINKAGE FACTOR USED IN THE EARTHWORK CALCULATIONS IS FOR DESIGN ESTIMATING PURPOSES ONLY.
- (9) THE TOP THREE FEET AND VARIABLE OF THE DESIGN SOILS (BOTH NATURAL AND EMBANKMENT) SHALL BE CONSTRUCTED OF SOIL CLASSIFIED AS B15 OR BETTER, PER MDOT SPECIFICATIONS 703.21, EXCEPT AT UNDERCUT LOCATIONS DESIGNATED ON THE PLANS OR AS DIRECTED BY THE ENGINEER TO RECEIVE CLASS B-15 BORROW EXCAVATION. EXTREME CARE SHALL BE EXERCISED IN UNDERCUT AREAS, AND THE UNDERCUT DEPTH MAY BE ADJUSTED AT CROSS DRAINS AS DIRECTED BY THE ENGINEER. FOR ADDITIONAL DETAILS THE CONTRACTOR IS REFERRED TO THE NOTICE TO BIDDERS ON DESIGN SOIL MATERIAL IN THE CONTRACT PROPOSAL DOCUMENT.
- (10) VOIDS CREATED BY THE REMOVAL OF, BUT NOT LIMITED TO, POSTS, CONCRETE ANCHORS, AND FOOTINGS SHALL BE BACKFILLED AND TAMPED IN ACCORDANCE WITH SECTION 203 OF **THE MISSISSIPPI STANDARD SPECIFICATIONS FOR ROAD AND BRIDGE CONSTRUCTION**, THE COST OF WHICH WILL BE ABSORBED IN OTHER ITEMS BID.
- (11) WORK ON STRUCTURES FOR THIS PROJECT REQUIRES EXCAVATION IN THE IMMEDIATE VICINITY OF TRAFFIC AND ADJACENT PROPERTIES. THEREFORE, THE RISK OF A FAILURE OCCURRING DURING EXCAVATION REQUIRES THAT EXTREME CAUTION BE EXERCISED. THE CONTRACTOR SHALL BE RESPONSIBLE FOR PLACING WHAT BRACING, SHORING, OR GROUND SUPPORT SYSTEM THAT IS DEEMED NECESSARY TO PREVENT A FAILURE AND PROTECT THE PERSONS WORKING NEAR THE EXCAVATION, THE PUBLIC THAT MAY BE ABOVE THE EXCAVATION, OR ANY STRUCTURES ADJACENT TO THE EXCAVATION. ALL COSTS FOR DESIGNING, DRAWING, AND CONSTRUCTING THE FACILITY SHALL BE INCLUDED IN THE PRICE BID FOR CONTRACT ITEMS.
- (12) VEGETATIVE MATERIAL WILL BE REMOVED PRIOR TO PLACEMENT OF GRANULAR MATERIAL. THE COST OF WHICH SHALL BE ABSORBED IN OTHER ITEMS BID.
- (13) PRIOR TO EARTHWORK OPERATIONS, THE EXISTING TOP 4" TOPSOIL IS TO BE STRIPPED AND STOCKPILED. AFTER THE GRADING OPERATIONS ARE COMPLETED, SAID TOPSOIL SHALL BE PLACED ON ALL AREAS THAT ARE NOT TO BE PAVED OR OTHERWISE PROTECTED, IN ACCORDANCE WITH SECTION 211 OF THE SPECIFICATIONS, OR THE VEGETATION SCHEDULE (SEE WK. SH. VS-1). EXISTING TOPSOIL AND ALL COSTS ASSOCIATED WITH STRIPPING, HAULING, STOCKPILING, AND PLACEMENT OF THE EXISTING TOPSOIL IS TO BE ABSORBED IN OTHER EARTHWORK ITEMS.

GENERAL NOTES (CONT'D)

EROSION CONTROL - TEMPORARY

- (14) WIRE FENCE BACKING WILL BE REQUIRED FOR ALL SILT FENCE. (SEE WK. NO. ECD-3)
- (15) THE EROSION CONTROL DEVICES REFERENCED IN THESE PLANS ARE A MINIMUM REQUIREMENT. IT IS THE RESPONSIBILITY OF THE CONTRACTOR TO ENSURE THAT SILT DOES NOT LEAVE THE RIGHT OF WAY OR CONTAMINATE WATERS OF THE U. S. DURING CONSTRUCTION. THE CONTRACTOR SHALL SUBMIT AN EROSION CONTROL PLAN PRIOR TO COMMENCEMENT OF WORK AND MAINTAIN THE PLAN DURING CONSTRUCTION. ANY ADDITIONAL SILT BASINS NOT SHOWN IN THE PLANS SHALL BE INCLUDED IN THE CONTRACTOR'S EROSION CONTROL PLAN PRIOR TO SUBMITTING FOR APPROVAL.
- (16) ALL ITEMS OF WORK ASSOCIATED WITH THE INSTALLATION OF A CONSTRUCTION ENTRANCE SHALL BE ABSORBED IN OTHER ITEMS OF WORK.

ENVIRONMENTAL & CLEARING

- (17) NO TEMPORARY CULVERT STREAM CROSSINGS WILL BE ALLOWED.

PAVEMENT, BASE, AND SHOULDERS

- (18) THE CONTRACTOR SHALL REPAIR ANY DAMAGE TO THE PAVED OR UNPAVED SHOULDER THAT MIGHT OCCUR DURING CONSTRUCTION. ANY REPAIR TO SHOULDER WILL BE IN ACCORDANCE WITH THE APPLICABLE SECTIONS OF **THE MISSISSIPPI STANDARD SPECIFICATIONS FOR ROAD AND BRIDGE CONSTRUCTION**. NO PAYMENT WILL BE MADE FOR REPAIR OF DAMAGED SHOULDER.
- (19) TEMPORARY PAVEMENT JOINTS (PAPER JOINTS) SHALL BE EMPLOYED AT ALL LOCATIONS REQUIRING TRAFFIC TO TRAVERSE AN UNEVEN PAVEMENT JOINT. PAPER JOINTS SHALL BE A MINIMUM OF OF 9 FEET IN LENGTH AND SHALL BE ADEQUATELY MAINTAINED.
- (20) WHERE MILLING IS REQUIRED, THE CONTRACTOR SHALL PROVIDE OUTLETS IN THE EXISTING SHOULDERS AT SUFFICIENT INTERVALS TO PREVENT POOLING OR STANDING WATER ON THE MILLED SURFACE, THE COST OF WHICH SHALL BE ABSORBED IN OTHER ITEMS BID.

PLANS

- (21) IF COLORS ARE USED ON PLAN/PROFILE SHEETS, THEY ARE INTENDED TO VISUALLY EASE THE LOCATION OF ELEMENTS FOR USERS OF THESE DRAWINGS. ALTHOUGH THE INTENT IS TO CATEGORIZE EVERYTHING AS EITHER EXISTING OR PROPOSED, IT IS THE END USER'S RESPONSIBILITY TO ENSURE ALL ELEMENTS ARE INTERPRETED CORRECTLY, REGARDLESS OF COLOR.
- (22) ALL ADDENDA TO THESE PLANS WILL BE POSTED TO WWW.MDOT.MS.GOV UNDER THE PROPOSAL ADDENDA COLUMN. BIDDERS ARE ADVISED THAT HARD COPIES OF ANY ADDENDA FOR THIS PROJECT WILL NOT BE MAILED. IT IS THE BIDDER'S RESPONSIBILITY TO CHECK AND SEE IF ANY ADDENDA HAVE BEEN POSTED FOR THIS PROJECT.
- (23) SEE BRIDGE PLANS FOR DETAILED INDEX SHEET(S), ESTIMATED AND SUMMARY OF QUANTITY SHEETS, AND EROSION CONTROL SHEETS.

ROADSIDE BARRIERS

- (24) ALL DIMENSIONS AND SPACINGS FOR BRIDGE RAIL CONNECTORS SHALL BE VERIFIED IN THE FIELD BY THE CONTRACTOR PRIOR TO FABRICATION.

TRAFFIC CONTROL - PERMANENT

- (25) INSTALLATION DATES SHALL BE CLEARLY WRITTEN IN BOLD BLACK MARKINGS ON THE BACK BOTTOM HALF OF ALL SIGNS WITH A PERMANENT MARKING STICK THAT IS WATERPROOF, FADE RESISTANT AND MARKS ON WET OR DRY SURFACES.
- (26) ALL POST, PIPE, AND I-BEAM LENGTHS IN THESE PLANS ARE ESTIMATES. POST LENGTHS FOR ALL SIGNS SHALL BE VERIFIED IN THE FIELD BY THE CONTRACTOR PRIOR TO FABRICATION.
- (27) ALL EXISTING SIGNS WHICH ARE TO BE REMOVED AS A PART OF THIS PROJECT THAT ARE NOT IN CONFLICT WITH CONSTRUCTION SHALL REMAIN IN PLACE UNTIL NEW SIGNS ARE INSTALLED UNLESS NOTED OR DIRECTED OTHERWISE BY THE PROJECT ENGINEER. ROADWAY SIGNS THAT ARE IN CONFLICT WITH CONSTRUCTION SHALL BE REMOVED AND RELOCATED BY THE CONTRACTOR AS DIRECTED BY THE ENGINEER, THE COST OF WHICH SHALL BE ABSORBED IN OTHER ITEMS BID.

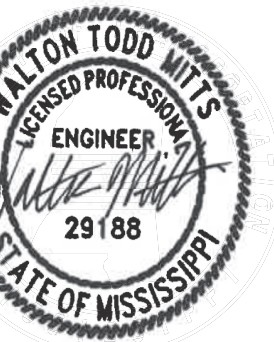

DESIGNED BY:
 DETAILED BY:
 CHECKED BY:
 DATE:

FMS CON: 103896/303000

PROJECT NO.: CRP-0024-04(031)

COUNTY: NESHOMA

GENERAL NOTES

SHEET ID
GN-1

SHEET NO.
6

GENERAL NOTES (CONT'D)

- (28) DIRECT-APPLIED LEGEND, BORDER, AND/OR SHIELDS ARE TO BE USED ON ALL GUIDE SIGNS. DIGITALLY PRODUCED SIGN COPY, SHIELDS, LEGEND, SYMBOLS, OR IMAGES WILL NOT BE ALLOWED WITHOUT WRITTEN APPROVAL FROM MDOT'S PROJECT ENGINEER.
- (29) ALL PERMANENT SIGNS SHALL CONFORM TO THE LATEST EDITION OF THE MANUAL ON UNIFORM TRAFFIC CONTROL DEVICES.
- (30) ALL SIGN LOCATIONS SHALL BE APPROVED BY THE PROJECT ENGINEER PRIOR TO INSTALLATION.
- (31) THE RETROREFLECTIVE SIGN SHEETING ON PERMANENT GROUND-MOUNTED SIGNS SHALL BE AS FOLLOWS: BROWN BACKGROUND SHEETING ON GUIDE SIGNS SHALL BE MINIMUM TYPE VIII; GREEN AND BLUE BACKGROUND SHEETING ON GUIDE SIGNS SHALL BE MINIMUM TYPE IX; ALL WHITE, YELLOW, FLUORESCENT YELLOW AND FLUORESCENT YELLOW/GREEN SHEETING SHALL BE TYPE XI. ALL SIGN SHEETING ON OVERHEAD SIGNS SHALL BE TYPE XI.
- (32) ALL EXISTING SIGNS AND SUPPORTS REMOVED UNDER THIS PROJECT SHALL BECOME THE PROPERTY OF THE CONTRACTOR AND ARE NOT A SEPARATE PAY ITEM.
- (33) ALL SIDE ROAD, STOP SIGN MOUNTED STREET NAME SIGNS TO BE SALVAGED AND STORED AT THE DIRECTION OF THE PROJECT ENGINEER FOR DELIVERY TO THE CITY (NOT A SEPARATE PAY ITEM).
- (34) REMOVAL OF RAISED PAVEMENT MARKERS THAT ARE IN CONFLICT WITH REQUIRED CONSTRUCTION IS NOT CONSIDERED A SEPARATE PAY ITEM. COST TO BE ABSORBED IN OTHER ITEMS BID.
- (35) REMOVAL OF OBJECT MARKERS IS NOT CONSIDERED A SEPARATE PAY ITEM, AND SHALL BE ABSORBED IN OTHER ITEMS BID.

TRAFFIC CONTROL - TEMPORARY

- (36) THE LOCATION AND SPACING OF SIGNS, SHOWN ON THE TRAFFIC CONTROL PLANS, ARE APPROXIMATE AND MAY BE ADJUSTED AS NECESSARY TO FIT FIELD CONDITIONS.
- (37) ALL TRAFFIC CONTROL DEVICES ON THIS PROJECT SHALL COMPLY WITH PART VI OF THE **MUTCD** (LATEST EDITION).
- (38) ALL PLASTIC DRUMS SHALL HAVE A BALLASTING COLLAR MADE FROM RECYCLED TRUCK TIRES OR OTHER SUITABLE MATERIAL.
- (39) FLUORESCENT ORANGE SHEETING SHALL BE USED ON ALL CONSTRUCTION AND TRAFFIC CONTROL SIGNS EXCEPT FOR THOSE DESIGNATED ON THE PLANS TO BE BLACK LEGEND AND BORDER ON WHITE BACKGROUND.
- (40) THE CONTRACTOR SHALL COORDINATE WITH THE CONTRACTOR FROM ADJACENT PROJECT(S) IN IMPLEMENTING THE TRAFFIC CONTROL PLAN AS DIRECTED BY THE ENGINEER. ALL CONFLICTING SIGNS SHALL BE COVERED OR REMOVED AS DIRECTED BY THE ENGINEER.
- (41) THE CONTRACTOR SHALL COVER OR REMOVE ANY TEMPORARY TRAFFIC CONTROL SIGNS SHOWN IN THE TRAFFIC CONTROL PLAN THAT DO NOT APPLY TO THE CURRENT PHASE.
- (42) THE RETROREFLECTIVE SIGN SHEETING ON RIGID, TEMPORARY TRAFFIC CONTROL (ORANGE) SIGNS SHALL BE MINIMUM TYPE IX.
- (43) TEMPORARY STRIPING SHALL CONFORM TO FINISHED STRIPE SPECIFICATIONS FOR ALIGNMENT, NEATNESS, AND STRAIGHTNESS.

UTILITIES

- (44) UTILITIES ON THE DRAWINGS ARE SHOWN IN THEIR ORIGINAL LOCATION BASED UPON THE BEST INFORMATION AVAILABLE TO THE ENGINEER. UTILITIES THAT WERE FOUND TO BE IN CONFLICT WITH CONSTRUCTION HAVE BEEN RELOCATED. PERMITS ARE ON FILE WITH THE DEPARTMENT SHOWING THE APPROXIMATE LOCATION OF UTILITIES RELOCATED WITHIN THE RIGHT-OF-WAY. THE ENGINEER CAN NOT AND DOES NOT WARRANT THAT THIS INFORMATION IS COMPLETE OR ACCURATE. THE CONTRACTOR MUST COORDINATE DIRECTLY WITH THE INVOLVED UTILITY OWNERS TO HAVE UNDERGROUND UTILITY LINES FIELD LOCATED IN ADVANCE OF CONSTRUCTION.
- (45) FOR LIST OF PUBLIC UTILITIES, SEE WORKING NO. 3.

GENERAL NOTES (CONT'D)

MISCELLANEOUS

- (46) SOME WORK IS REQUIRED OUTSIDE THE PROJECT LIMITS. NO ADDITIONAL COMPENSATION WILL BE MADE FOR SUCH WORK EXCEPT AS PROVIDED BY SPECIFIC PAY ITEMS INCLUDED IN THE PLANS.
- (47) THE CONTRACTOR SHALL BE RESPONSIBLE FOR MAINTAINING AND RELOCATING MAIL BOXES AS NECESSARY TO MAINTAIN CONTINUOUS MAIL SERVICE THROUGHOUT THE LIFE OF THE PROJECT, THE COST OF WHICH SHALL BE ABSORBED IN OTHER ITEMS BID.
- (48) THE CONTRACTOR IS RESPONSIBLE FOR FIELD-VERIFICATION OF EXISTING GRADES AND MAKING ADJUSTMENTS AS NECESSARY WITH THE APPROVAL OF THE PROJECT ENGINEER.
- (49) THE CONTRACTOR SHALL COORDINATE AND CONDUCT WORK AT LOCAL ROADS AND DRIVEWAYS IN A MANNER SUCH THAT ACCESS IS NOT INTERRUPTED UNNECESSARILY. ACCESS SHALL BE PRESERVED IN THE BEST MANNER POSSIBLE. COORDINATION AND COMMUNICATION WITH LANDOWNERS MAY BE NECESSARY TO PREVENT INTERRUPTION OF DRIVEWAY ACCESS.
- (50) ALL REFERENCE TO STP-0024-04(031), STP-0024-04(032), AND STP-0024-04(033) IS UNDERSTOOD TO REFER TO CRP-0024-04(031), CRP-0024-04(032), AND CRP-0024-04(033), RESPECTIVELY.
- (51) THE NOTES CONTAINED HEREON ARE SPECIFIC TO THE SUBJECT PROJECT AND SHOULD BE REVIEWED IN DETAIL BY THE CONTRACTOR. PER SECTION 102.05 OF THE STANDARD SPECIFICATIONS, "THE BIDDER IS REQUIRED TO EXAMINE CAREFULLY THE SITE OF THE PROPOSED WORK, THE PROPOSAL, PLANS, STANDARD SPECIFICATIONS, SPECIAL PROVISIONS, NOTICE TO BIDDERS, AND CONTRACT FORMS BEFORE SUBMITTING A PROPOSAL."

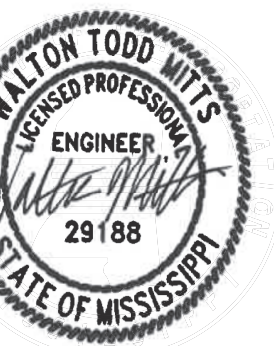

DESIGNED BY:
 DETAILED BY:
 CHECKED BY:
 DATE:

FMS CON: 103896/303000

PROJECT NO.: CRP-0024-04(031)

COUNTY: NESHOMA

GENERAL NOTES

SHEET ID
GN-2

SHEET NO.
7