

GENERAL INDEX

INCLUDED THIS PROJECT	BEGIN WITH SHEET
<input type="checkbox"/> ROADWAY	1
<input type="checkbox"/> PERMANENT SIGNS	1001
<input type="checkbox"/> TRAFFIC SIGNALS	2001
<input type="checkbox"/> ITS COMPONENTS	3001
<input type="checkbox"/> LIGHTING	4001
<input type="checkbox"/> (RESERVED)	5001
<input type="checkbox"/> ROADWAY STANDARD DWGS	6001
<input type="checkbox"/> BOX CULVERT STD. DRAWINGS (LRFD)	7001
<input type="checkbox"/> BOX CULVERT STD. DRAWINGS (STD. SPEC.)	7501
<input type="checkbox"/> BRIDGE	8001
<input type="checkbox"/> CROSS SECTIONS	9001

BRIDGE STRUCTURES REQ'D.

BOX BRIDGES REQ'D.

B.O.P. 405 + 87

E.O.P. 748 + 58

STATE OF MISSISSIPPI
MISSISSIPPI DEPARTMENT OF TRANSPORTATION
PLAN AND PROFILE OF PROPOSED
STATE HIGHWAY
FEDERAL AID PROJECT .NO. NHPP-0077-01(007)
US 278 FROM SR 338 TO SR 15 FMS CON. NO. 108650/ 301000
PONTOTOC COUNTY

SCALES			
PLAN		1 IN. =	100 FT.
PROFILE {	HOR.	1 IN. =	100 FT.
	VERT.	1 IN. =	10 FT.
LAYOUT		1 IN. =	FT.

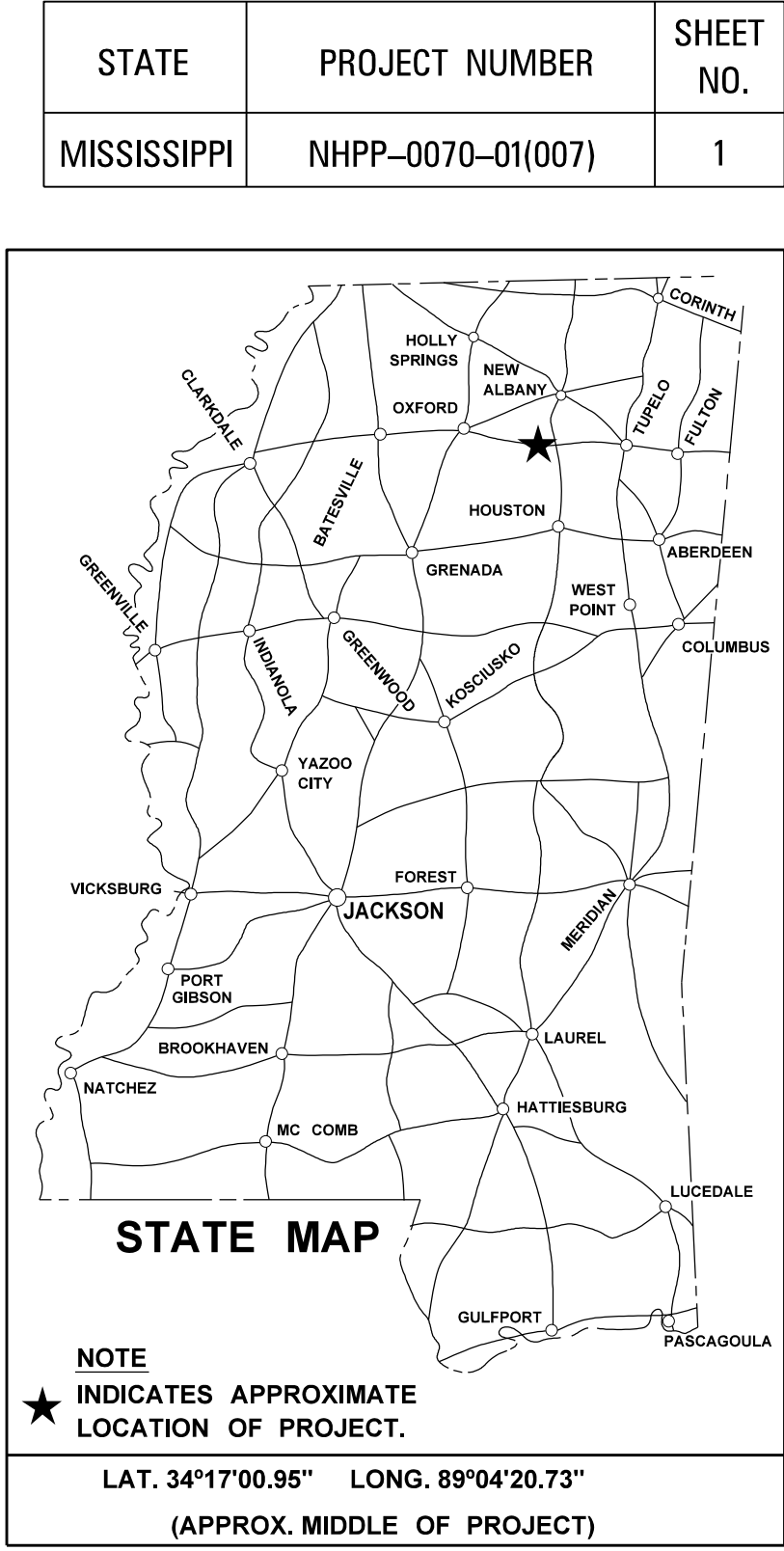
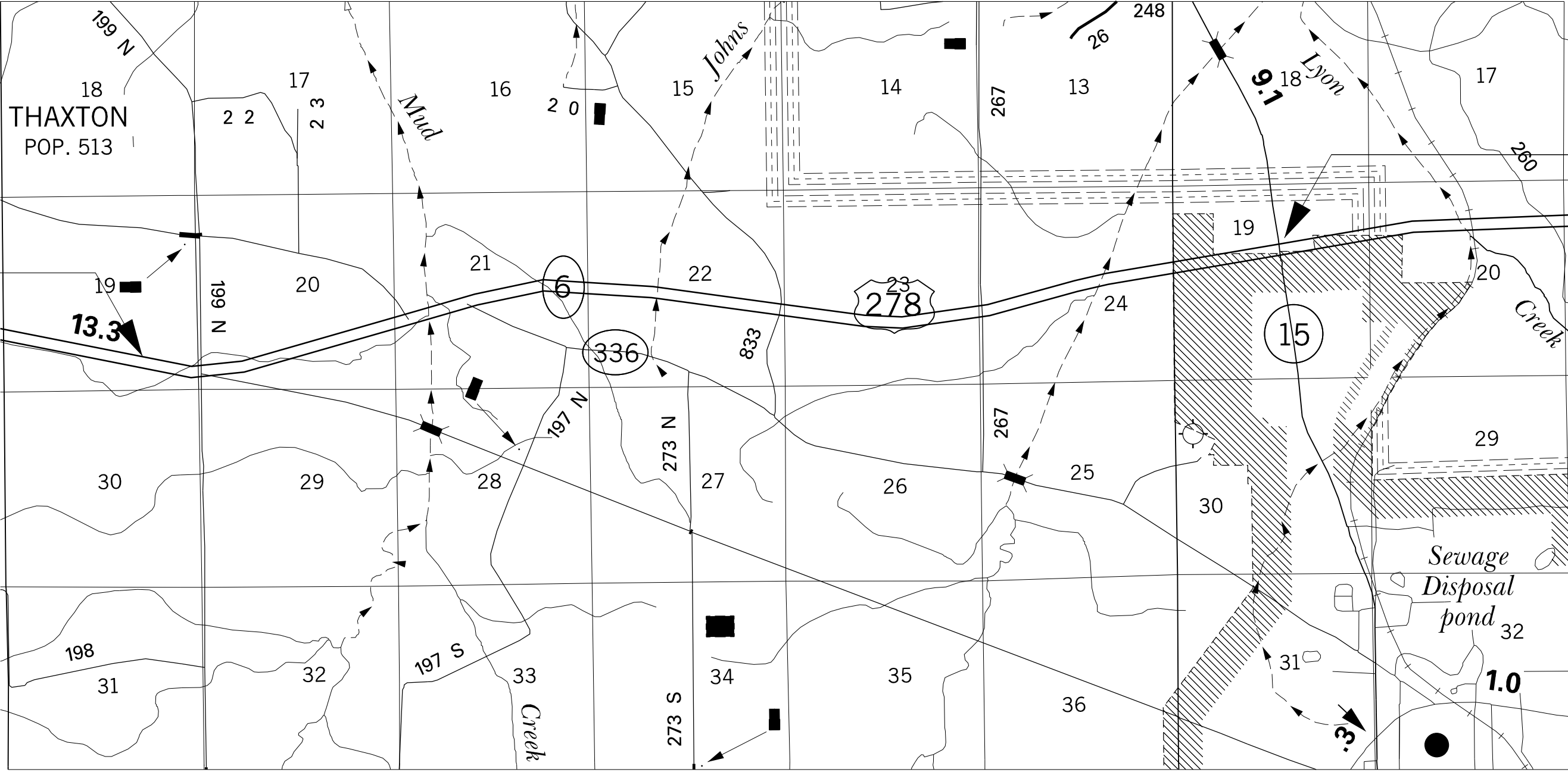

DESIGN CONTROL	
MPH =	V (SPEED DESIGN)
ADT () =	: ADT () =
DHV =	: D = % T = %

PERMITS ACQUIRED BY MDOT		
WETLANDS AND WATERS PERMITS		
	WATERS	WETLANDS
NATIONWIDE #14	<input type="checkbox"/> N	<input type="checkbox"/> N
NATIONWIDE (OTHER)*	<input type="checkbox"/> N	<input type="checkbox"/> N
GENERAL*	<input type="checkbox"/> N	<input type="checkbox"/> N
INDIVIDUAL (404)*	<input type="checkbox"/> N	<input type="checkbox"/> N
STORMWATER PERMIT <input type="checkbox"/> N		
Y	REQUIRED, CNOI SUBMITTED BY MDOT (DISTURBED AREA > 5 ACRES)	
S	REQUIRED, SCNOI TO BE SUBMITTED BY CONTRACTOR (1 TO 4.99 ACRES)	
N	NO STORMWATER PERMIT REQUIRED (<1 ACRE)	
APPROVED BY: _____		

CONVENTIONAL SYMBOLS

COUNTY LINE	-----
TOWN CORPORATION LINE	-----
SECTION LINE	-----
EXISTING ROAD OR TRAVELED WAY	-----
PROPOSED ROAD OR TRAVELED WAY	-----
RAILROAD	-----
SURVEY LINE	-----
BRIDGES	-----

EQUATIONS

LENGTH DATA

LENGTH OF ROADWAY	30,721	FT.	5.818	MI.
LENGTH OF BRIDGES	250	FT.	0.048	MI.
LENGTH OF PROJECT (NET)	34,271	△	6.491	△
LENGTH OF EXCEPTIONS	0	△	0.000	△
LENGTH OF PROJECT (GROSS)	34,271	△	6.491	MI.

EXCEPTIONS

P S & E DATE: 5/25/21			
APPROVED:			
DEPUTY EXECUTIVE DIRECTOR / CHIEF ENGINEER			
EXECUTIVE DIRECTOR			
			

DESCRIPTION OF SHEET

TITLE SHEET (1)

DETAILED INDEX & GENERAL NOTES (1)

DETAILED INDEX & GENERAL NOTES

TYPICAL SECTION SHEETS (2)

TYPICAL MILLING & OVERLAY SECTION - WESTBOUND

TYPICAL OVERLAY SECTION - EASTBOUND

QUANTITY SHEETS (2)

SUMMARY OF QUANTITIES

SUMMARY OF QUANTITIES

SPECIAL DESIGN SHEETS (1)

DETAIL OF CONSTRUCTION SIGNING

STANDARD DRAWINGS - ROADWAY SHEETS (17)

PAVEMENT MARKING DETAILS FOR 2 AND 4-LANE DIVIDED ROADWAYS

PAVEMENT MARKING LEGEND DETAILS

TYPICAL PAVEMENT MARKING DETAIL FOR MEDIAN CROSSOVERS

TWO-WAY CLEAR RAISED PAVEMENT MARKERS ON SIDE ROADS

RUMBLE STRIPES FOUR-LANE HIGHWAYS

TYPICAL INSTALLATION AND DETAILS OF DELINEATORS

TYPICAL INSTALLATION OF DELINEATORS

TYPICAL CROSSOVER DELINEATION

TYPICAL GUARDRAIL DELINEATION

TRAFFIC CONTROL PLAN FOR LANE CLOSURE EXTENDED PERIOD

TRAFFIC CONTROL PLAN FOR LANE CLOSURE WORK DAY ONLY

SHORT DURATION CLOSING OF DIVIDED HIGHWAYS

HIGHWAY SIGN AND BARRICADE DETAILS FOR CONSTRUCTION PROJECTS

TRAFFIC CONTROL PLAN MOBILE OPERATIONS MULTILANE ROADS AND TWO-LANE ROADS

DETAILS OF OUTSIDE LANE CLOSURE AT EXIT RAMP

TRAFFIC CONTROL PLANS UNEVEN PAVEMENT DETAILS

TEMPORARY STRIPING FOR TRAFFIC CONTROL 2-LANE AND 4-LANE DIVIDED HIGHWAYS

TOTAL NUMBER OF SHEETS (24)

GENERAL NOTES

- (1) THE LOCATION, NUMBER, AND SPACING OF SIGNS, SHOWN ON THE TRAFFIC CONTROL PLANS, ARE APPROXIMATE AND MAY BE ADJUSTED AS NECESSARY TO FIT FIELD CONDITIONS.
- (2) FLUORESCENT ORANGE SHEETING SHALL BE USED ON ALL CONSTRUCTION AND TRAFFIC CONTROL SIGNS EXCEPT FOR THOSE DESIGNATED ON THE PLANS TO BE BLACK LEGEND AND BORDER ON WHITE BACKGROUND.
- (3) ALL TRAFFIC CONTROL DEVICES ON THIS PROJECT SHALL COMPLY WITH PART VI OF THE MUTCD (LATEST EDITION).
- (4) BIDDER ARE ADVISED THAT HARD COPIES OF ANY ADDENDA FOR THIS PROJECT WILL NO LONGER BE MAILED. ALL ADDENDA FOR THIS PROJECT WILL BE POSTED TO WWW.MDOT.MS.GOV UNDER THE PROPOSAL ADDENDA COLUMN. IT IS THE BIDDERS RESPONSIBILITY TO CHECK AND SEE IF ANY ADDENDA HAVE BEEN POSTED FOR THIS PROJECT. PLEASE CONTACT CONTRACT ADMINISTRATION DIVISION AT 601-359-7700 FOR ANY QUESTIONS REGARDING ELECTRONIC ADDENDA.
- (5) PRIOR TO PLACING ANY BITUMINOUS PAVEMENT AND FINE MILLING, THE EXISTING SHOULDERS ARE TO BE BLADED FOR A MINIMUM OF 1' BEYOND THE EDGE OF THE EXISTING PAVEMENT TO REMOVE VEGETATION AND EXCESS SHOULDER MATERIAL (NOT A PAY ITEM).
- (6) NO ADDITIONAL COMPENSATION WILL BE MADE FOR INSTANCES WHERE CONCRETE IS ENCOUNTERED DURING MILLING OPERATIONS AND IS TO BE ABSORBED IN THE MILLING PAY ITEM.

PS & E PLANS-DATE...07/23/		
FMS CON. # 108650/301000		
REVISIONS		
DATE	SHEET NO.	BY

[illegible]