

**SECTION 905 -- PROPOSAL (CONTINUED)**

I (We) hereby certify by digital signature and electronic submission via Bid Express of the Section 905 proposal below, that all certifications, disclosures and affidavits incorporated herein are deemed to be duly executed in the aggregate, fully enforceable and binding upon delivery of the bid proposal. I (We) further acknowledge that this certification shall not extend to the bid bond or alternate security which must be separately executed for the benefit of the Commission. This signature does not cure deficiencies in any required certifications, disclosures and/or affidavits. I (We) also acknowledge the right of the Commission to require full and final execution on any certification, disclosure or affidavit contained in the proposal at the Commission's election upon award. Failure to so execute at the Commission's request within the time allowed in the Standard Specifications for execution of all contract documents will result in forfeiture of the bid bond or alternate security.

Bidder acknowledges receipt of and has added to and made a part of the proposal and contract documents the following addendum (addenda):

ADDENDUM NO. <u>  1  </u>	DATED <u>  1/26/2026  </u>	ADDENDUM NO. _____	DATED _____
ADDENDUM NO. <u>  2  </u>	DATED <u>  1/29/2026  </u>	ADDENDUM NO. _____	DATED _____
ADDENDUM NO. _____	DATED _____	ADDENDUM NO. _____	DATED _____

- | Number | Description  |
|--------|--|
| 1      | Postponed Letting Date to February 3, 2026; Amendment EBSx Download Required.  |
| 2      | Revised Table of Contents; Revised Advertisement; Added NTB No. 14 w/Supplement; Removed NTB No. 5750; Removed NTB No. 7409; Added NTB No. 7531; Added NTB No. 7585; Added NTB No. 7586; Revised Wage Rates; Added SP 907-899-1; Revised Bid Items; Revised Plan Sheet Nos. 2, 10-13, 28, 46-47, 54-57, 59, 6051, 6064, 6304-6306, 6314, 6317-6318, 6351, 6356, 6358-6359, 6362, 6363, & 6366; Amendment EBSx Download Required. |

TOTAL ADDENDA:   2    
(Must agree with total addenda issued prior to opening of bids)

Respectfully Submitted,

DATE \_\_\_\_\_

\_\_\_\_\_  
Contractor

BY \_\_\_\_\_  
Signature

TITLE \_\_\_\_\_

ADDRESS \_\_\_\_\_

CITY, STATE, ZIP \_\_\_\_\_

PHONE \_\_\_\_\_

FAX \_\_\_\_\_

E-MAIL \_\_\_\_\_

(To be filled in if a corporation)

Our corporation is chartered under the Laws of the State of \_\_\_\_\_ and the names, titles and business addresses of the executives are as follows:

_____ President	_____ Address
_____ Secretary	_____ Address
_____ Treasurer	_____ Address

The following is my (our) itemized proposal.  
BR-2909-00(006)/ 106103301000  
Marshall County(ies)  
Revised 01/26/2016

**MISSISSIPPI DEPARTMENT OF TRANSPORTATION  
TABLE OF CONTENTS**

**PROJECT: BR-2909-00(006)/106103301 - Marshall**

Section 901 - Advertisement

Section 904 - Notice to Bidders

#1	Governing Specification, w/ Supplement
#2	Status of ROW, w/ Attachments
#3	Final Cleanup
#14	Railway-Highway Provision, w/Supplement
#23	Exposure to Moderate Sulfate Areas Below Ground Level
#296	Reduced Speed Limit Signs
#445	Mississippi Agent or Qualified Nonresident Agent
#447	Traffic on Milled Surface in Rural Areas
#516	Errata and Modifications to the 2017 Standard Specifications
#757	Additional Erosion Control Requirements
#1225	Early Notice to Proceed
#1226	Material Storage Under Bridges
#1241	Fuel and Material Adjustments
#1434	Erosion Control Plan
#1963	Guardrail Pads
#2172	App for Storm Water Reports
#2206	MASH Compliant Devices
#2273	Mississippi Special Fuel Tax Law
#2895	Exploratory Joint Cleanout
#2954	Reflective Sheeting for Signs
#3676	Asphalt Gyratory Compactor Internal Angle Calibration
#3963	Super Silt Fence
#4113	Unique Entity ID Requirement For Federal Funded Projects
#4638	Storm Water Discharge Associated with Construction Activity (> 5 Acres)
#4699	Right-of-Way Plat
#4702	App for Traffic Control Report
#5086	Detail of Square Tube Sign Posts
#5551	Federal Bridge Formula
#5570	Special Provisions Related to Concrete
#7304	Erosion Control Contract Compliance
#7530	Contract Time
#7531	Specialty Items
#7533	Corrugated Pipe Installed by MDOT Forces
#7534	Additional Construction Requirements
#7535	Removal of Obstructions
#7578	Obligation Date
#7584	Placement of Fill Material in Federally Regulated Areas
#7585	Pay Item Correction
#7586	Type C Filter Material – Gradation Revision
906	Required Federal Contract Provisions -- FHWA 1273, w/Supplements

**PROJECT: BR-2909-00(006)/106103301 - Marshall**

Section 907 - Special Provisions

907-101-1	Definitions and Terms
907-102-2	Bidding Requirements and Conditions
907-104-2	Minor Alterations to the Contract
907-105-2	Control of Work
907-106-4	Control of Materials
907-107-2	Contractor's Erosion Control Plan
907-108-4	Subletting of Contract
907-108-6	Default and Termination of Contract
907-109-5	Measurement and Payment
907-234-1	Silt Fence
907-401-2	Asphalt Pavements - General
907-403-4	Asphalt Pavements
907-502-1	Concrete Bridge End Pavement
907-601-1	Structural Concrete
907-618-12	Traffic Control Management
907-619-5	Traffic Control for Construction Zones
907-626-12	Thermoplastic Traffic Markings
907-627-1	Raised Pavement Markings
907-700-2	Materials and Tests w/Attachment
907-701-4	Hydraulic Cement, w/ Supplement
907-702-4	Bituminous Materials
907-703-2	Gradation
907-705-1	Stone Riprap
907-707-3	Joint Materials
907-708-4	Concrete Pipe
907-711-2	Plain Steel Wire
907-712-1	Fence and Guardrail
907-714-4	Miscellaneous Materials
907-718-1	Timber and Dimension Lumber
907-720-4	Pavement Marking Materials
907-721-4	Materials for Signing
907-799-1	Hydraulic Cement Mixtures
907-803-5	Test Piles, w/ Supplement
907-803-6	Deep Foundations
907-804-13	Concrete Bridges and Structures w/ Supplement
907-823-8	Preformed Joint Seal
907-899-1	Railway-Highway Provisions

Section 905 - Proposal, Proposal Bid Items, Combination Bid Proposal

Certification of Performance - Prior Federal-Aid Contracts

Certification Regarding Non-Collusion, Debarment and Suspension

SAM.GOV Registration and Unique Entity ID

Section 902 - Contract Form

Section 903 - Contract Bond Forms

Progress Schedule

**PROJECT: BR-2909-00(006)/106103301 - Marshall**

(REVISIONS TO THE ABOVE WILL BE INDICATED ON THE SECOND SHEET  
OF SECTION 905 AS ADDENDA)

01/28/2026 03:29 PM

# MISSISSIPPI DEPARTMENT OF TRANSPORTATION

## SECTION 901 - ADVERTISEMENT

Electronic bids will be received by the Mississippi Transportation Commission at 10:00 o'clock A.M., Tuesday, February 03, 2026, from the Bid Express Service and shortly thereafter publicly read in the Construction Division for:

Bridge Replacement on SR 178 (Bridge Nos. 33.6, 34.1, 35.2, 35.4 & 35.6), known as Federal Aid Project No. BR-2909-00(006) / 106103301 in Marshall County.

The attention of bidders is directed to the Contract Provisions governing selection and employment of labor. Minimum wage rates have been predetermined by the Secretary of Labor and are subject to Public Law 87-581, Work Hours Act of 1962, as set forth in the Contract Provisions.

Contractors may request permission to bid online at <http://shop.mdot.ms.gov> at no cost. Upon approval, Contractors shall be eligible to submit a bid using Bid Express at <http://bidx.com>. Specimen proposals may be viewed and downloaded online at no cost at <http://mdot.ms.gov> or purchased online at <http://shop.mdot.ms.gov> at a cost of Ten Dollars (\$10.00) per proposal plus a small convenience fee. Cash or checks will not be accepted as payment.

Plans must be purchased online at <https://shop.mdot.ms.gov>. Costs of plans will be on a per sheet basis plus a small convenience fee. If you have any questions, you can contact the MDOT Plans Print Shop at (601) 359-7460, or e-mail at [plans@mdot.state.ms.us](mailto:plans@mdot.state.ms.us). Plans will be shipped upon receipt of payment. Cash or checks will not be accepted as payment.

Bid bond, signed or countersigned by a Mississippi Agent or Qualified Nonresident Agent, with Power of Attorney attached, a Cashier's check or Certified Check for five (5%) percent of bid, payable to STATE OF MISSISSIPPI, must accompany each proposal.

The attention of bidders is directed to the provisions of Subsection 102.07 pertaining to irregular proposals and rejection of bids.

BRAD WHITE  
EXECUTIVE DIRECTOR

# MISSISSIPPI DEPARTMENT OF TRANSPORTATION

## SUPPLEMENT TO NOTICE TO BIDDERS NO. 14

**DATE:** 01/22/2026

**PROJECT:** BR-2909-00(006) / 106103301 – Marshall County

Prior to bidding, the Contractor shall contact the **BNSF Railway** concerning insurance coverage required for this project. In case the railroad requires coverage above and beyond that required by the Standard Specifications, the railroad requirements shall be met.

The name insured, description of the work and designation of the job site to be shown on the policy are as follows:

Name Insured: BNSF Railway Company

Description

And Designation: Bridge Replacement on SR 178 (Bridge Nos. 33.6, 34.1, 35.2, 35.4 & 35.6)

Approximate

Midpoint of Project: Latitude: 34.7183333, Longitude: -89.4105556

(Railroad is near or adjacent to SR 178 throughout the project)

Notice of starting to work and correspondence pertaining to railroad liability insurance shall be directed to:

Drexel Verrette Jr.  
Manager of Public Projects  
AL, AR, LA, MS, TN  
Drexel.Verrette@bnsf.com  
Cell: (559)-353-4265

# MISSISSIPPI DEPARTMENT OF TRANSPORTATION

SECTION 904 - NOTICE TO BIDDERS NO. 14

CODE: (SP)

DATE: 01/17/2017

SUBJECT: Railway-Highway Provisions

Prior to bidding, the Contractor shall contact the Railroad concerning insurance coverage required for this project. In case the railroad requires coverage over and above that required by the Standard Specifications, the railroad requirements shall be met.

The name insured, description of the work and designation of the job site to be shown on the Policy are as follows:

Notice of starting to work, completion of any required forms, and correspondence pertaining to railroad liability insurance shall be directed to the person below.

The Contractor shall not commence, or carry on, any work for installation, maintenance, repair, changing or renewal of any FACILITY, under, over or on RAILROAD property at any location without giving at least ten (10) working days prior notice to the RAILROAD authorized representative at the RAILROAD's office(s) below.

If in the opinion of the RAILROAD, the presence of an authorized representative of the RAILROAD is required to supervise the same, the RAILROAD shall render bills to the Contractor for all expenses incurred by it for such supervision. This includes all labor costs for flagmen or cable locate supplied by the RAILROAD to protect RAILROAD operation, and for the full cost of furnishing, installation and later removal of any temporary supports for said tracks, as the RAILROAD's Chief Engineer's Office may deem necessary.

**It will be the Contractor's responsibility to pay all bills associated with railroad flagging and cable locating.** Generally, the flagging rate is \$700.00 per day (1 to 8 hours) plus overtime at \$125.00 per hour, however, the Contractor shall contact the RAILROAD to verify all rates.

A flagman is required anytime a Contractor does any work on or near RAILROAD property within twenty-five (25) feet horizontally of the centerline or any work over any railroad track. The RAILROAD, however, also reserves the right to require a flagman for work on RAILROAD property, which is more than twenty-five (25) feet from the centerline of a railroad track when there are other conditions or considerations that would dictate the need for a flagman to safeguard the RAILROAD's operations, property and safety of working personnel.

A cable locate of RAILROAD owned facilities may be required to identify and protect Signal & Communication cables that have been installed to provide power, signal control, wayside communications. These cables are vital to a safe and reliable railway operation. The cable locate will be performed by a qualified RAILROAD employee.

Outside Contractors are prohibited from driving on, along, or across any track that does not have a RAILROAD installed crossing. They may utilize an existing public crossing. The practice of allowing rubber tired equipment to operate over track with no crossing has been banned.

Exceptions to this rule will require the express approval from the RAILROAD Engineers.

**MISSISSIPPI DEPARTMENT OF TRANSPORTATION**

**SECTION 904 - NOTICE TO BIDDERS NO. 7585**

**CODE: (SP)**

**DATE: 01/23/2026**

**SUBJECT: Pay Item Correction**

**PROJECT: BR-2909-00(006) / 106103301 – Marshall County**

Bidders are hereby advised that Pay Item No. 907-899-A001, Railway-Highway Provisions, is not shown in the Contract Plans, but a quantity of **1 Lump Sum** for this pay item has been added to the bid items.

**MISSISSIPPI DEPARTMENT OF TRANSPORTATION**

**SECTION 904 - NOTICE TO BIDDERS NO. 7586**

**DATE: 01/27/2026**

**SUBJECT: Type C Filter Material – Gradation Revision**

**PROJECT: BR-2909-00(006) / 106103301 – Marshall County**

The Bidder's attention is called to Subsection 704.04 in the Standard Specifications. For this project, Sieve Size No. 16 shall have a Percent Passing of 37% - 100%.



OPERATOR: Bulldozer.....	\$ 14.21	0.00
OPERATOR: Crane.....	\$ 19.97	0.00
OPERATOR: Grader/Blade.....	\$ 15.00	0.00
OPERATOR: Loader.....	\$ 13.54	0.00
OPERATOR: Mechanic.....	\$ 20.92	0.00
OPERATOR: Milling Machine.....	\$ 16.20	0.00
OPERATOR: Oiler.....	\$ 9.50	0.00
OPERATOR: Paver (Asphalt, Aggregate, and Concrete).....	\$ 11.78	0.00
OPERATOR: Roller (All Types)....	\$ 13.07	0.00
OPERATOR: Scraper.....	\$ 12.25	0.00
OPERATOR: Tractor.....	\$ 10.78	0.00
PILEDRIVERMAN.....	\$ 12.50	1.23
TRUCK DRIVER: Flatbed Truck.....	\$ 13.00	0.00
TRUCK DRIVER: Lowboy Truck.....	\$ 12.43	0.00
TRUCK DRIVER: Mechanic.....	\$ 13.00	0.00
TRUCK DRIVER: Water Truck.....	\$ 14.49	0.00
TRUCK DRIVER: Dump Truck (All Types).....	\$ 13.08	0.00
TRUCK DRIVER: Semi/Trailer Truck.....	\$ 15.22	0.00

-----

WELDERS - Receive rate prescribed for craft performing operation to which welding is incidental.

=====

Note: Executive Order (EO) 13706, Establishing Paid Sick Leave for Federal Contractors applies to all contracts subject to the Davis-Bacon Act for which the contract is awarded (and any solicitation was issued) on or after January 1, 2017. If this contract is covered by the EO, the contractor must provide employees with 1 hour of paid sick leave for every 30 hours they work, up to 56 hours of paid sick leave each year. Employees must be permitted to use paid sick leave for their own illness, injury or other health-related needs, including preventive care; to assist a family member (or person who is like family to the employee) who is ill, injured, or has other health-related needs, including preventive care; or for reasons resulting from, or to assist a family member (or person who is like family to the employee) who is a victim of, domestic violence, sexual assault, or stalking. Additional information on contractor requirements and worker protections under the EO is available at <https://www.dol.gov/agencies/whd/government-contracts>.

Note: Executive Order 13658 generally applies to contracts subject to the Davis-Bacon Act that were awarded on or between January 1, 2015 and January 29, 2022, and that have not been renewed or extended on or after January 30, 2022. Executive Order 13658 does not apply to contracts subject only to the Davis-Bacon Related Acts regardless of when they were awarded. If a contract is subject to Executive Order 13658, the contractor must pay all covered workers at least \$13.30 per hour (or the applicable wage rate listed on this wage determination, if it is higher) for all hours spent performing on the contract in 2025. The applicable Executive Order minimum wage rate will be adjusted annually. Additional information on contractor requirements and worker protections under Executive Order 13658 is available at [www.dol.gov/whd/govcontracts](http://www.dol.gov/whd/govcontracts).

Unlisted classifications needed for work not included within the scope of the classifications listed may be added after award only as provided in the labor standards contract clauses (29CFR 5.5 (a) (1) (iii)).

-----

The body of each wage determination lists the classifications and wage rates that have been found to be prevailing for the type(s) of construction and geographic area covered by the wage determination. The classifications are listed in alphabetical order under rate identifiers indicating whether the particular rate is a union rate (current union negotiated rate), a survey rate, a weighted union average rate, a state adopted rate, or a supplemental classification rate.

#### Union Rate Identifiers

A four-letter identifier beginning with characters other than ""SU"", ""UAVG"", ?SA?, or ?SC? denotes that a union rate was prevailing for that classification in the survey. Example: PLUM0198-005 07/01/2024. PLUM is an identifier of the union whose collectively bargained rate prevailed in the survey for this classification, which in this example would be Plumbers. 0198 indicates the local union number or district council number where applicable, i.e., Plumbers Local 0198. The next number, 005 in the example, is an internal number used in processing the wage determination. The date, 07/01/2024 in the example, is the effective date of the most current negotiated rate.

Union prevailing wage rates are updated to reflect all changes over time that are reported to WHD in the rates in the collective bargaining agreement (CBA) governing the classification.

#### Union Average Rate Identifiers

The UAVG identifier indicates that no single rate prevailed for those classifications, but that 100% of the data reported for the classifications reflected union rates. EXAMPLE: UAVG-OH-0010 01/01/2024. UAVG indicates that the rate is a weighted union average rate. OH indicates the State of Ohio. The next number, 0010 in the example, is an internal number used in producing the wage determination. The date, 01/01/2024 in the example, indicates the date the wage determination was updated to reflect the most current union average rate.

A UAVG rate will be updated once a year, usually in January, to reflect a weighted average of the current rates in the collective bargaining agreements on which the rate is based.

#### Survey Rate Identifiers

The ""SU"" identifier indicates that either a single non-union rate prevailed (as defined in 29 CFR 1.2) for this classification in the survey or that the rate was derived by computing a weighted average rate based on all the rates reported in the survey for that classification. As a weighted average rate includes all rates reported in the survey, it may include both union and non-union rates. Example: SUFL2022-007 6/27/2024. SU indicates the rate is a single non-union prevailing rate or a weighted average of survey data for that classification. FL indicates the State of Florida. 2022 is the year of the survey on which these classifications and rates are based. The next number, 007 in the example, is an internal number used in producing the wage determination. The date, 6/27/2024 in the example, indicates the survey completion date for the classifications and rates under that identifier.

?SU? wage rates typically remain in effect until a new survey is conducted. However, the Wage and Hour Division (WHD) has the discretion to update such rates under 29 CFR 1.6(c)(1).

#### State Adopted Rate Identifiers

The ""SA"" identifier indicates that the classifications and prevailing wage rates set by a state (or local) government were adopted under 29 C.F.R 1.3(g)-(h). Example: SAME2023-007 01/03/2024. SA reflects that the rates are state adopted. ME refers to the State of Maine. 2023 is the year during which the state completed the survey on which the listed classifications and rates are based. The next number, 007 in the example, is an internal number used in producing the wage determination. The date, 01/03/2024 in the example, reflects the date on which the classifications and rates under the ?SA? identifier took effect under state law in the state from which the rates were adopted.

-----  

#### WAGE DETERMINATION APPEALS PROCESS

1) Has there been an initial decision in the matter? This can be:

- a) a survey underlying a wage determination
- b) an existing published wage determination
- c) an initial WHD letter setting forth a position on a wage determination matter
- d) an initial conformance (additional classification and rate) determination

On survey related matters, initial contact, including requests for summaries of surveys, should be directed to the WHD Branch of Wage Surveys. Requests can be submitted via email to [davisbaconinfo@dol.gov](mailto:davisbaconinfo@dol.gov) or by mail to:

Branch of Wage Surveys  
Wage and Hour Division  
U.S. Department of Labor  
200 Constitution Avenue, N.W.  
Washington, DC 20210

Regarding any other wage determination matter such as conformance decisions, requests for initial decisions should be directed to the WHD Branch of Construction Wage Determinations. Requests can be submitted via email to BCWD-Office@dol.gov or by mail to:

Branch of Construction Wage Determinations  
Wage and Hour Division  
U.S. Department of Labor  
200 Constitution Avenue, N.W.  
Washington, DC 20210

2) If an initial decision has been issued, then any interested party (those affected by the action) that disagrees with the decision can request review and reconsideration from the Wage and Hour Administrator (See 29 CFR Part 1.8 and 29 CFR Part 7). Requests for review and reconsideration can be submitted via email to dba.reconsideration@dol.gov or by mail to:

Wage and Hour Administrator  
U.S. Department of Labor  
200 Constitution Avenue, N.W.  
Washington, DC 20210

The request should be accompanied by a full statement of the interested party's position and any information (wage payment data, project description, area practice material, etc.) that the requestor considers relevant to the issue.

3) If the decision of the Administrator is not favorable, an interested party may appeal directly to the Administrative Review Board (formerly the Wage Appeals Board). Write to:

Administrative Review Board  
U.S. Department of Labor  
200 Constitution Avenue, N.W.  
Washington, DC 20210.

=====

END OF GENERAL DECISION

..

# MISSISSIPPI DEPARTMENT OF TRANSPORTATION

SPECIAL PROVISION NO. 907-899-1

CODE: (SP)

DATE: 01/17/2017

SUBJECT: Railway-Highway Provisions

Section 907-899, Railway-Highway Provisions, is hereby added to and made part of the 2017 Edition of the Mississippi Standard Specifications for Road and Bridge Construction as follows:

## SECTION 907-899--RAILWAY-HIGHWAY PROVISIONS

**907-899.01--Description.** This special provision addresses the Contractor's involvement with railroad flagging, Contractor Safety Orientation, Contractor Background Investigation, Contractor Roadway Worker on Track Safety Program and Safety Action Plan, and any other requirements set forth by the Railroad and any attached Exhibits.

Prior to bidding, the Contractor shall read and comply with the requirements of the Railroad and any attached Exhibits. The Contractor shall contact the Railroad concerning insurance coverage requirements, Railroad flagging costs, Contractor Safety Orientation, Contractor Background Investigation, Contractor Roadway Worker on Track Safety Program and Safety Action Plan, and any other requirements set forth by the Railroad and any attached Exhibits. In case the railroad requires coverage over and above that required by the Standard Specifications, the railroad requirements shall be met.

If in the opinion of the RAILROAD, the presence of an authorized representative of the RAILROAD is required to supervise the same, the RAILROAD shall render bills to the Contractor for all expenses incurred by it for such supervision. This includes all labor costs for flagmen or cable locate supplied by the RAILROAD to protect RAILROAD operation, and for the full cost of furnishing, installation and later removal of any temporary supports for said tracks, as the RAILROAD's Chief Engineer's Office may deem necessary.

**It will be the Contractor's responsibility to pay all bills associated with the Railroad requirements and any attached Exhibits.**

A cable locate of RAILROAD owned facilities may be required to identify and protect Signal & Communication cables that have been installed to provide power, signal control, wayside communications. These cables are vital to a safe and reliable railway operation. The cable locate will be performed by a qualified RAILROAD employee.

Outside Contractors are prohibited from driving on, along, or across any track that does not have a RAILROAD installed crossing. They may utilize an existing public crossing. The practice of allowing rubber tired equipment to operate over track with no crossing has been banned.

The Contractor shall complete and process any required forms addressed by the Railroad or any attached Exhibits. The Contractor shall not commence or carry on any form of work on, under, above or within the designated distance from the Railroad track prior to getting approval from the Railroad.

**907-899.02--Blank.**

**907-899.03--Construction Requirements.** The Contractor shall read and comply with the requirements of the Railroad and any attached Exhibits.

**907-899.04--Method of Measurement.** Railway-highway provisions will be measured as a unit lump sum quantity. Measurement for payment will be in accordance with the following schedule:

- a) On the first estimate, twenty five percent (25%) of the amount bid for Railway Highway Provision will be paid.
- b) When twenty five percent (25%) of the original contract amount is earned from all direct pay items, fifty percent (50%) of the amount bid for Railway Highway Provision will be paid.
- c) When fifty percent (50%) of the original contract amount is earned from all direct pay items, one hundred percent (100%) of the amount bid for Railway Highway Provision will be paid.

**907-899.05--Basis of Payment.** Railway-highway provisions, measured as prescribed above, will be paid for at the contract lump sum price, which price shall be payment in full for all insurance coverage requirements, railroad flagging costs, Contractor safety orientation, Contractor background investigation, Contractor safety programs and plans, and any other requirements set forth by the Railroad and any attached Exhibits, and other incidentals necessary to complete the requirements of this work.

Payment will be made under:

907-899-A: Railway-Highway Provisions

- lump sum

Bridge Replacement on SR 178 (Bridge Nos. 33.6, 34.1, 35.2, 35.4 & 35.6), known as Federal Aid Project No. BR-2909-00(006) / 106103301 in Marshall County.

Line No.	Item Code	Adj Code	Quantity	Units	Description [Fixed Unit Price]
<b>Roadway Items</b>					
0010	201-A001		1	Lump Sum	Clearing and Grubbing
0020	201-B001		1	Acre	Clearing and Grubbing
0030	202-A001		1	Lump Sum	Removal of Obstructions
0040	202-B004		358	Square Yard	Removal of Asphalt Driveways, All Depths
0050	202-B007		3,441	Square Yard	Removal of Asphalt Pavement, All Depths
0060	202-B019		48	Linear Feet	Removal of Box Culvert
0070	202-B023		5	Each	Removal of Bridge
0080	202-B069		15,021	Square Yard	Removal of Concrete Pavement w/ Variable Depth Overlay
0090	202-B150		3,032	Linear Feet	Removal of Guard Rail Including Post, Blockouts & Hardware
0100	202-B191		76	Linear Feet	Removal of Pipe, 8" And Above
0110	202-B206		8	Each	Removal of Right-Of-Way Marker
0120	202-B215		23	Each	Removal of Sign Including Post & Footing
0130	203-A001	(E)	73,418	Cubic Yard	Unclassified Excavation, FM, AH
0140	203-EX020	(E)	64,990	Cubic Yard	Borrow Excavation, AH, FME, Class B9
0150	206-A001	(S)	2,392	Cubic Yard	Structure Excavation
0160	206-B001	(E)	127	Cubic Yard	Select Material for Undercuts, Contractor Furnished, FM
0170	209-A005		104,050	Square Yard	Geotextile Stabilization, Type V, Non-Woven
0180	211-B001	(E)	4,849	Cubic Yard	Topsoil for Slope Treatment, Contractor Furnished
0190	213-C001		10	Ton	Superphosphate
0200	216-A001		3,400	Square Yard	Solid Sodding
0210	217-A001		1,378	Square Yard	Ditch Liner
0220	219-A001		68	Thousand Gallon	Watering [\$20.00]
0230	220-A001		10	Acre	Insect Pest Control [\$30.00]
0240	221-A001	(S)	215	Cubic Yard	Concrete Paved Ditch
0250	223-A001		114	Acre	Mowing [\$70.00]
0260	224-A001		801	Square Yard	Soil Reinforcing Mat
0270	225-A001		19	Acre	Grassing
0280	225-B001		10	Ton	Agricultural Limestone
0290	225-C001		37	Ton	Mulch, Vegetative Mulch
0300	226-A001		19	Acre	Temporary Grassing
0310	235-A001		300	Each	Temporary Erosion Checks
0320	237-A002		1,200	Linear Feet	Wattles, 20"

Line No.	Item Code	Adj Code	Quantity	Units	Description [Fixed Unit Price]
0330	239-A001		2,400	Linear Feet	Temporary Slope Drains
0340	245-A001		1,200	Linear Feet	Silt Dike
0350	246-B002		1,200	Linear Feet	Rockbags
0360	247-A001		2	Each	Temporary Stream Diversion
0370	249-A001		700	Ton	Riprap for Erosion Control
0380	304-B004	(GT)	16,500	Ton	Granular Material, Class 5, Group D
0390	406-D001		1,887	Square Yard	Fine Milling of Bituminous Pavement, All Depths
0400	407-A001	(A2)	3,745	Gallon	Asphalt for Tack Coat
0410	423-A001		4	Mile	Rumble Strips, Ground In
0420	501-K001		96	Square Yard	Transverse Grooving
0430	503-C010		1,018	Linear Feet	Saw Cut, Full Depth
0440	602-A001	(S)	95,523	Pounds	Reinforcing Steel
0450	603-ALT003	(S)	248	Linear Feet	18" Type A Alternate Pipe
0460	603-ALT005	(S)	88	Linear Feet	22" x 13" Type A Alternate Pipe
0470	603-ALT008	(S)	64	Linear Feet	29" x 18" Type A Alternate Pipe
0480	603-CA026	(S)	208	Linear Feet	24" Reinforced Concrete Pipe, Class III
0490	603-CB004	(S)	4	Each	24" Reinforced Concrete End Section
0500	603-CE018	(S)	136	Linear Feet	44" x 27" Concrete Arch Pipe, Class A III
0510	603-CE023	(S)	72	Linear Feet	51" x 31" Concrete Arch Pipe, Class A III
0520	603-CE028	(S)	96	Linear Feet	58" x 36" Concrete Arch Pipe, Class A III
0530	603-CF005	(S)	1	Each	44" x 27" Concrete Arch Pipe End Section
0540	603-CF006	(S)	4	Each	51" x 31" Concrete Arch Pipe End Section
0550	605-AA001	(S)	196	Square Yard	Geotextile for Subsurface Drainage, Type III
0560	605-O002	(S)	352	Linear Feet	4" Perforated Sewer Pipe for Underdrains, SDR 23.5
0570	605-P002	(S)	240	Linear Feet	4" Non-perforated Sewer Pipe for Underdrains, SDR 23.5
0580	605-W001	(GY)	14	Cubic Yard	Filter Material for Combination Storm Drain and/or Underdrains, Type A, FM
0590	605-X005	(GY)	47,130	Cubic Yard	Filter Material for Filter Beds, Type C
0600	606-B001		775	Linear Feet	Guard Rail, Class A, Type 1
0610	606-D022		16	Each	Guard Rail, Bridge End Section, Type I
0620	606-E005		16	Each	Guard Rail, Terminal End Section, Flared
0630	612-A001		25	Cubic Yard	Flowable Fill, Excavatable
0640	615-A024	(S)	160	Linear Feet	Concrete Bridge End Barrier, 37.5"
0650	617-A001		63	Each	Right-of-Way Marker
0660	618-B001		1	Square Feet	Additional Construction Signs [\$10.00]

Line No.	Item Code	Adj Code	Quantity	Units	Description [Fixed Unit Price]
0670	619-A1004		4	Mile	Temporary Traffic Stripe, Continuous White, Paint
0680	619-A2004		3	Mile	Temporary Traffic Stripe, Continuous Yellow, Paint
0690	619-A4002		1	Mile	Temporary Traffic Stripe, Skip Yellow
0700	619-C7001		183	Each	Two-Way Yellow Reflective High Performance Raised Marker
0710	619-D1001		286	Square Feet	Standard Roadside Construction Signs, Less than 10 Square Feet
0720	619-D2001		822	Square Feet	Standard Roadside Construction Signs, 10 Square Feet or More
0730	619-F1001		300	Linear Feet	Concrete Median Barrier, Precast
0740	619-G4001		216	Linear Feet	Barricades, Type III, Double Faced
0750	619-G5001		500	Each	Free Standing Plastic Drums
0760	619-G7001		30	Each	Warning Lights, Type "B"
0770	619-J1002		2	Each	Impact Attenuator, 45 MPH
0780	619-J2002		2	Each	Impact Attenuator, 45 MPH, Replacement Package
0790	620-A001		1	Lump Sum	Mobilization
0800	621-A001		1	Each	Field Laboratory
0810	630-A001		40	Square Feet	Standard Roadside Signs, Sheet Aluminum, 0.080" Thickness
0820	630-A003		81	Square Feet	Standard Roadside Signs, Sheet Aluminum, 0.125" Thickness
0830	630-C005		128	Linear Feet	Square Tube Posts, 2.0 lb/ft
0840	630-F006		76	Each	Delineators, Guard Rail, White
0850	630-G003		18	Each	Type 3 Object Markers, OM-3L, Post Mounted
0860	630-G007		18	Each	Type 3 Object Markers, OM-3R, Post Mounted
0870	699-A001		1	Lump Sum	Roadway Construction Stakes
0880	815-A002	(S)	45	Ton	Loose Riprap, Size 100
0890	815-A007	(S)	6,222	Ton	Loose Riprap, Size 300
0900	815-E001	(S)	9,705	Square Yard	Geotextile under Riprap
0910	907-234-A001		12,100	Linear Feet	Temporary Silt Fence
0920	907-234-C001		2,278	Linear Feet	Super Silt Fence
0930	907-403-A003	(BA1)	2,606	Ton	12.5-mm, ST, Asphalt Pavement
0940	907-403-A006	(BA1)	3,189	Ton	19-mm, ST, Asphalt Pavement
0950	907-403-A015	(BA1)	2,241	Ton	9.5-mm, ST, Asphalt Pavement
0960	907-403-B003	(BA1)	929	Ton	12.5-mm, ST, Asphalt Pavement, Leveling
0970	907-403-C003	(BA1)	89	Ton	19-mm, ST, Asphalt Pavement, Trench Widening
0980	907-502-A001	(C)	667	Square Yard	Reinforced Cement Concrete Bridge End Pavement
0990	907-601-A001	(S)	473	Cubic Yard	Class "B" Structural Concrete

Line No.	Item Code	Adj Code	Quantity	Units	Description [Fixed Unit Price]
1000	907-601-B001	(S)	20	Cubic Yard	Class "B" Structural Concrete, Minor Structures
1010	907-618-A001		1	Lump Sum	Maintenance of Traffic
1020	907-619-E3001		10	Each	Changeable Message Sign
1030	907-626-C012		4	Mile	6" Thermoplastic Double Drop Edge Stripe, Continuous White
1040	907-626-D003		1	Mile	6" Thermoplastic Double Drop Traffic Stripe, Skip Yellow
1050	907-626-E003		3	Mile	6" Thermoplastic Double Drop Traffic Stripe, Continuous Yellow
1060	907-627-L001		183	Each	Two-Way Yellow Reflective High Performance Raised Markers
1062	907-899-A001		1	Lump Sum	Railway-Highway Provisions
<b>ALTERNATE GROUP AA NUMBER 1</b>					
1070	304-F001	(GT)	10,900	Ton	3/4" and Down Crushed Stone Base
<b>ALTERNATE GROUP AA NUMBER 2</b>					
1080	304-F002	(GT)	10,900	Ton	Size 610 Crushed Stone Base
<b>ALTERNATE GROUP AA NUMBER 3</b>					
1090	304-F003	(GT)	10,900	Ton	Size 825B Crushed Stone Base
<b>ALTERNATE GROUP BB NUMBER 1</b>					
1100	605-W002	(GY)	11	Cubic Yard	Filter Material for Combination Storm Drain and/or Underdrains, Type B, FM
<b>ALTERNATE GROUP BB NUMBER 2</b>					
1110	605-W003	(GY)	11	Cubic Yard	Filter Material for Combination Storm Drain and/or Underdrains, Type C, FM
<b>Bridge Items</b>					
1120	501-K001		3,516	Square Yard	Transverse Grooving
1130	803-D007	(S)	4,290	Linear Feet	HP 14 x 89 Steel Piling
1140	803-P008	(S)	2,550	Linear Feet	20" Steel Pipe Piling, Wall Thickness 0.500"
1150	804-C188	(S)	2,386	Linear Feet	80' Prestressed Concrete Beam, Type FIB-36
1160	804-C192	(S)	2,488	Linear Feet	100' Prestressed Concrete Beam, Type FIB-36
1170	805-A001	(S)	349,043	Pounds	Reinforcement
1180	805-C001	(S)	12,366	Pounds	Reinforcement, Corrosion Resistant
1190	813-A004	(S)	1,976	Linear Feet	Concrete Railing, 36"
1200	815-A007	(S)	9,761	Ton	Loose Riprap, Size 300
1210	815-E001	(S)	6,305	Square Yard	Geotextile under Riprap
1220	907-803-B001	(S)	4	Each	Conventional Static Pile Load Test [\$5,000.00]
1230	907-803-I003	(S)	4	Each	PDA Test Pile, HP Steel Pile
1240	907-803-I004	(S)	4	Each	PDA Test Pile, Steel Pipe Pile
1250	907-803-J001	(S)	8	Each	Pile Restrike
1260	907-804-A001	(S)	1,187	Cubic Yard	Bridge Concrete, Class BDx

<b>Line No.</b>	<b>Item Code</b>	<b>Adj Code</b>	<b>Quantity</b>	<b>Units</b>	<b>Description [Fixed Unit Price]</b>
1270	907-804-A002	(S)	462	Cubic Yard	Bridge Concrete, Class AA
1280	907-823-A001		219	Linear Feet	Preformed Joint Seal, Type I
1290	907-823-A002		73	Linear Feet	Preformed Joint Seal, Type II





**ADDENDUM**

STATE	MISS	PROJECT NO.	BR-2909-00(006)
-------	------	-------------	-----------------

**SUMMARY OF QUANTITIES (SHEET 2)**

PAY ITEM NO.	PAY ITEM	UNIT	MARSHALL : 106103-301000	
			Prelim	Final
225-C001	Mulch, Vegetative Mulch	TON	37	
226-A001	Temporary Grassing	ACRE	19	
907-234-A001	***EROSION CONTROL ITEMS*** Temporary Silt Fence	LF	12,100	
907-234-C001	Super Silt Fence	LF	2,278	
235-A001	Temporary Erosion Checks	EA	300	
237-A002	Wattles, 20"	LF	1,200	
239-A001	Temporary Slope Drains	LF	2,400	
245-A001	Silt Dike	LF	1,200	
246-B002	Rockbags	LF	1,200	
247-A001	Temporary Stream Diversion	EA	2	④
249-A001	Riprap for Erosion Control	TON	700	
815-A002	Loose Riprap, Size 100	TON	45	
815-A007	Loose Riprap, Size 300	TON	6,222	
815-E001	Geotextile under Riprap	SY	9,705	
304-B004	***BASE ITEMS*** Granular Material, Class 5, Group D	TON	16,500	② ③ ④
304-F001	3/4" and Down Crushed Stone Base OR	TON	10,900	② ③
304-F002	Size 610 Crushed Stone Base OR	TON	10,900	② ③
304-F003	Size 825B Crushed Stone Base	TON	10,900	② ③
907-403-A003	***PAVING ITEMS*** 12.5-mm, ST, Asphalt Pavement	TON	2,606	④
907-403-A006	19-mm, ST, Asphalt Pavement	TON	3,189	④
907-403-A015	9.5-mm, ST, Asphalt Pavement	TON	2,241	④
907-403-B003	12.5-mm, ST, Asphalt Pavement, Leveling	TON	929	④
907-403-C003	19-mm, ST, Asphalt Pavement, Trench Widening	TON	89	④
406-D001	Fine Milling of Bituminous Pavement, All Depths	SY	1,887	
407-A001	Asphalt for Tack Coat	GAL	3,745	①
423-A001	Rumble Strips, Ground In	MI	4	

- ① INCLUDES 3,523.42 GAL FROM THE BITUMINOUS PAVING EQ & 221.19 GAL FROM THE BITUMINOUS PAVING, LEVELING EQ.
- ② INCLUDES 20% SHRINKAGE FACTOR.
- ③ INCLUDES 20% SHRINKAGE FACTOR.
- ④ TO BE USED AT STA. 477+50 & 491+50.

**MISSISSIPPI DEPARTMENT OF TRANSPORTATION**  
**SUMMARY OF QUANTITIES**

SR 178 BRIDGE REPLACEMENT PROJECT

PROJ NO: BR-2909-00(006)  
 COUNTY: MARSHALL

Working Number  
 SQ-2

Sheet Number  
 11

Design Team: STANTEC  
 Checked: JES Date: 2022-02-28

FILENAME: SQ

CR	07/23/2025	REVIS: PAY ITEM NUMBER
CR	10/26/2024	REVIS: PAY ITEM NUMBER, QUANTITY AND CHANGE ORDER ITEM
CR	01/16/2024	REVIS: QUANTITY
CR		REVISION



**ADDENDUM**

STATE	MISS	PROJECT NO.
		BR-2909-00(006)

**SUMMARY OF QUANTITIES (SHEET 4)**

PAY ITEM NO.	PAY ITEM	UNIT	MARSHALL : 106103-301000	
			Prelim	Final
612-A001	Flowable Fill, Excavatable	CY	25	
617-A001	Right-of-Way Marker	EA	63	
907-618-A001	Maintenance of Traffic	LS	1	
618-B001	Additional Construction Signs	SF	1	
619-A1004	Temporary Traffic Stripe, Continuous White, Paint	MI	4	
619-A2004	Temporary Traffic Stripe, Continuous Yellow, Paint	MI	3	
619-A4002	Temporary Traffic Stripe, Skip Yellow	MI	1	
619-C7001	Two-Way Yellow Reflective High Performance Raised Marker	EA	183	
619-D1001	Standard Roadside Construction Signs, Less than 10 Square Feet	SF	286	
619-D2001	Standard Roadside Construction Signs, 10 Square Feet or More	SF	822	
907-619-E3001	Changeable Message Sign	EA	10	
619-F1001	Concrete Median Barrier, Precast	LF	300	
619-G4001	Barricades, Type III, Double Faced	LF	216	
619-G5001	Free Standing Plastic Drums	EA	500	
619-G7001	Warning Lights, Type "B"	EA	30	
619-J1002	Impact Attenuator, 45 MPH	EA	2	
619-J2002	Impact Attenuator, 45 MPH, Replacement Package	EA	2	
620-A001	Mobilization	LS	1	
621-A001	Field Laboratory	EA	1	
907-626-C012	6" Thermoplastic Double Drop Edge Stripe, Continuous White	MI	4	
907-626-D003	6" Thermoplastic Double Drop Traffic Stripe, Skip Yellow	MI	1	
907-626-E003	6" Thermoplastic Double Drop Traffic Stripe, Continuous Yellow	MI	3	
907-627-L001	Two-Way Yellow Reflective High Performance Raised Markers	EA	183	
	***SIGNING ITEMS***			
630-A001	Standard Roadside Signs, Sheet Aluminum, 0.080" Thickness	SF	40	
630-A003	Standard Roadside Signs, Sheet Aluminum, 0.125" Thickness	SF	81	
630-C005	Square Tube Posts, 2.0 lb/ft	LF	128	
630-F006	Delineators, Guard Rail, White	EA	76	
630-G003	Type 3 Object Markers, OM-3L, Post Mounted	EA	18	
630-G007	Type 3 Object Markers, OM-3R, Post Mounted	EA	18	
699-A001	Roadway Construction Stakes	LS	1	

- ① OMNI-DIRECTIONAL ANCHOR AND SLEEVE ARE ABSORBED.
- ② TO BE USED AS NEEDED AND AT THE DIRECTION OF THE ENGINEER.
- ③ INCLUDES 1,960 LF OF STRIPE ON BRIDGE
- ④ INCLUDES 1,960 LF OF STRIPE ON BRIDGE
- ⑤ INCLUDES 331 LF OF STRIPE ON BRIDGE
- ⑥ INCLUDES 331 LF OF STRIPE ON BRIDGE
- ⑦ INCLUDES 872 LF OF STRIPE ON BRIDGE
- ⑧ INCLUDES 872 LF OF STRIPE ON BRIDGE

**MISSISSIPPI DEPARTMENT OF TRANSPORTATION**  
**SUMMARY OF QUANTITIES**

SR 178 BRIDGE REPLACEMENT PROJECT

PROJ NO: BR-2909-00(006)  
 COUNTY: MARSHALL

Working Number  
 SQ-4

Sheet Number  
 13

Design Team: STANTEC  
 Checked: JES Date: 2022-02-28

FILENAME: SQ

REVISION RVTM NUMBER QUANTITIES AND FOOTNOTE CR 01/16/2024

REVISION RVTM NUMBER QUANTITIES AND FOOTNOTE CR 01/16/2024

**ADDENDUM**

SIGN NO.		SIZE	QUAN. REQ'D.	TOTAL SIGN AREA SQ. FT.	REMARKS
620	- 4	36" X 18"	4.50		FLUORESCENT
M1	- 1	24" X 24"	4.00		1 OR 2 DIGIT
M1	- 4	30" X 24"	5.00		3 DIGIT
M1	- 4	30" X 24"	5.00		1 OR 2 DIGIT
M1	- 4	30" X 24"	5.00		3 DIGIT
M1	- 5	24" X 24"	4.00		1 OR 2 DIGIT
M1	- 5	30" X 24"	5.00		3 DIGIT
M3	- 1	24" X 12"	2.00		REFLECTIVE DIGIT RATE MARKER
M3	- 2	24" X 12"	2.00		REFLECTIVE DIGIT RATE MARKER
M3	- 3	24" X 12"	2.00		REFLECTIVE DIGIT RATE MARKER
M3	- 3	24" X 12"	2.00		REFLECTIVE DIGIT RATE MARKER
M3	- 4	24" X 12"	2.00		REFLECTIVE DIGIT RATE MARKER
M3	- 4	24" X 12"	2.00		REFLECTIVE DIGIT RATE MARKER
M3	- 4	30" X 15"	3.13		REFLECTIVE DIGIT RATE MARKER
M3	- 4	30" X 15"	3.13		REFLECTIVE DIGIT RATE MARKER
M4	- 8	24" X 12"	2.00		REFLECTIVE DIGIT RATE MARKER
M4	- 8	30" X 15"	3.13		REFLECTIVE DIGIT RATE MARKER
M4	- 9	48" X 36"	12.00		DETOUR
M4	- 9L	48" X 36"	12.00		DETOUR
M4	- 9BL	48" X 36"	12.00		DETOUR
M4	- 9SL	48" X 36"	12.00		DETOUR
M4	- 9SLS	48" X 36"	12.00		DETOUR
M4	- 9R	48" X 36"	12.00		DETOUR
M4	- 9BR	48" X 36"	12.00		DETOUR
M4	- 9SR	48" X 36"	12.00		DETOUR
M4	- 9BSR	48" X 36"	12.00		DETOUR
M4	- 10L	48" X 18"	6.00		DETOUR
M4	- 10R	48" X 18"	6.00		DETOUR
M4	- 5	24" X 12"	2.00		TO
M5	- 1L	21" X 15"	2.19		
M5	- 2L	21" X 15"	2.19		
M5	- 2R	21" X 15"	2.19		
M5	- 1L	21" X 15"	2.19		
M6	- 1R	21" X 15"	2.19		
M6	- 2R	21" X 15"	2.19		
M6	- 3	21" X 15"	2.19		
R1	- 1	36" OCTAGON	7.46		STOP
R1	- 2	48" X 48" X 48"	13.25		
R1	- 2	48" X 48" X 48"	6.33		
R1	- 2	60" X 60" X 60"	10.83		

SIGN NO.		SIZE	QUAN. REQ'D.	TOTAL SIGN AREA SQ. FT.	REMARKS
R1	- 3	18" X 9"	1.13		3-WAY, 4 WAY ETC.
R1	- 3	24" X 12"	2.00		
R2	- 1	36" X 48"	12.00		SPEED LIMIT
R2	- 1	48" X 60"	20.00		
R3	- 1	36" X 36"	9.00		
R3	- 2	48" X 48"	16.00		
R3	- 2	36" X 36"	9.00		
R3	- 4	36" X 36"	9.00		
R3	- 4	48" X 48"	16.00		
R3	- 5L	30" X 36"	7.50		
R3	- 5R	30" X 36"	7.50		
R3	- 6L	30" X 36"	7.50		
R3	- 6R	30" X 36"	7.50		
R3	- 7L	30" X 30"	6.25		LEFT LANE TURN LEFT MUST TURN RIGHT
R3	- 7R	30" X 30"	6.25		
R4	- 1	24" X 30"	5.00		DO NOT PASS
R4	- 2	24" X 30"	5.00		PASS WITH CARE
R4	- 7	48" X 60"	20.00		
R4	- 8	48" X 60"	20.00		
R5	- 1	48" X 48"	16.00		DO NOT ENTER
R5	- 10	42" X 30"	8.75		WRONG WAY
R6	- 1L	36" X 12"	3.00		ONE WAY
R6	- 1R	36" X 12"	3.00		ONE WAY
R6	- 2L	24" X 30"	5.00		ONE WAY
R6	- 2R	24" X 30"	5.00		ONE WAY
R11	- 2	48" X 30"	10.00		ROAD CLOSED
R11	- 30	60" X 30"	12.50		ROAD CLOSED
R11	- 3b	60" X 30"	12.50		ROAD CLOSED
R11	- 4	60" X 30"	12.50		ROAD CLOSED
R12	- 1	36" X 48"	12.00		WEIGHT LIMIT
R16	- 3	36" X 48"	12.00		WORKERS SPEEDING FINES DOUBLED
R16	- 3	48" X 60"	20.00		
W1	- 1L	48" X 48"	16.00		
W1	- 1R	48" X 48"	16.00		
W1	- 2L	48" X 48"	16.00		
W1	- 2R	48" X 48"	16.00		
W1	- 3L	48" X 48"	16.00		
W1	- 3R	48" X 48"	16.00		
W1	- 4L	48" X 48"	16.00		
W1	- 4R	48" X 48"	16.00		
W1	- 5L	48" X 48"	16.00		
W1	- 5R	48" X 48"	16.00		
W1	- 6L	48" X 24"	8.00		
W1	- 6R	60" X 30"	12.50		
W1	- 6R	48" X 24"	8.00		
W1	- 7	60" X 24"	8.00		

SIGN NO.		SIZE	QUAN. REQ'D.	TOTAL SIGN AREA SQ. FT.	REMARKS
W1	- 7	60" X 30"	12.50		
W1	- 8L	18" X 24"	3.00		
W1	- 8R	36" X 48"	12.00		
W1	- 8R	18" X 24"	3.00		
W1	- 9L	36" X 48"	12.00		
W1	- 9R	48" X 48"	16.00		
W3	- 10	48" X 48"	16.00		
W3	- 20	48" X 48"	16.00		
W3	- 3	48" X 48"	16.00		
W3	- 5	48" X 48"	16.00		SPEED REDUCTION
W4	- 1L	48" X 48"	16.00		
W4	- 1R	48" X 48"	16.00		
W4	- 2L	48" X 48"	16.00		
W4	- 2R	48" X 48"	16.00		
W5	- 10	48" X 48"	16.00		PAVEMENT NARROWS
W6	- 1	48" X 48"	16.00		
W6	- 2	48" X 48"	16.00		
W6	- 3	48" X 48"	16.00		
W8	- 1	48" X 48"	16.00		BUMP
W8	- 4	48" X 48"	16.00		SOFT SHOULDER
W8	- 6	48" X 48"	16.00		TRUCK CROSSING
W8	- 7	48" X 48"	16.00		LOOSE GRAVEL
W8	- 9	48" X 48"	16.00		LOW SHOULDER
W8	- 11	36" X 36"	9.00		UNEVEN LANES
W8	- 12	48" X 48"	16.00		NO CENTER STRIPE
W10	- 1	36" DIA.	7.07		
W10	- 1	48" DIA.	12.56		
W14	- 3	36" X 48"	5.56		NO PASSING
W14	- 3	48" X 64"	9.89		XX FEET
W16	- 2	24" X 18"	3.00		
W19	- 2	48" X 48"	16.00		BRIDGE W/ ICE IN OLD WEATHER
W20	- 1	48" X 48"	16.00		ADVANCE ROAD WORK
W20	- 1	36" X 36"	9.00		ADVANCE DETOUR
W20	- 2	48" X 48"	16.00		ADVANCE ROAD CLOSED
W20	- 3	48" X 48"	16.00		
W20	- 4	48" X 48"	16.00		ADVANCE ONE-LN. RD.
W20	- 4B	48" X 48"	16.00		ADVANCE ONE-LN. RD.
W20	- 5L	48" X 48"	16.00		ADVANCE RT. LN. CLOSED
W20	- 5R	48" X 48"	16.00		ADVANCE LT. LN. CLOSED
W20	- 70	48" X 48"	16.00		WORKERS
W21	- 1	36" X 36"	9.00		
W21	- 10	36" X 36"	9.00		

SIGN NO.		SIZE	QUAN. REQ'D.	TOTAL SIGN AREA SQ. FT.	REMARKS
W21	- 2	36" X 36"	9.00		FRESH OIL (TAR)
W21	- 3	48" X 48"	16.00		ADVANCE ROAD MACHINERY WORK
W21	- 5	48" X 48"	16.00		
W21	- 6	36" X 36"	9.00		SURVEY CREW
W24	- 1L	48" X 48"	16.00		
W24	- 1R	48" X 48"	16.00		
W24	- 1BL	48" X 48"	16.00		
W24	- 1BR	48" X 48"	16.00		
VP	- 1L	12" X 36"	3.00		
VP	- 1R	12" X 36"	3.00		
VP	- 2	24" X 12"	2.00		FLUORESCENT ORANGE PANEL
OM	- 3L	12" X 36"	3.00		
OM	- 3R	12" X 36"	3.00		
TOTAL SIGN AREA			LESS THAN 10 SQ. FT.		
TOTAL SIGN AREA			10 SQ. FT. OR MORE		285.32 SQ. FT.

**NOTES**

- INTERSTATE ROUTE MARKER
- UNITED STATES ROUTE MARKER
- STATE ROUTE MARKER
- COLORS OF CARDINAL DIRECTION MARKERS AND DIRECTIONAL ARROWS SHALL BE APPROPRIATE TO MATCH ACCOMPANYING BLACK STRIPES ON YELLOW BACKGROUND
- INTERSTATE USE ONLY
- TOP OF SIGN - BLACK LETTERING ON ORANGE BACKGROUND, BOTTOM OF SIGN - BLACK LETTERING ON WHITE BACKGROUND
- THE BACKGROUND OF ALL WARNING SIGNS ("W" SERIES) EXCEPT W10-1 SHALL BE ORANGE. THE W10-1 BACKGROUND SHALL BE YELLOW IN ALL CASES.

MISSISSIPPI DEPARTMENT OF TRANSPORTATION  
ESTIMATED QUANTITIES  
TRAFFIC CONTROL SIGNS

PROJ. NO.: BR-2509-00(006)  
COUNTY: MARSHALL

WORKING NUMBER: EQ-15  
SHEET NUMBER: 28

DESIGN TEAM: STANTEC CHECKED: DATE:

FMS CON: 10610301000

PROJECT NO.: BR-2509-00(006)





FMS CON: 106103/301000

**ADDENDUM**

STATE	PROJECT NO.
MISS.	BR-2909-00(006)

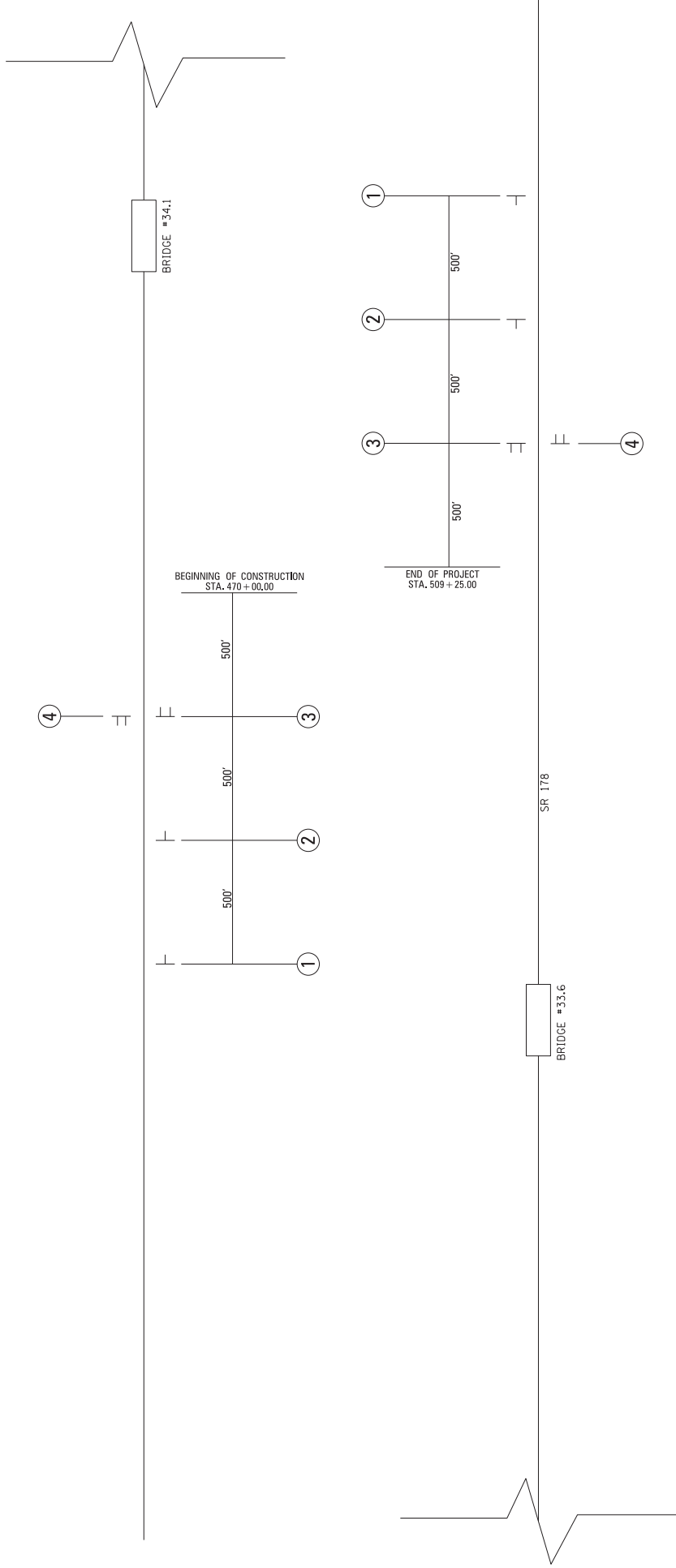

MISSISSIPPI DEPARTMENT OF TRANSPORTATION	
DETAIL CONSTRUCTION SIGNING	
SR 178	
PROJ. NO.: BR-2909-00(006)	WORKING NUMBER
COUNTY: MARSHALL	DCS-1
FILENAME: DCS-1.DGN	SHEET NUMBER
DESIGN TEAM	54
CHECKED	DATE



NOTES:  $\Delta$

- WORK ON BRIDGE #33.6 AND #34.1 SHALL NOT BEGIN UNTIL THE REALIGNMENT FOR BRIDGE #35.2, #35.4 & #35.6 HAS BEEN COMPLETED AND OPEN TO TRAFFIC

- ④ END ROAD WORK 600-2 48x24 (TO BE MOUNTED WITH DOUBLE FACE BARRICADE 6' WIDE)
- ③ ROAD WORK 300 FT 48x48 (TO BE MOUNTED WITH DOUBLE FACE BARRICADE 6' WIDE)
- ② ROAD WORK 100 FT 48x48
- ① ROAD WORK 150 FT 48x48

FMS CON: 1061030301000

**ADDENDUM**

STATE MISS. PROJECT NO. BR-2509-00(006)

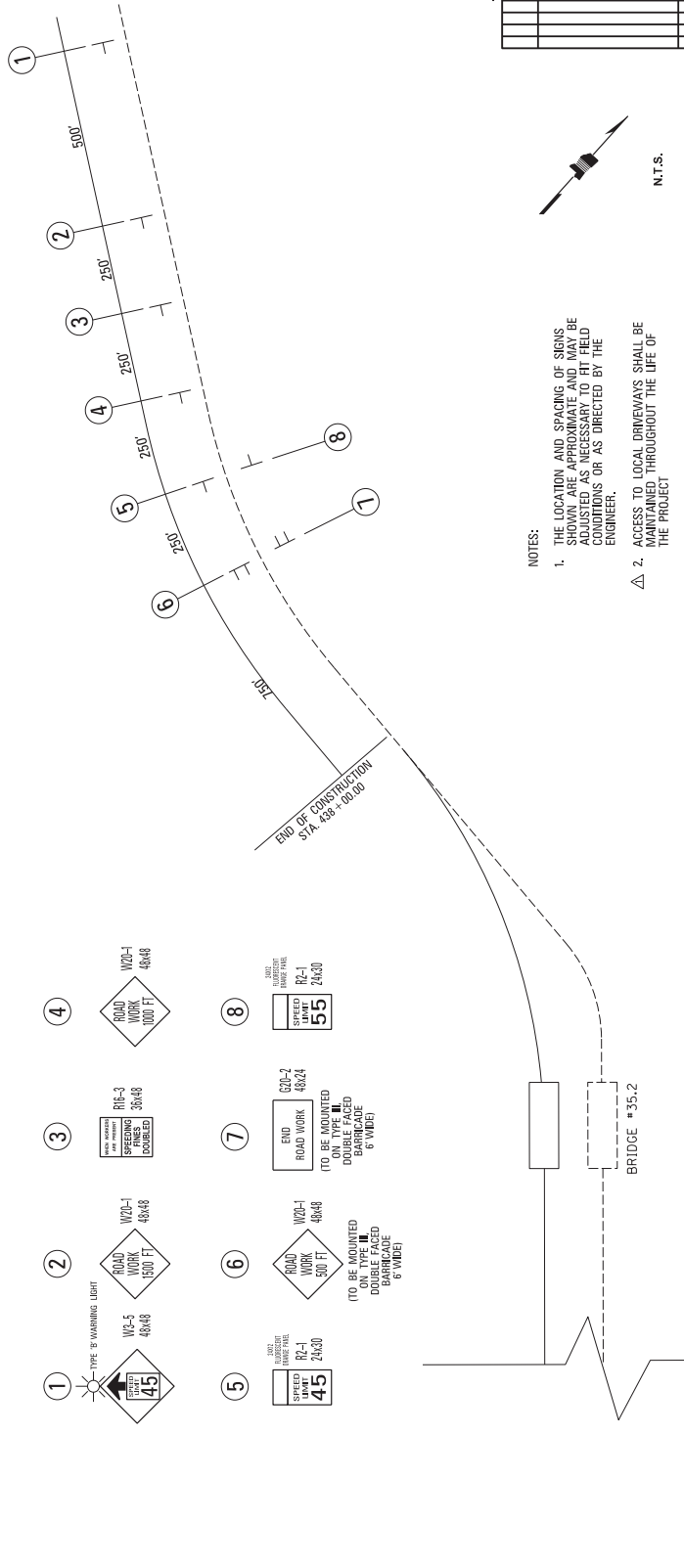
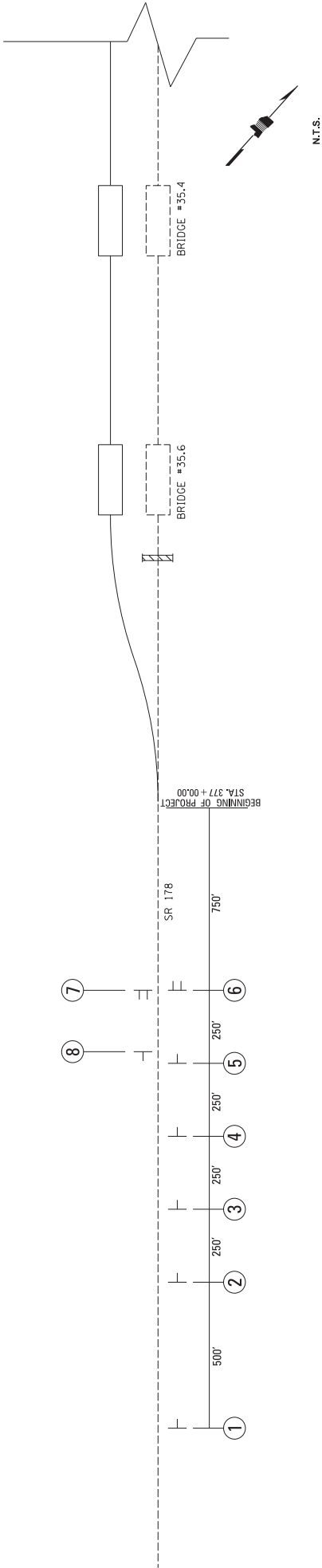

- NOTES:
1. THE LOCATION AND SPACING OF SIGNS SHOULD BE MAINTAINED THROUGHOUT THE LIFE OF THE PROJECT.
  2. ACCESS TO LOCAL DRIVEWAYS SHALL BE MAINTAINED THROUGHOUT THE LIFE OF THE PROJECT.

MISSISSIPPI DEPARTMENT OF TRANSPORTATION  
**DETAIL CONSTRUCTION SIGNING**

SR 178

PROJ. NO.: BR-2509-00(006)  
 COUNTY: MARSHALL

WORKING NUMBER: DCS-2  
 SHEET NUMBER: 55

DATE: \_\_\_\_\_ DESIGN TEAM: \_\_\_\_\_ CHECKED: \_\_\_\_\_



STATE	PROJECT NO.
MISS.	BR-2909-00(006)

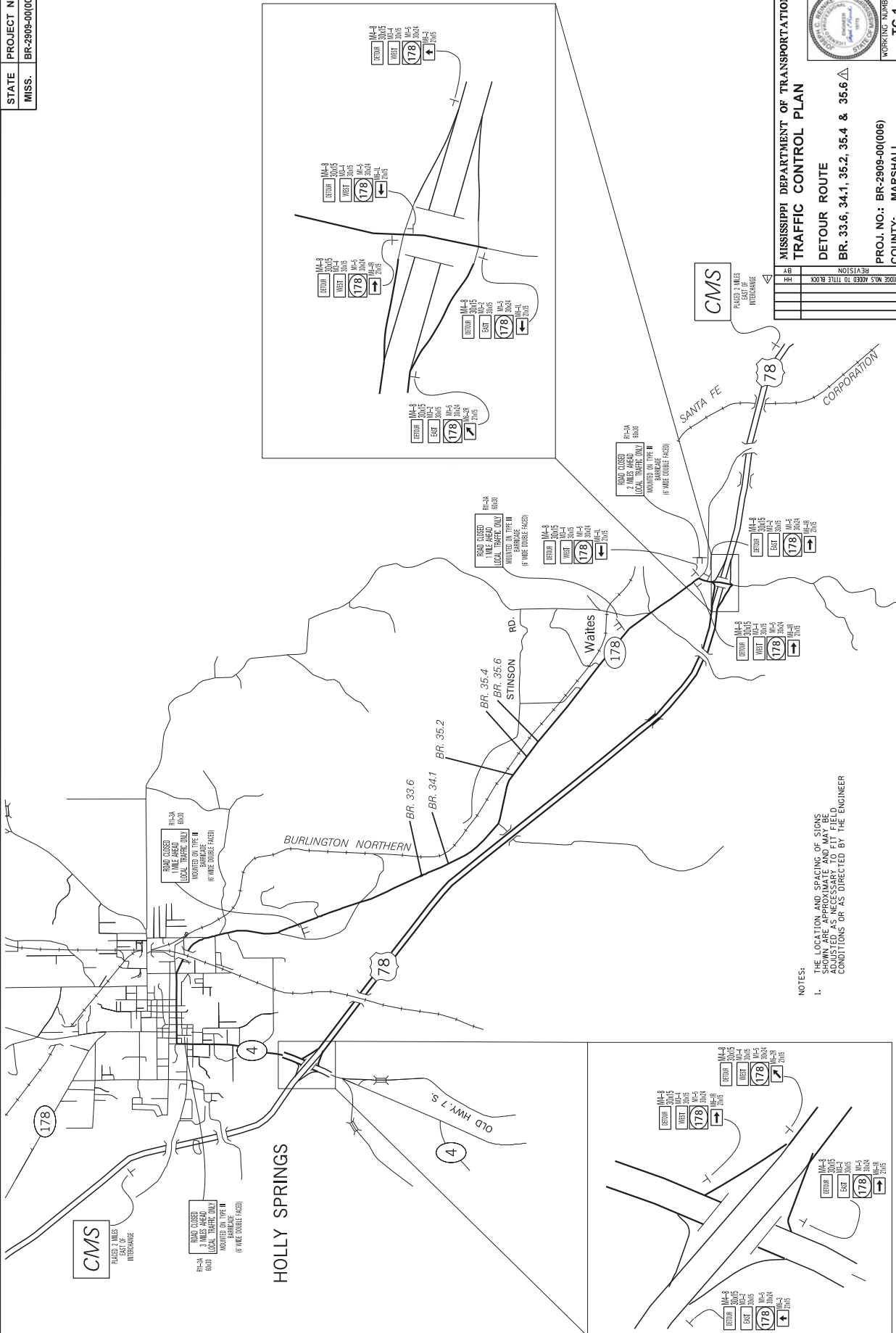

NOTES:  
 1. THE LOCATION AND SPACING OF SIGNS AND ROAD CLOSURES HAS BEEN ADJUSTED AS NECESSARY TO FIT FIELD CONDITIONS OR AS DIRECTED BY THE ENGINEER

MISSISSIPPI DEPARTMENT OF TRANSPORTATION	
TRAFFIC CONTROL PLAN	
DETOUR ROUTE	
BR. 33.6, 34.1, 35.2, 35.4 & 35.6	
PROJ. NO.:	BR-2909-00(006)
COUNTY:	MARSHALL
FILE NAME:	TC-1.dgn
DESIGN TEAM:	_____
CHECKED:	_____
DATE:	_____
WORKING NUMBER:	TC-1
SHEET NUMBER:	56



# ADDENDUM

FMS CON: 106103/301000

STATE	PROJECT NO.
MISS.	BR-2909-00(006)

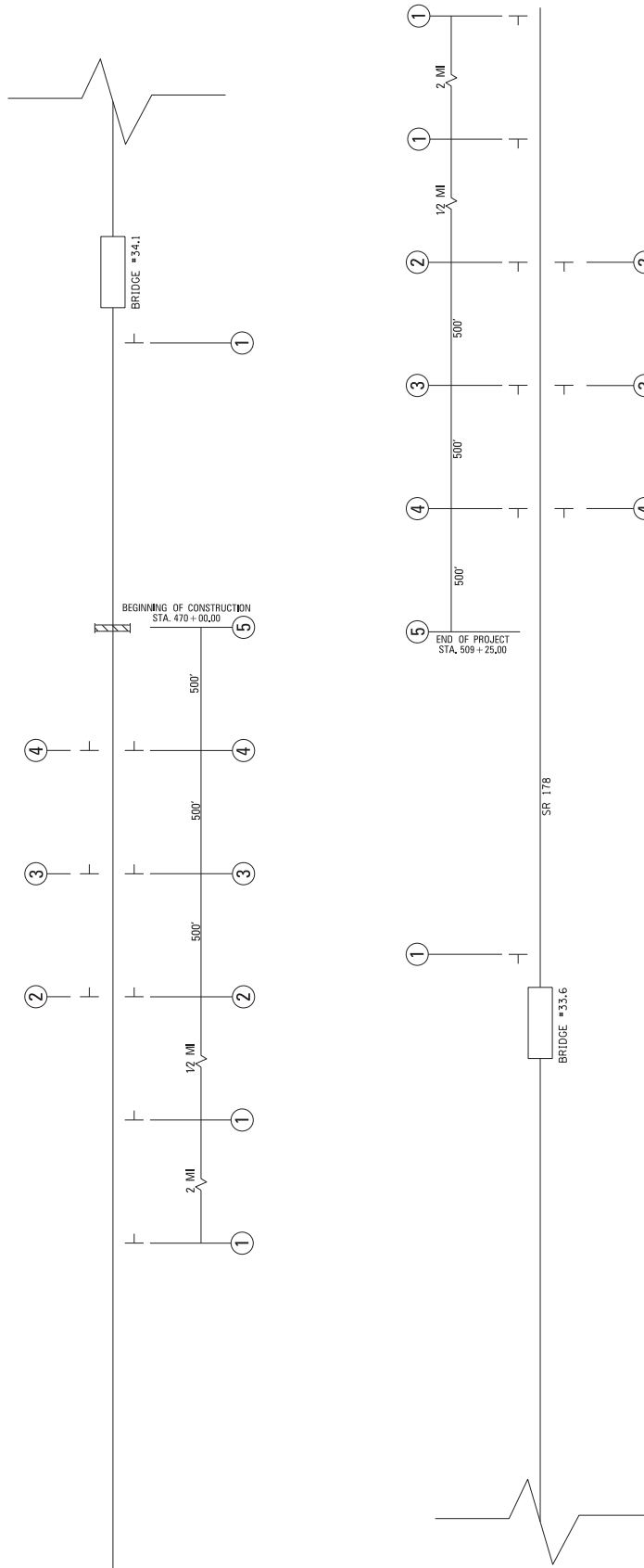



- NOTES:
1. THE LOCATION AND SPACING OF SIGNS SHOWN ARE APPROXIMATE AND MAY BE ADJUSTED AS NECESSARY TO ACCOMMODATE CONDITIONS ON AS DIRECTED BY THE ENGINEER.
  2. CMS BOARDS TO BE PLACED 2 MILES AND 1/2 MILE PRIOR TO CLOSURE. CMS SCREEN MESSAGES TO BE DETERMINED BY THE PROJECT ENGINEER.
  3. CMS BOARDS TO FLASH SCREEN MESSAGES FOR 2 WEEKS PRIOR TO CLOSURE. MONTH AND DAY TO BE UPDATED BASED ON ACTUAL ROAD CLOSURE.
  4. ACCESS TO LOCAL DRIVEWAYS SHALL BE MAINTAINED THROUGHOUT LIFE OF THE PROJECT.
  5. WORK ON BRIDGE #33.6 AND #34.1 SHALL NOT BECOME A MAJOR PROJECT UNTIL BRIDGES #33.4 & #35.6 HAS BEEN COMPLETED AND OPEN TO TRAFFIC.

1  CMS MESSAGES INCLUDE: "SR 178 TO CLOSE" & "MONTHDAY"

2  TYPE "B" WARNING LIGHT W20-3 4848 1500 FT

3  TYPE "B" WARNING LIGHT W20-3 4848 1000 FT

4  TYPE "B" WARNING LIGHT W20-3 4848 500 FT

5  TYPE "B" WARNING LIGHT R11-2 48830 ROAD CLOSED (TO BE MOUNTED ON TYPE M DOUBLE FACED BOARD 24" WIDE)

MISSISSIPPI DEPARTMENT OF TRANSPORTATION  
TRAFFIC CONTROL PLAN  
BR. 33.6 & 34.1 Δ

PROJ. NO.: BR-2909-00(006)  
COUNTY: MARSHALL

FILE NAME: TC-2.000  
DESIGN TEAM: STATEC  
CHECKED: \_\_\_\_\_ DATE: \_\_\_\_\_

WORKING NUMBER: TC-2  
SHEET NUMBER: 57



TYPE "B" WARNING LIGHT  
W20-1 (45 M.P.H.)

TYPE "B" WARNING LIGHT  
W13-1 (35 M.P.H.)

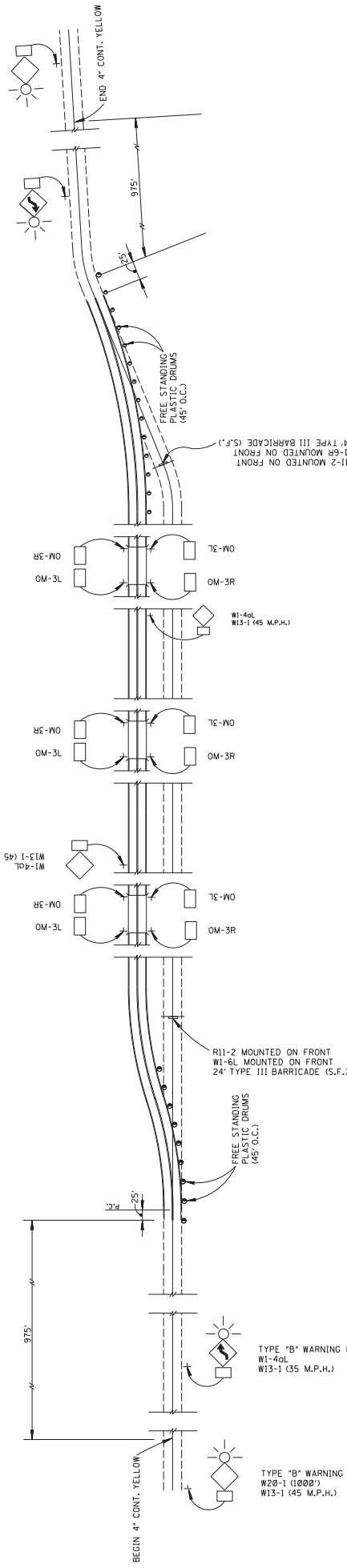

TRAFFIC CONTROL PLAN - REALIGNMENT (PHASE TWO)

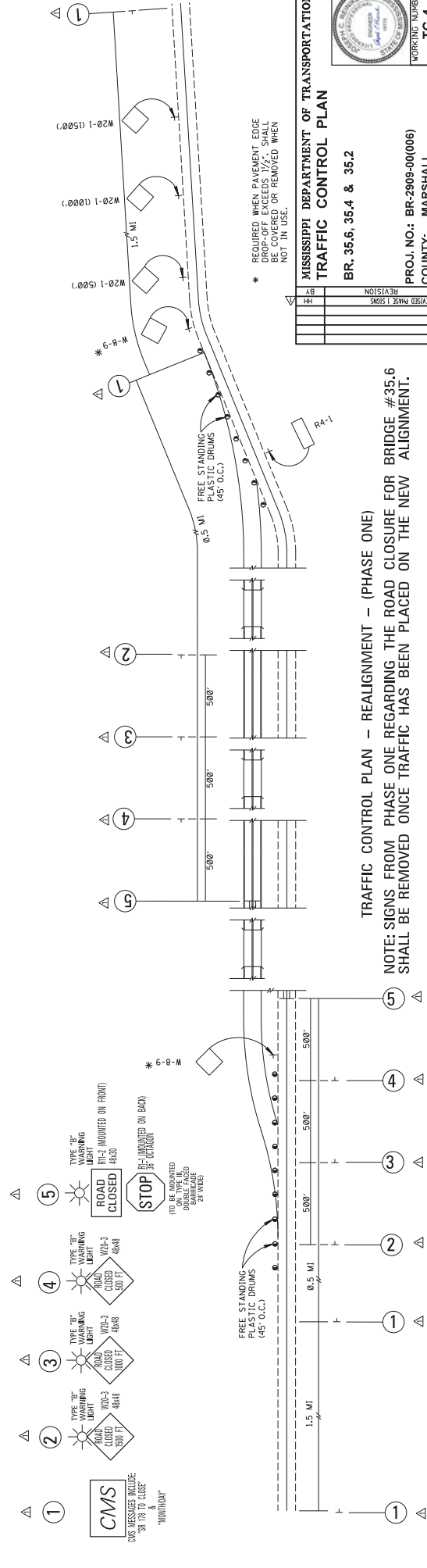

TRAFFIC CONTROL PLAN - REALIGNMENT - (PHASE ONE)  
NOTE: SIGNS FROM PHASE ONE REGARDING THE ROAD CLOSURE FOR BRIDGE #35.6 SHALL BE REMOVED ONCE TRAFFIC HAS BEEN PLACED ON THE NEW ALIGNMENT.

MISSISSIPPI DEPARTMENT OF TRANSPORTATION	
TRAFFIC CONTROL PLAN	
BR. 35.6, 35.4 & 35.2	
WORKING NUMBER	TC-4
COUNTY	MARSHALL
PROJECT NO.	BR-2909-00(006)
FILE NAME	TC-4.dgn
DESIGN TEAM	STANTEC
CHECKED	JCR
DATE	
REVISION	
BY	
DATE	
REVISION	
BY	
DATE	
REVISION	
BY	
DATE	

# ADDENDUM

STATE PROJECT NO.  
MISS.

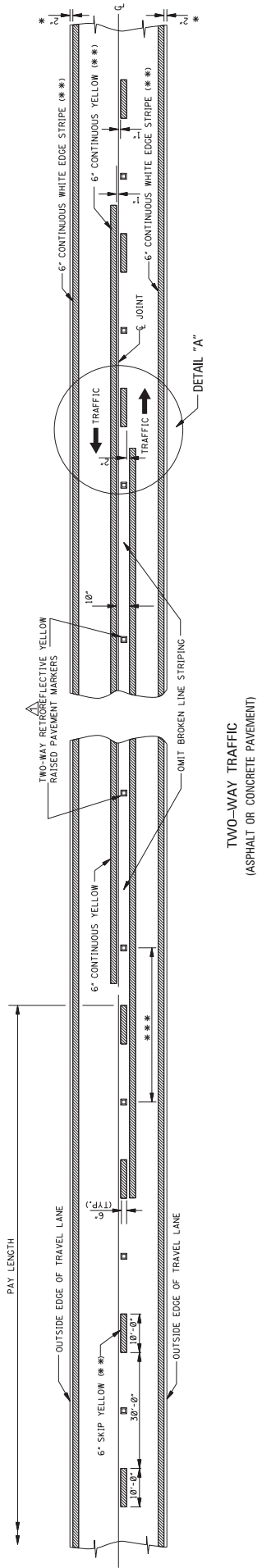

TWO-WAY TRAFFIC  
(ASPHALT OR CONCRETE PAVEMENT)

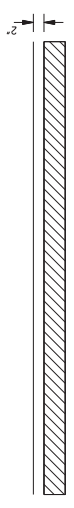

NOTE: THE CRITERIA FOR NO-PASSING ZONES CAN BE FOUND IN THE MOOT ROADWAY DESIGN MANUAL, SECTION 11-1.01.

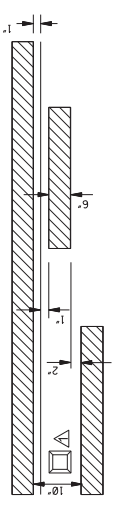

DETAIL "A"

TANGENT SECTIONS	RURAL AREA (40'-0" - 80'-0")	URBAN AREA (80'-0" - 400'-0")
HORIZONTAL CURVES	40'-0"-0"	40'-0"-0"
INTERCHANGE LIMITS	40'-0"-0"	1-400'-0"

- GENERAL NOTES:
- UNLESS SHOWN ELSEWHERE ON THE PLANS, FOR STRIPING ON RUMBLE STRIP SECTIONS REFER TO WK. SHEETS RS-1, RS-2, AND RS-3.
  - EDGE STRIPE SHALL BE SAME MATERIAL AS LANE-LINE STRIPE (PAINT OR PLASTIC AS INDICATED IN PAY ITEMS).
  - SPACING OF RETROREFLECTIVE RAISED PAVEMENT MARKERS IS AS FOLLOWS:

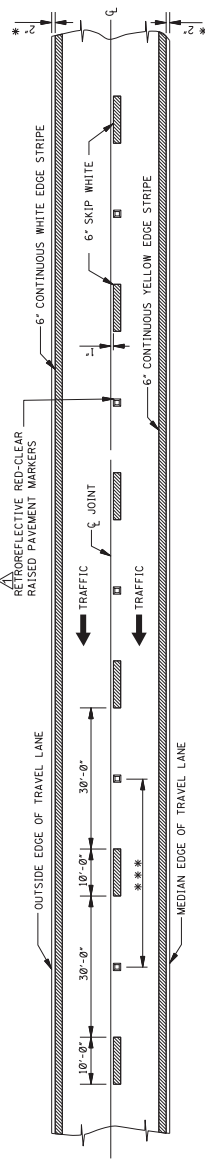

4-LANE WITH ONE-WAY TRAFFIC

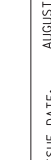

MISSISSIPPI DEPARTMENT OF TRANSPORTATION  
ROADWAY DESIGN DIVISION  
STANDARD PLAN

**PAVEMENT MARKING  
DETAILS FOR  
2-LANE AND 4-LANE  
DIVIDED ROADWAYS**

DATE	ISSUE DATE:	AUGUST 01, 2017
REVISION		
BY		
CHECKED		
APPROVED		

WORKING NUMBER: PM-1  
SHEET NUMBER: 6051













# ADDENDUM

STATE PROJECT NO.  
MISS.

DRAWING NOT INTENDED TO REPRESENT PAVEMENT MARKING DETAILS

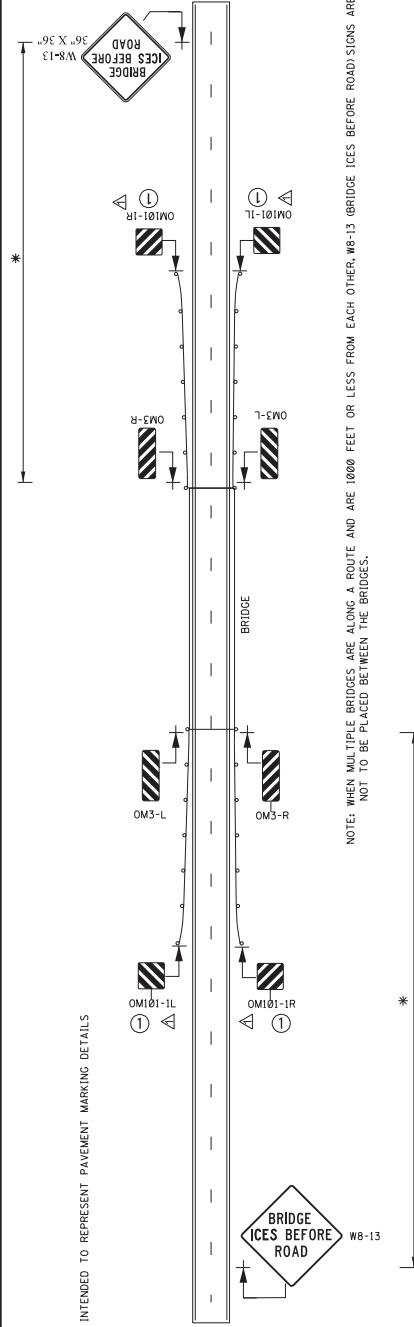

NOTE: WHEN MULTIPLE BRIDGES ARE ALONG A ROUTE AND ARE 1000 FEET OR LESS FROM EACH OTHER, W8-13 (BRIDGE ICES BEFORE ROAD) SIGNS ARE NOT TO BE PLACED BETWEEN THE BRIDGES.

## UNDIVIDED HIGHWAY DETAIL

SIGN QUANTITIES FOR UNDIVIDED HIGHWAY (PER SIGN)				
MUTCD NUMBER	STANDARD ROAD SIGN SIZE (FEET)	STANDARD ROAD SIGN SQUARE THICKNESS (INCHES)	FEET SQUARE THICKNESS	POST (3-P) U-SECTION THICKNESS
OM3-L	12" X 36"	0.125"	3 SF	9 LF
OM3-R	12" X 36"	0.125"	3 SF	9 LF
W8-13	36" X 36"	0.125"	9 SF	15 LF

① RETROREFLECTIVE ADHESIVE SHEETING WITH ALTERNATING BLACK AND YELLOW STRIPES (SLOPING DOWNWARD) (OM101-1L, OM101-1R) AT AN ANGLE OF 45 DEGREES (IN THE DIRECTION TRAFFIC IS TO PASS) IS REQUIRED ON THE END OF THE TERMINAL END SECTION. NOT A SEPARATE PAY ITEM. COST TO BE ABSORBED IN GUARD RAIL.

* MUTCD		MINIMUM PLACEMENT (FEET)
SPEED (MPH)		
35		250
40		305
45		360
50		420
55		495
60		570
65		645
70		730

SIGN QUANTITIES FOR DIVIDED HIGHWAY (PER SIGN)				
MUTCD NUMBER	STANDARD ROAD SIGN SIZE (FEET)	STANDARD ROAD SIGN SQUARE THICKNESS (INCHES)	FEET SQUARE THICKNESS	POST (3-P) U-SECTION THICKNESS
OM3-L	12" X 36"	0.125"	3 SF	9 LF
OM3-R	12" X 36"	0.125"	3 SF	9 LF
W8-13	48" X 48"	0.125"	16 SF	16.5 LF

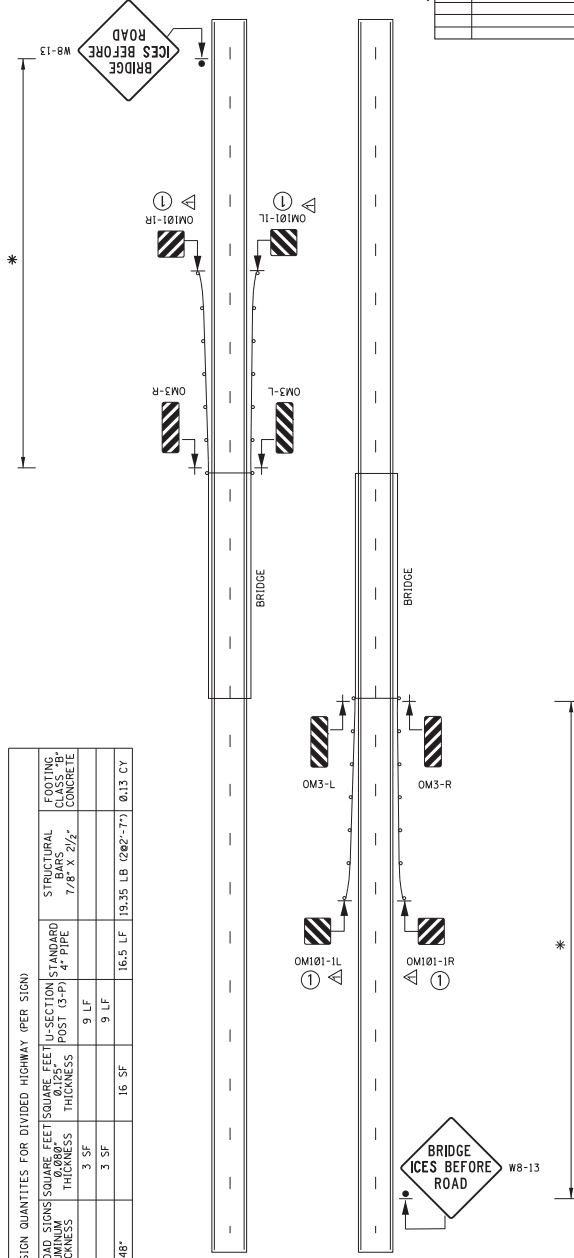

## DIVIDED HIGHWAY DETAIL

DATE	BY	REVISION

MISSISSIPPI DEPARTMENT OF TRANSPORTATION  
ROADWAY DESIGN DIVISION  
STANDARD PLAN

## SIGNING DETAILS FOR BRIDGE APPROACHES

MDOT  
WORKING NUMBER  
SN-9  
SHEET NUMBER  
6318

ISSUE DATE: AUGUST 01, 2017



# ADDENDUM

STATE MISS. PROJECT NO.

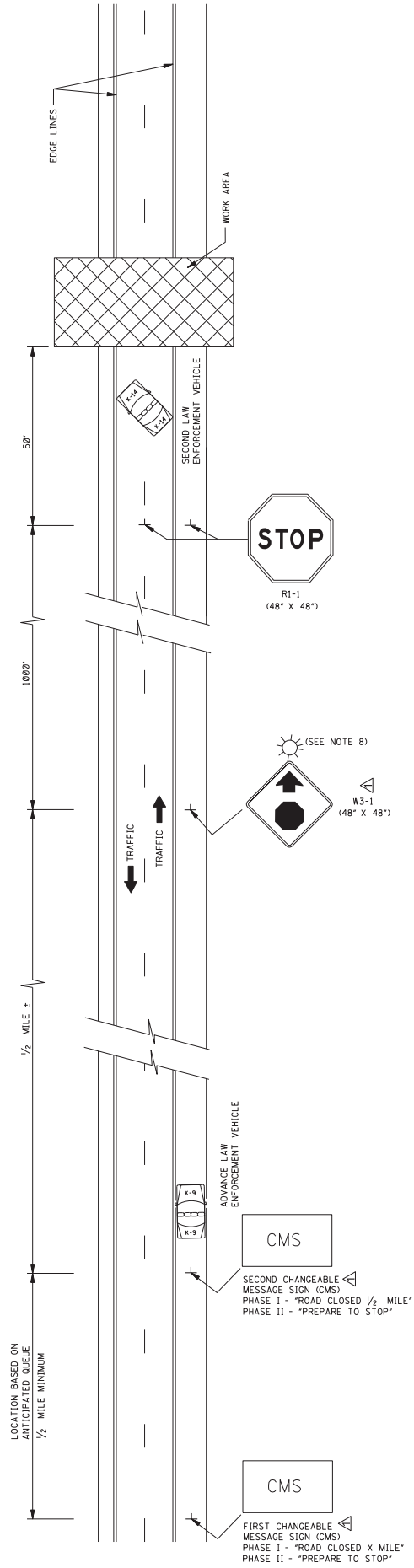

### GENERAL NOTES:

- THIS TYPE OF HIGHWAY CLOSURE SHOULD ONLY BE USED FOR CONSTRUCTION OPERATIONS. THE CLOSURE SHOULD NOT EXCEED 30 MINUTES. AFTER THE HIGHWAY HAS BEEN CLOSED AND REOPENED VIA THE CONTRACT DOCUMENT, THE CONTRACTOR SHALL PROVIDE ANOTHER SHORT DURATION CLOSURE, EXCEPT WITH THE APPROVAL OF THE ENGINEER.
- AT LEAST TWO LAW ENFORCEMENT OFFICERS AND TWO LAW ENFORCEMENT VEHICLES SHOULD BE PROVIDED ON EACH APPROACH TO THE CLOSURE. EACH LAW ENFORCEMENT VEHICLE SHOULD HAVE A PROTRUDING OPERATING FLASHING BLUE LIGHT ON LIGHT BAR.
- RESTRICTIONS ON ROAD CLOSURES ARE SPECIFIED IN THE CONTRACT DOCUMENT.
- THE ADVANCE LAW ENFORCEMENT VEHICLE SHOULD BE MOVED BACK AS REQUIRED BY THE QUEUING OF STOPPED VEHICLES.
- IF QUEUE EXCEEDS THE FIRST CHANGEABLE MESSAGE SIGN (CMS) AT ANY TIME DURING A CLOSURE, THE TRAFFIC CONTROL PLAN SHOULD BE ADJUSTED AS NECESSARY, WITH APPROVAL OF THE ENGINEER.
- TRAFFIC CONTROL FOR THE CLOSURE SHOULD BE ACCOMPLISHED IN THE FOLLOWING ORDER:
  - FIRST CHANGEABLE MESSAGE SIGN (CMS)
  - SECOND CHANGEABLE MESSAGE SIGN (CMS)
  - ADVANCE LAW ENFORCEMENT VEHICLE (CMS) AND FLASHERS ON.
  - W3-1 (48" X 48") (ORANGE/BLACK TYPE XI RETROREFLECTIVE SHEETING) SIGNS ERRECTED.
  - R1-1 (48" X 48") SIGNS ERRECTED OR INSTALLED ON TEMPORARY STANDS TO STOP TRAFFIC. THE ORDER OF ERECTION SHOULD BE IN THE FOLLOWING ORDER: RIGHT SHOULDER THEN CENTER, AND FLASHERS ON.
  - SECOND LAW ENFORCEMENT VEHICLE, LIGHTS AND FLASHERS ON.
- TRAFFIC CONTROL SHOULD BE REMOVED IN THE FOLLOWING ORDER:
  - WITH TRAFFIC STOPPED REMOVE THE "R1-1" SHOULDER IN THE FOLLOWING ORDER: CENTER THEN SIGN ON THE RIGHT SHOULDER. SECOND LAW ENFORCEMENT VEHICLE LEADS TRAFFIC THROUGH WORK AREA.
  - AFTER ALL STOPPED VEHICLES HAVE STARTED MOVING THE "W3-1 (48" X 48") SIGNS SHALL BE REMOVED. THESE SIGNS MAY BE COVERED IF RE-USE IS IMMINENT.
  - AFTER ALL VEHICLES HAVE RESUMED APPROXIMATELY NORMAL SPEED, THE CHANGEABLE MESSAGE SIGNS SHALL BE TURNED OFF.

- UNILLUMINATED SECTIONS OF HIGHWAYS SHOULD NOT BE CLOSED DURING HOURS OF DARKNESS EXCEPT FOR EMERGENCIES OR WITH THE APPROVAL OF THE ENGINEER. THE CLOSURE SHOULD BE LIMITED TO THE HOURS OF DARKNESS. A TYPE B HIGH INTENSITY FLASHING BARRICADE WARNING LIGHT SHALL BE USED ON EACH W3-1 SIGN.
- IF AN ENTRANCE RAMP IS LOCATED BETWEEN THE SECOND CMS AND R1-1, THE CMS AND W3-1 SIGNS SHALL ALSO BE ERRECTED ON THE RAMP SHOULDER.
- THE ABOVE DURATION WILL APPLY TO EACH APPROACH TO THE CLOSURE.
- ALL TRAFFIC CONTROL ITEMS SHOWN ON THIS SHEET WILL NOT BE MEASURED FOR SEPARATE PAYMENT. THIS WORK SHALL BE INCLUDED IN THE PRICE BID FOR MAINTENANCE OF TRAFFIC, INCLUDING SECURING LAW ENFORCEMENT SERVICES.

NO.	DATE	BY	REVISION
1			ISSUED FOR BIDDING
2			REVISED SHEET
3			REVISED SHEET
4			REVISED SHEET
5			REVISED SHEET
6			REVISED SHEET
7			REVISED SHEET
8			REVISED SHEET
9			REVISED SHEET
10			REVISED SHEET
11			REVISED SHEET
12			REVISED SHEET
13			REVISED SHEET
14			REVISED SHEET
15			REVISED SHEET
16			REVISED SHEET
17			REVISED SHEET
18			REVISED SHEET
19			REVISED SHEET
20			REVISED SHEET

MISSISSIPPI DEPARTMENT OF TRANSPORTATION  
ROADWAY DESIGN DIVISION  
STANDARD PLAN

**SHORT DURATION  
CLOSING OF TWO-LANE  
TWO-WAY HIGHWAYS**

ISSUE DATE: AUGUST 01, 2017

SHEET NUMBER: 6356

WORKING NUMBER: TCP-6

# ADDENDUM

STATE PROJECT NO.  
MISS.

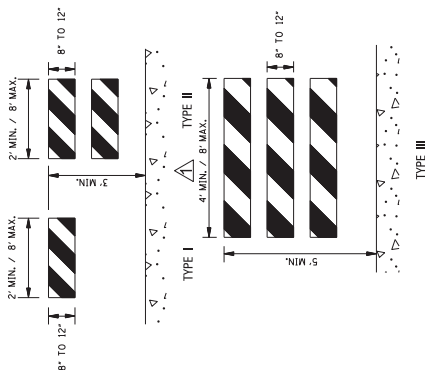

## STANDARD BARRICADES

1. THE RETROREFLECTIVE MARKING FOR BARRICADE RAILS SHALL BE ORANGE AND WHITE (SLOPING DOWNWARD AT AN ANGLE OF 45° IN THE DIRECTION THAT TRAFFIC IS TO PASS).
2. RAIL STRIPE SHOULD BE 6 INCHES, EXCEPT THAT 4-INCH WIDE STRIPES MAY BE USED IF RAIL LENGTHS ARE LESS THAN 36 INCHES.
3. DO NOT PLACE SANDBARS OR OTHER DEVICES ON BARRICADE RAILS TO PROVIDE MASS SOUNDS, UNLESS MAJOR WORK ZONES AS BALLAST TO THE LOWER PARTS OF THE FRAME OR THE STAYS TO BARRICADES.
4. FOR ADDITIONAL INFORMATION OR DETAILS, SEE MUTED LATEST EDITION.
5. BARRICADES ARE CLASSIFIED BY FHWA AS CATEGORY II WORK ZONE DEVICES. A LIST OF CRASHWORTHY BARRICADES AND OTHER CATEGORY II DEVICES CAN BE FOUND ON FHWA'S WEBSITE: <http://highways.dot.gov/safety/rwd/rdw/reduce-crash-severity>
6. WHERE ROAD USERS INCLUDE PEDESTRIANS, THE PROVISION OF SUPPLEMENTAL AUDIBLE INFORMATION OR DETECTABLE BARRIERS OR BARRICADES SHOULD BE PROVIDED FOR PEOPLE WITH VISION DISABILITIES.
7. BARRICADE RAIL SUPPORTS SHOULD NOT PROJECT INTO PEDESTRIAN CIRCULATION ROUTES MORE THAN 4 INCHES FOR THE SUPPORTS LOCATED BETWEEN 27 INCHES TO 88 INCHES ABOVE THE EXISTING SURFACE.

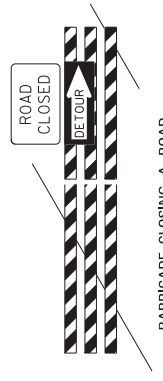

## BARRICADE CHARACTERISTICS

	I	II	III
WIDTH OF RAIL **	8" MIN. - 12" MAX.	8" MIN. - 12" MAX.	8" MIN. - 12" MAX.
LENGTH OF RAIL **	24" MIN. / 95" MAX.	24" MIN. / 95" MAX.	48" MIN. / 95" MAX.
WIDTH OF STRIPE *	6"	6"	6"
HEIGHT	36" MIN.	36" MIN.	60" MIN.
NUMBER OF RETROREFLECTORIZED RAIL FACES	2 (ONE EACH DIRECTION)	4 (TWO EACH DIRECTION)	3 IF FACING TRAFFIC IN TWO DIRECTIONS 6 IF FACING TRAFFIC IN TWO DIRECTIONS

- \* 1. FOR RAILS LESS THAN 36" LONG, 4" WIDE STRIPES MAY BE USED.
- \*\* 2. BARRICADES INTENDED FOR USE ON EXPRESSWAYS, FREEWAYS AND OTHER HIGH SPEED FACILITIES SHALL HAVE A MINIMUM OF 270 SQ FT OF REFLECTIVE AREA FACING TRAFFIC.

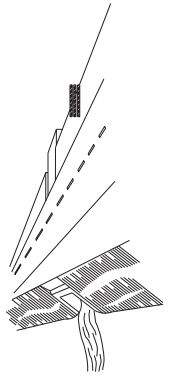

## WING BARRICADES

1. WING BARRICADES ARE TYPE III BARRICADES ERECTED ON THE SHOULDER OF A ROADWAY TO PROVIDE A WARNING OF A NARROWING OR RESTRICTED ROADWAY. WING BARRICADES MAY BE USED AS A MOUNTING FOR THE ADVANCE WARNING SIGNS OR FLASHERS.
2. WING BARRICADES SHOULD BE USED:
  - A. IN ADVANCE OF A CONSTRUCTION PROJECT EVEN WHEN NO PART OF THE ROADWAY IS ACTUALLY CLOSED.
  - B. IN ADVANCE OF ALL BRIDGE OR CULVERT WIDENING OPERATIONS.

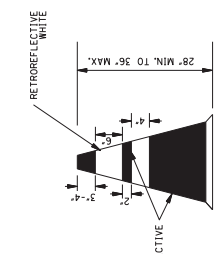

1. PLASTIC CONES, TUBULAR MARKERS, OR PLASTIC DRUMS SHALL BE ON, AND USED AS AN EXPEDITIOUS METHOD FOR TRAFFIC CHANNELIZATION. THE COLOR AND MARKING OF THE DEVICE USED SHALL BE CONSISTENT WITH MARKING STANDARDS FOR BARRICADE. THE PREDOMINANT COLOR ON THE DEVICE USED SHALL BE ORANGE WITH RETROREFLECTIVE, HORIZONTAL, CIRCUMFERENTIAL WHITE STRIPES AS SHOWN ON THE DETAILS.
2. DRUMS, TUBULAR MARKERS, OR PLASTIC CONES SHOULD NEVER BE PLACED IN THE ROADWAY WITHOUT WARNING SIGNS.
3. WHERE PRACTICAL, PLASTIC DRUMS, TUBULAR MARKERS, OR PLASTIC CONES SHOULD BE PLACED NO CLOSER THAN 3'-0" FROM THE EDGE OF TRAVELED LANE.
4. BALLAST SHALL NOT BE PLACED ON THE TOP OF THE DRUM.

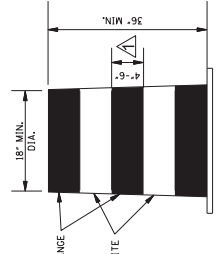
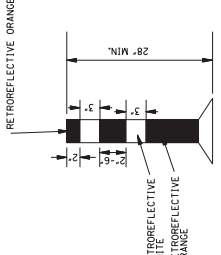

1. TYPE 3 OBJECT MARKERS SHALL BE USED AT ALL EXPOSED BRIDGE ABUTMENTS AND AT OTHER LOCATIONS AS DEEMED NECESSARY BY THE ENGINEER.
2. THE OMS-R IS SHOWN. THE OMS-L IS SIMILAR EXCEPT THE STRIPES ARE DOWNWARD SLOPING ON THE LOWER RIGHT SIDE AND SHALL BE PLACED ON THE LEFT SIDE OF THE OBJECT.
3. THE INSIDE EDGE OF THE MARKER SHALL BE IN LINE WITH THE INNER EDGE OF THE OBSTRUCTION.
4. THE STRIPING SHALL CONSIST OF ALTERNATING BLACK AND RETROREFLECTIVE YELLOW SLOPING DOWNWARD TOWARD THE SIDE ON WHICH TRAFFIC IS THE PASS.

## TYPE 3 OBJECT MARKER (OMS-R)

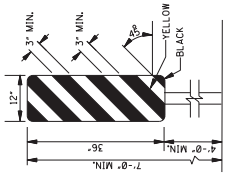

## RETROREFLECTIVE CHEVRON ALIGNMENT SIGN DETAIL (VM-8)

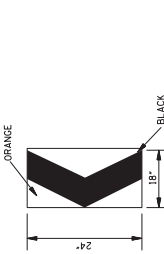

1. CHEVRON SIGN CONSISTS OF A BLACK CHEVRON TYPE MARKING ON AN ORANGE BACKGROUND AND SHALL POINT IN THE DIRECTION OF TRAFFIC FLOW.
2. THE CHEVRON SIGN SHALL BE MOUNTED ON CRASHWORTHY SUPPORT.
3. CHEVRON SIGNS MAY BE USED TO SUPPLEMENT OTHER STANDARD DEVICES WHERE ONE OR MORE LANES ARE CLOSED FOR CONSTRUCTION OR MAINTENANCE. THEY SHOULD BE PLACED APPROXIMATELY 2'-0" BEHIND THE LANE TRANSITION STRIPE.
4. CHEVRON SIGNS SHALL BE INSTALLED AT A MINIMUM HEIGHT OF 4 FEET MEASURED VERTICALLY FROM THE BOTTOM OF THE SIGN TO THE ELEVATION OF THE NEAR EDGE OF THE TRAVELWAY.

NO.	DATE	REVISION

MISSISSIPPI DEPARTMENT OF TRANSPORTATION  
ROADWAY DESIGN DIVISION  
STANDARD PLAN

**HIGHWAY SIGN AND BARRICADE DETAILS FOR CONSTRUCTION PROJECTS**

ISSUE DATE: AUGUST 01, 2017  
SHEET NUMBER: 6358







# ADDENDUM

STATE PROJECT NO.  
MISS.

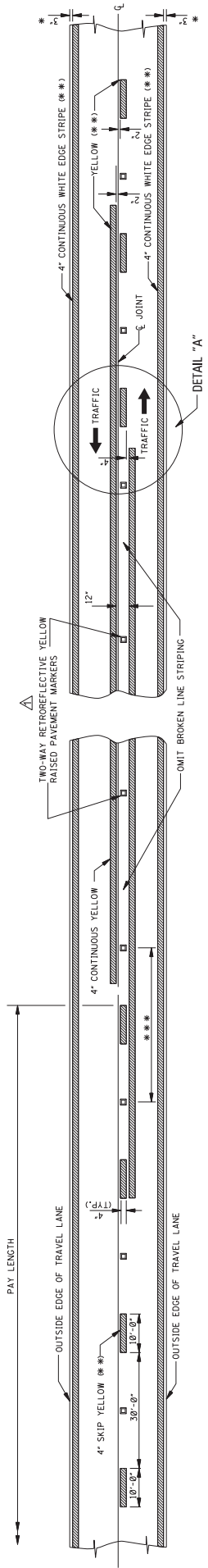

**TWO-WAY TRAFFIC**  
(ASPHALT OR CONCRETE PAVEMENT)

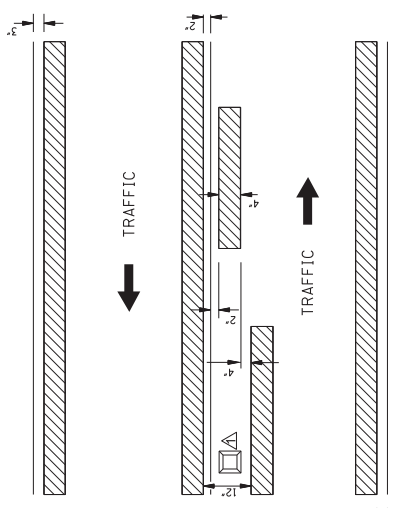

**DETAIL "A"**

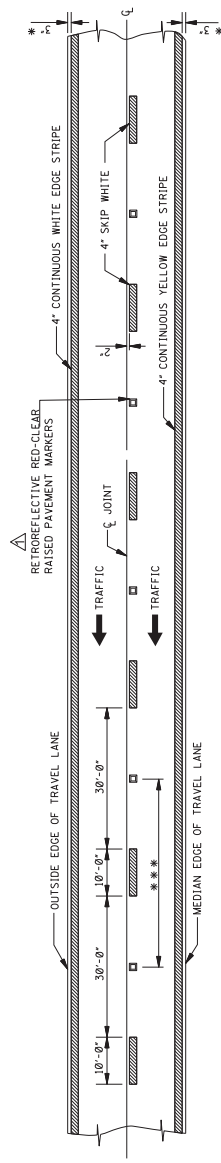

**4-LANE WITH ONE-WAY TRAFFIC**



- GENERAL NOTES:
- \* 1. 3" UNLESS SHOWN ELSEWHERE ON THE PLANS.
  - \*\* 2. EDGE STRIPE SHALL BE SAME MATERIAL AS LANE-LINE STRIPE (PAINT OR TAPE AS INDICATED IN PAY ITEMS).
  - ▲ 3. RETROREFLECTIVE RAISED PAVEMENT MARKERS TO BE USED IF TEMPORARY MARKINGS ARE TO REMAIN IN PLACE OVER 3 MONTHS.
  - ▲\*\*\* 4. SPACING OF RETROREFLECTIVE RAISED PAVEMENT MARKERS IS AS FOLLOWS:

TANGENT SECTIONS	URBAN AREA (ft-in)	RURAL AREA (ft-in)
HORIZONTAL CURVES	40'-0"	80'-0"
INTERCHANGE LIMITS	40'-0"	+ 40'-0"

- ▲† NOTE: ON THE MAIN FACILITY, RETROREFLECTIVE RED-CLEAR RAISED PAVEMENT MARKERS ON A 40'-0" SPACING WILL BE REQUIRED ON LANE-LINES THROUGH ALL INTERCHANGE AREAS BEGINNING 1000' IN ADVANCE (IN DIRECTION OF TRAFFIC) OF THE EXIT RAMP AND ENDING 1000' BEFORE THE INTERCHANGE TO THE END OF THE ENTRANCE RAMP TAPER.
- ▲ 5. PAVEMENT MARKERS SHALL BE HIGH PERFORMANCE RETROREFLECTIVE RAISED PAVEMENT MARKERS FROM THE MOST APPROVED PRODUCTS LIST.

MISSISSIPPI DEPARTMENT OF TRANSPORTATION  
ROADWAY DESIGN DIVISION  
STANDARD PLAN

**TEMPORARY STRIPING FOR  
TRAFFIC CONTROL  
2-LANE AND 4-LANE  
DIVIDED HIGHWAYS**

DATE	ISSUE DATE:	AUGUST 01, 2017
REVISION		
REVISION		
REVISION		
REVISION		

ISSUE DATE: AUGUST 01, 2017  
SHEET NUMBER 6363  
WORKING NUMBER TCP-13

# ADDENDUM

STATE MISS. PROJECT NO.

MISS.

PROJECT NO.

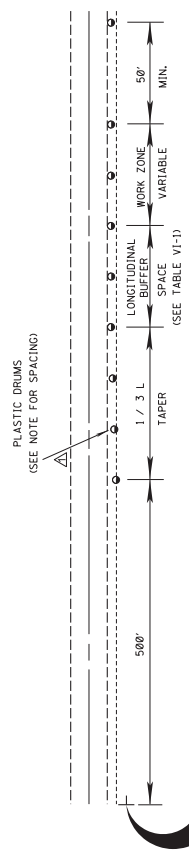

## TYPICAL SHOULDER CLOSURE

- (1) TO BE USED WITH EIGHT (8) FOOT OR GREATER WIDTH IMPROVED SHOULDER.
- (2) TO BE USED WHEN CONSTRUCTION VEHICLES (EQUIPMENT) ENCRUSHES ON OR WITHIN TWO (2) FEET OF THE SHOULDER BREAK.
- (3) FOR SHORT DURATION OPERATIONS OF 60 MINUTES OR LESS, ALL SIGNS AND CHANNELIZING DEVICES MAY BE ELIMINATED IF A VEHICLE WITH ACTIVATED HIGH-INTENSITY ROTATING, FLASHING, OSCILLATING, OR STROBE LIGHTS IS USED.

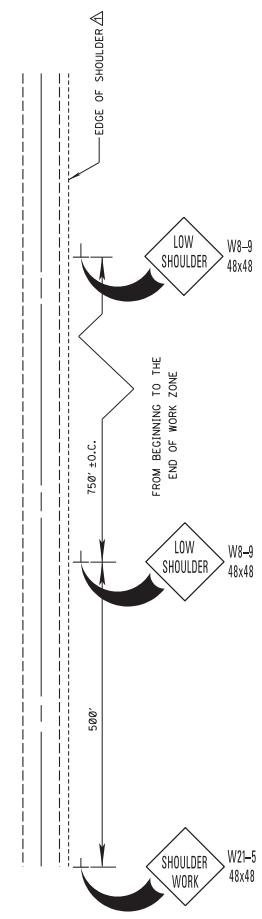

## TYPICAL SHOULDER WORK #1

- (1) IF LESS THAN TWO AND ONE QUARTER (2.25) INCHES-NO PROTECTION REQUIRED. PLACE A SHOULDER WORK SIGN (W21-5) 500 FEET IN ADVANCE OF WORK ZONE SHOULDER AND A LOW SHOULDER SIGN (W8-9) AT THE BEGINNING AND THROUGHOUT THE WORK ZONE @ (750'±O.C.).
- (2) TWO AND ONE QUARTER TO THREE INCHES-PLACE DRUMS, VERTICAL PANELS OR BARRICADES EVERY 100 FEET ON TANGENT SECTIONS FOR SPEEDS OF 50 MILES PER HOUR OR GREATER, CONES MAY BE USED IN PLACE OF DRUMS, PANELS, AND BARRICADES DURING DAYLIGHT HOURS, FOR TANGENT SECTIONS WITH SPEEDS LESS THAN 50 MILES PER HOUR AND FOR CURVES, DEVICES SHOULD BE PLACED EVERY 50 FEET. SPACING FOR TAPERS SHOULD BE IN ACCORDANCE WITH THE MUTCD (1 / 3 L, WHERE L IS THE TAPER LENGTH IN FEET).
- (3) GREATER THAN THREE (3) INCHES-POSITIVE SEPARATION OR WEDGE WITH 4:1 OR FLATTER SLOPE NEEDED, IF THERE IS EIGHT (8) FEET OR MORE DISTANCE BETWEEN THE EDGE OF TRAVEL LANE AND DROP-OFF, THEN DRUMS, PANELS OR BARRICADES MAY BE USED.
- (4) FOR TEMPORARY CONDITIONS, DROP-OFFS GREATER THAN THREE (3) INCHES MAY BE PROTECTED WITH DRUMS, VERTICAL PANELS OR BARRICADES FOR SHORT DISTANCES DURING DAYLIGHT HOURS WHILE WORK IS BEING DONE IN THE DROP-OFF AREA.
- (5) LESSER TREATMENTS THAN THOSE DESCRIBED ABOVE MAY BE CONSIDERED FOR LOW-VOLUME LOCAL STREETS.

## TYPICAL SHOULDER WORK #2

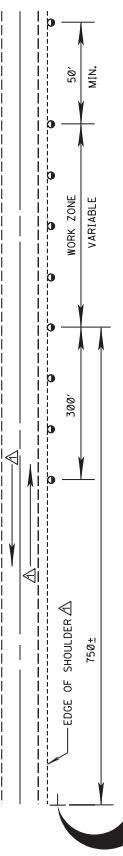

## TYPICAL SHOULDER WORK #2

- NOTE: WORK OUTSIDE TWO (2) FOOT AND WITHIN TEN (10) FEET OF THE SHOULDER BREAK MAY BE PROTECTED BY PLACING DRUMS ALONG THE SHOULDER EDGE, 300 FEET PRIOR TO AND 50 FEET BEYOND THE WORK AREA, OR SEE NOTE A-3 THIS SHEET.

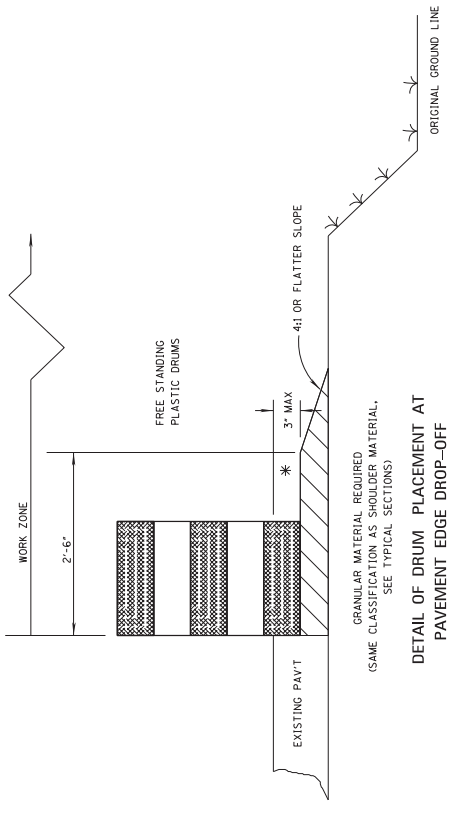

## DETAIL OF DRUM PLACEMENT AT PAVEMENT EDGE DROP-OFF

GRANULAR MATERIAL REQUIRED AS SHOULDER MATERIAL, (SAME SPECIFICATIONS AS SHOULDER MATERIAL, SEE TYPICAL SECTIONS)

## NOTES:

- \* A. PAVEMENT EDGE DROP-OFF
- 1. IF LESS THAN TWO AND ONE QUARTER (2.25) INCHES-NO PROTECTION REQUIRED. PLACE A SHOULDER WORK SIGN (W21-5) 500 FEET IN ADVANCE OF WORK ZONE SHOULDER AND A LOW SHOULDER SIGN (W8-9) AT THE BEGINNING AND THROUGHOUT THE WORK ZONE @ (750'±O.C.).
- 2. TWO AND ONE QUARTER TO THREE INCHES-PLACE DRUMS, VERTICAL PANELS OR BARRICADES EVERY 100 FEET ON TANGENT SECTIONS FOR SPEEDS OF 50 MILES PER HOUR OR GREATER, CONES MAY BE USED IN PLACE OF DRUMS, PANELS, AND BARRICADES DURING DAYLIGHT HOURS, FOR TANGENT SECTIONS WITH SPEEDS LESS THAN 50 MILES PER HOUR AND FOR CURVES, DEVICES SHOULD BE PLACED EVERY 50 FEET. SPACING FOR TAPERS SHOULD BE IN ACCORDANCE WITH THE MUTCD (1 / 3 L, WHERE L IS THE TAPER LENGTH IN FEET).
- 3. GREATER THAN THREE (3) INCHES-POSITIVE SEPARATION OR WEDGE WITH 4:1 OR FLATTER SLOPE NEEDED, IF THERE IS EIGHT (8) FEET OR MORE DISTANCE BETWEEN THE EDGE OF TRAVEL LANE AND DROP-OFF, THEN DRUMS, PANELS OR BARRICADES MAY BE USED.
- 4. FOR TEMPORARY CONDITIONS, DROP-OFFS GREATER THAN THREE (3) INCHES MAY BE PROTECTED WITH DRUMS, VERTICAL PANELS OR BARRICADES FOR SHORT DISTANCES DURING DAYLIGHT HOURS WHILE WORK IS BEING DONE IN THE DROP-OFF AREA.
- 5. LESSER TREATMENTS THAN THOSE DESCRIBED ABOVE MAY BE CONSIDERED FOR LOW-VOLUME LOCAL STREETS.

## \* B. DRUM, VERTICAL PANEL, OR BARRICADE SPACING

- 1. TANGENTS = 2 X S
- 2. TAPERS = L / 3
- WHERE L = L / 3
- L = TAPER LENGTH IN FEET
- S = SPEED IN MPH (POSTED OR ANTICIPATED OPERATING SPEED)
- W = WIDTH OF OFFSET IN FEET

C. ALL TRAFFIC CONTROL ITEMS SHOWN ON THIS SHEET SHALL BE PAID FOR UNDER MAINTENANCE OF TRAFFIC.

TABLE VI-1. GUIDELINES FOR LENGTH OF LONGITUDINAL BUFFER SPACE

PERCENTILE SPEED (MPH)	LENGTH (FEET)
20	115
25	155
30	200
35	250
40	305
45	360
50	425
55	495
60	570
65	645

\* POSTED SPEED, OFF-PEAK 85 PERCENTILE SPEED (OR LOWER), OR THE ANTICIPATED OPERATING SPEED IN MPH.

MISSISSIPPI DEPARTMENT OF TRANSPORTATION  
ROADWAY DESIGN DIVISION  
STANDARD PLAN

TRAFFIC CONTROL DETAILS  
DRUM PLACEMENT  
AND  
SHOULDER CLOSURE

ISSUE DATE: AUGUST 01, 2017  
SHEET NUMBER 6366