

GENERAL INDEX

INCLUDED THIS PROJECT	BEGIN WITH SHEET
<input checked="" type="checkbox"/> ROADWAY.....	1
<input checked="" type="checkbox"/> PERMANENT SIGNS.....	1001
<input type="checkbox"/> TRAFFIC SIGNALS.....	2001
<input type="checkbox"/> ITS COMPONENTS.....	3001
<input type="checkbox"/> LIGHTING.....	4001
<input type="checkbox"/> (RESERVED).....	5001
<input checked="" type="checkbox"/> ROADWAY STD. DWGS.....	6001
<input type="checkbox"/> BOX CULVERT STD. DWGS (LRFD).....	7001
<input type="checkbox"/> BOX CULVERT STD. DWGS (STD. SPEC.)....	7501
<input type="checkbox"/> BRIDGE.....	8001
<input type="checkbox"/> CROSS SECTIONS.....	9001

STATE OF MISSISSIPPI
MISSISSIPPI DEPARTMENT OF TRANSPORTATION

PLAN AND PROFILE OF
PROPOSED STATE HIGHWAY
STATE PROJECT NO. SP-0042-01(012)

SR 397 FM KEMPER CL TO ROBERTSON RD
WINSTON COUNTY

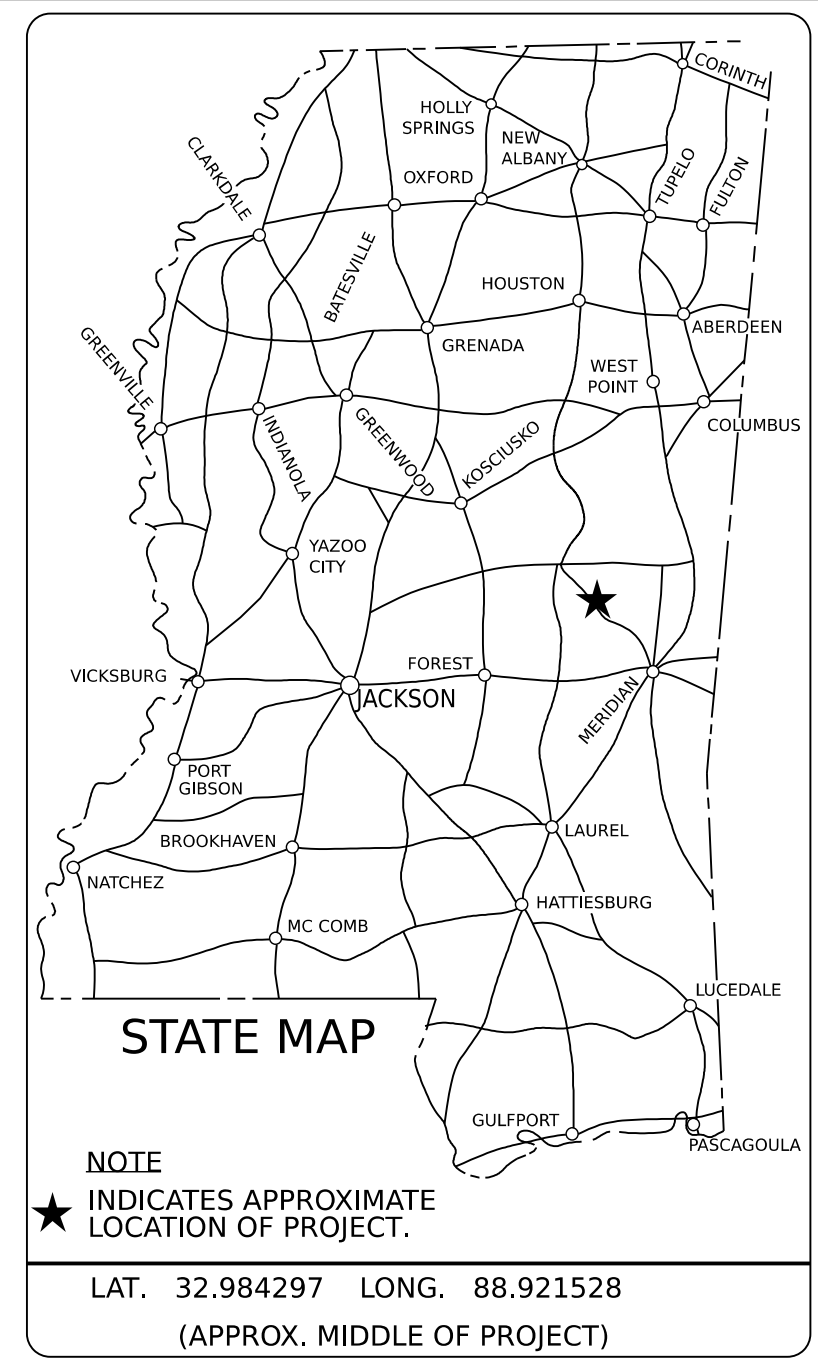

BRIDGE STRUCTURES REQ'D.

BOX BRIDGES REQ'D.

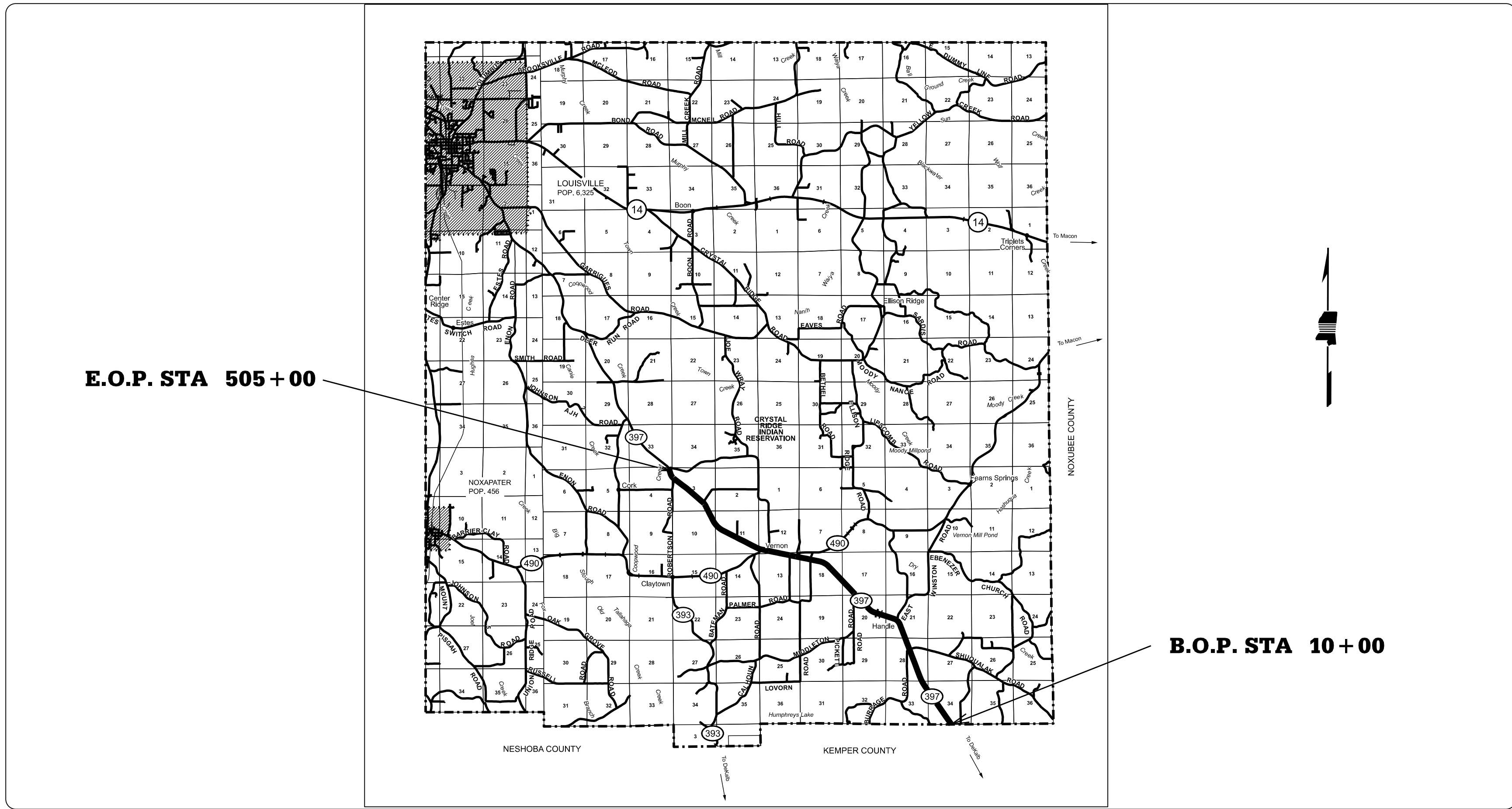

DESIGN CONTROL	
MPH = V (SPEED DESIGN)	
ADT () =	: ADT () =
DHV =	: D = % T = %
PERMITS ACQUIRED BY MDOT	
WETLANDS AND WATERS PERMITS	
NATIONWIDE #14	<input checked="" type="checkbox"/> WETLANDS <input checked="" type="checkbox"/>
NATIONWIDE (OTHER)*	<input checked="" type="checkbox"/> WETLANDS <input checked="" type="checkbox"/>
GENERAL*	<input checked="" type="checkbox"/> WETLANDS <input checked="" type="checkbox"/>
INDIVIDUAL (404)*	<input checked="" type="checkbox"/> WETLANDS <input checked="" type="checkbox"/>
STORMWATER PERMIT <input checked="" type="checkbox"/>	
Y REQUIRED, CNOI SUBMITTED BY MDOT (DISTURBED AREA=5 ACRES)	
S REQUIRED, SCNOI TO BE SUBMITTED BY CONTRACTOR (1 TO 4.99 ACRES)	
N NO STORMWATER PERMIT REQUIRED (<1 ACRE)	
APPROVED BY: _____	

TITLE SHEET

CONVENTIONAL SYMBOLS

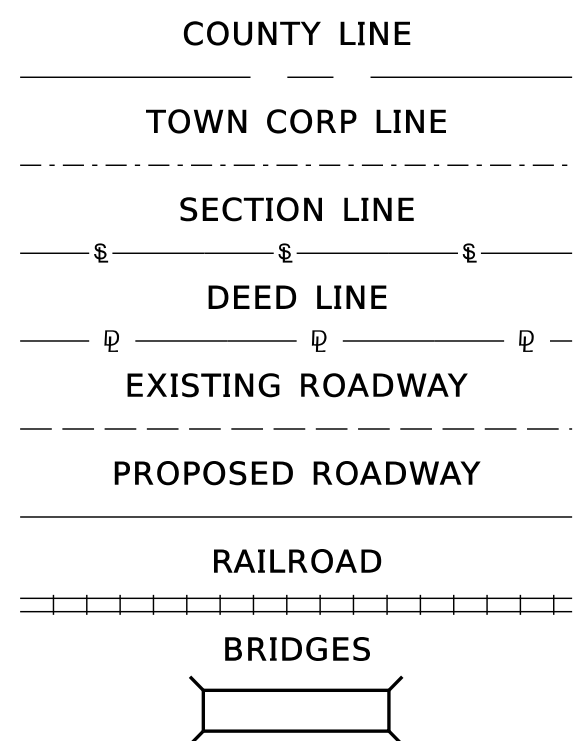

LENGTH DATA	
LENGTH OF ROADWAY	49,015 FT. 9.283 MI.
LENGTH OF BRIDGES	485 FT. 0.092 MI.
LENGTH OF PROJECT (NET)	49,500 FT. 9.375 MI.
LENGTH OF EXCEPTIONS	0 FT. 0 MI.
LENGTH OF PROJECT (GROSS)	49,500 FT. 9.375 MI.

EQUATIONS

SCALES

PLAN	1 IN. = 100 FT.
PROFILE	{ HOR. 1 IN. = 100 FT.
	{ VERT. 1 IN. = 10 FT.
LAYOUT	1 IN. = FT.

EXCEPTIONS

12/18/2025 8:43:00 AM SP-0042-01(012) PLANS.dgn



DESIGNED BY:	
CONSTRUCTION PROJECT DATA	
EXTERNAL PROJECT NUMBER	SP-0042-01(012)
FMS & DETAIL	108911/301000
P S & E DATE: 12/15/2025	
APPROVED:	
DEPUTY EXECUTIVE DIRECTOR / CHIEF ENGINEER	
EXECUTIVE DIRECTOR	

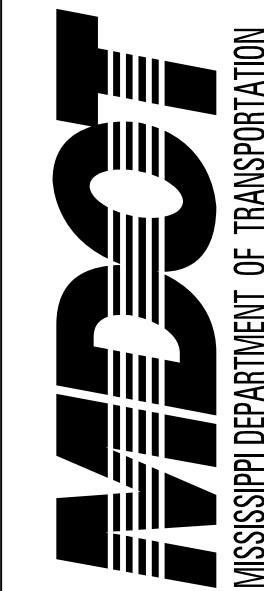

DESIGNED BY:
 DETAILED BY:
 CHECKED BY:
 DATE:

FMS CON: 108911/301000
 PROJECT NO.: SP-0042-01(012)
 COUNTY: WINSTON

DETAILED INDEX

SHEET ID
DI-1
 SHEET NO.
2

DESCRIPTION OF SHEET

REVISION DATE WKG. NO. SH. NO.

TITLE SHEET (1)			1
DETAIL INDEX & GENERAL NOTES (1)		DI-1	2
SUMMARY OF REVISIONS		REV-1	3
TYPICAL OVERLAY SECTIONS (5)			
TYPICAL SECTION MILL AND OVERLAY & FAILED AREAS		TS-1	4
TYPICAL SECTION MILL AND OVERLAY & FAILED AREAS		TS-2	5
TYPICAL SECTION PIPE @ STA: 221+00		TS-3	6
TYPICAL SECTION PIPE @ STA: 280+48		TS-4	7
TYPICAL SECTION PIPE @ STA: 371+00		TS-5	8
QUANTITY SHEETS (2)			
SUMMARY OF QUANTITIES		SQS-1	9
SUMMARY OF QUANTITIES		SQS-2	10
SPECIAL DESIGN-ROADWAY ITEMS (9)			
DETAIL OF CONSTRUCTION SIGNING		DCS-1	11
DETAIL OF CONSTRUCTION SIGNING		DCS-2	12
DETAIL OF CONSTRUCTION SIGNING		DCS-3	13
TRAFFIC CONTROL PLAN		TC-1	14
RUMBLE STRIPES 2-LANE HIGHWAYS (ASPH. LANES, 2-FT ASPH. SHLD.)		RSw/RPM	15
SIGN SUPPORT HARDWARE 2.0" SQUARE POST		TSS-2	16
SIGN QUANTITIES		SRS-1	17
SIGN QUANTITIES		SRS-2	18
STANDARD DRAWINGS - ROADWAY SHEETS (19)			
PAVEMENT MARKING DETAIL FOR 2-LANE AND 4-LANE DIVIDED HIGHWAYS		PM-1	6051
2-WAY RAISED PAVEMENT MARKERS AT INTERSECTING ROADS (2-LANE)		PM-11	6061
GUARDRAIL: "W" BEAM (STEEL POST)		GR-1B	6203
GUARDRAIL: BRIDGE END SECTION TYPE "H" (STEEL POST)		GR-2D	6208
GUARDRAIL: TYPICAL INSTALLATION AT BRIDGE APPROACHES FOR 2-LANE, 2-WAY HIGHWAY		GR-4A	6215
GUARDRAIL: MISCELLANEOUS HARDWARE		GR-HW	6221
STANDARD ROADSIDE SIGN ASSEMBLY AND INSTALLATION		SN-4	6306
STANDARD ROADSIDE SIGN ASSEMBLY AND INSTALLATION		SN-4A	6307
STANDARD ROADSIDE SIGN ASSEMBLY AND INSTALLATION		SN-4B	6308
TYPICAL INSTALLATION AND DETAILS OF DELINEATORS AND DISTANCE REFERENCE SIGNS		SN-8	6314
TYPICAL GUARDRAIL DELINEATION		SN-8C	6317
SIGN DETAILS FOR BRIDGE APPROACHES		SN-9	6318
TRAFFIC CONTROL PLAN WITH FLAGGER (ONE-LANE CLOSURE OF TWO-WAY TRAFFIC)		TCP-1	6351
HIGHWAY SIGN AND BARRICADE DETAILS FOR CONSTRUCTION PROJECTS		TCP-8	6358
TRAFFIC CONTROL PLAN MOBILE OPERATIONS MULTILANE ROADS AND TWO LANE ROADS		TCP-9	6359
TRAFFIC CONTROL PLAN UNEVEN PAVEMENT DETAILS		TCP-12	6362
TEMPORARY STRIPE FOR TRAFFIC CONTROL 2-LANE AND 4-LANE DIVIDED HIGHWAYS		TCP-13	6363
CONCRETE PIPE COLLAR		PC-1	6503
FLARED END SECTION FOR CONCRETE PIPE		FE-1	6530

GENERAL NOTES:

- WHERE MILLING OF THE ROADWAY LANES IS REQUIRED, THE CONTRACTOR SHALL PROVIDE OUTLETS IN THE EXISTING SHOULDERS AT SUFFICIENT INTERVALS TO PREVENT POOLING OR STANDING WATER ON THE MILLED SURFACE. (ABSORBED COST)
- FLUORESENT ORANGE SHEETING SHALL BE USED ON ALL CONSTRUCTION AND TRAFFIC CONTROL SIGNS EXCEPT FOR THOSE DESIGNATED ON THE PLANS TO BE BLACK LEGEND AND BORDER ON THE WHITE BACKGROUND.
- FAILED AREAS WHERE THE EXISTING ASPHALT IS REMOVED VIA MILLING SHALL BE PAID FOR WITH FINE MILLING, ALL DEPTHS.
- THE LOCATION AND SPACING OF SIGNS, SHOWN ON THE TRAFFIC CONTROL PLANS, ARE APPROXIMATE AND MAY BE ADJUSTED AS NECESSARY TO FIT FIELD CONDITIONS.
- ALL TRAFFIC CONTROL DEVICES ON THIS PROJECT SHALL COMPLY WITH PART VI OF THE MUTCD (LATEST EDITION).
- REMOVAL OF RAISED PAVEMENT MARKERS THAT ARE IN CONFLICT WITH REQUIRED CONSTRUCTION IS NOT CONSIDERED A SEPARATE PAY ITEM. COST TO BE ABSORBED INTO OTHER ITEMS BID.
- TEMPORARY STRIPING SHALL CONFORM TO FINISHED STRIPE SPECIFICATIONS FOR ALIGNMENT, NEATNESS, AND STRAIGHTNESS.
- BIDDERS ARE ADVISED THAT HARD COPIES OF ANY ADDENDA FOR THIS PROJECT WILL NO LONGER BE MAILED. ALL ADDENDA FOR THIS PROJECT WILL BE POSTED TO www.mdot.ms.gov UNDER THE PROPOSAL ADDENDA COLUMN. IT IS THE BIDDERS RESPONSIBILITY TO CHECK AND SEE IF ANY ADDENDA HAVE BEEN POSTED FOR THIS PROJECT. PLEASE CONTACT CONTRACT ADMINISTRATION DIVISION AT 601-359-7700 FOR ANY QUESTION REGARDING ELECTRONIC ADDENDA.

SEQUENCE OF OPERATIONS

- PERFORM PIPE REPLACEMENT/EXTENSIONS.
- REPAIR OF FAILED AREAS AS DIRECTED.
- FINE MILLING
- PLACEMENT OF SURFACE COURSE
- PLACEMENT OF TEMPORARY STRIPE.
- PLACEMENT OF PERMANENT STRIPE.

DISTRICT 1

PS & E PLANS-DATE 12/15/25		
FMS CON. 108911/301000		
REVISIONS		
DATE.	SHEET NO.	BY

PLAN SHEET

12/18/2025 10:34:13 AM SP-0042-01(012) PLANS.dgn