

SECTION 905 -- PROPOSAL (CONTINUED)

I (We) hereby certify by digital signature and electronic submission via Bid Express of the Section 905 proposal below, that all certifications, disclosures and affidavits incorporated herein are deemed to be duly executed in the aggregate, fully enforceable and binding upon delivery of the bid proposal. I (We) further acknowledge that this certification shall not extend to the bid bond or alternate security which must be separately executed for the benefit of the Commission. This signature does not cure deficiencies in any required certifications, disclosures and/or affidavits. I (We) also acknowledge the right of the Commission to require full and final execution on any certification, disclosure or affidavit contained in the proposal at the Commission's election upon award. Failure to so execute at the Commission's request within the time allowed in the Standard Specifications for execution of all contract documents will result in forfeiture of the bid bond or alternate security.

Bidder acknowledges receipt of and has added to and made a part of the proposal and contract documents the following addendum (addenda):

ADDENDUM NO. <u> 1 </u>	DATED <u> 5/12/2026 </u>	ADDENDUM NO. _____	DATED _____
ADDENDUM NO. _____	DATED _____	ADDENDUM NO. _____	DATED _____
ADDENDUM NO. _____	DATED _____	ADDENDUM NO. _____	DATED _____

Number	Description
1	Revised NTB No. 7924; Amendment EBSx Download Required.

TOTAL ADDENDA: 1
(Must agree with total addenda issued prior to opening of bids)

Respectfully Submitted,

DATE _____

Contractor

BY _____
Signature

TITLE _____

ADDRESS _____

CITY, STATE, ZIP _____

PHONE _____

FAX _____

E-MAIL _____

(To be filled in if a corporation)

Our corporation is chartered under the Laws of the State of _____ and the names, titles and business addresses of the executives are as follows:

_____ President	_____ Address
_____ Secretary	_____ Address
_____ Treasurer	_____ Address

The following is my (our) itemized proposal.
STBG-9999-02(384)/ 108781302000
Panola County(ies)

Revised 01/26/2016

MISSISSIPPI DEPARTMENT OF TRANSPORTATION

SECTION 904 -NOTICE TO BIDDERS NO. 7924

CODE: (SP)

DATE: 05/12/2026

SUBJECT: Scope of Work

PROJECT: STBG-9999-02(384) / 108781302 – Panola County

The contract documents do not include an official set of construction plans but may, by reference, include some Standard Drawings when so specified in a Notice to Bidders entitled, "Attached Drawings".

Minor changes in detail of design or construction procedure may be authorized by the Director of Structures, State Bridge Engineer provided such changes will not be cause for contract price adjustment. Work for which no pay item is provided will not be paid for directly and shall therefore be considered an absorbed item of work.

It shall be the responsibility of the Contractor to protect existing structures from damage which might occur during construction. The Contractor shall replace or repair, as directed by the Director of Structures, State Bridge Engineer, any structures damaged during the life of the contract. No payment will be made for replacement or repair of damaged items.

All details are based on the dimensions shown on the original plans for the existing structure. The Contractor shall be responsible for adjusting the elements of the new construction to ensure a proper fit with the existing structure. The Contractor shall verify all dimensions of the existing structure prior to beginning work.

During construction, care shall be exercised to ensure that no debris falls into the roadway crossing below the structures. All debris, including any material that has accumulated on the bridge caps, shall become the property of the Contractor and shall be removed from the construction site.

Any areas disturbed by the Contractor shall be stabilized by the end of the Project at no additional cost to the State.

Work on the project shall consist of the following repairs to bridge numbers 237.3A (13691) and 237.3B (13692) located on I-55 over Hentz Road in Panola County.

Scope of Work – Bridge 237.3A (13691)

- Remove and replace bearings in accordance with the Attached Drawings.
- Remove existing joint material and replace with preformed joint seal at all joints
- Epoxy repair damage to prestressed beams and other locations specified in the Attached Drawings

- Repair the top of end wall in accordance with the Attached Drawings
- Underseal end bent caps and approach pavement
- Clean all caps

Scope of Work – Bridge 237.3B (13692)

- Remove and replace bearings in accordance with the Attached Drawings.
- Remove existing joint material and replace with preformed joint seal at all joints
- Epoxy repair damage to prestressed beams and other locations specified in the Attached Drawings
- Repair the top of end wall in accordance with the Attached Drawings
- Underseal end bent caps and approach pavement
- Clean all caps

Joint & Endwall Removal and Replacement

Removal and replacement of the concrete endwall shall be performed at all End Bents per Attached Drawings and shall be paid for under Pay Item No. 907-824-PP008: Bridge Repair, Endwall Repair, Per Plans. After the endwall has been replaced and existing joint material removed, the ¼” seats shall be formed by saw cuts as shown in the Attached Drawings. Saw cuts required shall be paid for under Pay Item No. 907-823-B001: Saw Cut, Type I. Existing joint material shall be replaced with preformed joint seal in accordance with Special Provision 907-823. The joints shall be sealed by one of the three approved Manufacturers listed in Special Provision 907-823 and installed according to the Manufacturer’s specifications. All new preformed joints shall be paid for under Pay Items No. 907-808-A002 Joint Repair and No. 907-823-A001: Preformed Joint Seal, Type I.

Cap Cleaning and Bridge Deck Cleaning:

Cap Cleaning shall be done in accordance with Special Provision Subsection 907-824.03.3. This item of work shall be paid for under Pay Item No. 907-824-C001, Cap Cleaning. The bridge deck and gutters shall be swept clean upon completion of the Project. This shall be considered an absorbed item of work.

Bearing Replacements:

Bearings at Bridges 13691 & 13692 shall be replaced in accordance with Special Provision Subsection 907-824.03.4 and the Attached Drawings. Payment for this work shall be made under Pay Item No. 907-824-D002, Bearing Replacements, Prestressed Concrete Girder.

In no case shall laminated pads be field cut. Bearing area on top of cap shall be cast smooth and true to grade. Steel plates in laminated pads shall conform to ASTM A 1011 Grade 36, Type 1. The testing acceptance procedure shall be in accordance with section 714.10.6 of the Specifications. Elastomer shall have a hardness of 50 durometer with a minimum shear modulus at 73°F of 0.095 k.s.i. and a maximum shear modulus at 73°F of 0.130 k.s.i

General Epoxy Repairs:

Locations for General Epoxy Repair can be found in the Attached Drawings. General Epoxy

Repair shall be done in accordance with Special Provision Subsection 907-824.03.1 and with the approved materials outlined in Special Provision Subsection 907-824.02.1. All work and material required to perform this item of work shall be paid for under Pay Item No. 907-824-A003, General Epoxy Repair. It should be noted that hammers used for concrete removal should be limited to 15 lbs. for prestressed beams and 30 lbs. for all other epoxy repairs.

This item shall be bid such that this item may be increased, decreased, or eliminated as directed by the Project Engineer.

Undersealing:

Voids under end bent caps and approach pavement on both bridges are to be filled with injectable urethane compound material meeting the required properties outlined in Special Provision Section 907-420.02.

Prior to injection, the site shall be prepared according to Manufacturer's recommendations. Urethane compound shall be installed in strict accordance with Manufacturer's instructions.

All costs associated with filling voids underneath and behind end bent caps with urethane compound shall be included in the price for Pay Item 907-420-A001, Undersealing.

The accepted quantities will be paid for per pound of urethane compound material as reported on packaging.

Contractor Submittals:

Prior to any construction or fabrication, the Contractor shall comply with the following submittal requirements.

Field Verification Submittal:

All dimensions of the existing structure and clearances shall be field verified by the Contractor. The Contractor shall be responsible for adjusting the elements of the new construction to ensure proper fit with the existing structure. The Contractor shall submit field verification of the existing bridge elements associated with the work items described herein. This shall include, but is not limited to:

- a. Finish grades of existing bridge
- b. Existing open joint widths
- c. Existing bearing and cap dimensions
- d. Any other element that will affect the work items described herein

Bearing Pad Shop Drawing Submittal:

The Contractor shall submit shop drawings of the new bearing pads for approval by the Director of Structures, State Bridge Engineer. Shop drawings shall not be approved without the corresponding field verification submittal outlined above.

Jacking Plan Submittal:

The Contractor shall submit a set of bracing and jacking arrangement plans along

with design calculations and all assumptions. The Contractor shall employ the service of a Mississippi registered Professional Engineer knowledgeable in the field of bridge design. The submitted plans shall bear the seal of the Professional Engineer.

Special Provisions:

907-420: Undersealing

907-808: Joint Repair

907-823: Preformed Joint Seal

907-824: Routine Bridge Repair

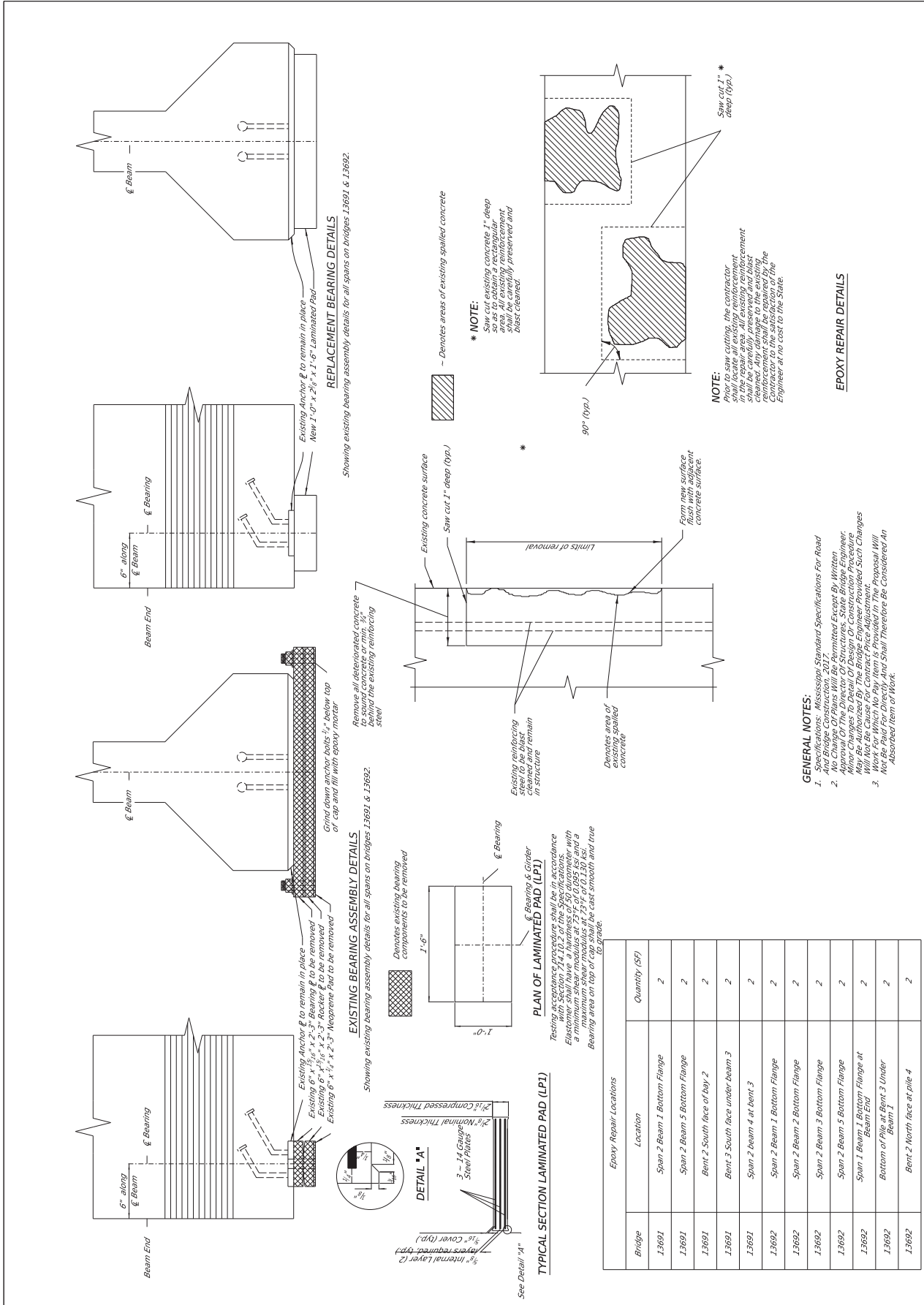

NOTES ON ASSOCIATED ITEMS OF WORK:

907-823-PP008 BRIDGE REPAIR, ENDWALL REPAIR, PER PLANS

Description: Shall include the Work Necessary To Remove And Replace The Damaged Endwall, As Designated In The Detail Drawings Provided. Instead Of Limiting The Repair To The Damaged Section, The Specified Depth Of Endwall Shall Be Removed Along The Entire Width Of The Bridge Deck.

Basis Of Payment: The Accepted Quantities Will Be Paid For In Linear Feet At The Contract Unit Price Along The Length Of The Centerline Joint.

Designs Called To Attention Of The Structure Of Retaining Walls, Computing The Volume Of Concrete To Be Repaired By The Contractor For The Bridge Deck. The Repair Work Shall Be Done In Accordance With The Specifications For Repairing Concrete Structures. The Contractor Shall Be Responsible For Computing The Quantity Of Concrete To Be Repaired. The Contractor Shall Be Responsible For Computing The Quantity Of Concrete To Be Repaired. The Contractor Shall Be Responsible For Computing The Quantity Of Concrete To Be Repaired.

New Concrete Shall Be High Early Strength Bridge Concrete, As Follows:
The concrete mixture design shall be furnished by the Contractor for approval. The concrete shall be placed and finished in accordance with the following:
- Total Air Content: 3-6%
- Retarders: None
- Non-chloride based accelerator may be used if the ambient temperature is 50°F or less, but shall not be used if the ambient temperature is greater than 50°F.

Manufacturer from MCO's Approved Products List, and the manufacturer's curing time to be continuous until 2500 psi is reached. Traffic is to be diverted from the repair area until this value is reached. The Contractor may use the final acceptance of the in-place concrete shall be determined using right concrete placement. Two cylinders are to be tested at 8, 16, and 24 hour intervals. The two remaining cylinders shall be used to determine the 28-day concrete.

907-808-4062 JOINT REPAIR
Description: Shall include The Work Necessary To Repair Joints In Preparation For The Placement Of New Expansion Material. Of Existing Silicone Seals, Compression, AC Sealed Joint Materials, and Armored Joint Materials Will Not Be Paid For Directly. Removal of joint materials and any trash and debris (including but not limited to compacted dirt, vegetation and trash) located at any depth Requirements Shall Be In Accordance With The Applicable Provisions Of Section 809 Of The Specifications And Any Other Sections Specified Therein.

Basis Of Payment: The Accepted Quantities Will Be Paid For In Linear Feet At Each Side Of The Centerline Joint.
907-823-B001 SAW CUT, TYPE I
Description: The Saw Cut Depth Shall Be Equivalent To The Installation Depth Required By The Manufacturer's Specifications. The Saw Cut Type Shall Be The Same As The Preliminary Joint Seal Selected.

Basis Of Payment: The Accepted Quantities Will Be Paid For In Linear Feet At Each Side Of The Centerline Joint. The Contractor Shall Be Responsible For Ensuring That The Proper Seal Is Selected Based On The Manufacturer's Recommendations.

907-823-A001 PREFORMED JOINT SEAL, TYPE I
Description: Shall include The Manufacturer's Required Joint Preparation Including Sandblasting Both Sides Of The Joint And Blowing The Joint Free Of Compressed Air And Placement Of The New Preformed Joint Seal.

Basis Of Payment: The Accepted Quantities Will Be Paid For In Linear Feet At Each Side Of The Centerline Joint. The Contractor Shall Be Responsible For Ensuring That The Proper Seal Is Selected Based On The Manufacturer's Recommendations.

907-823-A002 PREFORMED JOINT SEAL, TYPE II
Description: Shall include The Manufacturer's Required Joint Preparation Including Sandblasting Both Sides Of The Joint And Blowing The Joint Free Of Compressed Air And Placement Of The New Preformed Joint Seal.

Basis Of Payment: The Accepted Quantities Will Be Paid For In Linear Feet At Each Side Of The Centerline Joint. The Contractor Shall Be Responsible For Ensuring That The Proper Seal Is Selected Based On The Manufacturer's Recommendations.

907-823-A003 PREFORMED JOINT SEAL, TYPE III
Description: Shall include The Manufacturer's Required Joint Preparation Including Sandblasting Both Sides Of The Joint And Blowing The Joint Free Of Compressed Air And Placement Of The New Preformed Joint Seal.

Basis Of Payment: The Accepted Quantities Will Be Paid For In Linear Feet At Each Side Of The Centerline Joint. The Contractor Shall Be Responsible For Ensuring That The Proper Seal Is Selected Based On The Manufacturer's Recommendations.

907-823-A004 PREFORMED JOINT SEAL, TYPE IV
Description: Shall include The Manufacturer's Required Joint Preparation Including Sandblasting Both Sides Of The Joint And Blowing The Joint Free Of Compressed Air And Placement Of The New Preformed Joint Seal.

Basis Of Payment: The Accepted Quantities Will Be Paid For In Linear Feet At Each Side Of The Centerline Joint. The Contractor Shall Be Responsible For Ensuring That The Proper Seal Is Selected Based On The Manufacturer's Recommendations.

907-823-A005 PREFORMED JOINT SEAL, TYPE V
Description: Shall include The Manufacturer's Required Joint Preparation Including Sandblasting Both Sides Of The Joint And Blowing The Joint Free Of Compressed Air And Placement Of The New Preformed Joint Seal.

Basis Of Payment: The Accepted Quantities Will Be Paid For In Linear Feet At Each Side Of The Centerline Joint. The Contractor Shall Be Responsible For Ensuring That The Proper Seal Is Selected Based On The Manufacturer's Recommendations.

907-823-A006 PREFORMED JOINT SEAL, TYPE VI
Description: Shall include The Manufacturer's Required Joint Preparation Including Sandblasting Both Sides Of The Joint And Blowing The Joint Free Of Compressed Air And Placement Of The New Preformed Joint Seal.

Basis Of Payment: The Accepted Quantities Will Be Paid For In Linear Feet At Each Side Of The Centerline Joint. The Contractor Shall Be Responsible For Ensuring That The Proper Seal Is Selected Based On The Manufacturer's Recommendations.

907-823-A007 PREFORMED JOINT SEAL, TYPE VII
Description: Shall include The Manufacturer's Required Joint Preparation Including Sandblasting Both Sides Of The Joint And Blowing The Joint Free Of Compressed Air And Placement Of The New Preformed Joint Seal.

Basis Of Payment: The Accepted Quantities Will Be Paid For In Linear Feet At Each Side Of The Centerline Joint. The Contractor Shall Be Responsible For Ensuring That The Proper Seal Is Selected Based On The Manufacturer's Recommendations.

907-823-A008 PREFORMED JOINT SEAL, TYPE VIII
Description: Shall include The Manufacturer's Required Joint Preparation Including Sandblasting Both Sides Of The Joint And Blowing The Joint Free Of Compressed Air And Placement Of The New Preformed Joint Seal.

Basis Of Payment: The Accepted Quantities Will Be Paid For In Linear Feet At Each Side Of The Centerline Joint. The Contractor Shall Be Responsible For Ensuring That The Proper Seal Is Selected Based On The Manufacturer's Recommendations.

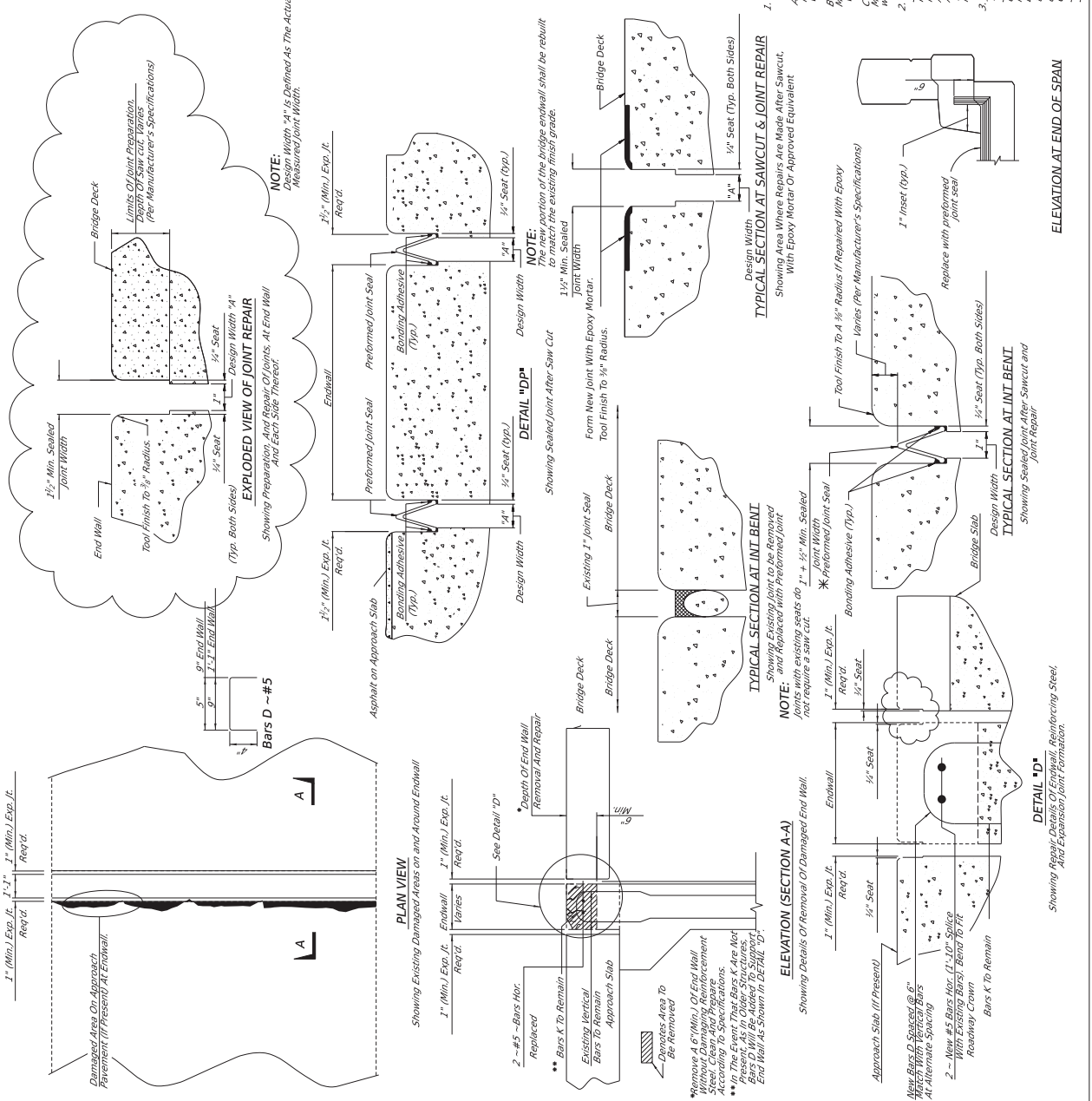

Notes on associated items of work, including descriptions of repair work, basis of payment, and material specifications.

Notes on associated items of work, including descriptions of repair work, basis of payment, and material specifications.

Notes on associated items of work, including descriptions of repair work, basis of payment, and material specifications.

Notes on associated items of work, including descriptions of repair work, basis of payment, and material specifications.

Notes on associated items of work, including descriptions of repair work, basis of payment, and material specifications.

Notes on associated items of work, including descriptions of repair work, basis of payment, and material specifications.

Notes on associated items of work, including descriptions of repair work, basis of payment, and material specifications.

Notes on associated items of work, including descriptions of repair work, basis of payment, and material specifications.

Notes on associated items of work, including descriptions of repair work, basis of payment, and material specifications.

Notes on associated items of work, including descriptions of repair work, basis of payment, and material specifications.

Notes on associated items of work, including descriptions of repair work, basis of payment, and material specifications.

Notes on associated items of work, including descriptions of repair work, basis of payment, and material specifications.

Notes on associated items of work, including descriptions of repair work, basis of payment, and material specifications.

Notes on associated items of work, including descriptions of repair work, basis of payment, and material specifications.

Notes on associated items of work, including descriptions of repair work, basis of payment, and material specifications.

Notes on associated items of work, including descriptions of repair work, basis of payment, and material specifications.

Notes on associated items of work, including descriptions of repair work, basis of payment, and material specifications.

Notes on associated items of work, including descriptions of repair work, basis of payment, and material specifications.

Notes on associated items of work, including descriptions of repair work, basis of payment, and material specifications.

Notes on associated items of work, including descriptions of repair work, basis of payment, and material specifications.

Notes on associated items of work, including descriptions of repair work, basis of payment, and material specifications.

Notes on associated items of work, including descriptions of repair work, basis of payment, and material specifications.

Notes on associated items of work, including descriptions of repair work, basis of payment, and material specifications.

Notes on associated items of work, including descriptions of repair work, basis of payment, and material specifications.

Notes on associated items of work, including descriptions of repair work, basis of payment, and material specifications.

Notes on associated items of work, including descriptions of repair work, basis of payment, and material specifications.

Notes on associated items of work, including descriptions of repair work, basis of payment, and material specifications.

Notes on associated items of work, including descriptions of repair work, basis of payment, and material specifications.

Notes on associated items of work, including descriptions of repair work, basis of payment, and material specifications.

Notes on associated items of work, including descriptions of repair work, basis of payment, and material specifications.

Notes on associated items of work, including descriptions of repair work, basis of payment, and material specifications.

Notes on associated items of work, including descriptions of repair work, basis of payment, and material specifications.

Notes on associated items of work, including descriptions of repair work, basis of payment, and material specifications.

Notes on associated items of work, including descriptions of repair work, basis of payment, and material specifications.

Notes on associated items of work, including descriptions of repair work, basis of payment, and material specifications.

Notes on associated items of work, including descriptions of repair work, basis of payment, and material specifications.

Notes on associated items of work, including descriptions of repair work, basis of payment, and material specifications.

Notes on associated items of work, including descriptions of repair work, basis of payment, and material specifications.

Notes on associated items of work, including descriptions of repair work, basis of payment, and material specifications.



DESIGNED BY: _____
 CHECKED BY: _____
 DATE: _____

FMS CON: 10871/302000
 PROJECT NO.: STBG-9999-07284
 COUNTY: PANOLA

Notice to Bidders No. 7924

SHEET NO. 5
 SHEET ID E01

SIGNS REQUIRED

SIGN NO.	SIZE	UNIT AREA SQ. FT.	TOTAL SIGN REQU'D. AREA P.T.	REMARKS
G20-1	60" X 24"	10.00	6	ROAD WORK NEXT XX MILES
G20-2	48" X 24"	8.00	4	END ROAD WORK
G20-4	36" X 18"	4.50	6	PILOT CAR FOLLOW DUE
M1-1	24" X 24"	4.00	1 OR 2	1 OR 2 DIGIT
M1-1	30" X 24"	5.00	3	3 DIGIT
M1-4	24" X 24"	4.00	1 OR 2	1 OR 2 DIGIT
M1-4	30" X 24"	5.00	3	3 DIGIT
M1-5	30" X 24"	5.00	3	3 DIGIT
M3-1	24" X 15"	3.13	2.00	NORTH-1 OR 2 DIGIT ROUTE MARKER
M3-1	30" X 15"	3.13	2.00	NORTH-1 OR 2 DIGIT ROUTE MARKER
M3-2	24" X 12"	2.00	2.00	EAST-3 DIGIT ROUTE MARKER
M3-2	30" X 15"	3.13	2.00	EAST-3 DIGIT ROUTE MARKER
M3-3	24" X 12"	2.00	2.00	SOUTH-1 OR 2 DIGIT ROUTE MARKER
M3-3	30" X 15"	3.13	2.00	SOUTH-1 OR 2 DIGIT ROUTE MARKER
M3-4	24" X 12"	2.00	2.00	WEST-1 OR 2 DIGIT ROUTE MARKER
M3-4	30" X 15"	3.13	2.00	WEST-1 OR 2 DIGIT ROUTE MARKER
M3-4	30" X 15"	3.13	2.00	WEST-3 DIGIT ROUTE MARKER
M4-8	24" X 12"	2.00	2.00	DIGIT ROUTE MARKER
M4-8	30" X 15"	3.13	2.00	DIGIT ROUTE MARKER
M4-9	48" X 36"	12.00	4	DETOUR ↑
M4-9L	48" X 36"	12.00	4	DETOUR ←
M4-9BL	48" X 36"	12.00	4	DETOUR ↙
M4-9SL	48" X 36"	12.00	4	DETOUR ↘
M4-9BSL	48" X 36"	12.00	4	DETOUR ↗
M4-9BR	48" X 36"	12.00	4	DETOUR ↖
M4-9BSR	48" X 36"	12.00	4	DETOUR ↘
M4-10L	48" X 18"	6.00	6	DETOUR
M4-10R	48" X 18"	6.00	6	DETOUR
M4-5	24" X 12"	2.00	2.19	TO
M5-1R	21" X 15"	2.19	2.19	↑
M5-2L	21" X 15"	2.19	2.19	↓
M5-2R	21" X 15"	2.19	2.19	←
M6-1R	21" X 15"	2.19	2.19	→
M6-2L	21" X 15"	2.19	2.19	↖
M6-2R	21" X 15"	2.19	2.19	↗
M6-3	21" X 15"	2.19	2.19	↑

SIGNS REQUIRED

SIGN NO.	SIZE	UNIT AREA SQ. FT.	TOTAL SIGN REQU'D. AREA P.T.	REMARKS
R1-1	36" OCTAGON	7.46	1	STOP
R1-1	48" OCTAGON	13.25	2	STOP
R1-2	36" X 36" X 36"	3.90	2	YIELD
R1-2	48" X 48" X 48"	6.93	2	YIELD
R1-2	60" X 60" X 60"	10.83	3	3-WAY 4-WAY, ETC.
R1-3	18" X 9"	1.13	2.00	SPEED LIMIT
R1-3	24" X 12"	2.00	2.00	SPEED LIMIT
R2-1	24" X 30"	5.00	1	SPEED LIMIT
R2-1	36" X 48"	12.00	1	SPEED LIMIT
R2-1	48" X 60"	20.00	1	SPEED LIMIT
R3-1	36" X 36"	9.00	1	LEFT LANE MUST TURN LEFT
R3-1	48" X 48"	16.00	1	RIGHT LANE MUST TURN RIGHT
R3-2	36" X 36"	9.00	1	DO NOT PASS
R3-2	48" X 48"	16.00	1	DO NOT PASS
R3-4	36" X 36"	9.00	1	PASS WITH CARE
R3-4	48" X 48"	16.00	1	PASS WITH CARE
R3-5L	30" X 36"	7.50	1	ONE WAY
R3-5R	30" X 36"	7.50	1	ONE WAY
R3-6L	30" X 36"	7.50	1	ONE WAY
R3-6R	30" X 36"	7.50	1	ONE WAY
R3-7L	30" X 30"	6.25	1	ROAD CLOSED
R3-7R	30" X 30"	6.25	1	ROAD CLOSED
R4-1	24" X 30"	5.00	20.00	ROAD CLOSED
R4-1	48" X 60"	20.00	20.00	ROAD CLOSED
R4-2	24" X 30"	5.00	20.00	ROAD CLOSED
R4-2	48" X 60"	20.00	20.00	ROAD CLOSED
R4-7	48" X 60"	20.00	4	ROAD CLOSED
R4-8	48" X 60"	20.00	4	ROAD CLOSED
R5-1	48" X 48"	16.00	1	ROAD CLOSED
R5-1a	42" X 30"	8.75	1	ROAD CLOSED
R6-1L	36" X 12"	3.00	3.00	ROAD CLOSED
R6-1R	36" X 12"	3.00	3.00	ROAD CLOSED
R6-2L	24" X 30"	5.00	5.00	ROAD CLOSED
R6-2R	24" X 30"	5.00	5.00	ROAD CLOSED
R11-2	48" X 30"	10.00	4	ROAD CLOSED
R11-3a	60" X 30"	12.50	4	ROAD CLOSED
R11-3b	60" X 30"	12.50	4	ROAD CLOSED
R11-4	60" X 30"	12.50	4	ROAD CLOSED
R12-1	36" X 48"	12.00	4	ROAD CLOSED
R16-3	36" X 48"	12.00	4	ROAD CLOSED
R16-3	48" X 60"	20.00	4	ROAD CLOSED

SIGNS REQUIRED

SIGN NO.	SIZE	UNIT AREA SQ. FT.	TOTAL SIGN REQU'D. AREA P.T.	REMARKS
W1-1L	48" X 48"	16.00	4	ROAD CLOSED
W1-1R	48" X 48"	16.00	4	ROAD CLOSED
W1-2L	48" X 48"	16.00	4	ROAD CLOSED
W1-2R	48" X 48"	16.00	4	ROAD CLOSED
W1-3L	48" X 48"	16.00	4	ROAD CLOSED
W1-3R	48" X 48"	16.00	4	ROAD CLOSED
W1-4L	48" X 48"	16.00	4	ROAD CLOSED
W1-4R	48" X 48"	16.00	4	ROAD CLOSED
W1-5L	48" X 48"	16.00	4	ROAD CLOSED
W1-5R	48" X 48"	16.00	4	ROAD CLOSED
W1-6L	48" X 24"	9.00	4	ROAD CLOSED
W1-6L	60" X 30"	12.50	4	ROAD CLOSED
W1-6R	48" X 24"	9.00	4	ROAD CLOSED
W1-6R	60" X 30"	12.50	4	ROAD CLOSED
W1-7	48" X 24"	9.00	4	ROAD CLOSED
W1-7	60" X 30"	12.50	4	ROAD CLOSED
W1-8L	18" X 24"	3.00	4	ROAD CLOSED
W1-8L	36" X 48"	12.00	4	ROAD CLOSED
W1-8R	18" X 24"	3.00	4	ROAD CLOSED
W1-8R	36" X 48"	12.00	4	ROAD CLOSED
W1-9L	48" X 48"	16.00	4	ROAD CLOSED
W1-9L	48" X 48"	16.00	4	ROAD CLOSED
W2-6	36" X 36"	9.00	4	ROAD CLOSED
W3-2a	48" X 48"	16.00	4	ROAD CLOSED
W3-2a	48" X 48"	16.00	4	ROAD CLOSED
W3-3	48" X 48"	16.00	4	ROAD CLOSED
W3-5	48" X 48"	16.00	4	ROAD CLOSED
W4-1L	48" X 48"	16.00	4	ROAD CLOSED
W4-1R	48" X 48"	16.00	4	ROAD CLOSED
W4-2L	48" X 48"	16.00	4	ROAD CLOSED
W4-2R	48" X 48"	16.00	4	ROAD CLOSED
W4-3L	48" X 48"	16.00	4	ROAD CLOSED
W4-3R	48" X 48"	16.00	4	ROAD CLOSED
W4-6	48" X 48"	16.00	4	ROAD CLOSED
W5-1a	48" X 48"	16.00	4	ROAD CLOSED
W6-1	48" X 48"	16.00	4	ROAD CLOSED
W6-2	48" X 48"	16.00	4	ROAD CLOSED
W6-3	48" X 48"	16.00	4	ROAD CLOSED
W8-1	48" X 48"	16.00	4	ROAD CLOSED
W8-4	48" X 48"	16.00	4	ROAD CLOSED
W8-6	48" X 48"	16.00	4	ROAD CLOSED

SIGNS REQUIRED

SIGN NO.	SIZE	UNIT AREA SQ. FT.	TOTAL SIGN REQU'D. AREA P.T.	REMARKS
W8-7	48" X 48"	16.00	4	ROAD CLOSED
W8-9	48" X 48"	16.00	4	ROAD CLOSED
W8-11	36" X 36"	9.00	4	ROAD CLOSED
W8-12	48" X 48"	16.00	4	ROAD CLOSED
W10-1	36" DIA.	7.07	4	ROAD CLOSED
W10-1	24" X 24"	4.00	4	ROAD CLOSED
W14-3	36" X 48" X 48"	5.56	4	ROAD CLOSED
W14-3	48" X 64" X 64"	9.89	4	ROAD CLOSED
W16-2	24" X 18"	3.00	4	ROAD CLOSED
W19-2	48" X 48"	16.00	4	ROAD CLOSED
W20-1	48" X 48"	16.00	8	ROAD CLOSED
W20-1	36" X 36"	9.00	8	ROAD CLOSED
W20-2	48" X 48"	16.00	4	ROAD CLOSED
W20-3	48" X 48"	16.00	4	ROAD CLOSED
W20-4	48" X 48"	16.00	4	ROAD CLOSED
W20-4b	48" X 48"	16.00	4	ROAD CLOSED
W20-5L	48" X 48"	16.00	4	ROAD CLOSED
W20-5R	48" X 48"	16.00	4	ROAD CLOSED
W20-7a	48" X 48"	16.00	4	ROAD CLOSED
W21-1	36" X 36"	9.00	4	ROAD CLOSED
W21-1a	36" X 36"	9.00	4	ROAD CLOSED
W21-2	36" X 36"	9.00	4	ROAD CLOSED
W21-3	48" X 48"	16.00	4	ROAD CLOSED
W21-5	48" X 48"	16.00	4	ROAD CLOSED
W21-6	36" X 36"	9.00	4	ROAD CLOSED
W24-1L	48" X 48"	16.00	4	ROAD CLOSED
W24-1R	48" X 48"	16.00	4	ROAD CLOSED
W24-1aR	48" X 48"	16.00	4	ROAD CLOSED
W24-1bL	48" X 48"	16.00	4	ROAD CLOSED
W24-1bR	48" X 48"	16.00	4	ROAD CLOSED
VP-1L	12" X 36"	3.00	4	ROAD CLOSED
VP-1R	12" X 36"	3.00	4	ROAD CLOSED
OM-3L	12" X 36"	3.00	4	ROAD CLOSED
OM-3R	12" X 36"	3.00	4	ROAD CLOSED
TOTAL SIGN AREA LESS THAN 10 SQ. FT.				48 SQ. FT.
TOTAL SIGN AREA GREATER THAN 10 SQ. FT.				128 SQ. FT.

NOTES

- STANDARD
- SPECIAL (USE WHERE WARRANTED)
- INTERSTATE ROUTE MARKER
- UNITED STATES ROUTE MARKER
- STATE ROUTE MARKER
- COLORS OF CARDINAL DIRECTION MARKERS AND DIRECTIONAL ROUTE MARKERS.
- BLACK STRIPES ON YELLOW BACKGROUND
- INTERSTATE USE ONLY
- TOP OF SIGN - BLACK LETTERING ON ORANGE BACKGROUND.
- BOTTOM OF SIGN - BLACK LETTERING ON WHITE BACKGROUND.
- THE BACKGROUND OF ALL WARNING SIGNS ("W" SERIES) EXCEPT W10-1 SHALL BE ORANGE. THE W10-1 BACKGROUND SHALL BE YELLOW IN ALL CASES.

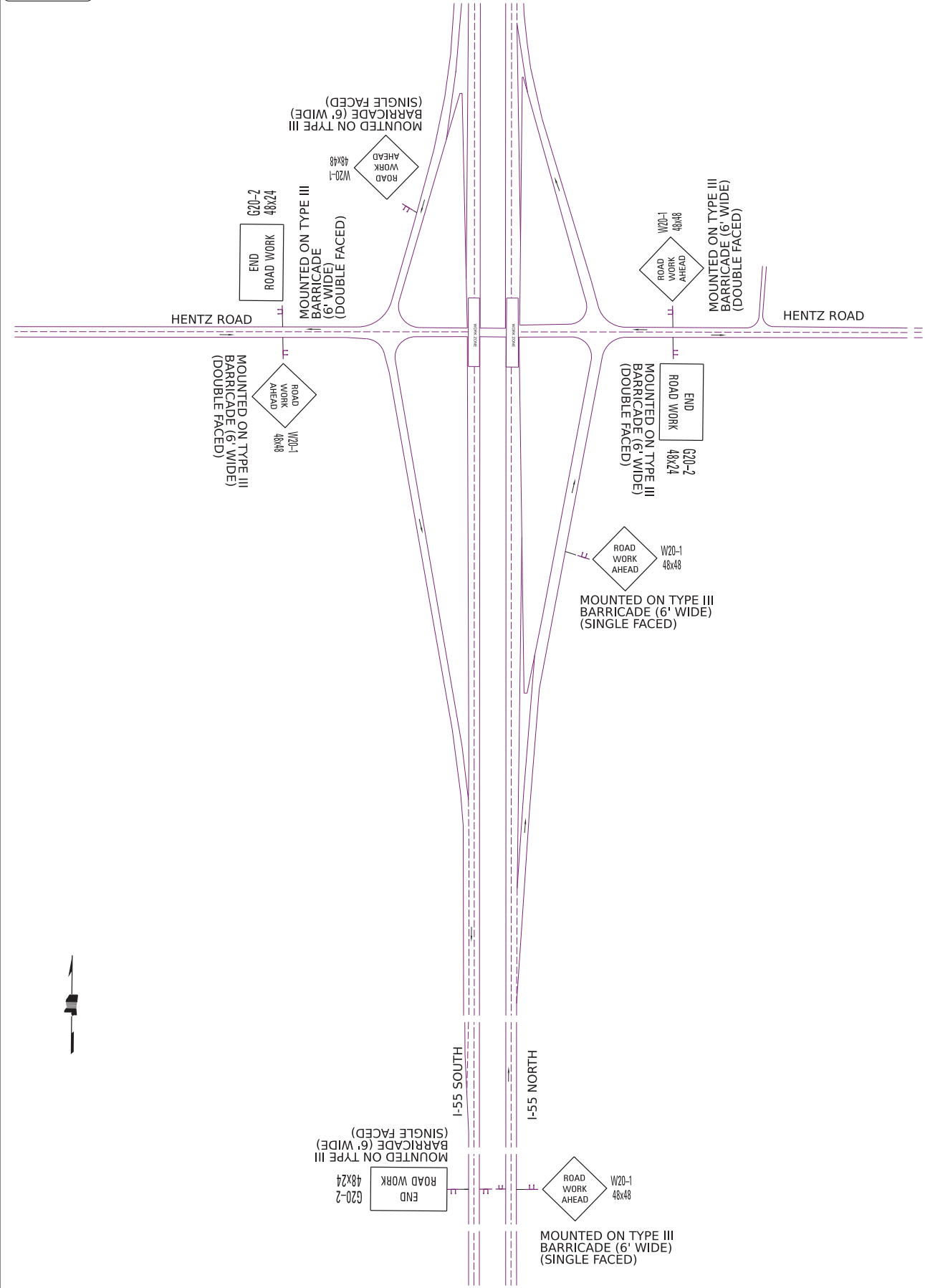



MISSISSIPPI DEPARTMENT OF TRANSPORTATION

DESIGNED BY:

DETAILED BY:

CHECKED BY:

DATE:

FMS CON: 108781/302000

PROJECT NO.: STBG-9999-20-2(2A)

COUNTY: PANOLA

Notice to Bidders No. 7924 - Con

SHEET ID
DCS-1 (SHEET)

SHEET NO.



MOUNTED ON TYPE III
BARRICADE (6' WIDE)
(SINGLE FACED)

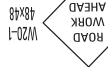

END ROAD WORK
G20-2
48x24

MOUNTED ON TYPE III
BARRICADE (6' WIDE)
(SINGLE FACED)

I-55 SOUTH

I-55 NORTH