

GENERAL INDEX

INCLUDED THIS PROJECT	BEGIN WITH SHEET
<input checked="" type="checkbox"/> ROADWAY.....	1
<input type="checkbox"/> PERMANENT SIGNS.....	1001
<input type="checkbox"/> TRAFFIC SIGNALS.....	2001
<input type="checkbox"/> ITS COMPONENTS.....	3001
<input type="checkbox"/> LIGHTING.....	4001
<input type="checkbox"/> (RESERVED).....	5001
<input checked="" type="checkbox"/> ROADWAY STD. DWGS.....	6001
<input checked="" type="checkbox"/> BOX CULVERT STD. DWGS (LRFD).....	7001
<input type="checkbox"/> BOX CULVERT STD. DWGS (STD. SPEC.)....	7501
<input type="checkbox"/> BRIDGE.....	8001
<input checked="" type="checkbox"/> CROSS SECTIONS.....	9001

STATE OF MISSISSIPPI
MISSISSIPPI DEPARTMENT OF TRANSPORTATION
PLAN AND PROFILE OF
PROPOSED STATE HIGHWAY
FEDERAL AID PROJECT NO. STP-0022-01(089)

S.R. 15 OVER CYPRESS BRANCH
HARRISON COUNTY

FMS CONST: 108392/301000

B.O.P STA. 540+00

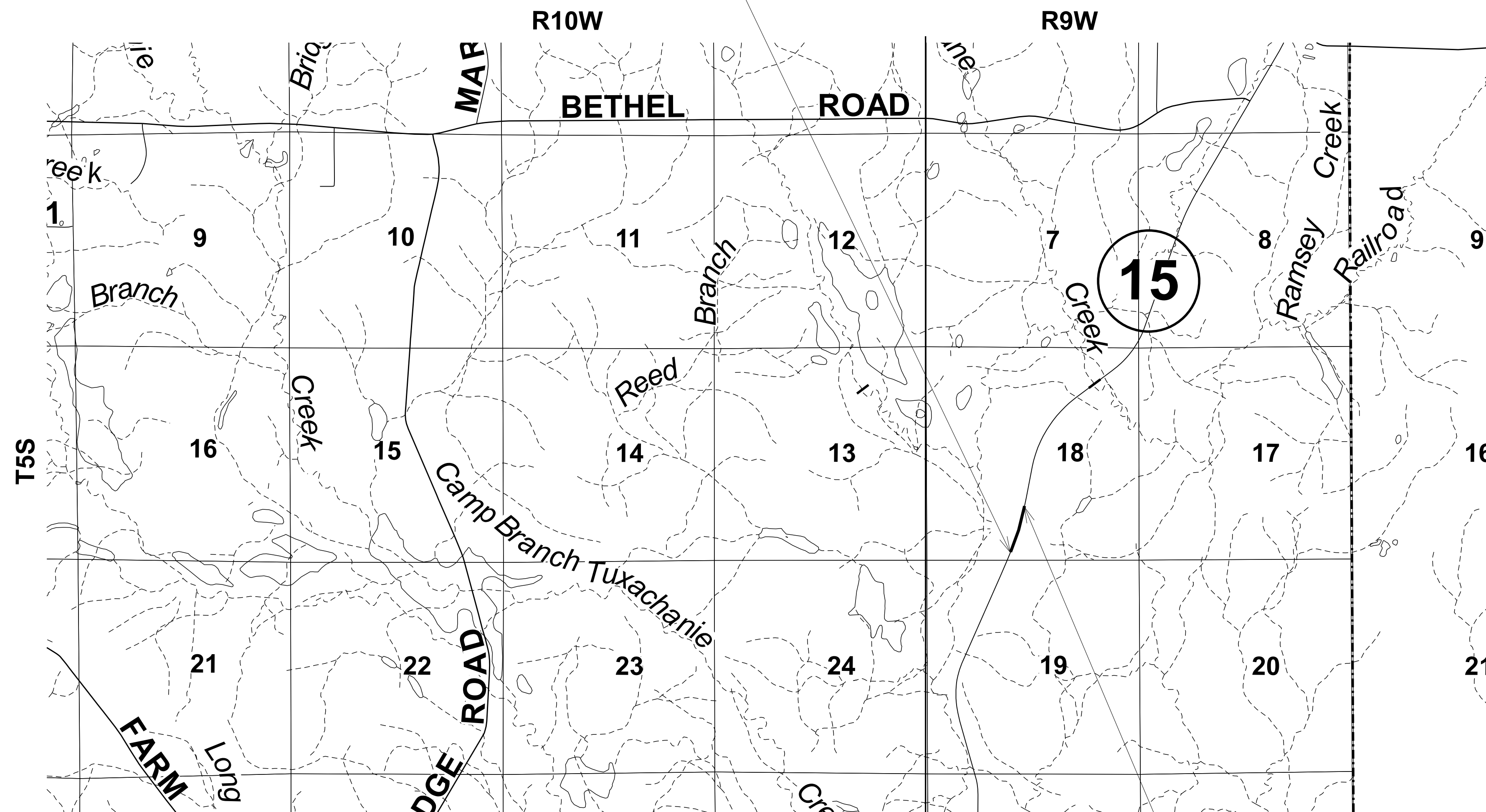

BOX BRIDGES REQ'D.
 BR.# 15.7 STA. 548+47.83
 152.5 L.F. DBL. 16'X8'

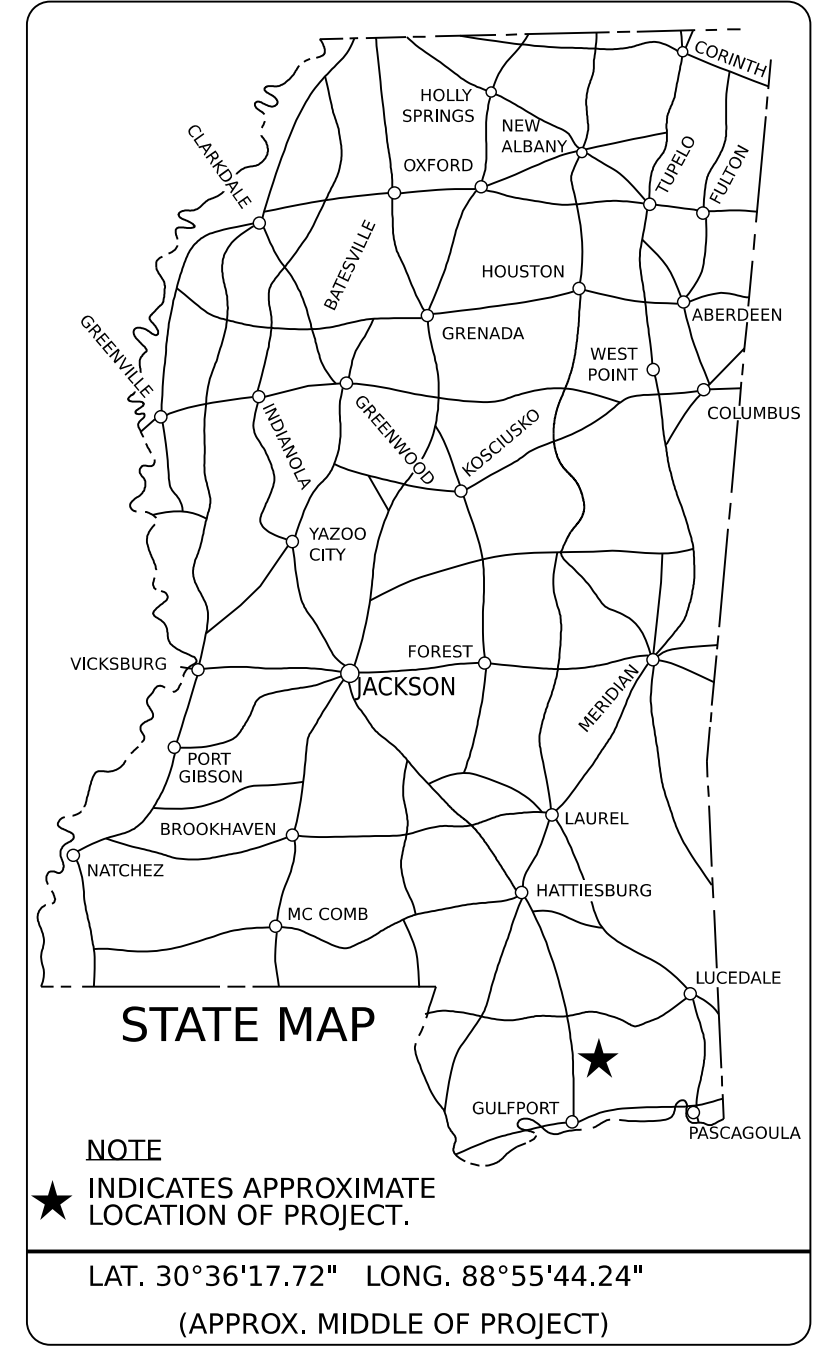

DESIGN CONTROL
 55 MPH = V (SPEED DESIGN)

ADT (2035) = 1680 : ADT (2045) = 2050
 DHV = 190 : D = 60 % T = 8 %

PERMITS ACQUIRED BY MDOT

WETLANDS AND WATERS PERMITS

	WATERS	WETLANDS
NATIONWIDE #14	<input type="checkbox"/> N	<input type="checkbox"/> Y
NATIONWIDE (OTHER)*	<input checked="" type="checkbox"/> Y	<input type="checkbox"/> Y
GENERAL*	<input type="checkbox"/> N	<input type="checkbox"/> N
INDIVIDUAL (404)*	<input type="checkbox"/> N	<input type="checkbox"/> N

STORMWATER PERMIT Y

Y REQUIRED, CNOI SUBMITTED BY MDOT (DISTURBED AREA=5 ACRES)

S REQUIRED, SCNOI TO BE SUBMITTED BY CONTRACTOR (1 TO 4.99 ACRES)

N NO STORMWATER PERMIT REQUIRED (<1 ACRE)

APPROVED BY: _____

CONVENTIONAL SYMBOLS

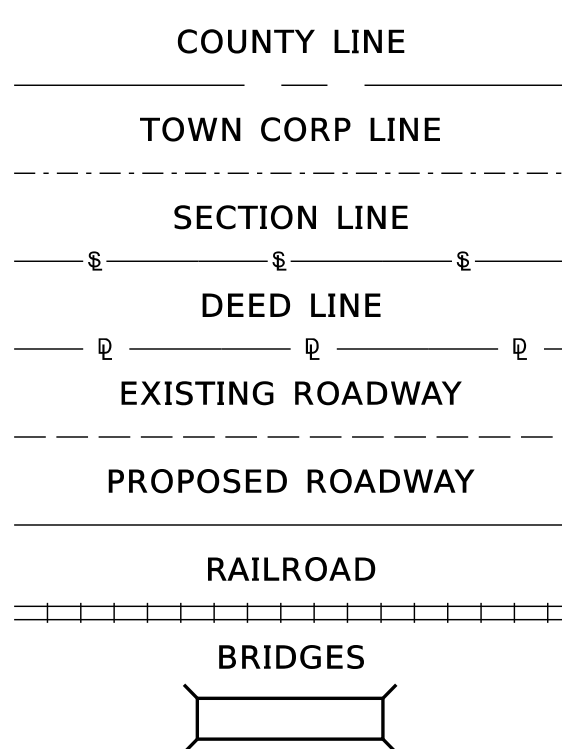

LENGTH DATA

LENGTH OF ROADWAY	1300	FT. 0.2462 MI.
LENGTH OF BRIDGES	0	FT. 0 MI.
LENGTH OF PROJECT (NET)	1300	FT. 0.2462 MI.
LENGTH OF EXCEPTIONS	0	FT. 0 MI.
LENGTH OF PROJECT (GROSS)	1300	FT. 0.2462 MI.

SCALES

PLAN	1 IN. = 50 FT.
PROFILE	{ HOR. 1 IN. = 50 FT.
LAYOUT	{ VERT. 1 IN. = 5 FT.
	1 IN. = 2,000 FT.

EQUATIONS
 NONE

EXCEPTIONS
 NONE

E.O.P STA. 564+00

PLAN SHEET

DATE 3:28:59 PM 1.TITLE.dgn

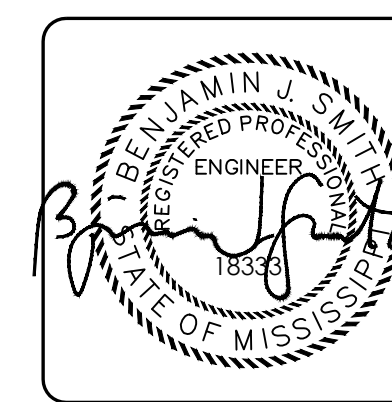

DESIGNED BY: BROWN, MITCHELL & ALEXANDER

CONSTRUCTION PROJECT DATA

EXTERNAL PROJECT NUMBER	STP-0022-01(089)
FMS & DETAIL	108392/301000

P S & E DATE: 04/24/2024

APPROVED:

DEPUTY EXECUTIVE DIRECTOR / CHIEF ENGINEER

EXECUTIVE DIRECTOR

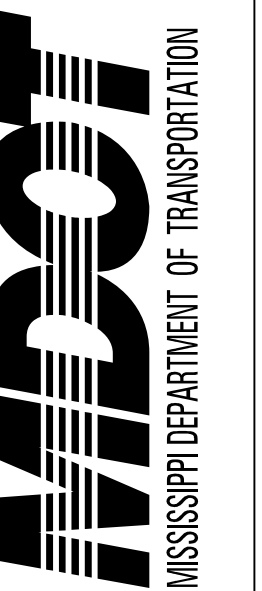
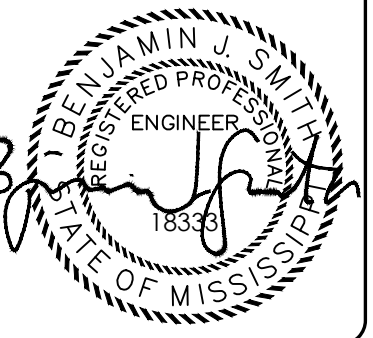

DESIGNED BY: BMA
 DETAILED BY:
 CHECKED BY:
 DATE: 04/24/24

FMS CON: 108392/301000
 PROJECT NO.: STP-0022-01(089)
 COUNTY: HARRISON

DETAILED INDEX

SHEET ID
DI-1
 SHEET NO.
2

DESCRIPTION OF SHEET WKG. NO. SH. NO.

TITLE SHEET (1)		1
DETAILED INDEX & GENERAL NOTES (2)		
DETAILED INDEX	DI-1	2
GENERAL NOTES	GN-1	3
TYPICAL SECTION SHEETS (2)		
TYPICAL SECTION - MAINLINE	TS-1	4
TYPICAL SECTION - DETOUR LEFT & DETOUR RIGHT	TS-2	5
QUANTITY SHEETS (8)		
SUMMARY OF QUANTITIES	SQ-1	6
SUMMARY OF QUANTITIES	SQ-2	7
ESTIMATED QUANTITIES FOR TRAFFIC CONTROL SIGNS	EQ-1	8
ESTIMATED QUANTITIES - TEMPORARY TRAFFIC CONTROL ITEMS, REMOVAL ITEMS & PERMANENT TRAFFIC CONTROL ITEMS	EQ-2	9
ESTIMATED QUANTITIES - ESTIMATED EARTHWORK	EQ-3	10
ESTIMATED QUANTITIES - ESTIMATED EARTHWORK	EQ-4	11
ESTIMATED QUANTITIES - EROSION CONTROL, TEMPORARY PIPE, & SUMMARY OF PAVEMENT MARKINGS	EQ-5	12
ESTIMATED QUANTITIES - BOX CULVERT & CULVERT HYDRAULIC DESIGN SUMMARY	EQ-6	13
CLEARING LIMITS SHEETS (1)		
CLEARING LIMITS	CL-1	14
PLAN & PROFILE SHEETS (3)		
S.R. 15 MAINLINE B.O.P. TO E.O.P.	3	15
S.R. 15 DETOUR LEFT	3-LT	16
S.R. 15 DETOUR RIGHT	3-RT	17
EROSION CONTROL SHEETS (3)		
EROSION CONTROL PLAN - MAINLINE	ECP-3	18
EROSION CONTROL PLAN - DETOUR LEFT	ECP-3-LT	19
EROSION CONTROL PLAN - DETOUR RIGHT	ECP-3-RT	20
CONSTRUCTION SIGNING (1)		
CONSTRUCTION SIGNING	CS-1	21
TRAFFIC CONTROL PLAN SHEETS (1)		
TRAFFIC CONTROL PLAN - S.R. 15	TCP-1	22
VEGETATION SCHEDULE (1)		
VEGETATION SCHEDULE	VS-1	23
STANDARD DRAWINGS - ROADWAY SHEETS (29)		
PAVEMENT MARKINGS		
PAVEMENT MARKING DETAILS FOR 2-LANE & 4-LANE DIVIDED ROADWAYS	PM-1	6051
RUMBLE STRIPES 2-LANE HIGHWAYS (ASPHALT LANES, 2-FT ASPHALT SHOULDERS)	RS-1	6064
EROSION CONTROL		
TYPICAL TEMPORARY EROSION CONTROL/SEDIMENT CONTROL APPLICATIONS	ECD-1	6101
DETAILS OF SEDIMENT BARRIER APPLICATIONS	ECD-2	6102
DETAILS OF SILT FENCE INSTALLATION	ECD-3	6103
DITCH CHECK STRUCTURES, TYPICAL APPLICATIONS AND DETAILS	ECD-4	6104
TEMPORARY EROSION, SEDIMENT AND WATER POLLUTION CONTROL MEASURES, SILT FENCE AND HAY BALE DITCH CHECKS	ECD-5	6105
DETAILS OF EROSION CONTROL WATTLE DITCH CHECK	ECD-6	6106
ROCK DITCH CHECK	ECD-8	6108
ROCK FILTER DAM	ECD-9	6109
ROCK DITCH CHECK WITH SUMP EXCAVATION AND ROCK FILTER DAM	ECD-10	6110

DESCRIPTION OF SHEET WKG. NO. SH. NO.

EROSION CONTROL (CONT.D)		
STABILIZED CONSTRUCTION ENTRANCE	ECD-16	6116
TEMPORARY STREAM DIVERSION	ECD-18	6118
TEMPORARY STREAM DIVERSION (BOX EXTENSIONS)	ECD-19	6119
DETAILS OF EROSION CONTROL SANDBAG DITCH CHECK	ECD-21	6121
DETAILS OF TYPICAL DITCH TREATMENTS	DT-1	6123
TYPICAL TEMPORARY EROSION CONTROL MEASURES (SLOPE DRAIN AND TYPE A SILT BASIN)	BAS-A	6125
SIGNING		
TYPICAL INSTALLATION AND DETAILS OF DELINEATORS AND DISTANCE REFERENCE SIGNS	SN-8	6314
TRAFFIC CONTROL PLAN		
TRAFFIC CONTROL PLAN WITH FLAGGER (ONE-LANE CLOSURE OF TWO-WAY TRAFFIC)	TCP-1	6351
HIGHWAY SIGN AND BARRICADE DETAILS FOR CONSTRUCTION PROJECTS	TCP-8	6358
TRAFFIC CONTROL PLAN MOBILE OPERATIONS MULTILANE ROADS AND TWO-LANE ROADS	TCP-9	6359
TRAFFIC CONTROL PLAN: UNEVEN PAVEMENT DETAILS	TCP-12	6362
TEMPORARY STRIPING FOR TRAFFIC CONTROL 2-LANE AND 4-LANE DIVIDED HIGHWAYS	TCP-13	6363
TRAFFIC CONTROL DETAILS DRUM PLACEMENT AND SHOULDER CLOSURE	TCP-16	6366
MISCELLANEOUS ROADWAY DETAILS		
TYPICAL GRADING TRANSITION BETWEEN CUTS & FILLS	GT-1	6404
SUPERELEVATION CASE 1 ROTATION ABOUT CENTERLINE	SE-2A	6408
SUPERELEVATION RUNOFF CASE 1 ROTATION ABOUT CENTERLINE	SE-3A	6413
MISCELLANEOUS DETAIL SHEET 1. STACKED PIPE JOINTS 2. EXCAVATION AT GRADE POINTS	MDS-1	6425
DRAINAGE		
FLEXIBLE PIPE CULVERT INSTALLATION	PI-2	6502
STANDARD DRAWINGS - LRFD BOX CULVERT SHEETS (8)		
BASIC CULVERT DRAWING - COLLAR LOCATIONS - NORMAL AND SKEWED CULVERTS GROUP I DIAGRAMS	IBJL-1	7005
COLLAR DETAILS FOR BOX STRUCTURES	ICJ-1	7008
BARREL DETAILS - DOUBLE CELL - HEIGHT 8 FT. - SPANS 16 - 32 FT. (SHEET 1 OF 3)	IBD-8	7118
BARREL DETAILS - DOUBLE CELL - HEIGHT 8 FT. - SPANS 16 - 32 FT. (SHEET 2 OF 3)	IBD-8	7119
BARREL DETAILS - DOUBLE CELL - HEIGHT 8 FT. - SPANS 16 - 32 FT. (SHEET 3 OF 3)	IBD-8	7120
WINGS WITH 3:1 SLOPE FOR BASIC CULVERT DRAWING - DOUBLE CELL	IWD-3W	7136
0° SKEW DETAILS - HEIGHT 8 FT. - SPANS 16 - 32 FT.		
WINGS WITH 3:1 SLOPE FOR BASIC CULVERT DRAWING - DOUBLE CELL	IWD-8-3W	7139
0° SKEW DETAILS - HEIGHT 8 FT. - SPANS 16 - 32 FT. (SHEET 1 OF 2)		
WINGS WITH 3:1 SLOPE FOR BASIC CULVERT DRAWING - DOUBLE CELL	IWD-8-3W	7140
0° SKEW DETAILS - HEIGHT 8 FT. - SPANS 16 - 32 FT. (SHEET 2 OF 2)		
CROSS SECTIONS (12)		
S.R. 15 - STA. 543+00 TO STA. 554+00 PHASE 1		9001 - 9004
S.R. 15 - STA. 543+00 TO STA. 554+00 PHASE 2		9005 - 9008
S.R. 15 - STA. 543+00 TO STA. 554+00 PHASE 3		9009 - 9012

PS & E PLANS-DATE 04/24/2024		
FMS CON. # 108392/301000		
REVISIONS		
DATE	SHEET NO.	BY
3/25/26	6,7	CN
4/22/26	6,7	CN
4/22/26	6051,6064,6351	
4/22/26	6358,6359,6362	
4/22/26	6366	

PLAN SHEET

4/22/2026 11:28:26 AM 2.Di.dgn

GENERAL NOTES

BRIDGES AND WALLS

- (1) STORAGE OF FLAMMABLE MATERIALS WILL NOT BE ALLOWED UNDER ANY BRIDGE STRUCTURES WITHOUT WRITTEN APPROVAL FROM THE PROJECT ENGINEER. SEE NOTICE TO BIDDERS ENTITLED "MATERIAL STORAGE UNDER BRIDGES" FOR MORE INFORMATION.

DRAINAGE STRUCTURES

- (2) ALL PIPE JOINTS ARE TO BE WRAPPED IN 24-INCH WIDE TYPE V GEOTEXTILE FABRIC. ALL PICKUP HOLES SHALL BE PLUGGED AND COVERED WITH TYPE V GEOTEXTILE FABRIC , THE COST OF WHICH SHALL BE ABSORBED IN OTHER ITEMS BID.
- (3) FULL COLLARS ARE TO BE USED AT ALL BOX CULVERT EXTENSIONS AND AT ALL BOX CULVERT CONSTRUCTION JOINTS. (SEE WK. NO. ICJ-1 FOR DETAILS)
- (4) THE CONTRACTOR SHALL BE RESPONSIBLE FOR PROTECTING EXISTING STRUCTURES SUCH AS, BUT NOT LIMITED TO, PIPES, INLETS, APRONS, AND BRIDGES FROM DAMAGE WHICH MIGHT OCCUR DURING CONSTRUCTION. THE CONTRACTOR SHALL REPLACE OR REPAIR, AS DIRECTED BY THE ENGINEER, ANY STRUCTURES DAMAGED DURING THE LIFE OF THE CONTRACT. NO PAYMENT WILL BE MADE FOR REPLACEMENT OR REPAIR OF DAMAGED ITEMS.

EARTHWORK

- (5) 25% SHRINKAGE FACTOR USED IN THE EARTHWORK CALCULATIONS IS FOR DESIGN ESTIMATING PURPOSES ONLY.
- (6) THE TOP THREE FEET AND VARIABLE OF THE DESIGN SOILS (BOTH NATURAL AND EMBANKMENT) SHALL BE CONSTRUCTED OF SOIL CLASSIFIED AS B7 OR BETTER, PER AASHTO DESIGNATION: M 145-91, EXCEPT AT UNDERCUT LOCATIONS DESIGNATED ON THE PLANS OR AS DIRECTED BY THE ENGINEER TO RECEIVE STONE. EXTREME CARE SHALL BE EXERCISED IN UNDERCUT AREAS, AND THE UNDERCUT DEPTH MAY BE ADJUSTED AT CROSS DRAINS AS DIRECTED BY THE ENGINEER. FOR ADDITIONAL DETAILS THE CONTRACTOR IS REFERRED TO THE NOTICE TO BIDDERS ON DESIGN SOIL MATERIAL IN THE CONTRACT PROPOSAL DOCUMENT.
- (7) VOIDS CREATED BY THE REMOVAL OF, BUT NOT LIMITED TO, POSTS, CONCRETE ANCHORS, AND FOOTINGS SHALL BE BACKFILLED AND TAMPED IN ACCORDANCE WITH SECTION 203 OF **THE MISSISSIPPI STANDARD SPECIFICATIONS FOR ROAD AND BRIDGE CONSTRUCTION** , THE COST OF WHICH WILL BE ABSORBED IN OTHER ITEMS BID.
- (8) WORK ON STRUCTURES FOR THIS PROJECT REQUIRES EXCAVATION IN THE IMMEDIATE VICINITY OF TRAFFIC AND ADJACENT PROPERTIES. THEREFORE, THE RISK OF A FAILURE OCCURRING DURING EXCAVATION REQUIRES THAT EXTREME CAUTION BE EXERCISED. THE CONTRACTOR SHALL BE RESPONSIBLE FOR PLACING WHAT BRACING, SHORING, OR GROUND SUPPORT SYSTEM THAT IS DEEMED NECESSARY TO PREVENT A FAILURE AND PROTECT THE PERSONS WORKING NEAR THE EXCAVATION, THE PUBLIC THAT MAY BE ABOVE THE EXCAVATION, OR ANY STRUCTURES ADJACENT TO THE EXCAVATION. ALL COSTS FOR DESIGNING, DRAWING, AND CONSTRUCTING THE FACILITY SHALL BE INCLUDED IN THE PRICE BID FOR CONTRACT ITEMS.
- (9) VEGETATIVE MATERIAL WILL BE REMOVED PRIOR TO PLACEMENT OF GRANULAR MATERIAL. THE COST OF WHICH SHALL BE ABSORBED IN OTHER ITEMS BID.
- (10) PRIOR TO EARTHWORK OPERATIONS, THE EXISTING TOP 4" TOPSOIL IS TO BE STRIPPED AND STOCKPILED. AFTER THE GRADING OPERATIONS ARE COMPLETED, SAID TOPSOIL SHALL BE PLACED ON ALL AREAS THAT ARE NOT TO BE PAVED OR OTHERWISE PROTECTED, IN ACCORDANCE WITH SECTION 211 OF THE SPECIFICATIONS, OR THE VEGETATION SCHEDULE (SEE WK. SH. VS-1). EXISTING TOPSOIL AND ALL COSTS ASSOCIATED WITH STRIPPING, HAULING, STOCKPILING, AND PLACEMENT OF THE EXISTING TOPSOIL IS TO BE ABSORBED IN OTHER EARTHWORK ITEMS.

ENVIRONMENTAL & CLEARING

- (11) NO TEMPORARY CULVERT STREAM CROSSINGS WILL BE ALLOWED.
- (12) CLEARING OF TREES WITHIN A WETLAND AREA SHALL NOT BE GRUBBED UNLESS NECESSARY FOR SHOWN DETOURS. AREAS SHALL BE CLEARED AND THEN STUMPS GROUND TO THE NATURAL GROUND LINE.

GENERAL NOTES (CONT.)

EROSION CONTROL - TEMPORARY

- (13) WIRE FENCE BACKING WILL BE REQUIRED FOR ALL SILT FENCE. (SEE WK. NO. ECD-3).
- (14) THE EROSION CONTROL DEVICES REFERENCED IN THESE PLANS ARE A MINIMUM REQUIREMENT. IT IS THE RESPONSIBILITY OF THE CONTRACTOR TO ENSURE THAT SILT DOES NOT LEAVE THE RIGHT OF WAY OR CONTAMINATE WATERS OF THE U. S. DURING CONSTRUCTION. THE CONTRACTOR SHALL SUBMIT AN EROSION CONTROL PLAN PRIOR TO COMMENCEMENT OF WORK AND MAINTAIN THE PLAN DURING CONSTRUCTION. ANY ADDITIONAL SILT BASINS NOT SHOWN IN THE PLANS SHALL BE INCLUDED IN THE CONTRACTOR'S EROSION CONTROL PLAN PRIOR TO SUBMITTING FOR APPROVAL.

PAVEMENT, BASE, AND SHOULDERS

- (15) THE CONTRACTOR SHALL REPAIR ANY DAMAGE TO THE PAVED OR UNPAVED SHOULDER THAT MIGHT OCCUR DURING CONSTRUCTION. ANY REPAIR TO SHOULDER WILL BE IN ACCORDANCE WITH THE APPLICABLE SECTIONS OF **THE MISSISSIPPI STANDARD SPECIFICATIONS FOR ROAD AND BRIDGE CONSTRUCTION** . NO PAYMENT WILL BE MADE FOR REPAIR OF DAMAGED SHOULDER.
- (16) TEMPORARY PAVEMENT JOINTS (PAPER JOINTS) SHALL BE EMPLOYED AT ALL LOCATIONS REQUIRING TRAFFIC TO TRAVERSE AN UNEVEN PAVEMENT JOINT. PAPER JOINTS SHALL BE A MINIMUM OF OF 9 FEET IN LENGTH AND SHALL BE ADEQUATELY MAINTAINED.
- (17) WHERE MILLING IS REQUIRED, THE CONTRACTOR SHALL PROVIDE OUTLETS IN THE EXISTING SHOULDERS AT SUFFICIENT INTERVALS TO PREVENT POOLING OR STANDING WATER ON THE MILLED SURFACE, THE COST OF WHICH SHALL BE ABSORBED IN OTHER ITEMS BID.

PLANS

- (18) ALL ADDENDA TO THESE PLANS WILL BE POSTED TO WWW.MDOT.MS.GOV UNDER THE PROPOSAL ADDENDA COLUMN. BIDDERS ARE ADVISED THAT HARD COPIES OF ANY ADDENDA FOR THIS PROJECT WILL NOT BE MAILED. IT IS THE BIDDER'S RESPONSIBILITY TO CHECK AND SEE IF ANY ADDENDA HAVE BEEN POSTED FOR THIS PROJECT.

TRAFFIC CONTROL - PERMANENT

- (19) REMOVAL OF OBJECT MARKERS IS NOT CONSIDERED A SEPARATE PAY ITEM, AND SHALL BE ABSORBED IN OTHER ITEMS BID.
- (20) PERMANENT RAISED MARKERS TO BE PLACED EVERY 40' ALONG CENTERLINE.

TRAFFIC CONTROL - TEMPORARY

- (21) THE LOCATION AND SPACING OF SIGNS, SHOWN ON THE TRAFFIC CONTROL PLANS, ARE APPROXIMATE AND MAY BE ADJUSTED AS NECESSARY TO FIT FIELD CONDITIONS.
- (22) ALL PLASTIC DRUMS SHALL HAVE A BALLASTING COLLAR MADE FROM RECYCLED TRUCK TIRES OR OTHER SUITABLE MATERIAL.
- (23) FLUORESCENT ORANGE SHEETING SHALL BE USED ON ALL CONSTRUCTION AND TRAFFIC CONTROL SIGNS EXCEPT FOR THOSE DESIGNATED ON THE PLANS TO BE BLACK LEGEND AND BORDER ON WHITE BACKGROUND.
- (24) THE CONTRACTOR SHALL COVER OR REMOVE ANY TEMPORARY TRAFFIC CONTROL SIGNS SHOWN IN THE TRAFFIC CONTROL PLAN THAT DO NOT APPLY TO THE CURRENT PHASE.
- (25) THE RETROREFLECTIVE SIGN SHEETING ON RIGID, TEMPORARY TRAFFIC CONTROL (ORANGE) SIGNS SHALL BE MINIMUM TYPE IX.
- (26) TEMPORARY STRIPING SHALL CONFORM TO FINISHED STRIPE SPECIFICATIONS FOR ALIGNMENT, NEATNESS, AND STRAIGHTNESS.

MISCELLANEOUS

- (27) SOME WORK IS REQUIRED OUTSIDE THE PROJECT LIMITS. NO ADDITIONAL COMPENSATION WILL BE MADE FOR SUCH WORK EXCEPT AS PROVIDED BY SPECIFIC PAY ITEMS INCLUDED IN THE PLANS.
- (28) THE CONTRACTOR IS RESPONSIBLE FOR FIELD-VERIFICATION OF EXISTING GRADES AND MAKING ADJUSTMENTS AS NECESSARY WITH THE APPROVAL OF THE PROJECT ENGINEER.



DESIGNED BY: BMA
 DETAILED BY:
 CHECKED BY:
 DATE: 04/24/24

FMS CON: 108392/301000
 PROJECT NO.: STP-0022-01(089)
 COUNTY: HARRISON

GENERAL NOTES

SHEET ID
GN-1
 SHEET NO.
3

PLAN SHEET

4/24/2024 10:10:50 AM 3:GN-1.dgn