

GENERAL INDEX

INCLUDED THIS PROJECT	BEGIN WITH SHEET
<input checked="" type="checkbox"/> ROADWAY.....	1
<input type="checkbox"/> PERMANENT SIGNS.....	1001
<input type="checkbox"/> TRAFFIC SIGNALS.....	2001
<input type="checkbox"/> ITS COMPONENTS.....	3001
<input type="checkbox"/> LIGHTING.....	4001
<input type="checkbox"/> (RESERVED).....	5001
<input checked="" type="checkbox"/> ROADWAY STD. DWGS.....	6001
<input type="checkbox"/> BOX CULVERT STD. DWGS (LRFD).....	7001
<input type="checkbox"/> BOX CULVERT STD. DWGS (STD. SPEC.)....	7501
<input type="checkbox"/> BRIDGE.....	8001
<input type="checkbox"/> CROSS SECTIONS.....	9001

STATE OF MISSISSIPPI
MISSISSIPPI DEPARTMENT OF TRANSPORTATION

PLAN AND PROFILE OF
PROPOSED STATE HIGHWAY
STATE PROJECT NO. SP-0071-05(017)

SR 4 FROM EAST OF CHURCH STREET TO WEST OF JUNCTION SR 371 AT HOBO STATION

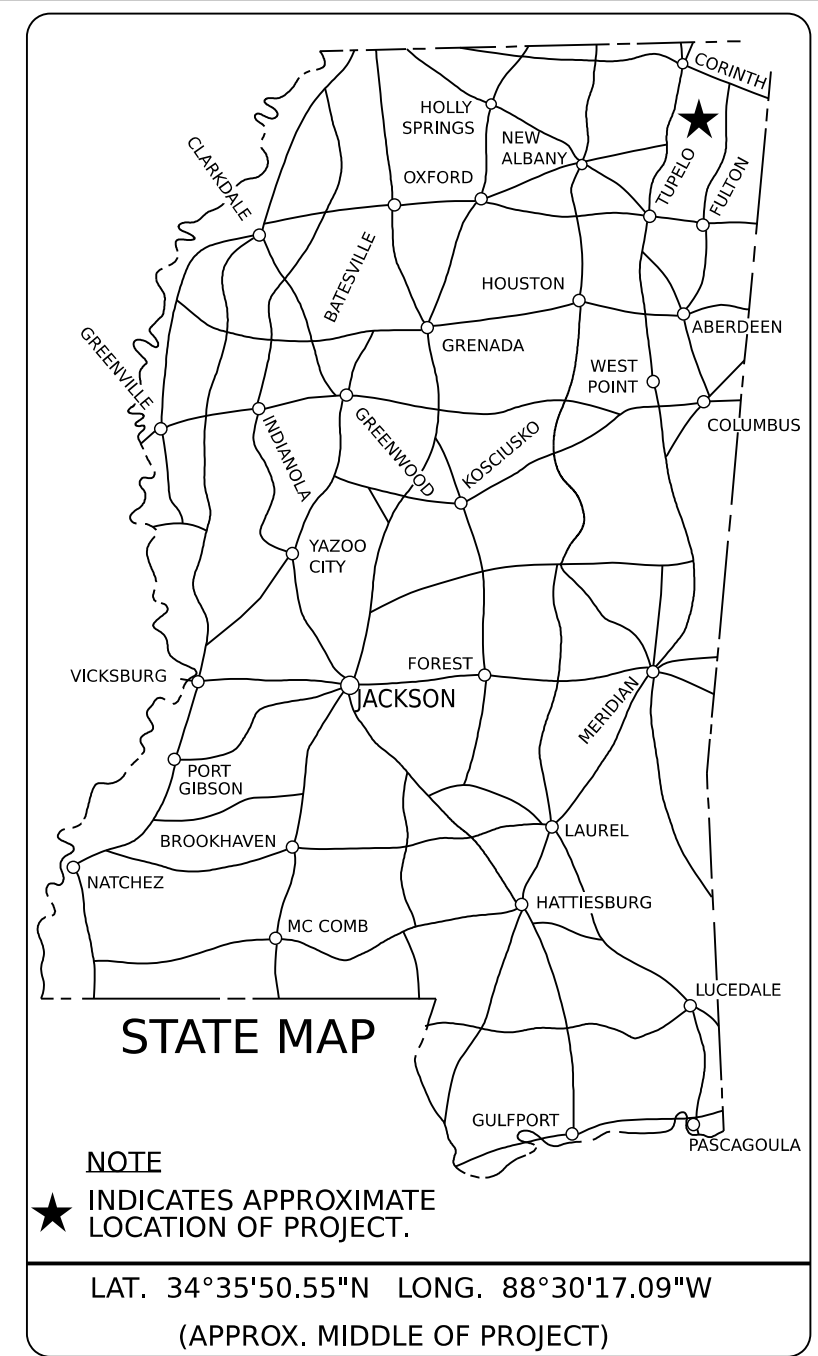

BRIDGE STRUCTURES REQ'D.

BOX BRIDGES REQ'D.

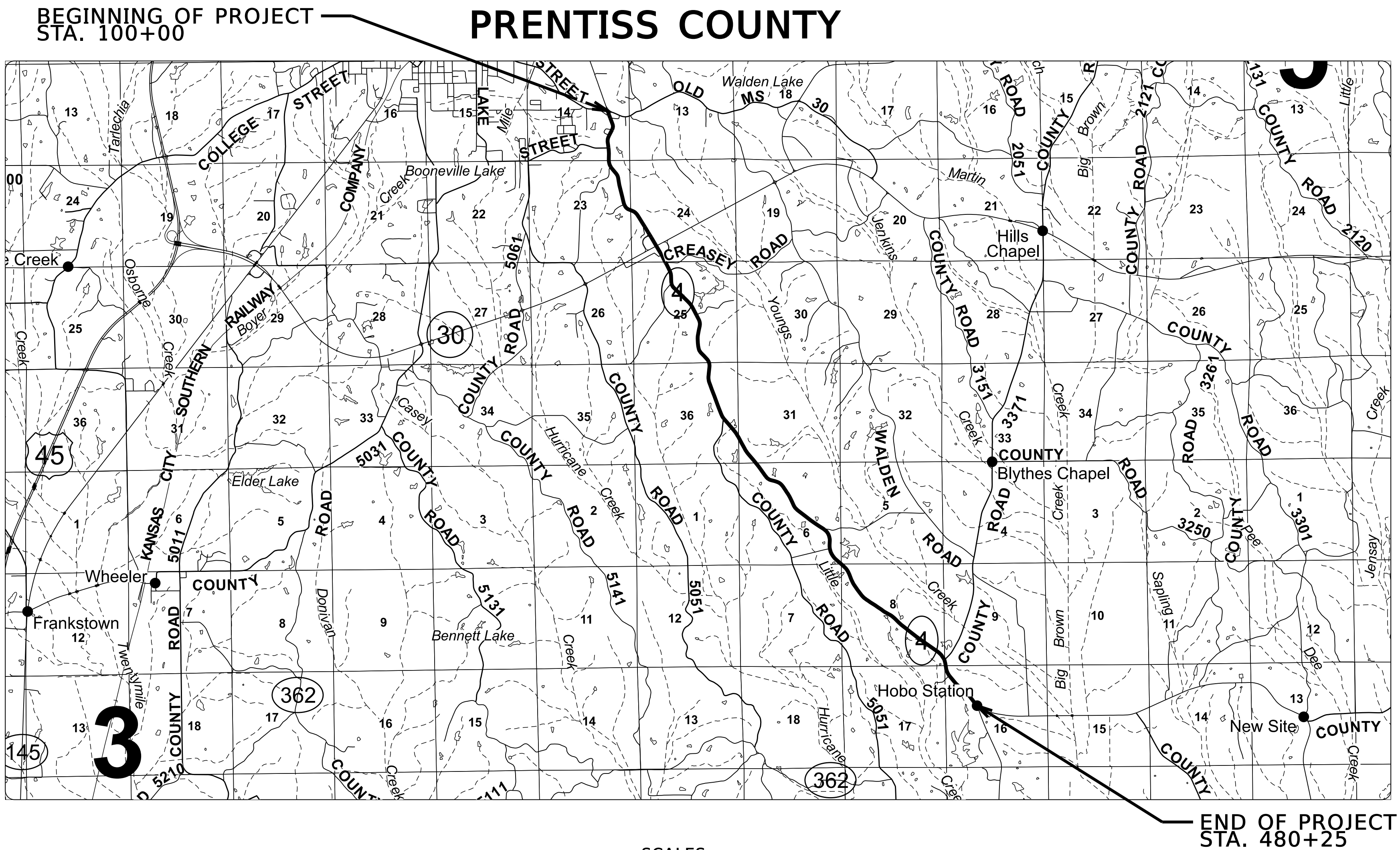

DESIGN CONTROL
 ___ MPH = V (SPEED DESIGN)
 ADT (___) = ___ : ADT (___) = ___
 DHV = ___ : D = ___ % T = ___ %

PERMITS ACQUIRED BY MDOT

WETLANDS AND WATERS PERMITS	
	WATERS WETLANDS
NATIONWIDE #14	<input type="checkbox"/> <input type="checkbox"/>
NATIONWIDE (OTHER)*	<input type="checkbox"/> <input type="checkbox"/>
GENERAL*	<input type="checkbox"/> <input type="checkbox"/>
INDIVIDUAL (404)*	<input type="checkbox"/> <input type="checkbox"/>
STORMWATER PERMIT <input checked="" type="checkbox"/>	
Y REQUIRED, CNOI SUBMITTED BY MDOT (DISTURBED AREA=5 ACRES)	
S REQUIRED, SCNOI TO BE SUBMITTED BY CONTRACTOR (1 TO 4.99 ACRES)	
N NO STORMWATER PERMIT REQUIRED (<1 ACRE)	
APPROVED BY: _____	

CONVENTIONAL SYMBOLS

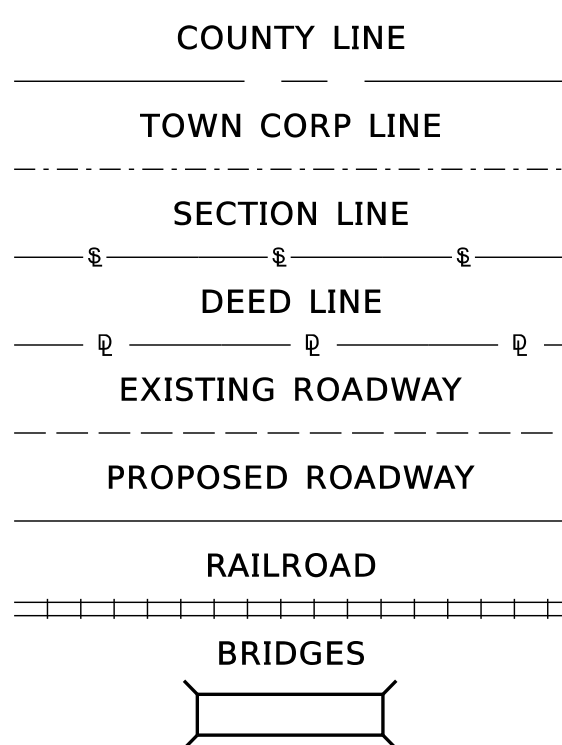

LENGTH DATA

LENGTH OF ROADWAY	37590	FT.	7.119	MI.
LENGTH OF BRIDGES	435	FT.	.082	MI.
LENGTH OF PROJECT (NET)	38025	FT.	7.202	MI.
LENGTH OF EXCEPTIONS	0	FT.	0	MI.
LENGTH OF PROJECT (GROSS)	38025	FT.	7.202	MI.

EQUATIONS

SCALES

PLAN	1 IN. = 100 FT.
PROFILE	{ HOR. 1 IN. = 100 FT.
	{ VERT. 1 IN. = 10 FT.
LAYOUT	1 IN. = FT.

EXCEPTIONS

TITLE SHEET

1/22/2025 1:31:35 PM TITLE.dgn



DESIGNED BY: _____

CONSTRUCTION PROJECT DATA

EXTERNAL PROJECT NUMBER	SP-0071-05(017)
FMS & DETAIL	109758/301000

P S & E DATE: 1/22/25

APPROVED:

 DEPUTY EXECUTIVE DIRECTOR / CHIEF ENGINEER

 EXECUTIVE DIRECTOR

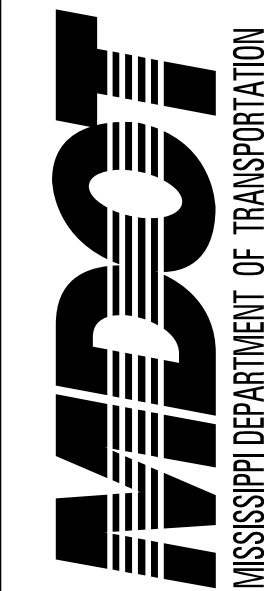

DESIGNED BY:
 DETAILED BY:
 CHECKED BY:
 DATE:

FMS CON: 109758/301000
 PROJECT NO.: SP-0071-05(017)
 COUNTY: PRENTISS

DETAILED INDEX

WK. NO.
DI-1
 SHEET NO.
2

DESCRIPTION OF SHEET	REVISION DATE	WKG. NO.	SH. NO.
TITLE SHEET			1
DETAILED INDEX & GENERAL NOTES (2)			
DETAILED INDEX		DI-1	2
GENERAL NOTES		GN-1	3
SUMMARY OF REVISIONS		REV-1	4
TYPICAL SECTION SHEETS (3)			
TYPICAL SECTION - MILL AND OVERLAY		TS-1	5
TYPICAL SECTION - DIGOUT		TS-2	6
TYPICAL SECTION - ROADSIDE CLEAR ZONES REQUIRED		TS-3	7
QUANTITY SHEETS (4)			
SUMMARY OF QUANTITIES		SQ-1	8
SUMMARY OF QUANTITIES		SQ-2	9
ESTIMATED QUANTITIES (SIGNS)		EQ-1	10
ESTIMATED QUANTITIES (TREES)		EQ-2	11
SPECIAL DESIGN SHEETS (5)			
DETAIL OF CONSTRUCTION SIGNING		DSC-1	12
DETAIL OF CONSTRUCTION SIGNING		DSC-2	13
SIGNING OF TWO-WAY TRAFFIC FOR NO PASSING ZONES		TC-1	14
RUMBLE STRIPES 2-LANE HIGHWAYS (ASPHALT LANES 2-FT ASPHALT SHOULDERS)		RS-1	15
SIGN SUPPORT HARDWARE - 2.0" SQUARE POST		TSS-1	16
STANDARD DRAWING- ROADWAY SHEETS (13)			
PAVEMENT MARKING DETAILS FOR 2-LANE AND 4-LANE DIVIDED ROADWAYS		PM-1	6051
PAVEMENT MARKING LEGEND DETAILS		PM-5	6055
PAVEMENT MARKING LEGEND DETAILS		PM-6	6056
2-WAY RAISED PAVEMENT MARKERS AT INTERSECTING ROADS (2-LANE)		PM-11	6061
STANDARD ROADSIDE SIGNS		SN-3	6303
STANDARD ROADSIDE SIGNS		SN-3A	6304
STANDARD ROADSIDE SIGNS		SN-3B	6305
TRAFFIC CONTROL PLAN WITH FLAGGER (ONE-LANE CLOSURE OF TWO-WAY TRAFFIC)		TCP-1	6351
HIGHWAY SIGN AND BARRICADE DETAILS FOR CONSTRUCTION PROJECTS		TCP-8	6358
TRAFFIC CONTROL PLAN MOBILE OPERATIONS MULTILANE ROADS AND TWO-LANE ROADS		TCP-9	6359
TRAFFIC CONTROL PLANS UNEVEN PAVEMENT DETAILS		TCP-12	6362
TEMPORARY STRIPING FOR TRAFFIC CONTROL, 2-LANE AND 4-LANE DIVIDED ROADWAYS		TCP-13	6363
TRAFFIC CONTROL DETAILS DRUM PLACEMENT AND SHOULDER CLOSURE		TCP-16	6366

PLAN SHEET

8:20:30 AM MISC.dgn

DATE

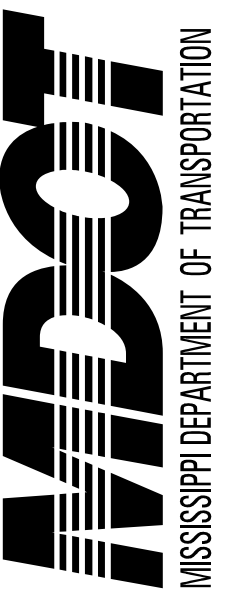

GENERAL NOTES:

- (1) THE LOCATION AND SPACING OF SIGNS, SHOWN ON THE TRAFFIC CONTROL PLANS, ARE APPROXIMATE AND MAY BE ADJUSTED AS NECESSARY TO FIT FIELD CONDITIONS.
- (2) ALL TRAFFIC CONTROL DEVICES ON THIS PROJECT SHALL COMPLY WITH PART VI OF THE MUTCD (LATEST EDITION).
- (3) ALL PLASTIC DRUMS SHALL HAVE A BALLASTING COLLAR MADE FROM RECYCLED TRUCK TIRES OR OTHER SUITABLE MATERIAL.
- (4) THE CONTRACTOR SHALL BE RESPONSIBLE FOR PROTECTING EXISTING STRUCTURES SUCH AS, BUT NOT LIMITED TO, PIPES, INLETS, APRONS, AND BRIDGES FROM DAMAGE WHICH MIGHT OCCUR DURING CONSTRUCTION. THE CONTRACTOR SHALL REPLACE OR REPAIR, AS DIRECTED BY THE ENGINEER, ANY STRUCTURES DAMAGED DURING THE LIFE OF THE CONTRACT. NO PAYMENT WILL BE MADE FOR REPLACEMENT OR REPAIR OF DAMAGED ITEMS.
- (5) FLUORESCENT ORANGE SHEETING SHALL BE USED ON ALL CONSTRUCTION AND TRAFFIC CONTROL SIGNS EXCEPT FOR THOSE DESIGNATED ON THE PLANS TO BE BLACK LEGEND AND BORDER ON WHITE BACKGROUND.
- (6) VEGETATIVE MATERIAL WILL BE REMOVED PRIOR TO PLACEMENT OF GRANULAR MATERIAL. THE COST OF WHICH SHALL BE ABSORBED IN OTHER BID ITEMS.
- (7) ALL EXISTING SIGNS WHICH ARE TO BE REMOVED AS A PART OF THIS PROJECT THAT ARE NOT IN CONFLICT WITH CONSTRUCTION SHALL REMAIN IN PLACE UNTIL NEW SIGNS ARE INSTALLED UNLESS NOTED OR DIRECTED OTHERWISE BY THE PROJECT ENGINEER. ROADWAY SIGNS THAT ARE IN CONFLICT WITH CONSTRUCTION SHALL BE REMOVED AND RELOCATED BY THE CONTRACTOR AS DIRECTED BY THE ENGINEER, THE COST OF WHICH SHALL BE ABSORBED IN OTHER ITEMS BID.
- (8) REMOVAL OF RAISED PAVEMENT MARKERS THAT ARE IN CONFLICT WITH REQUIRED CONSTRUCTION IS NOT CONSIDERED A SEPARATE PAY ITEM. COST TO BE ABSORBED IN OTHER ITEMS BID.
- (9) WHERE MILLING IS REQUIRED, THE CONTRACTOR SHALL PROVIDE OUTLETS IN THE EXISTING SHOULDERS AT SUFFICIENT INTERVALS TO PREVENT POOLING OR STANDING WATER ON THE MILLED SURFACE, THE COST OF WHICH SHALL BE ABSORBED IN OTHER ITEMS BID.
- (10) TEMPORARY STRIPING SHALL CONFORM TO FINISHED STRIPE SPECIFICATIONS FOR ALIGNMENT, NEATNESS, AND STRAIGHTNESS.
- (11) INSTALLATION DATES SHALL BE CLEARLY WRITTEN IN BOLD, BLACK MARKINGS ON THE BACK BOTTOM HALF OF ALL PERMANENT SIGNS WITH A PERMANENT MARKING STICK THAT IS WATERPROOF, FADE RESISTANT, AND MARKS ON WET OR DRY SURFACES.
- (12) ALL ADDENDA TO THESE PLANS WILL BE POSTED TO WWW.MDOT.MS.GOV UNDER THE PROPOSAL ADDENDA COLUMN. BIDDERS ARE ADVISED THAT HARD COPIES OF ANY ADDENDA FOR THIS PROJECT WILL NOT BE MAILED. IT IS THE BIDDER'S RESPONSIBILITY TO CHECK AND SEE IF ANY ADDENDA HAVE BEEN POSTED FOR THIS PROJECT.
- (13) TEMPORARY PAVEMENT JOINTS (PAPER JOINTS) SHALL BE EMPLOYED AT ALL LOCATIONS REQUIRING TRAFFIC TO TRAVERSE AN UNEVEN PAVEMENT JOINT. PAPER JOINTS SHALL BE A MINIMUM OF 9 FEET IN LENGTH AND SHALL BE ADEQUATELY MAINTAINED.
- (14) CLEAR GUARDRAIL PADS FOR POSITIVE DRAINAGE
- (15) THE CONTRACTOR SHALL REPAIR ANY DAMAGE TO THE PAVED OR UNPAVED SHOULDER THAT MIGHT OCCUR DURING CONSTRUCTION. ANY REPAIR TO SHOULDER WILL BE IN ACCORDANCE WITH THE APPLICATION SECTION OF THE MISSISSIPPI STANDARD SPECIFICATIONS FOR ROAD AND BRIDGE CONSTRUCTION. NO PAYMENT WILL BE MADE FOR REPAIR OF DAMAGED SHOULDER.
- (16) ALL POST, PIPE, AND I-BEAM LENGTHS IN THESE PLANS ARE ESTIMATES. POST LENGTH FOR ALL SIGNS SHALL BE VERIFIED IN THE FIELD BY THE CONTRACTOR PRIOR TO FABRICATION.
- (17) ALL PERMANENT SIGNS SHALL CONFORM TO THE LATEST EDITION OF THE MANUAL ON UNIFORM TRAFFIC CONTROL DEVICES.
- (18) ALL SIGN LOCATIONS SHALL BE APPROVED BY THE PROJECT ENGINEER PRIOR TO INSTALLATION.
- (19) THE RETROREFLECTIVE SIGN SHEETING ON PERMANENT GROUND-MOUNTED SIGNS SHALL BE AS FOLLOWS: BROWN BACKGROUND SHEETING ON GUIDE SIGNS SHALL BE A MINIMUM TYPE VIII; GREEN AND BLUE BACKGROUND SHEETING ON GUIDE SIGNS SHALL BE A MINIMUM TYPE IX; ALL WHITE, YELLOW, FLUORESCENT YELLOW, AND FLUORESCENT YELLOW/GREEN SHEETING SHALL BE TYPE XI. ALL SIGN SHEETING ON OVERHEAD SIGNS SHALL BE TYPE XI.
- (20) ALL EXISTING SIGNS AND SUPPORTS REMOVED UNDER THIS PROJECT SHALL BECOME THE PROPERTY OF THE CONTRACTOR AND ARE NOT A SEPERATE PAY ITEM.
- (21) ALL SIDE ROAD, STOP SIGN MOUNTED STREET NAME SIGNS TO BE SALVAGED AND STORED AT THE DIRECTION OF THE PROJECT ENGINEER FOR DELIVERY TO THE CITY (NOT A SEPERATE PAY ITEM)
- (22) THE RETROREFLECTIVE SIGN SHEETING ON RIGID, TEMPORARY TRAFFIC CONTROL (ORANGE) SIGNS SHALL BE A MINIMUM TYPE IX.
- (23) THE CONTRACTOR SHALL COVER OR REMOVE ANY TEMPORARY TRAFFIC CONTROL SIGNS SHOWN IN THE TRAFFIC CONTROL PLAN THAT DO NOT APPLY TO THE CURRENT PHASE.

PLAN SHEET

8:20:50 AM MISC.dgn

DATE

DESIGNED BY:
 DETAILED BY:
 CHECKED BY:
 DATE:

FMS CON: 109758/301000
 PROJECT NO.: SP-0071-05(017)
 COUNTY: PRENTISS

GENERAL NOTES

SUMMARY OF REVISIONS

DATE	1ST. ORDER	ADDENDUM	2ND. ORDER	BY	WK. NO.	DESCRIPTION



DESIGNED BY:
 DETAILED BY:
 CHECKED BY:
 DATE:

FMS CON: 109758/301000
 PROJECT NO.: SP-0071-05(017)
 COUNTY: PRENTISS

SUMMARY OF REVISIONS

WK. NO.
REV-1
 SHEET NO.
4