

GENERAL INDEX

INCLUDED THIS PROJECT	BEGIN WITH SHEET
<input checked="" type="checkbox"/> ROADWAY.....	1
<input checked="" type="checkbox"/> PERMANENT SIGNS.....	1001
<input checked="" type="checkbox"/> TRAFFIC SIGNALS.....	2001
<input type="checkbox"/> ITS COMPONENTS.....	3001
<input type="checkbox"/> LIGHTING.....	4001
<input type="checkbox"/> (RESERVED).....	5001
<input checked="" type="checkbox"/> ROADWAY STD. DWGS.....	6001
<input type="checkbox"/> BOX CULVERT STD. DWGS (LRFD).....	7001
<input type="checkbox"/> BOX CULVERT STD. DWGS (STD. SPEC.).....	7501
<input type="checkbox"/> BRIDGE.....	8001
<input checked="" type="checkbox"/> CROSS SECTIONS.....	9001

**STATE OF MISSISSIPPI
MISSISSIPPI DEPARTMENT OF TRANSPORTATION**

**PLAN AND PROFILE OF
PROPOSED STATE HIGHWAY
FEDERAL AID PROJECT NO. NHPP-0002-06(034)
US 45 & US 278 TRAFFIC SIGNAL & INTERCHANGE MODIFICATIONS -
NORTHBOUND RAMP TRAFFIC SIGNAL & RAMP WIDENING AT US 278
LEE COUNTY**

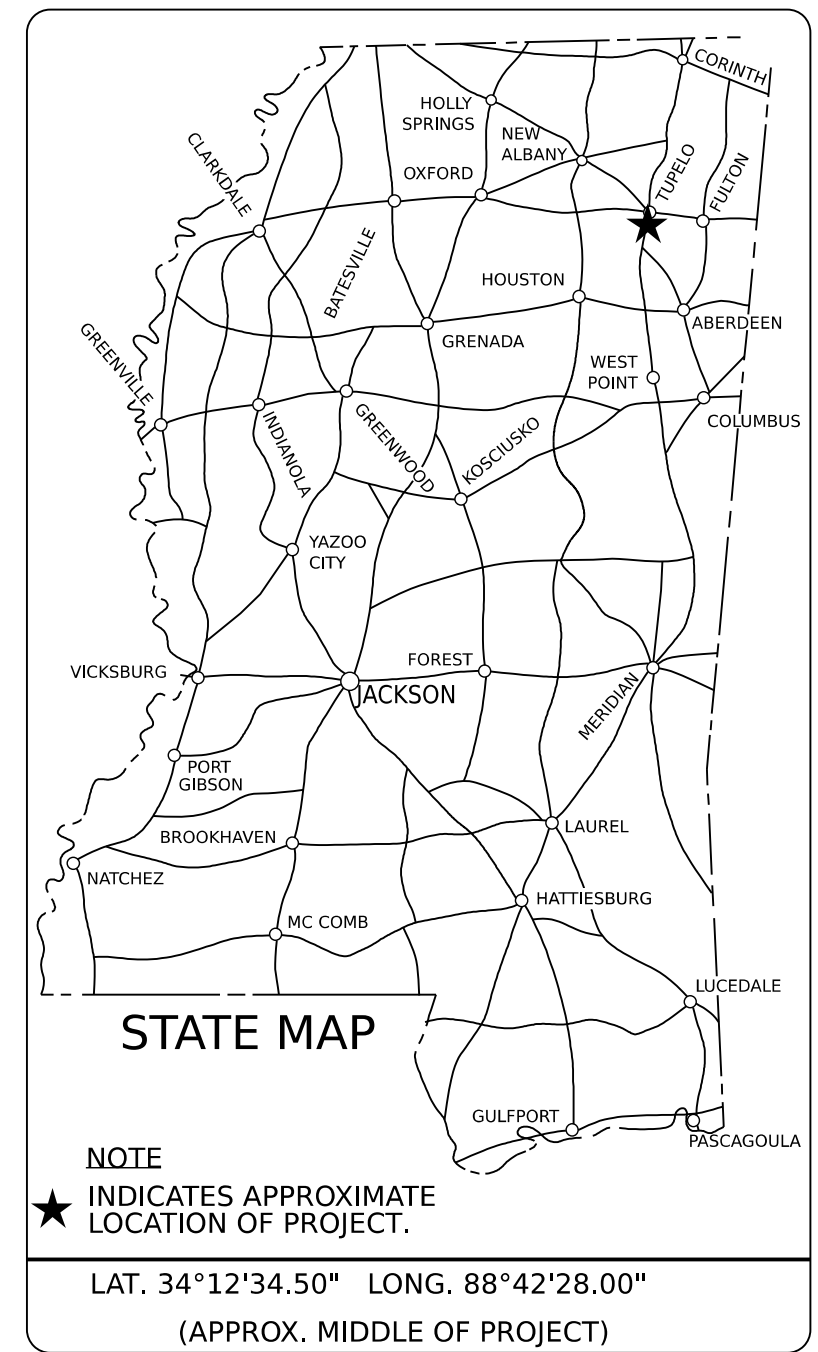

B.O.P. STA. 32+63.51 — R 5 E — R 6 E — E.O.P. STA. 48+07.00

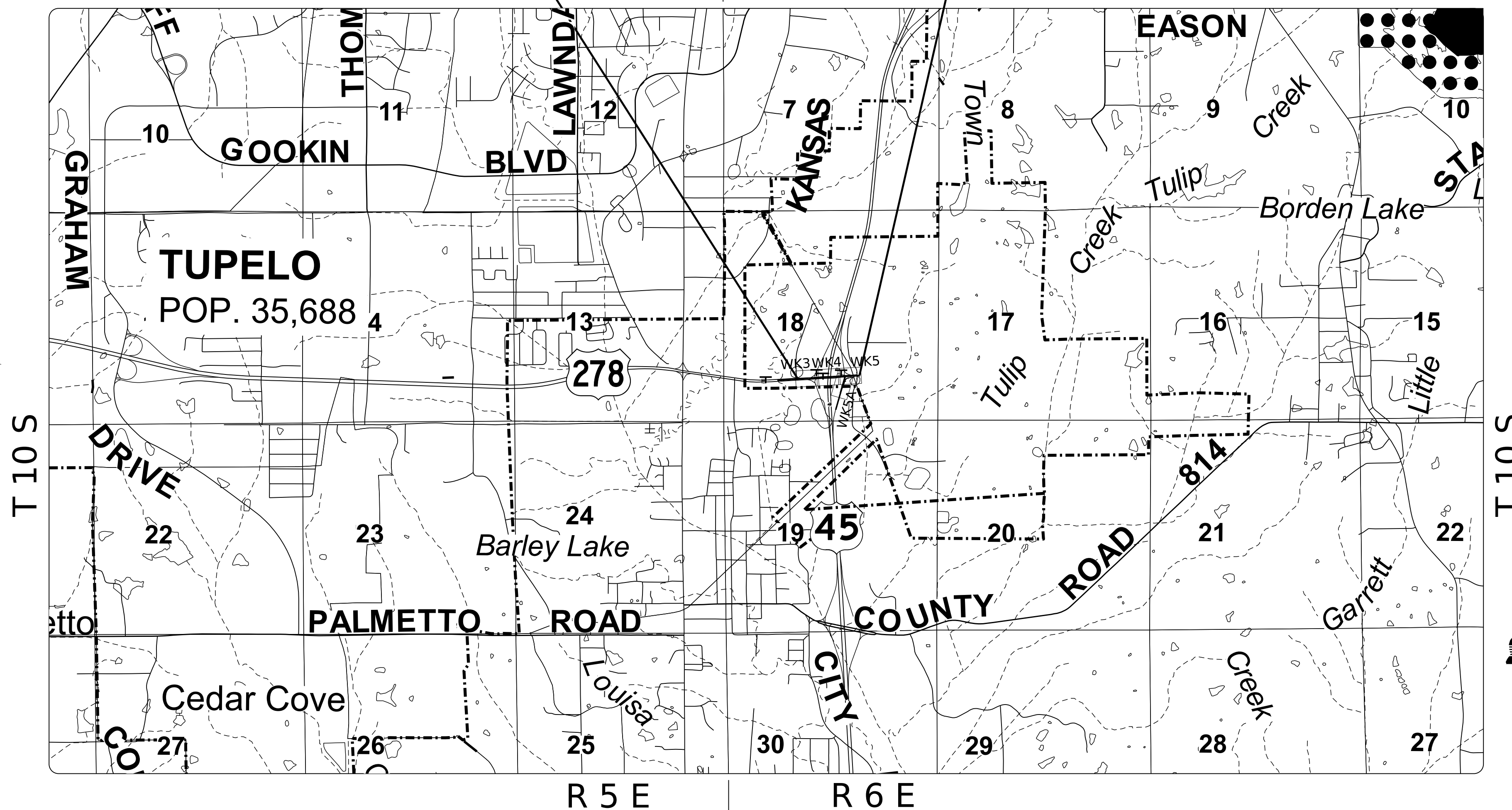

BRIDGE STRUCTURES REQ'D.
NONE

BOX BRIDGES REQ'D.
NONE

DESIGN CONTROL

45 MPH = V (SPEED DESIGN)
ADT (2024) = 16,000 : ADT (2044) = 20,000
DHV = 2,000 : D = 55 % T = 7 %

PERMITS ACQUIRED BY MDOT

WETLANDS AND WATERS PERMITS	
NATIONWIDE #14	<input checked="" type="checkbox"/> WATERS <input checked="" type="checkbox"/> WETLANDS
NATIONWIDE (OTHER)*	<input checked="" type="checkbox"/> <input checked="" type="checkbox"/>
GENERAL*	<input checked="" type="checkbox"/> <input checked="" type="checkbox"/>
INDIVIDUAL (404)*	<input checked="" type="checkbox"/> <input checked="" type="checkbox"/>
STORMWATER PERMIT <input checked="" type="checkbox"/>	
Y REQUIRED, CNOI SUBMITTED BY MDOT (DISTURBED AREA=5 ACRES)	
S REQUIRED, SCNOI TO BE SUBMITTED BY CONTRACTOR (1 TO 4.99 ACRES)	
N NO STORMWATER PERMIT REQUIRED (<1 ACRE)	
APPROVED BY: _____	

CONVENTIONAL SYMBOLS

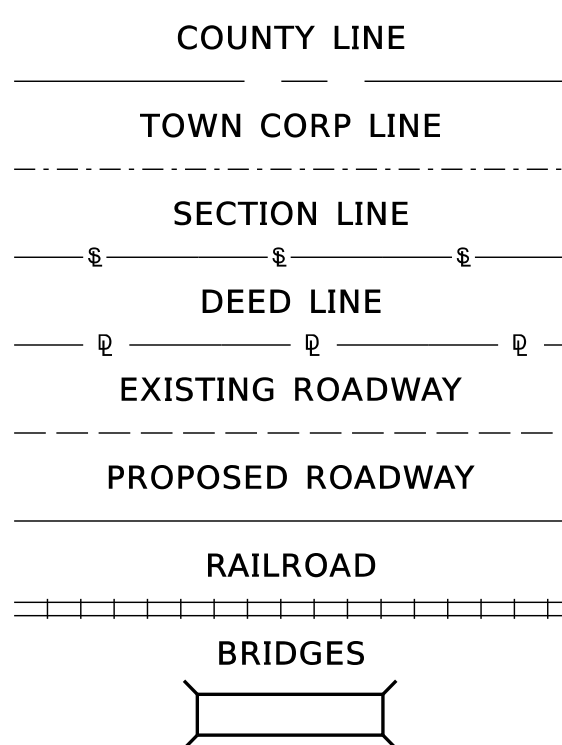

LENGTH DATA

LENGTH OF ROADWAY	1250.84 FT.	0.237 MI.
LENGTH OF BRIDGES	292.65 FT.	0.055 MI.
LENGTH OF PROJECT (NET)	1543.49 FT.	0.292 MI.
LENGTH OF EXCEPTIONS	0.00 FT.	0.000 MI.
LENGTH OF PROJECT (GROSS)	1543.49 FT.	0.292 MI.

EQUATIONS

NONE

SCALES

PLAN 1 IN. = 20 FT.
PROFILE { HOR. 1 IN. = 20 FT.
VERT. 1 IN. = 5 FT.
LAYOUT 1 IN. = 2000 FT.

EXCEPTIONS

NONE

DESIGNED BY: NEEL-SCHAFFER INC.

CONSTRUCTION PROJECT DATA

EXTERNAL PROJECT NUMBER	NHPP-0002-06(034)
FMS & DETAIL	109902/301000

P S & E DATE: 05/18/2026

APPROVED:

DEPUTY EXECUTIVE DIRECTOR / CHIEF ENGINEER

EXECUTIVE DIRECTOR

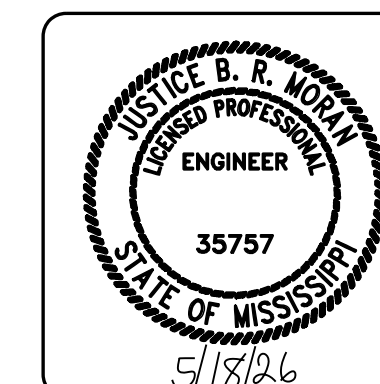

TITLE SHEET

5/18/2026 3:08:01 PM TITLE.dgn

DESCRIPTION OF SHEET	REVISION DATE	SHEET ID	SHEET. NO.
TITLE SHEET (1)			1
DETAILED INDEX, SUMMARY OF REVISIONS, & GENERAL NOTES (3)			
DETAILED INDEX		DI- 1	2
SUMMARY OF REVISIONS		RVP- 1	
GENERAL NOTES		GN- 1	3
GENERAL NOTES		GN- 2	4
TYPICAL SECTION SHEETS (3)			
TYPICAL SECTIONS		TS- 1	5
TYPICAL SECTIONS		TS- 2	6
TYPICAL SECTIONS		TS- 3	7
QUANTITY SHEETS (8)			
SUMMARY OF QUANTITIES		SQ- 1	8
SUMMARY OF QUANTITIES		SQ- 2	9
SUMMARY OF QUANTITIES		SQ- 3	10
ESTIMATED QUANTITIES - PAVED FLUMES, COMBINATION CONCRETE CURB AND GUTTER, EARTHWORK, REMOVAL ITEMS		EQ- 1	11
ESTIMATED QUANTITIES - SUMMARY OF PAVEMENT MARKINGS, DIRECTIONAL SIGN ASSEMBLIES, STANDARD ROADSIDE SIGN ASSEMBLY		EQ- 2	12
ESTIMATED QUANTITIES - STANDARD ROADSIDE SIGN ASSEMBLY		EQ- 3	13
ESTIMATED QUANTITIES - SUMMARY OF TRAFFIC CONTROL ITEMS REQUIRED		EQ- 4	14
ESTIMATED QUANTITIES - TRAFFIC CONTROL SIGNS		EQ- 5	15
PLAN & PROFILE SHEETS (4)			
US 278 - B.O.P. - STA. 37+60		WK- 3	16
US 278 - STA. 37+60 - STA. 43+00		WK- 4	17
US 278 - STA. 43+00 - E.O.P.		WK- 5	18
US 45 SE RAMP & US 278 - STA. 15+61.85 - STA. 19+44.71		WK- 5A	19
EROSION CONTROL SHEETS (4)			
US 278 - B.O.P. - STA. 37+60		ECP- 3	20
US 278 - STA. 37+60 - STA. 43+00		ECP- 4	21
US 278 - STA. 43+00 - E.O.P.		ECP- 5	22
US 45 SE RAMP & US 278 - STA. 15+61.85 - STA. 19+44.71		ECP- 5A	23
SPECIAL DESIGN SHEETS (13)			
FORM GRADES - US 278		FG- 1	24
FORM GRADES - US 45 SE RAMP & US 278		FG- 2	25
DETAIL CONSTRUCTION SIGNING			
TRAFFIC CONTROL NARRATIVE		TC- NAR	27
TRAFFIC CONTROL PLAN - US 45 SE RAMP & US 278 PHASE 1		TC- 1	28
TRAFFIC CONTROL PLAN - US 45 SE RAMP & US 278 PHASE 1		TC- 2	29
TRAFFIC CONTROL PLAN - US 45 SE RAMP & US 278 PHASE 1		TC- 3	30
PAVEMENT MARKING DETAILS - US 278		PMD- 1	31
PAVEMENT MARKING DETAILS - US 278		PMD- 2	32
PAVEMENT MARKING DETAILS - US 45 SE RAMP		PMD- 3	33
VEGETATION SCHEDULE			
SIGN SUPPORT HARDWARE 2.5" SQUARE POST		TSS- 1	35
SIGN SUPPORT HARDWARE 2.0" SQUARE POST		TSS- 2	36
PERMANENT SIGNING SHEETS (5)			
PERMANENT SIGNING PLAN		PSP- 1	1001
DIRECTIONAL SIGN DETAILS - US 45 SE RAMP & US 278		PSP- DET- 1	1002
DIRECTIONAL SIGN DETAILS - US 45 SE RAMP & US 278		PSP- DET- 2	1003
DIRECTIONAL SIGN DETAILS - US 45 SE RAMP & US 278		PSP- DET- 3	1004
INSTALLATION OF DELINEATORS - US 45 SE RAMP		PSPD- 1	1005
TRAFFIC SIGNAL INSTALLATION SHEETS (14)			
US 45 SE RAMP & US 278 - TRAFFIC SIGNAL COMMUNICATIONS		TSI- 1A	2001
US 45 SE RAMP & US 278 - TRAFFIC SIGNAL INSTALLATION		TSI- 1B	2002

DESCRIPTION OF SHEET	REVISION DATE	SHEET ID	SHEET. NO.
US 45 RAMP & US 278 - CHARTS AND GRAPHS		TSI- 1C	2003
TRAFFIC SIGNAL GENERAL NOTES		TSI- 1D	2004
TRAFFIC SIGNAL HEADS, TRAFFIC SIGNAL SIGNS, & WIND SPEEDS		TSI- 2	2005
CURVED MAST ARM AND PEDESTAL POLE DETAILS		TSI- 3C	2006
SIGNAL POLE AND PEDESTAL POLE FOUNDATION DETAILS		TSI- 4	2007
TRAFFIC SIGNAL GROUNDING DETAILS		TSI- 5	2008
CONTROLLER CABINET AND POWER SERVICE DETAILS		TSI- 6	2009
POWER SERVICE PEDESTAL DETAILS		TSI- 7	2010
PULL BOX AND CONDUIT TRENCHING DETAILS		TSI- 8	2011
TYPE 1 VIDEO DETECTION INSTALLATION FOR TRAFFIC SIGNALS		TSI- 9C	2012
TRAFFIC CONTROL PLAN (TYPICAL SIGNAL INSTALLATION)		TSI- 10	2013
RADIO/SIGNAL MONITORING CCTV MOUNTING DETAILS		TSI- 15	2014
STANDARD DRAWINGS (36)			
CONCRETE ISLAND PAVEMENT DETAILS		CIP- 1	6011
PAVEMENT MARKING DETAILS FOR 2- LANE & 4- LANE DIVIDED ROADWAYS	12/11/2025	PM- 1	6051
PAVEMENT MARKING LEGEND DETAILS	12/11/2025	PM- 6	6056
4- LANE TO 2- LANE TRANSITION AT INTERCHANGE	12/11/2025	PM- 8	6058
OFFSET LEFT TURN LANES	12/11/2025	PM- 13	6063
TYPICAL TEMPORARY EROSION CONTROL/SEDIMENT CONTROL APPLICATIONS		ECD- 1	6101
DETAILS OF SEDIMENT BARRIER APPLICATIONS		ECD- 2	6102
DETAILS OF SILT FENCE INSTALLATION		ECD- 3	6103
DITCH CHECK STRUCTURES, TYPICAL APPLICATIONS AND DETAILS		ECD- 4	6104
TEMPORARY EROSION, SEDIMENT, & WATER POLLUTION CONTROL MEASURES (SILT FENCE & HAY BALE DITCH CHECKS)		ECD- 5	6105
DETAILS OF EROSION CONTROL WATTLE DITCH CHECK		ECD- 6	6106
DETAILS OF EROSION CONTROL SILT DIKE DITCH CHECK		ECD- 7	6107
ROCK DITCH CHECK		ECD- 8	6108
DETAILS OF TYPICAL DITCH TREATMENTS		DT- 1	6123
STANDARD DIRECTIONAL (GUIDE) SIGNS	12/11/2025	SN- 1	6301
ROUTE SHIELDS AND "EXIT ONLY" PANELS	12/11/2025	SN- 2	6302
STANDARD ROADSIDE SIGNS	12/11/2025	SN- 3	6303
STANDARD ROADSIDE SIGNS	12/11/2025	SN- 3A	6304
STANDARD ROADSIDE SIGNS	12/11/2025	SN- 3B	6305
STANDARD ROADSIDE SIGN ASSEMBLY AND INSTALLATION	12/11/2025	SN- 4	6306
STANDARD ROADSIDE SIGN ASSEMBLY AND INSTALLATION		SN- 4A	6307
STANDARD ROADSIDE SIGN ASSEMBLY AND INSTALLATION		SN- 4B	6308
TYPICAL INSTALLATION OF GROUND MOUNTED DIRECTIONAL SIGNS	12/11/2025	SN- 5	6309
SIGN FACE CONST. AND ATTACHMENT OF GROUND MOUNTED DIRECTIONAL SIGNS TO STEEL		SN- 7	6313
BEAMS (EXTRUDED ALUMINUM PANELS)			
TYPICAL INSTALLATION AND DETAILS OF DELINEATORS AND DISTANCE REFERENCE SIGNS	12/11/2025	SN- 8	6314
TYPICAL INSTALLATION OF DELINEATORS	12/11/2025	SN- 8A	6315
SIGNING DETAILS FOR BRIDGE APPROACHES	12/11/2025	SN- 9	6318
TRAFFIC CONTROL PLAN FOR POSTED SPEED LIMIT LESS THAN 65 MPH (4- LANE: MEDIAN LANE OR OUTSIDE LANE CLOSURE) (WORK DAY ONLY)	12/11/2025	TCP- 2	6352
TRAFFIC CONTROL PLAN FOR POSTED SPEED LIMIT LESS THAN 65 MPH (4- LANE: MEDIAN LANE OR OUTSIDE LANE CLOSURE) (EXTENDED PERIOD)	12/11/2025	TCP- 3	6353
HIGHWAY SIGN AND BARRICADE DETAILS FOR CONSTRUCTION PROJECTS	12/11/2025	TCP- 8	6358
TEMPORARY STRIPING FOR TRAFFIC CONTROL 2- LANE AND 4- LANE DIVIDED HIGHWAYS	12/11/2025	TCP- 13	6363
TRAFFIC CONTROL DETAILS DRUM PLACEMENT AND SHOULDER CLOSURE	12/11/2025	TCP- 16	6366
PERMANENT BARRICADE WITH BERM	12/11/2025	TCP- 17	6367
TYPICAL GRADING TRANSITION BETWEEN CUTS & FILLS		GT- 1	6404
DRIVEWAYS, CURB & GUTTER, & SIDEWALK		SD- 1	6419
DETAILS OF PAVED FLUMES		PF- 1	6426
CROSS SECTION SHEETS (3)			
US 45 SE RAMP - STA. 15+60.00 - STA. 16+50.00			9001
US 45 SE RAMP - STA. 17+00.00 - STA. 18+50.00			9002
US 45 SE RAMP - STA. 19+00.00 - STA. 19+42.18			9003
TOTAL SHEETS			
			94



DESIGNED BY: NEEL-SCHAFFER INC.
 DETAILED BY:
 CHECKED BY:
 DATE:

FMS CON: 109902/301000
 PROJECT NO.: NHPP-0002-06(034)
 COUNTY: LEE

DETAILED INDEX

SHEET ID
DI-1
 SHEET NO.
2

PLAN SHEET

5/18/2026 3:08:09 PM DI - Detailed Index.dgn

GENERAL NOTES

BRIDGES AND WALLS

- (1) STORAGE OF FLAMMABLE MATERIALS WILL NOT BE ALLOWED UNDER ANY BRIDGE STRUCTURES WITHOUT WRITTEN APPROVAL FROM THE PROJECT ENGINEER. SEE NOTICE TO BIDDERS ENTITLED "MATERIAL STORAGE UNDER BRIDGES" FOR MORE INFORMATION.

DRAINAGE STRUCTURES

- (2) CURB AND GUTTER VERTICAL DIMENSIONS SHOWN IN THE DETAIL DRAWINGS ARE FOR A CURB IN THE "CATCH" CONFIGURATION AND SHALL BE CONSIDERED TO BE MINIMUM DIMENSIONS. THE DIMENSIONS MAY BE MODIFIED AS NECESSARY FOR "SPILL" CURB AND GUTTER, BUT SHALL NOT BE LESS THAN THE MINIMUM SHOWN.
(3) THE CONTRACTOR SHALL BE RESPONSIBLE FOR PROTECTING EXISTING STRUCTURES SUCH AS, BUT NOT LIMITED TO, PIPES, INLETS, APRONS, AND BRIDGES FROM DAMAGE WHICH MIGHT OCCUR DURING CONSTRUCTION. THE CONTRACTOR SHALL REPLACE OR REPAIR, AS DIRECTED BY THE ENGINEER, ANY STRUCTURES DAMAGED DURING THE LIFE OF THE CONTRACT. NO PAYMENT WILL BE MADE FOR REPLACEMENT OR REPAIR OF DAMAGED ITEMS.

EARTHWORK

- (4) A SOIL PROFILE HAS BEEN PREPARED FOR THIS PROJECT USING SAMPLES TAKEN FROM HOLES AT THE LOCATIONS INDICATED IN THE TEST REPORTS. THIS SOIL PROFILE IS ON FILE IN THE DISTRICT AND CENTRAL CONSTRUCTION OFFICES AND IS AVAIL-ABLE FOR EXAMINATION. THE DEPARTMENT DOES NOT GUARANTEE THAT THE MATERIALS AS SHOWN IN THE REPORTS ARE NECESSARILY TO BE FOUND OUTSIDE THE TEST HOLES.
(5) 25 % SHRINKAGE FACTOR USED IN THE EARTHWORK CALCULATIONS IS FOR DESIGN ESTIMATING PURPOSES ONLY.
(6) VOIDS CREATED BY THE REMOVAL OF, BUT NOT LIMITED TO, POSTS, CONCRETE ANCHORS, AND FOOTINGS SHALL BE BACKFILLED AND TAMPED IN ACCORDANCE WITH SECTION 203 OF THE MISSISSIPPI STANDARD SPECIFICATIONS FOR ROAD AND BRIDGE CONSTRUCTION, THE COST OF WHICH WILL BE ABSORBED IN OTHER ITEMS BID.
(7) SMALL AMOUNTS OF EXCAVATION MAY BE NECESSARY AT SOME OF THE SITES. THIS MATERIAL MAY BE USED AS E.S.F.E. MATERIAL AND WILL BE PAID FOR AS BORROW. NO E.S.F.E. MATERIAL SHALL BE REMOVED FROM THE PROJECT WITHOUT THE APPROVAL OF THE ENGINEER.
(8) VEGETATIVE MATERIAL WILL BE REMOVED PRIOR TO PLACEMENT OF GRANULAR MATERIAL. THE COST OF WHICH SHALL BE ABSORBED IN OTHER ITEMS BID.
(9) PRIOR TO EARTHWORK OPERATIONS, THE EXISTING TOP 4" TOPSOIL IS TO BE STRIPPED AND STOCKPILED. AFTER THE GRADING OPERATIONS ARE COMPLETED, SAID TOPSOIL SHALL BE PLACED ON ALL AREAS THAT ARE NOT TO BE PAVED OR OTHERWISE PROTECTED, IN ACCORDANCE WITH SECTION 211 OF THE SPECIFICATIONS, OR THE VEGETATION SCHEDULE (SEE WK. SH. VS-1). EXISTING TOPSOIL AND ALL COSTS ASSOCIATED WITH STRIPPING, HAULING, STOCKPILING, AND PLACEMENT OF THE EXISTING TOPSOIL IS TO BE ABSORBED IN OTHER EARTHWORK ITEMS.

EROSION CONTROL - TEMPORARY

- (11) WIRE FENCE BACKING WILL BE REQUIRED FOR ALL SILT FENCE. (SEE WK. NO. ECD-3)
(12) THE EROSION CONTROL DEVICES REFERENCED IN THESE PLANS ARE A MINIMUM REQUIREMENT. IT IS THE RESPONSIBILITY OF THE CONTRACTOR TO ENSURE THAT SILT DOES NOT LEAVE THE RIGHT OF WAY OR CONTAMINATE WATERS OF THE U. S. DURING CONSTRUCTION. THE CONTRACTOR SHALL SUBMIT AN EROSION CONTROL PLAN PRIOR TO COMMENCEMENT OF WORK AND MAINTAIN THE PLAN DURING CONSTRUCTION. ANY ADDITIONAL SILT BASINS NOT SHOWN IN THE PLANS SHALL BE INCLUDED IN THE CONTRACTOR'S EROSION CONTROL PLAN PRIOR TO SUBMITTING FOR APPROVAL.
(13) ALL ITEMS OF WORK ASSOCIATED WITH THE INSTALLATION OF A CONSTRUCTION ENTRANCE SHALL BE ABSORBED IN OTHER ITEMS OF WORK.

PAVEMENT, BASE, AND SHOULDERS

- (14) THE CONTRACTOR SHALL REPAIR ANY DAMAGE TO THE PAVED OR UNPAVED SHOULDER THAT MIGHT OCCUR DURING CONSTRUCTION. ANY REPAIR TO SHOULDER WILL BE IN ACCORDANCE WITH THE APPLICABLE SECTIONS OF THE MISSISSIPPI STANDARD SPECIFICATIONS FOR ROAD AND BRIDGE CONSTRUCTION. NO PAYMENT WILL BE MADE FOR REPAIR OF DAMAGED SHOULDER.
(15) TEMPORARY PAVEMENT JOINTS (PAPER JOINTS) SHALL BE EMPLOYED AT ALL LOCATIONS REQUIRING TRAFFIC TO TRAVERSE AN UNEVEN PAVEMENT JOINT. PAPER JOINTS SHALL BE A MINIMUM OF OF 9 FEET IN LENGTH AND SHALL BE ADEQUATELY MAINTAINED.
(16) WHERE MILLING IS REQUIRED, THE CONTRACTOR SHALL PROVIDE OUTLETS IN THE EXISTING SHOULDERS AT SUFFICIENT INTERVALS TO PREVENT POOLING OR STANDING WATER ON THE MILLED SURFACE, THE COST OF WHICH SHALL BE ABSORBED IN OTHER ITEMS BID.

GENERAL NOTES

PLANS

- (17) IF COLORS ARE USED ON PLAN/PROFILE SHEETS, THEY ARE INTENDED TO VISUALLY EASE THE LOCATION OF ELEMENTS FOR USERS OF THESE DRAWINGS. ALTHOUGH THE INTENT IS TO CATEGORIZE EVERYTHING AS EITHER EXISTING OR PROPOSED, IT IS THE END USER'S RESPONSIBILITY TO ENSURE ALL ELEMENTS ARE INTERPRETED CORRECTLY, REGARDLESS OF COLOR.

- (18) ALL ADDENDA TO THESE PLANS WILL BE POSTED TO WWW.MDOT.MS.GOV UNDER THE PROPOSAL ADDENDA COLUMN. BIDDERS ARE ADVISED THAT HARD COPIES OF ANY ADDENDA FOR THIS PROJECT WILL NOT BE MAILED. IT IS THE BIDDER'S RESPONSIBILITY TO CHECK AND SEE IF ANY ADDENDA HAVE BEEN POSTED FOR THIS PROJECT.

TRAFFIC CONTROL - PERMANENT

- (19) INSTALLATION DATES SHALL BE CLEARLY WRITTEN IN BOLD BLACK MARKINGS ON THE BACK BOTTOM HALF OF ALL SIGNS WITH A PERMANENT MARKING STICK THAT IS WATERPROOF, FADE RESISTANT AND MARKS ON WET OR DRY SURFACES.
(20) ALL POST, PIPE, AND I-BEAM LENGTHS IN THESE PLANS ARE ESTIMATES. POST LENGTHS FOR ALL SIGNS SHALL BE VERIFIED IN THE FIELD BY THE CONTRACTOR PRIOR TO FABRICATION.
(21) ALL EXISTING SIGNS WHICH ARE TO BE REMOVED AS A PART OF THIS PROJECT THAT ARE NOT IN CONFLICT WITH CONSTRUCTION SHALL REMAIN IN PLACE UNTIL NEW SIGNS ARE INSTALLED UNLESS NOTED OR DIRECTED OTHERWISE BY THE PROJECT ENGINEER. ROADWAY SIGNS THAT ARE IN CONFLICT WITH CONSTRUCTION SHALL BE REMOVED AND RELOCATED BY THE CONTRACTOR AS DIRECTED BY THE ENGINEER, THE COST OF WHICH SHALL BE ABSORBED IN OTHER ITEMS BID.
(22) DIRECT-APPLIED LEGEND, BORDER, AND/OR SHIELDS ARE TO BE USED ON ALL SIGNS. DIGITALLY PRODUCED SIGN COPY, SHIELDS, LEGEND, SYMBOLS, OR IMAGES WILL NOT BE ALLOWED WITHOUT WRITTEN APPROVAL FROM MDOT'S PROJECT ENGINEER.
(23) ALL PERMANENT SIGNS SHALL CONFORM TO THE LATEST EDITION OF THE MANUAL ON UNIFORM TRAFFIC CONTROL DEVICES.
(24) ALL SIGN LOCATIONS SHALL BE APPROVED BY THE PROJECT ENGINEER PRIOR TO INSTALLATION.
(25) THE RETROREFLECTIVE SIGN SHEETING ON PERMANENT GROUND-MOUNTED SIGNS SHALL BE AS FOLLOWS: BROWN BACKGROUND SHEETING ON GUIDE SIGNS SHALL BE MINIMUM TYPE VIII; GREEN AND BLUE BACKGROUND SHEETING ON GUIDE SIGNS SHALL BE MINIMUM TYPE IX; ALL WHITE, YELLOW, FLUORESCENT YELLOW AND FLUORESCENT YELLOW/GREEN SHEETING SHALL BE TYPE XI. ALL SIGN SHEETING ON OVERHEAD SIGNS SHALL BE TYPE XI.
(26) ALL EXISTING SIGNS AND SUPPORTS REMOVED UNDER THIS PROJECT SHALL BECOME THE PROPERTY OF THE CONTRACTOR AND ARE NOT A SEPARATE PAY ITEM.
(27) REMOVAL OF RAISED PAVEMENT MARKERS THAT ARE IN CONFLICT WITH REQUIRED CONSTRUCTION IS NOT CONSIDERED A SEPARATE PAY ITEM. COST TO BE ABSORBED IN OTHER ITEMS BID.
(28) REMOVAL OF OBJECT MARKERS IS NOT CONSIDERED A SEPARATE PAY ITEM, AND SHALL BE ABSORBED IN OTHER ITEMS BID.

TRAFFIC CONTROL - TEMPORARY

- (29) THE LOCATION AND SPACING OF SIGNS, SHOWN ON THE TRAFFIC CONTROL PLANS, ARE APPROXIMATE AND MAY BE ADJUSTED AS NECESSARY TO FIT FIELD CONDITIONS.
(30) ALL TRAFFIC CONTROL DEVICES ON THIS PROJECT SHALL COMPLY WITH PART VI OF THE MUTCD (LATEST EDITION).
(31) ALL PLASTIC DRUMS SHALL HAVE A BALLASTING COLLAR MADE FROM RECYCLED TRUCK TIRES OR OTHER SUITABLE MATERIAL.
(32) FLUORESCENT ORANGE SHEETING SHALL BE USED ON ALL CONSTRUCTION AND TRAFFIC CONTROL SIGNS EXCEPT FOR THOSE DESIGNATED ON THE PLANS TO BE BLACK LEGEND AND BORDER ON WHITE BACKGROUND.
(33) THE CONTRACTOR SHALL COVER OR REMOVE ANY TEMPORARY TRAFFIC CONTROL SIGNS SHOWN IN THE TRAFFIC CONTROL PLAN THAT DO NOT APPLY TO THE CURRENT PHASE.
(34) THE RETROREFLECTIVE SIGN SHEETING ON RIGID, TEMPORARY TRAFFIC CONTROL (ORANGE) SIGNS SHALL BE MINIMUM TYPE IX.
(35) TEMPORARY STRIPING SHALL CONFORM TO FINISHED STRIPE SPECIFICATIONS FOR ALIGNMENT, NEATNESS, AND STRAIGHTNESS.

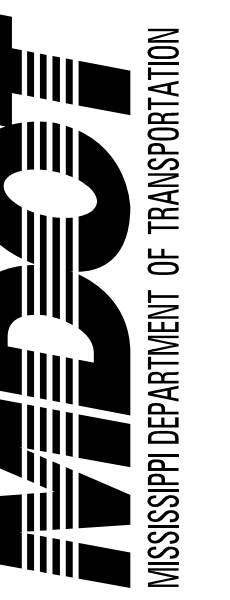
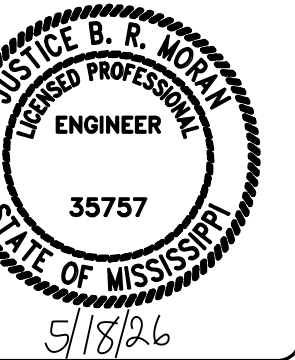

DESIGNED BY: NEEL-SCHAFFER INC.
DETAILED BY:
CHECKED BY:
DATE:

FMS CON: 109902/301000
PROJECT NO.: NHPP-0002-06(034)
COUNTY: LEE

GENERAL NOTES

SHEET ID
GN-1

SHEET NO.
3

PLAN SHEET

5/18/2026 3:08:30 PM GN - General Notes.dgn

GENERAL NOTES

UTILITIES

(36) UTILITIES ON THE DRAWINGS ARE SHOWN IN THEIR ORIGINAL LOCATION BASED UPON THE BEST INFORMATION AVAILABLE TO THE ENGINEER. UTILITIES THAT WERE FOUND TO BE IN CONFLICT WITH CONSTRUCTION HAVE BEEN RELOCATED. PERMITS ARE ON FILE WITH THE DEPARTMENT SHOWING THE APPROXIMATE LOCATION OF UTILITIES RELOCATED WITHIN THE RIGHT-OF-WAY. THE ENGINEER CAN NOT AND DOES NOT WARRANT THAT THIS INFORMATION IS COMPLETE OR ACCURATE. THE CONTRACTOR MUST COORDINATE DIRECTLY WITH THE INVOLVED UTILITY OWNERS TO HAVE UNDERGROUND UTILITY LINES FIELD LOCATED IN ADVANCE OF CONSTRUCTION.

MISCELLANEOUS

(37) SOME WORK IS REQUIRED OUTSIDE THE PROJECT LIMITS. NO ADDITIONAL COMPENSATION WILL BE MADE FOR SUCH WORK EXCEPT AS PROVIDED BY SPECIFIC PAY ITEMS INCLUDED IN THE PLANS.

(38) THE CONTRACTOR IS RESPONSIBLE FOR FIELD-VERIFICATION OF EXISTING GRADES AND MAKING ADJUSTMENTS AS NECESSARY WITH THE APPROVAL OF THE PROJECT ENGINEER.

NOTICE:

THE NOTES CONTAINED HEREON ARE SPECIFIC TO THE PROJECT AND SHOULD BE REVIEWED IN DETAIL BY THE CONTRACTOR, PER SECTION 102.02 OF THE STANDARD SPECIFICATIONS. "THE BIDDER IS REQUIRED TO EXAMINE CAREFULLY THE SITE OF THE PROJECT WORK, THE PROPOSAL, PLAN, STANDARD SPECIFICATION, SPECIAL PROVISIONS, NOTICES TO BIDDERS AND CONTRACT FORMS BEFORE SUBMITTING A PROPOSAL.

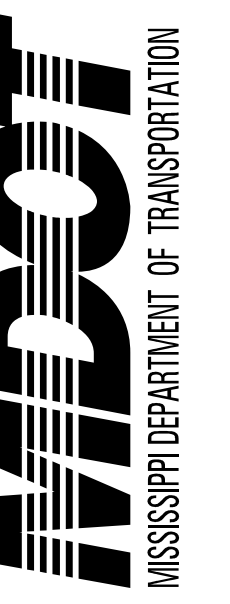
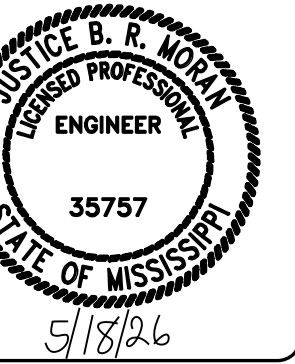

DESIGNED BY: NEEL-SCHAFFER, INC.

DETAILED BY:

CHECKED BY:

DATE:

FMS CON: 109902/301000

PROJECT NO.: NHPP-0002-06(034)

COUNTY: LEE

GENERAL NOTES

SHEET ID
GN-2

SHEET NO.
4