

NOT ALL ROAD NAMES IN INDEX ARE DISPLAYED ON MAP

- 6TH STREET E5
- ACCESS ROAD E5
- ALFORD ROAD E2
- AMOS ROAD C3
- ARTESIA WEST POINT ROAD F5, G5
- 8 AND W DRIVE E1
- BAKER ROAD A3, B3, B4
- BALLAD ROAD E1
- BARKMEYER ROAD E4
- BARNETT ROAD C1
- BARR FIRE TOWER ROAD B3, E3
- BARR ROAD E2, B3
- BARTON FERRY ROAD D7, E6, E7
- BENNETT ROAD F5, F6, G6
- BENNETT ROAD F1, F2
- BENNETT ROAD F3, F4
- BENNETT ROAD F5, F6
- BENNETT ROAD F7, F8
- BENNETT ROAD F9
- BENNETT ROAD F10
- BENNETT ROAD F11
- BENNETT ROAD F12
- BENNETT ROAD F13
- BENNETT ROAD F14
- BENNETT ROAD F15
- BENNETT ROAD F16
- BENNETT ROAD F17
- BENNETT ROAD F18
- BENNETT ROAD F19
- BENNETT ROAD F20
- BENNETT ROAD F21
- BENNETT ROAD F22
- BENNETT ROAD F23
- BENNETT ROAD F24
- BENNETT ROAD F25
- BENNETT ROAD F26
- BENNETT ROAD F27
- BENNETT ROAD F28
- BENNETT ROAD F29
- BENNETT ROAD F30
- BENNETT ROAD F31
- BENNETT ROAD F32
- BENNETT ROAD F33
- BENNETT ROAD F34
- BENNETT ROAD F35
- BENNETT ROAD F36
- BENNETT ROAD F37
- BENNETT ROAD F38
- BENNETT ROAD F39
- BENNETT ROAD F40
- BENNETT ROAD F41
- BENNETT ROAD F42
- BENNETT ROAD F43
- BENNETT ROAD F44
- BENNETT ROAD F45
- BENNETT ROAD F46
- BENNETT ROAD F47
- BENNETT ROAD F48
- BENNETT ROAD F49
- BENNETT ROAD F50
- BENNETT ROAD F51
- BENNETT ROAD F52
- BENNETT ROAD F53
- BENNETT ROAD F54
- BENNETT ROAD F55
- BENNETT ROAD F56
- BENNETT ROAD F57
- BENNETT ROAD F58
- BENNETT ROAD F59
- BENNETT ROAD F60
- BENNETT ROAD F61
- BENNETT ROAD F62
- BENNETT ROAD F63
- BENNETT ROAD F64
- BENNETT ROAD F65
- BENNETT ROAD F66
- BENNETT ROAD F67
- BENNETT ROAD F68
- BENNETT ROAD F69
- BENNETT ROAD F70
- BENNETT ROAD F71
- BENNETT ROAD F72
- BENNETT ROAD F73
- BENNETT ROAD F74
- BENNETT ROAD F75
- BENNETT ROAD F76
- BENNETT ROAD F77
- BENNETT ROAD F78
- BENNETT ROAD F79
- BENNETT ROAD F80
- BENNETT ROAD F81
- BENNETT ROAD F82
- BENNETT ROAD F83
- BENNETT ROAD F84
- BENNETT ROAD F85
- BENNETT ROAD F86
- BENNETT ROAD F87
- BENNETT ROAD F88
- BENNETT ROAD F89
- BENNETT ROAD F90
- BENNETT ROAD F91
- BENNETT ROAD F92
- BENNETT ROAD F93
- BENNETT ROAD F94
- BENNETT ROAD F95
- BENNETT ROAD F96
- BENNETT ROAD F97
- BENNETT ROAD F98
- BENNETT ROAD F99
- BENNETT ROAD F100

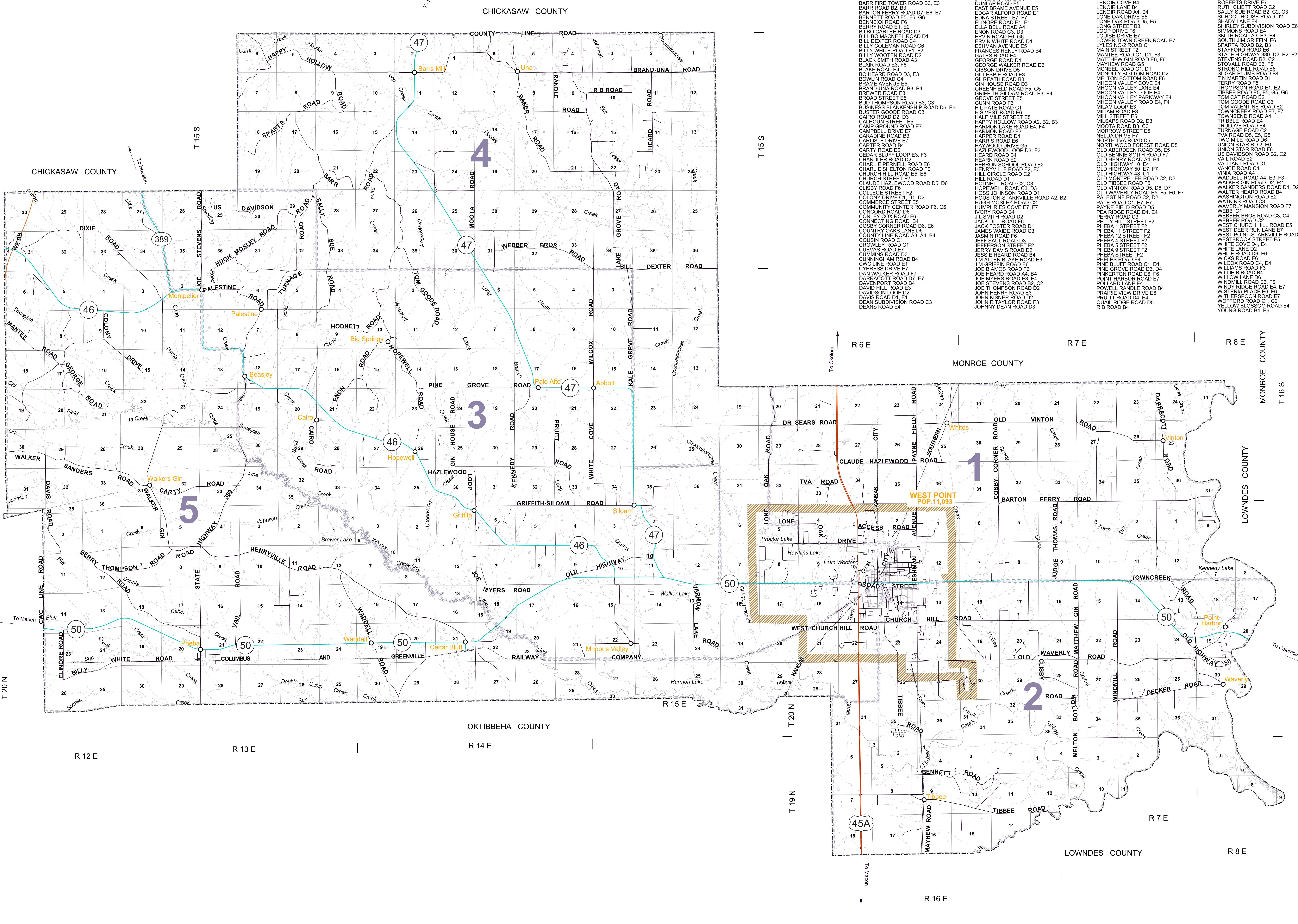

**LEGEND**

- STATE HIGHWAYS (blue circle with number)
- FEDERAL HIGHWAYS (red circle with number)
- INTERSTATE HIGHWAYS (green circle with number)
- COUNTY BOUNDARY (dashed line)
- SUPERVISOR DISTRICT (dotted line)
- NATIONAL PARKS (shaded area)
- INTERNATIONAL AIRPORT (airplane icon)
- AIRPORT (circle with airplane icon)
- LOCAL ROUTES (thin line)
- NATCHEZ TRACE (orange line)
- CITY LIMITS (orange hatched area)
- RAILROADS (black line with cross-ticks)
- RIVERS & STREAMS (blue wavy line)
- NATIONAL FOREST (cross-hatched area)
- LAKES (blue area)
- WETLANDS (green hatched area)

GENERAL HIGHWAY MAP  
**CLAY COUNTY**

MISSISSIPPI DEPARTMENT OF TRANSPORTATION  
PLANNING DIVISION  
IN COOPERATION WITH THE U.S. DEPARTMENT OF TRANSPORTATION  
FEDERAL HIGHWAY ADMINISTRATION

FEATURE	DATA SOURCE	DATE
CITY POPULATION	CENSUS	2013
CITY BOUNDARY	CENSUS	2013
STATE BOUNDARY	USGS	2011
HYDROLOGICAL	USGS	2011
REST LINES	USGS	2011

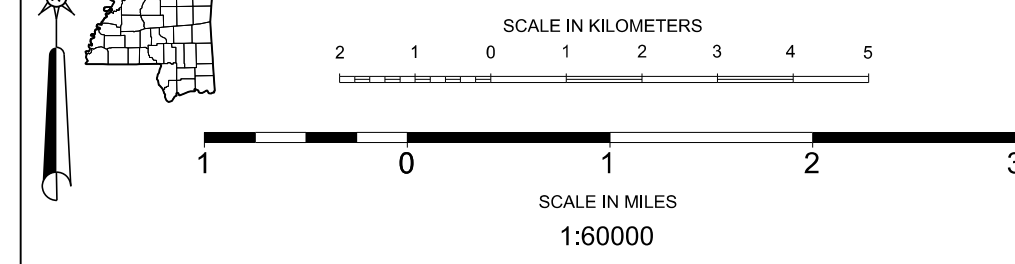

MISSISSIPPI DEPARTMENT OF TRANSPORTATION  
COPYRIGHT LICENSE AGREEMENT

The map is owned by the Mississippi Department of Transportation and is protected by the United States copyright laws and international provisions. You are required to treat the map like any other copyrighted material except that you may copy the map in whole or in part, without modification, provided the notice of copyright by the Mississippi Department of Transportation is displayed in a prominent location on each copy.

You have a royalty-free right to reproduce and distribute the copyrighted map in a whole or in part, without modification provided the Mississippi Department of Transportation copyright notice is displayed in a prominent visible location on each reproduction.

Any modification of a map voids this agreement and requires your license to use, copy, and distribute the map. Use of modified maps is strictly prohibited and is subject to prosecution under State and Federal laws.

This agreement is governed by the Laws of the State of Mississippi, U.S. Federal, and U.S. International Treaties.

Should you have any questions concerning this agreement, please write: Mississippi Department of Transportation, Planning Division, Post Office Box 1650, Jackson, Mississippi 39215-1650.